

WIS 28 Bridge

E Branch Rock River Bridge

Dodge County

Public Involvement Meeting
November 16th, 2023



Project Contacts

- Andy Luedtke
 - WisDOT Project Leader
- Craig Hardy, P.E.
 - WisDOT Project Manager
- Justin Kutschenreuter, P.E.
 - WisDOT Project Supervisor



Presentation overview

- Project limits
- Purpose and need of the project
- Proposed improvements
- Detour & traffic control information
- Schedule
- Questions



Project limits

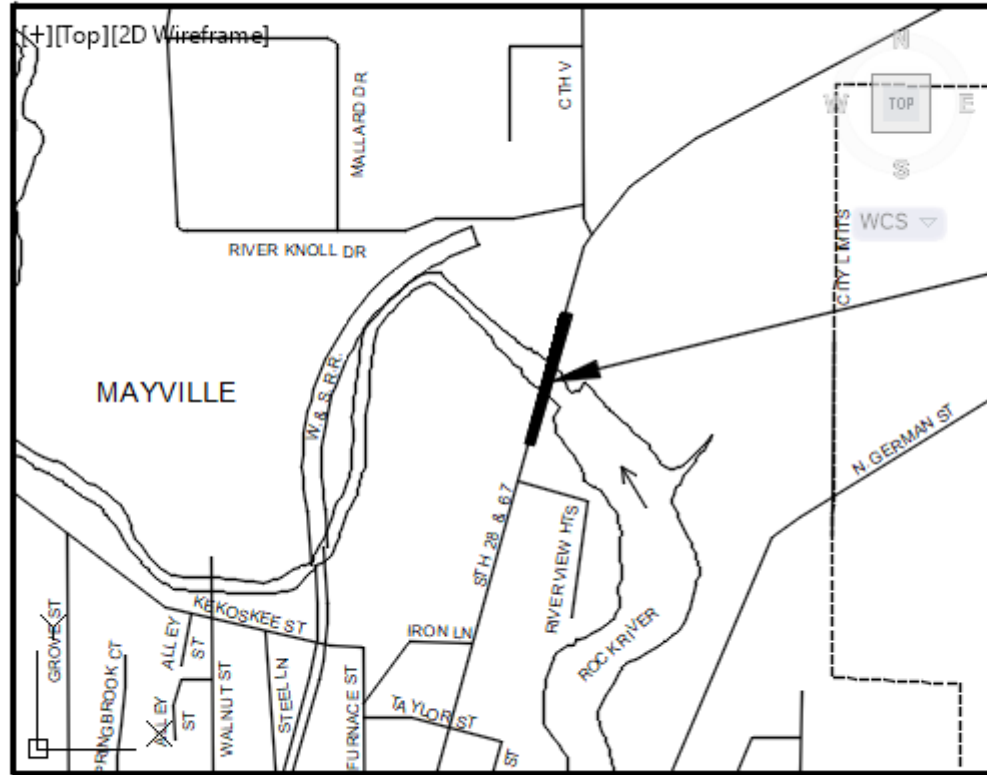

PROJECT LOCATION
STRUCTURE B-14-067

Project limits

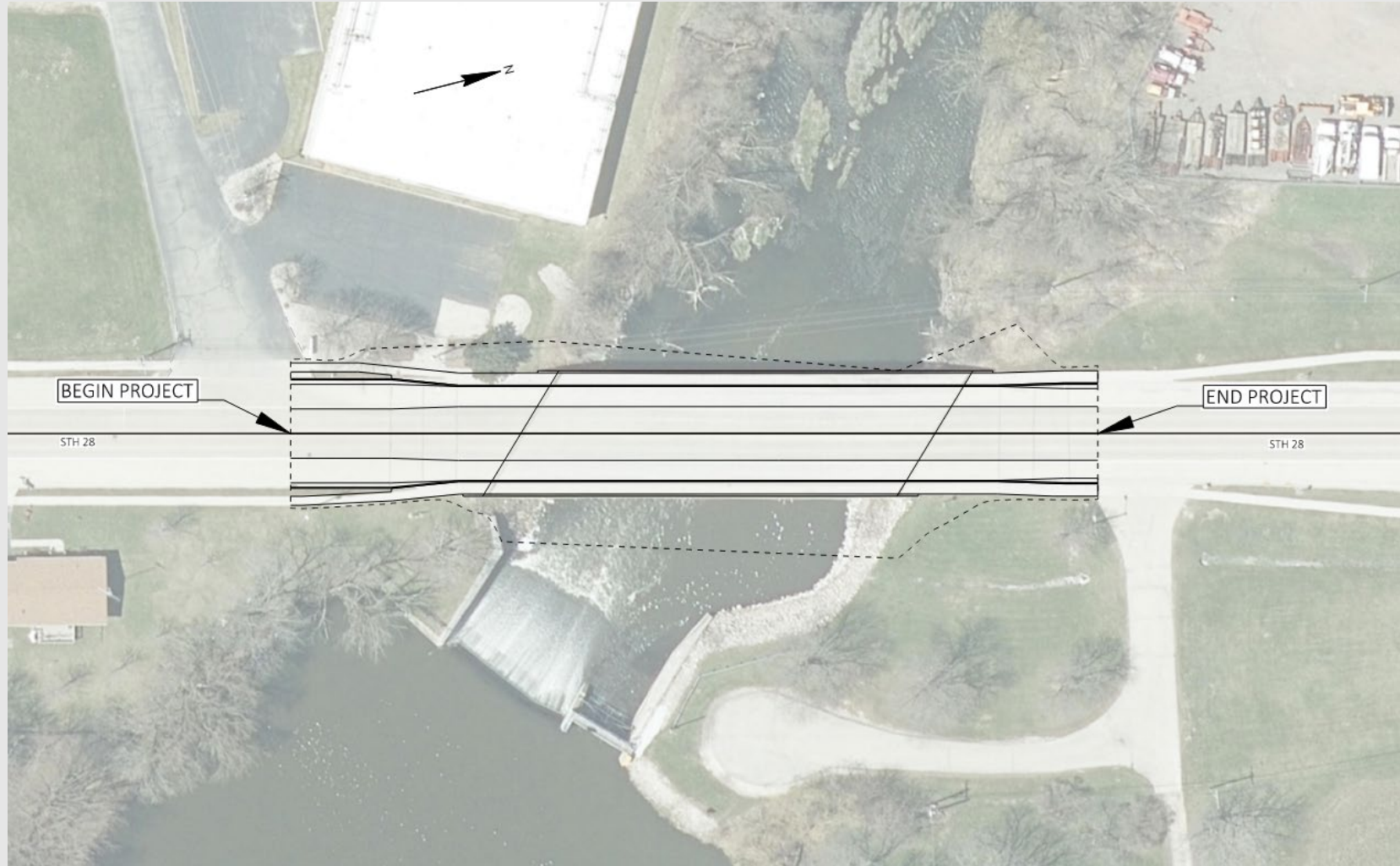

Purpose and need

- The purpose of the project is to address deteriorating concrete and moderate rusting



Purpose and need

- The concrete has large spalls with exposed rebar



Purpose and need

- The steel girders have moderate rust and the paint is failing at areas of corrosion



Purpose and need

- Corrective action is needed to address the large concrete spalls, rusted steel members, and areas of failing paint



Proposed improvements

- Replace bridge deck
- Repaint girders in areas of rust
- Replace roadway approaches leading up to bridge
- Concrete surface repairs at the abutments
- Additional riprap at abutment slopes
- Widen sidewalk from 5' to 6' on the bridge



Proposed improvements

- Replace bridge deck
- Replace roadway approaches
- Widen sidewalk on bridge from 5' to 6'

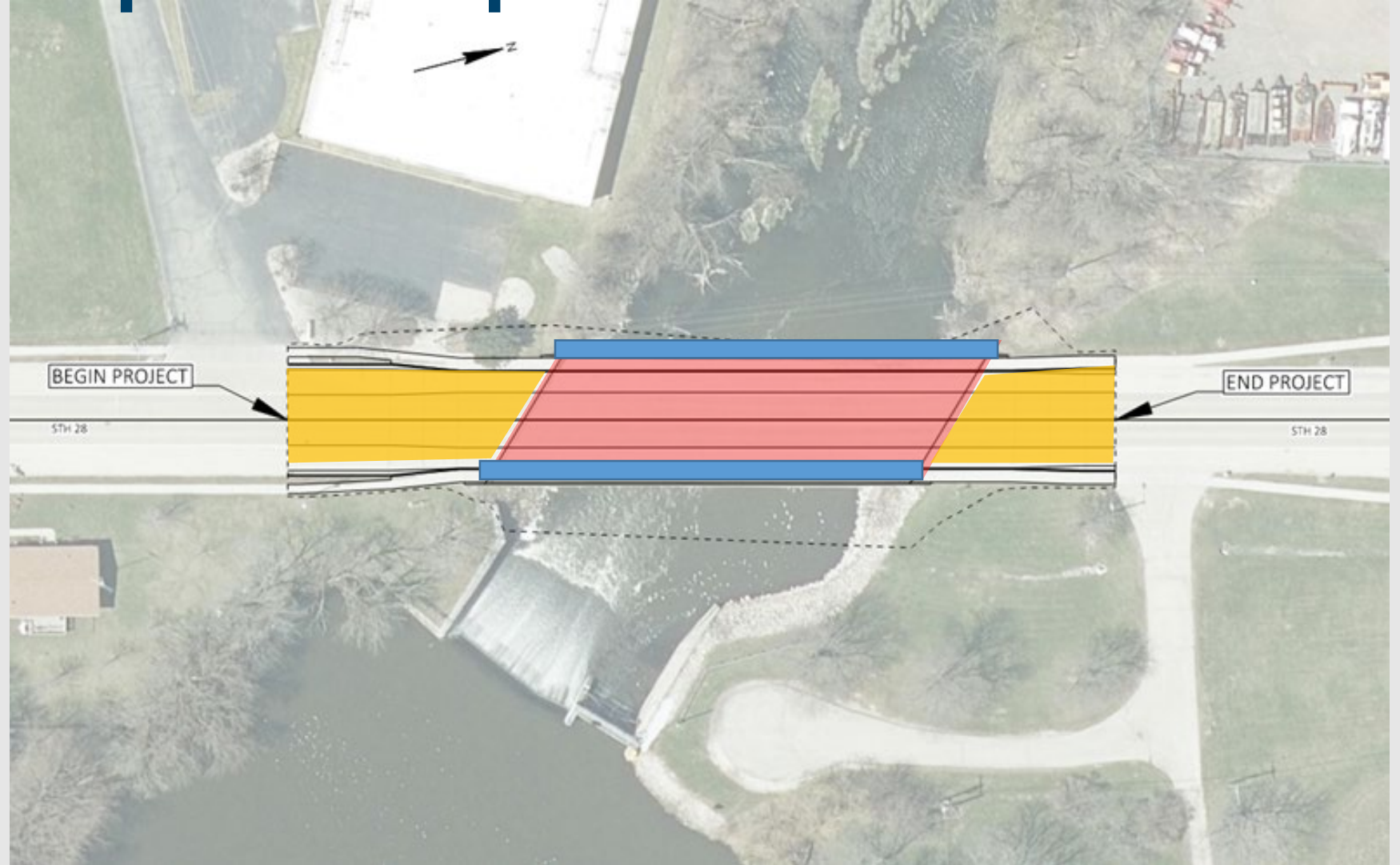

Proposed improvements

- Example of concrete surface in need of repair
- Example of a potential area for additional riprap



Detour

- WIS 28
 - WIS 67 to WIS 33 to I-41

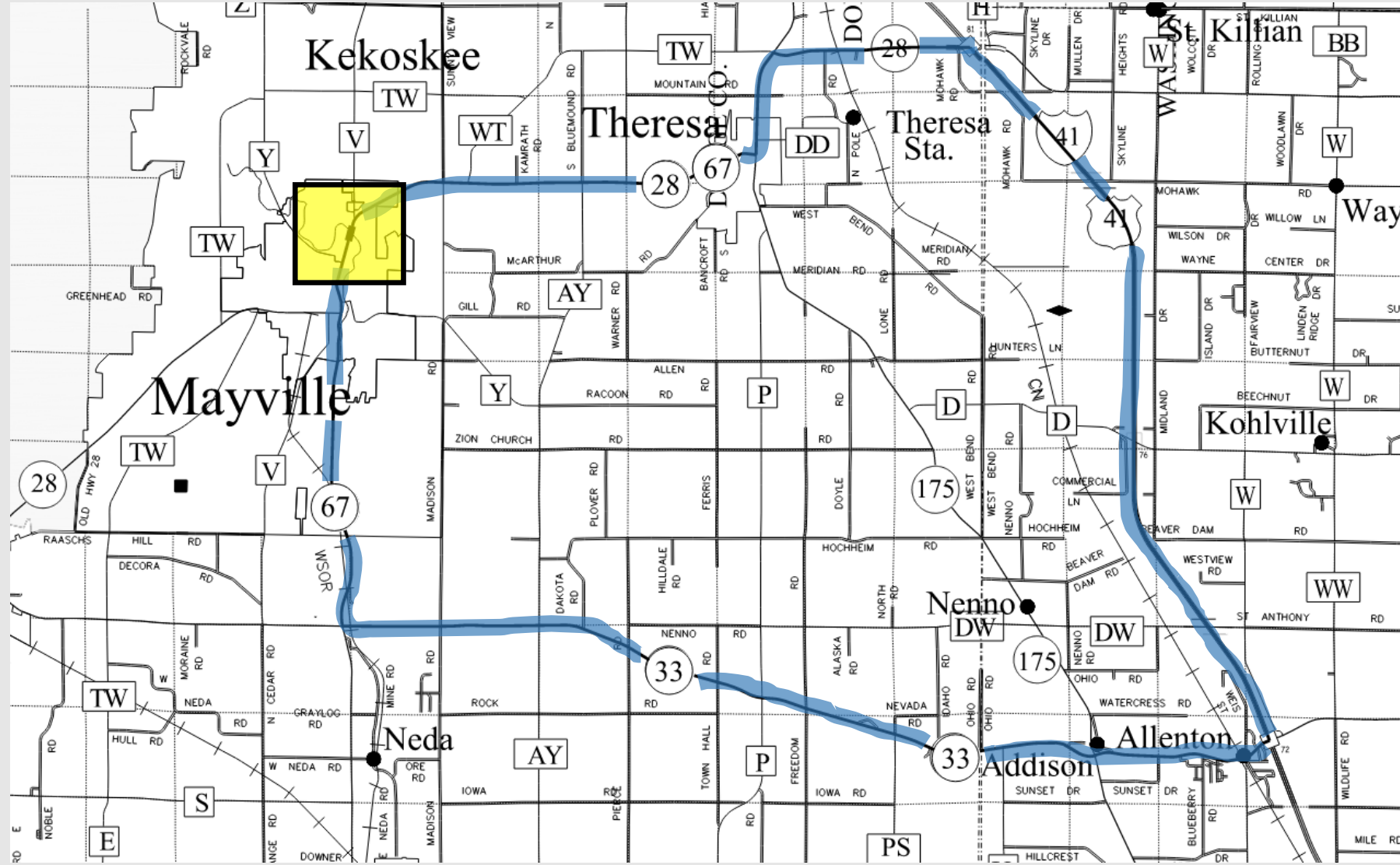

Schedule

- Environmental document – February 2024
- 60% plan – June 2024
- Second public involvement meeting – May 2025
- 90% plan – March 2025
- Final plans due – August 2026
- Construction – Summer 2027



Related projects

- WIS 28

- County V to WIS 175 – Anticipated 2025 construction
 - Mill & Overlay
 - Culverts
 - Sidewalk Ramps

- WIS 28

- Raaschs Hill Rd to County TW – Anticipated 2025 construction
 - Mill & Overlay



Related projects

- WIS 175

- Dodge County Line (Hochheim Rd) to County DD – Anticipated 2027 construction
 - Mill & overlay (rural)
 - Reconstruction (urban)

- WIS 67

- WIS 60 to County S – Anticipated 2026 construction
 - Mill & overlay



Related projects

- I-41

- WIS28 to North County Line— Anticipated 2027 construction
 - Resurfacing, north and southbound lanes

- WIS 33

- Horicon to West Bend – Anticipated 2029 construction
 - Work TBD



Questions

For more information, please contact:

Andy Luedtke
Project Leader
608-246-3269

Andrew.Luedtke@dot.wi.gov

Craig Hardy, P.E.
Project Manager
608-246-5406

Craig.Hardy@dot.wi.gov

Justin Kutschenreuter, P.E.
Project Supervisor
262-548-6441

Justin.Kutschenreuter@dot.wi.gov

