

NOTES

1. Sign is Type II - Type H Reflective
2. Color:
Background - Blue
Message - White
3. Message Series - D
4. D5-53L is the same as D6-53R except that the arrow is reversed.

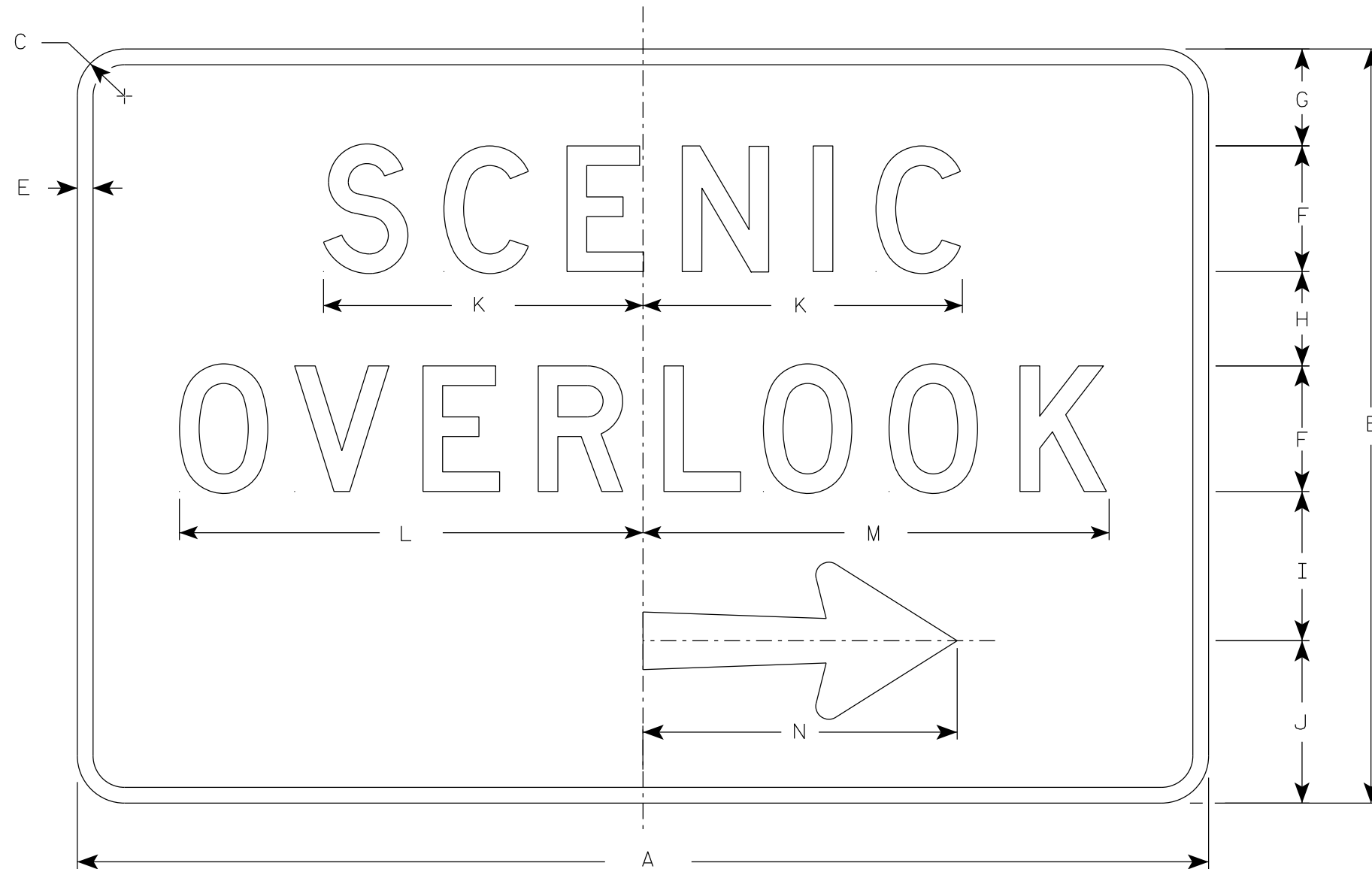

D6-53R

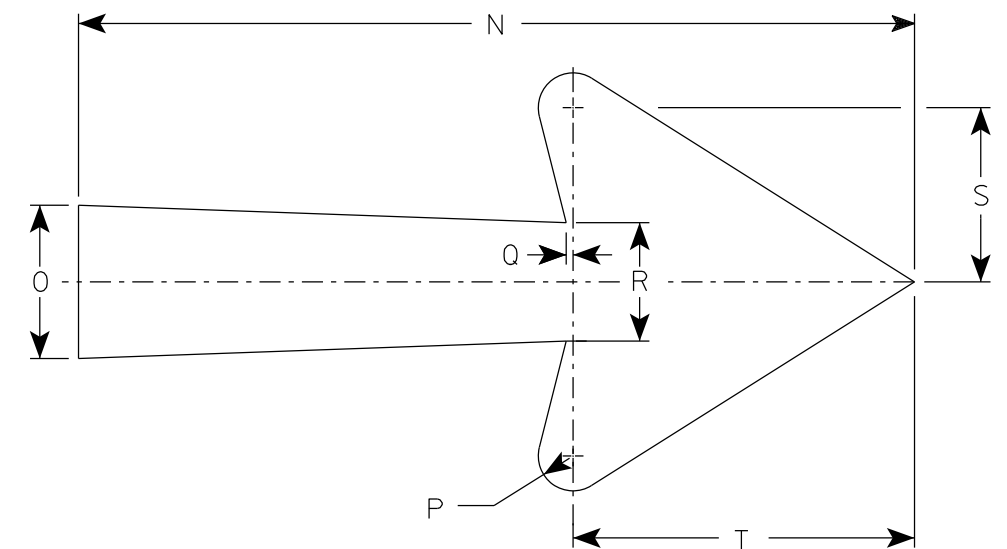

Arrow Detail

SIZE	A	B	C	D	E	F	G	H	I	J	K	L	M	N	O	P	Q	R	S	T	U	V	W	X	Y	Z	Area sq. ft.
1																											
2	54	36	2 1/4		3/4	6	4 5/8	4 1/2	7 1/8	7 3/4	15 1/4	22 1/8	22 1/4	15	2 3/4	5/8	1/8	2 1/8	3 1/8	6 1/8							13.5
3	72	48	3		1	8	6	6	10	10	20	28 1/4	28 1/4	21	4 1/4	3/4	1/4	2 3/4	4	7 7/8							24.0
4																											
5																											

STANDARD SIGN
D6-53

WISCONSIN DEPT OF TRANSPORTATION

APPROVED *Matthew R Rauch*
for State Traffic Engineer

DATE 4/9/19 PLATE NO. D6-53.6