

NOTES

1. Sign is Type II - Type H Reflective
2. Color:  
Background - Brown  
Message - White
3. Message Series - D
4. D7-66L is the same as D7-66R except that the arrow is reversed.

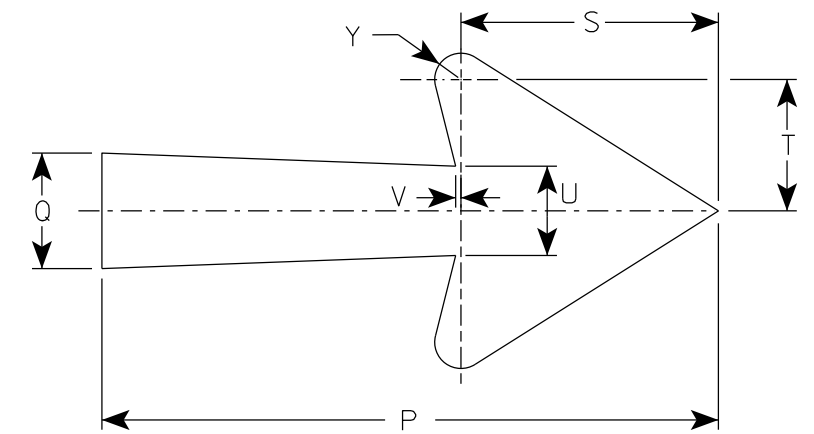

Arrow Detail

SIZE	A	B	C	D	E	F	G	H	I	J	K	L	M	N	O	P	Q	R	S	T	U	V	W	X	Y	Z	Area sq. ft.
1																											
2S	60	36	1 7/8		3/4	4 1/2	6	4 5/8	4 1/2	7 1/8	7 3/4	16 7/8	1	23		21	3 1/4	5/8	6 1/8	3 1/8	2 1/8	1/8	5	17 3/8	5/8		15.0
2M	60	36	1 7/8		3/4	4 1/2	6	4 5/8	4 1/2	7 1/8	7 3/4	16 7/8	1	23		21	3 1/4	5/8	6 1/8	3 1/8	2 1/8	1/8	5	17 3/8	5/8		15.0
3	78	48	3		1	6	8	6	6	10	10	23	1 1/2	31		27	4 1/4	1/8	7 7/8	4	2 3/4	1/4	7	23 7/8	3/4		26.0
4																											
5																											

STANDARD SIGN  
D7-66

WISCONSIN DEPT OF TRANSPORTATION

APPROVED *Matthew R. Rauch*  
for State Traffic Engineer

DATE 3/27/2024 PLATE NO. D7-66.8