



Wisconsin Department of Transportation

Division of Transportation Systems Development

Bureau of Project Development
 4802 Sheboygan Avenue, Rm 601
 P O Box 7916
 Madison, WI 53707-7916

Telephone: (608) 266-1631
 Facsimile (FAX): (608) 266-8459

March 5, 2018

NOTICE TO ALL CONTRACTORS:

**Proposal #29: 1517-75-73, WISC 2018 157
 USH 10 – USH 10/STH 441
 County CB – Oneida Street
 USH 10
 Winnebago County**

**1517-75-79, WISC 2018 158
 USH 10 – USH 10/STH 441
 County CB – Oneida Street
 USH 10
 Winnebago County**

Letting of March 13, 2018

This is Addendum No. 02, which provides for the following:

Schedule of Items:

Revised Bid Item Quantities					
Bid Item	Item Description	Unit	Old Quantity	Revised Quantity	Proposal Total
201.0105	Clearing	STA	150	6	156
201.0205	Grubbing	STA	150	6	156
205.0100	Common Excavation	CY	408,513	34,750	443,263
522.1036	Apron Endwalls for Culvert Pipe Reinforced Concrete 36-Inch	Each	11	-1	10
628.7504	Temporary Ditch Checks	LF	1501	80	1581
635.0200	Sign Support Structural Steel HS	LB	2756	293	3049
636.0100	Sign Support Concrete Masonry	CY	409.0	1.6	410.6
636.0500	Sign Support Steel Reinforcement	LB	340	98	438

Added Bid Item Quantities					
Bid Item	Item Description	Unit	Old Quantity	Revised Quantity	Proposal Total
638.2101	Moving Signs Type I	Each	0	1	1
638.4100	Moving Structural Steel Sign Supports	Each	0	2	2

Plan Sheets:

Revised Plan Sheets	
Plan Sheet	Plan Sheet Title (brief description of changes to sheet)
84 & 85	1517-75-73 Construction Detail at Fill Site adding Sign work and erosion control
319-323	1517-75-73 Permanent Signing w/ Speed Limit Sign Revisions
823	1517-75-73 Clearing and Grubbing table to add work at Fill site

829	1517-75-73 Common Excavation quantity modification to account for clay liner excavation
841	1517-75-73 Apron Endwall MQ modified to remove duplicate endwall
867	1517-75-73 Erosion Control MQ modified for work at Fill Site
875-877	1517-75-73 Permanent signing MQ modified for work at Fill Site and for Speed limit change
1184	1517-75-73 Structures N-70-121, 130, 131, 140 – added correct bracket needed for Fire Hydrant and addresses to put on the sign

Schedule of Items

Attached, dated March 5, 2018, are the revised Schedule of Items Pages 1, 2, 6, 13, 14, and 33.

Plan Sheets

The following 8½ x 11-inch sheets are attached and made part of the plans for this proposal:
Revised: 84, 85, 319-323, 823, 829, 841, 867, 875-877 and 1184.

The responsibility for notifying potential subcontractors and suppliers of these changes remains with the prime contractor.

Sincerely,

Mike Coleman

Proposal Development Specialist
Proposal Management Section

END OF ADDENDUM

Addendum No. 02
ID 1517-75-73
Revised Sheet 84
March 5, 2018

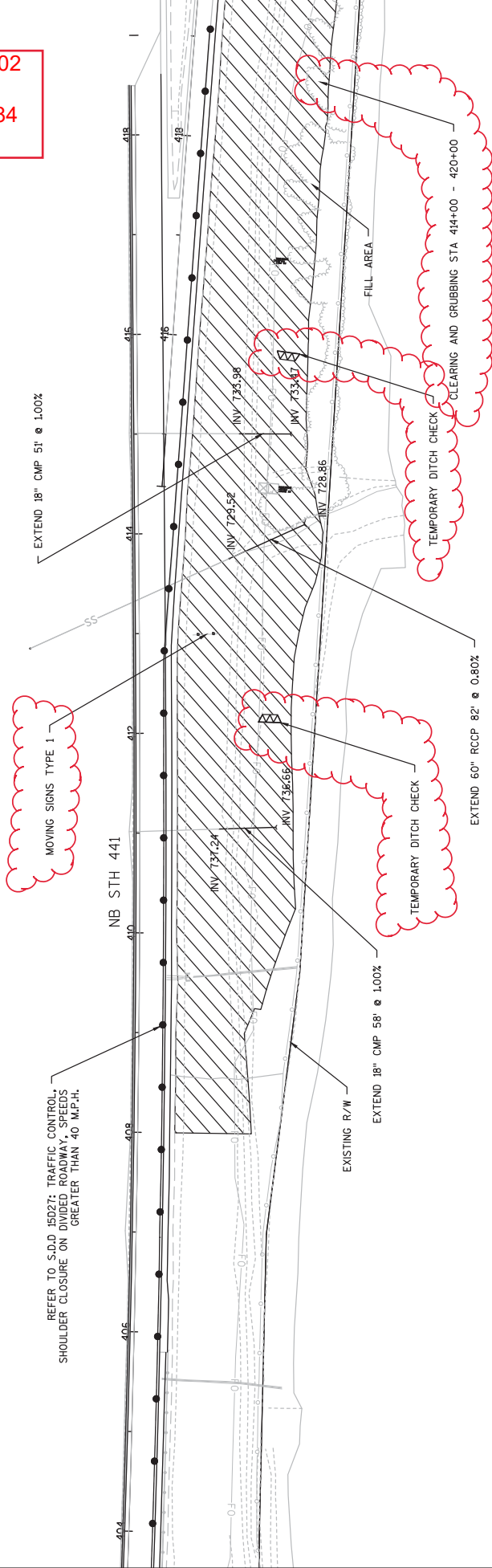



CTH 00

REFER TO S.D.D. 15027, TRAFFIC CONTROL, DIVIDED ROADWAY, SPEEDS GREATER THAN 40 M.P.H. SHOULDER CLOSURE ON DIVIDED ROADWAY, SPEEDS GREATER THAN 40 M.P.H.

NB STH 441

ACCESS FILL AREA HERE

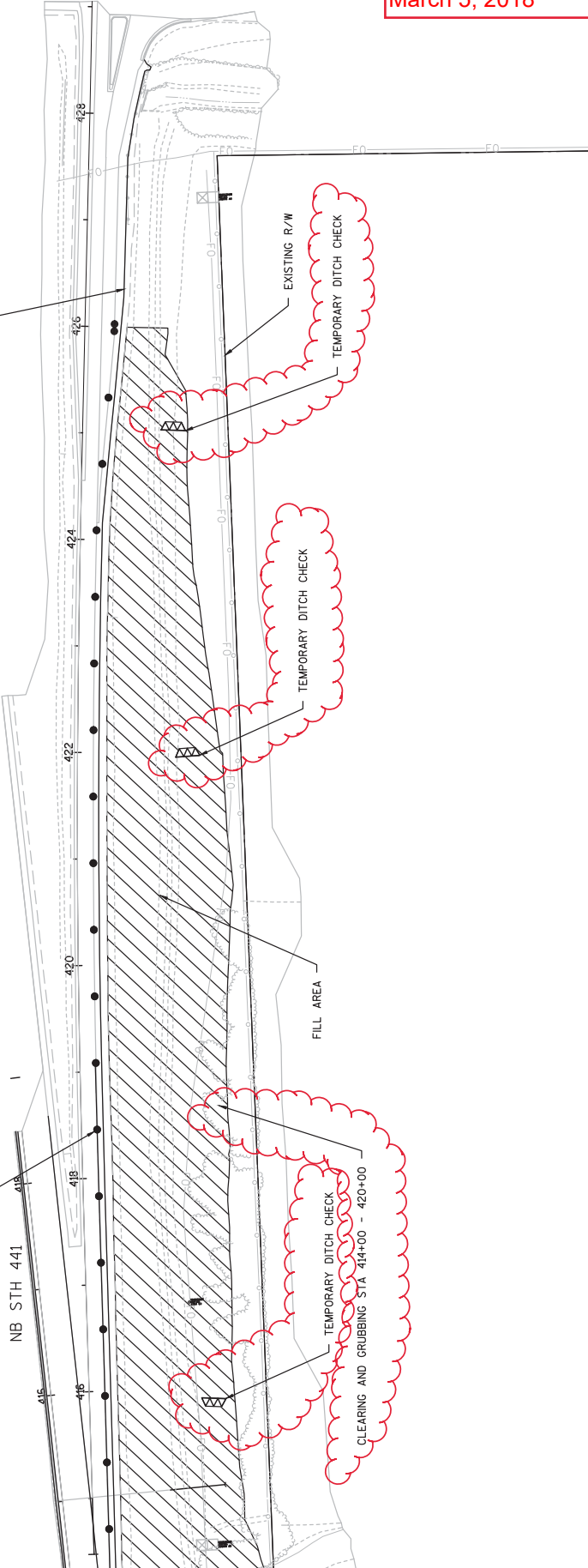

Addendum No. 02
 ID 1517-75-73
 Revised Sheet 85
 March 5, 2018

PROJECT NO: 1517-75-73	HWY: STH 441/USH 10	COUNTY: WINNEBAGO	CONSTRUCTION DETAIL: STH 441/CTH 00 FILL SITE	SHEET 85
FILE NAME : S:\NPOS\C30\WIS441\B00\DESIGN\WIS441\B00\FILL-75.DWG				
LAYOUT NAME - WIS441\B00\FILL\NEWALTERNATEZ - 06 (1)				
PLOT DATE : 2/26/2018 3:50 PM			PLOT SCALE : 1 IN:100 FT	
PLOT BY : COHEN, MICHAEL J			PLOT NAME :	
WISDOT/CADD SHEET 42				

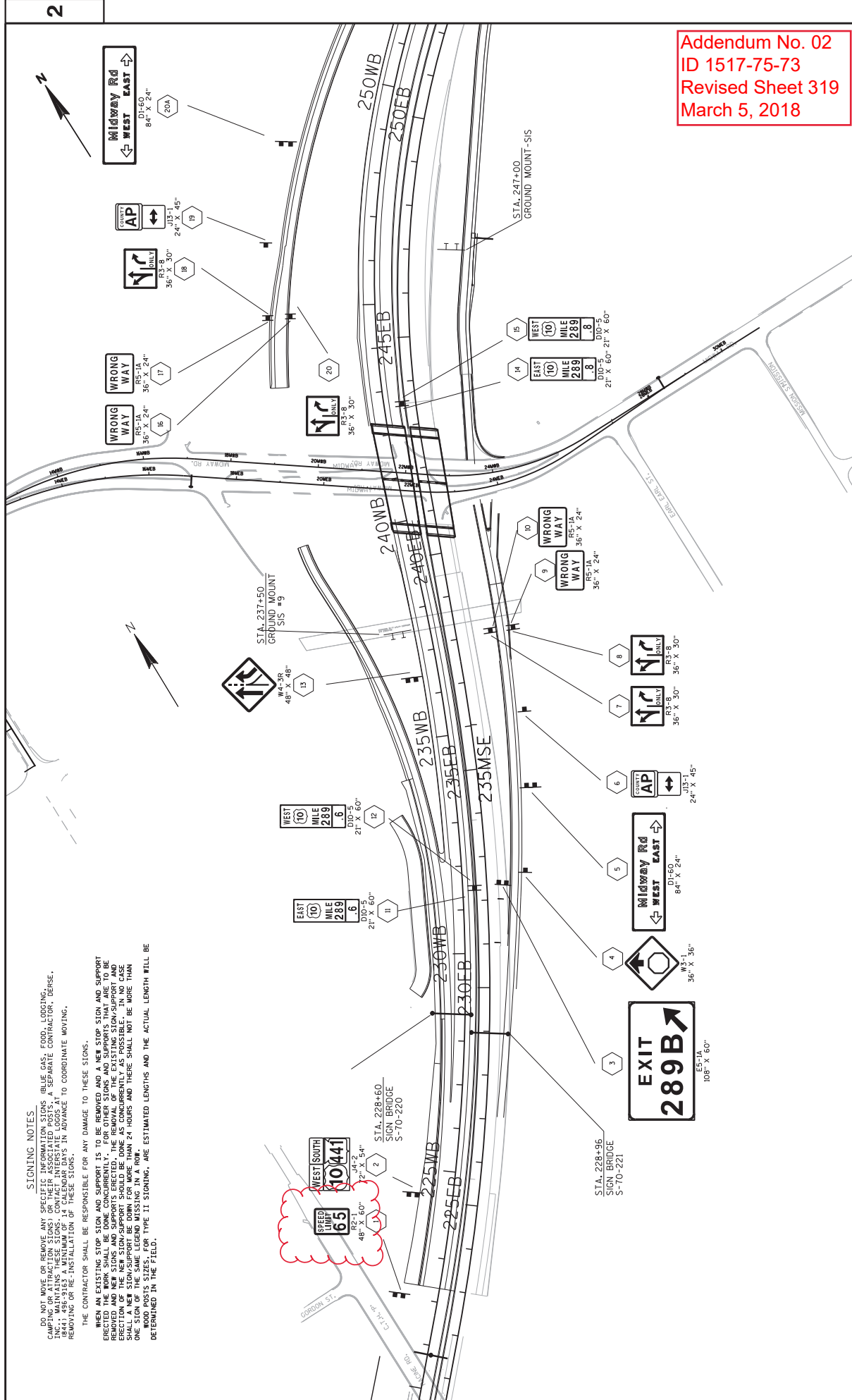

Addendum No. 02
 ID 1517-75-73
 Revised Sheet 319
 March 5, 2018

SIGNING NOTES

DO NOT MOVE OR REMOVE ANY SPECIFIC INFORMATION SIGNS (BLUE GAS, FORD, LOADING, INC., MAINTAINS THESE SIGNS, CONTACT INTERSTATE LOGS AT 844.498-9163 A MINIMUM OF 14 CALENDAR DAYS IN ADVANCE TO COORDINATE MOVING, REMOVING OR RE-INSTALLATION OF THESE SIGNS.

THE CONTRACTOR SHALL BE RESPONSIBLE FOR ANY DAMAGE TO THESE SIGNS.

WHEN AN EXISTING STOP SIGN AND SUPPORT IS TO BE REMOVED AND A NEW STOP SIGN AND SUPPORT IS TO BE INSTALLED, THE EXISTING STOP SIGN AND SUPPORT SHALL BE REMOVED AND NEW SIGNS AND SUPPORTS ERECTED. THE REMOVAL OF THE EXISTING SIGN/SUPPORT AND ERECTION OF THE NEW SIGN/SUPPORT SHOULD BE DONE AS CONCURRENTLY AS POSSIBLE. IN NO CASE SHALL THE WORK BE COMPLETED IN LESS THAN 24 HOURS AND THERE SHALL NOT BE MORE THAN ONE SIGN OF THE SAME LEGEND MISSING IN A ROW.

WOOD POSTS SIZES, FOR TYPE II SIGNING, ARE ESTIMATED LENGTHS AND THE ACTUAL LENGTH WILL BE DETERMINED IN THE FIELD.



SIGNING NOTES

DO NOT MOVE OR REMOVE ANY SPECIFIC INFORMATION SIGNS (BELLIE GAS, FOOD, LODGING, ETC.), MAINTAINING THESE SIGNS. CONTACT INTERSTATE LOGS AT (844) 498-6362. A MINIMUM OF 14 CALENDAR DAYS IN ADVANCE TO COORDINATE MOVING, REMOVAL OR THE INSTALLATION OF THESE SIGNS.

THE CONTRACTOR SHALL BE RESPONSIBLE FOR ANY DAMAGE TO THESE SIGNS.

WHEN AN EXISTING STOP SIGN AND SUPPORT IS TO BE REMOVED AND A NEW STOP SIGN AND SUPPORT ERRECTED THE WORK SHALL BE DONE CONCURRENTLY. FOR OTHER SIGNS AND SUPPORTS THAT ARE TO BE ERRECTED THE CONTRACTOR SHALL BE RESPONSIBLE FOR THE REMOVAL OF THE EXISTING SIGN AND SUPPORTS. THE ERECTION OF THE NEW SIGN/SUPPORT SHOULD BE DONE AS CONCURRENTLY AS POSSIBLE. IN NO CASE SHALL A NEW SIGN/SUPPORT BE DOWN FOR MORE THAN 24 HOURS AND THERE SHALL NOT BE MORE THAN ONE SIGN/SUPPORT DOWN AT ANY ONE TIME. THE CONTRACTOR SHALL BE RESPONSIBLE FOR THE REMOVAL OF ROAD POSTS. SIGNS, FOR TYPE 11 SIGNING, ARE ESTIMATED LENGTHS AND THE ACTUAL LENGTH WILL BE DETERMINED IN THE FIELD.



E5-11A
108" X 60"

200



E5-1
36" X 36"
20B



E5-1
48" X 60"
65



E5-1
72" X 54"
10441



E5-1
21" X 60"
10
290
4
24



E5-1
21" X 60"
10
290
4
23

1280ANW
280WB
280EB
1280ASW

1275ANW
275WB
275EB
1275ASW

270WB
270ASW

265WB
265EB

260WB
260EB

255EB

Addendum No. 02
ID 1517-75-73
Revised Sheet 320
March 5, 2018



SIGNING NOTES

DO NOT MOVE OR REMOVE ANY EXISTING INFORMATION SIGNS (BLUE GAGE, FOOD, LOGGING, CAMPING OR ATTRACTION SIGNS) OR THEIR ASSOCIATED POSTS. A SEPARATE CONTRACTOR, DERSE, INC., WILL MAINTAIN THESE SIGNS. CONTRACTOR SHALL ADVISE STATE LOGS AT THE TIME OF REMOVAL OR RE-INSTALLATION OF THESE SIGNS.

THE CONTRACTOR SHALL BE RESPONSIBLE FOR ANY DAMAGE TO THESE SIGNS. WHEN AN EXISTING STOP SIGN AND SUPPORT IS TO BE REMOVED AND A NEW STOP SIGN AND SUPPORT ERRECTED THE WORK SHALL BE DONE CONCURRENTLY. ALL OTHER SIGNS AND SUPPORTS THAT ARE TO BE ERRECTED SHALL BE DONE CONCURRENTLY. THE ERRECTION OF THE NEW SIGN/SUPPORT SHALL BE DONE AS CONCURRENTLY AS POSSIBLE. IN NO CASE SHALL A NEW SIGN/SUPPORT BE DOWN FOR MORE THAN 24 HOURS AND THERE SHALL NOT BE MORE THAN ONE SIGN/SUPPORT DOWN AT ANY ONE TIME. SIGN/SUPPORT SIZES, FOR TYPE II SIGNING, ARE ESTIMATED LENGTHS AND THE ACTUAL LENGTH WILL BE DETERMINED IN THE FIELD.

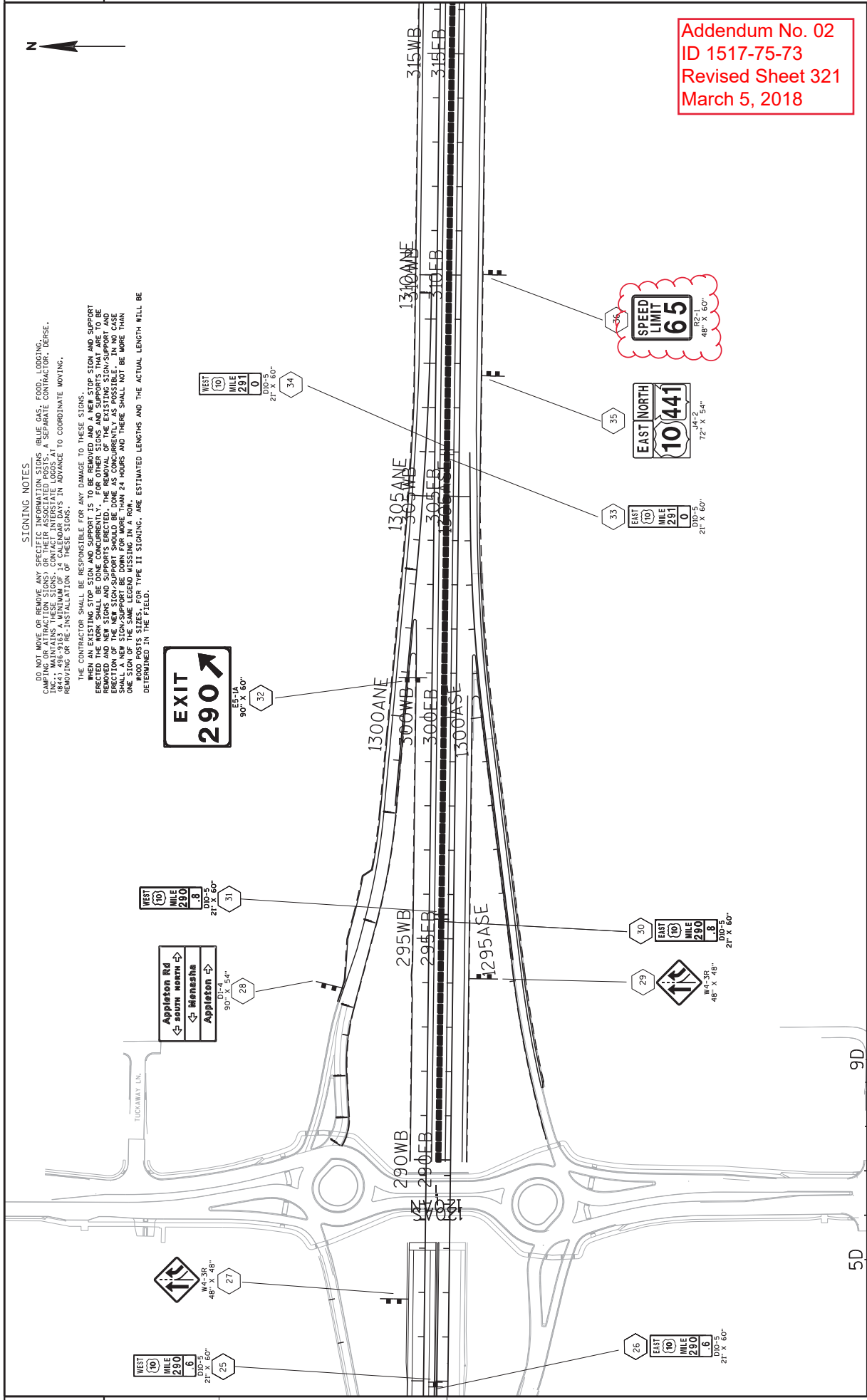

Addendum No. 02
ID 1517-75-73
Revised Sheet 321
March 5, 2018

WEST
(10)
MILE
290
8
D10-5
21" X 60"
25

Appleton Rd
← south north →
← Menasha →
Appleton
90" X 54"
21

WEST
(10)
MILE
290
8
D10-5
21" X 60"
31

WEST
(10)
MILE
290
8
D10-5
21" X 60"
32

EAST
(10)
MILE
290
6
D10-5
21" X 60"
26

WEST
(10)
MILE
290
8
D10-5
21" X 60"
29

EAST
(10)
MILE
290
8
D10-5
21" X 60"
30

EAST
(10)
MILE
291
0
D10-5
21" X 60"
33

EAST NORTH
10/441
72" X 54"
35

SPEED
LIMIT
65
48" X 60"
36



SIGNING NOTES

DO NOT MOVE OR REMOVE ANY SPECIFIC INFORMATION SIGNS (BLUE GAS, FOOD, LOADING, CAPS, etc.) UNLESS SPECIFICALLY NOTED OTHERWISE. CONTACT INTERSTATE LOGS AT 800-445-4667 FOR MORE INFORMATION ON THESE SIGNS.

THE CONTRACTOR SHALL BE RESPONSIBLE FOR ANY DAMAGE TO THESE SIGNS.

WHEN AN EXISTING STOP SIGN AND SUPPORT IS TO BE REMOVED AND A NEW STOP SIGN AND SUPPORT ERECTED THE WORK SHALL BE DONE CONCURRENTLY. FOR OTHER SIGNS AND SUPPORTS THAT ARE TO BE REMOVED AND NEW SIGNS AND SUPPORTS ERECTED, THE REMOVAL OF THE EXISTING SIGN/SUPPORT AND THE ERUCTION OF THE NEW SIGN/SUPPORT SHALL BE DONE SEPARATELY. THE CONTRACTOR SHALL A NEW SIGN/SUPPORT BE DOWN FOR MORE THAN 24 HOURS AND THERE SHALL NOT BE MORE THAN ONE SIGN OF THE SAME LEGEND MISSING IN A ROW.

ESTIMATED LENGTHS OR TYPE II SIGNING, ARE ESTIMATED LENGTHS AND THE ACTUAL LENGTH WILL BE DETERMINED IN THE FIELD.

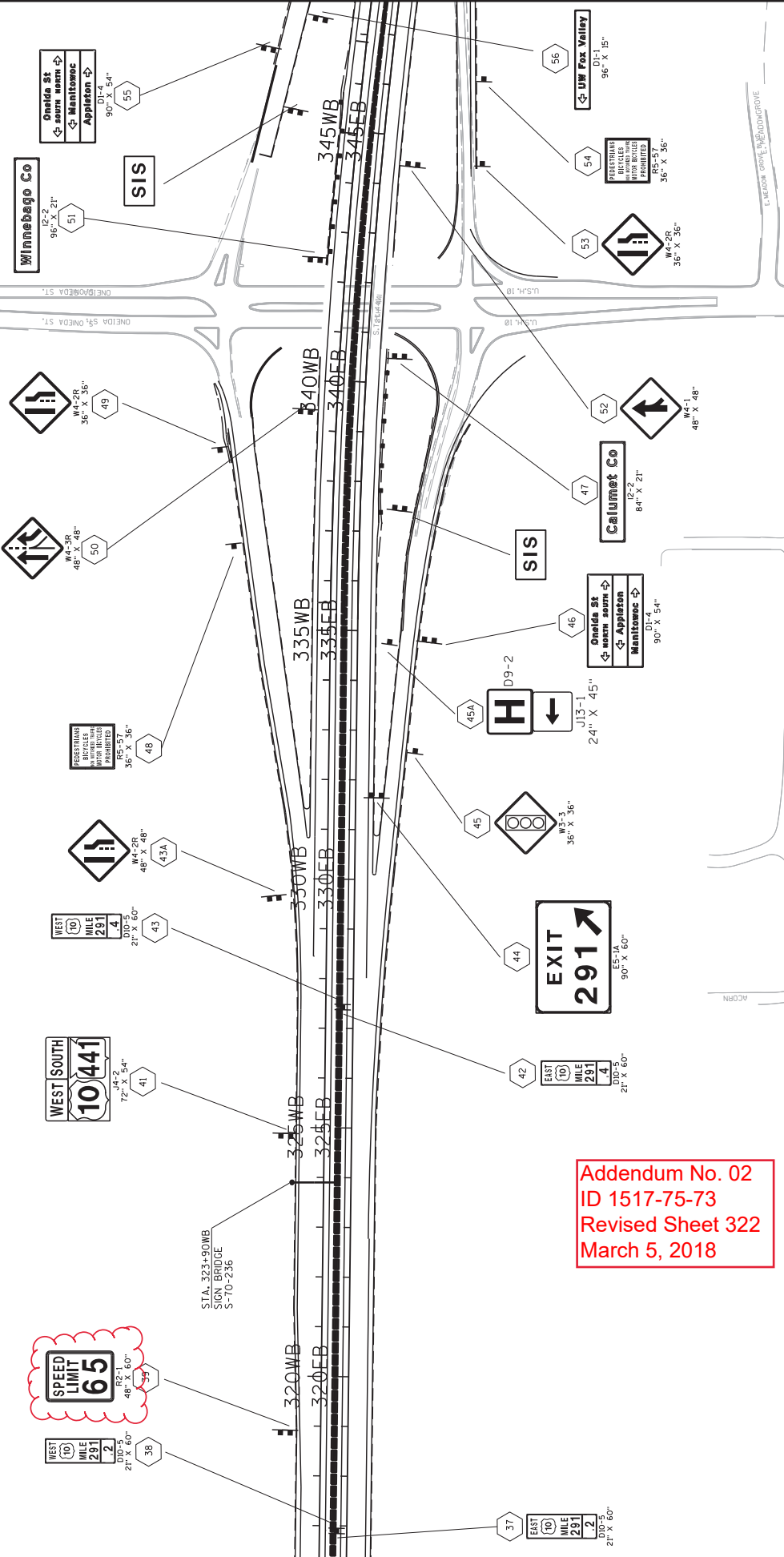

Addendum No. 02
 ID 1517-75-73
 Revised Sheet 322
 March 5, 2018



Addendum No. 02
ID 1517-75-73
Revised Sheet 323
March 5, 2018

SIGNING NOTES

DO NOT MOVE OR REMOVE ANY SPECIFIC INFORMATION SIGNS (BLUE GAS, FOOD, LOADING, CAMPING OR ATTRACTION SIGNS) OR THEIR ASSOCIATED POSTS. A SEPARATE CONTRACTOR, DESER, INC., MAINTAINS THESE SIGNS. CONTACT DESER, INC. FOR ANY INFORMATION REGARDING THE REMOVAL OR RE-INSTALLATION OF THESE SIGNS.

THE CONTRACTOR SHALL BE RESPONSIBLE FOR ANY DAMAGE TO THESE SIGNS. WHEN AN EXISTING STOP SIGN AND SUPPORT IS TO BE REMOVED AND A NEW STOP SIGN AND SUPPORT ERRECTED THE WORK SHALL BE DONE CONCURRENTLY. FOR OTHER SIGNS AND SUPPORTS THAT ARE TO BE ERRECTED THE CONTRACTOR SHALL BE RESPONSIBLE FOR THE REMOVAL OF THE EXISTING SIGNS AND SUPPORTS. THE ERECTION OF THE NEW SIGN/SUPPORT SHOULD BE DONE AS CONCURRENTLY AS POSSIBLE. IN NO CASE SHALL A NEW SIGN/SUPPORT BE DOWN FOR MORE THAN 24 HOURS AND THERE SHALL NOT BE MORE THAN ONE SIGN/SUPPORT DOWN AT ANY ONE TIME. SIGN AND SUPPORT SIZES ARE ESTIMATED LENGTHS AND THE ACTUAL LENGTH WILL BE DETERMINED IN THE FIELD.

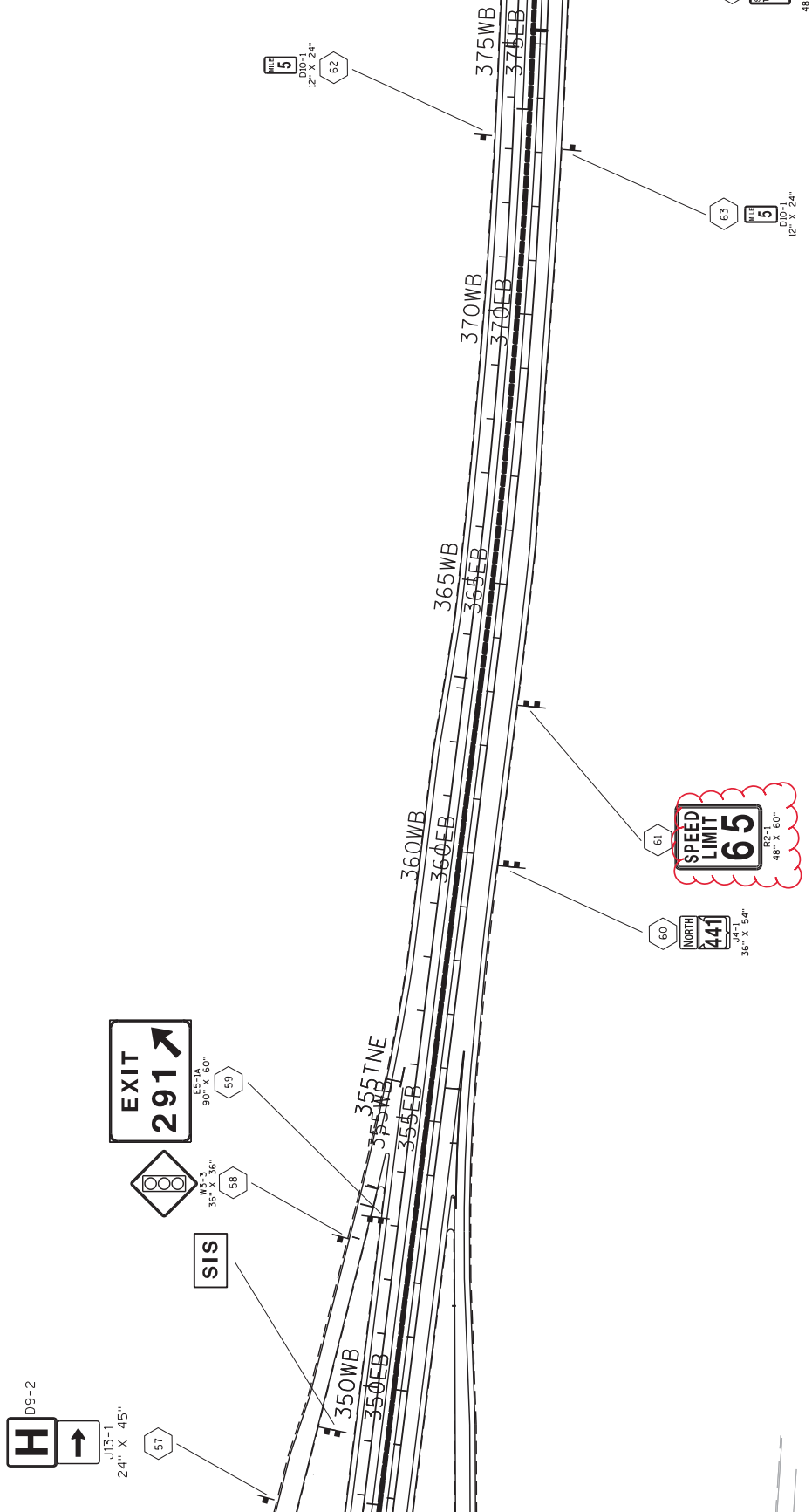
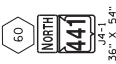
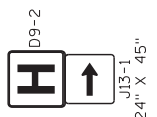

EARTHWORK QUANTITIES

Category	Division	From/To Station	Location	Common Excavation (Item # 205.0100)		Salvaged/Unusable Pavement Material (CY)	Available Material (CY)	Fill (CY)	Roadway Embankment (CY) (Item # SPV.0035.001)	Mass Ordinate +/- (7)
				Cut (CY) (2)	EBS (CY) (3)					
1000	Stage 3	289WB+25 to 396WB+00 300WB+00 to 326WB+70 305WB+60 to 338WB+00 360WB+30 to 396WB+00 1300ANE+00 to 1309ANE+50 325TNNW+27 to 338TNNW+00 345TNE+00 to 359TNE+50 321WB+00 to 330WB+50 0TEMPANE+00 to 5TEMPANE+50	WB MAINLINE (SEE NOTE 6) MEDIAN OUTSIDE SHOULDER MEDIAN APPLETON RD NE RAMP USH 10/ONEIDA ST NW RAMP USH 10/ONEIDA ST NE RAMP POND 5 TEMPORARY APPLETON RD NE RAMP	49,613 0 0 0 7,014 6,095 5,901 108,100 376	0 7,766 1,614 10,921 0 0 0 0 0	11,540 0 0 0 0 0 0 0 0	38,073 0 0 0 7,014 6,095 5,901 108,100 376	18,892.0 0 0 0 324 9,090 4,222 2,900 0	19,181 0 0 0 6,690 -2,995 1,679 105,200 376	
	Stage 3 Subtotal			177,089	20,301	11,540	185,559	35,428	130,131	
	Stage 4	267WB+50 to 396WB+00 300WB+00 to 306WB+00 307WB+50 to 319WB+00 362WB+50 to 396WB+00 307WB+90 to 337WB+00 225MSE+30 to 239MSE+25 224MSW+48 to 240MSW+00 242MNNW+00 to 245MNNW+50 1275ANNW+28 to 1282ANNW+50 1299ANE+50 to 1305ANE+50 347TSE+00 to 358TSE+00 322TSW+77 to 334TSW+00 241MNNW+50 to 255MNNW+50 0TEMPANE+00 to 6TEMPANE+64 5TEMP TSW+91 to 9TEMPANE+02	EB MAINLINE MEDIAN MEDIAN MEDIAN OUTSIDE SHOULDER MIDWAY RD SE RAMP MIDWAY RD SW RAMP MIDWAY RD NW RAMP APPLETON RD NW RAMP APPLETON RD SE RAMP USH 10/ONEIDA ST SE RAMP USH 10/ONEIDA ST SW RAMP POND 4 TEMPORARY APPLETON RD SE RAMP TEMPORARY USH 10/ONEIDA ST SW RAMP	53,709 0 0 0 0 4,023 31,865 2,671 1,858 2,901 2,156 6,056 79,378 132 221	0 3,401 901 8,773 1,242 0 0 0 0 0 0 0 0 0 0	0 0 0 0 0 0 0 0 0 0 0 0 0 0 0	53,709 0 0 0 0 4,023 31,865 2,671 1,858 2,901 2,156 6,056 79,378 132 221	22,842 0 0 0 0 4,056 3,505 585 690 81 6,025 2,334 0 705 0	30,867 0 0 0 0 -33 28,360 2,086 1,168 2,820 -3,869 3,722 79,378 -573 221	
	Stage 4 Subtotal			184,970	14,317	0	184,970	40,823	144,147	
	PROJECT 1517-75-73 Totals	406+00 to 426+25	WIS 441 & CTH OO FILL SITE	1,508 363,577	0 34,618	0 11,540	1,508 350,529	30,618 106,869	-29,110 245,168	
				Total Common Exc						
				388,195						

- Common Excavation is the sum of the Cut and EBS Excavation columns. Item number 205.0100
- Salvaged/Unusable Pavement Material is included in Cut.
- EBS Excavation to be backfilled with Breaker Run.
- Salvaged/Unusable Pavement Material is the material classified as top soil located in the median of STH 441/USH 10 between Appleton Rd. and East End of Project Limits. Average depth of top soil was determined to be 0.75'.
- Available Material = Cut - Salvaged/Unusable Pavement Material
- Roadway Embankment = (Fill+EBS Excavation)
- The Mass Ordinate is calculated by division. A positive quantity indicates an excess of material within the Division and a negative quantity indicates a shortage of material within the Division. Mass Ordinate = Cut- Fill. The Mass Ordinate is for information purposes only as Common Excavation and Roadway Embankment are not balanced for quantity purposes and does not guarantee the quality of Common Excavation, and if it can be reused onsite.
- Temporary MSE Wall Backfill Quantity of 1278 CY was removed from Fill/Roadway Embankment Quantity in Stage 3 Mainline

Addendum No. 02
 ID 1517-75-73
 Revised Sheet 829
 March 5, 2018

EROSION CONTROL (CONTINUED)

CATEGORY	ROADWAY	STATION	TO	STATION	OFFSET	CY	628.1504		628.1520		628.7005		628.7010		628.7504		628.7555		645.0120		645.0130	
							SILT FENCE	SILT FENCE MAINTENANCE	INLET PROTECTION TYPE A	INLET PROTECTION TYPE B	TEMPORARY DITCH CHECKS	CULVERT PIPE CHECKS	GEOTEXTILE TYPE HR	GEOTEXTILE TYPE R								
1000	STAGE 4B																					
	APPLETON RD SE RAMP	1292ASE+16	-	1292ASE+16	LT	-	-	-	-	-	-	-	-	-	-	-	-	-	-	-	-	-
	APPLETON RD SE RAMP	1293ASE+46	-	1293ASE+43	LT	-	-	-	-	-	-	-	-	-	-	-	-	-	-	-	-	-
	APPLETON RD SE RAMP	1294ASE+90	-	1294ASE+90	LT	-	-	-	-	-	-	-	-	-	-	-	-	-	-	-	-	-
	APPLETON RD SE RAMP	1296ASE+40	-	1296ASE+40	LT	-	-	-	-	-	-	-	-	-	-	-	-	-	-	-	-	-
	APPLETON RD SE RAMP	1292ASE+54	-	1292ASE+54	RT	-	-	-	-	-	-	-	-	-	-	-	-	-	-	-	-	-
	APPLETON RD SE RAMP	1293ASE+87	-	1293ASE+87	RT	-	-	-	-	-	-	-	-	-	-	-	-	-	-	-	-	-
	APPLETON RD SE RAMP	1295ASE+02	-	1295ASE+02	RT	-	-	-	-	-	-	-	-	-	-	-	-	-	-	-	-	-
	APPLETON RD SE RAMP	1296ASE+68	-	1296ASE+68	RT	-	-	-	-	-	-	-	-	-	-	-	-	-	-	-	-	-
	ONEIDA ST/USH 10 SW RAMP	3367TSW+77	-	3367TSW+77	RT	-	-	-	-	-	-	-	-	-	-	-	-	-	-	-	-	-
	ONEIDA ST/USH 10 SW RAMP	3377TSW+30	-	3377TSW+30	LT	-	-	-	-	-	-	-	-	-	-	-	-	-	-	-	-	-
	WIS 441 & CTH 00 FILL SITE																					
	UNDISTRIBUTED																					
	STAGE 4B SUBTOTAL					0	0	0	0	0	0	0	0	0	0	0	0	0	0	0	0	0
	PROJECT 1517-75-73 TOTAL					195	9669	9669	33	249	132	326	80									

Addendum No. 02
ID 1517-75-73
Revised Sheet 867
March 5, 2018

Addendum No. 02
 ID 1517-75-73
 Revised Sheet 875
 March 5, 2018

3

ERECTION OF TYPE II SIGNS AND SUPPORTS

SIGN NO.	LOCATION	SIGN CODE	W X H		637.2210 SIGN TYPE II REFLECTIVE S.F.	637.2230 SIGN TYPE II REFLECTIVE S.F.	634.0614		634.0808	
			W	H			POSTS WOOD 4x6x14 EACH	POSTS TUBULAR STEEL 2x2x8 EACH		
1	USH 10/STH 441, W. OF MIDWAY RD	R2-1	48"	X 60"	20.00	---	2	---	---	REMARKS: 65 MPH SEE PLAN SHEET
2	"	J4-2	72"	X 54"	27.00	---	2	---	---	---
3	MIDWAY RD EB OFF RAMP	E5-1A	108"	X 60"	45.00	---	2	---	---	---
4	"	W3-1	36"	X 36"	9.00	---	1	---	---	---
5	"	D1-60	84"	X 24"	14.00	---	2	---	---	---
6	"	J13-1	24"	X 57"	9.50	---	1	---	---	SEE SIGN DETAILS
7	"	R3-8	36"	X 30"	7.50	---	1	---	---	SEE PLAN SHEET
8	"	R3-8	36"	X 30"	7.50	---	1	---	---	---
9	"	R5-1A	36"	X 24"	6.00	---	---	---	---	MOUNT TO BACK OF SIGN 8
10	"	R5-1A	36"	X 24"	6.00	---	---	---	---	MOUNT TO BACK OF SIGN 7
11	USH 10/STH 441, W. OF MIDWAY RD	D10-5	21"	X 60"	8.75	---	---	---	---	MILE 289.6
12	"	D10-5	21"	X 60"	8.75	---	1	---	---	MILE 289.6, MOUNT TO BACK OF SIGN 11
13	"	W4-3	48"	X 48"	16.00	---	2	---	---	---
14	USH 10/STH 441, E. OF MIDWAY RD	D10-5	21"	X 60"	8.75	---	1	---	---	MILE 289.8
15	"	D10-5	21"	X 60"	8.75	---	---	---	---	MILE 289.8, MOUNT TO BACK OF SIGN 14
16	MIDWAY RD WB OFF RAMP	R5-1A	36"	X 24"	6.00	---	1	---	---	---
17	"	R5-1A	36"	X 24"	6.00	---	1	---	---	---
18	"	R3-8	36"	X 30"	7.50	---	---	---	---	MOUNT TO BACK OF SIGN 17
19	"	J13-1	24"	X 45"	7.50	---	1	---	---	SEE PLAN SHEET
20	"	R3-8	36"	X 30"	7.50	---	---	---	---	MOUNT TO BACK OF SIGN 16
20A	"	D1-60	84"	X 24"	14.00	---	2	---	---	SEE SIGN DETAILS
20B	"	W3-1	36"	X 36"	9.00	---	1	---	---	---
20C	"	E5-1A	108"	X 60"	45.00	---	2	---	---	---
21	USH 10/STH 441, W. OF APPLETON RD	R2-1	48"	X 60"	20.00	---	2	---	---	REMARKS: 65 MPH SEE PLAN SHEET
22	"	J4-2	72"	X 54"	27.00	---	2	---	---	---
23	"	D10-5	21"	X 60"	8.75	---	1	---	---	MILE 290.4
24	"	D10-5	21"	X 60"	8.75	---	---	---	---	MILE 290.4, MOUNT TO BACK OF SIGN 23
25	"	D10-5	21"	X 60"	8.75	---	1	---	---	MILE 290.6
26	"	D10-5	21"	X 60"	8.75	---	---	---	---	MILE 290.6, MOUNT TO BACK OF SIGN 25
27	"	W4-3R	48"	X 48"	16.00	---	2	---	---	---
28	APPLETON RD WB OFF RAMP	D1-4	90"	X 54"	33.75	---	2	---	---	SEE SIGN DETAILS
29	USH 10/STH 441, E. OF APPLETON RD	W4-3R	48"	X 48"	16.00	---	2	---	---	---
30	"	D10-5	21"	X 60"	8.75	---	---	---	---	MOUNT ON BARRIER WALL, MILE 290.8
31	"	D10-5	21"	X 60"	8.75	---	---	---	---	MILE 290.8, MOUNT TO BACK OF SIGN 31
32	"	E5-1A	90"	X 60"	37.50	---	2	---	---	EXIT 290
33	"	D10-5	21"	X 60"	8.75	---	---	---	---	MOUNT ON BARRIER WALL, MILE 291.0
34	"	D10-5	21"	X 60"	8.75	---	---	---	---	MILE 291.0, MOUNT TO BACK OF SIGN 33
35	"	J4-2	72"	X 54"	27.00	---	2	---	---	SEE PLAN SHEET
36	"	R2-1	48"	X 60"	20.00	---	2	---	---	65 MPH
37	"	D10-5	21"	X 60"	8.75	---	---	---	---	MOUNT ON BARRIER WALL, MILE 291.2
38	"	D10-5	21"	X 60"	8.75	---	---	---	---	MILE 291.2, MOUNT TO BACK OF SIGN 37
39	"	R2-1	48"	X 60"	20.00	---	2	---	---	65 MPH
PAGE SUBTOTALS					543.75	66.00	8	36	3	

3

ERECTION OF TYPE II SIGNS AND SUPPORTS

SIGN NO.	LOCATION	SIGN CODE	W X H	637.2210 SIGNS TYPE II REFLECTIVE H S.F.	637.2230 SIGNS TYPE II REFLECTIVE F S.F.	634.0614 POSTS WOOD 4x6x14 EACH	634.0616 POSTS WOOD 4x6x16 EACH	634.0808 POSTS TUBULAR STEEL 2x2x8 EACH	REMARKS
40	VACANT								
41	USH 10/STH 441, W. OF ONEIDA ST	J4-2	72" X 54"	27.00			2		SEE PLAN SHEET
42	"	D10-5	21" X 60"	8.75				1	MOUNT ON BARRIER WALL, MILE 291.4
43	"	D10-5	21" X 60"	8.75					MILE 291.4, MOUNT TO BACK OF SIGN 42
43A	"	W4-2R	48" X 48"		16.00		2		
44	ONEIDA ST EB OFF RAMP	E5-1A	90" X 60"	37.50			2		EXIT 291
45	"	W3-3	36" X 36"		9.00		1		
45A	"	J13-1	24" X 45"	7.50			1		D9-2 (HOSPITAL)
46	"	D1-4	90" X 54"	33.75			2		SEE SIGN DETAILS
47	USH 10/STH 441, W. OF ONEIDA ST	I2-2	84" X 21"	12.25		2			SEE SIGN DETAILS
48	ONEIDA ST WB ON RAMP	R5-57	36" X 36"	9.00			1		
49	"	W4-2R	36" X 36"		9.00				
50	USH 10/STH 441, W. OF ONEIDA ST	W4-3	48" X 48"		16.00		2		
51	STH 441, E. OF ONEIDA ST	I2-2	96" X 21"	14.00		2			SEE SIGN DETAILS
52	"	W4-1	48" X 48"		16.00		2		
53	ONEIDA ST EB ON RAMP	W4-2R	36" X 36"		9.00		1		
54	"	R5-57	36" X 36"	9.00			1		
55	ONEIDA ST WB OFF RAMP	D1-4	90" X 54"	33.75			2		SEE SIGN DETAILS
56	"	D1-1	96" X 15"	10.00		2			SEE SIGN DETAILS
57	"	J13-1	24" X 45"	7.50			1		D9-2 (HOSPITAL)
58	"	W3-3	36" X 36"		9.00		1		
59	"	E5-1A	90" X 60"	37.50			2		EXIT 291
60	STH 441, E. OF ONEIDA ST	J4-1	36" X 54"	13.50			1		SEE PLAN SHEET
61	"	R2-1	48" X 60"	20.00			2		65 MPH
62	"	D10-1	12" X 24"	2.00		1			MILE 3
63	"	D10-1	12" X 24"	2.00		1			MILE 5
64	VACANT								
65	STH 441, E. OF ONEIDA ST	R4-3	48" X 60"	20.00			2		
PAGE SUBTOTALS				313.75	84.00	8	28		
PROJECT TOTALS				857.50	150.00	16.00	64.00	4.00	

Addendum No. 02
 ID 1517-75-73
 Revised Sheet 876
 March 5, 2018

STATE PROJECT NUMBER
1517-75-73

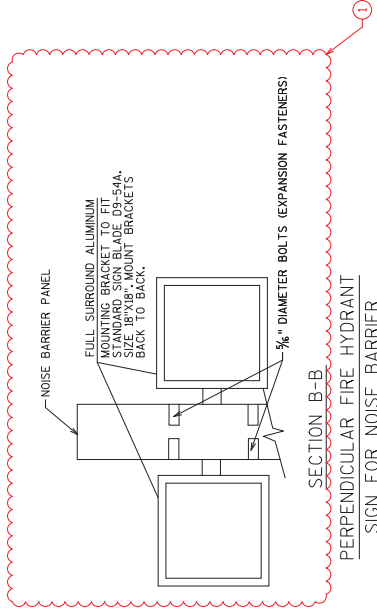
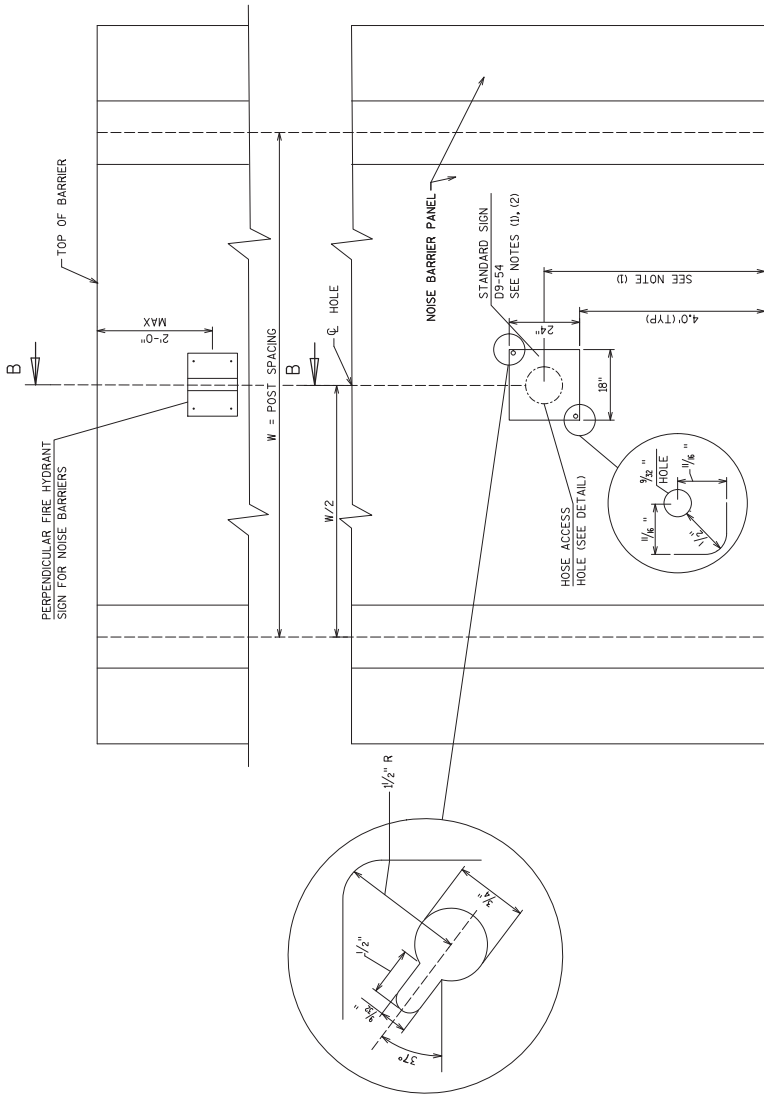

Addendum No. 02
ID 1517-75-73
Revised Sheet 1184
March 5, 2018

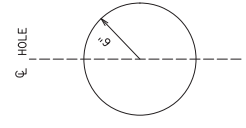

HOSE ACCESS HOLE DETAIL

FIRE HYDRANT LOCATION/HOSE ACCESS DETAIL

N-70-130: STA. 1H+66.00 (ADDRESS: 1665 UNIVERSITY DRIVE)
N-70-131: STA. 7H+60.00 (ADDRESS: MID ALCAN DRIVE) & STA. 17+37.00 (ADDRESS: 1699 ALCAN DRIVE)
N-70-140: STA. 1H+09.00 (ADDRESS: ITI ALCORN COURT)
NOTE: FIRE HOSE ACCESS HOLE LOCATIONS ARE APPROXIMATE; ADJUST LOCATION OF ACCESS HOLES AS NEEDED TO BE CENTERED ON THE AS-FABRICATED PANEL.

NOTES:

1. STANDARD SIGNS D9-54 AND D9-54A WILL BE FURNISHED BY THE CONTRACTOR. SEE PLAN.
2. TWO STANDARD SIGNS D9-54 AND D9-54A TO BE FURNISHED PER LOCATION. ONE OF EACH SIGN SHALL BE INSTALLED ON EACH SIDE OF THE BARRIER.
3. FIRE HYDRANT SIGN BLADE D9-54A SHALL BE ATTACHED TO THE NOISE BARRIER PANEL WITH THE FIRE HYDRANT SIGN BLADE PERPENDICULAR TO THE NOISE BARRIER PANEL OVER THE HOSE ACCESS HOLE. SEE DETAILS ABOVE FOR UNDER BID ITEM "NOISE BARRIER DOUBLE-SIDED SOUND ABSORPTIVE (STRUCTURE)".
4. MOUNTING BOLTS, BRACKETS AND EXPANSION FASTENERS FOR ALL SIGNS ATTACHED TO NOISE BARRIER ARE INCIDENTAL TO THE BID ITEM "NOISE BARRIER DOUBLE-SIDED SOUND ABSORPTIVE (STRUCTURE)".
5. TIP ACCESS HOLE SLIGHTLY TOWARD HIGHWAY SIDE OF WALL TO PROVIDE DRAINAGE.



William C. Decker SRP
03/01/18

NO.	DATE	REVISION	ADDRESS, NOTES & SIGN SIZE	CEB
1	2/28/18			CEB

STATE OF WISCONSIN
DEPARTMENT OF TRANSPORTATION
STRUCTURE N-70-121, 130, 131, 140

DESIGNED BY: MJA
DRAWN BY: CEB
CHECKED BY: MJA
SHEET 7 OF 12
CONSTRUCTION DETAILS 3
1184



Proposal Schedule of Items

Proposal ID: 20180313029 Project(s): 1517-75-73, 1517-75-79

Federal ID(s): WISC 2018157, WISC 2018158

SECTION: 0001

Contract Items

Alt Set ID:

Alt Mbr ID:

Proposal Line Number	Item ID Description	Approximate Quantity and Units	Unit Price	Bid Amount
0002	201.0105 Clearing	156.000 STA	_____.	_____.
0004	201.0205 Grubbing	156.000 STA	_____.	_____.
0006	203.0100 Removing Small Pipe Culverts	13.000 EACH	_____.	_____.
0008	204.0100 Removing Pavement	103,182.000 SY	_____.	_____.
0010	204.0110 Removing Asphaltic Surface	24,521.000 SY	_____.	_____.
0012	204.0120 Removing Asphaltic Surface Milling	8,386.000 SY	_____.	_____.
0014	204.0150 Removing Curb & Gutter	440.000 LF	_____.	_____.
0016	204.0155 Removing Concrete Sidewalk	1,326.000 SY	_____.	_____.
0018	204.0165 Removing Guardrail	1,295.000 LF	_____.	_____.
0020	204.0170 Removing Fence	9,960.000 LF	_____.	_____.
0022	204.0175 Removing Concrete Slope Paving	636.000 SY	_____.	_____.
0024	204.0180 Removing Delineators and Markers	124.000 EACH	_____.	_____.
0026	204.0190 Removing Surface Drains	1.000 EACH	_____.	_____.
0028	204.0195 Removing Concrete Bases	6.000 EACH	_____.	_____.
0030	204.0210 Removing Manholes	30.000 EACH	_____.	_____.
0032	204.0220 Removing Inlets	62.000 EACH	_____.	_____.



Proposal Schedule of Items

Proposal ID: 20180313029 Project(s): 1517-75-73, 1517-75-79

Federal ID(s): WISC 2018157, WISC 2018158

SECTION: 0001

Contract Items

Alt Set ID:

Alt Mbr ID:

Proposal Line Number	Item ID Description	Approximate Quantity and Units	Unit Price	Bid Amount
0034	204.0245 Removing Storm Sewer (size) 01. 12-15-Inch	2,477.000 LF	_____.	_____.
0036	204.0245 Removing Storm Sewer (size) 02. 18-21-Inch	3,097.000 LF	_____.	_____.
0038	204.0245 Removing Storm Sewer (size) 03. 24-30-Inch	7,022.000 LF	_____.	_____.
0040	204.0245 Removing Storm Sewer (size) 04. 36-42-Inch	560.000 LF	_____.	_____.
0042	204.0245 Removing Storm Sewer (size) 05. 48-54-Inch	2,332.000 LF	_____.	_____.
0044	204.0280 Sealing Pipes	1.000 EACH	_____.	_____.
0046	204.9090.S Removing (item description) 01. Noise Barrier	3,676.000 LF	_____.	_____.
0048	204.9090.S Removing (item description) 02. Underdrain	38,639.000 LF	_____.	_____.
0050	205.0100 Excavation Common	443,263.000 CY	_____.	_____.
0052	209.1100 Backfill Granular Grade 1	20.000 CY	_____.	_____.
0054	209.2100 Backfill Granular Grade 2	580.000 CY	_____.	_____.
0056	210.1100 Backfill Structure Type A	227.000 CY	_____.	_____.
0058	213.0100 Finishing Roadway (project) 01. 1517-75-73	1.000 EACH	_____.	_____.
0060	213.0100 Finishing Roadway (project) 02. 1517-75-79	1.000 EACH	_____.	_____.



Proposal Schedule of Items

Proposal ID: 20180313029 Project(s): 1517-75-73, 1517-75-79

Federal ID(s): WISC 2018157, WISC 2018158

SECTION: 0001

Contract Items

Alt Set ID:

Alt Mbr ID:

Proposal Line Number	Item ID Description	Approximate Quantity and Units	Unit Price	Bid Amount
0158	522.1018 Apron Endwalls for Culvert Pipe Reinforced Concrete 18-Inch	8.000 EACH	_____.	_____.
0160	522.1024 Apron Endwalls for Culvert Pipe Reinforced Concrete 24-Inch	13.000 EACH	_____.	_____.
0162	522.1030 Apron Endwalls for Culvert Pipe Reinforced Concrete 30-Inch	1.000 EACH	_____.	_____.
0164	522.1036 Apron Endwalls for Culvert Pipe Reinforced Concrete 36-Inch	10.000 EACH	_____.	_____.
0166	522.1060 Apron Endwalls for Culvert Pipe Reinforced Concrete 60-Inch	2.000 EACH	_____.	_____.
0168	522.2619 Apron Endwalls for Culvert Pipe Reinforced Concrete Horizontal Elliptical 19x30-Inch	2.000 EACH	_____.	_____.
0170	522.2658 Apron Endwalls for Culvert Pipe Reinforced Concrete Horizontal Elliptical 58x91-Inch	1.000 EACH	_____.	_____.
0172	531.0300.S Noise Barriers Double-Sided Sound Absorptive (structure) 001. N-70-121	31,050.000 SF	_____.	_____.
0174	531.0300.S Noise Barriers Double-Sided Sound Absorptive (structure) 002. N-70-130	19,910.000 SF	_____.	_____.
0176	531.0300.S Noise Barriers Double-Sided Sound Absorptive (structure) 003. N-70-131	56,700.000 SF	_____.	_____.
0178	531.0300.S Noise Barriers Double-Sided Sound Absorptive (structure) 004. N-70-140	29,625.000 SF	_____.	_____.
0180	550.1100 Piling Steel HP 10-Inch X 42 Lb	860.000 LF	_____.	_____.
0182	601.0405 Concrete Curb & Gutter 18-Inch Type A	3,831.000 LF	_____.	_____.



Proposal Schedule of Items

Proposal ID: 20180313029 Project(s): 1517-75-73, 1517-75-79

Federal ID(s): WISC 2018157, WISC 2018158

SECTION: 0001

Contract Items

Alt Set ID:

Alt Mbr ID:

Proposal Line Number	Item ID Description	Approximate Quantity and Units	Unit Price	Bid Amount
0364	628.1520 Silt Fence Maintenance	10,066.000 LF	_____.	_____.
0366	628.1905 Mobilizations Erosion Control	28.000 EACH	_____.	_____.
0368	628.1910 Mobilizations Emergency Erosion Control	17.000 EACH	_____.	_____.
0370	628.2004 Erosion Mat Class I Type B	181,527.000 SY	_____.	_____.
0372	628.2006 Erosion Mat Urban Class I Type A	4,438.000 SY	_____.	_____.
0374	628.2008 Erosion Mat Urban Class I Type B	14,300.000 SY	_____.	_____.
0376	628.7005 Inlet Protection Type A	129.000 EACH	_____.	_____.
0378	628.7010 Inlet Protection Type B	253.000 EACH	_____.	_____.
0380	628.7015 Inlet Protection Type C	61.000 EACH	_____.	_____.
0382	628.7020 Inlet Protection Type D	34.000 EACH	_____.	_____.
0384	628.7504 Temporary Ditch Checks	1,581.000 LF	_____.	_____.
0386	628.7555 Culvert Pipe Checks	160.000 EACH	_____.	_____.
0388	628.7560 Tracking Pads	14.000 EACH	_____.	_____.
0390	629.0210 Fertilizer Type B	117.800 CWT	_____.	_____.
0392	630.0130 Seeding Mixture No. 30	3,070.000 LB	_____.	_____.
0394	630.0140 Seeding Mixture No. 40	398.000 LB	_____.	_____.
0396	630.0200 Seeding Temporary	1,075.000 LB	_____.	_____.



Proposal Schedule of Items

Proposal ID: 20180313029 Project(s): 1517-75-73, 1517-75-79

Federal ID(s): WISC 2018157, WISC 2018158

SECTION: 0001

Contract Items

Alt Set ID:

Alt Mbr ID:

Proposal Line Number	Item ID Description	Approximate Quantity and Units	Unit Price	Bid Amount
0398	630.0400 Seeding Nurse Crop	415.000 LB	_____.	_____.
0400	633.0100 Delineator Posts Steel	249.000 EACH	_____.	_____.
0402	633.0500 Delineator Reflectors	429.000 EACH	_____.	_____.
0404	633.1000 Delineator Brackets	180.000 EACH	_____.	_____.
0406	633.5200 Markers Culvert End	28.000 EACH	_____.	_____.
0408	634.0612 Posts Wood 4x6-Inch X 12-FT	4.000 EACH	_____.	_____.
0410	634.0614 Posts Wood 4x6-Inch X 14-FT	52.000 EACH	_____.	_____.
0412	634.0616 Posts Wood 4x6-Inch X 16-FT	78.000 EACH	_____.	_____.
0414	634.0618 Posts Wood 4x6-Inch X 18-FT	7.000 EACH	_____.	_____.
0416	634.0808 Posts Tubular Steel 2x2-Inch X 8-FT	4.000 EACH	_____.	_____.
0418	635.0200 Sign Supports Structural Steel HS	3,049.000 LB	_____.	_____.
0420	636.0100 Sign Supports Concrete Masonry	410.600 CY	_____.	_____.
0422	636.0500 Sign Supports Steel Reinforcement	438.000 LB	_____.	_____.
0424	636.1000 Sign Supports Steel Reinforcement HS	2,840.000 LB	_____.	_____.
0426	636.1500 Sign Supports Steel Coated Reinforcement HS	49,760.000 LB	_____.	_____.
0428	637.1220 Signs Type I Reflective SH	7,764.500 SF	_____.	_____.



Proposal Schedule of Items

Proposal ID: 20180313029 Project(s): 1517-75-73, 1517-75-79

Federal ID(s): WISC 2018157, WISC 2018158

SECTION: 0001

Contract Items

Alt Set ID:

Alt Mbr ID:

Proposal Line Number	Item ID Description	Approximate Quantity and Units	Unit Price	Bid Amount
0958	SPV.0180 Special 006. Colored & Stamped Concrete 5-Inch, Color 16293	4,377.000 SY	_____.	_____.
0960	SPV.0180 Special 007. Colored Concrete 5-Inch	627.000 SY	_____.	_____.
0962	SPV.0180 Special 008. Colored Concrete 10-Inch	151.000 SY	_____.	_____.
0964	SPV.0195 Special 001. Cold Patch	20.000 TON	_____.	_____.
0966	305.0500 Shaping Shoulders	72.000 STA	_____.	_____.
0968	638.2101 Moving Signs Type I	1.000 EACH	_____.	_____.
0970	638.4100 Moving Structural Steel Sign Supports	2.000 EACH	_____.	_____.
Section: 0001			Total:	_____.
			Total Bid:	_____.

