



# Wisconsin Department of Transportation

March 8, 2018

**Division of Transportation Systems Development**

Bureau of Project Development  
 4802 Sheboygan Avenue, Rm 601  
 P O Box 7916  
 Madison, WI 53707-7916

**NOTICE TO ALL CONTRACTORS:**

Telephone: (608) 266-1631  
 Facsimile (FAX): (608) 266-8459

**Proposal #40: 8110-02-73**  
**Stillwater – Somerset**  
**Loop Trail System (Ped/Bike Facility)**  
**STH 64**  
**St. Croix County**

**Letting of: March 13, 2018**

This is Addendum No. 02, which provides for the following:

**Special Provisions:**

Revised Special Provisions	
Article No.	Description
54	Infiltration Basin Soil Mix, Item SPV.0180.01

**Schedule of Items:**

Revised Bid Item Quantities					
Bid Item	Item Description	Unit	Old Quantity	Revised Quantity	Proposal Total
632.9101	Landscape Planting Surveillance and Care Cycles	EA	2	24	26

Added Bid Item Quantities					
Bid Item	Item Description	Unit	Old Quantity	Revised Quantity	Proposal Total
632.0101.18	Trees (Species)(size)(root) . Autumn Blaze Maple 2.5" B&B	EA	0	11	11
632.0101.19	Trees (Species)(size)(root) American Basswood 3" B&B	EA	0	15	15
632.0101.20	Trees (Species)(size)(root) Bur Oak 3" B&B	EA	0	47	47
632.0101.21	Trees (Species)(size)(root) Red Oak 3" B&B	EA	0	42	42
632.0101.22	Trees (Species)(size)(root) Sugar Maple 2.5" B&B	EA	0	21	21
632.0101.23	Trees (Species)(size)(root) White Oak 3" B&B	EA	0	27	27
632.0101.24	Trees (Species)(size)(root) White Pine 2.5" B&B	EA	0	8	8

Deleted Bid Item Quantities					
Bid Item	Item Description	Unit	Old Quantity	Revised Quantity	Proposal Total
632.0101.01	Trees (Species)(size)(root) 01. Autumn Blaze Maple 3" B&B	EA	11	-11	0
632.0101.02	Trees (Species)(size)(root) 02. American Basswood 4" B&B	EA	15	-15	0
632.0101.03	Trees (Species)(size)(root) 03. Bur Oak 4" B&B	EA	47	-47	0
632.0101.04	Trees (Species)(size)(root) 04. Red Oak 4" B&B	EA	42	-27	0
632.0101.05	Trees (Species)(size)(root) 05. Sugar Maple 3" B&B	EA	21	-21	0
632.0101.06	Trees (Species)(size)(root) 06. White Oak 4" B&B	EA	27	-27	0
632.0101.07	Trees (Species)(size)(root) 07. White Pine 3" B&B	EA	8	-8	0

**Plan Sheets:**

Revised Plan Sheets	
Plan Sheet	Plan Sheet Title (brief description of changes to sheet)
129	Landscape Details (Removed reference to weed free barrier around shrubs)
217	Miscellaneous Quantities (Updated Tree tables with reduced caliper sizes)
218	Miscellaneous Quantities (Updated Tree tables with reduced caliper sizes)
220	Miscellaneous Quantities (Revised Landscape Planting Surveillance and Care Cycles)

The responsibility for notifying potential subcontractors and suppliers of these changes remains with the prime contractor.

Sincerely,

*Mike Coleman*

Proposal Development Specialist  
Proposal Management Section

**ADDENDUM NO. 02**

**8110-02-73**

**March 8, 2018**

**Special Provisions**

**46. Infiltration Basin Soil Mix, Item SPV.0180.01.**

*Replace C Construction with the following:*

**C Construction**

The 6-inch engineered soil mix shall be incorporated into the existing soil using a chisel plow or rotary device with the capability of reaching 24 inches below the graded surface. Construction and placement of the Infiltration Basin Soil Mix shall follow the construction standards outlined in the Wisconsin Department of Natural Resources Infiltration Basin practice standard.

**Schedule of Items**

Attached, dated March 8, 2018, are the revised Schedule of Items Pages 9 – 17.

**Plan Sheets**

The following 8½ x 11-inch sheets are attached and made part of the plans for this proposal:  
Revised: 129, 217, 218, 220.

END OF ADDENDUM

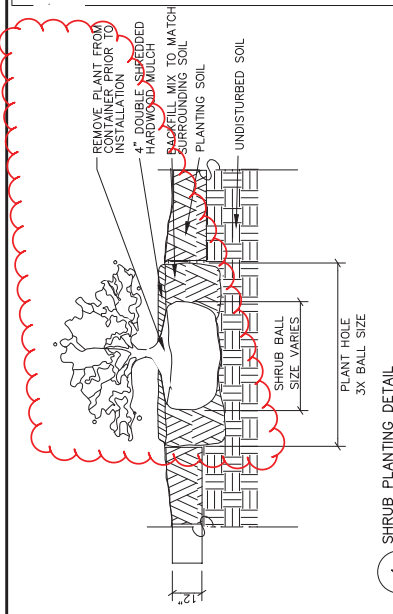

1 SHRUB PLANTING DETAIL

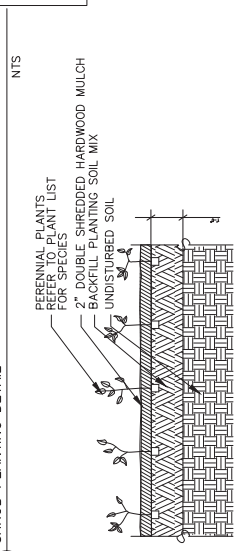

2 GROUNDCOVER/PERENNIAL DETAIL

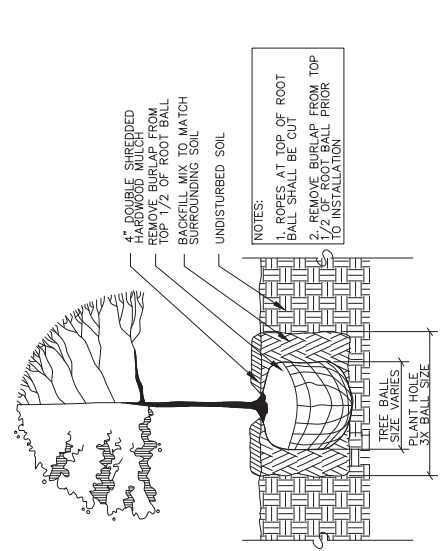

3 TREE PLANTING DETAIL

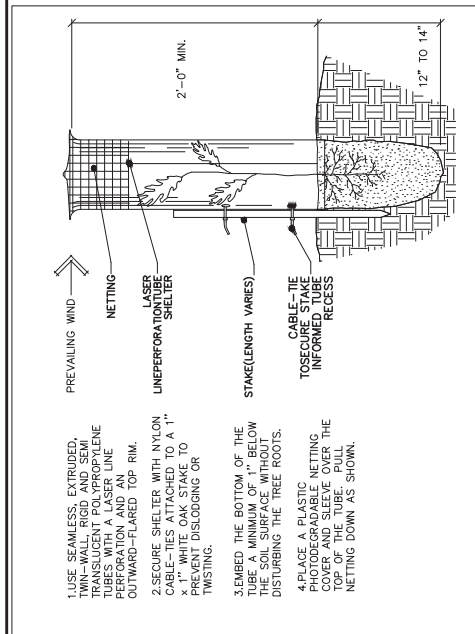

6 SEEDLING TREE SHELTERS

PRAIRIE AND PERENNIAL PLANTING BEDS

LOCATION	SEED MIX	AREA (acres)	TOTAL
BED 1	perennial seed mix #70A	0.02	
BED 2	perennial seed mix #70A	0.04	
BED 3	perennial seed mix #70A	0.03	
BED 4	perennial seed mix #70A	0.06	
BED 5	perennial seed mix #70A	0.03	
BED 6	perennial seed mix #70A	0.03	
BED 7	perennial seed mix #70A	0.06	
BED 8	perennial seed mix #70A	0.02	
BED 9	perennial seed mix #70A	0.05	
BED 10	perennial seed mix #70A	0.05	
BED 11	perennial seed mix #70A	0.01	
BED 12	perennial seed mix #70A	0.04	
BED 13	perennial seed mix #70A	0.04	
BED 14	perennial seed mix #70A	0.06	
BED 15	perennial seed mix #70A	0.02	
BED 16	perennial seed mix #70A	0.04	
BED 17	perennial seed mix #70A	0.05	
BED 18	perennial seed mix #70A	0.01	
BED 19	perennial seed mix #70A	0.07	
BED 20	mow seed mix #20	0.27	
BED 21	mow seed mix #20	0.37	
BED 22	mow seed mix #20	0.23	
			1.62

7 SEED MIX PLANTING BED QUANTITIES

Addendum No. 02  
ID 8110-02-73  
Revised Sheet 129  
March 8, 2018

6 SEEDLING TREE SHELTERS

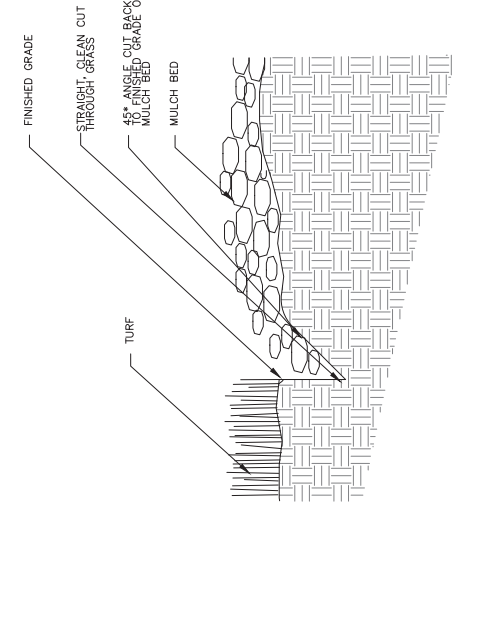

4 EDGE DETAIL

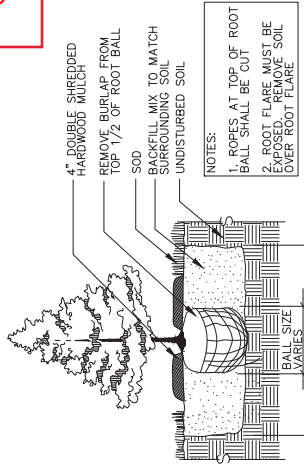

5 EVERGREEN PLANTING DETAIL

SEEDING MIXTURE NO. 80

CATEGORY	STATION	LOCATIONS	630.0180 LB	REMARKS
0020	162+50	HILLTOP PARKING LOT	40	
0020		MAIN TRAIL HEAD PARKING LOT	50	
0020		OLD STH 64 MULTI-USE PATH	6	
0020		STH 64	7	
TOTAL 0020			103	

SEEDING BORROW PLOT

CATEGORY	LOCATIONS	630.0300 LB	REMARKS
0010	BORROW PIT	2	
0010	UNDISTRIBUTED	3	
TOTAL 0010			5

TREES (SPECIES) (SIZE) (ROOT) 01 (AUTUMN BLAZE MAPLE) (2.5") (B&B)

CATEGORY	LOCATIONS	632.0101.01 EACH	REMARKS
0050	PROJECT WIDE	11	SEE LANDSCAPE PLAN
TOTAL 0050			11

TREES (SPECIES) (SIZE) (ROOT) 02 (AMERICAN BASSWOOD) (3") (B&B)

CATEGORY	LOCATIONS	632.0101.02 EACH	REMARKS
0050	PROJECT WIDE	15	SEE LANDSCAPE PLAN
TOTAL 0050			15

CATEGORY	STATION TO	STATION	LOCATIONS	630.0200 LB	REMARKS
0010	500+52	-	513+87	HOULTON SCHOOL CIRCLE	47
0010	500+52	-	513+88	HOULTON SCHOOL CIRCLE	17
TOTAL 0010					64

Addendum No. 02  
 ID 8110-02-73  
 Revised Sheet 217  
 March 8, 2018

TREES (SPECIES) (SIZE) (ROOT) 03 (BUR OAK) (3") (B&B)

CATEGORY	LOCATION	632.0101.03 EACH	REMARKS
0050	PROJECT WIDE	47	SEE LANDSCAPE PLAN
TOTAL 0050		47	

TREES (SPECIES) (SIZE) (ROOT) 06 (WHITE OAK) (3") (B&B)

CATEGORY	LOCATION	632.0101.06 EACH	REMARKS
0050	PROJECT WIDE	27	SEE LANDSCAPE PLAN
TOTAL 0050		27	

TREES (SPECIES) (SIZE) (ROOT) 04 (RED OAK) (3") (B&B)

CATEGORY	LOCATION	632.0101.04 EACH	REMARKS
0050	PROJECT WIDE	42	SEE LANDSCAPE PLAN
TOTAL 0050		42	

TREES (SPECIES) (SIZE) (ROOT) 07 (WHITE PINE) (2.5") (B&B)

CATEGORY	LOCATION	632.0101.07 EACH	REMARKS
0050	PROJECT WIDE	8	SEE LANDSCAPE PLAN
TOTAL 0050		8	

TREES (SPECIES) (SIZE) (ROOT) 05 (SUGAR MAPLE) (2.5") (B&B)

CATEGORY	LOCATION	632.0101.05 EACH	REMARKS
0050	PROJECT WIDE	21	SEE LANDSCAPE PLAN
TOTAL 0050		21	

TREES (SPECIES) (SIZE) (ROOT) 08 (WILD BLACK CHERRY) (2.5") (B&B)

CATEGORY	LOCATION	632.0101.08 EACH	REMARKS
0050	PROJECT WIDE	46	SEE LANDSCAPE PLAN
TOTAL 0050		46	

TREES (SPECIES) (SIZE) (ROOT) 09 (HAWTHORN) (2.5") (B&B)

CATEGORY	LOCATION	632.0101.09 EACH	REMARKS
0050	PROJECT WIDE	23	SEE LANDSCAPE PLAN
TOTAL 0050		23	

TREES (SPECIES) (SIZE) (ROOT) 10 (KENTUCKY COFFEE TREE) (2.5") (B&B)

CATEGORY	LOCATION	632.0101.10 EACH	REMARKS
0050	PROJECT WIDE	2	SEE LANDSCAPE PLAN
TOTAL 0050		2	

TREES (SPECIES) (SIZE) (ROOT) 12 (BUR OAK) (12-INCH HEIGHT) (BR)

CATEGORY	LOCATION	632.0101.12 EACH	REMARKS
0020	RIVER BRIDGE ABUTMENT	45	BLUFF RESTORATION
0020	RIVER BRIDGE ABUTMENT	33	UNDER BRIDGE RESTORATION
TOTAL 0020		78	

TREES (SPECIES) (SIZE) (ROOT) 13 (EASTERN COTTONWOOD) (12-INCH HEIGHT) (BR)

CATEGORY	LOCATION	632.0101.13 EACH	REMARKS
0020	RIVER BRIDGE ABUTMENT	10	BLUFF RESTORATION
0020	RIVER BRIDGE ABUTMENT	8	UNDER BRIDGE RESTORATION
TOTAL 0020		18	

TREES (SPECIES) (SIZE) (ROOT) 11 (RIVER BIRCH) (2.5") (B&B)

CATEGORY	LOCATION	632.0101.11 EACH	REMARKS
0050	PROJECT WIDE	40	SEE LANDSCAPE PLAN
TOTAL 0050		40	

Addendum No. 02  
ID 8110-02-73  
Revised Sheet 218  
March 8, 2018

SHRUBS (SPECIES) (SIZE) (ROOT) 02 (ARROWWOOD VIBURNUM) (#1) (CONT.)

CATEGORY	LOCATION	632.0201.02 EACH	REMARKS
0050	PROJECT WIDE	34	SEE LANDSCAPE PLAN
	TOTAL 0050	34	

SHRUBS (SPECIES) (SIZE) (ROOT) 05 (FRAGRANT SUMAC) (#1) (CONT.)

CATEGORY	LOCATION	632.0201.05 EACH	REMARKS
0050	PROJECT WIDE	43	SEE LANDSCAPE PLAN
	TOTAL 0050	43	

SHRUBS (SPECIES) (SIZE) (ROOT) 08 (FROST GRAPE) (#1) (CONT.)

CATEGORY	LOCATION	632.0201.08 EACH	REMARKS
0050	PROJECT WIDE	115	SEE LANDSCAPE PLAN
	TOTAL 0050	115	

SHRUBS (SPECIES) (SIZE) (ROOT) 11 (RED OSIER DOGWOOD) (#1) (CONT.)

CATEGORY	LOCATION	632.0201.11 EACH	REMARKS
0050	PROJECT WIDE	137	SEE LANDSCAPE PLAN
	TOTAL 0050	137	

SHRUBS (SPECIES) (SIZE) (ROOT) 03 (CHOKE CHERRY) (#1) (CONT.)

CATEGORY	LOCATION	632.0201.03 EACH	REMARKS
0050	PROJECT WIDE	81	SEE LANDSCAPE PLAN
	TOTAL 0050	81	

SHRUBS (SPECIES) (SIZE) (ROOT) 06 (JUNBERRY) (#1) (CONT.)

CATEGORY	LOCATION	632.0201.06 EACH	REMARKS
0050	PROJECT WIDE	114	SEE LANDSCAPE PLAN
	TOTAL 0050	114	

SHRUBS (SPECIES) (SIZE) (ROOT) 09 (PRICKLY GOOSEBERRY) (#1) (CONT.)

CATEGORY	LOCATION	632.0201.09 EACH	REMARKS
0050	PROJECT WIDE	6	SEE LANDSCAPE PLAN
	TOTAL 0050	6	

SHRUBS (SPECIES) (SIZE) (ROOT) 04 (OWARBUSH HONEYSUCKLE) (#1) (CONT.)

CATEGORY	LOCATION	632.0201.04 EACH	REMARKS
0050	PROJECT WIDE	128	SEE LANDSCAPE PLAN
	TOTAL 0050	128	

SHRUBS (SPECIES) (SIZE) (ROOT) 07 (MANNYBERRY VIBURNUM) (#1) (CONT.)

CATEGORY	LOCATION	632.0201.07 EACH	REMARKS
0050	PROJECT WIDE	125	SEE LANDSCAPE PLAN
	TOTAL 0050	125	

SHRUBS (SPECIES) (SIZE) (ROOT) 10 (GRAY DOGWOOD) (#1) (CONT.)

CATEGORY	LOCATION	632.0201.10 EACH	REMARKS
0050	PROJECT WIDE	135	SEE LANDSCAPE PLAN
	TOTAL 0050	135	

Addendum No. 02  
ID 8110-02-73  
Revised Sheet 220  
March 8, 2018

LANDSCAPE PLANTING SURVEILLANCE AND CARE CYCLES

CATEGORY	LOCATION	632.9101 EACH	REMARKS
0050	PROJECT WIDE	26	
	TOTAL 0050	26	



Proposal Schedule of Items

Proposal ID: 20180313040 Project(s): 8110-02-73

Federal ID(s): N/A

SECTION: 0001 Contract Items

Alt Set ID: Alt Mbr ID:

Proposal Line Number	Item ID Description	Approximate Quantity and Units	Unit Price	Bid Amount
0248	630.0110 Seeding Mixture No. 10	22.000 LB	_____.	_____.
0250	630.0120 Seeding Mixture No. 20	1,373.000 LB	_____.	_____.
0252	630.0130 Seeding Mixture No. 30	16.000 LB	_____.	_____.
0254	630.0171 Seeding Mixture No. 70A	104.000 LB	_____.	_____.
0256	630.0180 Seeding Mixture No. 80	103.000 LB	_____.	_____.
0258	630.0200 Seeding Temporary	64.000 LB	_____.	_____.
0260	630.0300 Seeding Borrow Pit	5.000 LB	_____.	_____.
0276	632.0101 Trees (species) (size) (root) 08. Wild Black Cherry 2.5" B&B	46.000 EACH	_____.	_____.
0278	632.0101 Trees (species) (size) (root) 09. Hawthorn 2.5" B&B	23.000 EACH	_____.	_____.
0280	632.0101 Trees (species) (size) (root) 10. Kentucky Coffeetree 2.5" B&B	2.000 EACH	_____.	_____.
0282	632.0101 Trees (species) (size) (root) 11. River Birch 2.5" B&B	40.000 EACH	_____.	_____.
0284	632.0101 Trees (species) (size) (root) 12. Bur Oak 12-Inch Height BR	78.000 EACH	_____.	_____.
0286	632.0101 Trees (species) (size) (root) 13. Eastern Cottonwood 12-Inch Height BR	18.000 EACH	_____.	_____.
0288	632.0101 Trees (species) (size) (root) 14. Quaking Aspen 12-Inch Height BR	36.000 EACH	_____.	_____.
0290	632.0101 Trees (species) (size) (root) 15. Red Oak 12-Inch Height BR	55.000 EACH	_____.	_____.





Proposal Schedule of Items

Proposal ID: 20180313040 Project(s): 8110-02-73

Federal ID(s): N/A

SECTION: 0001 Contract Items

Alt Set ID: Alt Mbr ID:

Proposal Line Number	Item ID Description	Approximate Quantity and Units	Unit Price	Bid Amount
0292	632.0101 Trees (species) (size) (root) 16. White Pine 12-Inch Height BR	124.000 EACH	_____.	_____.
0294	632.0101 Trees (species) (size) (root) 17. White Spruce 12-Inch Height BR	48.000 EACH	_____.	_____.
0296	632.0201 Shrubs (species) (size) (root) 01. American Hazelnut #1 Cont.	61.000 EACH	_____.	_____.
0298	632.0201 Shrubs (species) (size) (root) 02. Arrowwood Viburnum #1 Cont.	34.000 EACH	_____.	_____.
0300	632.0201 Shrubs (species) (size) (root) 03. Choke Cherry #1 Cont.	81.000 EACH	_____.	_____.
0302	632.0201 Shrubs (species) (size) (root) 04. Dwarfbush Honeysuckle #1 Cont.	128.000 EACH	_____.	_____.
0304	632.0201 Shrubs (species) (size) (root) 05. Fragrant Sumac #1 Cont.	43.000 EACH	_____.	_____.
0306	632.0201 Shrubs (species) (size) (root) 06. Junberry #1 Cont.	114.000 EACH	_____.	_____.
0308	632.0201 Shrubs (species) (size) (root) 07. Nannyberry Viburnum #1 Cont.	125.000 EACH	_____.	_____.
0310	632.0201 Shrubs (species) (size) (root) 08. Frost Grape #1 Cont.	115.000 EACH	_____.	_____.
0312	632.0201 Shrubs (species) (size) (root) 09. Prickly Gooseberry #1 Cont.	6.000 EACH	_____.	_____.
0314	632.0201 Shrubs (species) (size) (root) 10. Gray Dogwood #1 Cont.	135.000 EACH	_____.	_____.
0316	632.0201 Shrubs (species) (size) (root) 11. Red Osier Dogwood #1 Cont.	137.000 EACH	_____.	_____.



Proposal Schedule of Items

Proposal ID: 20180313040 Project(s): 8110-02-73

Federal ID(s): N/A

SECTION: 0001 Contract Items

Alt Set ID: Alt Mbr ID:

Proposal Line Number	Item ID Description	Approximate Quantity and Units	Unit Price	Bid Amount
0318	632.9101 Landscape Planting Surveillance and Care Cycles	26.000 EACH	_____.	_____.
0320	633.5200 Markers Culvert End	44.000 EACH	_____.	_____.
0322	634.0809 Posts Tubular Steel 2x2-Inch X 9.5-FT	57.000 EACH	_____.	_____.
0324	634.0810 Posts Tubular Steel 2x2-Inch X 10-FT	19.000 EACH	_____.	_____.
0326	634.0811 Posts Tubular Steel 2x2-Inch X 11-FT	33.000 EACH	_____.	_____.
0328	634.0812 Posts Tubular Steel 2x2-Inch X 12-FT	11.000 EACH	_____.	_____.
0330	634.0814 Posts Tubular Steel 2x2-Inch X 14-FT	4.000 EACH	_____.	_____.
0332	634.0885 Posts Tubular Steel 2x2-Inch X 8.5-FT	1.000 EACH	_____.	_____.
0334	637.2210 Signs Type II Reflective H	403.790 SF	_____.	_____.
0336	637.2230 Signs Type II Reflective F	193.880 SF	_____.	_____.
0338	638.2102 Moving Signs Type II	4.000 EACH	_____.	_____.
0340	638.2602 Removing Signs Type II	36.000 EACH	_____.	_____.
0342	638.3000 Removing Small Sign Supports	37.000 EACH	_____.	_____.
0344	642.5201 Field Office Type C	1.000 EACH	_____.	_____.
0346	643.0300 Traffic Control Drums	7,700.000 DAY	_____.	_____.
0348	643.0420 Traffic Control Barricades Type III	1,040.000 DAY	_____.	_____.



Proposal Schedule of Items

Proposal ID: 20180313040 Project(s): 8110-02-73

Federal ID(s): N/A

SECTION: 0001 Contract Items

Alt Set ID: Alt Mbr ID:

Proposal Line Number	Item ID Description	Approximate Quantity and Units	Unit Price	Bid Amount
0350	643.0705 Traffic Control Warning Lights Type A	1,920.000 DAY	_____.	_____.
0352	643.0715 Traffic Control Warning Lights Type C	720.000 DAY	_____.	_____.
0354	643.0900 Traffic Control Signs	4,800.000 DAY	_____.	_____.
0356	643.5000 Traffic Control	1.000 EACH	_____.	_____.
0358	645.0120 Geotextile Type HR	235.000 SY	_____.	_____.
0360	645.0130 Geotextile Type R	40.000 SY	_____.	_____.
0362	646.1020 Marking Line Epoxy 4-Inch	33,971.000 LF	_____.	_____.
0364	646.3020 Marking Line Epoxy 8-Inch	318.000 LF	_____.	_____.
0366	646.5020 Marking Arrow Epoxy	23.000 EACH	_____.	_____.
0368	646.5220 Marking Symbol Epoxy	17.000 EACH	_____.	_____.
0370	646.6120 Marking Stop Line Epoxy 18-Inch	35.000 LF	_____.	_____.
0372	646.7020 Marking Diagonal Epoxy 6-Inch	1,406.000 LF	_____.	_____.
0374	646.7420 Marking Crosswalk Epoxy Transverse Line 6-Inch	943.000 LF	_____.	_____.
0376	646.8120 Marking Curb Epoxy	9.000 LF	_____.	_____.
0378	646.8320 Marking Parking Stall Epoxy	4,168.000 LF	_____.	_____.
0380	646.9000 Marking Removal Line 4-Inch	144.000 LF	_____.	_____.



Proposal Schedule of Items

Proposal ID: 20180313040 Project(s): 8110-02-73

Federal ID(s): N/A

SECTION: 0001 Contract Items

Alt Set ID: Alt Mbr ID:

Proposal Line Number	Item ID Description	Approximate Quantity and Units	Unit Price	Bid Amount
0382	649.0105 Temporary Marking Line Paint 4-Inch	3,200.000 LF	_____.	_____.
0384	650.4000 Construction Staking Storm Sewer	17.000 EACH	_____.	_____.
0386	650.5000 Construction Staking Base	11,806.000 LF	_____.	_____.
0388	650.5500 Construction Staking Curb Gutter and Curb & Gutter	3,792.000 LF	_____.	_____.
0390	650.6000 Construction Staking Pipe Culverts	16.000 EACH	_____.	_____.
0392	650.7000 Construction Staking Concrete Pavement	136.000 LF	_____.	_____.
0394	650.8000 Construction Staking Resurfacing Reference	7,102.000 LF	_____.	_____.
0396	650.8500 Construction Staking Electrical Installations (project) 01. 8110-02-73	LS	LUMP SUM	_____.
0398	650.9000 Construction Staking Curb Ramps	8.000 EACH	_____.	_____.
0400	650.9910 Construction Staking Supplemental Control (project) 01. 8110-02-73	LS	LUMP SUM	_____.
0402	650.9920 Construction Staking Slope Stakes	7,538.000 LF	_____.	_____.
0404	652.0210 Conduit Rigid Nonmetallic Schedule 40 1-Inch	40.000 LF	_____.	_____.
0406	652.0225 Conduit Rigid Nonmetallic Schedule 40 2-Inch	3,555.000 LF	_____.	_____.
0408	653.0140 Pull Boxes Steel 24x42-Inch	17.000 EACH	_____.	_____.
0410	654.0106 Concrete Bases Type 6	10.000 EACH	_____.	_____.



Proposal Schedule of Items

Proposal ID: 20180313040 Project(s): 8110-02-73

Federal ID(s): N/A

SECTION: 0001 Contract Items

Alt Set ID: Alt Mbr ID:

Proposal Line Number	Item ID Description	Approximate Quantity and Units	Unit Price	Bid Amount
0412	655.0610 Electrical Wire Lighting 12 AWG	1,701.000 LF	_____.	_____.
0414	655.0625 Electrical Wire Lighting 6 AWG	6,031.000 LF	_____.	_____.
0416	655.0635 Electrical Wire Lighting 2 AWG	2,852.000 LF	_____.	_____.
0418	657.0255 Transformer Bases Breakaway 11 1/2-Inch Bolt Circle	10.000 EACH	_____.	_____.
0420	657.0326 Poles Type 6-Steel	1.000 EACH	_____.	_____.
0422	657.0327 Poles Type 6-Aluminum	6.000 EACH	_____.	_____.
0424	657.0714 Luminaire Arms Truss Type 4-Inch Clamp 15-FT	3.000 EACH	_____.	_____.
0426	657.0715 Luminaire Arms Truss Type 4 1/2-Inch Clamp 15-FT	6.000 EACH	_____.	_____.
0428	659.1120 Luminaires Utility LED B	9.000 EACH	_____.	_____.
0430	659.1205 Luminaires Underdeck LED A	10.000 EACH	_____.	_____.
0432	690.0150 Sawing Asphalt	5,593.000 LF	_____.	_____.
0434	690.0250 Sawing Concrete	103.000 LF	_____.	_____.
0436	715.0415 Incentive Strength Concrete Pavement	500.000 DOL	1.00000	500.00
0438	SPV.0060 Special 01. Interpretive Panel Support Posts and Bases	10.000 EACH	_____.	_____.
0440	SPV.0060 Special 02. Interpretive Panel Support Post, Delivered	2.000 EACH	_____.	_____.



Proposal Schedule of Items

Proposal ID: 20180313040 Project(s): 8110-02-73

Federal ID(s): N/A

SECTION: 0001 Contract Items

Alt Set ID: Alt Mbr ID:

Proposal Line Number	Item ID Description	Approximate Quantity and Units	Unit Price	Bid Amount
0442	SPV.0060 Special 03. Gate Pedestrian Railing	1.000 EACH	_____.	_____.
0444	SPV.0060 Special 04. Install Light Pole, State Owned	3.000 EACH	_____.	_____.
0446	SPV.0060 Special 05. Pedestal Mounted Outdoor Outlet	4.000 EACH	_____.	_____.
0448	SPV.0060 Special 06. Grouted Riprap Restoration	7.000 EACH	_____.	_____.
0450	SPV.0060 Special 07. Remove And Replace Tunnel Luminaire	10.000 EACH	_____.	_____.
0452	SPV.0060 Special 08. Remove and Reinstall Ramp Closure Gates Hardwired 40-FT	1.000 EACH	_____.	_____.
0454	SPV.0060 Special 09. Gate Chain Link (26 Ft. Width) Special	1.000 EACH	_____.	_____.
0456	SPV.0060 Special 10. Install Wire And Vandal Guards	10.000 EACH	_____.	_____.
0458	SPV.0060 Special 11. Traffic Control Removing Sign Covers	4.000 EACH	_____.	_____.
0460	SPV.0075 Special 01. Polyethylene Sheeting Mobilization	25.000 HRS	_____.	_____.
0462	SPV.0085 Special 01. Infiltration Basin Seeding	21.000 LB	_____.	_____.
0464	SPV.0090 Special 01. Pedestrian Railing	3,550.000 LF	_____.	_____.
0466	SPV.0090 Special 02. Fence Chain Link Coated 6-FT	230.000 LF	_____.	_____.
0468	SPV.0090 Special 03. Concrete Curb and Gutter Cure and Seal Treatment	3,792.000 LF	_____.	_____.



Proposal Schedule of Items

Proposal ID: 20180313040 Project(s): 8110-02-73

Federal ID(s): N/A

SECTION: 0001 Contract Items

Alt Set ID: Alt Mbr ID:

Proposal Line Number	Item ID Description	Approximate Quantity and Units	Unit Price	Bid Amount
0470	SPV.0090 Special 04. Safety Fence Maintenance	800.000 LF	_____.	_____.
0472	SPV.0090 Special 05. Cleaning, Grading and Shaping Existing Ditch	50.000 LF	_____.	_____.
0474	SPV.0105 Special 02. Electrical Service Meter Breaker Pedestal Special (MB100)	LS	LUMP SUM	_____.
0476	SPV.0105 Special 03. Electrical Service Meter and Control Panels (CB200)	LS	LUMP SUM	_____.
0478	SPV.0105 Special 03. Picnic Shelter	LS	LUMP SUM	_____.
0480	SPV.0105 Special 04. Electrical Service Meter and Control Panels (CB300)	LS	LUMP SUM	_____.
0482	SPV.0105 Special 05. State Welcome Sign Structure	LS	LUMP SUM	_____.
0484	SPV.0165 Special 01. Anti-Graffiti Coating	4,795.000 SF	_____.	_____.
0486	SPV.0165 Special 02. Concrete Sidewalk Cure and Seal Treatment	13,114.000 SF	_____.	_____.
0488	SPV.0180 Special 01. Infiltration Basin Soil Mix	3,807.000 SY	_____.	_____.
0490	SPV.0180 Special 02. 6-Inch Fabric Formed Articulated Concrete Revetment Mat	27.000 SY	_____.	_____.
0492	SPV.0195 Special 01. Limestone Aggregate	387.000 TON	_____.	_____.
0494	SPV.0060 Special 12. Concrete Base Type 1 Modified	2.000 EACH	_____.	_____.
0496	632.0101 Trees (species) (size) (root) 18. Autumn Blaze Maple 2.5" B&B	11.000 EACH	_____.	_____.



Proposal Schedule of Items

Proposal ID: 20180313040 Project(s): 8110-02-73

Federal ID(s): N/A

SECTION: 0001 Contract Items

Alt Set ID: Alt Mbr ID:

Proposal Line Number	Item ID Description	Approximate Quantity and Units	Unit Price	Bid Amount
0498	632.0101 Trees (species) (size) (root) 19. American Basswood 3" B&B	15.000 EACH	_____.	_____.
0500	632.0101 Trees (species) (size) (root) 20. Bur Oak 3" B&B	47.000 EACH	_____.	_____.
0502	632.0101 Trees (species) (size) (root) 21. Red Oak 3" B&B	42.000 EACH	_____.	_____.
0504	632.0101 Trees (species) (size) (root) 22. Sugar Maple 2.5" B&B	21.000 EACH	_____.	_____.
0506	632.0101 Trees (species) (size) (root) 23. White Oak 3" B&B	27.000 EACH	_____.	_____.
0508	632.0101 Trees (species) (size) (root) 24. White Pine 2.5" B&B	8.000 EACH	_____.	_____.
<b>Section: 0001</b>			<b>Total:</b>	_____.
			<b>Total Bid:</b>	_____.