

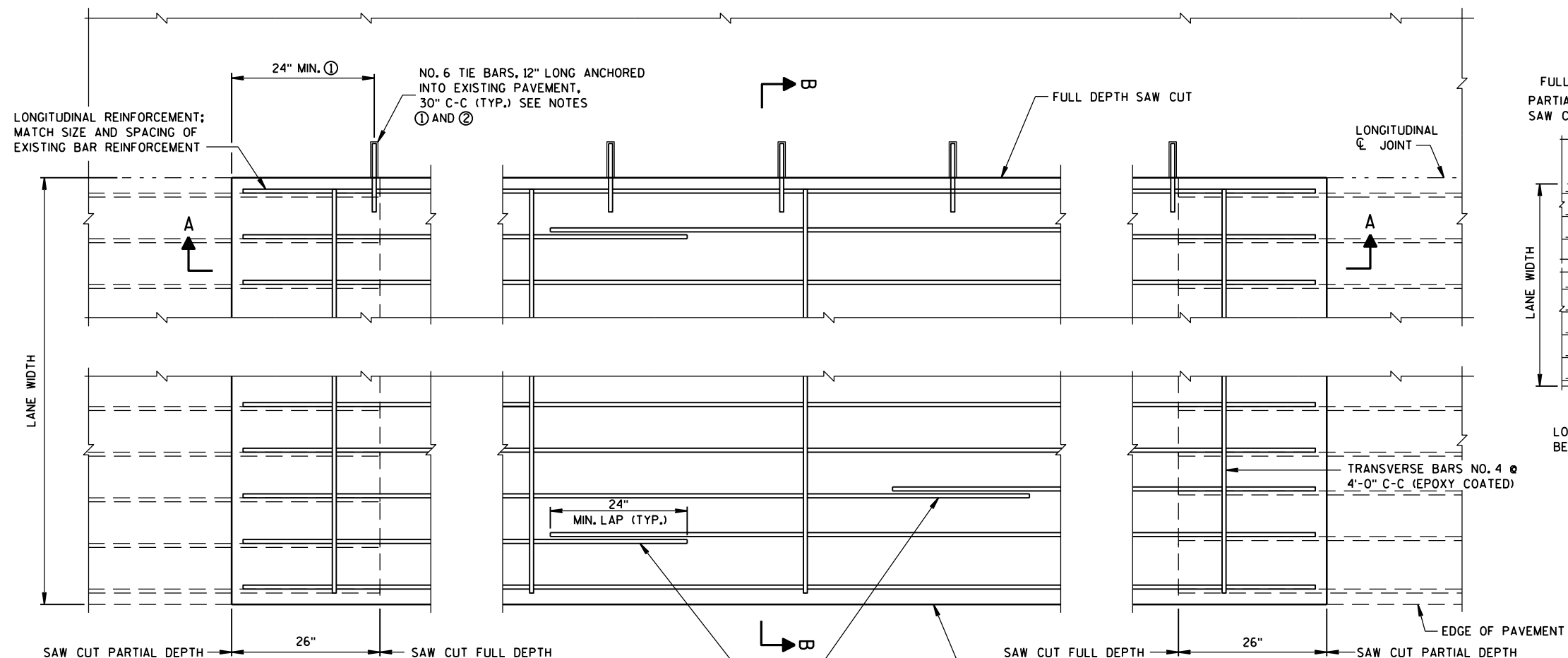

SDD 13A7 Continuously Reinforced Concrete Pavement Repair and Replacement

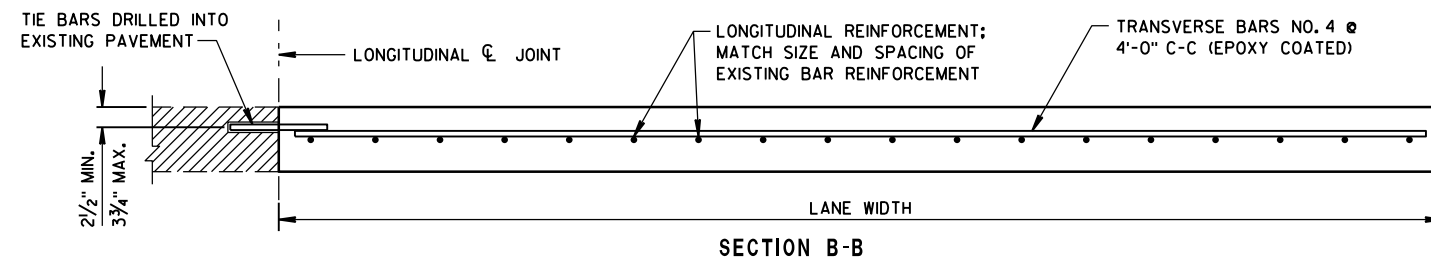
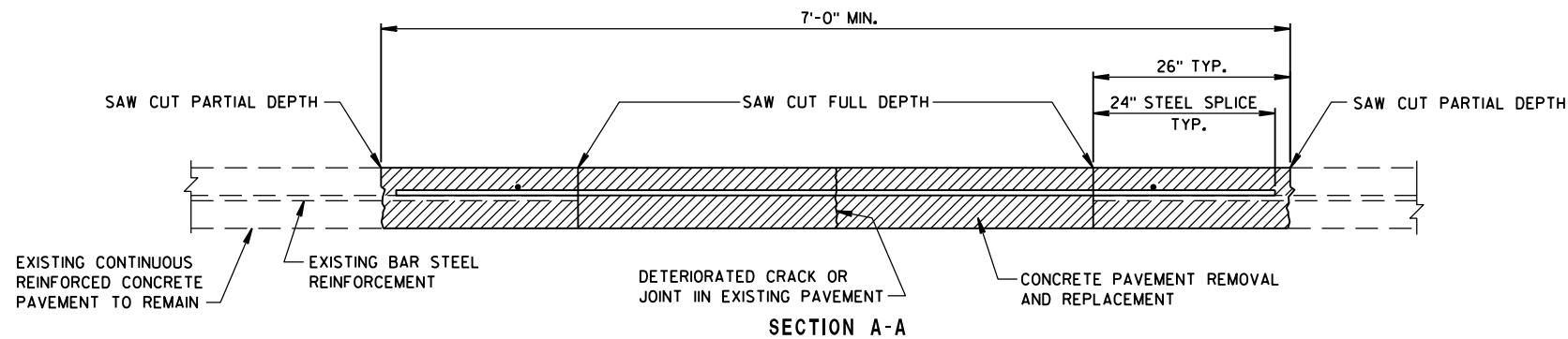

REINFORCEMENT STEEL PLACEMENT IN
CONTINUOUSLY REINFORCED CONCRETE PAVEMENT REPLACEMENT

GENERAL NOTES

PLACE ALL BAR STEEL REINFORCEMENT AT MID PAVEMENT DEPTH UNLESS OTHERWISE NOTED.

PAY FOR THE TRANSVERSE AND LONGITUDINAL JOINT SAW CUT AS LINEAR FEET OF "SAWING CONCRETE".

WHEN THE PASSING AND TRAVELING LANES ARE TO BE REPLACED, REPLACE THE PASSING LANE FIRST.

ADD TRANSVERSE STEEL BARS TO REPAIRS GREATER THAN 6' IN LENGTH, USE NO. 4 BARS PLACED TRANSVERSELY AND SPACED 4' C-C. PAYMENT SHALL BE INCIDENTAL TO "CONCRETE PAVEMENT CONTINUOUS REINFORCEMENT".

TIE ALL CONCRETE PAVEMENT REPAIRS WHICH ARE GREATER THAN 15' IN LENGTH, AND ARE ADJACENT TO EXISTING CONCRETE PAVEMENT, TO THE EXISTING PAVEMENT USING TIE BARS. DETAILS FOR TIE BAR CONSTRUCTION SHALL CONFORM TO THE STANDARD SPECIFICATIONS AND STANDARD DETAIL DRAWINGS.

- ① PROVIDE A MINIMUM DISTANCE OF 24 INCHES FROM AN EXISTING TRANSVERSE JOINT OR THE EDGE OF REPLACEMENT TO THE CENTER OF THE TIE BAR NEAREST THAT JOINT OR EDGE.
- ② ANCHOR TIE BARS INTO DRILLED HOLES WITH AN EPOXY.
- ③ SAW CUT THE LONGITUDINAL EDGE JOINT IF THE ADJACENT SHOULDER IS CONCRETE.

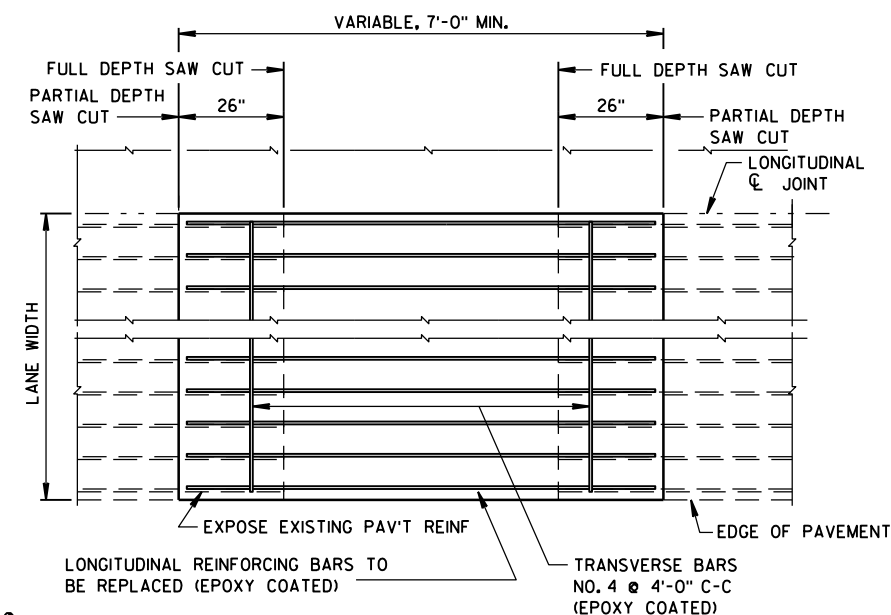

LONGITUDINAL STEEL PLACEMENT
IN CRCP REPAIRS

PLAN VIEW

CONTINUOUSLY REINFORCED
CONCRETE PAVEMENT
REPAIR AND REPLACEMENT

STATE OF WISCONSIN
DEPARTMENT OF TRANSPORTATION

APPROVED

DATE 11/1/2011

FHWA

/S/ Deb Bischoff
PAVEMENT POLICY & DESIGN ENGINEER

*Continuously Reinforced Concrete Pavement Repair and Replacement***References:**[FDM 14-25-10](#)**Bid items associated with this drawing:**

<u>ITEM NUMBER</u>	<u>DESCRIPTION</u>	<u>UNIT</u>
416.0610	Drilled Tie Bars.....	EACH
690.0250	Sawing Concrete.....	LF

Standardized Special Provisions associated with this drawing:

<u>STSP NUMBER</u>	<u>TITLE</u>
NONE	

Other SDDs associated with this drawing:

NONE

Design Notes:

Include this SDD along with "SPV.0180.XX Continuously Reinforced Pavement SHES Repair" whenever the plans include continuously reinforced concrete pavement repair.

Contact Person:

Peter Kemp (608) 246-5393