

FULL DEPTH CONCRETE PAVEMENT REMOVAL

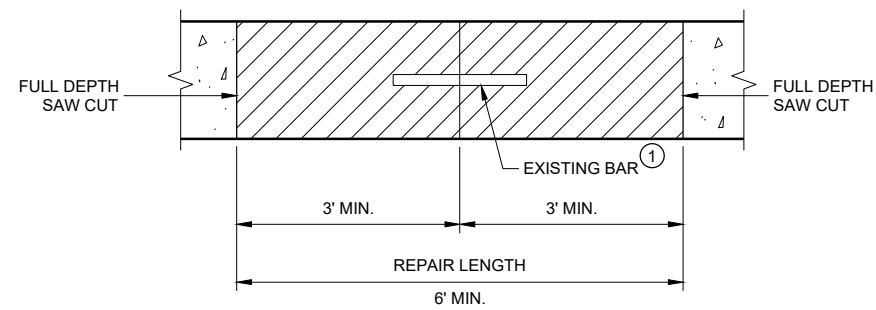

GENERAL NOTES

SAW CUT, DRILL, AND LIFT OUT EXISTING CONCRETE PAVEMENT WITHIN THE BOUNDARIES OF CONCRETE REPAIR AREAS. THE CONTRACTOR MAY MAKE ADDITIONAL SAW CUTS INSIDE THE REPAIR LIMITS TO REDUCE WEIGHT AND SIZE OF CONCRETE PIECES.

PROVIDE A 6 FOOT MINIMUM DISTANCE FROM BOUNDARIES OF CONCRETE REPAIR AREA TO ADJACENT TRANSVERSE JOINT OR CRACK.

THE LENGTH OF THE REPAIRS MAY VARY FROM THE DIMENSIONS SHOWN IF THE EXISTING CONCRETE PAVEMENT IS NON-DOWELED AND THE PAVEMENT IS TO BE OVERLAID AFTER REPAIRING.

① DOWEL BARS MAY NOT BE PRESENT.

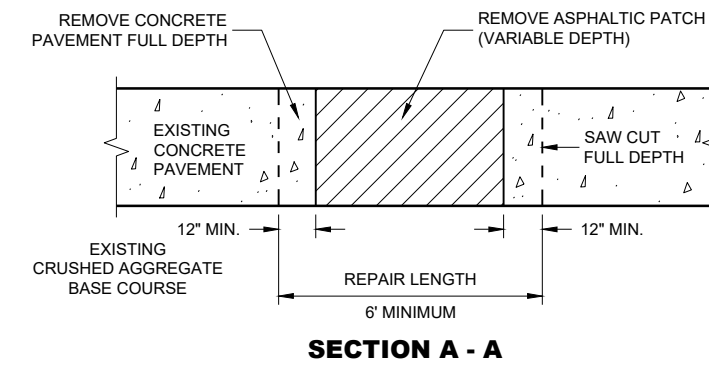
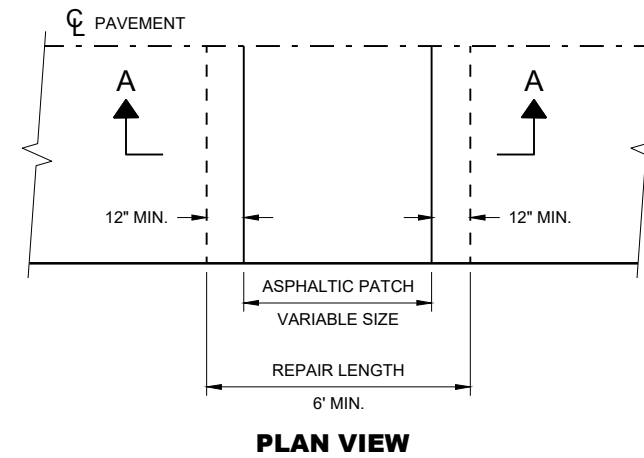

CONCRETE PAVEMENT REPAIR AND REPLACEMENT
STATE OF WISCONSIN DEPARTMENT OF TRANSPORTATION

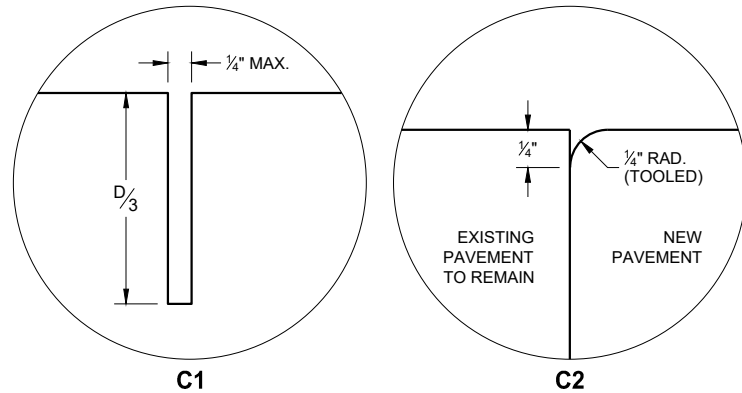

TRANSVERSE JOINTS

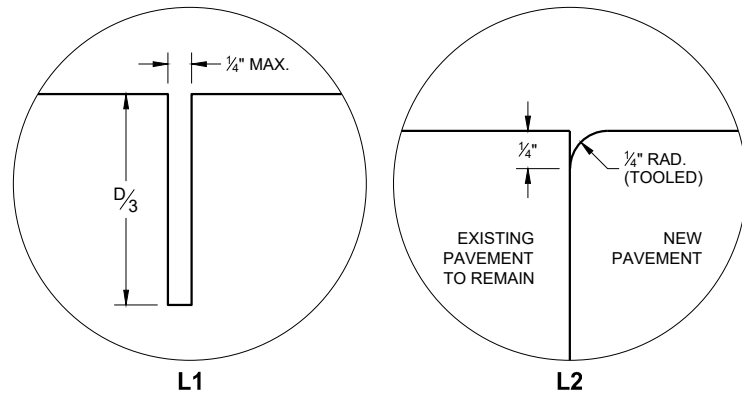

LONGITUDINAL JOINTS

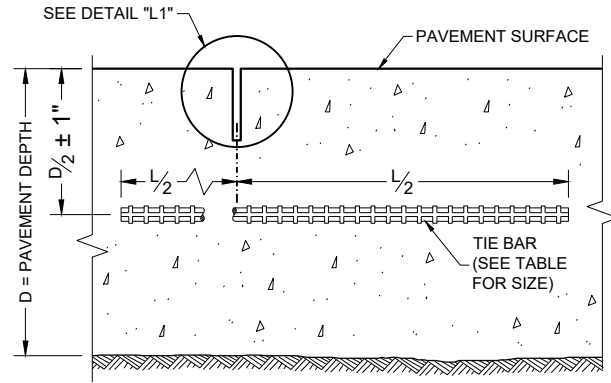

**SECTION C - C
SAWED LONGITUDINAL JOINT**

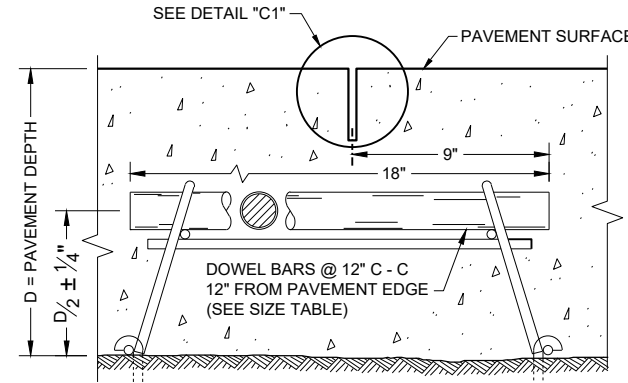

**SECTION F - F
DOWELED CONTRACTION JOINT**

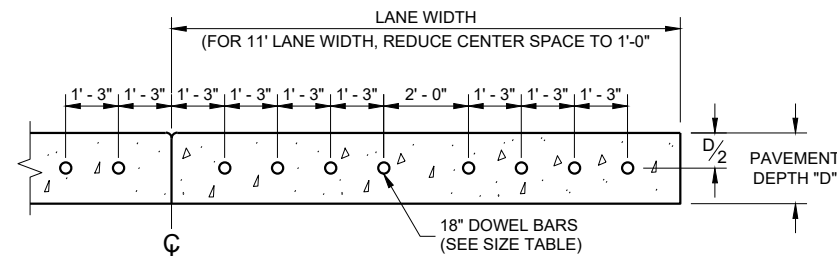

**SECTION E - E
DRILLED DOWEL BAR CONSTRUCTION JOINT**

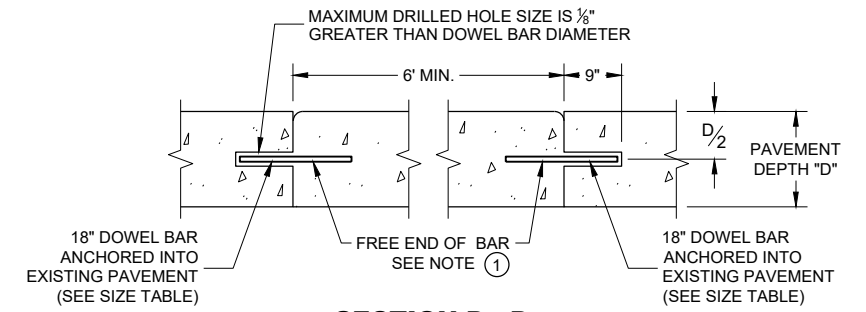

SECTION D - D

TIE BAR TABLE

PAVEMENT DEPTH (D)	TIE BAR SIZE	TIE BAR LENGTH (L)	MAX. TIE BAR SPACING
< 10 1/2"	NO. 4	30"	36"
≥ 10 1/2"	NO. 5	36"	36"
	NO. 4*	30"	24" **

* SUBSTITUTE BENT BARS AT LONGITUDINAL JOINTS WHEN EQUIPMENT LIMITATIONS DURING CONSTRUCTION WARRANT (e.g. AUXILIARY LANES OR TURN LANES)

** CONFORM TO 15" MINIMUM SPACING FROM TRANSVERSE JOINTS; SPACING BETWEEN TIE BARS WILL BE 30" AT TRANSVERSE JOINTS.

PAVEMENT DEPTH, DOWEL BAR SIZE AND JOINT SPACING TABLE

PAVEMENT DEPTH (D)	DOWEL BAR DIAMETER	DRILLED DOWEL BAR DIAMETER	CONTRACTION JOINT SPACING
6", 6 1/2"	NONE	NONE	12'
7", 7 1/2"	1"	1"	14'
8" & ABOVE	1 1/4"	1 1/4"	15'

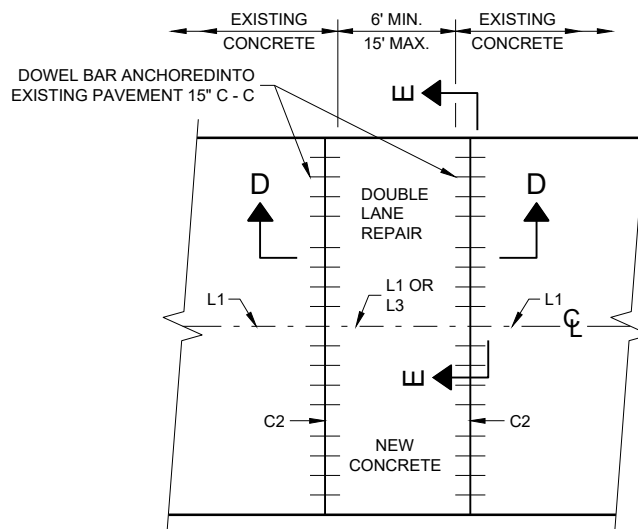

PLAN VIEW

MULTILANE CONCRETE PAVEMENT REPAIR

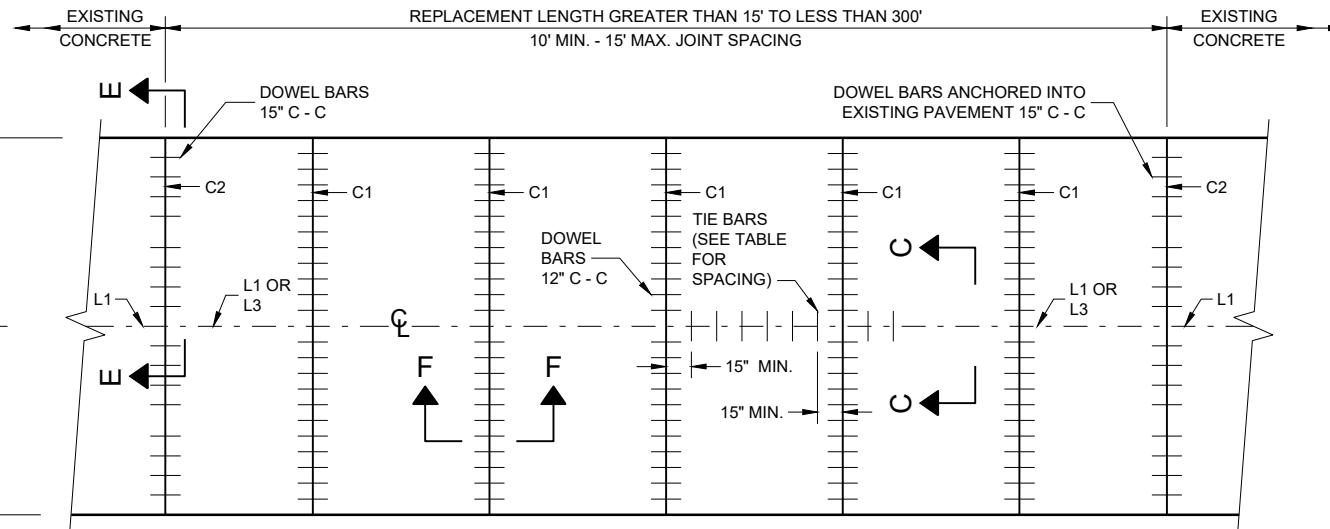

PLAN VIEW

MULTILANE CONCRETE PAVEMENT REPLACEMENT

CONCRETE PAVEMENT REPAIR AND REPLACEMENT

STATE OF WISCONSIN
DEPARTMENT OF TRANSPORTATION

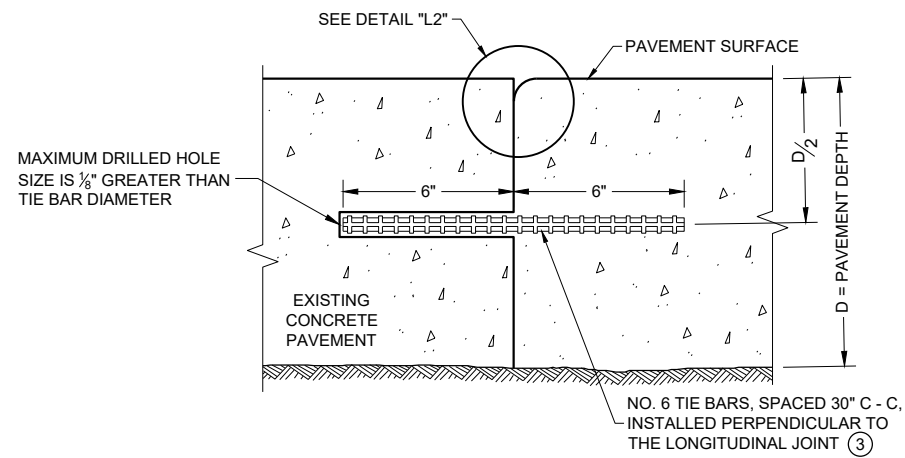

SECTION G - G
TIE BARS ANCHORED INTO EXISTING PAVEMENT

GENERAL NOTES

- ① WITH THE APPROVAL OF THE ENGINEER, FOR SINGLE LANE PAVEMENT REPLACEMENTS LESS THAN 30 FEET IN LENGTH, THE CONTRACTOR MAY INSTALL DRILLED TIE BARS ON 6:1 SKEW HORIZONTALLY, DIRECTION OF SKEW ALTERNATING WITH EACH SUCCESSIVE BAR. DRIVE SKEWED TIE BARS TO A DEPTH OF 6 INCHES IN A HOLE OF SUCH A DIAMETER AS TO PROVIDE A TIGHT DRIVEN FIT.
- ② USE AN ENGINEER APPROVED BOND BREAKER (E.G. RELEASE AGENT, CURING COMPOUND) FOR SINGLE LANE REPAIRS UP TO 15 FEET IN LENGTH.
- ③ ANCHOR TIE BARS INTO DRILLED HOLES WITH AN EPOXY.

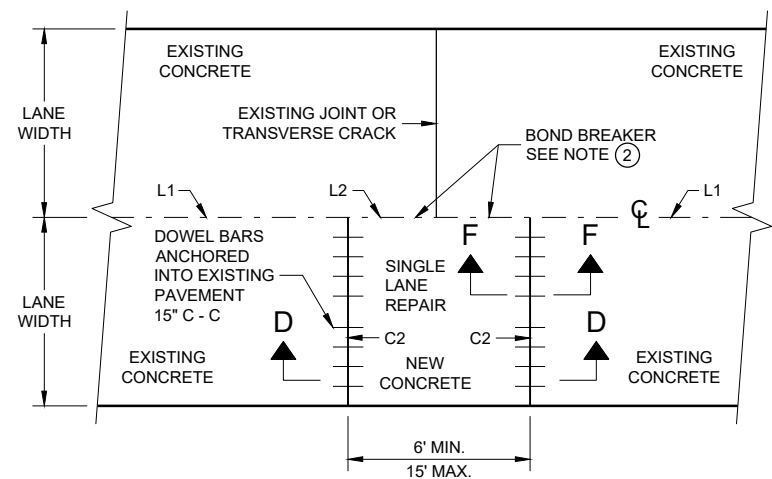

PLAN VIEW
SINGLE LANE CONCRETE PAVEMENT REPAIR

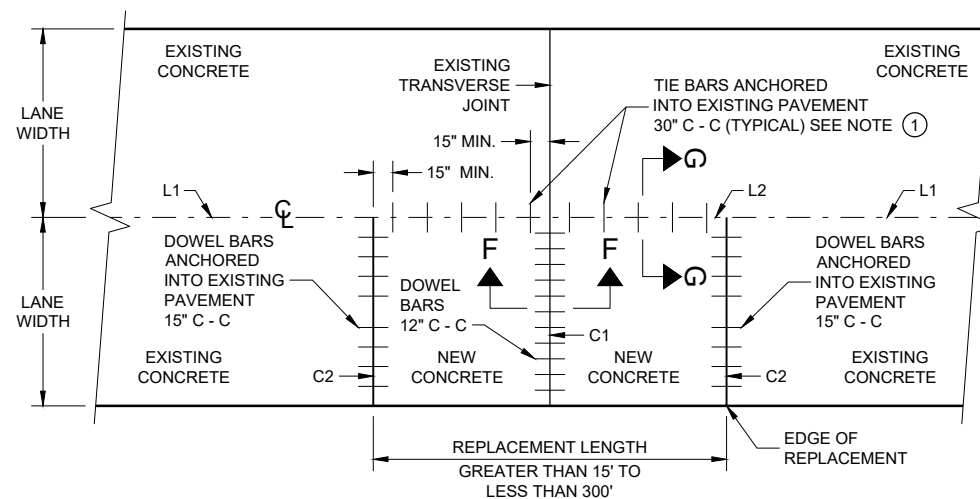

PLAN VIEW
SINGLE LANE CONCRETE PAVEMENT REPLACEMENT

CONCRETE REPAIR AND REPLACEMENT

STATE OF WISCONSIN
DEPARTMENT OF TRANSPORTATION

APPROVED
November 2022 /S/ Peter Kemp P.E.
DATE PAVEMENT SUPERVISOR

FHWA

Concrete Pavement Repair and Replacement

References:[FDM 14-25-10](#)**Bid items associated with this drawing:**

<u>ITEM NUMBER</u>	<u>DESCRIPTION</u>	<u>UNIT</u>
204.0100	Removing Concrete Pavement.....	SY
415.0060 - 0199	Concrete Pavement (inch).....	SY
415.1080 - 1199	Concrete Pavement HES (inch)	SY
416.0610	Drilled Tie Bars.....	EACH
416.0620	Drilled Dowel Bars.....	EACH
416.1710	Concrete Pavement Repair	SY
416.1715	Concrete Pavement Repair SHES	SY
416.1720	Concrete Pavement Replacement.....	SY
416.1725	Concrete Pavement Replacement SHES	SY
690.0250	Sawing Concrete	LF

Standardized Special Provisions associated with this drawing:

<u>STSP NUMBER</u>	<u>TITLE</u>
NONE	

Other SDDs associated with this drawing:

SDD 13C11	Rural Doweled Concrete Pavement
SDD 13C13	Urban Doweled Concrete Pavement

Design Notes:

Always include SDD 13C9 sheets "a", "b" and "c" together in plan sets.

If Concrete Pavement Repair or Concrete Pavement Repair SHES are part of a project, designers should also consider including Concrete Pavement Replacement or Concrete Pavement Replacement SHES and Concrete Pavement (inch) or Concrete Pavement HES (inch) bid items since unforeseen pavement repairs may extend beyond 15 feet in length.

Contact Person:

Amy Brooks (608) 246-5396