

GENERAL NOTES

CONTRACTION JOINTS

CONSTRUCT TRANSVERSE CONTRACTION JOINTS NORMAL TO THE CENTERLINE. SHOW THE LOCATION OF CONTRACTION JOINTS THROUGH INTERSECTIONS ON THE PLANS OR AS DIRECTED BY THE ENGINEER.

INSTALL DOWEL BARS PARALLEL TO THE PAVEMENT CENTERLINE AND PAVEMENT SURFACE.

FOR PAVEMENT SLABS OF VARYING WIDTHS, LOCATE THE OUTER MOST DOWEL BAR SO THAT THE CENTER OF THE BAR IS A MINIMUM OF 6 INCHES FROM AND A MAXIMUM OF 18 INCHES FROM THE FREE EDGE OF PAVEMENT.

CONSTRUCTION JOINTS

LOCATE CONSTRUCTION JOINTS A MINIMUM OF 6 FEET FROM THE NEAREST CONTRACTION JOINT AND ALIGN PARALLEL TO THE CONTRACTION JOINTS.

- ① REFER TO TYPICAL CROSS SECTIONS FOR ADDITIONAL DETAILS.
- ② MEASURE THE ENTIRE PAVED WIDTH INCLUDING THE PORTION(S) LABELED "PAVED SHOULDER" AS CONCRETE PAVEMENT.
- ③ SHOULDER WIDTHS LESS THAN 3 FEET SHALL BE PAVED INTEGRAL TO THE MAINLINE CONCRETE PAVEMENT, SEE SECTION B-B.

PAVEMENT DEPTH, DOWEL BAR SIZE AND JOINT SPACING TABLE

PAVEMENT DEPTH (D)	DOWEL BAR DIAMETER	CONTRACTION JOINT SPACING
6", 6 1/2"	NONE	12'
7", 7 1/2"	1"	14'
8" & ABOVE	1 1/4"	15'

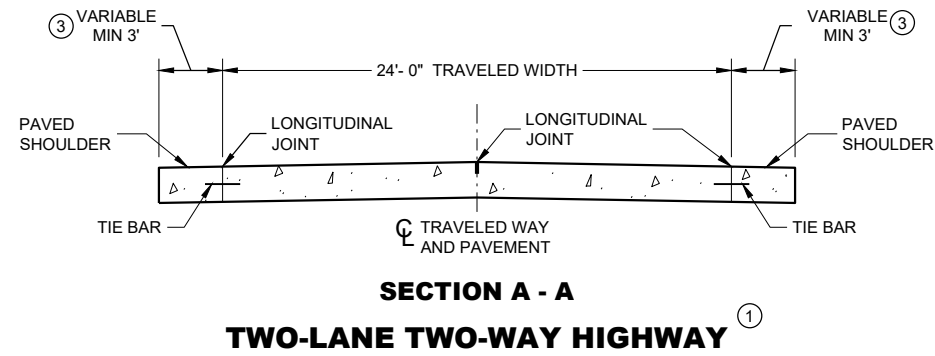

**SECTION A - A
TWO-LANE TWO-WAY HIGHWAY**

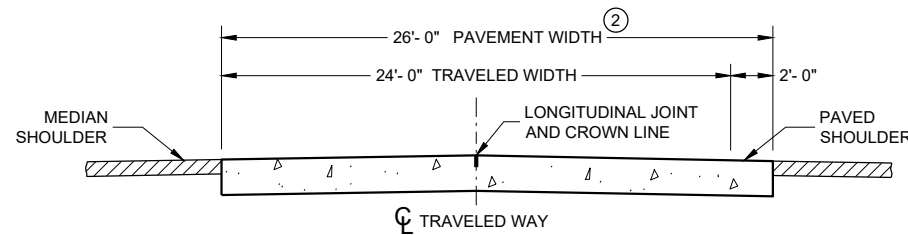

SECTION B - B

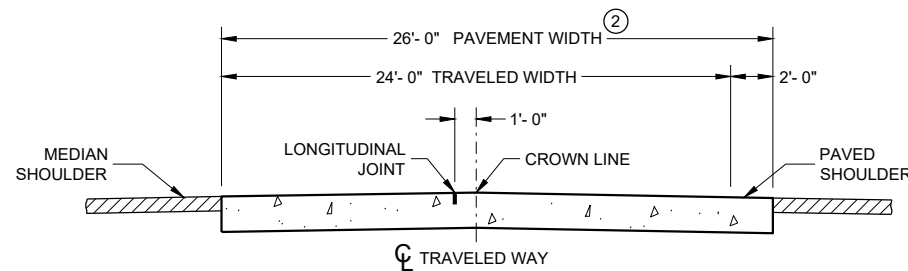

**ALTERNATIVE SECTION B - B
DIVIDED HIGHWAY**

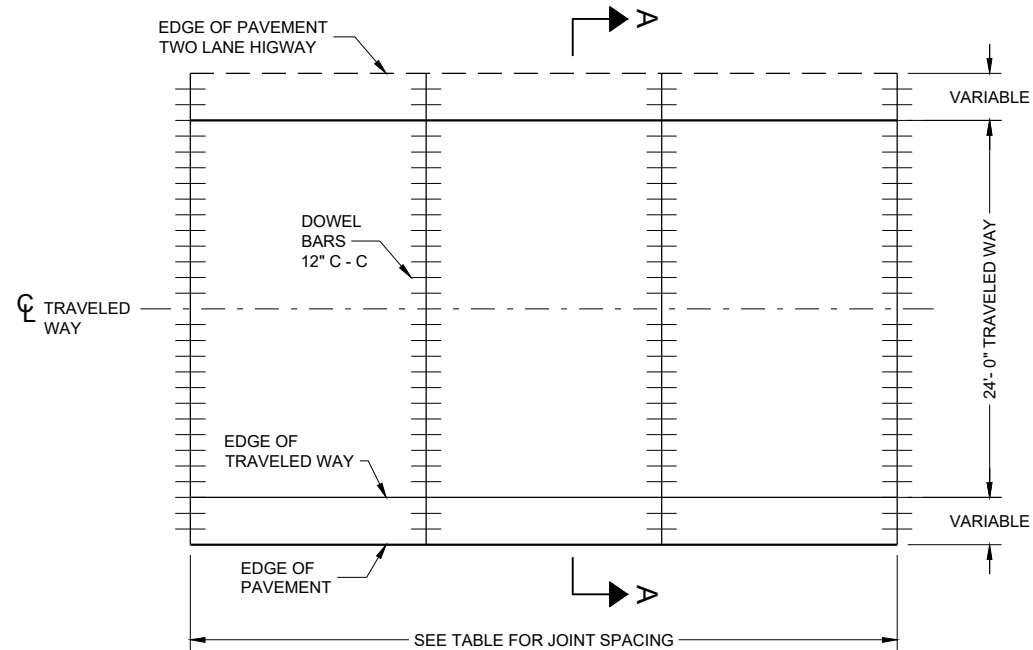

**CONTRACTION JOINT LAYOUT FOR
TWO-LANE TWO-WAY HIGHWAY**

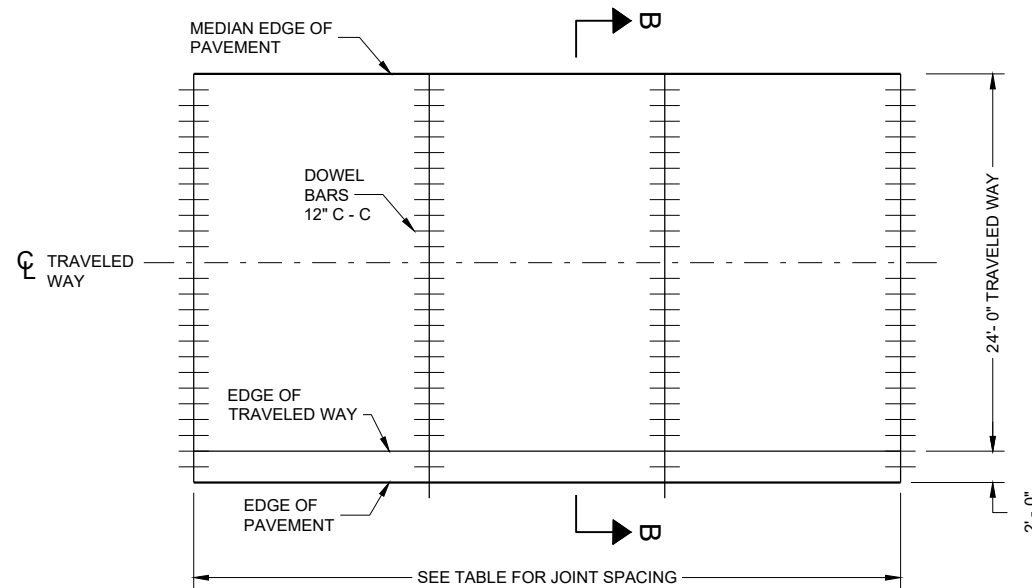

**CONTRACTION JOINT LAYOUT FOR
DIVIDED HIGHWAY**

**RURAL DOWELED
CONCRETE PAVEMENT**

STATE OF WISCONSIN
DEPARTMENT OF TRANSPORTATION

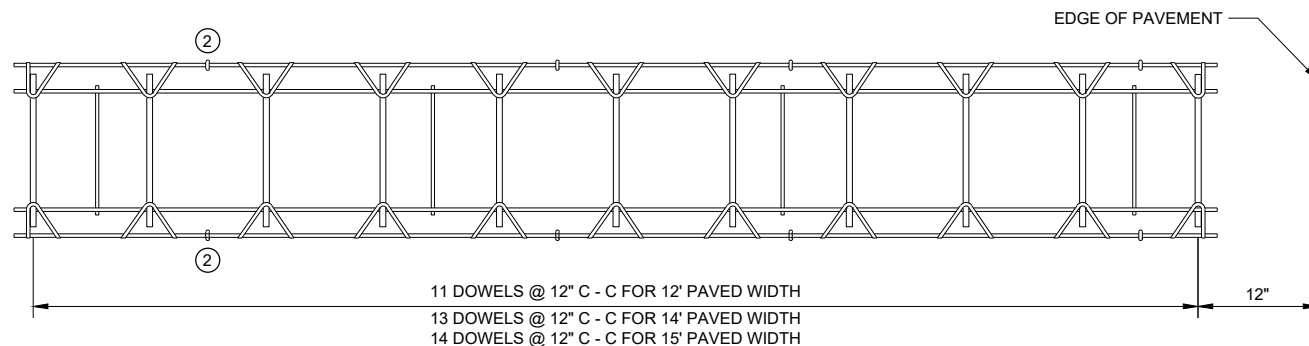

PLAN VIEW

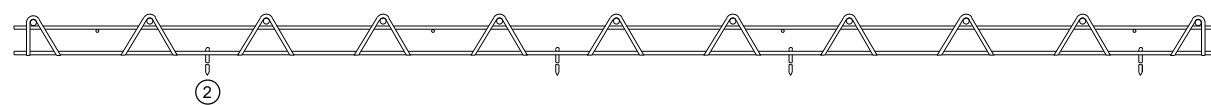

SIDE VIEW
(NORMAL TO CENTERLINE)

CONTRACTION JOINT DOWEL ASSEMBLY ①

GENERAL NOTES

- ① OBTAIN THE ENGINEER'S APPROVAL FOR THE USE OF ALTERNATIVE DESIGNS OF THE DOWEL ASSEMBLY. USE MECHANICAL DOWEL BAR INSERTERS OR DOWEL ASSEMBLIES WHEN CONSTRUCTION CONTRACTION JOINTS.
- ② SECURE BASKETS WITH ANCHORS TO HOLD DOWEL BARS IN THE CORRECT POSITION AND ALIGNMENT. TYPE, LOCATION, NUMBER AND LENGTH OF ANCHORS ARE DEPENDENT UPON FIELD CONDITIONS.
- ③ FORM OR SAW CONSTRUCTION JOINTS. PROVIDE A ¼" RADIUS AT FORMED JOINTS.
- ④ PROVIDE A SMOOTH VERTICAL FACE FOR THE ENTIRE DEPTH OF THE PAVEMENT WHEN FORMING CONSTRUCTION JOINTS.
- ⑤ INSTALL DOWEL BARS AT CONSTRUCTION JOINTS BY FORMING OR DRILLING. INSTALL FORMED DOWEL BARS 12 INCHES C - C AND 12 INCHES FROM PAVEMENT EDGE. REMOVE EXCESS CONCRETE FROM THE FREE END OF THE DOWEL BAR IF DOWEL BARS ARE FORMED THROUGH A HEADER BOARD. INSTALL DRILLED DOWEL BARS ACCORDING TO THE "DRILLED DOWEL BAR CONSTRUCTION JOINT" DETAIL.
- ⑥ APPLY A THIN UNIFORM COATING OF SURFACE TREATMENT TO THE FREE END OF DOWEL BARS TO PREVENT BONDING.
- ⑦ ANCHOR DOWEL BARS AND TIE BARS INTO DRILLED HOLES WITH AN EPOXY. MAXIMUM DRILLED HOLE SIZE IS ⅛" GREATER THAN DOWEL BAR DIAMETER, 9 INCHES IN LENGTH.

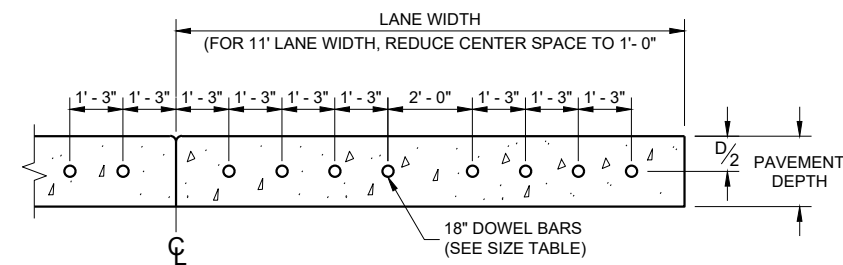

DRILLED DOWEL BAR CONSTRUCTION JOINT ⑦

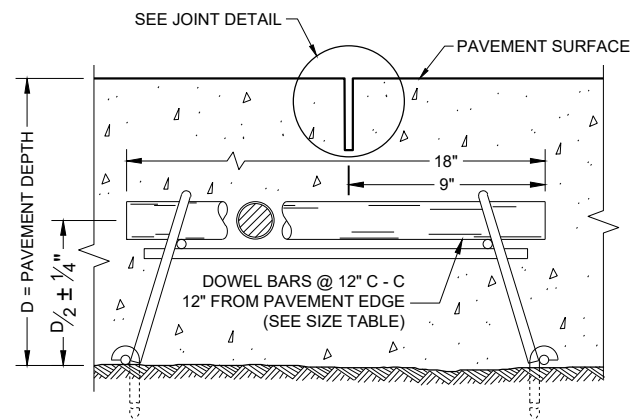

DOWELED CONTRACTION JOINT

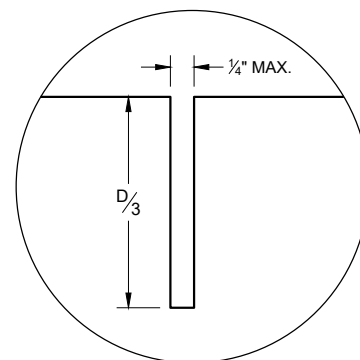

JOINT DETAIL

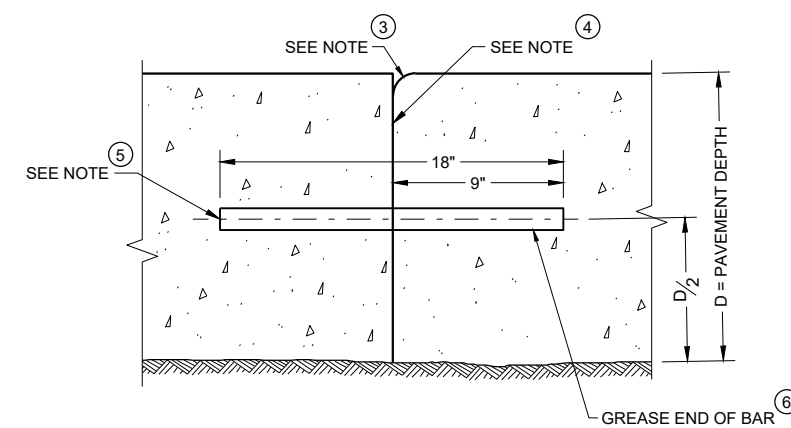

TRANSVERSE CONSTRUCTION JOINT

**RURAL DOWELED
CONCRETE PAVEMENT**

STATE OF WISCONSIN
DEPARTMENT OF TRANSPORTATION

APPROVED
November 2022 /S/ Peter Kemp P.E.
DATE PAVEMENT SUPERVISOR
FHWA

Rural Doweled Concrete Pavement

References:

[FDM 14-10-5](#)

Bid items associated with this drawing:

<u>Item Number</u>	<u>Description</u>	<u>UNIT</u>
415.0060 - 0199	Concrete Pavement (inch).....	SY
415.1080 - 1199	Concrete Pavement HES (inch)	SY
416.0620	Drilled Dowel Bars.....	EACH

Standardized Special Provisions associated with this drawing:

<u>STSP NUMBER</u>	<u>TITLE</u>
NONE	

Other SDDs associated with this drawing:

[SDD 13C1](#) Concrete Pavement Longitudinal Joints and Ties is required.

Design Notes:

- Always include SDDs 13C11 sheets "a" and " b" together in plan sets.
- Always include SDD 13C1 when using this SDD.
- [FDM 11-15-1](#) provides pavement and shoulder width criteria.
- [FDM 14-10-5](#) provides guidance on concrete pavement design.
- [FDM 14-10-25](#) provides guidance for paved shoulders.

Contact Person:

Peter Kemp (608) 246-5393