

### GENERAL NOTES

SIGNING AND MARKING IS SHOWN AS TYPICAL PLACEMENT. FIELD CONDITIONS MAY DICTATE CHANGES IN SIGNING AND MARKING PLACEMENT.

① USED ONLY WHEN APPROVED BY REGION TRAFFIC ENGINEER.

\* CONFIRM MARKING LINE WIDTH WITH THE MISCELLANEOUS QUANTITIES

\*\* SIGNS MAY BE OMITTED IF SPACE DOES NOT PERMIT PLACEMENT.

\*\*\* IF POSTED SPEED IS 45 MPH OR GREATER, PLACE W5-54 SIGN UNDER R4-7 SIGN. MOUNT W5-54 SIGN AT 4' MOUNTING HEIGHT (TOP OF ROADWAY TO BOTTOM OF SIGN).

### LEGEND

A DISTANCE DEPENDENT ON SPEED (SEE TABLE)

⊙ SIGN MOUNTED ON PERMANENT SUPPORT

➡ DIRECTION OF TRAFFIC

#### DISTANCE TABLE

POSTED OR 85TH PERCENTILE SPEED	DISTANCE "A"
25	325'
30	460'
35	565'
40	670'
45	775'
50	885'
55	990'
65	1200'
70	1250'

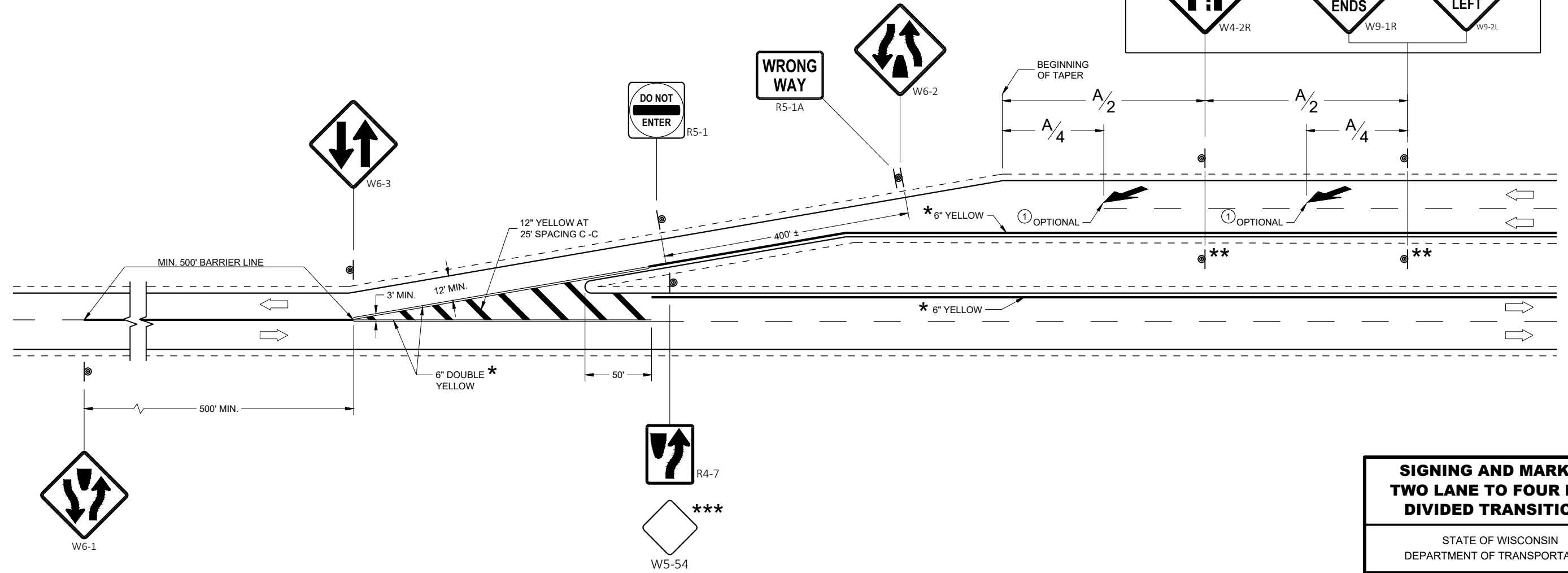
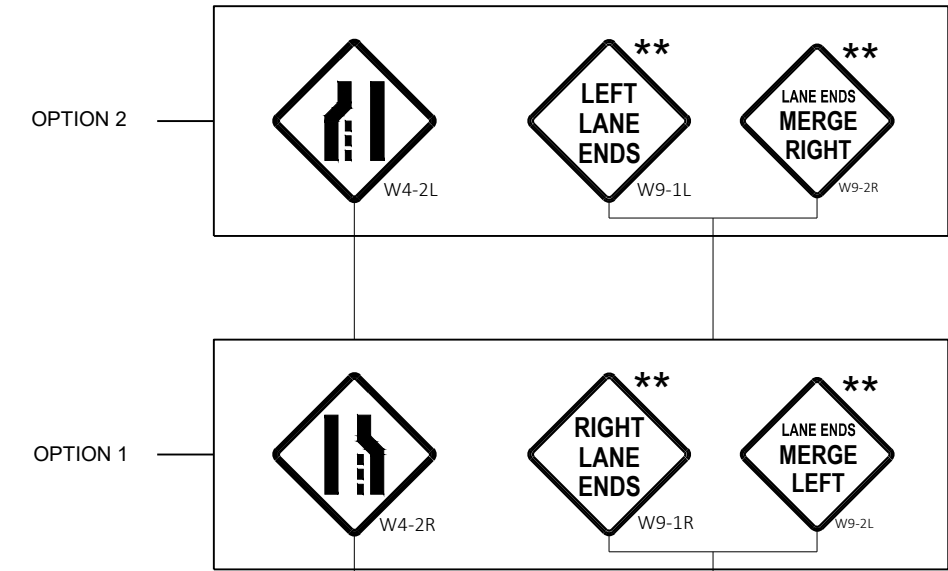

**SIGNING AND MARKING  
TWO LANE TO FOUR LANE  
DIVIDED TRANSITIONS**

STATE OF WISCONSIN  
DEPARTMENT OF TRANSPORTATION

APPROVED  
May 2023 /S/ Matthew Rauch  
DATE STATE SIGNING AND MARKING  
ENGINEER

FHWA

6

6

SDD 15C21-11

SDD 15C21-11

Signing and Marking for Two Lane to Four Lane Divided Transitions

References:

MUTCD Chapters 2 and 3.

Bid items associated with this drawing:

<u>ITEM NUMBER</u>	<u>DESCRIPTION</u>	<u>UNIT</u>
646.5000 - 5099	Marking Arrow (material) .....	EACH
646.7100 - 7199	Marking Diagonal (material) 12-Inch .....	LF
<b>If permanent signing is to be included in the contract:</b>		
634.0612- 0622	Posts Wood 4x6 Inch, X _____ FT.....	EACH
634.0801- 0816	Posts Tubular Steel 2x2 Inch, X _____ FT.....	EACH
637.2210	Signs Type II Reflective H .....	SF

Standardized Special Provisions associated with this drawing:

<u>STSP NUMBER</u>	<u>TITLE</u>
NONE	

Other SDDs associated with this drawing:

- [SDD 15C7](#) Pavement Marking Arrows is required when arrows are called for in the plans.
- [SDD 15C8](#) sheet "a" - Pavement Marking (Mainline)) is required when this drawing is called for in the plans.

Design Notes:

When bidding Arrows, specify the kind of Arrow (e.g. Type 5) on the Miscellaneous Quantities list heading. There should be a list for every type of arrow to be used.

Consult with the Regional Signing/Marking Engineer for placement of Type 5 Arrows.

Contact Person:

Jeannie Silver (608) 246-5408  
 Ryan Mayer (608) 246-3810