



Consistent with LEED® goals
& Green Globes™ criteria
for light pollution reduction

Autobahn Series ATB0

Roadway Lighting

PRODUCT OVERVIEW



Applications:

Roadways
Off ramps
Residential streets
Parking lots

DIMENSIONS

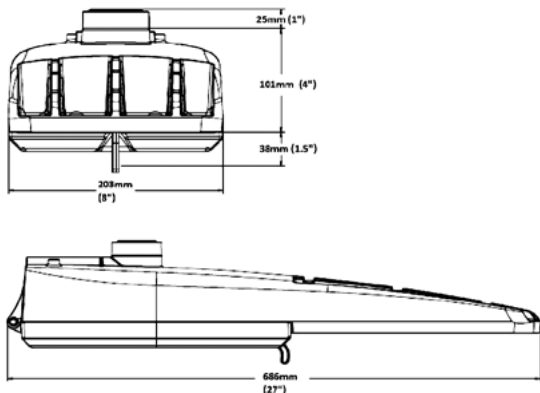

Effective Projected Area (EPA): The EPA for the ATB0 is 0.76 sq. ft.
Approx. Wt. = 14 lbs.

STANDARDS

DesignLights Consortium® (DLC) qualified product. Not all versions of this product may be DLC qualified. Please check the DLC Qualified Products List at www.designlights.org/QPL to confirm which versions are qualified.

Color temperatures of $\leq 3000\text{K}$ must be specified for International Dark-Sky Association certification.

Rated for -40°C to 40°C ambient

CSA Certified to U.S. and Canadian standards

Complies with ANSI: C136.2, C136.10, C136.14, C136.31, C136.15, C136.37

Features:

OPTICAL

Same Light: Performance is comparable to 70-250W HPS roadway luminaires.

White Light: Correlated color temperature - 4000K, 70 CRI minimum, 3000K, 70 CRI minimum or optional 5000K, 70 CRI minimum.

Unique IP66 rated LED light engines provided 0% uplight and restrict backlight to within sidewalk depth, providing optimal application coverage and optimal pole spacing. Available in Type II, III, IV, and V roadway distributions.

ELECTRICAL

Expected Life: LED light engines are rated $>100,000$ hours at 25°C , L70. Electronic driver has an expected life of 100,000 hours at a 25°C ambient.

Lower Energy: Saves an expected of 40-60% over comparable HID luminaires.

Robust Surge Protection: Three different surge protection options provide a minimum of ANSI C136.2 10kV/5kA protection. 20kV/10kA protection is also available.

MECHANICAL

Includes standard AEL lineman-friendly features such as tool-less entry, 3 station terminal block and quick disconnects. Bubble level located inside the electrical compartment for easily leveling at installation.

Rugged die-cast aluminum housing and door are polyester powder-coated for durability and corrosion resistance. Rigorous five-stage pre-treating and painting process yields a finish that achieves a scribe creepage rating of 7 (per ASTM D1654) after over 5000 hours exposure to salt fog chamber (operated per ASTM B117).

Mast arm mount is adjustable for arms from 1-1/4" to 2" (1-5/8" to 2-3/8" O.D.) diameter. Provides a 3G vibration rating per ANSI C136.31

Wildlife shield is cast into the housing (not a separate piece).

CONTROLS

NEMA 3 pin photocontrol receptacle is standard, with the Acuity designed ANSI standard 7 pin receptacle optionally available.

Premium solid state locking style photocontrol - PCSS (10 year rated life) Extreme long life solid state locking style photocontrol - PCLL (20 year rated life).

Multi-level dimming available to provide scheduled dimming as specified by the customer.

Optional onboard Adjustable Output module allows the light output and input wattage to be modified to meet site specific requirements, and also can allow a single fixture to be flexibly applied in many different applications.

Note: Specifications subject to change without notice. Actual performance may differ as a result of end-user environment and application.

Autobahn Series ATB0

Roadway Lighting

ORDERING INFORMATION

Example: ATB0 30LEDE10 MVOLT R2

| Series | Performance Packages | Voltage | Optics |
|----------------------------------|--|---|--|
| ATB0 Autobahn LED Roadway | 10BLEDE70 10B Chips, 700mA Driver 10BLEDE10 10B Chips, 1050mA Driver 10BLEDE15 10B Chips, 1500mA Driver 20BLEDE53 20B Chips, 525mA Driver 20BLEDE70 20B Chips, 700mA Driver 20BLEDE10 20B Chips, 1050mA Driver 20BLEDE13 20B Chips, 1300mA Driver 20BLEDE15 20B Chips, 1500mA Driver 30BLEDE70 30B Chips, 700mA Driver 30BLEDE85 30B Chips, 850mA Driver 30BLEDE10 30B Chips, 1050mA Driver 30BLEDE13 30B Chips, 1300mA Driver 30BLEDE15 30B Chips, 1500mA Driver | MVOLT Multi-volt, 120-277V 347 347V 480 480V | R2 Roadway Type II R3 Roadway Type III R4 Roadway Type IV R5 Roadway Type V |

Options

Color Temperature (CCT)

| | |
|----------------|------------------------|
| (Blank) | 4000K CCT, 70 CRI Min. |
| 3K | 3000K CCT, 70 CRI Min. |
| 5K | 5000K CCT, 70 CRI Min. |

Paint

| | |
|----------------|-----------------|
| (Blank) | Gray (Standard) |
| BK | Black |
| BZ | Bronze |
| DDB | Dark Bronze |
| GI | Graphite |
| WH | White |

Surge Protection

| | |
|-----------------------|--------------------------|
| (Blank) | Standard 10kV/5kA SPD |
| 20 | 20kV/10KA SPD |
| MP¹ | MOV Pack |
| IL¹ | SPD with Indicator Light |

Terminal Block

| | |
|----------------|----------------------------|
| (Blank) | Terminal Block (Standard) |
| T2 | Wired to L1 & L2 Positions |

Misc.

| | |
|---------------|--|
| BL | External Bubble Level |
| HS | House-Side Shield |
| NL | Nema Label |
| XL | Not CSA Certified |
| UMR-XX | 8" Horizontal Arm for Round Pole, Painted to match Fixture |

| | |
|-----------------|---|
| UMS-XX | 8" Horizontal Arm for Square Pole, Painted to match Fixture |
| UMR-GALV | 8" Horizontal Arm for Round Pole, Galvanized |
| UMS-GALV | 8" Horizontal Arm for Square Pole, Galvanized |

Controls

| | |
|-------------------------|--|
| (Blank) | 3 Pin NEMA Photocontrol Receptacle (Standard) |
| P7² | 7 Pin Photocontrol Receptacle (Dimmable Driver Included) |
| NR | No Photocontrol Receptacle |
| AO³ | Field Adjustable Output |
| DM | 0V-10V Dimmable Driver (Controls by others) |
| ML^{4,5} | Multi-Level Dimming |
| PCSS¹ | Solid State Lighting Photocontrol (120-277V) |
| PCLL | Solid State Long Life Photocontrol |
| SH | Shorting Cap |

Packaging

| | |
|----------------|------------------------|
| (Blank) | Single Unit (Standard) |
| JP | Job Pack (42/Pallet) |

Notes

- 1 Not available in 347 or 480V.
- 2 Not available with DM, ML or NR.
- 3 Not available with DM or ML options. Not available with 10BLEDE packages.
- 4 Not available with AO, DM, P5 or P7 options.
- 5 Dimming Schedule and light level information required from the customer in order to configure product. Contact Infrastructure Technical Support to proceed.



AEL Headquarters, 3825 Columbus Road, Granville, OH 43023
www.americanelectriclighting.com

© 2014-2017 Acuity Brands Lighting, Inc. All Rights Reserved. ATB0 07/24/17

Warranty Five-year limited warranty. Complete warranty terms located at: www.acuitybrands.com/CustomerResources/Terms_and_conditions.aspx
Actual performance may differ as a result of end-user environment and application. All values are design or typical values, measured under laboratory conditions at 25 °C. Specifications subject to change without notice.

Please contact your sales representative for the latest product information.

Autobahn Series ATB0

Roadway Lighting

PERFORMANCE PACKAGE

| Performance Package | Drive Current (mA) | Input Watts | Optic | 4000K CCT | | LLD @ 25°C | | |
|---------------------|--------------------|-------------|-------|------------------|----------------|------------|-----------|------------|
| | | | | Delivered Lumens | Efficacy (LPW) | 50k Hours | 75k Hours | 100k Hours |
| 10B | 700 | 25 | R2 | 2994 | 120 | 0.98 | 0.98 | 0.97 |
| | 1000 | 37 | | 4293 | 116 | 0.98 | 0.98 | 0.97 |
| | 1500 | 54 | | 5688 | 105 | 0.97 | 0.97 | 0.96 |
| | 700 | 25 | R3 | 3009 | 120 | 0.98 | 0.98 | 0.97 |
| | 1000 | 37 | | 4313 | 117 | 0.98 | 0.98 | 0.97 |
| | 1500 | 54 | | 5742 | 106 | 0.97 | 0.97 | 0.96 |
| | 700 | 25 | R4 | 2992 | 120 | 0.98 | 0.98 | 0.97 |
| | 1000 | 37 | | 4232 | 114 | 0.98 | 0.98 | 0.97 |
| | 1500 | 54 | | 5653 | 105 | 0.97 | 0.97 | 0.96 |
| | 700 | 25 | R5 | 3065 | 123 | 0.98 | 0.98 | 0.97 |
| 20B | 1000 | 37 | | 4422 | 120 | 0.98 | 0.98 | 0.97 |
| | 1500 | 54 | | 5844 | 108 | 0.97 | 0.97 | 0.96 |
| | 525 | 36 | R2 | 4638 | 129 | 0.98 | 0.98 | 0.97 |
| | 700 | 48 | | 5956 | 124 | 0.98 | 0.98 | 0.97 |
| | 1000 | 71 | | 8506 | 120 | 0.98 | 0.98 | 0.97 |
| | 1300 | 87 | | 9922 | 114 | 0.96 | 0.94 | 0.92 |
| | 1500 | 99 | | 11038 | 111 | 0.95 | 0.92 | 0.90 |
| | 525 | 36 | R3 | 4704 | 131 | 0.98 | 0.98 | 0.97 |
| | 700 | 48 | | 6114 | 127 | 0.98 | 0.98 | 0.97 |
| | 1000 | 71 | | 8606 | 121 | 0.98 | 0.98 | 0.97 |
| | 1300 | 87 | | 10065 | 116 | 0.96 | 0.94 | 0.92 |
| | 1500 | 99 | | 11181 | 113 | 0.95 | 0.92 | 0.90 |
| | 525 | 36 | R4 | 4676 | 130 | 0.98 | 0.98 | 0.97 |
| | 700 | 48 | | 6022 | 125 | 0.98 | 0.98 | 0.97 |
| | 1000 | 72 | | 8569 | 119 | 0.98 | 0.98 | 0.97 |
| | 1300 | 87 | | 10053 | 116 | 0.96 | 0.94 | 0.92 |
| | 1500 | 99 | | 11160 | 113 | 0.95 | 0.92 | 0.90 |
| | 525 | 36 | R5 | 4869 | 135 | 0.98 | 0.98 | 0.97 |
| | 700 | 48 | | 6287 | 131 | 0.98 | 0.98 | 0.97 |
| | 1000 | 71 | | 8880 | 125 | 0.98 | 0.98 | 0.97 |
| | 1300 | 87 | | 10397 | 120 | 0.96 | 0.94 | 0.92 |
| | 1500 | 99 | | 11593 | 117 | 0.95 | 0.92 | 0.90 |
| 30B | 700 | 70 | R2 | 9174 | 131 | 0.98 | 0.98 | 0.97 |
| | 850 | 83 | | 10457 | 126 | 0.98 | 0.98 | 0.97 |
| | 1000 | 105 | | 12414 | 118 | 0.96 | 0.96 | 0.95 |
| | 1300 | 126 | | 14964 | 119 | 0.96 | 0.94 | 0.92 |
| | 1500 | 145 | | 16251 | 112 | 0.94 | 0.91 | 0.89 |
| | 700 | 70 | R3 | 8893 | 127 | 0.98 | 0.98 | 0.97 |
| | 850 | 83 | | 10825 | 130 | 0.98 | 0.98 | 0.97 |
| | 1000 | 105 | | 12748 | 121 | 0.96 | 0.96 | 0.95 |
| | 1300 | 126 | | 14850 | 118 | 0.96 | 0.94 | 0.92 |
| | 1500 | 145 | | 16193 | 112 | 0.94 | 0.91 | 0.89 |
| | 700 | 70 | R4 | 8971 | 128 | 0.98 | 0.98 | 0.97 |
| | 850 | 83 | | 10589 | 128 | 0.98 | 0.98 | 0.97 |
| | 1000 | 105 | | 12782 | 122 | 0.96 | 0.96 | 0.95 |
| | 1300 | 126 | | 14889 | 118 | 0.96 | 0.94 | 0.92 |
| | 1500 | 145 | | 16463 | 114 | 0.94 | 0.91 | 0.89 |
| | 700 | 70 | R5 | 9329 | 133 | 0.98 | 0.98 | 0.97 |
| | 850 | 83 | | 11209 | 135 | 0.98 | 0.98 | 0.97 |
| | 1000 | 105 | | 13296 | 127 | 0.96 | 0.95 | 0.94 |
| | 1300 | 126 | | 15254 | 121 | 0.96 | 0.94 | 0.92 |
| | 1500 | 145 | | 16871 | 116 | 0.94 | 0.91 | 0.89 |

Note: Information shown above is based on 4000K nominal system data. Individual fixture performance may vary. To calculate 3000K lumen values, multiply the 4000K lumens by .93. Specifications subject to change without notice.

| ATB0 LLD Multiplier | 15°C | 20°C | 25°C | 30°C | 35°C | 40°C |
|---------------------|------|------|------|------|------|------|
| | 1.02 | 1.01 | 1 | 0.98 | 0.97 | 0.95 |

To calculate the LLD for a temperature other than 25°C, multiply the LLD @ 25°C (shown in the performance package table) by the LLD multiplier for the selected temperature.



AEL Headquarters, 3825 Columbus Road, Granville, OH 43023
www.americanelectricleighting.com

© 2014-2017 Acuity Brands Lighting, Inc. All Rights Reserved. ATB0 07/24/17

Warranty Five-year limited warranty. Complete warranty terms located at: www.acuitybrands.com/CustomerResources/Terms_and_conditions.aspx
Actual performance may differ as a result of end-user environment and application. All values are design or typical values, measured under laboratory conditions at 25 °C. Specifications subject to change without notice.

Please contact your sales representative for the latest product information.

Autobahn Series ATB0

Roadway Lighting

UMR POLE ADAPTOR

RECOMMENDED FOR USE WITH POLES OF 4" DIAMETER OR SMALLER

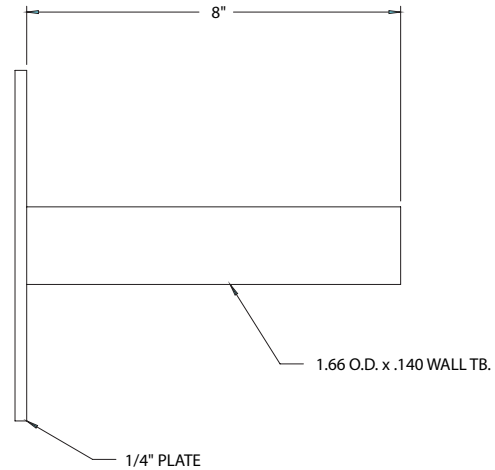
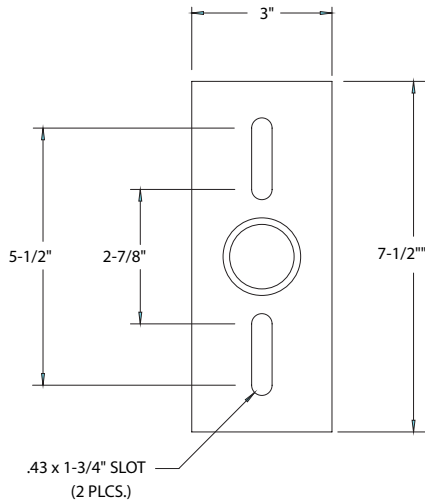
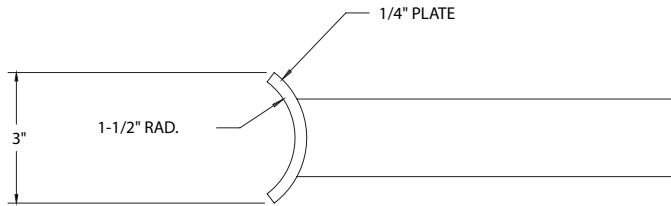

UMS POLE ADAPTOR



AEL Headquarters, 3825 Columbus Road, Granville, OH 43023
www.americanelectriclighting.com

© 2014-2017 Acuity Brands Lighting, Inc. All Rights Reserved. ATB0 07/24/17

Warranty Five-year limited warranty. Complete warranty terms located at:

www.acuitybrands.com/CustomerResources/Terms_and_conditions.aspx

Actual performance may differ as a result of end-user environment and application. All values are design or typical values, measured under laboratory conditions at 25 °C. Specifications subject to change without notice.

Please contact your sales representative for the latest product information.