

# **BUS 51, Grand Avenue Public Involvement Meeting**

**Wisconsin Department of Transportation**

Schofield City Hall

**December 10<sup>th</sup>, 2025**

**5:30 p.m.-7:00 p.m.**

# Presentation Overview

- Project Information
- Project Need
- Proposed Improvements
- Traffic Impacts
- Real Estate Impacts
- Schedule
- Questions & Comments





# Project Need

- Existing pavement is showing signs of distress (spalling, cracking, joint failure)
- Existing curb ramps are not ADA compliant
- There has been 6 bicycle crashes in the past 7 years that involved bicycles riding on the sidewalk that struck or were struck by vehicles leaving businesses.
- Bicycle accommodations do not meet current standards
- Existing street lighting, traffic signals, and street signage do not meet current standards









# Proposed Improvements

- Replace concrete pavement with 6.25" asphalt and 13" base aggregate
- Replace concrete curb & gutter with a wide gutter pan
- Reduce the inside lane width from 12-foot to 11-foot from the Eau Claire River bridge to Lakeview Drive
- Provide a five-foot bicycle lane from the Eau Claire River bridge to Kent Street
- Replace concrete sidewalk.
- Adjust or replace existing inlets and manholes
- Remove and replace traffic signals to provide a signal head per lane.
- Install curb ramps that meet ADA standards.
- Adjust street lighting as needed.



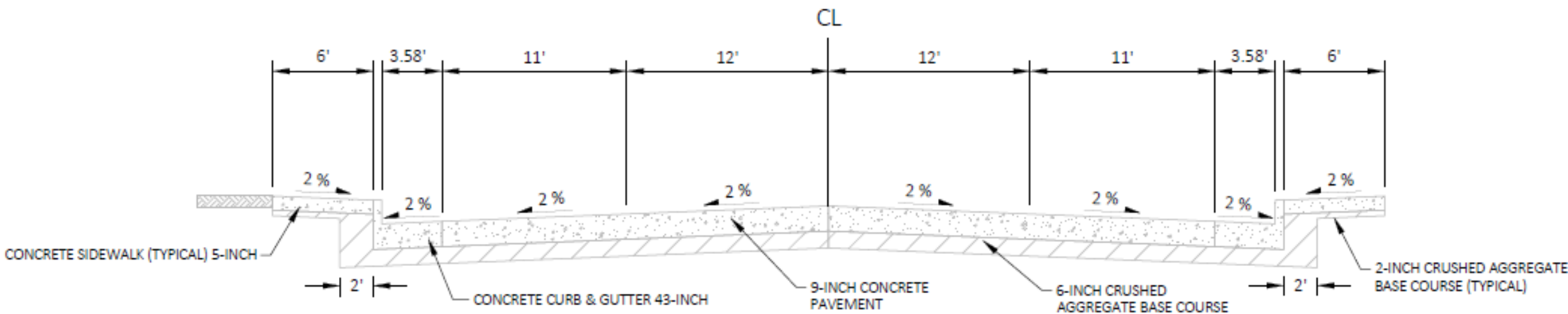

EXISTING TYPICAL SECTION - BUSINESS 51

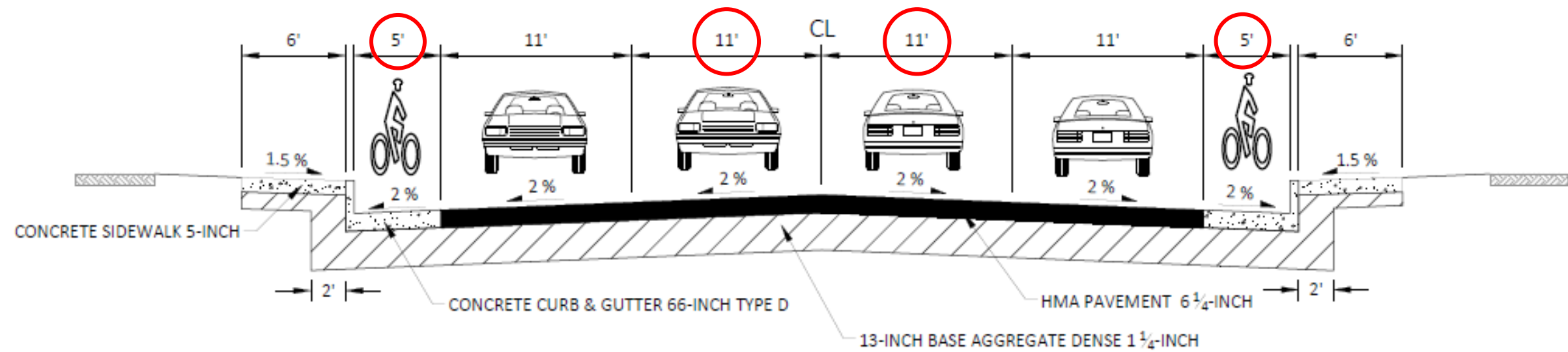

FINISHED TYPICAL SECTION - BUSINESS 51



# Example

## WIS 16 | La Crosse County



# Traffic Impacts

- Project will be constructed with single lane closures with bidirectional traffic
- Access will be maintained to business and residences during construction
- Sidewalks will be closed
- Free pedestrian shuttle service
- Kent Street will be closed for approximately 3 weeks to reconstruct the intersection. Bus Route A will remain operational and will be rerouted during the closure.



# Traffic Impacts

## Stage 1A

Install temporary traffic signals on Radtke St, Skelly St, Lakeview Dr, and Kent St.

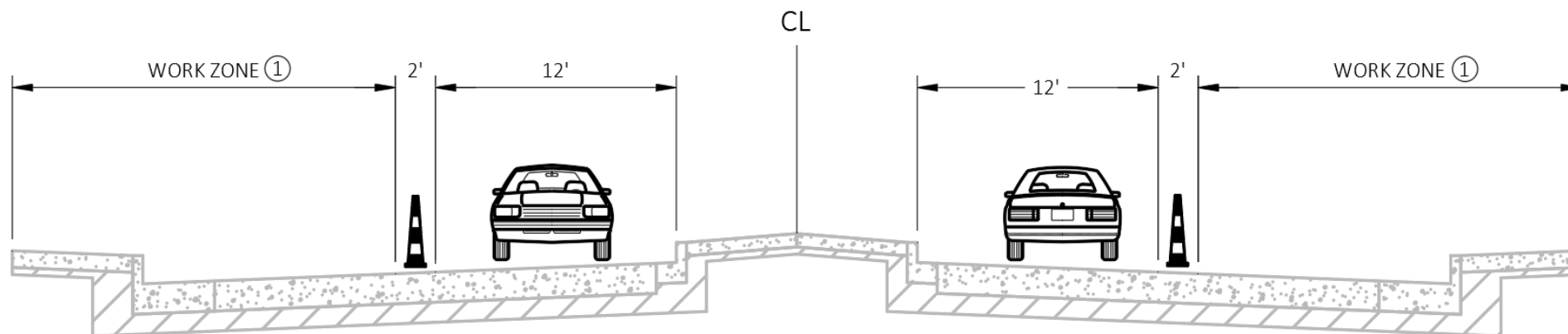

① INSTALL AND ACTIVATE TEMPORARY TRAFFIC SIGNALS AT  
RADTKE, SKELLY, LAKEVIEW, AND KENT

TRAFFIC CONTROL TYPICAL SECTION-STAGE 1A

# Traffic Impacts

## Stage 1B

Close inside lanes, traffic on outside lanes

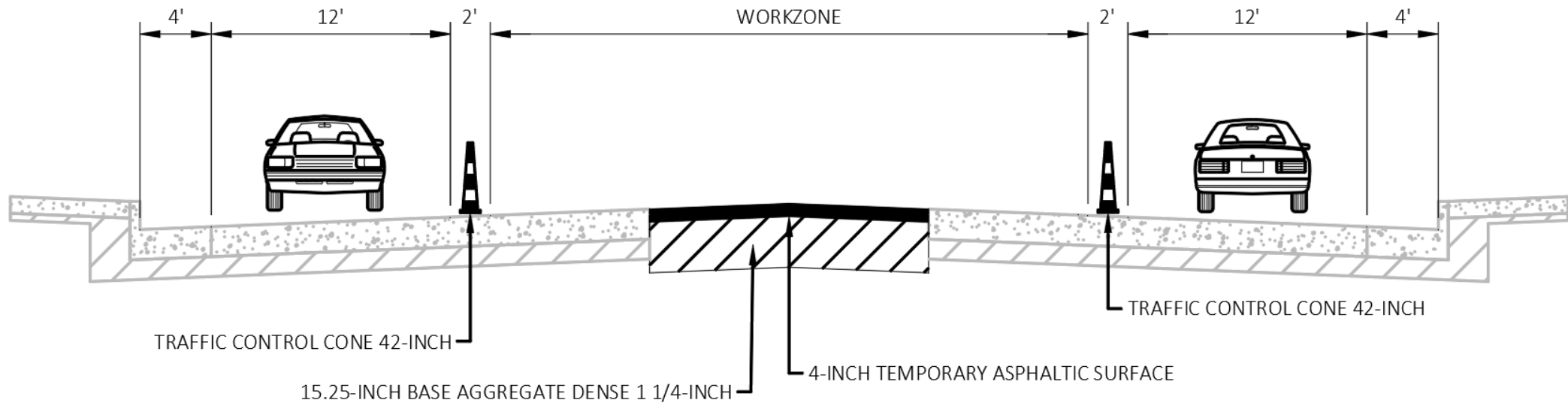

TRAFFIC CONTROL TYPICAL SECTION-STAGE 1B



# Traffic Impacts

## Stage 2

Close BUS 51 SB, bidirectional traffic on BUS 51 NB

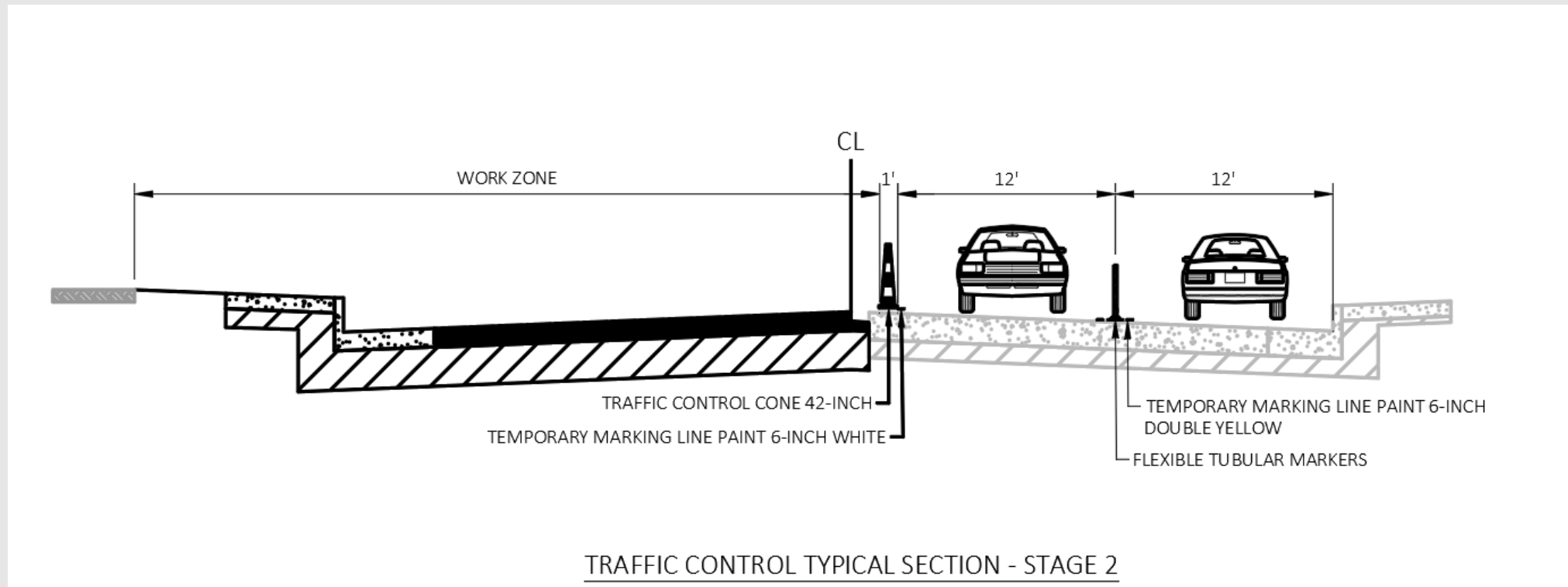

# Traffic Impacts

## Stage 3

Close BUS 51 NB, bidirectional traffic on BUS 51 SB

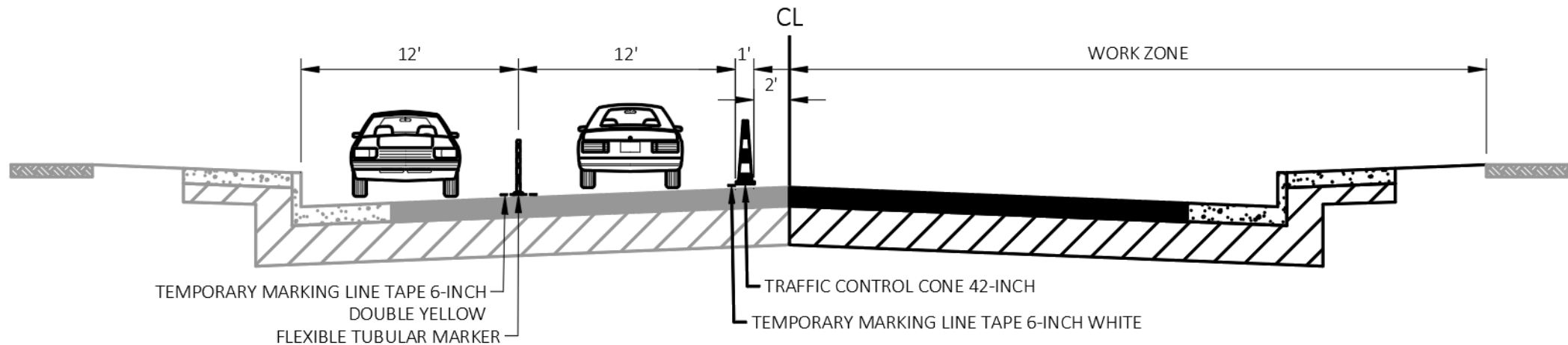

TRAFFIC CONTROL TYPICAL SECTION - STAGE 3

# Traffic Impacts

## Stage 4

Close inside lanes, traffic on outside lanes

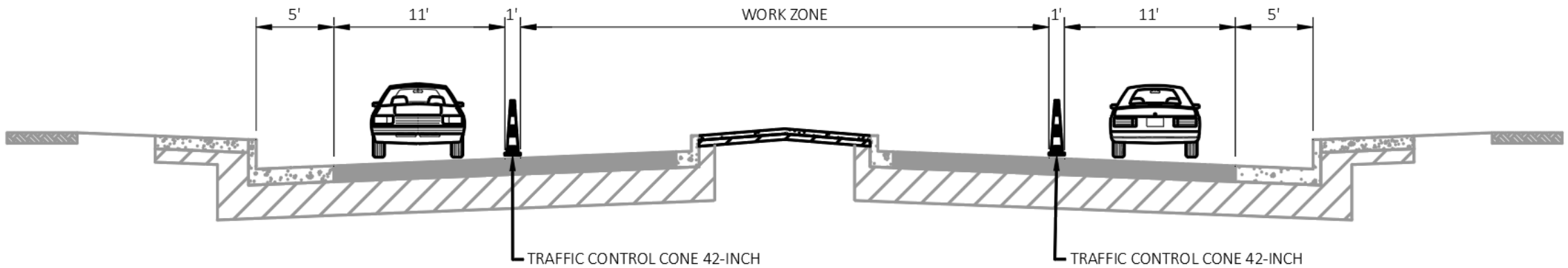

TRAFFIC CONTROL TYPICAL SECTION-STAGE 4

# Real Estate & Schedule

## Real estate

- Minor temporary and permanent real estate impacts are anticipated throughout the Business 51 corridor for sidewalk replacement, upgrading traffic signals, adjusting street lighting, and grading
- For any questions regarding real estate acquisitions, please contact the City of Wausau or the City of Schofield

## Schedule

Preliminary Plans: April 2026

Real Estate Begins: August 2026

Final Plans: August 2028

Construction: 2030, but could be as early as 2029











# Where to Find Project Information?

## Wisconsindot.gov/pages/projects/by-region

Wisconsin.Gov



State of Wisconsin  
Department of Transportation



DMV Services

Doing Business

Travel

Safety

Projects and Studies

About WisDOT



### Highway projects and studies

- Visit the pages below for more information regarding study and design of state highway projects.
- The department maintains interactive maps listing projects within the [improvement](#) and [construction](#) programs.
- Go to [511 Wisconsin Construction Projects](#) to view all projects under or scheduled for construction in the current year.
- Citizen input and [business outreach](#) are important elements of any WisDOT project.
- Related resources include the [Infrastructure Investment and Jobs Act \(IIJA\)](#) and [local assistance programs](#).

[North Central](#)

Adams, Florence, Forest, Green Lake, Iron, Langlade, Lincoln, Marathon, Marquette, Menominee, Oneida, Portage, Price, Shawano, Vilas, Waupaca, Waushara and Wood counties.

[Northeast](#)

Brown, Calumet, Door, Fond du Lac, Kewaunee, Manitowoc, Marinette, Oconto, Outagamie, Sheboygan and Winnebago counties.

[Northwest](#)

Ashland, Barron, Bayfield, Buffalo, Burnett, Chippewa, Clark, Douglas, Dunn, Eau Claire, Jackson, Pepin, Pierce, Polk, Rusk, Sawyer, St. Croix, Taylor, Trempealeau and Washburn counties.

[Southeast](#)

Kenosha, Milwaukee, Ozaukee, Racine, Walworth, Washington and Waukesha counties.

[Southwest](#)

Columbia, Crawford, Dane, Dodge, Grant, Green, Iowa, Jefferson, Juneau, La Crosse, Lafayette, Monroe, Richland, Rock, Sauk and Vernon counties.





# Questions & Comments

## Emily Vander Koy

Project Leader

Wisconsin Department of Transportation  
1681 Second Avenue South  
Wisconsin Rapids, WI 54494  
715-213-4913  
[emily.vanderkoy@dot.wi.gov](mailto:emily.vanderkoy@dot.wi.gov)

## Zach Gruling

Project Manager

Wisconsin Department of Transportation  
1681 Second Avenue South  
Wisconsin Rapids, WI 54494  
715-421-8346  
[zachary.gruling@dot.wi.gov](mailto:zachary.gruling@dot.wi.gov)

**Please Mail Comment Form by January 9th**

