

**STAGE 1 TYPICAL SECTION USH 10**

WORK ON USH 10 OUTSIDE LANES:  
MILL AND PAVE OUTSIDE SHOULDER  
SHOULDER GRAVEL

① LANE CLOSURE SHOWN, PLACE TRAFFIC CONTROL DRUMS  
OUTSIDE OF SHOULDER WHILE LANE IS OPEN TO TRAFFIC

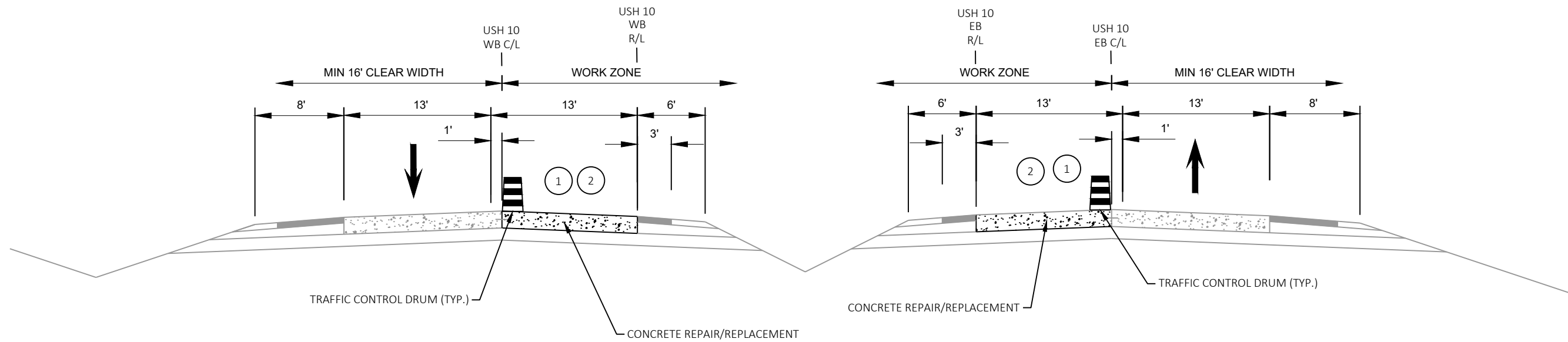

**STAGE 2A TYPICAL SECTION USH 10**

WORK ON USH 10 INSIDE LANES:  
CONCRETE PAVEMENT REPAIR/REPLACEMENT  
CONCRETE APPROACH SLAB

① LANE CLOSURE SHOWN, PLACE TRAFFIC CONTROL DRUMS  
OUTSIDE OF SHOULDER WHILE LANE IS OPEN TO TRAFFIC  
② TRAFFIC CONTROL DRUMS TO REMAIN ON WORK ZONE SIDE OF LANE  
LINE EXCEPT FOR WHEN ADJACENT PAVEMENT PATCH IS BEING  
REMOVED AND POURED BACK THEN CAN BE MOVED OVER LANE LINE  
AND RETURNED ONCE CONCRETE PAVEMENT IS COMPLETE.

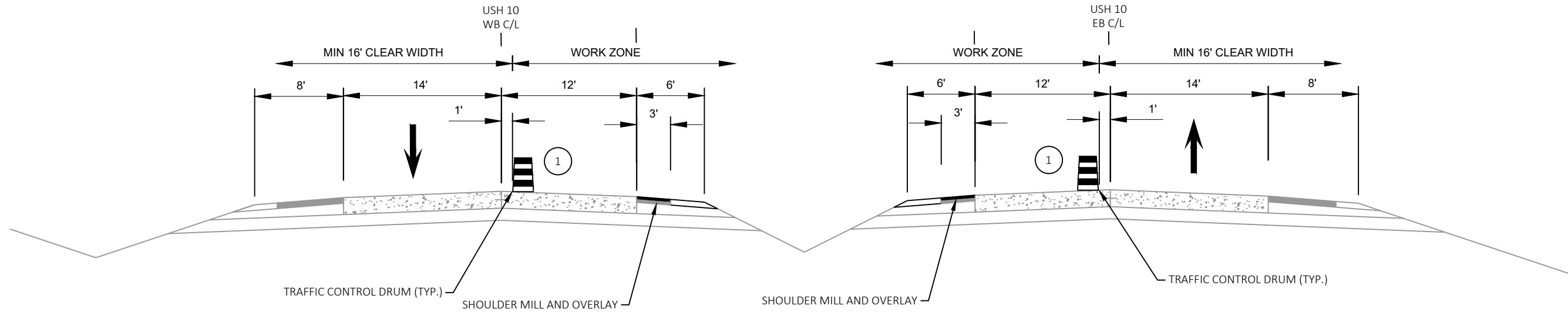

**STAGE 2B TYPICAL SECTION USH 10**

WORK ON USH 10 INSIDE LANES:  
MILL AND OVERLAY INSIDE SHOULDER  
ADD SHOULDER GRAVEL  
BEAM GUARD  
PAVEMENT MARKING

① LANE CLOSURE SHOWN, PLACE TRAFFIC CONTROL DRUMS OUTSIDE OF SHOULDER WHILE LANE IS OPEN TO TRAFFIC

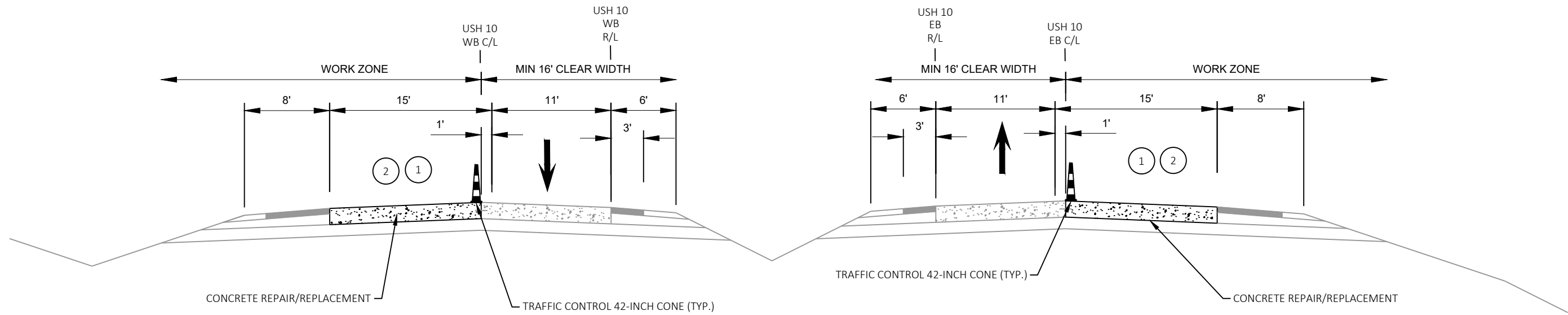

**STAGE 3A TYPICAL SECTION USH 10**

WORK ON USH 10 OUTSIDE LANES:  
CONCRETE PAVEMENT REPAIR/REPLACEMENT  
CONCRETE APPROACH SLAB

① LANE CLOSURE SHOWN, PLACE TRAFFIC CONTROL DRUMS OUTSIDE OF SHOULDER WHILE LANE IS OPEN TO TRAFFIC

② TRAFFIC CONTROL DRUMS TO REMAIN ON WORK ZONE SIDE OF LANE LINE EXCEPT FOR WHEN ADJACENT PAVEMENT PATCH IS BEING REMOVED AND POURED BACK THEN CAN BE MOVED OVER LANE LINE AND RETURNED ONCE CONCRETE PAVEMENT IS COMPLETE.

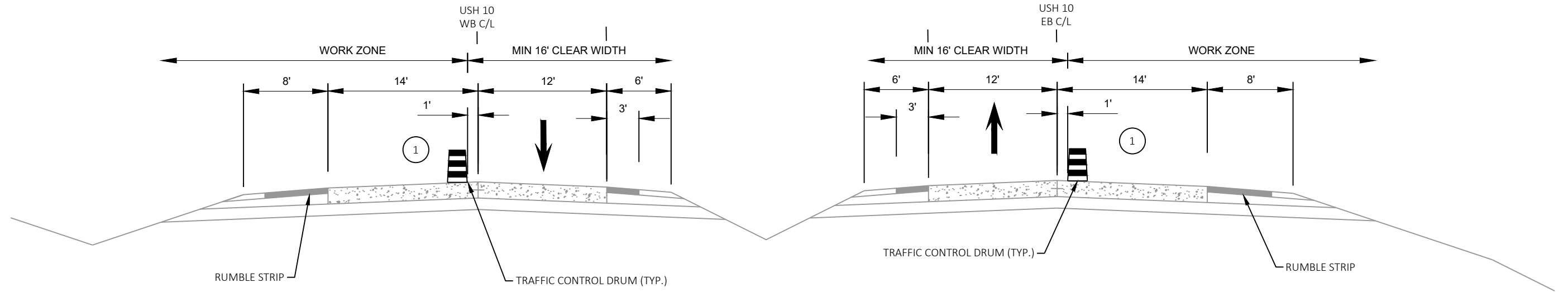

**STAGE 3B TYPICAL SECTION USH 10**

WORK ON USH 10 OUTSIDE LANES:  
CRACK SEAL  
RUMBLE STRIP  
BEAM GUARD  
PAVEMENT MARKING

① LANE CLOSURE SHOWN, PLACE TRAFFIC CONTROL DRUMS OUTSIDE OF SHOULDER WHILE LANE IS OPEN TO TRAFFIC