

# Public Involvement Handout

**US 8  
WIS 55 South to WIS 32 South  
Monico - Laona**

**Project ID: 1590-18-01**

**US 8 Shared-use Pathway: Phase 1  
Fire Keeper Road to Love Knot Lane**

**Project ID: 9813-02-00**



**6 p.m.  
Tuesday, Jan. 31, 2023  
Forest County Potawatomi Museum and Cultural Center  
8130 Mish Ko Swen Drive  
Crandon, WI 54520**

Deaf, hard-of-hearing, deaf-blind and speech-disabled persons should contact Wisconsin Relay for assistance by dialing 711.

## Purpose

The intent of this meeting is to provide an update on the Wisconsin Department of Transportation's (WisDOT's) planned improvement projects along US 8 in Forest County. The meeting will have a presentation, and all attendees are encouraged to ask questions and provide comments on the improvement project. Our objective is to obtain your input on the identified needs, proposed improvements and real estate needs along US 8.

## Project Information

We are proposing to improve 11.3 miles of US 8 from the WIS 55 South intersection to WIS 32 South Intersection.

The primary purpose of this project is to extend the service life of the roadway as well as improve substandard cable guard and guardrail installations, improve stormwater drainage, address safety concerns and substandard sidewalk curb ramps in the city of Crandon, and provide non-motorized travel accommodations within the corridor.

The need for the project is to improve roadway deficiencies.

- The existing US 8 roadway surface is showing signs of distress including alligator cracking, rutting and longitudinal and transverse cracking with the pavement condition expected to be at a poor level by 2025.
- The existing cable guard and guardrail installations throughout the project corridor are outdated and do not meet current design standards.
- Several culverts along the corridor are deteriorating.
- The existing intersections of Youngs Lane and Kwe Da Kik Lane with US 8 have intersection sight distance concerns.
- Curb ramps in the city of Crandon do not meet Americans With Disabilities Act standards.
- Off-road biking and walking facilities are non-existent.
- **The segment of US 8 between Wildwood Avenue and Grandview Avenue has experienced a significant number of crashes.**

Proposed improvements consist of:

- Resurfacing US 8 in all areas outside spot improvement areas near Kwe Da Kik Lane and Youngs Lane.
- Lowering the profiles of US 8 and Youngs Lane where they intersect to meet current design standards.
- Shifting the horizontal alignment of US 8 at its intersection with Kwe Da Kik Lane to the north to provide intersection sight distances that meet current design standards and extend the existing box culvert in this area.
- Removing and replacing several existing culverts throughout the corridor.
- Removing cable guard throughout the corridor and grade standard slopes in these areas. The existing cable guard near Silver Lake will remain in place.
- Constructing a new multi-modal underpass that will accommodate bicycles, pedestrians and ATVs/UTVs.
- **Reconfiguring US 8 lanes between Wildwood and Grandview Avenue to a two-lane roadway with a two-way left turn lane to improve safety. This improvement leads to a removal of the auxiliary lane on US 8 from Grandview Avenue to High View Drive.**
- **Improve intersection sight distance at Grandview Avenue by removing vegetation/trees and excavation east of the intersection.**

The project will also include a multi-use path that is being designed by Forest County Potawatomi Community from Fire Keepers Road to Love Knot Lane.

Future corridor Projects include:

A. Wisconsin Department of Transportation

- The existing US 8 structure over the Rat River is planned to be replaced.

B. Forest County Potawatomi

- Plan to expand the multi-use path from the City of Crandon to Otter Creek Road.

*Note: Removal of the US 8 auxiliary lane from Grandview Avenue to High View Drive is not necessary for construction of a multi-use path.*

Based on the scope of work, the project is not anticipated to impact any historical or archaeological property sites. The environmental document will be drafted in Spring of 2023.

# Project Location Map

Design Project ID: 1590-18-01  
Monico - Laona  
WIS 55 South to WIS 32 South  
US 8  
Forest County



Project Location  
Forest County



Coordination with Multi-Use Path  
under Project 9813-02-00

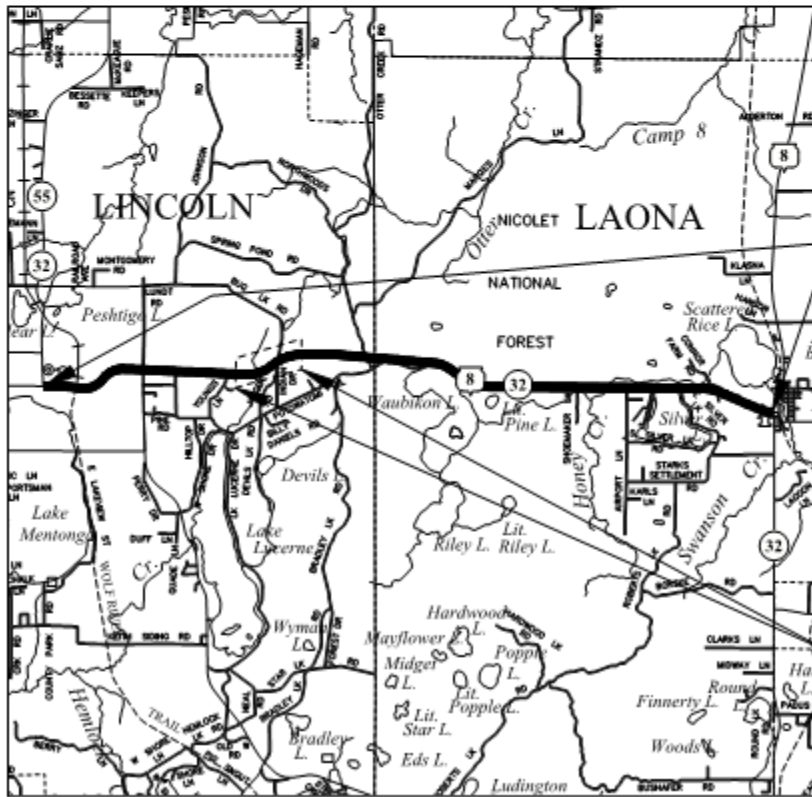

Project 1590-18-01

Project 9813-02-00

Map Not  
To Scale

## Proposed traffic impacts

Construction is currently scheduled to begin in 2025, with completion that fall.

During construction, US 8 is anticipated to be detoured for the spot improvements in the vicinity of Youngs Lane and Kwe Da Kik Lane. The proposed detour route will be WIS 32 to WIS 64 to WIS 55 and will be in place for approximately 5 months. Access to local residents and emergency responders will be maintained at all times. Single-lane closures with flagging operations will facilitate the rest of the construction operations. Temporary driveway closures will be necessary during parts of the construction process. WisDOT will contact homeowners and businesses in advance before closing a driveway.

## Real estate

Additional right of way will be required for this project to:

- Install sidewalk curb ramps in Crandon that meet current design standards
- Improve geometrics on US 8 between Fire Keeper Road and Bug Lake Road
- Extend the slopes to current standards in areas where cable barrier is removed

Preliminary right-of-way impacts are shown on the exhibits. WisDOT expects to begin real estate acquisition in May of 2023.

## Forest County Land Impacts

In order to construct the widened slopes in the areas of removal of cable guard between Bug Lake Road and just east of Otter Creek Road right-of-way will be required. Therefore, impacts are anticipated to recreational lands owned by Forest County. Impacts can be found at the following locations:

- **Approximately .80 miles west of Otter Creek Rd.**  
Forest County Forest Land is located within the project area. This area of the parcel is passively managed and intended to protect the existing forest and is part of the Otter Creek Recreational Area. This parcel of land is open to the public for passive recreation. An easement or acquisition will be required to complete grading and upgrade side slopes to standards. This project will require approximately .047 acres of permanent easement or fee from Forest County.
- **Approximately .10 miles west of Otter Creek Rd.**  
Forest County Forest Land is located within the project area. This area of the parcel is passively managed and intended to protect the existing forest. This parcel of land is open to the public for recreation, including multi-use trails, and contains the Otter Creek Recreational Area. A single-track bike trail will be impacted with the widening of the slopes in this area. In correspondence with the Forest County Forestry Department and the Forest County Area Singletrack Association (FCASA) the trail will be re-located by the FCASA after construction in the area. An easement or acquisition will be required to complete grading and upgrade side slopes to standards. This project will require approximately .511 acres of permanent easement or fee from Forest County.
- **The Northeast Quadrant of Otter Creek Rd. and US 8**  
Forest County Forest Land is located within the project area. This area of the parcel is passively managed and intended to protect the existing forest and is part of the Otter Creek Recreational Area. This parcel of land is open to the public for passive recreation. An easement or acquisition will be required to complete grading and upgrade side

slopes to standards. This project will require approximately .179 acres of permanent easement or fee from Forest County.

This project is not expected to have an adverse effect on the activities, features and functions of the Forest County parcels.

## Project update/next steps

Local officials meeting #2	Jan. 12, 2023
Public involvement meeting #2	Jan. 31, 2023
Preliminary plans	Mar. 2023
Environmental document	Apr. 2023
Final right-of-way plat	May 2023
Real estate negotiations	May 2023 to Sept. 2024
Final plans	Nov. 1, 2024
Construction currently scheduled	2025

## Public input/comments

Your comments assist us in developing a project that will serve the needs of the traveling public as well as the needs of the local community. Your input is welcome and appreciated throughout the design process.

There are several ways to submit your input by Feb. 15, 2023:

1. Fill out the comment form attached to this handout and mail it to WisDOT.
2. Send comments or questions to WisDOT Project Manager Stacy Hagenbucher at:
  - [Stacy.Hagenbucher@dot.wi.gov](mailto:Stacy.Hagenbucher@dot.wi.gov)
  - Wisconsin Department of Transportation  
Attn.: Stacy Hagenbucher  
510 N. Hanson Lake Road  
Rhineland, WI 54501

Deaf, hard-of-hearing, deaf-blind, and speech-disabled persons should contact the Wisconsin Relay Service by dialing 711.

# Public Involvement Comment Form

Project ID 1590-18-01 & 9813-02-00  
Monico - Laona  
WIS 55 South to WIS 32 South  
US 8  
Forest County

Please mail by **Feb. 15, 2023** to the address on the back of this sheet. Comments can also be emailed to [Stacy.Hagenbucher@dot.wi.gov](mailto:Stacy.Hagenbucher@dot.wi.gov). Your comments assist us in developing a project that will serve the needs of the traveling public as well as the needs of the local community. Your input is welcome and appreciated throughout the design process.

Name: \_\_\_\_\_

Address: \_\_\_\_\_

Phone Number (optional): \_\_\_\_\_

Email Address (optional): \_\_\_\_\_

Please Print Comments (attach additional sheets if necessary)

---

---

---

---

---

---

---

---

---

---

---

---

---

---

---

---

---

---

---

---

---

---

---

---

---

*The information in this document including names, addresses, phone numbers, email addresses and signatures is not confidential, and may be subject to disclosure upon request, pursuant to the requirements of the Wisconsin open records law, sections 19.31 - 19.39 of the Wisconsin statutes.*

Fold here

---

Place  
Stamp  
Here

Attn.: Stacy Hagenbucher, P.E.  
WisDOT North Central Region - Rhinelander  
510 N. Hanson Lake Road  
Rhinelander, WI 54501

---

To mail, fold here and tape.