

Project Handout

**Chippewa County
WIS 27
Cornell to Ladysmith
350 Feet East of South 8th Street to Rusk County Line**

Project ID: 8180-00-02 (72)



December 2025/January 2026

Purpose of the outreach

The objective of this outreach is to obtain public input on the identified needs, real estate needs and the proposed improvements and traffic impacts related to this project on WIS 27 in Chippewa County.

Project information

The Wisconsin Department of Transportation (WisDOT) is proposing to improve approximately 10.3 miles of WIS 27 in Chippewa County. The WIS 27 project begins approximately 350 feet east of the intersection of South 8th Street in the city of Cornell and ends at the Chippewa/Rusk County line. Within the project limits, WIS 27 is a two-lane undivided highway.

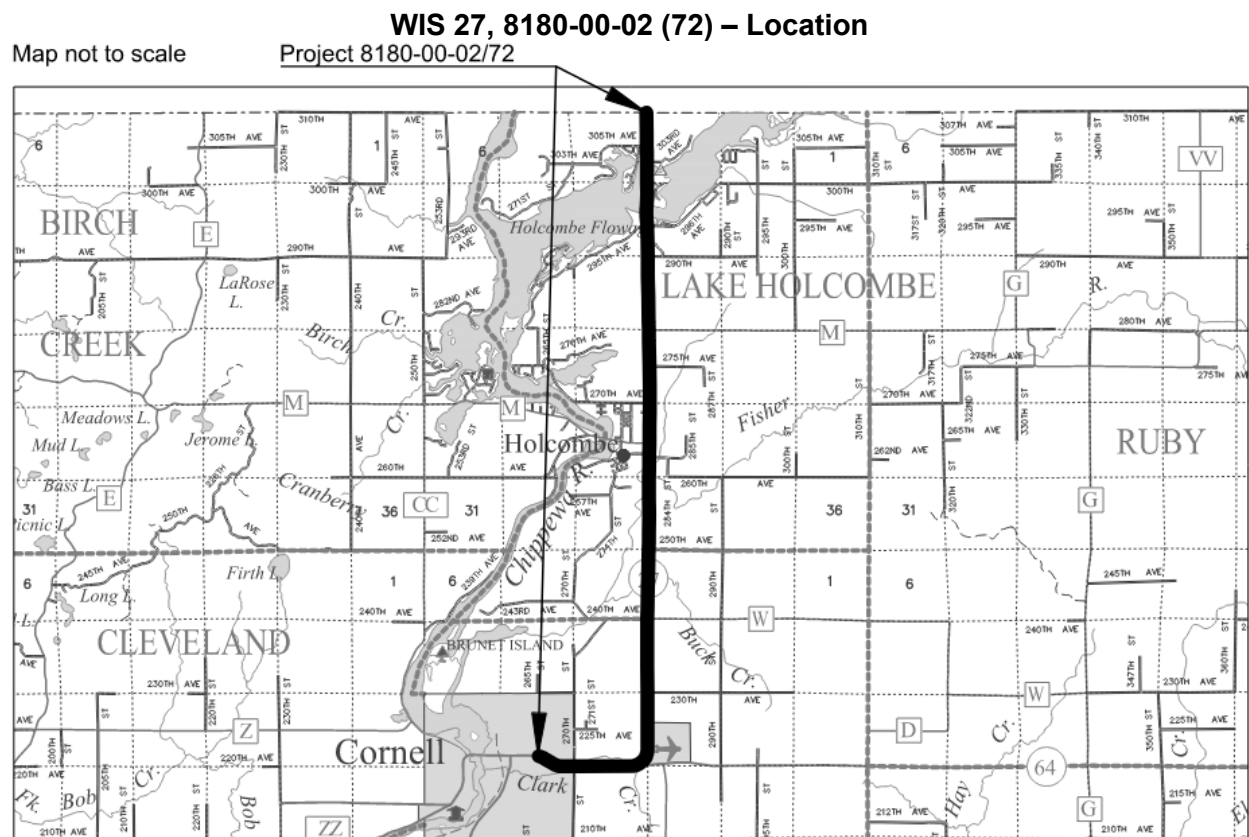

WisDOT has identified several needs along this section of WIS 27, including:

- The existing pavement is showing signs of deterioration including alligator, edge, longitudinal and transverse cracking and rutting.
- The existing culvert pipes under WIS 27 are showing signs of deterioration including corrosion, joint separation, damaged or missing end walls, accumulated sediment and overgrown ditches.
- The existing guardrail is outdated and doesn't meet current design standards.
- The existing culvert structure carrying Buck Creek under the highway is experiencing corrosion of the culvert barrel and cracking and spalling of the concrete headwalls.



Proposed improvements include:

- Resurfacing the existing asphaltic pavement with multiple resurfacing treatments
 - Milling the surface layer of existing asphaltic pavement and overlaying the roadway with multiple new layers of hot-mix asphalt (HMA) pavement
 - Milling the surface layer of existing asphaltic pavement, recycling the remaining existing asphaltic pavement and overlaying recycled pavement with multiple new layers of HMA pavement
- Replacing, repairing or cleaning culverts
- Completing the following at Buck Creek culvert (C-09-30):
 - Replacing existing culvert structure with a proposed box culvert structure
 - Constructing a single-lane temporary bypass road and structure for maintaining traffic and removing both after culvert replacement
 - Reconstructing the roadway at the structure replacement location
- Replacing guardrail and grading side slopes to meet current design standards
- Placing a polymer overlay over the decks of bridges over the Holcombe Flowage (B-09-273) and the Fisher River (B-09-274)
- Installing centerline and shoulder rumble strips for the total length of the project
- Placing new pavement markings
- Completing the following work at the wayside and boat landing on the east side of WIS 27 near the Holcombe Flowage:
 - Resurfacing the pavement
 - Replacing the concrete boat ramp
 - Repairing the dock
 - Abandoning a well

Proposed traffic impacts

During construction, the public can expect the roadway to remain open to through traffic. Motorists can expect to encounter daily flagging operations and single-lane closures on WIS 27 during pavement resurfacing operations, guardrail replacement and most culvert work. A moving flagging operation will be used during milling, pavement recycling and asphalt paving operations as traffic will be limited to one lane within the moving work zone. Additional flaggers will be provided at intersecting roadways when the work zone encompasses an intersection or multiple intersections.

WIS 27 will remain open to a single lane of traffic during replacement of the culvert at Buck Creek and placement of the polymer overlays on the decks of the bridges over the Holcombe Flowage and Fisher River. Traffic will be controlled by temporary signals, signing and pavement markings. A single-lane, temporary bypass road and structure will be constructed to the west of the existing C-09-30 culvert structure to maintain traffic on WIS 27. Temporary precast concrete barrier wall and traffic control drums will be included to protect the work zone at Buck Creek. Traffic control drums will be included to protect the work zone at the bridges over Holcombe Flowage and Fisher River.

Access to business and residential driveways will be maintained. However, single driveways will be temporarily closed for short periods of time when the milling, pavement recycling and asphalt paving operations are in the immediate vicinity of the driveway. When multiple driveways serve a single property, the construction will be staged, so at least one of the driveways remains open. Coordination will be completed with property owners and businesses along WIS 27 to inform them of impending construction.

Construction is currently anticipated to begin in the spring of 2028.

Real estate

Additional right of way will need to be acquired by WisDOT to facilitate the proposed guardrail improvements and replacement of C-09-30 culvert structure. Project representatives will contact the affected property owners once the final right-of-way needs are determined. The real estate acquisition process is anticipated to be completed during 2026 and 2027.

Project update/next steps

Public Involvement comment period	December 2025/January 2026
Environmental document	January 2026
Preliminary plans	Winter 2026
Transportation project plat	May 2026
Final plans	Nov. 1, 2027
Construction currently scheduled	Spring/Summer/Fall 2028

Project ID: 8180-00-02 (72)

Title: Cornell - Ladysmith

County: Chippewa

December 2025/January 2026

Name: _____

Address:

Daytime Phone Number (optional):

Email Address (optional): _____

Please Print Comments (attach additional sheets if necessary)

This image shows a blank sheet of white paper with horizontal ruling lines. The lines are evenly spaced and run across the width of the page. There are no margins, text, or other markings on the paper.

The information in this document including names, addresses, phone numbers, email addresses and signatures is not confidential, and may be subject to disclosure upon request, pursuant to the requirements of the Wisconsin open records law, sections 19.31 - 19.39 of the Wisconsin statutes.

Fold here

[*Stamp*]

Wisconsin Department of Transportation

718 W. Clairemont Ave.

Eau Claire, WI 54701

Attn.: Nick Pitsch

Fold here to mail