



PUBLIC INVOLVEMENT MEETING

WIS 181 IMPROVEMENTS | Wisconsin Avenue – Center Street



Thank you for attending the first Public Involvement Meeting (PIM) for the WIS 181 Improvements project. The project, led by WisDOT and the City of Wauwatosa, will enhance safety, accessibility, and infrastructure reliability from Wisconsin Avenue to Center Street.

This open-house meeting provides an opportunity to learn about the corridor, review exhibits, and share feedback directly with the project team. See page 4 for more details on getting involved.

CORRIDOR OVERVIEW:

The corridor covers the Village area, schools, and adjacent neighborhoods, connecting major destinations such as Wauwatosa East High School, Longfellow Middle School, the Village Center, and numerous local churches and businesses.

PROJECT PURPOSE & NEED:

The project aims to modernize infrastructure, enhance safety, and improve mobility while respecting the community's character. Planned corridor-wide upgrades include:



Updated pavement



Harmonee Bridge rehabilitation



Updated drainage & utilities



Improved lighting



Modern traffic signals with upgraded timing



Improvements to accessibility



Improved bike & pedestrian accommodations

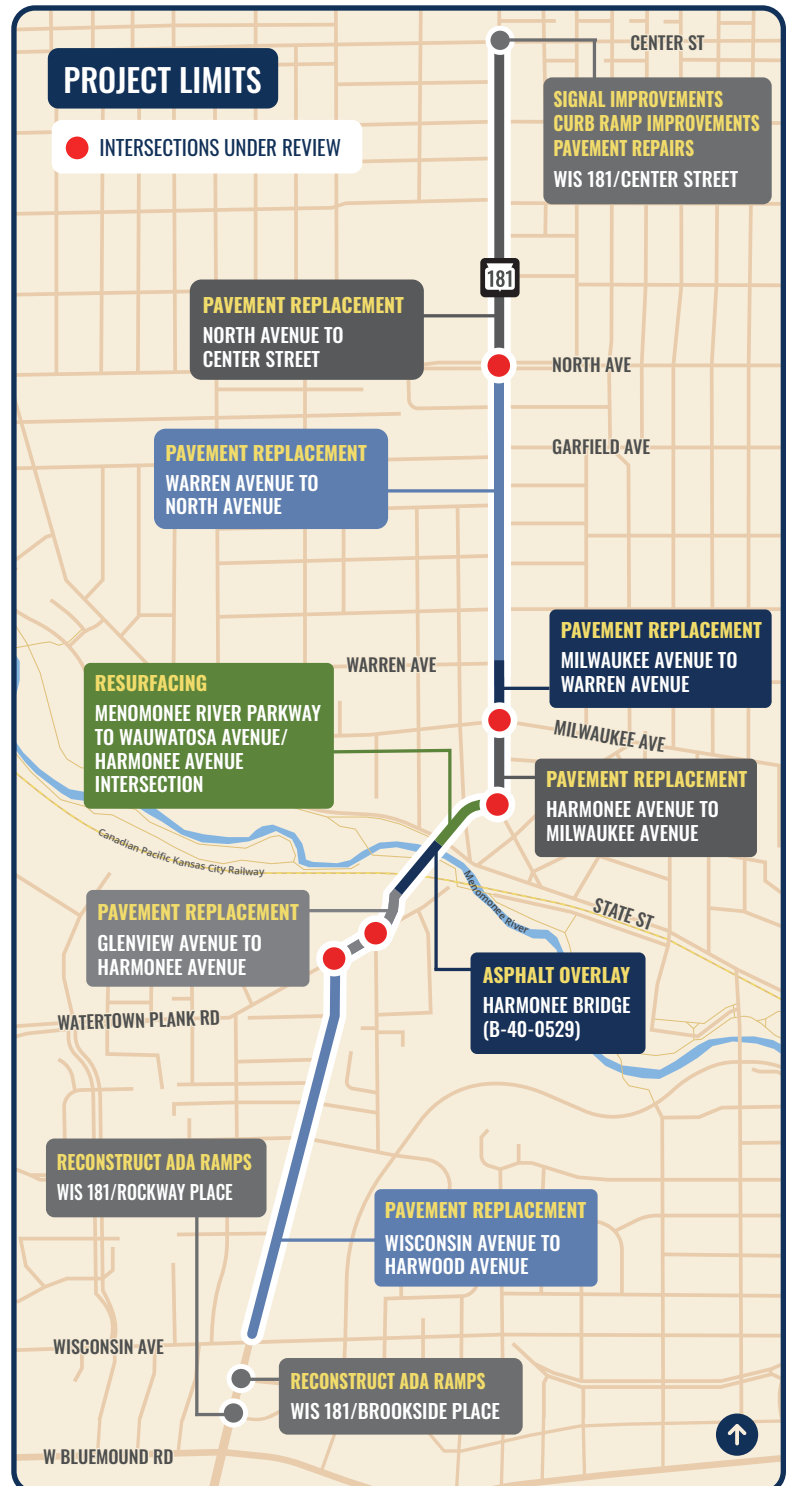



SEGMENT HIGHLIGHTS

- **Wisconsin Avenue → Harwood Avenue**
Adds bike lanes, removes west-side parking
- **Glenview Avenue → Harmonee Avenue**
Widen outside lanes from 9 feet to 10 feet by reducing gutter from 2-foot typical to 1-foot
- **Harmonee Bridge**
Widen south sidewalk from 5 feet to 6 feet
- **Menomonee River Parkway → Wauwatosa Avenue**
Maintains width to Underwood Avenue; widen 1-foot from Underwood Avenue to Wauwatosa Avenue
- **Harmonee Avenue → Milwaukee Avenue**
Widen some lanes from 9 feet to 10 feet; adjust the width of the terraces and sidewalks for overall consistency.
- **Milwaukee Avenue → Warren Avenue**
Widen lanes to 11 feet with dedicated southbound right and left turn lanes
- **Warren Avenue → North Avenue**
Widen lanes from 10 feet to 11 feet and narrow bike lanes from 7 feet to 6 feet
- **North Avenue → Center Street**
Narrows roadway; adds separated bike lanes; removes parking from west-side

INTERSECTION IMPROVEMENTS:

WisDOT and the City of Wauwatosa are studying five major intersections to balance safety, accessibility, and traffic flow.

GLENVIEW AVENUE & HARWOOD AVENUE

Realigned to form a true four-way intersection at Glenview Place.

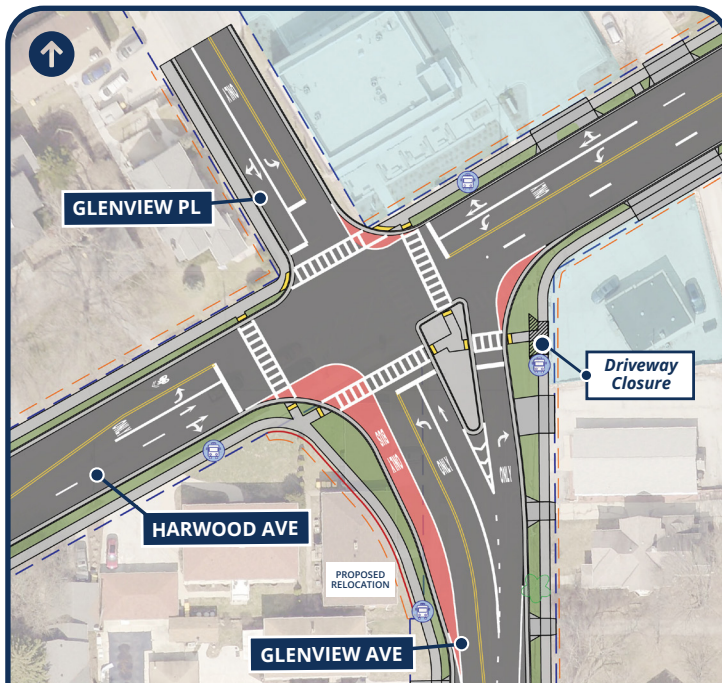

ALTERNATIVE 1: With right-turn slip lane
Provides opportunity to reduce signal timing for pedestrians

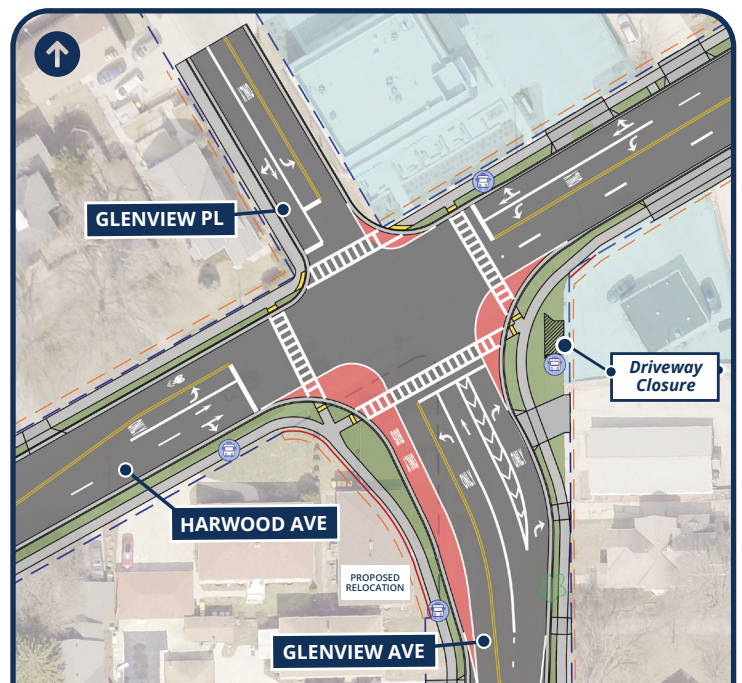

ALTERNATIVE 2: Without slip lane

HARWOOD AVENUE TO MILWAUKEE AVENUE



HARWOOD AVENUE & HARMONEE AVENUE

Proposed changes include a new eastbound lane configuration & a longer southbound left-turn lane to improve traffic flow.



HARMONEE AVENUE & WAUWATOSA AVENUE

Safer intersection design with better operations.

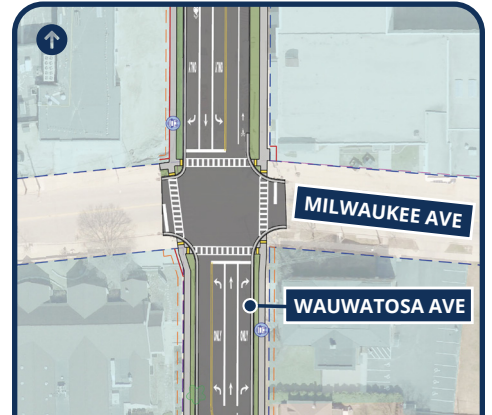

WAUWATOSA AVENUE & MILWAUKEE AVENUE

Improved crossings and more consistent traffic flow.

WAUWATOSA AVENUE & NORTH AVENUE

Two concepts reflect different design priorities:

Both concepts provide extended left turn lanes, offset opposing left turn lanes, and an option for an improved drop-off area at Longfellow Middle School.

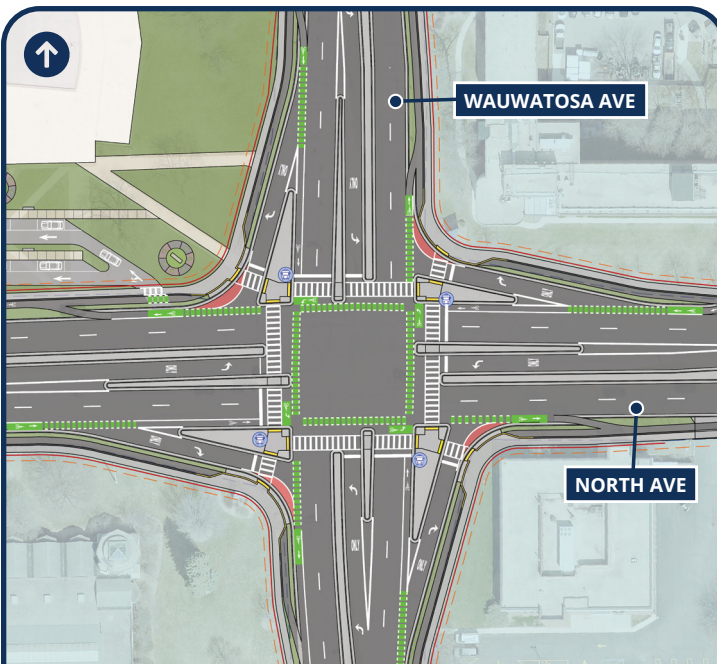

ALTERNATIVE 1: With right-turn slip lanes

Closer to the existing layout with additional improvements

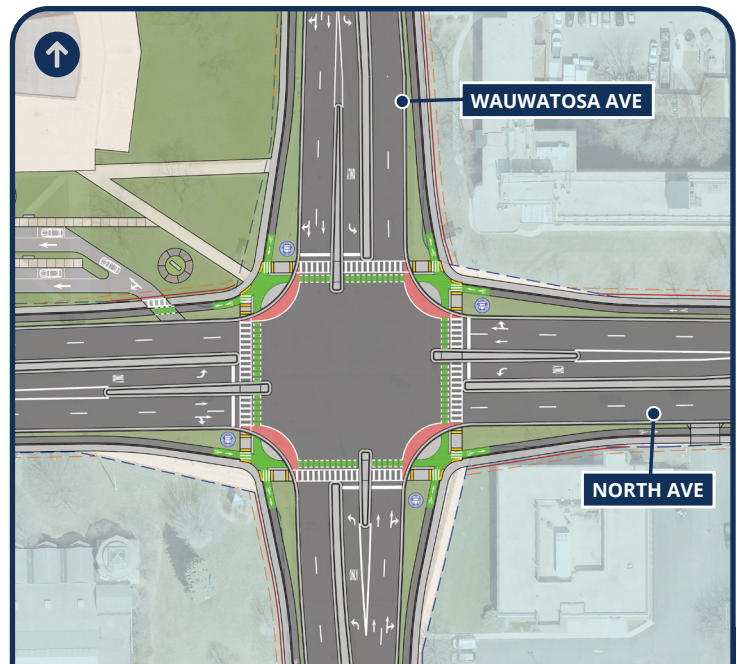

ALTERNATIVE 2: Protected Intersection

Removes slip lanes; fewer conflicts; increased delay at peak hours.



PUBLIC INVOLVEMENT MEETING

WIS 181 IMPROVEMENTS | Wisconsin Avenue – Center Street



PROJECT SCHEDULE

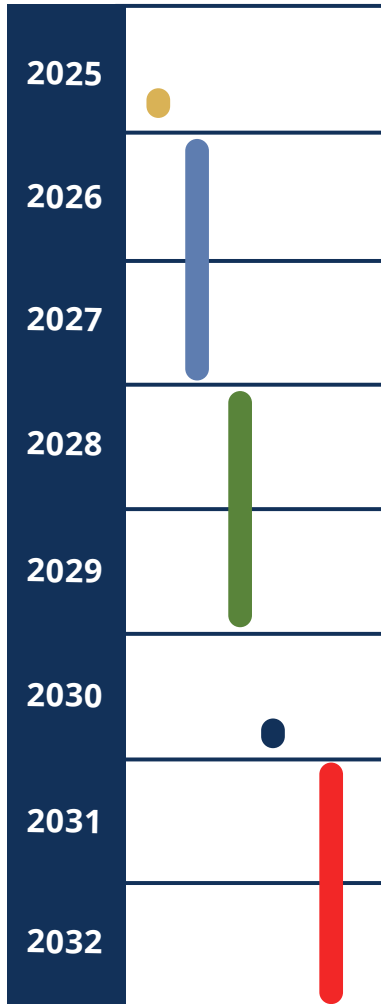

- November 19, 2025**
PIM #1 (open house)
- Refine Alternatives & Environmental Document (NEPA)**
- Right-of-Way Acquisition & Final Design**
- Letting**
- Construction** (anticipated completion 2032)

Construction could start in 2030 if funding is available.

STAY INVOLVED



We look forward to your feedback! Please provide comments by December 20, 2025.

- Submit comment forms by mail:
Wisconsin Department of Transportation
Southeast Transportation Region
141 NW Barstow St, Suite 218
Waukesha, WI 53188-3789
ATTN: Douglas Cain

ENGAGE WAUWATOSA:



- Or submit online via the Social Pinpoint interactive map at the QR code above or engage.wauwatosa.net

STEPS:

1. Select "Add Marker"
2. Drop a pin
3. Add comments
4. Click Submit

CONTACT

Jeni Schroeder, PE
City of Wauwatosa Project Manager
jschroeder@wauwatosa.net
(414) 479-3544

Doug Cain, PE
WisDOT Project Manager
douglas.cain@dot.wi.gov
(262) 548-5603

CITY SPECIAL ASSESSMENT:

The WIS 181 project is classified as a Type A road reconstruction project by the City of Wauwatosa. As such, property owners whose parcels connect with the roadway will share in the cost of the improvements through a special assessment.

A public hearing will be held before special assessments are adopted and payment options will be available. For more information on the assessment process, visit the City's special assessments webpage at bit.ly/3LI2j0R