



# Wisconsin Department of Transportation

May 16, 2019

## Division of Transportation Systems Development

Bureau of Project Development  
4822 Madison Yards Way, 4<sup>th</sup> Floor South  
Madison, WI 53705

Telephone: (608) 266-1631  
Facsimile (FAX): (608) 266-8459

### NOTICE TO ALL CONTRACTORS:

- Proposal #51:**
- |  |  |
|--|--|
| <p><b>1060-33-94, WISC 2019 219</b><br/> <b>Zoo IC, Swan &amp; Discovery Rndabt</b><br/> <b>1060-33-73 Limits to WDNR</b><br/> <b>Access Rd</b><br/> <b>Local Street</b><br/> <b>Milwaukee County</b></p> <p><b>1693-37-74, WISC2019 433</b><br/> <b>Bike Path B – Hank Aaron</b><br/> <b>State Trail</b><br/> <b>Hwy 100 to UPRR</b><br/> <b>Non Highway</b><br/> <b>Milwaukee County</b></p> | <p><b>1060-35-94</b><br/> <b>Zoo IC, Swan Blvd Roadway Maint</b><br/> <b>Underwood Parkway to USH 45</b><br/> <b>Local Street</b><br/> <b>Milwaukee County</b></p> |
|--|--|

### Letting of May 21, 2019

This is Addendum No. 01, which provides for the following:

#### Special Provisions:

<b>Revised Special Provisions</b>	
Article No.	Description
3	Prosecution and Progress
6	Utilities

#### Plan Sheets:

<b>Revised Plan Sheets – Project ID 1060-33-94</b>	
Plan Sheet	Plan Sheet Title (brief description of changes to sheet)
82	Lighting Plan – 3 of 8 of 023701_lp (added Pull Boxes and Electrical Wire)
85	Lighting Plan – 6 of 8 of 023701_lp (added Pull Boxes and Electrical Wire)

<b>Added Plan Sheets – Project ID 1060-33-94</b>	
Plan Sheet	Plan Sheet Title (brief description of why sheet was added)
52A	Backfill Slurry detail for storm sewer (omitted from plan set)
141A	Miscellaneous Quantities - added Pull Boxes and Electrical Wire

<b>Revised Plan Sheets – Project ID 1693-37-74</b>	
Plan Sheet	Plan Sheet Title (brief description of changes to sheet)
2	General Notes and Utility Contacts (updated utility contacts)
32	Permanent Signing Quantities (additional signs listed)
73	Signing Detail – Type II Signs (sign color clarification added for first two signs)

<b>Added Plan Sheets – Project ID 1693-37-74</b>	
Plan Sheet	Plan Sheet Title (brief description of why sheet was added)
17A-F	Permanent Signing (new signs added to contract)
32A	Permanent Signing Quantities (second sheet needed due to additional signs)
73A-B	Permanent Signing Details (new signs added to contract)

The responsibility for notifying potential subcontractors and suppliers of these changes remains with the prime contractor.

Sincerely,

*Mike Coleman*

Proposal Development Specialist  
Proposal Management Section

**ADDENDUM NO. 01**

**1060-33-94 / 1060-35-94 / 1693-37-74**

**May 16, 2019**

**Special Provisions**

**3. Prosecution and Progress.**

*Delete the following paragraph:*

Do not work next to wetlands on project 1060-33-94 until the Section 404 permit has been approved. The department anticipates approval of this permit Apr11 2019.

**6. Utilities.**

*Replace the entire article with the following:*

This contract comes under the provisions of Administrative Rule TRANS 220.

Additional information regarding recently relocated utility facilities may be available on permits issued to the utility companies. These permits can be viewed at the Region Office during normal working hours. Contact WisDOT SE Freeways Utility Coordinator Greg Berry at (414) 750-7828 for further information.

Underground and overhead utility facilities are located within the project limits. Utility adjustments are required for this construction project as noted below. Coordinate construction activities with a call to Diggers Hotline or a direct call to the utilities that have facilities in the area as required per state statute. Use caution to ensure the integrity of underground facilities and maintain code clearances from overhead facilities at all times.

Some utility work, as described below, is dependent on prior work being performed by the contractor at a specific site. Provide the engineer and the affected utility a good faith notice of when the utility is to start work at the site. Notice shall be given 14 to 16 calendar days in advance of when the site will be available to the utility. Follow up with a confirmation notice to the engineer and the utility not less than 3 working days before the site will be ready for the utility to begin its work.

Contact utility companies listed in the plans prior to preparing bids to obtain current information on existing utility locations and the status of any new utility relocation work.

Utility companies will be performing utility work and adjustments within the limits during the life of the project. The contractor shall cooperate and coordinate construction activities with these companies.

There may be discontinued utility facilities within the project limits. If a conflict with a discontinued utility facility is encountered, contact the appropriate utility owner/representative to coordinate construction activities and proper removal and disposal of said facility as necessary.

Utility working days shown herein are as defined in Wisconsin Administrative Code Chapter Trans 220.

Known utilities in the project area are as follows:

**Project ID 1060-33-94**

**AT&T Wisconsin** has existing underground and overhead communications facilities within the project limits. Prior to and during construction AT&T Wisconsin will perform the following work:

- Install a new pedestal at STA 193 + 50BV, 47' LT.
- Intercept the existing cable at the new pedestal at STA 193 + 50BV, 47' LT, then install a new cable 2 ft south of the ROW of Swan Blvd from STA 193+50BV, 47' LT to STA 202BV + 90, 100' LT.
- Install a new pedestal at STA 31SB + 78, 54' LT.
- Install new cable from the pedestal at STA 31SB + 78, 54' LT south to STA 27+ 70NB, 65' LT.
- Install cable to existing pedestal in easement defined in 1060-33-27 RWP STA 27 + 68, 65.5' LT to STA 32 + 10, 90' LT.
- AT&T to transfer to new cable and discontinue the existing copper cable and IPP.

It is anticipated that work will begin June 2019. Estimated construction time to complete the work is 45 working days.

Contact Jay C Bulanek (262- 896-7669 office / 414-491-2855 cell) of AT&T Wisconsin 7 days in advance to coordinate locations and any excavation near their facilities.

**Charter Communications** has existing communications facilities within the project limits. No conflicts are anticipated.

Contact Scott Dietrich (414-277-4283) of Charter Communications 7 days in advance to coordinate locations and any excavation near their communications facilities.

**City of Wauwatosa – Street Lighting** has existing facilities within the project limits. Street Lighting installation will be completed under project pay items by the contractor during construction.

Contact Randy Michelz (414-471-8429) of the City of Wauwatosa 7 days in advance to coordinate locations and any excavation near their communications facilities.

**City of Wauwatosa - Water** has existing facilities within the project limits. Water utility relocations will be completed under project pay items by the contractor during construction.

Contact Adam Florin (414-471-8480, ext. 5915) of the City of Wauwatosa 7 days in advance to coordinate locations and any excavation near their communications facilities.

**We Energies – Electric** has existing overhead and underground electric facilities within the project limits. Prior to and During construction We Energies will be removing all overhead facilities in the project area, and replacing it with new underground lines:

- Install new cable along the north side of Swan Blvd from STA 195BV LT40 in easement to STA 202BVWB+25 LT64', cross Swan Blvd and splice into the existing cable along Discovery Parkway at STA 29SB+62 LT39'.
- Intercept existing cable in Discovery Parkway at STA 29SB+77 LT 31', install new crossing Discovery Pkwy to the east, continue along the south side of Swan Blvd to the existing VFI at STA 210BV RT 60'.
- Pole Removals:

Station	Pole No	Work Proposed
191BV+45 RT 71'	06-03596	Pole and down anchors to be removed
194BV+13 RT 48'	06-03595	Pole and down anchors to be removed
196BV+22 RT 64'	06-03597	Pole to be removed
198BV+05 RT 63'	06-02607	Pole to be removed
198BV+39 RT 63'	13-04108	Pole to be removed
200BVEB+50 RT 66'	06-02606	Pole to be removed
3C+50 LT 39'	13-04347	Pole to be removed
3C+44 LT 27'	13-04346	Pole to be removed
2C+21 LT 16'	13-08567	Pole to be removed

205BVEB+48 RT 41'	06-02608	Pole to be removed
208BV+05 RT 57'	06-02684	Pole to be removed
210BV+44 RT 55'	06-03803	Pole and down anchors to be removed

It is anticipated that work will begin June 2019. Estimated construction time to complete the work is 40 working days.

Contact Leonard Brown (414-540-5705) of We Energies 7 days in advance to coordinate locations and any excavation near their facilities.

**We Energies – Gas** has existing gas facilities within the project limits. No conflicts anticipated

Contact Nate Zilles (414-944-5664 office/ 414-651-6693 cell) of We Energies 7 days in advance to coordinate locations and any excavation near their facilities.

**Project ID 1060-35-94**

There are no known utility facilities within the project limits.

**Project ID 1693-37-74**

**AT&T Legacy (aka AT&T Corporation)** has an existing underground communications duct package within the project limits beginning beyond the easterly project limits and running northwesterly along a line 18' south and parallel to the Hank Aaron State Trail, crossing STH 100 at Station 565SS+25. It continues northwesterly to beyond the westerly project limits. This duct package consists of six 2-inch ducts. This line will remain in place without adjustment.

Contact Ken Nine (574-842-8830 office / 574-904-6336 cell) of JMC Engineers & Associates, Inc. 7 days in advance to coordinate locations and any excavation near AT&T Corporation facilities.

**AT&T Local Network (aka Teleport Communications of America (TCA))** has an existing underground communications line within the project limits beginning beyond the easterly project limits and running northwesterly along a line 18' south and parallel to the Hank Aaron State Trail, crossing STH 100 at Station 565SS+25. It continues northwesterly to beyond the westerly project limits. This line will remain in place without adjustment.

Contact Sandra Falatyk (414-459-3565 office / 414-651-6013 cell) of Northwind Technical Services 7 days in advance to coordinate locations and any excavation near TCA facilities.

**AT&T Wisconsin** has existing underground communications facilities within the project limits in the following locations:

- An existing underground communications line beginning beyond the southerly project limits and running northerly along the westerly curb line of STH 100, to a manhole at Station 562SS+17, 29' LT. From there the line turns westerly and continues beyond the westerly project limits. This line will remain in place without adjustment.
- A discontinued underground communications line beginning at a manhole at 562SS+17, 29' LT and running northerly along the westerly curb line of STH 100, crossing the Hank Aaron State Trail on the STH 100 structure and continuing to beyond the northerly project limits.

Contact Jay Bulanek (262-896-7669 office / 414-491-2855 cell) of AT&T Wisconsin 7 days in advance to coordinate locations and any excavation near their facilities.

**American Transmission Company (ATC)** has six overhead 138kV electric transmission lines beginning beyond the westerly project limits and running southeasterly along the south side of eastbound IH 94, crossing STH 100 between Station 566SS+19 and Station 568SS+00, and continuing southeasterly to beyond the

easterly project limits. These lines will remain in place without adjustment. Use caution when operating overhead equipment in this area and maintain OSHA safe working clearance to the overhead conductors at all times.

Contact Ivan Keller (262-506-6773) of American Transmission Company 7 days in advance before beginning any work within or around overhead electric transmission lines and to coordinate locations and any excavation near their facilities.

**Milwaukee Metropolitan Sewerage District (MMSD)** has existing underground sanitary sewer lines within the project limits at the following locations:

- An existing underground sanitary sewer line beginning at a manhole at Station 564SS+00, 46' RT and running easterly to a manhole at Station 564SS+01, 71' RT. From there it turns and runs northerly to a manhole at Station 566SS+56, 70' RT. It then turns easterly to a manhole at Station 566SS+67, 133' RT. It then turns northerly and continues beyond the northerly project limits. This sewer line will remain in place without adjustment. MMSD will adjust the manhole at Station 566SS+67, 133' RT during construction. Allow 2 days for MMSD to adjust the manhole during construction.
- An existing underground sanitary sewer begins at a manhole at Station 564SS+00, 46' RT running northerly to a manhole at Station 564SS+12, 46' RT. From there it turns northeasterly and connects to a sewer at Station 564SS+30, 56' RT. This sewer line will remain in place without adjustment.
- An existing underground sanitary sewer line begins beyond the westerly project limits and runs easterly, perpendicular to STH 100, crossing at Station 564SS+31, to a manhole at Station 564SS+31, 24' RT. From there it continues in an easterly direction beyond the easterly project limits. This sewer line will remain in place without adjustment.

Milwaukee Metropolitan Sewerage District also has a discontinued sanitary sewer line within the project limits beginning at a manhole at Station 566SS+56, 70' RT and running northerly along the easterly curb of STH 100 to beyond the northerly project limits.

Contact Larry Anderson (414-225-2241) of the Milwaukee Metropolitan Sewerage District 7 days in advance to coordinate locations and any excavation near their facilities. Contact Bob Rebitski (414-225-2214) of the Milwaukee Metropolitan Sewerage District 7 days in advance to coordinate manhole adjustments.

**WE Energies – Electric** has existing overhead and underground electric facilities within the project limits in the following locations:

- An underground electric line beginning beyond the southerly project limits and running northeasterly, crossing the Hank Aaron State Trail at Station 147HA+98, and continuing northeasterly to Station 147HA+98, 130'LT. From there the line runs northerly to beyond the project limits. This line will remain in place without adjustment.
- Four existing underground electric conduit packages beginning beyond the southerly project limits and running northeasterly, crossing the Hank Aaron State Trail between Stations 148HA+10 and Station 148HA+30, and continuing northeasterly to Station 148HA+10, 126'LT on the west and Station 148HA+30, 106'LT on the east. From there, the four electric conduit packages run southeasterly to beyond the project limits. These lines will remain in place without adjustment.
- An underground electric line beginning beyond the easterly project limits and running northwesterly to Station 148HA+06, 136'LT where it turns and runs northeasterly to beyond the project limits. This line will remain in place without adjustment.

Contact Nicholas Welch (414-944-5765) of We Energies 7 days in advance to coordinate locations and any excavation near their facilities.

**We Energies – Gas** has an existing 24-inch underground gas line beginning beyond the southerly project limits running northerly along a line 50' easterly of and parallel to the existing easterly curb of STH 100, to Station 564SS+00, 115' RT and continuing northeasterly to Station 564SS+82, 125' RT. From there it continues northerly to beyond the northerly project limits. This line will remain in place without adjustment.

We Energies – Gas also has a discontinued underground gas line beginning beyond the southerly project limit and running northerly along the existing easterly curb of STH 100, to Station 563SS+80, 54' RT where it turns and runs northeasterly to Station 564+33, 79' RT. From there it runs northerly to Station 566SS+15, 78' RT where it turns and runs northwesterly to Station 566SS+70, 53' RT and then turns and runs northerly to beyond the project limits. The discontinued gas main is in a steel casing pipe between Station 564SS+61 and Station 565SS+64, under the Hank Aaron State Trail.

We Energies will remove any portion of the discontinued gas main in conflict with proposed construction in locations where the gas main coating may contain hazardous material. The removal of such discontinued gas main will occur during construction. Allow We Energies 5 days for removal of any impacted portions of gas main. Contact Nick Ernster (414-944-5574) of We Energies 10 days prior to any activity that will expose the existing gas main to coordinate removal activities.

Contact Nick Ernster (414-944-5574) of We Energies 7 days in advance to coordinate locations and any excavation near their facilities.

**West Allis – Lighting** has existing underground lighting facilities beginning beyond the southerly project limits and running northerly, along the westerly curb of STH 100, to Station 561SS+70, 40' LT where it turns and runs easterly, crossing STH 100 at Station 561SS+70, and continues easterly to Station 561SS+70, 56' RT. From there it continues southerly, along the easterly curb of STH 100, to beyond the southerly project limits. These facilities will remain in place without adjustment.

Contact Peter Daniels (414-302-8374) of the City of West Allis, 7 days in advance to coordinate locations and any excavation near their facilities.

**West Allis – Sewer** has an underground sanitary sewer beginning beyond the southerly project limits and running northerly, 10' westerly of and parallel to the easterly curb of STH 100, to a manhole at Station 562SS+75, 46' RT. It continues northerly to a Milwaukee Metropolitan Sewerage District manhole at Station 564SS+00, 46' RT. These lines will remain in place without adjustment.

Contact Peter Daniels (414-302-8374) of the City of West Allis 7 days in advance to coordinate locations and any excavation near their facilities.

**Wisconsin Independent Network (WIN)** has an existing underground communications line in WisDOT Communications conduit beginning beyond the southerly project limits and running northerly along a line approximately 20' east of the easterly curb of STH 100 to Station 565SS+22, 87' RT. From there it runs northwesterly to Station 565SS+50, 74' RT and then runs northerly to Station 566SS+91, 82' RT. From there it turns and runs northeasterly to a vault at Station 567SS+12, 100' RT where it turns and runs northerly to beyond the project limits. This line will remain in place without adjustment.

Contact Jim Birkenheier (715-832-6041 office / 715-838-4007 cell) of Wisconsin Independent Network 7 days in advance to coordinate locations and any excavation near their facilities.

**WisDOT – Lighting** has existing overhead and underground lighting facilities along STH 100, along IH 94 Mainline, and along the eastbound IH 94 exit ramp to STH 100. These facilities will remain in place without adjustment.

Contact Eric Perea (262-574-5422 office / 414-750-0935 cell) of WisDOT 7 days in advance to coordinate construction, locations and any excavation near their facilities.

**WisDOT – Signals** has existing overhead and underground signal facilities within the project limits at the eastbound IH 94 exit ramp to STH 100, from Station 566SS+53 to beyond the northerly project limits. The facilities will remain in place without adjustment.

Contact Derrin Wolford of WisDOT (262-521-4409) 7 days in advance to coordinate locations and any excavation near their facilities.

**WisDOT – Communications** has existing underground traffic management and communications facilities throughout the project limits in the following locations:

- An existing underground communications line beginning beyond the southerly project limits and running northerly along a line approximately 20' east of the easterly curb of STH 100 to Station 565SS+22, 87' RT. From there it runs northwesterly to Station 565SS+50, 74' RT and then runs northerly to Station 566SS+91, 82' RT. From there it turns and runs northeasterly to a vault at Station 567SS+15, 100' RT where it turns and runs northerly to beyond the project limits. This line will remain in place without adjustment.
- A discontinued underground communications line beginning beyond the southerly project limits and running northerly in a conduit in the east parapet wall of the STH 100 bridge over the Hank Aaron State Trail to a vault at Station 566SS+14, 60' LT. From there it runs northeasterly and ends at a vault at Station 567SS+15, 100' RT.
- A discontinued underground communications line beginning at a vault at Station 566SS+14, 60' LT and running northwesterly to beyond the project limits.

Contact Jeff Madson (414-225-3723) of WisDOT 7 days in advance to coordinate construction, locations and any excavation near their facilities.

#### **Plan Sheets**

The following 8½ x 11-inch sheets are attached and made part of the plans for this proposal:

##### **1060-33-94**

Revised: 82 and 85

Added: 52A and 141A

##### **1693-37-74**

Revised: 2, 32, and 73

Added: 17A – 17F, 32A, and 73A – 73B

END OF ADDENDUM



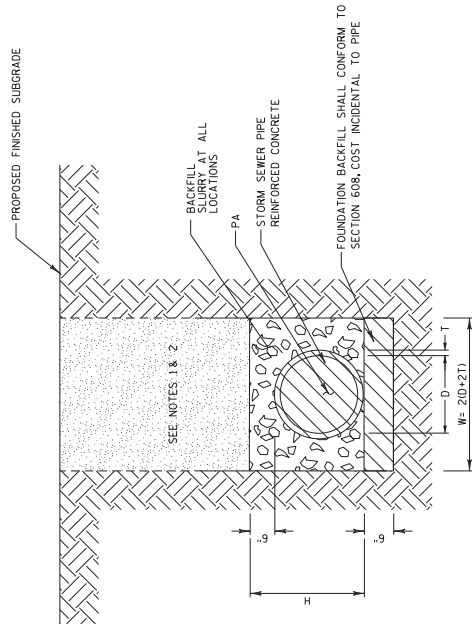

NOTES

- (1) IF THE PIPE IS OUTSIDE THE TRAVELED WAY INCLUSIVE OF SHOULDERS, NATIVE BACKFILL MAY BE USED ABOVE BACKFILL SLURRY AND SHALL CONFORM TO SECTION 209.
- (2) IF THE PIPE IS WITHIN THE TRAVELED WAY INCLUSIVE OF SHOULDERS, BACKFILL ABOVE BACKFILL SLURRY SHALL CONFORM TO SECTION 209.
- (3) WHEN TEMPORARY SUBGRADE IS HIGHER THAN PROPOSED FINISHED SUBGRADE, PROVIDE GRANULAR BACKFILL AT ALL LOCATIONS. COST FOR GRANULAR BACKFILL IS CONSIDERED INCIDENTAL TO CONSTRUCTION.
- (4) PAYMENT FOR BACKFILL SLURRY QUANTITY IS LIMITED TO THE DETAIL AS SHOWN. BACKFILL QUANTITY FOR ANY OVER EXCAVATED AREA IS CONSIDERED PART OF CONSTRUCTION, AND NO ADDITIONAL PAYMENT WILL BE MADE.

Addendum No. 01  
ID 1060-33-94  
Added Sheet 52A  
May 16, 2019

BACKFILL SLURRY DETAIL - STORM SEWER TRENCH

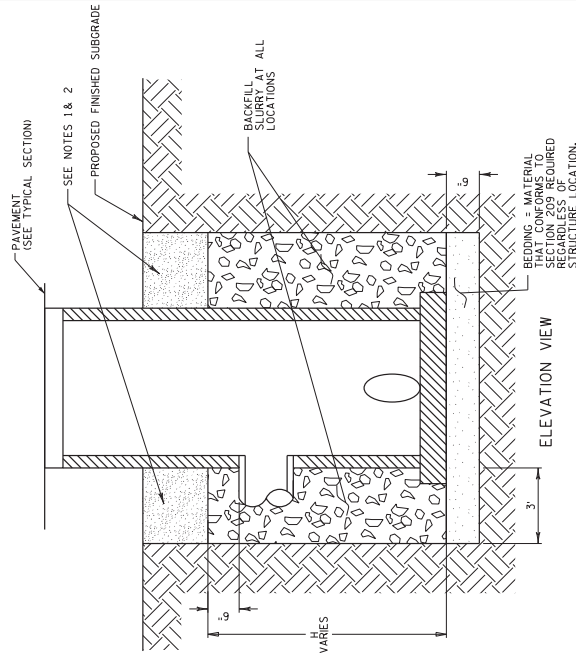

ELEVATION VIEW

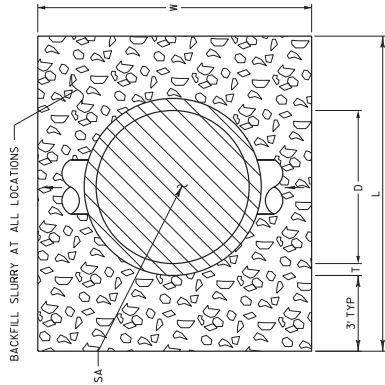

PLAN VIEW

- (1) IF THE STRUCTURE IS OUTSIDE THE TRAVELED WAY INCLUSIVE OF SHOULDERS, NATIVE BACKFILL MAY BE USED ABOVE BACKFILL SLURRY AND SHALL CONFORM TO SECTION 209.
- (2) IF THE STRUCTURE IS WITHIN THE TRAVELED WAY INCLUSIVE OF SHOULDERS, BACKFILL ABOVE BACKFILL SLURRY SHALL CONFORM TO SECTION 209.
- (3) WHEN TEMPORARY SUBGRADE IS HIGHER THAN PROPOSED FINISHED SUBGRADE, PROVIDE GRANULAR BACKFILL AT ALL LOCATIONS. COST FOR GRANULAR BACKFILL IS CONSIDERED INCIDENTAL TO CONSTRUCTION.
- (4) PAYMENT FOR BACKFILL SLURRY QUANTITY IS LIMITED TO THE DETAIL AS SHOWN. BACKFILL QUANTITY FOR ANY OVER EXCAVATED AREA IS CONSIDERED PART OF CONSTRUCTION, AND NO ADDITIONAL PAYMENT WILL BE MADE.

BACKFILL SLURRY DETAIL - STORM SEWER STRUCTURES

Addendum No. 01  
ID 1060-33-94  
Revised Sheet 82  
May 16, 2019

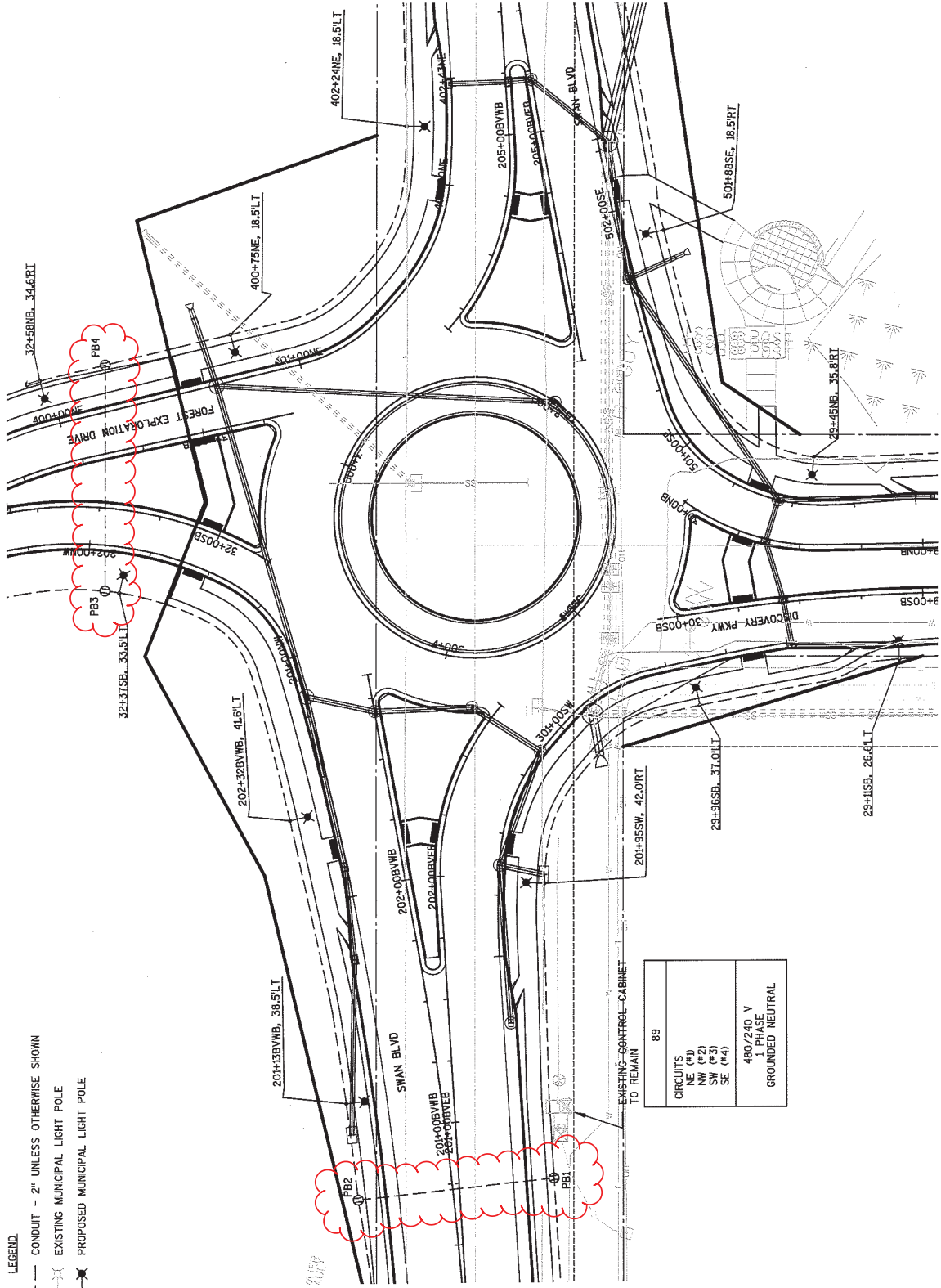

- LEGEND**
- CONDUIT - 2" UNLESS OTHERWISE SHOWN
  - x-x- EXISTING MUNICIPAL LIGHT POLE
  - o-o- PROPOSED MUNICIPAL LIGHT POLE

89	
EXISTING CONTROL CABINET TO REMAIN	
CIRCUITS	
NE (#1)	
NW (#2)	
SW (#3)	
SE (#4)	
480/240 V	
1 PHASE	
GROUNDING NEUTRAL	

Addendum No. 01  
ID 1060-33-94  
Revised Sheet 85  
May 16, 2019

- LEGEND
- CONDUIT - 2" UNLESS OTHERWISE SHOWN
  - - - - - EXISTING MUNICIPAL LIGHT POLE
  - PROPOSED MUNICIPAL LIGHT POLE

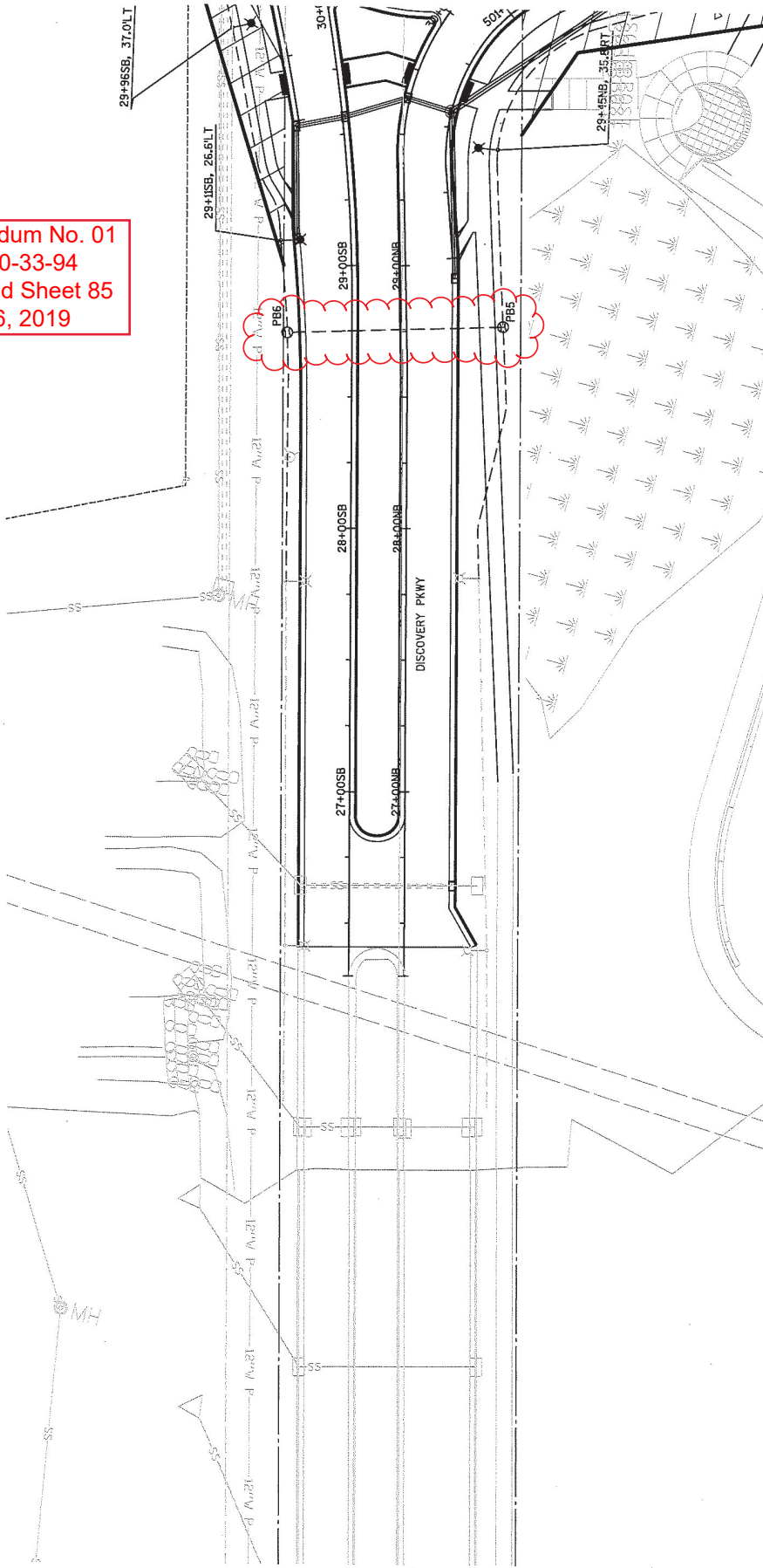

Addendum No. 01  
 ID 1060-33-94  
 Added Sheet 141A  
 May 16, 2019

CATEGORY 1100  
 LIGHTING PULL BOX QUANTITIES

653.0140 PULL BOXES STEEL 24 X 42-INCH  
 655.0615 ELECTRICAL WIRE LIGHTING 10 AWG (GROUNDING WIRE)

SYSTEM	LABEL	653.0140 PULL BOXES ELECTRICAL STEEL 24 X 42	655.0615 WIRE LIGHTING 10 AWG	COMMENTS
		EACH	LF	
89	PB1	1	20	SWAN BLVD
89	PB2	1	10	SWAN BLVD
89	PB3	1	10	FOREST EXPLORATION CENTER PKWY
89	PB4	1	30	FOREST EXPLORATION CENTER PKWY
89	PB5	1	45	DISCOVERY PKWY
89	PB6	1	25	DISCOVERY PKWY
TOTAL (0060)		6	140	

UTILITY CONTACTS

**ATC**  
MR. IVAN KELLER  
W234 N2000 RIDGEVIEW PARKWAY COURT  
WAUKESHA, WI 53187  
PHONE: (262) 506-8773  
JKELLER@ATCLLC.COM

**AT&T CORPORATION**  
MR. KEN NINE  
JMC ENGINEERS & ASSOCIATES, INC  
110 NORTH MAIN STREET  
CULVER, IN 46511  
PHONE: (574) 842-8830  
CELL: (574) 904-6536  
KENNETHNINE@ATT.NET

**AT&T WISCONSIN -  
COMMUNICATION LINE**  
JAY BULANEK  
2005 PEWAUKEE RD  
WAUKESHA, WI 53188-2443  
(262) 896-7869  
jbs175@att.com

**MMSD MANHOLE ADJUSTMENT  
CONTACT**  
MR. ROBERT REBITSKI  
260 W. SEEBOTH STREET  
MILWAUKEE, WI 53204  
PHONE: (414) 225-2214  
RREBITSKI@MMSD.COM

**MILWAUKEE METROPOLITAN  
SEWERAGE DISTRICT – SEWER**  
MICKI KLAPPA-SULLIVAN  
260 W SEEBOTH ST  
MILWAUKEE, WI 53204  
(414) 225-2178  
MklappaSullivan@mmsd.com

**WISCONSIN DEPARTMENT OF  
TRANSPORTATION -  
COMMUNICATION LINE**  
JEFF MADSON  
STE. 300  
433 W. ST. PAUL AVE.  
MILWAUKEE, WI 53203-3007  
(414) 225-3723  
Jeffrey.Madson@dot.wi.gov

**WISCONSIN DEPARTMENT OF  
TRANSPORTATION - STREET  
LIGHTING**  
ERIC PEREA  
141 NW BARSTOW STREET  
WAUKESHA, WI 53188  
(262) 574-5422  
Eric.Perea@dot.wi.gov

**WISCONSIN DEPARTMENT OF  
TRANSPORTATION - WISCONSIN  
SIGNAL**  
DERRIN WOLFORD  
141 NW BARSTOW STREET  
WAUKESHA, WI 53188  
(262) 521-4409  
derrin.wolford@dot.wi.gov

**ELECTRICAL FIELD UNIT  
WEST ALLIS, WI 53214**  
PHONE: (414) 266-1170

**WISCONSIN INDEPENDENT  
NETWORK**  
MR. JIM BIRKENHEIER  
800 WISCONSIN AVE, UNIT 15  
EAU CLAIRE, WI 54703  
PHONE: (715) 832-6041  
CELL: (715) 838-4007

**WE ENERGIES – ELECTRICITY**  
NICOLE SMULLEN  
A299  
333 W EVERETT ST  
MILWAUKEE, WI 53203  
(414) 221-5617  
Nicole.SmulLEN@weenergygroup.com

**CONSTRUCTION FIELD CONTACT:**  
MR. NICHOLAS WELCH  
500 S. 116TH STREET  
WEST ALLIS, WI 53214  
PHONE: (414) 944-5765  
NICHOLAS.WELCH@WE-ENERGIES.COM

**WE ENERGIES - GAS/PETROLEUM**  
NICOLE SMULLEN  
A299  
333 W EVERETT ST  
MILWAUKEE, WI 53203  
(414) 221-5617  
Nicole.SmulLEN@weenergygroup.com

**CONSTRUCTION FIELD CONTACT:**  
MR. NICK ERNSTER  
500 S. 116TH STREET  
WEST ALLIS, WI 53214  
PHONE: (414) 944-5574  
NICHOLAS.ERNSTER@WE-ENERGIES.COM

**TCA**  
SANDRA FALATYK  
6070 N. FLINT ROAD  
GLENDALE, WI 53209  
PHONE: (414) 459-3565  
CELL: (414) 651-6013  
S.FALATYK@NORTHWINDTECH.COM

**Addendum No. 01  
ID 1693-37-74  
Revised Sheet 2  
May 16, 2019**

STATE AGENCIES

**WISCONSIN DEPARTMENT OF  
NATURAL RESOURCES**  
MS. KRISTINA BETZOLD - ENVIRONMENTAL SPECIALIST  
2300 N. MARTIN LUTHER KING JR. DRIVE  
MILWAUKEE, WI 53212  
CELL: (414) 507-4946  
kristina.betzold@wisconsin.gov

**WISCONSIN DEPARTMENT OF  
TRANSPORTATION**  
MR. JOSH LEVEQUE - PROJECT MANAGER  
141 NW BARSTOW ST.  
WAUKESHA, WI 53187-0798  
CELL: (414) 750-1468  
Joshua.Lev@dot.wi.gov

**WISCONSIN DEPARTMENT OF  
TRANSPORTATION**  
MR. GREG BERRY – UTILITY COORDINATOR  
141 NW BARSTOW STREET  
WAUKESHA, WI 53187-0798  
CELL: (414) 750-7828  
gregory.berry@dot.wi.gov

**WISCONSIN DEPARTMENT OF  
TRANSPORTATION**  
MS. DOBRA PAYANT  
141 NW BARSTOW ST.  
WAUKESHA, WI 53187-0798  
PHONE: (414) 750-2677  
DOBRA.PAYANT@DOT.WI.GOV

OTHER AGENCIES

**MILWAUKEE COUNTY DPW  
MANAGER**  
MR. GREG HEISEL, HWY MAINT.  
10790 W. WATERTOWN PLANK ROAD  
MILWAUKEE, WI 53226  
PHONE: (414) 257-6566  
gheisel@milwcnty.com

**MILWAUKEE COUNTY TRANSIT SYSTEM**  
MS. MELANIE FLYNN  
1942 N. 17TH STREET  
MILWAUKEE, WI 53205  
PHONE: (414) 343-1764  
mflynn@mcts.org

**WISCONSIN DEPARTMENT OF  
NATURAL RESOURCES**  
MS. MELISSA COOK – HAST TRAIL MANAGER  
2300 N. MARTIN LUTHER KING JUR. DRIVE  
MILWAUKEE, WI 53212  
PHONE: (414) 263-8559  
MELISSA.COOK@WISCONSIN.GOV

**SOUTHEASTERN WISCONSIN  
REGIONAL PLANNING COMMISSION**  
MR. ROB MERRY  
W239 N1812 ROCKWOOD DRIVE  
P.O. BOX 1807  
WAUKESHA, WI 53187-1607  
PHONE: (262) 953-4289  
CELL: (920) 912-1036  
rmerry@sewrpc.org

**CITY OF WEST ALLIS – CITY  
ENGINEER**  
PETER DANIELS  
7525 W GREENFIELD AVE  
WEST ALLIS, WI 53214  
(414) 302-8374  
pdaniels@westallis.wi.gov



Addendum No. 01  
ID 1693-37-74  
Added Sheet 17A  
May 16, 2019



S. 78TH ST

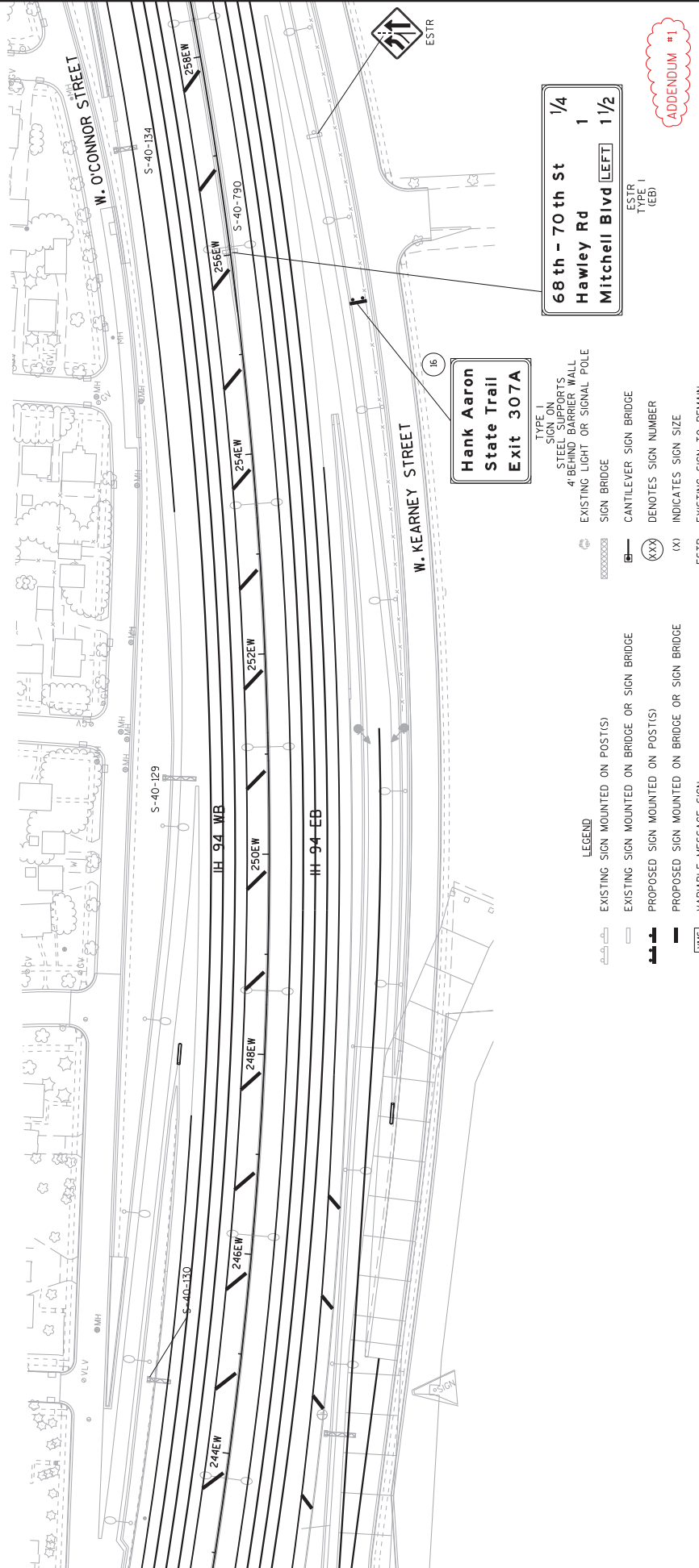

68th - 70th St	1/4
Hawley Rd	1
Mitchell Blvd (LEFT)	1 1/2

Hank Aaron  
State Trail  
Exit 307A

- LEGEND
- EXISTING SIGN MOUNTED ON POST(S)
  - EXISTING SIGN MOUNTED ON BRIDGE OR SIGN BRIDGE
  - PROPOSED SIGN MOUNTED ON POST(S)
  - PROPOSED SIGN MOUNTED ON BRIDGE OR SIGN BRIDGE
  - VARIABLE MESSAGE SIGN
  - EXISTING LIGHT OR SIGNAL POLE
  - SIGN BRIDGE
  - CANTILEVER SIGN BRIDGE
  - DENOTES SIGN NUMBER
  - INDICATES SIGN SIZE
  - EXISTING SIGN TO REMAIN

ADDENDUM #1



- LEGEND**
- EXISTING SIGN MOUNTED ON POST(S)
  - EXISTING SIGN MOUNTED ON BRIDGE OR SIGN BRIDGE
  - PROPOSED SIGN MOUNTED ON POST(S)
  - PROPOSED SIGN MOUNTED ON BRIDGE OR SIGN BRIDGE
  - VARIABLE MESSAGE SIGN
  - EXISTING LIGHT OR SIGNAL POLE
  - SIGN BRIDGE
  - CANTILEVER SIGN BRIDGE
  - DENOTES SIGN NUMBER
  - INDICATES SIGN SIZE
  - EXISTING SIGN TO REMAIN

(17)

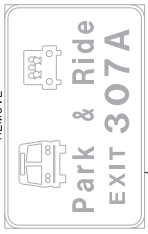
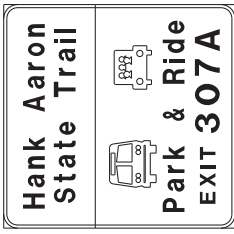
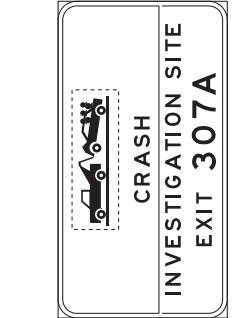

TYPE I  
MOUNT ON  
STEEL POSTS  
7' BETWEEN POSTS

TYPE I  
MOUNT ON  
2 WOOD POSTS

TYPE I  
ESTR

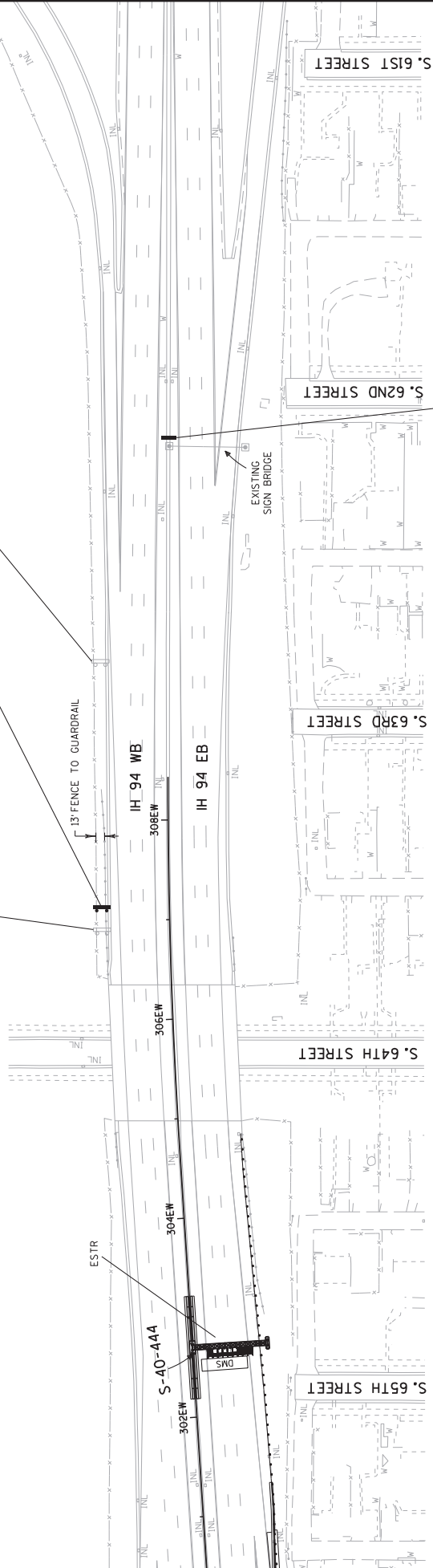

**Addendum No. 01**  
**ID 1693-37-74**  
**Added Sheet 17B**  
**May 16, 2019**

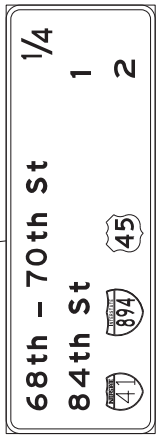

ADDENDUM #1

- LEGEND**
- EXISTING SIGN MOUNTED ON POST(S)
  - EXISTING SIGN MOUNTED ON BRIDGE OR SIGN BRIDGE
  - PROPOSED SIGN MOUNTED ON POST(S)
  - PROPOSED SIGN MOUNTED ON BRIDGE OR SIGN BRIDGE
  - VARIABLE MESSAGE SIGN
  - EXISTING LIGHT OR SIGNAL POLE
  - SIGN BRIDGE
  - CANTILEVER SIGN BRIDGE
  - DENOTES SIGN NUMBER
  - INDICATES SIGN SIZE
  - EXISTING SIGN TO REMAIN

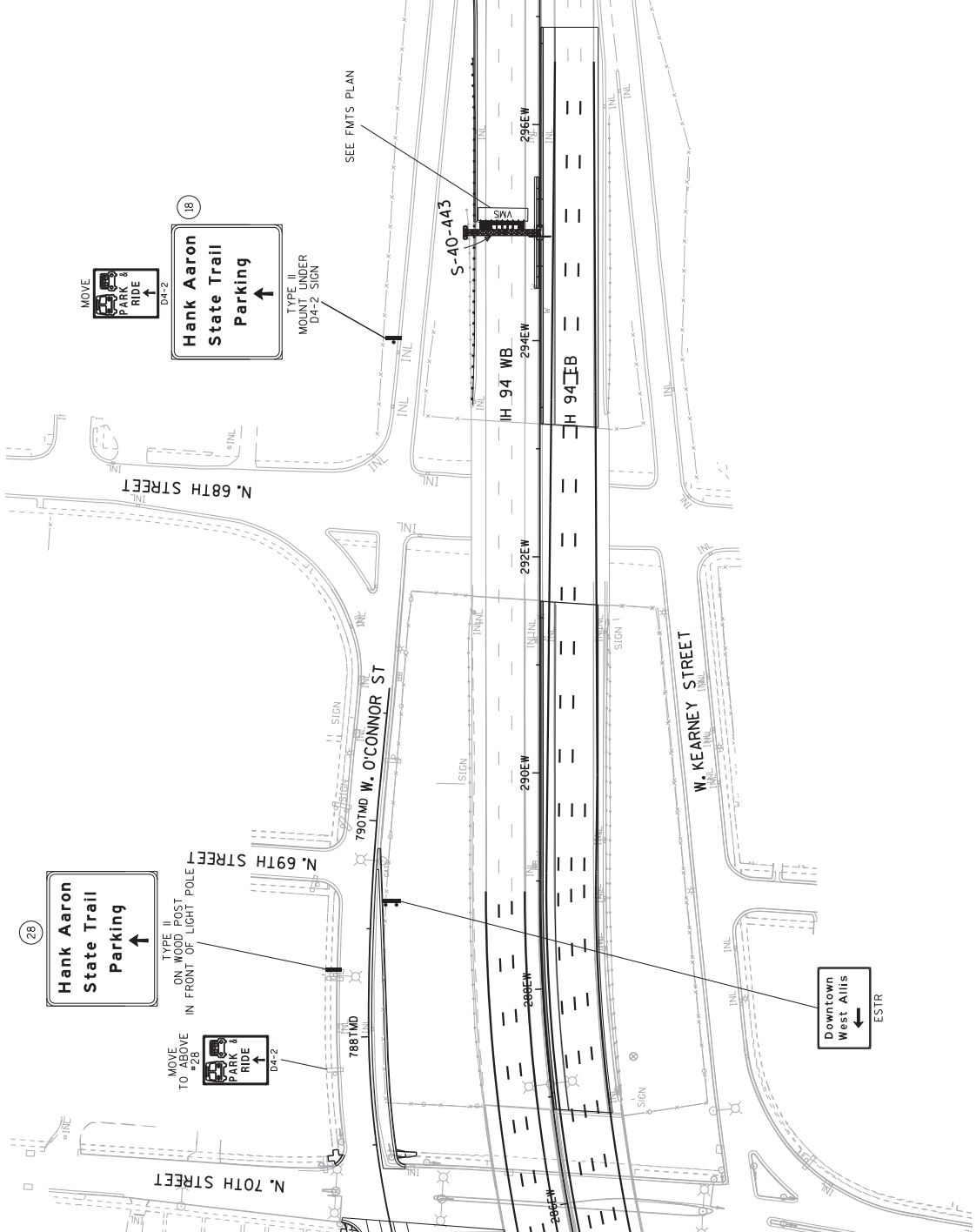

Addendum No. 01  
ID 1693-37-74  
Added Sheet 17C  
May 16, 2019

ADDENDUM #1



- LEGEND**
- - - EXISTING SIGN MOUNTED ON POST(S)
  - - - EXISTING SIGN MOUNTED ON BRIDGE OR SIGN BRIDGE
  - - - PROPOSED SIGN MOUNTED ON POST(S)
  - - - PROPOSED SIGN MOUNTED ON BRIDGE OR SIGN BRIDGE
  - [WMS] VARIABLE MESSAGE SIGN
  - EXISTING LIGHT OR SIGNAL POLE
  - SIGN BRIDGE
  - CANTILEVER SIGN BRIDGE
  - (XXX) DENOTES SIGN NUMBER
  - (XY) INDICATES SIGN SIZE
  - ESTR EXISTING SIGN TO REMAIN

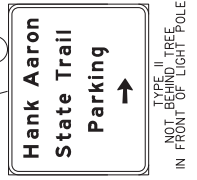
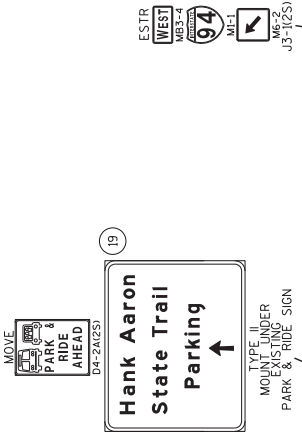

Addendum No. 01  
ID 1693-37-74  
Added Sheet 17D  
May 16, 2019

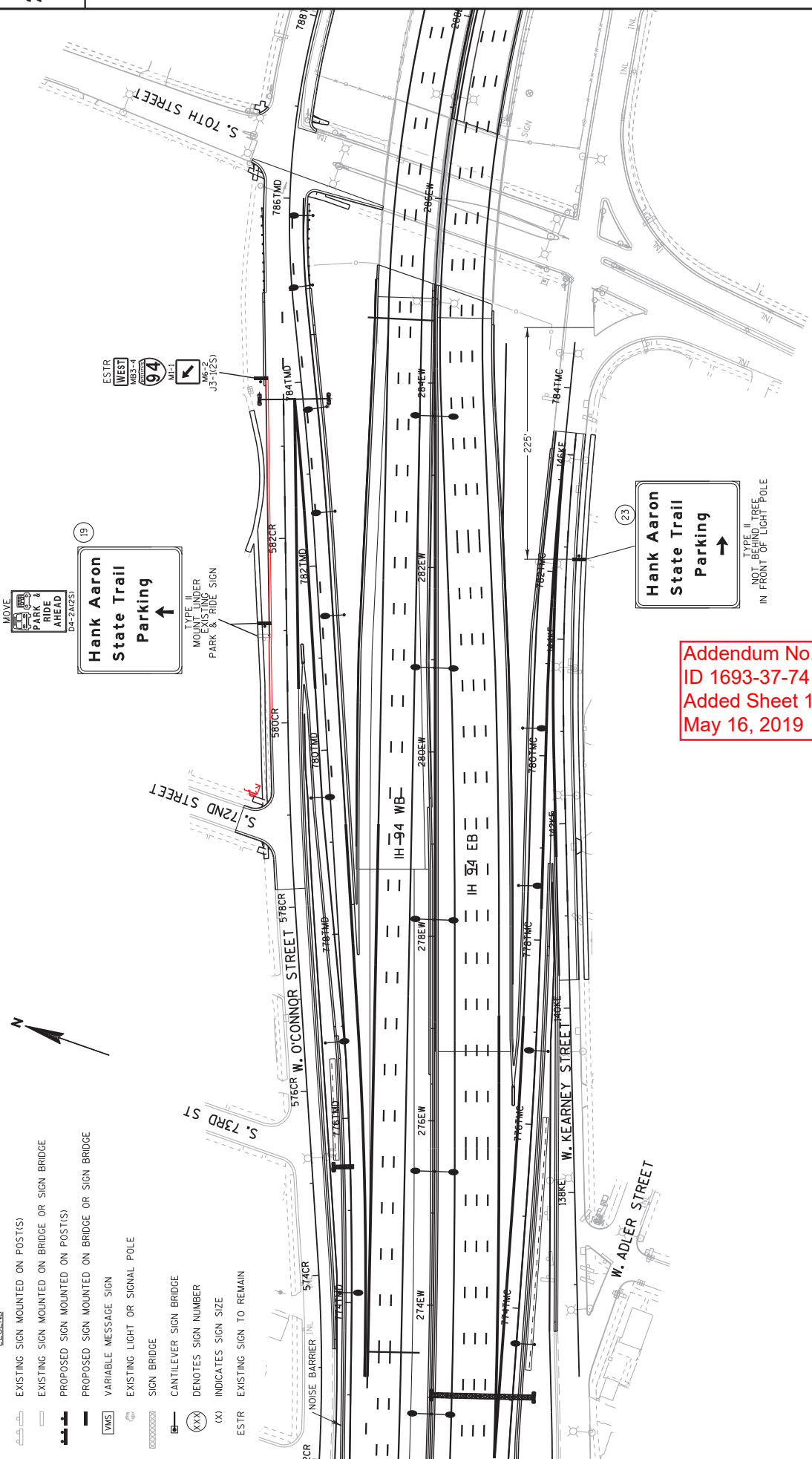

ADDENDUM #1



**Hank Aaron State Trail Parking**  
TYPE II ON LEFT

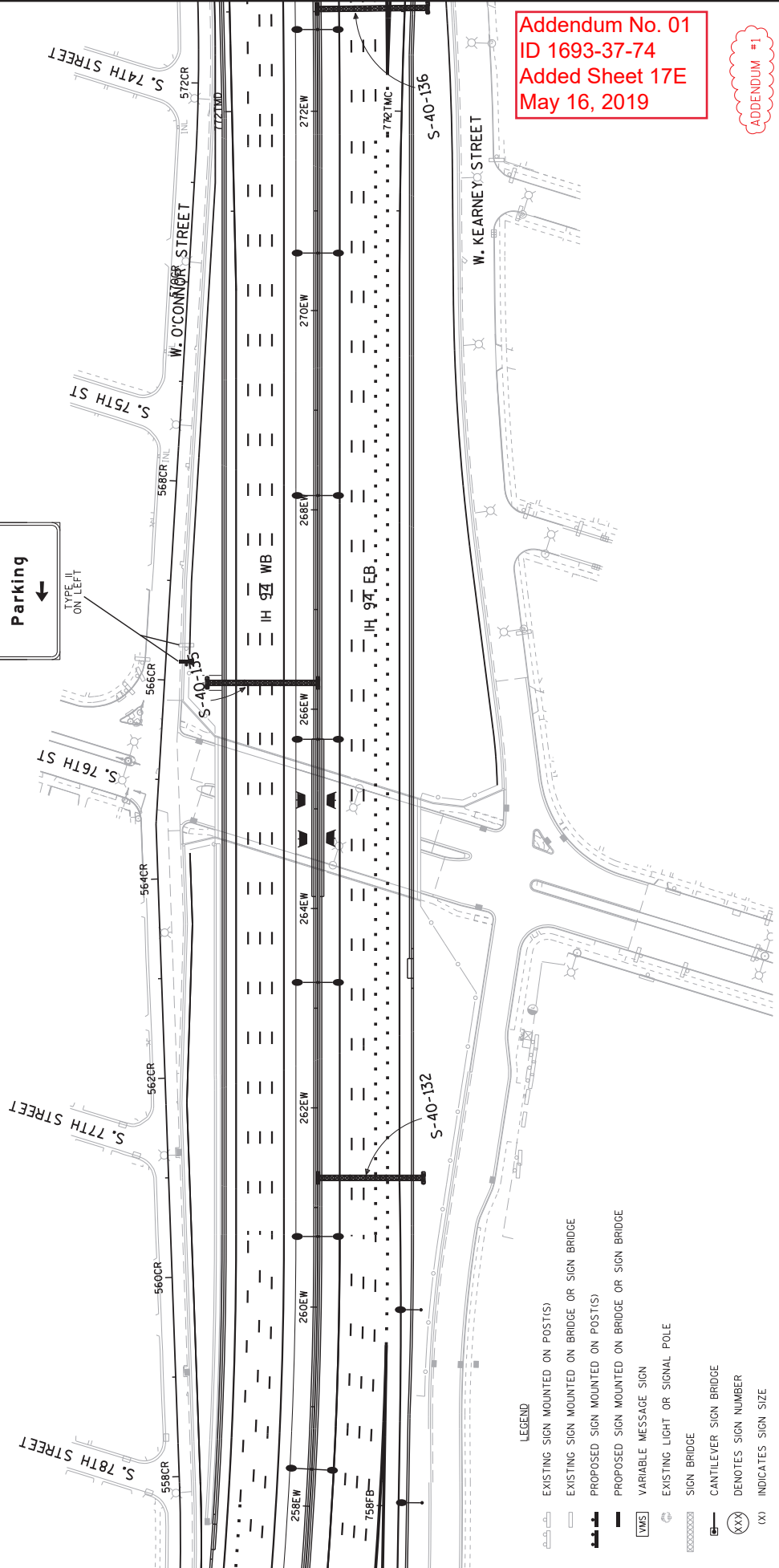

Addendum No. 01  
ID 1693-37-74  
Added Sheet 17E  
May 16, 2019

ADDENDUM #1

SHEET 5 OF 6

SHEET 17E

PERMANENT SIGNING - HANK AARON STATE TRAIL

COUNTY: MILWAUKEE

HWY: I94

PROJECT NO: 1693-37-74

FILE NAME : J:\proj\objects\02-16933794\SIGN\023231-1ps.dgn  
ESTR EXISTING SIGN TO REMAIN  
(X) INDICATES SIGN SIZE  
(XX) DENOTES SIGN NUMBER  
CANTILEVER SIGN BRIDGE  
SIGN BRIDGE  
EXISTING LIGHT OR SIGNAL POLE  
VARIABLE MESSAGE SIGN  
PROPOSED SIGN MOUNTED ON BRIDGE OR SIGN BRIDGE  
PROPOSED SIGN MOUNTED ON POST(S)  
EXISTING SIGN MOUNTED ON BRIDGE OR SIGN BRIDGE  
EXISTING SIGN MOUNTED ON POST(S)  
LEGEND

PLOT BY : dotshw

PLOT DATE : 17-APR-2019 14:10

PLOT SCALE : 100:1

WISDOT/CADDS SHEET 42

Addendum No. 01  
ID 1693-37-74  
Added Sheet 17F  
May 16, 2019

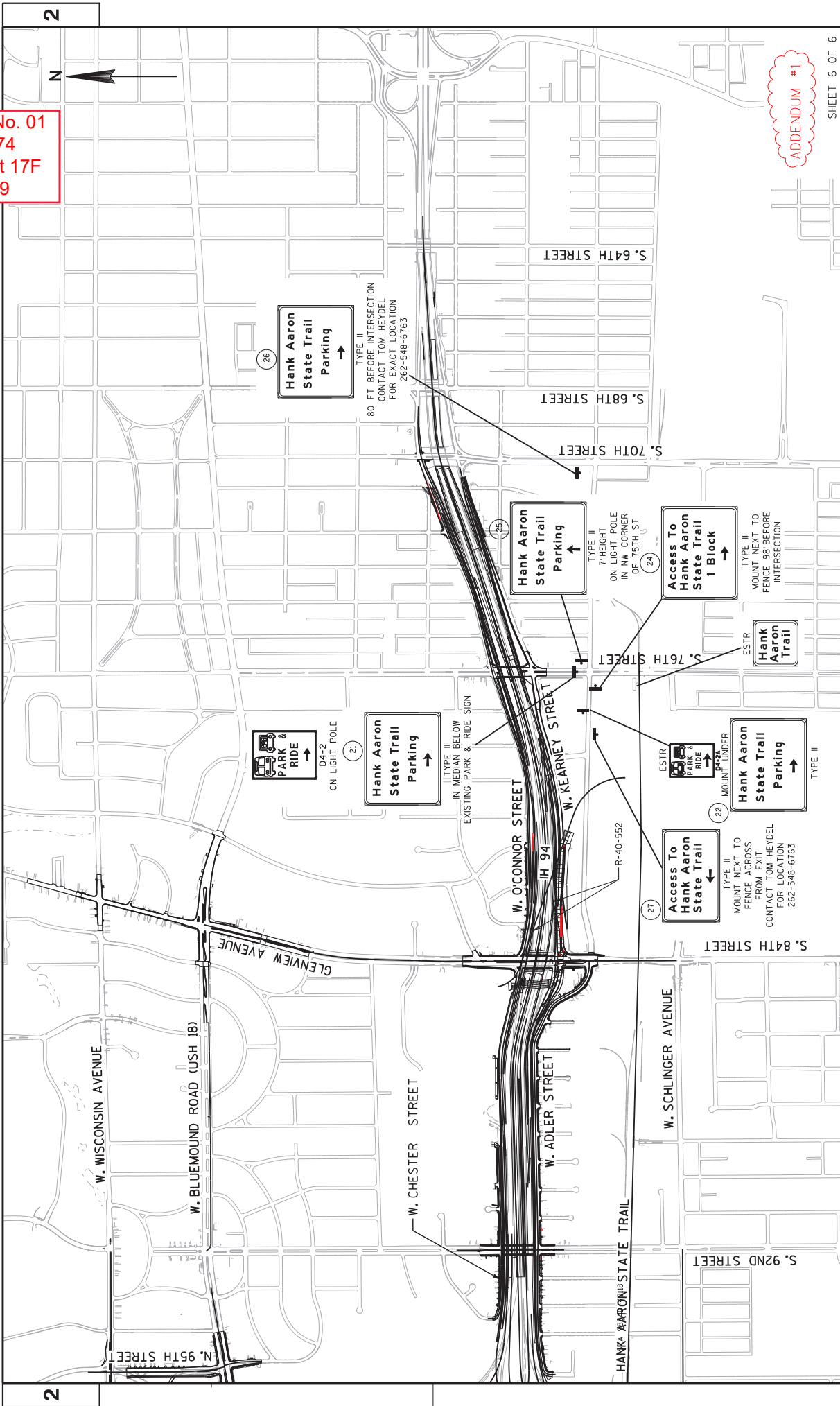

ADDENDUM #1

SHEET 17F

SHEET 6 OF 6

PROJECT NO: 1693-37-74

HWY: I 94

COUNTY: MILWAUKEE

PERMANENT SIGNING - HANK AARON STATE TRAIL

PLOT DATE: 17-APR-2019 14:10

PLOT BY: 00187W

PLOT SCALE: 799.99992:1

WISDOT/CADDIS SHEET 42

FILE NAME: J:\nproj\objects\02-16933794\SIGN\020208.dwg

1693-37-74

TYPE I & II PERMANENT SIGNING -

SIGN NO.	SIGN CODE & SIZE	SIGN MESSAGE	TYPE II SIGN SIZE W x H [IN.] x [IN.]	637.2210 SIGNS TYPE II REFLC H [SF]	637.2230 SIGNS TYPE II REFLC F [SF]	634.0618 WOOD POSTS 4" X 6" X 18" [EA]	634.0816 TUBULAR STEEL POSTS 2" X 2" X 16" [EA]	638.3000 REM SMALL SIGN SUP [EA]	638.2102 MOVE SIGNS TYPE II [EA]	MOUNT POSTS AS SIGN#	TYPE I SIGN SIZE W X H FEET	637.1220 SIGNS TYPE I REFLECTIVE SH SF	638.2801 REMOVING SIGNS TYPE I EA	STEEL POST TYPE	636.0100 SIGN SUPPORTS CONCRETE MASONRY CY	636.0500 SIGN SUPPORTS STEEL REINFORCING LBS	635.0200 SIGN SUPPORTS STRUCTURAL STEEL HS EST LBS	REMARKS / NEW SIGN LOCATION
1	NONE	TO HANK AARON TRAIL	24 X 30	5.000			1											SEE DETAIL
2	NONE	TO HANK AARON TRAIL	24 X 30	5.000			1											SEE DETAIL
3	R1-2		18 X 15.5	0.970			1											
4	W1-5L		18 X 18		2.250		1											
5	W1-2L		18 X 18		2.250		1											
6	W3-1		18 X 18		2.250		1											
7	R1-1		18 X 18	1.880			1											
8	J3-1		24 X 57	9.500		1												
	M4-5		24 X 12															
	M1-6	STH 100	24 X 24															
	M6-1		21 X 21			1												
9	J3-1		24 X 57	9.500		1												
	M4-5		24 X 12															
	M1-6	STH 100	24 X 24															
	M6-1		21 X 21															
10	R5-3(ZS)		24 X 24	4.000														
11	NONE	TO MILWAUKEE COUNTY ZOO	24 X 36	6.000			1											
12	NONE	TO MILWAUKEE COUNTY ZOO	24 X 36	6.000			1											
13	NONE	TO MILWAUKEE COUNTY ZOO	24 X 36	6.000			1											
14	W7-5		18 X 18		2.250		1											
15	R5-3(ZS)		24 X 24	4.000			1											
16	NONE	HANK AARON STATE TRAIL									12 X 7	64		A	1.2	68	600	4 FEET BEHIND BARRIER WALL
		EXT 307A																
17	NONE	HANK AARON STATE TRAIL						2			8 X 8	64	1	B	1.6	98	1000	7 FEET BETWEEN POSTS. BEHIND GUARDRAIL
		PARK AND RIDE																
		EXT 307A																
18	NONE	HANK AARON STATE TRAIL PARKING	30 X 36	7.500		1												
		ARROW AHEAD																
19	NONE	HANK AARON STATE TRAIL PARKING	30 X 36	7.500		1												
		ARROW AHEAD																

ADDENDUM # 1

SHEET 1 OF 2

E

PROJECT NO.: 1693-37-74

HWY: STH 100

COUNTY: MILWAUKEE

PERMANENT SIGNING QUANTITIES

SHEET: 32

PLOT BY: DOTTAR

PLOT NAME: 090502.mxd

PLOT SCALE: 1:1

Addendum # 1

SHEET 2 OF 2

TYPE I & II PERMANENT SIGNING -

SIGN NO.	SIGN CODE & SIZE	SIGN MESSAGE	TYPE II SIGN SIZE (IN) x (IN) x (IN)	SIGN REFLECT H (SF)	SIGN TYPE II REFLECT H (SF)	SIGN TYPE II REFLECT F (SF)	WOOD POSTS 4"x6"x18" (EA)	TUBULAR STEEL POSTS 2"x2"x16" (EA)	REINFORCING STEEL SUP (EA)	SMALL SIGN SUP (EA)	MOVE SIGN TYPE II (EA)	MOUNT ON SAME POST AS SIGN #	TYPE I SIGN SIZE W X H FEET	SIGN TYPE I REFLECTIVE SH SF	REMOVING SIGN TYPE I EA	STEEL POST TYPE	SIGN SUPPORTS CONCRETE MASONRY CY	SIGN SUPPORTS STEEL REINFORCING LBS	SIGN SUPPORTS STRUCTURAL STEEL HS EST LBS	REMARKS / NEW SIGN LOCATION
20	NONE	HANK AARON STATE TRAIL PARKING	30 x 30	6.250			1				1									
		ARROW LEFT																		
21	NONE	HANK AARON STATE TRAIL PARKING	24 x 24	4.000																MOUNT ON LIGHT POLE
		ARROW RIGHT																		
22	NONE	HANK AARON STATE TRAIL PARKING	30 x 30	6.250																
		ARROW RIGHT																		
23	NONE	HANK AARON STATE TRAIL PARKING	30 x 30	6.250			1													
		ARROW RIGHT																		
24	NONE	HANK AARON STATE TRAIL PARKING	24 x 30	5.000				1												
		1 BLOCK ARROW RIGHT																		
25	NONE	HANK AARON STATE TRAIL PARKING	24 x 30	5.000																
		ARROW AHEAD																		MOUNT ON LIGHT POLE
26	NONE	HANK AARON STATE TRAIL PARKING	24 x 24	4.000				1												
		ARROW RIGHT																		
27	NONE	HANK AARON STATE TRAIL	24 x 24	4.000				1												
		ARROW LEFT																		
28	NONE	HANK AARON STATE TRAIL PARKING	30 x 36	7.500				1		1	1									MOUNT ON WOOD POST
		ARROW AHEAD																		
		UNDISTRIBUTED							2		1									
TOTALS				121.080	9.000		6	16	8	5				148	1		2.8	166	1600	

PROJECT NO. 1693-37-74

HWY: STH 100

COUNTY: MILWAUKEE

PERMANENT SIGNING QUANTITIES

SHEET: 32A

E

- 1. All Signs Type II - Type H Reflective
- 2. Color:
  - Background - Green
  - Message - White

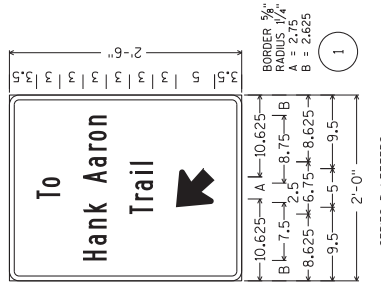
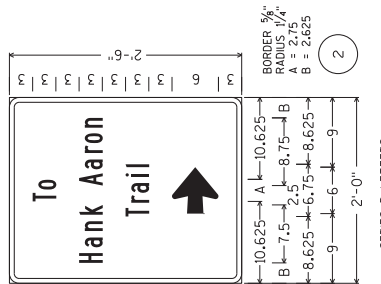
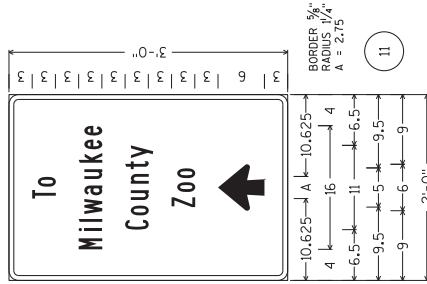
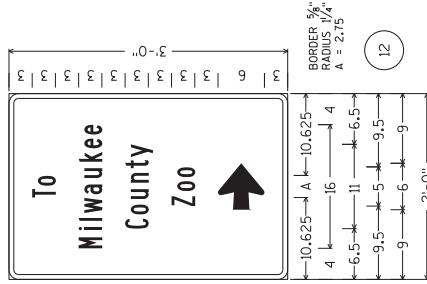
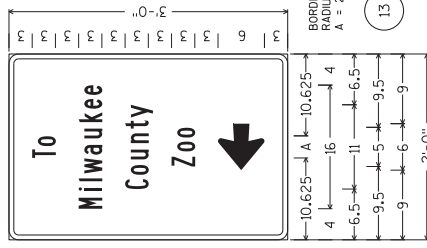

SERIES B LETTERS

SERIES B LETTERS

SERIES B LETTERS

SERIES B LETTERS

SERIES B LETTERS

Addendum # 1 - Signs  
# 1 and # 2 to be  
brown with white  
letters

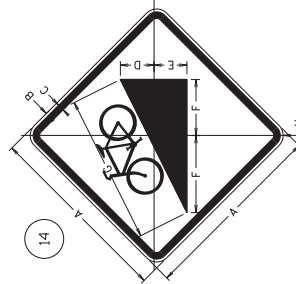

W7-5  
BICYCLE HILL PLAQUE

A	B	C	D	E	F	G	H
18	24	3.75	1.5	1.5	4	5.625	12.625
24	37.5	6.25	2.3	15.3	7.5	16.833	11.5

Colors:  
Legend - Black  
Background - Yellow Type F Sheeting

Addendum No. 01  
ID 1693-37-74  
Revised Sheet 73  
May 16, 2019

NOTES

1. All Signs Type I - Type SH Reflective
2. Color:  
Background - Brown  
Message - White
3. Message Series - E Modified except all CAP words Series E or as noted

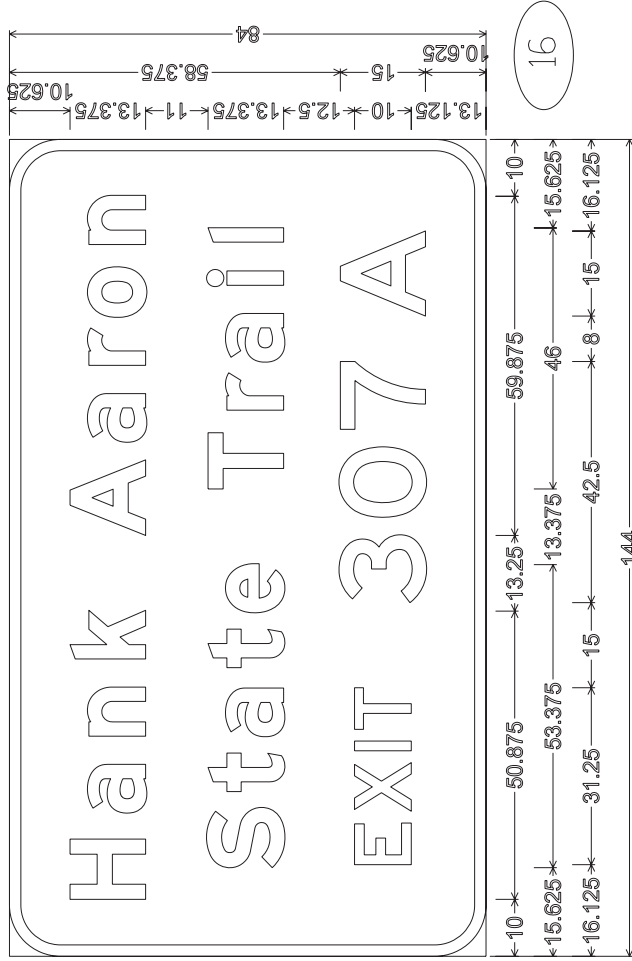

Identifier : E3-1  
 9.000" Radius, 2.000" Border, White on Brown;  
 "Hank" E Mod; "Aaron" E Mod; "State" E Mod; "Trail" E Mod; "EXIT" E;  
 "307" E; "A" E;

Addendum No. 01  
 ID 1693-37-74  
 Added Sheet 73A  
 May 16, 2019

NOTES

1. All Signs Type II - Type H Reflective
2. Color:  
Background - Green except as noted  
Message - White
3. Message Series - B except as noted

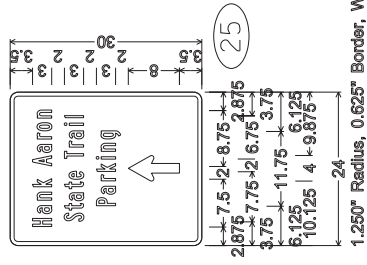
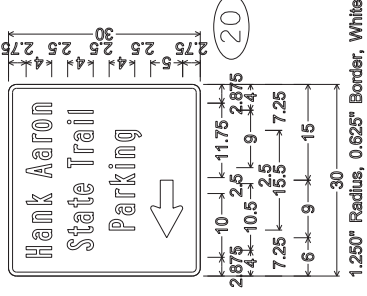
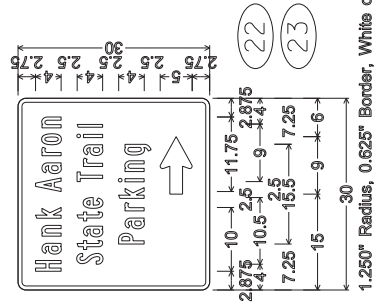

Type I sign - sign # 17

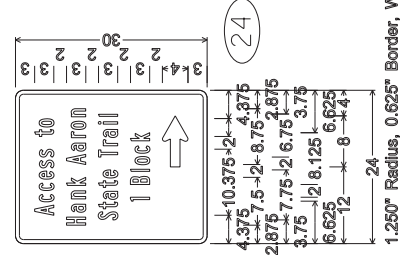
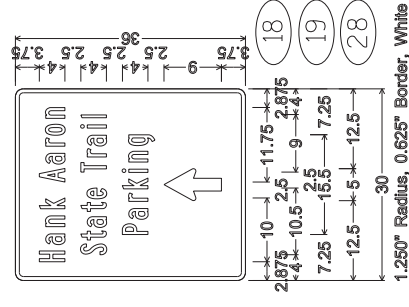
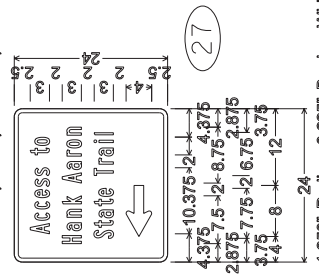
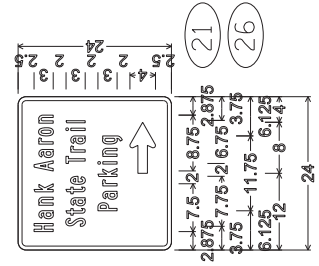
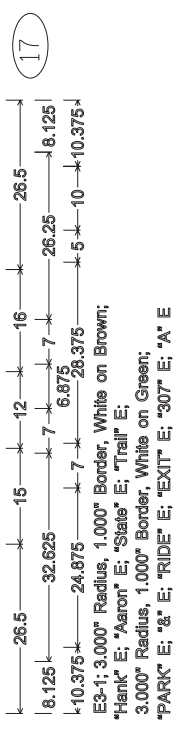
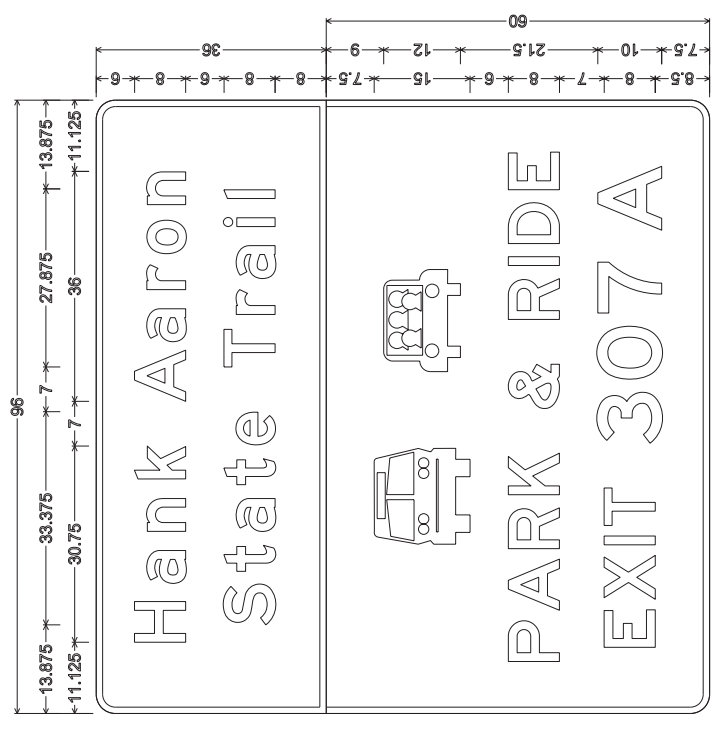

Addendum No. 01  
ID 1693-37-74  
Added Sheet 73B  
May 16, 2019