



Wisconsin Department of Transportation

May 26, 2021

Division of Transportation Systems Development

Bureau of Project Development
4822 Madison Yards Way, 4th Floor South
Madison, WI 53705

Telephone: (608) 266-1631
Facsimile (FAX): (608) 266-8459

NOTICE TO ALL CONTRACTORS:

Proposal #08: 6280-02-74, WISC 2021409
Stevens Point - Rosholt
I39 to Stevens Point Airport
STH 66
Portage County

Letting of June 8, 2021

This is Addendum No. 01, which provides for the following:

Special Provisions:

Added Special Provisions	
Article No.	Description
12	Remove and Reinstall Loop Detector, Wire and Lead-In Cable, Station 146+17WB

Schedule of Items:

Revised Bid Item Quantities					
Bid Item	Item Description	Unit	Old Quantity	Revised Quantity	Proposal Total
650.8000	Construction Staking Resurfacing References	LF	5575	-4775	800

Added Bid Item Quantities					
Bid Item	Item Description	Unit	Old Quantity	Revised Quantity	Proposal Total
601.0407	Concrete Curb & Gutter 18-Inch Type D	EACH	0	675	675
SPV.0105.01	Remove and Reinstall Loop Detector, Wire and Lead-In Cable, Station 146+17WB	LS	0	1	1

Deleted Bid Item Quantities					
Bid Item	Item Description	Unit	Old Quantity	Revised Quantity	Proposal Total
416.0610	Drilled Tie Bars	EACH	207	-207	0
601.0405	Concrete Curb & Gutter 18-Inch Type A	LF	675	-675	0

Plan Sheets:

Revised Plan Sheets	
Plan Sheet	Plan Sheet Title (brief description of changes to sheet)
6	Typical Section – Revise stationing
51, 56	Miscellaneous Quantities – Change curb & gutter type, remove tie bars, revise construction staking

Added Plan Sheets	
Plan Sheet	Plan Sheet Title (brief description of why sheet was added)
14A, B	Signal Plan – Remove and replace loop detector that was installed in prior to construction

The responsibility for notifying potential subcontractors and suppliers of these changes remains with the prime contractor.

Sincerely,

Mike Coleman

Proposal Development Specialist
Proposal Management Section

ADDENDUM NO. 01

6280-02-74

May 26, 2021

Special Provisions

12. Remove and Reinstall Loop Detector, Wire and Lead-In Cable, Station 146+17WB, Item SPV.0105.01.

This special provision describes removing and reinstalling loop detector, wire and lead-in cable on STH 66 at Sta. 146+17WB to accommodate the construction efforts occurring on STH 66. Electrical wiring shall be installed according to the pertinent provisions of standard spec 204 and 652 and as hereinafter provided.

B Materials

Supply incidental materials required to complete the work described in this special provision according to the pertinent provisions of standard spec 652. These materials include the replacement of damaged materials.

C Construction

Contact the WisDOT NC Region (Ken Radtke, 715-459-4264) three days prior to disturbing/removal of pavement near loop 21 so splice kits can be cut out so lead-in does not get pulled back from cabinet.

After existing pavement is removed, cut and temporarily cap the remaining two 1-inch loop detector conduit leads at the curb line. Salvage the existing loop detector conduit set up. After the base aggregate dense material is installed, reinstall the loop detector conduit. Re-connect to the remaining conduit leads using standard conduit couplings. Install the loop detector wire from PB10 through the loop detector conduit. Splice the loop detector wire into the loop detector lead-in cable in PB10 using a Standard Splice Kit.

D Measurement

The department will measure Remove and Reinstall Loop Detector, Wire and Lead-In Cable as a single lump sum unit of work, acceptably completed.

E Payment

The department will pay for measured quantities at the contract unit price under the following bid item:

ITEM NUMBER	DESCRIPTION	UNIT
SPV.0105.01	Remove and Reinstall Loop Detector, Wire and Lead-In Cable, Station 146+17WB	LS

Payment for Removing and Reinstalling Loop Detector, Wire and Lead-In Cable is full compensation for excavating, removing, salvaging and reinstalling existing loop detectors, and for providing all pertinent materials required for re-installation.

Replacing damaged materials is incidental to this bid item.

Schedule of Items

Attached, dated May 26, 2021, are the revised Schedule of Items Pages 1-4.

Plan Sheets

The following 8½ x 11-inch sheets are attached and made part of the plans for this proposal:

Revised: 6, 51, 56.

Added: 14A-14B.

END OF ADDENDUM

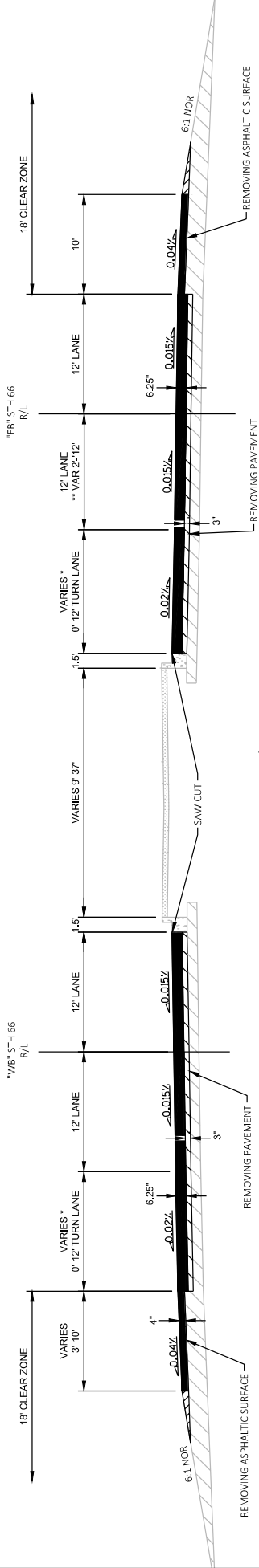

FINISHED TYPICAL SECTION STH 66/STANLEY STREET

STA 145+00WB TO STA 151+90WB
 STA 157+75WB TO STA 165+10WB
 STA 165+10WB TO STA 165+34WB (LT SHLD ONLY)
 STA 45+00EB TO STA 51+65EB
 STA 57+50EB TO STA 61+20EB
 STA 61+20EB TO STA 65+50EB (EXCLUDE RT SHLD)**
 * LEAVE EXISTING CONCRETE TURN LANE: STA 45+64EB TO STA 47+09EB
 STA 149+10WB TO STA 152+31WB

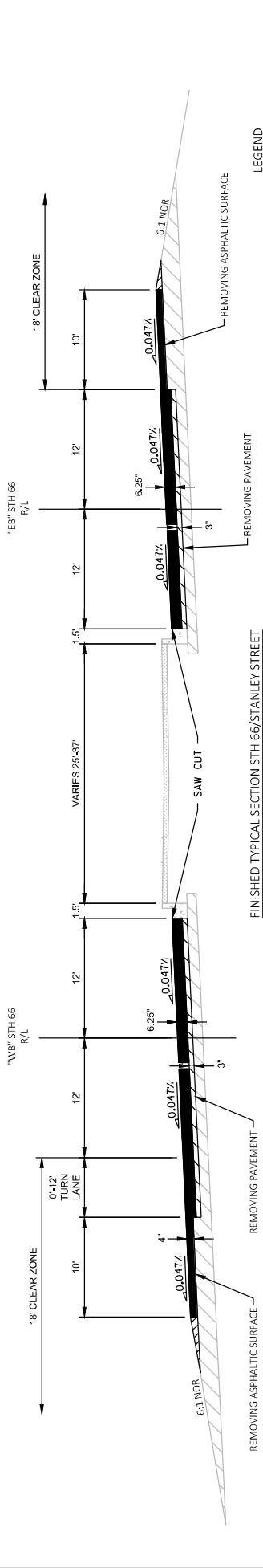

FINISHED TYPICAL SECTION STH 66/STANLEY STREET

STA 151+90WB TO STA 157+75WB
 STA 51+65EB TO STA 57+50EB

Addendum No. 01
ID 6280-02-74
Revised Sheet 6
May 26, 2021

LEGEND

- HMA PAVEMENT (SEE NOTE FOR TYPES)
- BASE AGGREGATE DENSE 1 1/4-INCH
- BASE AGGREGATE DENSE 3/4-INCH
- EXISTING PC CONCRETE PAVEMENT
- EXISTING HMA PAVEMENT
- EXISTING BASE AGGREGATE DENSE 1 1/4-INCH
- EXISTING TOPSOIL
- EXISTING CONCRETE CURB & GUTTER 18-INCH

NOTE: HMA PAVEMENT TYPES

DRIVING LANES:
 LOWER LAYER = 4.5-INCHES, TYPE 3 MT 58-28 S (2 LIFTS)
 UPPER LAYER = 1.75-INCHES, TYPE 4 MT 58-28 H

SHOULDERS:
 LOWER LAYER = 2.25-INCHES, TYPE 3 MT 58-28 S
 UPPER LAYER = 1.75-INCHES, TYPE 4 MT 58-28 S

PROJECT NO: 6280-02-74	HWY: STH 66	COUNTY: PORTAGE	TYPICAL SECTION	SHEET 6	E
FILE NAME: I:\PDS\CD\62800204\SHETS\PLAN\6280027A\023001-T5.DWG	DATE: 5/17/2021 11:15 AM	DESIGNER: CHRISTIANSON, ERIN M	PLOT NAME:	PLOT SCALE: 1 IN=10 FT	WISDOT/CADD/SHEET 42
LAYOUT NAME: 0515					

Addendum No. 01
ID 6280-02-74
Added Sheet 14A
May 26, 2021

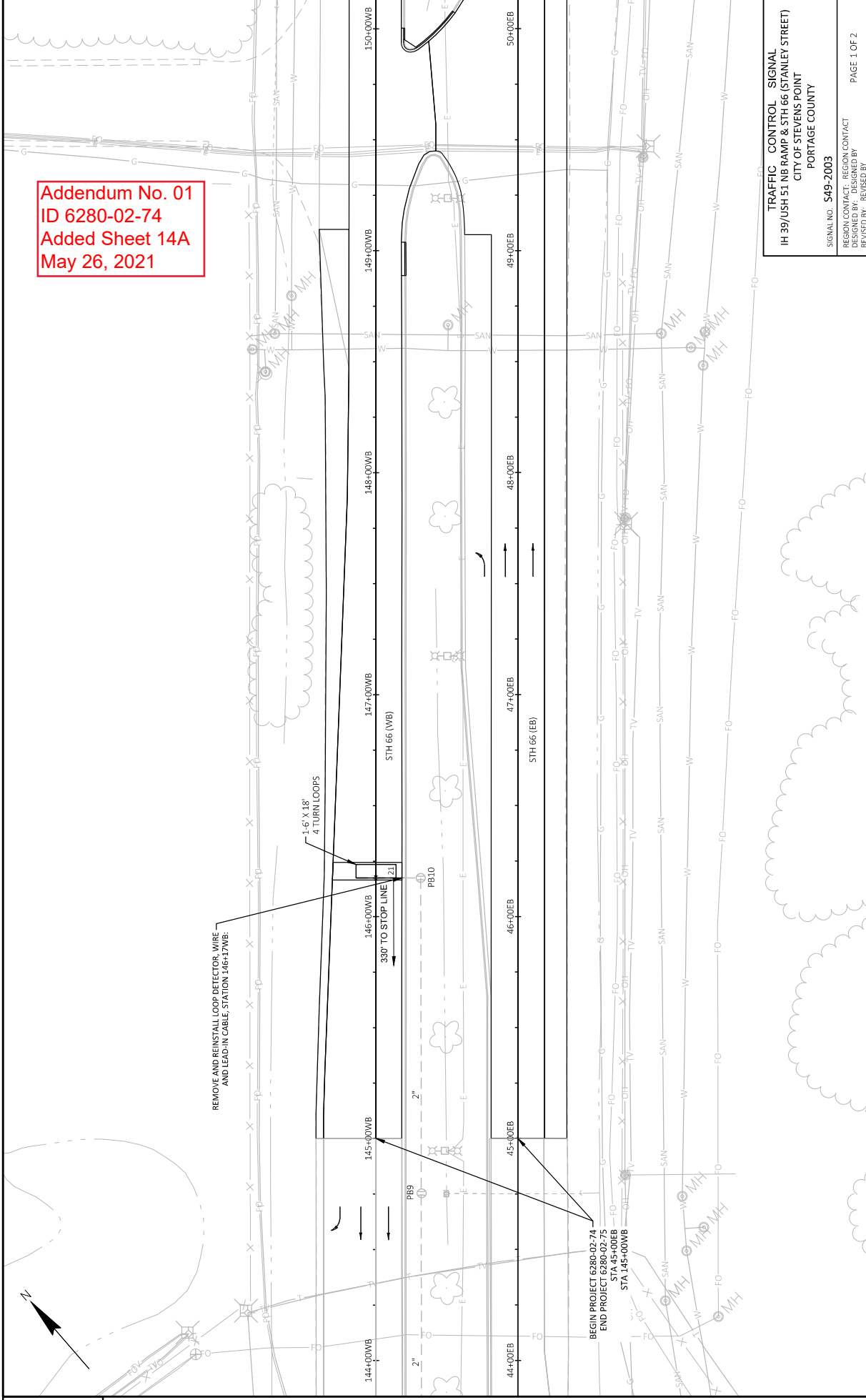

PROJECT NO: 6280-02-74 FILE NAME: I:\PDS\CD\62800204\SHETSPLAN\6280274\02-001-SP.DWG LAYOUT NAME: 05-99	COUNTY: PORTAGE HWY: STH 66	TRAFFIC SIGNAL PLAN	
		SHEET 14A	E
PROJECT DATE: 5/25/2021 9:27 AM PLOT BY: CHRISTIANSON, ERIN M PLOT NAME: 1 IN 40 FT		PAGE 1 OF 2	
TRAFFIC CONTROL SIGNAL IH 39/USH 51 NB RAMP & STH 66 (STANLEY STREET) CITY OF STEVENS POINT PORTAGE COUNTY		SIGNAL NO: S49-2003 REGION CONTACT: REGION CONTACT DESIGNED BY: DESIGNED BY REVISED BY: REVISED BY	

NONE
CLOSED LOOP
TWISTED PAIR
FIBER OPTIC*
FIBER OPTIC (ETHERNET)
RADIO
CELL MODEM

NONE
TBC
TRAFFIC RESPONSIVE
ADAPTIVE
*LOCATION OF MASTER
CONTROLLER NO. S-
SIGNAL SYSTEM NO: SS-

BY OTHER AGENCY
IN TRAFFIC SIGNAL CABINET
IN SEPARATE DOT LIGHTING CABINET

NONE
RAILROAD
EMERGENCY VEHICLE
GTT
TOMAR
HARDWARE
OTHER
LIFT BRIDGE
LOUJUE DETECTOR

GENERAL NOTES:

1. ANY ACTUATED PHASE FOR WHICH THERE IS NO CALL SHALL BE SKIPPED.
2. WHEN ONE PHASE IS ON ALONE, ANY NONCONFLICTING PHASE MAY START TIMING CONCURRENTLY WITHOUT A CALL.
3. WHEN OPPOSING THROUGH PHASES ARE TIMING CONCURRENTLY THEY SHALL TERMINATE TOGETHER DUE TO PERMISSIVE LEFT TURN CONFLICT.

TRAFFIC CONTROL SIGNAL
 IH 39/USH 51 NB RAMP & 5TH 66 (STANLEY STREET)
 CITY OF STEVENS POINT
 PORTAGE COUNTY
 SIGNAL NO. S49-2003
 REGION CONTACT: REGION CONTACT
 DESIGNED BY: DESIGNED BY
 REVISED BY: REVISED BY
 PAGE 2 OF 2

SHEET 14B
 E

CONTROLLER LOGIC

PHASE NUMBER	PHASE LOCKING	DUAL ENTRY W/OB	PHASE RECALL	PHASE ACTIVE
1		6		X
2	X	6	MIN	X
3				
4				
5				
6	X	2	MIN	X
7				
8				X

SPECIAL OVERLAPS

PROTECTED	PERMISSIVE
O.L."E"	1
O.L."F"	2
O.L."G"	
O.L."H"	

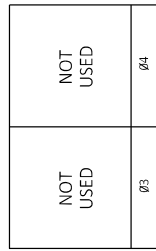

RING 1

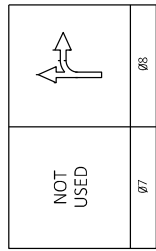

RING 2

BARRIER

DETECTOR LOGIC

DETECTOR INPUT	DETECTOR #S	PHASE CALLED	CALL OPTION	DELAY TIME	EXTENSION OPTION	EXTEND TIME	USE ADDED INITIAL	STRETCH TIME	LOOP SIZE (F/FT)	NUMBER TURNS
3	61	11	81	83	85					
6	1	2	8	8						
X	X	X	X	X						
X	X	X	X	X						
X	X	X	X	X						
5.0	2.0	5.0	2.0	2.0	2.0					
X	X	X	X	X						
6x18	6x20	6x18	6x6	6x20	6x20					
4	3	4	4	3	3					

DETECTOR INPUT	DETECTOR #S	PHASE CALLED	CALL OPTION	DELAY TIME	EXTENSION OPTION	EXTEND TIME	USE ADDED INITIAL	STRETCH TIME	LOOP SIZE (F/FT)	NUMBER TURNS
4	12	82	84	86						
1	8	8								
X	X	X	X	X						
X	X	X	X	X						
X	X	X	X	X						
2.0	2.0	2.0	2.0	2.0						
6x20	6x6	6x20	6x20	6x20						
3	4	3	3	3						

Addendum No. 01
 ID 6280-02-74
 Added Sheet 14B
 May 26, 2021

PROJECT NO: 6280-02-74
 HWY: 5TH 66
 COUNTY: PORTAGE
 TRAFFIC SIGNAL PLAN - SEQUENCE OF OPERATION

PLOT DATE: 5/25/2021 9:27 AM
 PLOT BY: CHRISTIANSON, ERIN M

PLOT SCALE: 1 IN=40 FT
 WISDOT/CADDS SHEET 42

ASPHALTIC SURFACE TEMPORARY

STATION - STATION	LOCATION	TON	REMARKS
465.0125			
61+20EB - 173+88WB	STH 66 (EB)	126	SHLD WIDENING
165+54WB - 177+00WB	STH 66 (WB)	117	SHLD WIDENING
TOTAL		243	

WATER

STATION - STATION	LOCATION	MGAL	SEED	MGAL	REMARKS
624.0100		630.0500			
45+0EB - 68+75EB	STH 66 (EB)	12	---		
61+20WB - 173+88WB	STH 66 (EB)	---	5		
145+00WB - 168+55WB	STH 66 (WB)	13	---		
165+54WB - 177+00WB	STH 66 (WB)	---	6		
DUST CONTROL	PROJECT LIMITS	5	---		
UNDISTRIBUTED	PROJECT LIMITS	5	4		
TOTALS		35	15		

Addendum No. 01
ID 6280-02-74
Revised Sheet 51
May 26, 2021

CONCRETE CURB & GUTTER

STATION - STATION	LOCATION	LF	EACH	REMARKS
601.0407		416.0610		
148+89WB - 149+04WB	STH 66 MEDIAN	15	4	
150+00WB - 50+07EB	STH 66 MEDIAN	29	8	
50+51EB - 50+67EB	STH 66 MEDIAN	16	4	
153+41WB - 153+51WB	STH 66 MEDIAN	10	2	
53+74EB - 153+88WB	STH 66 MEDIAN	32	9	
154+55WB - 55+03EB	STH 66 MEDIAN	59	18	
155+97WB - 156+12WB	STH 66 MEDIAN	15	4	
157+13WB - 157+23WB	STH 66 MEDIAN	10	2	
159+00WB - 159+10WB	STH 66 MEDIAN	10	2	
159+90WB - 160+10WB	STH 66 MEDIAN	20	5	
61+27EB - 161+17WB	STH 66 MEDIAN	62	19	
63+33EB - 163+17WB	STH 66 MEDIAN	49	15	
163+94WB - 64+26EB	STH 66 MEDIAN	48	15	
UNDISTRIBUTED	STH 66 MEDIAN	300	100	
TOTALS		675	207	

18-INCH DRILLED
TYPE D
TIE BARS

BASE AGGREGATE DENSE

STATION - STATION	LOCATION	TON	REMARKS
305.0110		305.0120	
3/4-INCH	1 1/4-INCH		
45+00EB - 61+20EB	STH 66 (EB)	45	---
45+00EB - 64+25EB	STH 66 (EB)	---	504
45+00EB - 68+75EB	STH 66 (EB)	---	528
61+20EB - 173+88WB	STH 66 (EB)	232	166
145+00WB - 165+54WB	STH 66 (WB)	57	---
145+00WB - 166+00WB	STH 66 (WB)	---	502
145+00WB - 168+56WB	STH 66 (WB)	---	604
165+54WB - 177+00WB	STH 66 (WB)	207	149
TOTALS		541	2453

TACK COAT

STATION - STATION	LOCATION	GAL	REMARKS
455.0605			
45+00EB - 64+26EB	STH 66 (EB)	302	INSIDE LANE
45+00EB - 68+75EB	STH 66 (EB)	317	OUTSIDE LANE
45+00EB - 68+75EB	STH 66 (EB)	144	SHOULDER
145+00WB - 166+00WB	STH 66 (WB)	301	OUTSIDE LANE
145+00WB - 168+56WB	STH 66 (WB)	363	INSIDE LANE
145+00WB - 168+56WB	STH 66 (WB)	113	SHOULDER
TOTAL		1540	

HMA PAVEMENT

STATION - STATION	LOCATION	TON	REMARKS
460.6223		460.6224	460.6424
3 MT 58-28 S 4 MT 58-28 S 4 MT 58-28 H			
45+00EB - 64+26EB	STH 66 (EB)	761	296
45+00EB - 68+75EB	STH 66 (EB)	799	311
45+00EB - 68+75EB	STH 66 (EB)	363	282
145+00WB - 166+00WB	STH 66 (WB)	758	295
145+00WB - 168+56WB	STH 66 (WB)	914	355
145+00WB - 168+56WB	STH 66 (WB)	285	222
TOTALS		3880	1257

CONSTRUCTION STAKING

STATION - STATION	LOCATION	LF	LS	LF	REMARKS
45+00EB - 64+25EB	STH 66 (EB)	1926	---	---	INSIDE LANE
45+00EB - 68+75EB	STH 66 (EB)	2375	---	---	OUTSIDE LANE
61+20EB - 173+88WB	STH 66 (EB)	1284	---	1284	SHLD WIDENING
65+25EB - 69+25EB	STH 66 (EB)	400	---	---	---
145+00WB - 166+00WB	STH 66 (WB)	2100	---	---	OUTSIDE LANE
145+00WB - 168+56WB	STH 66 (WB)	2356	---	---	INSIDE LANE
165+00WB - 169+00WB	STH 66 (WB)	400	---	---	---
165+54WB - 177+00WB	STH 66 (WB)	1146	---	1146	SHLD WIDENING
PROJECT LIMITS	STH 66	---	1	---	---
TOTALS		11187	1	2430	

650.9910 SUPPLEMENTAL CONTROL STAKES (6600-00-61)

650.8000 RESURFACING REFERENCES

650.5000 BASE REFERENCES

650.9920 SLOPE STAKES

650.9920 SUPPLEMENTAL CONTROL STAKES

650.9920 SLOPE STAKES

650.9920 SUPPLEMENTAL CONTROL STAKES

650.9920 SLOPE STAKES

650.9920 SUPPLEMENTAL CONTROL STAKES

650.9920 SLOPE STAKES

650.9920 SUPPLEMENTAL CONTROL STAKES

650.9920 SLOPE STAKES

650.9920 SUPPLEMENTAL CONTROL STAKES

650.9920 SLOPE STAKES

650.9920 SUPPLEMENTAL CONTROL STAKES

REMOVE AND REINSTALL LOOP DETECTOR, WIRE AND LEAD-IN CABLE

STATION	LOCATION	LS	REMARKS
146+17WB	STH 66 (WB)	1	LOOP 21
TOTAL		1	

SPV.0105.01 STATION 146+17WB

SPV.0105.01 STATION 146+17WB

SPV.0105.01 STATION 146+17WB

SPV.0105.01 STATION 146+17WB

SPV.0105.01 STATION 146+17WB

SPV.0105.01 STATION 146+17WB

SPV.0105.01 STATION 146+17WB

SPV.0105.01 STATION 146+17WB

SPV.0105.01 STATION 146+17WB

SPV.0105.01 STATION 146+17WB

SPV.0105.01 STATION 146+17WB

SPV.0105.01 STATION 146+17WB

SPV.0105.01 STATION 146+17WB

SPV.0105.01 STATION 146+17WB

SPV.0105.01 STATION 146+17WB

SPV.0105.01 STATION 146+17WB

SPV.0105.01 STATION 146+17WB

SPV.0105.01 STATION 146+17WB

SPV.0105.01 STATION 146+17WB

SPV.0105.01 STATION 146+17WB

SPV.0105.01 STATION 146+17WB

SPV.0105.01 STATION 146+17WB

SPV.0105.01 STATION 146+17WB

SPV.0105.01 STATION 146+17WB

SPV.0105.01 STATION 146+17WB

SPV.0105.01 STATION 146+17WB

SPV.0105.01 STATION 146+17WB

SPV.0105.01 STATION 146+17WB

SPV.0105.01 STATION 146+17WB

SPV.0105.01 STATION 146+17WB

SPV.0105.01 STATION 146+17WB

SPV.0105.01 STATION 146+17WB

SPV.0105.01 STATION 146+17WB

SPV.0105.01 STATION 146+17WB

SPV.0105.01 STATION 146+17WB

SPV.0105.01 STATION 146+17WB

SPV.0105.01 STATION 146+17WB

SPV.0105.01 STATION 146+17WB

SPV.0105.01 STATION 146+17WB

SPV.0105.01 STATION 146+17WB

SPV.0105.01 STATION 146+17WB

SPV.0105.01 STATION 146+17WB

SPV.0105.01 STATION 146+17WB

SPV.0105.01 STATION 146+17WB

SPV.0105.01 STATION 146+17WB

SPV.0105.01 STATION 146+17WB

SPV.0105.01 STATION 146+17WB

SPV.0105.01 STATION 146+17WB

SAWING

STATION - STATION	LOCATION	LF	REMARKS
45+00EB - 68+75EB	STH 66 (EB)	185	4047
145+00WB - 168+56WB	STH 66 (WB)	175	5181
148+89WB - 149+04WB	STH 66 MEDIAN	---	18
150+00WB - 50+07EB	STH 66 MEDIAN	---	38
50+51EB - 50+67EB	STH 66 MEDIAN	---	16
153+41WB - 153+51WB	STH 66 MEDIAN	---	10
53+74EB - 153+88WB	STH 66 MEDIAN	---	42
154+55WB - 55+03EB	STH 66 MEDIAN	---	67
155+97WB - 156+12WB	STH 66 MEDIAN	---	15
157+13WB - 157+23WB	STH 66 MEDIAN	---	10
159+00WB - 159+10WB	STH 66 MEDIAN	---	20
159+90WB - 160+10WB	STH 66 MEDIAN	---	74
61+27EB - 161+17WB	STH 66 MEDIAN	---	49
63+33EB - 163+17WB	STH 66 MEDIAN	---	48
163+94WB - 64+26EB	STH 66 MEDIAN	---	450
UNDISTRIBUTED	STH 66 MEDIAN	---	450
TOTALS		360	10095

690.0150 ASPHALT CONCRETE

690.0250 CONCRETE

690.0150 ASPHALT CONCRETE

690.0150 ASPHALT CONCRETE

690.0150 ASPHALT CONCRETE

690.0150 ASPHALT CONCRETE

690.0150 ASPHALT CONCRETE

690.0150 ASPHALT CONCRETE

690.0150 ASPHALT CONCRETE

690.0150 ASPHALT CONCRETE

690.0150 ASPHALT CONCRETE

690.0150 ASPHALT CONCRETE

690.0150 ASPHALT CONCRETE

690.0150 ASPHALT CONCRETE

690.0150 ASPHALT CONCRETE

690.0150 ASPHALT CONCRETE

690.0150 ASPHALT CONCRETE

690.0150 ASPHALT CONCRETE

690.0150 ASPHALT CONCRETE

690.0150 ASPHALT CONCRETE

690.0150 ASPHALT CONCRETE

690.0150 ASPHALT CONCRETE

690.0150 ASPHALT CONCRETE

690.0150 ASPHALT CONCRETE

690.0150 ASPHALT CONCRETE

690.0150 ASPHALT CONCRETE

690.0150 ASPHALT CONCRETE

690.0150 ASPHALT CONCRETE

690.0150 ASPHALT CONCRETE

690.0150 ASPHALT CONCRETE

Addendum No. 01
ID 6280-02-74
Revised Sheet 56
May 26, 2021



Proposal Schedule of Items

Proposal ID: 20210608008 Project(s): 6280-02-74

Federal ID(s): WISC 2021409

SECTION: 0001 Roadway Items

Alt Set ID: Alt Mbr ID:

Proposal Line Number	Item ID Description	Approximate Quantity and Units	Unit Price	Bid Amount
0002	204.0100 Removing Concrete Pavement	12,827.000 SY	_____.	_____.
0004	204.0110 Removing Asphaltic Surface	6,196.000 SY	_____.	_____.
0006	204.0150 Removing Curb & Gutter	714.000 LF	_____.	_____.
0008	205.0100 Excavation Common	240.000 CY	_____.	_____.
0010	211.0100 Prepare Foundation for Asphaltic Paving (project) 01. 6280-02-74	LS	LUMP SUM	_____.
0012	211.0400 Prepare Foundation for Asphaltic Shoulders	48.000 STA	_____.	_____.
0014	213.0100 Finishing Roadway (project) 01. 6280- 02-74	1.000 EACH	_____.	_____.
0016	305.0110 Base Aggregate Dense 3/4-Inch	541.000 TON	_____.	_____.
0018	305.0120 Base Aggregate Dense 1 1/4-Inch	2,453.000 TON	_____.	_____.
0022	455.0605 Tack Coat	1,540.000 GAL	_____.	_____.
0024	460.2000 Incentive Density HMA Pavement	3,610.000 DOL	1.00000	3,610.00
0026	460.6223 HMA Pavement 3 MT 58-28 S	3,880.000 TON	_____.	_____.
0028	460.6224 HMA Pavement 4 MT 58-28 S	504.000 TON	_____.	_____.
0030	460.6424 HMA Pavement 4 MT 58-28 H	1,257.000 TON	_____.	_____.
0032	465.0125 Asphaltic Surface Temporary	243.000 TON	_____.	_____.
0036	618.0100 Maintenance And Repair of Haul Roads (project) 01. 6280-02-74	1.000 EACH	_____.	_____.



Proposal Schedule of Items

Proposal ID: 20210608008 Project(s): 6280-02-74

Federal ID(s): WISC 2021409

SECTION: 0001 Roadway Items

Alt Set ID: Alt Mbr ID:

Proposal Line Number	Item ID Description	Approximate Quantity and Units	Unit Price	Bid Amount
0038	619.1000 Mobilization	1.000 EACH	_____.	_____.
0040	620.0300 Concrete Median Sloped Nose	166.000 SF	_____.	_____.
0042	624.0100 Water	35.000 MGAL	_____.	_____.
0044	625.0100 Topsoil	2,240.000 SY	_____.	_____.
0046	628.1905 Mobilizations Erosion Control	2.000 EACH	_____.	_____.
0048	628.1910 Mobilizations Emergency Erosion Control	2.000 EACH	_____.	_____.
0050	628.2008 Erosion Mat Urban Class I Type B	2,240.000 SY	_____.	_____.
0052	628.7015 Inlet Protection Type C	2.000 EACH	_____.	_____.
0054	628.7555 Culvert Pipe Checks	20.000 EACH	_____.	_____.
0056	629.0210 Fertilizer Type B	1.340 CWT	_____.	_____.
0058	630.0140 Seeding Mixture No. 40	40.400 LB	_____.	_____.
0060	630.0500 Seed Water	15.000 MGAL	_____.	_____.
0062	634.0614 Posts Wood 4x6-Inch X 14-FT	4.000 EACH	_____.	_____.
0064	634.0616 Posts Wood 4x6-Inch X 16-FT	7.000 EACH	_____.	_____.
0066	638.2102 Moving Signs Type II	9.000 EACH	_____.	_____.
0068	642.5201 Field Office Type C	1.000 EACH	_____.	_____.
0070	643.0300 Traffic Control Drums	4,969.000 DAY	_____.	_____.



Proposal Schedule of Items

Proposal ID: 20210608008 Project(s): 6280-02-74

Federal ID(s): WISC 2021409

SECTION: 0001 Roadway Items

Alt Set ID: Alt Mbr ID:

Proposal Line Number	Item ID Description	Approximate Quantity and Units	Unit Price	Bid Amount
0072	643.0420 Traffic Control Barricades Type III	186.000 DAY	_____.	_____.
0074	643.0705 Traffic Control Warning Lights Type A	372.000 DAY	_____.	_____.
0076	643.0715 Traffic Control Warning Lights Type C	723.000 DAY	_____.	_____.
0078	643.0800 Traffic Control Arrow Boards	50.000 DAY	_____.	_____.
0080	643.0900 Traffic Control Signs	2,125.000 DAY	_____.	_____.
0082	643.0920 Traffic Control Covering Signs Type II	6.000 EACH	_____.	_____.
0084	643.1070 Traffic Control Cones 42-Inch	4,803.000 DAY	_____.	_____.
0086	643.5000 Traffic Control	1.000 EACH	_____.	_____.
0088	646.1020 Marking Line Epoxy 4-Inch	11,200.000 LF	_____.	_____.
0090	646.3545 Marking Line Grooved Wet Ref Contrast Epoxy 8-Inch	415.000 LF	_____.	_____.
0092	646.7120 Marking Diagonal Epoxy 12-Inch	160.000 LF	_____.	_____.
0094	646.9000 Marking Removal Line 4-Inch	4,755.000 LF	_____.	_____.
0096	649.0120 Temporary Marking Line Epoxy 4-Inch	1,065.000 LF	_____.	_____.
0098	649.0150 Temporary Marking Line Removable Tape 4-Inch	2,200.000 LF	_____.	_____.
0100	650.5000 Construction Staking Base	11,187.000 LF	_____.	_____.
0102	650.8000 Construction Staking Resurfacing Reference	800.000 LF	_____.	_____.



Proposal Schedule of Items

Proposal ID: 20210608008 Project(s): 6280-02-74

Federal ID(s): WISC 2021409

SECTION: 0001

Roadway Items

Alt Set ID:

Alt Mbr ID:

Proposal Line Number	Item ID Description	Approximate Quantity and Units	Unit Price	Bid Amount
0104	650.9910 Construction Staking Supplemental Control (project) 01. 6280-02-74	LS	LUMP SUM	_____.
0106	650.9920 Construction Staking Slope Stakes	2,430.000 LF	_____.	_____.
0108	690.0150 Sawing Asphalt	360.000 LF	_____.	_____.
0110	690.0250 Sawing Concrete	10,095.000 LF	_____.	_____.
0112	740.0440 Incentive IRI Ride	3,580.000 DOL	1.00000	3,580.00
0114	ASP.1T0A On-the-Job Training Apprentice at \$5.00/HR	1,200.000 HRS	5.00000	6,000.00
0116	ASP.1T0G On-the-Job Training Graduate at \$5.00/HR	600.000 HRS	5.00000	3,000.00
0118	601.0407 Concrete Curb & Gutter 18-Inch Type D	675.000 LF	_____.	_____.
0120	SPV.0105 Special 01. Remove and Reinstall Loop Detector, Wire and Lead-In Cable, Station 146+17WB	LS	LUMP SUM	_____.
Section: 0001			Total:	_____.
			Total Bid:	_____.