



Wisconsin Department of Transportation

Division of Transportation Systems Development

Bureau of Project Development
4822 Madison Yards Way, 4th Floor South
Madison, WI 53705

September 2, 2021

Telephone: (608) 266-1631
Facsimile (FAX): (608) 266-8459

NOTICE TO ALL CONTRACTORS:

Proposal #10: 2260-08-70, WISC 2021479
Durand Avenue, City of Racine
Kearney Ave to East of Memorial Drive
STH 11
Racine County

Letting of September 14, 2021

This is Addendum No. 01, which provides for the following:

Schedule of Items:

Added Bid Item Quantities					
Bid Item	Item Description	Unit	Old Quantity	Revised Quantity	Proposal Total
204.0185	Removing Masonry	CY	0	9	9

Plan Sheets:

Revised Plan Sheets	
Plan Sheet	Plan Sheet Title (brief description of changes to sheet)
49	Storm Sewer – added existing underground box culvert
154	Miscellaneous Quantities – added bid item for removing underground box culvert
197	Plan & Profile – added existing underground box culvert

Schedule of Items

Attached, dated September 2, 2021, are the revised Schedule of Items Page 13.

Plan Sheets

The following 8½ x 11-inch sheets are attached and made part of the plans for this proposal:
Revised: 49, 154, and 197.

The responsibility for notifying potential subcontractors and suppliers of these changes remains with the prime contractor.

Sincerely,

Mike Coleman

Proposal Development Specialist
Proposal Management Section

END OF ADDENDUM

Addendum No. 01
 ID 2260-08-70
 Revised Sheet 49
 September 2, 2021

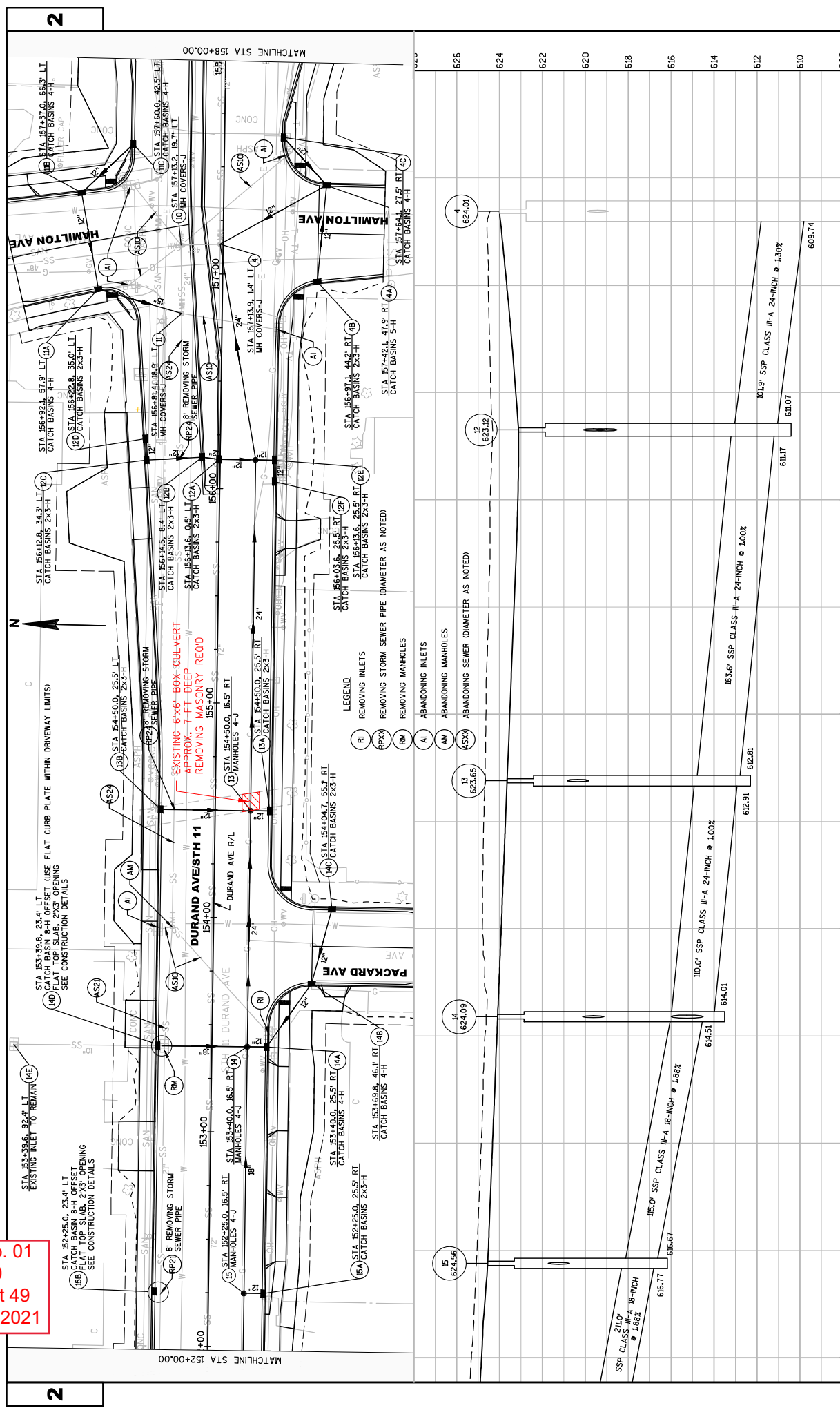

PROJECT NO: 2260-08-70	COUNTY: RACINE	STORM SEWER	SHEET 49
HWY: STH 11			
DATE: 9/2/2021 7:49 AM	PLOT NAME:	PLOT SCALE: 1 IN=40 FT	WISDOT/CADD SHEET 41
FILE NAME: T:\1\42715\3D\22600800\SSHEETS\PLAN\022501-SS.DWG	LAYOUT NAME: 022501-SS - 03		

Addendum No. 01
 ID 2260-08-70
 Revised Sheet 154
 September 2, 2021

CLEARING & GRUBBING

CATEGORY	STAGE	ROADWAY	STATION TO	STATION	LOCATION	201.0105 CLEARING	201.0205 GRUBBING
						STA	STA
0010	1	DURAND AVE	142+00 - 146+00	RT		2	4
			154+00 - 156+00	RT		2	2
TOTAL 0010						4	6

REMOVALS

CATEGORY	STAGE	ROADWAY	STATION TO	STATION	LOCATION	204.0100	204.0110	204.0115	204.0150	204.0155	204.0170	#	204.0185	204.0195	204.9165 S.01
						REMOVING CONCRETE PAVEMENT	REMOVING ASPHALTIC SURFACE	REMOVING ASPHALTIC SURFACE BUTT JOINTS	REMOVING CURB & GUTTER	REMOVING CONCRETE SIDEWALK	REMOVING FENCE		REMOVING MASONRY	REMOVING CONCRETE BASIS	REMOVING LANDSCAPING STONE
						SF	SF	SF	LF	SF	LF		CT	EACH	SF
0010	1	DURAND AVE	141+03 - 146+00	RT		1,532	-	-	-	-	5	-	-	-	-
			146+00 - 152+00	RT		2,032	-	-	60	-	292	-	-	-	-
			152+00 - 158+00	RT		2,136	256	-	-	-	-	9	-	1	-
			158+00 - 162+70	RT		1,304	56	30	266	155	-	-	-	-	467
		PACKARD AVE	49+05 - 49+50	13		-	-	-	99	-	-	-	-	-	-
		S MEMORIAL DR	76+98 - 79+25	LT		306	81	30	141	-	-	-	-	-	-
			80+75 - 81+75	LT		259	-	-	-	-	-	-	-	-	-
STAGE 1 SUBTOTAL						7,569	406	60	566	155	297	9	1	1	467
0010	2	DURAND AVE	141+03 - 146+00	LT		1,629	-	-	-	378	37	-	-	-	-
			146+00 - 152+00	LT		2,021	-	-	-	408	5	-	-	-	-
			152+00 - 158+00	LT		1,958	355	-	-	422	-	-	-	-	-
			158+00 - 162+78	LT		1,535	123	27	273	222	-	-	-	-	-
		MADISON ST	10+50 - 11+00			206	-	-	-	67	-	-	-	-	-
		HAMILTON AVE	70+65 - 71+00	NORTH		215	-	-	-	48	-	-	-	-	-
		S MEMORIAL DR	76+98 - 79+25	RT		290	316	111	146	-	-	-	-	-	-
			80+75 - 81+75	LT & RT		396	-	-	-	-	-	-	-	-	-
STAGE 2 SUBTOTAL						8,250	794	138	419	1,545	42	-	-	-	-
0010	3	DURAND AVE	158+00 - 163+75	LT & RT		99	-	-	-	82	-	-	-	-	-
		S MEMORIAL DR	76+98 - 79+25	RT		106	-	-	206	-	-	-	-	-	-
			80+75 - 81+75	RT		123	-	-	-	-	-	-	-	-	-
STAGE 3 SUBTOTAL						328	-	-	206	82	-	-	-	-	-
TOTAL 0010						16,147	1,200	198	1,191	1,782	339	9	1	1	467

ADDITIONAL QUANTITIES SHOWN ELSEWHERE. SEE "LIGHTING UNIT REMOVAL QUANTITIES" TABLE AND "TRAFFIC SIGNAL REMOVALS" TABLE.

Addendum No. 01
 ID 2260-08-70
 Revised Sheet 197
 September 2, 2021

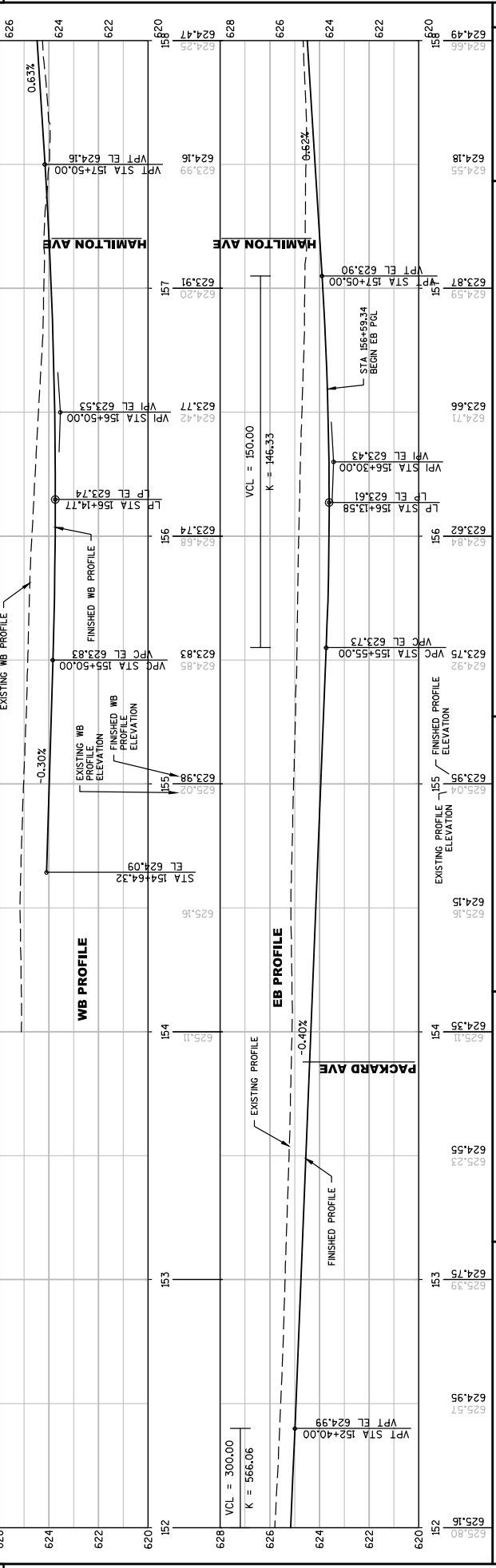
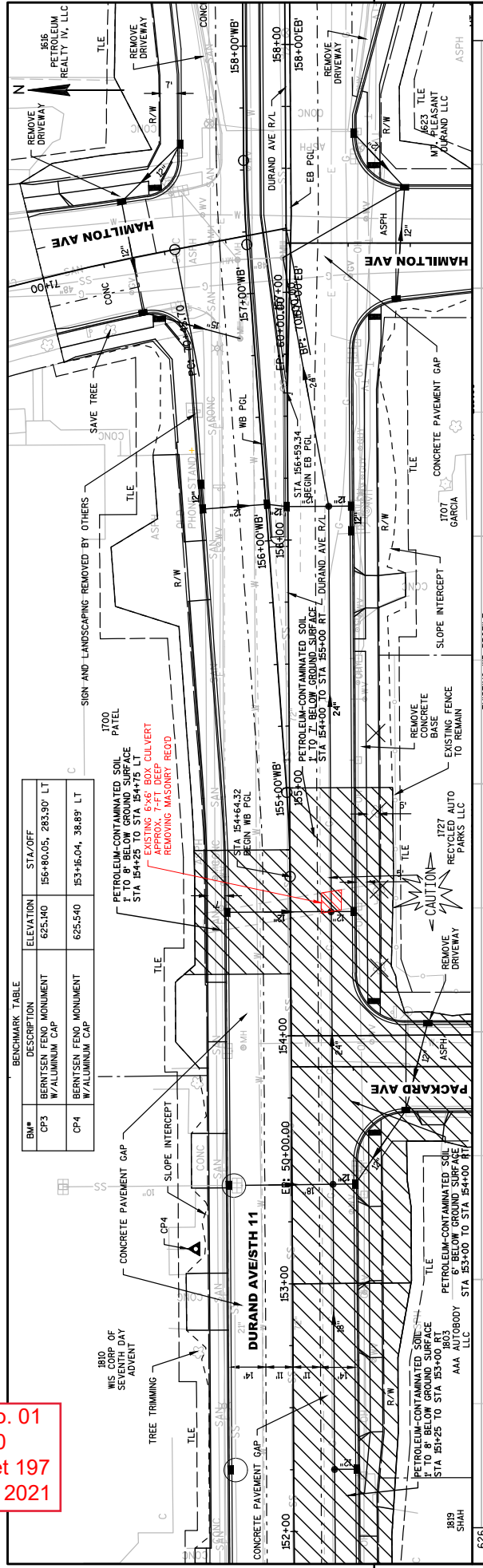



Proposal Schedule of Items

Proposal ID: 20210914010 Project(s): 2260-08-70

Federal ID(s): WISC 2021479

SECTION: 0001 Contract Items

Alt Set ID: Alt Mbr ID:

Proposal Line Number	Item ID Description	Approximate Quantity and Units	Unit Price	Bid Amount
0002	201.0105 Clearing	4.000 STA	_____.	_____.
0004	201.0205 Grubbing	6.000 STA	_____.	_____.
0006	204.0100 Removing Concrete Pavement	16,147.000 SY	_____.	_____.
0008	204.0110 Removing Asphaltic Surface	1,200.000 SY	_____.	_____.
0010	204.0115 Removing Asphaltic Surface Butt Joints	198.000 SY	_____.	_____.
0012	204.0150 Removing Curb & Gutter	1,191.000 LF	_____.	_____.
0014	204.0155 Removing Concrete Sidewalk	1,782.000 SY	_____.	_____.
0016	204.0170 Removing Fence	339.000 LF	_____.	_____.
0018	204.0195 Removing Concrete Bases	19.000 EACH	_____.	_____.
0020	204.0210 Removing Manholes	2.000 EACH	_____.	_____.
0022	204.0220 Removing Inlets	8.000 EACH	_____.	_____.
0024	204.0245 Removing Storm Sewer (size) 10. 10-Inch	78.000 LF	_____.	_____.
0026	204.0245 Removing Storm Sewer (size) 12. 12-Inch	152.000 LF	_____.	_____.
0028	204.0245 Removing Storm Sewer (size) 15. 15-Inch	57.000 LF	_____.	_____.
0030	204.0245 Removing Storm Sewer (size) 18. 18-Inch	122.000 LF	_____.	_____.



Proposal Schedule of Items

Proposal ID: 20210914010 Project(s): 2260-08-70

Federal ID(s): WISC 2021479

SECTION: 0001 Contract Items

Alt Set ID: Alt Mbr ID:

Proposal Line Number	Item ID Description	Approximate Quantity and Units	Unit Price	Bid Amount
0032	204.0245 Removing Storm Sewer (size) 21. 21-Inch	15.000 LF	_____.	_____.
0034	204.0245 Removing Storm Sewer (size) 24. 24-Inch	16.000 LF	_____.	_____.
0036	204.0250 Abandoning Manholes	4.000 EACH	_____.	_____.
0038	204.0260 Abandoning Inlets	14.000 EACH	_____.	_____.
0040	204.0280 Sealing Pipes	8.000 EACH	_____.	_____.
0042	204.0291.S Abandoning Sewer	55.000 CY	_____.	_____.
0044	204.9060.S Removing (item description) 01. Removing Lighting Units	13.000 EACH	_____.	_____.
0046	204.9105.S Removing (item description) 01. Traffic Signals STH 11 (Durand Ave) & S Memorial Dr	LS	LUMP SUM	_____.
0048	204.9105.S Removing (item description) 02. Loop Detector Wire & Lead-In Cable STH 11 (Durand Ave) & S Memorial Dr	LS	LUMP SUM	_____.
0050	204.9165.S Removing (item description) 02. Landscaping Stone STA 160+48 to STA 161+62 RT	467.000 SF	_____.	_____.
0052	205.0100 Excavation Common	21,337.000 CY	_____.	_____.
0054	205.0501.S Excavation, Hauling, and Disposal of Petroleum Contaminated Soil	2,653.000 TON	_____.	_____.
0056	210.2500 Backfill Structure Type B	18.000 TON	_____.	_____.
0058	213.0100 Finishing Roadway (project) 01. 2260- 08-70	1.000 EACH	_____.	_____.



Proposal Schedule of Items

Proposal ID: 20210914010 Project(s): 2260-08-70

Federal ID(s): WISC 2021479

SECTION: 0001 Contract Items

Alt Set ID: Alt Mbr ID:

Proposal Line Number	Item ID Description	Approximate Quantity and Units	Unit Price	Bid Amount
0060	305.0120 Base Aggregate Dense 1 1/4-Inch	9,525.000 TON	_____.	_____.
0062	310.0110 Base Aggregate Open-Graded	131.000 TON	_____.	_____.
0064	312.0110 Select Crushed Material	21,605.000 TON	_____.	_____.
0066	415.0085 Concrete Pavement 8 1/2-Inch	16,957.000 SY	_____.	_____.
0068	415.0210 Concrete Pavement Gaps	12.000 EACH	_____.	_____.
0070	415.1085 Concrete Pavement HES 8 1/2-Inch	648.000 SY	_____.	_____.
0072	415.4100 Concrete Pavement Joint Filling	21,263.000 SY	_____.	_____.
0074	415.5110.S Concrete Pavement Joint Layout	LS	LUMP SUM	_____.
0076	416.0160 Concrete Driveway 6-Inch	907.000 SY	_____.	_____.
0078	416.0610 Drilled Tie Bars	44.000 EACH	_____.	_____.
0080	416.0620 Drilled Dowel Bars	163.000 EACH	_____.	_____.
0082	455.0605 Tack Coat	78.000 GAL	_____.	_____.
0084	460.2000 Incentive Density HMA Pavement	120.000 DOL	1.00000	120.00
0086	460.5223 HMA Pavement 3 LT 58-28 S	92.000 TON	_____.	_____.
0088	460.5224 HMA Pavement 4 LT 58-28 S	94.000 TON	_____.	_____.
0090	465.0105 Asphaltic Surface	196.000 TON	_____.	_____.
0092	465.0125 Asphaltic Surface Temporary	68.000 TON	_____.	_____.



Proposal Schedule of Items

Proposal ID: 20210914010 Project(s): 2260-08-70

Federal ID(s): WISC 2021479

SECTION: 0001 Contract Items

Alt Set ID: Alt Mbr ID:

Proposal Line Number	Item ID Description	Approximate Quantity and Units	Unit Price	Bid Amount
0094	520.8000 Concrete Collars for Pipe	2.000 EACH	_____.	_____.
0096	601.0405 Concrete Curb & Gutter 18-Inch Type A	5,203.000 LF	_____.	_____.
0098	601.0407 Concrete Curb & Gutter 18-Inch Type D	417.000 LF	_____.	_____.
0100	601.0409 Concrete Curb & Gutter 30-Inch Type A	1,115.000 LF	_____.	_____.
0102	601.0411 Concrete Curb & Gutter 30-Inch Type D	64.000 LF	_____.	_____.
0104	601.0600 Concrete Curb Pedestrian	474.000 LF	_____.	_____.
0106	602.0410 Concrete Sidewalk 5-Inch	30,043.000 SF	_____.	_____.
0108	602.0505 Curb Ramp Detectable Warning Field Yellow	360.000 SF	_____.	_____.
0110	602.0605 Curb Ramp Detectable Warning Field Radial Yellow	26.000 SF	_____.	_____.
0112	602.1500 Concrete Steps	44.000 SF	_____.	_____.
0114	608.0315 Storm Sewer Pipe Reinforced Concrete Class III 15-Inch	73.700 LF	_____.	_____.
0116	608.0318 Storm Sewer Pipe Reinforced Concrete Class III 18-Inch	54.300 LF	_____.	_____.
0118	608.0412 Storm Sewer Pipe Reinforced Concrete Class IV 12-Inch	977.600 LF	_____.	_____.
0120	608.0415 Storm Sewer Pipe Reinforced Concrete Class IV 15-Inch	461.600 LF	_____.	_____.
0122	608.0418 Storm Sewer Pipe Reinforced Concrete Class IV 18-Inch	55.200 LF	_____.	_____.



Proposal Schedule of Items

Proposal ID: 20210914010 Project(s): 2260-08-70

Federal ID(s): WISC 2021479

SECTION: 0001 Contract Items

Alt Set ID: Alt Mbr ID:

Proposal Line Number	Item ID Description	Approximate Quantity and Units	Unit Price	Bid Amount
0124	608.3012 Storm Sewer Pipe Class III-A 12-Inch	54.400 LF	_____.	_____.
0126	608.3015 Storm Sewer Pipe Class III-A 15-Inch	74.500 LF	_____.	_____.
0128	608.3018 Storm Sewer Pipe Class III-A 18-Inch	494.700 LF	_____.	_____.
0130	608.3024 Storm Sewer Pipe Class III-A 24-Inch	375.500 LF	_____.	_____.
0132	611.0420 Reconstructing Manholes	8.000 EACH	_____.	_____.
0134	611.0530 Manhole Covers Type J	25.000 EACH	_____.	_____.
0136	611.0535 Manhole Covers Type J-Special	9.000 EACH	_____.	_____.
0138	611.0624 Inlet Covers Type H	50.000 EACH	_____.	_____.
0140	611.1004 Catch Basins 4-FT Diameter	18.000 EACH	_____.	_____.
0142	611.1005 Catch Basins 5-FT Diameter	1.000 EACH	_____.	_____.
0144	611.1230 Catch Basins 2x3-FT	29.000 EACH	_____.	_____.
0146	611.2004 Manholes 4-FT Diameter	13.000 EACH	_____.	_____.
0148	611.2005 Manholes 5-FT Diameter	2.000 EACH	_____.	_____.
0150	611.8110 Adjusting Manhole Covers	1.000 EACH	_____.	_____.
0152	611.8115 Adjusting Inlet Covers	1.000 EACH	_____.	_____.
0154	611.8120.S Cover Plates Temporary	2.000 EACH	_____.	_____.
0156	612.0106 Pipe Underdrain 6-Inch	600.000 LF	_____.	_____.



Proposal Schedule of Items

Proposal ID: 20210914010 Project(s): 2260-08-70

Federal ID(s): WISC 2021479

SECTION: 0001 Contract Items

Alt Set ID: Alt Mbr ID:

Proposal Line Number	Item ID Description	Approximate Quantity and Units	Unit Price	Bid Amount
0158	612.0404 Pipe Underdrain Wrapped 4-Inch	60.000 LF	_____.	_____.
0160	619.1000 Mobilization	1.000 EACH	_____.	_____.
0162	620.0200 Concrete Median Blunt Nose	64.000 SF	_____.	_____.
0164	620.0300 Concrete Median Sloped Nose	286.000 SF	_____.	_____.
0166	624.0100 Water	670.000 MGAL	_____.	_____.
0168	625.0100 Topsoil	2,536.000 SY	_____.	_____.
0170	628.1905 Mobilizations Erosion Control	5.000 EACH	_____.	_____.
0172	628.1910 Mobilizations Emergency Erosion Control	5.000 EACH	_____.	_____.
0174	628.7005 Inlet Protection Type A	53.000 EACH	_____.	_____.
0176	628.7010 Inlet Protection Type B	6.000 EACH	_____.	_____.
0178	628.7015 Inlet Protection Type C	81.000 EACH	_____.	_____.
0180	628.7560 Tracking Pads	9.000 EACH	_____.	_____.
0182	629.0210 Fertilizer Type B	1.670 CWT	_____.	_____.
0184	631.0300 Sod Water	57.150 MGAL	_____.	_____.
0186	631.1000 Sod Lawn	2,536.000 SY	_____.	_____.
0188	632.0101 Trees (species) (size) (root) 01. Armstrong Freeman Maple, 2.5" Cal., B&B	6.000 EACH	_____.	_____.



Proposal Schedule of Items

Proposal ID: 20210914010 Project(s): 2260-08-70

Federal ID(s): WISC 2021479

SECTION: 0001 Contract Items

Alt Set ID: Alt Mbr ID:

Proposal Line Number	Item ID Description	Approximate Quantity and Units	Unit Price	Bid Amount
0190	632.0101 Trees (species) (size) (root) 02. Frontier Hybrid Elm, 2.5" Cal., B&B	2.000 EACH	_____.	_____.
0192	632.0101 Trees (species) (size) (root) 03. American Sentry Linden, 2.5" Cal., B&B	2.000 EACH	_____.	_____.
0194	632.9101 Landscape Planting Surveillance and Care Cycles	10.000 EACH	_____.	_____.
0196	634.0618 Posts Wood 4x6-Inch X 18-FT	6.000 EACH	_____.	_____.
0198	634.0814 Posts Tubular Steel 2x2-Inch X 14-FT	45.000 EACH	_____.	_____.
0200	637.2210 Signs Type II Reflective H	344.940 SF	_____.	_____.
0202	637.2215 Signs Type II Reflective H Folding	31.080 SF	_____.	_____.
0204	637.2230 Signs Type II Reflective F	45.250 SF	_____.	_____.
0206	638.2102 Moving Signs Type II	6.000 EACH	_____.	_____.
0208	638.2602 Removing Signs Type II	38.000 EACH	_____.	_____.
0210	638.3000 Removing Small Sign Supports	23.000 EACH	_____.	_____.
0212	643.0300 Traffic Control Drums	35,725.000 DAY	_____.	_____.
0214	643.0410 Traffic Control Barricades Type II	950.000 DAY	_____.	_____.
0216	643.0420 Traffic Control Barricades Type III	9,966.000 DAY	_____.	_____.
0218	643.0500 Traffic Control Flexible Tubular Marker Posts	277.000 EACH	_____.	_____.



Proposal Schedule of Items

Proposal ID: 20210914010 Project(s): 2260-08-70

Federal ID(s): WISC 2021479

SECTION: 0001 Contract Items

Alt Set ID: Alt Mbr ID:

Proposal Line Number	Item ID Description	Approximate Quantity and Units	Unit Price	Bid Amount
0220	643.0600 Traffic Control Flexible Tubular Marker Bases	277.000 EACH	_____.	_____.
0222	643.0705 Traffic Control Warning Lights Type A	20,920.000 DAY	_____.	_____.
0224	643.0715 Traffic Control Warning Lights Type C	4,113.000 DAY	_____.	_____.
0226	643.0900 Traffic Control Signs	20,175.000 DAY	_____.	_____.
0228	643.1050 Traffic Control Signs PCMS	30.000 DAY	_____.	_____.
0230	643.1070 Traffic Control Cones 42-Inch	7,840.000 DAY	_____.	_____.
0232	643.5000 Traffic Control	1.000 EACH	_____.	_____.
0234	644.1601 Temporary Pedestrian Curb Ramp	28.000 DAY	_____.	_____.
0236	644.1810 Temporary Pedestrian Barricade	484.000 LF	_____.	_____.
0238	645.0111 Geotextile Type DF Schedule A	269.000 SY	_____.	_____.
0240	646.1020 Marking Line Epoxy 4-Inch	8,090.000 LF	_____.	_____.
0242	646.5020 Marking Arrow Epoxy	13.000 EACH	_____.	_____.
0244	646.6120 Marking Stop Line Epoxy 18-Inch	307.000 LF	_____.	_____.
0246	646.7120 Marking Diagonal Epoxy 12-Inch	28.000 LF	_____.	_____.
0248	646.7420 Marking Crosswalk Epoxy Transverse Line 6-Inch	1,636.000 LF	_____.	_____.
0250	646.8120 Marking Curb Epoxy	54.000 LF	_____.	_____.



Proposal Schedule of Items

Proposal ID: 20210914010 Project(s): 2260-08-70

Federal ID(s): WISC 2021479

SECTION: 0001 Contract Items

Alt Set ID: Alt Mbr ID:

Proposal Line Number	Item ID Description	Approximate Quantity and Units	Unit Price	Bid Amount
0252	646.8220 Marking Island Nose Epoxy	3.000 EACH	_____.	_____.
0254	646.9000 Marking Removal Line 4-Inch	137.000 LF	_____.	_____.
0256	646.9100 Marking Removal Line 8-Inch	36.000 LF	_____.	_____.
0258	646.9200 Marking Removal Line Wide	19.000 LF	_____.	_____.
0260	649.0105 Temporary Marking Line Paint 4-Inch	3,204.000 LF	_____.	_____.
0262	649.0150 Temporary Marking Line Removable Tape 4-Inch	16,191.000 LF	_____.	_____.
0264	649.0250 Temporary Marking Line Removable Tape 8-Inch	835.000 LF	_____.	_____.
0266	649.0550 Temporary Marking Arrow Removable Tape	4.000 EACH	_____.	_____.
0268	649.0850 Temporary Marking Stop Line Removable Tape 18-Inch	88.000 LF	_____.	_____.
0270	649.0960 Temporary Marking Removable Mask Out Tape 6-Inch	762.000 LF	_____.	_____.
0272	649.0970 Temporary Marking Removable Mask Out Tape 10-Inch	130.000 LF	_____.	_____.
0274	650.4000 Construction Staking Storm Sewer	63.000 EACH	_____.	_____.
0276	650.4500 Construction Staking Subgrade	2,502.000 LF	_____.	_____.
0278	650.5500 Construction Staking Curb Gutter and Curb & Gutter	6,799.000 LF	_____.	_____.
0280	650.7000 Construction Staking Concrete Pavement	2,587.000 LF	_____.	_____.



Proposal Schedule of Items

Proposal ID: 20210914010 Project(s): 2260-08-70

Federal ID(s): WISC 2021479

SECTION: 0001 Contract Items

Alt Set ID: Alt Mbr ID:

Proposal Line Number	Item ID Description	Approximate Quantity and Units	Unit Price	Bid Amount
0282	650.8500 Construction Staking Electrical Installations (project) 01. 2260-08-70	LS	LUMP SUM	_____.
0284	650.9000 Construction Staking Curb Ramps	38.000 EACH	_____.	_____.
0286	650.9910 Construction Staking Supplemental Control (project) 01. 2260-08-70	LS	LUMP SUM	_____.
0288	650.9920 Construction Staking Slope Stakes	2,794.000 LF	_____.	_____.
0290	652.0225 Conduit Rigid Nonmetallic Schedule 40 2-Inch	2,524.000 LF	_____.	_____.
0292	652.0235 Conduit Rigid Nonmetallic Schedule 40 3-Inch	895.000 LF	_____.	_____.
0294	652.0605 Conduit Special 2-Inch	595.000 LF	_____.	_____.
0296	653.0140 Pull Boxes Steel 24x42-Inch	10.000 EACH	_____.	_____.
0298	653.0905 Removing Pull Boxes	34.000 EACH	_____.	_____.
0300	654.0101 Concrete Bases Type 1	2.000 EACH	_____.	_____.
0302	654.0105 Concrete Bases Type 5	22.000 EACH	_____.	_____.
0304	654.0120 Concrete Bases Type 10-Special	4.000 EACH	_____.	_____.
0306	654.0217 Concrete Control Cabinet Bases Type 9 Special	1.000 EACH	_____.	_____.
0308	655.0230 Cable Traffic Signal 5-14 AWG	745.000 LF	_____.	_____.
0310	655.0240 Cable Traffic Signal 7-14 AWG	362.000 LF	_____.	_____.



Proposal Schedule of Items

Proposal ID: 20210914010 Project(s): 2260-08-70

Federal ID(s): WISC 2021479

SECTION: 0001 Contract Items

Alt Set ID: Alt Mbr ID:

Proposal Line Number	Item ID Description	Approximate Quantity and Units	Unit Price	Bid Amount
0312	655.0260 Cable Traffic Signal 12-14 AWG	773.000 LF	_____.	_____.
0314	655.0290 Cable Traffic Signal 21-14 AWG	380.000 LF	_____.	_____.
0316	655.0320 Cable Type UF 2-10 AWG Grounded	571.000 LF	_____.	_____.
0318	655.0515 Electrical Wire Traffic Signals 10 AWG	861.000 LF	_____.	_____.
0320	655.0610 Electrical Wire Lighting 12 AWG	3,816.000 LF	_____.	_____.
0322	655.0635 Electrical Wire Lighting 2 AWG	16,151.000 LF	_____.	_____.
0324	656.0200 Electrical Service Meter Breaker Pedestal (location) 01. STH 11 (Durand Ave) & S Memorial Dr	LS	LUMP SUM	_____.
0326	657.0100 Pedestal Bases	2.000 EACH	_____.	_____.
0328	657.0255 Transformer Bases Breakaway 11 1/2-Inch Bolt Circle	22.000 EACH	_____.	_____.
0330	657.0322 Poles Type 5-Aluminum	22.000 EACH	_____.	_____.
0332	657.0352 Poles Type 10-Special	4.000 EACH	_____.	_____.
0334	657.0425 Traffic Signal Standards Aluminum 15-FT	2.000 EACH	_____.	_____.
0336	657.0541 Monotube Arms 40-FT-Special	2.000 EACH	_____.	_____.
0338	657.0546 Monotube Arms 45-FT-Special	2.000 EACH	_____.	_____.
0340	657.0610 Luminaire Arms Single Member 4 1/2-Inch Clamp 6-FT	27.000 EACH	_____.	_____.



Proposal Schedule of Items

Proposal ID: 20210914010 Project(s): 2260-08-70

Federal ID(s): WISC 2021479

SECTION: 0001 Contract Items

Alt Set ID: Alt Mbr ID:

Proposal Line Number	Item ID Description	Approximate Quantity and Units	Unit Price	Bid Amount
0342	657.0815 Luminaire Arms Steel 15-FT	4.000 EACH	_____.	_____.
0344	658.0173 Traffic Signal Face 3S 12-Inch	12.000 EACH	_____.	_____.
0346	658.0174 Traffic Signal Face 4S 12-Inch	8.000 EACH	_____.	_____.
0348	658.0416 Pedestrian Signal Face 16-Inch	8.000 EACH	_____.	_____.
0350	658.0500 Pedestrian Push Buttons	8.000 EACH	_____.	_____.
0352	658.5069 Signal Mounting Hardware (location) 01. STH 11 (Durand Ave) & S Memorial Dr	LS	LUMP SUM	_____.
0354	659.1125 Luminaires Utility LED C	4.000 EACH	_____.	_____.
0356	690.0150 Sawing Asphalt	1,850.000 LF	_____.	_____.
0358	690.0250 Sawing Concrete	863.000 LF	_____.	_____.
0360	715.0415 Incentive Strength Concrete Pavement	5,282.000 DOL	1.00000	5,282.00
0362	715.0710 Optimized Aggregate Gradation Incentive	16,520.000 DOL	1.00000	16,520.00
0364	740.0440 Incentive IRI Ride	11,290.000 DOL	1.00000	11,290.00
0366	ASP.1T0A On-the-Job Training Apprentice at \$5.00/HR	1,200.000 HRS	5.00000	6,000.00
0368	ASP.1T0G On-the-Job Training Graduate at \$5.00/HR	2,280.000 HRS	5.00000	11,400.00
0370	SPV.0035 Special 01. Coloring Concrete Custom Red	145.000 CY	_____.	_____.
0372	SPV.0060 Special 01. Standard LED Luminaires	27.000 EACH	_____.	_____.



Proposal Schedule of Items

Proposal ID: 20210914010 Project(s): 2260-08-70

Federal ID(s): WISC 2021479

SECTION: 0001 Contract Items

Alt Set ID: Alt Mbr ID:

Proposal Line Number	Item ID Description	Approximate Quantity and Units	Unit Price	Bid Amount
0374	SPV.0060 Special 02. Traffic Signal Controller & Cabinet STH 11 (Durand Ave) & S Memorial Dr	1.000 EACH	_____.	_____.
0376	SPV.0060 Special 03. Furnish and Install Ethernet Radio STH 11 (Durand Ave) & S Memorial Dr	1.000 EACH	_____.	_____.
0378	SPV.0060 Special 04. Catch Basins 8-FT Diameter	2.000 EACH	_____.	_____.
0380	SPV.0060 Special 05. Field Facilities Office Space	1.000 EACH	_____.	_____.
0382	SPV.0060 Special 06. Utility Line Opening	10.000 EACH	_____.	_____.
0384	SPV.0090 Special 01. Marking Contrast Epoxy 4-Inch	1,250.000 LF	_____.	_____.
0386	SPV.0090 Special 02. Marking Contrast Epoxy 8-Inch	1,186.000 LF	_____.	_____.
0388	SPV.0105 Special 01. Video Vehicle Detection System STH 11 (Durand Ave) & S Memorial Dr	LS	LUMP SUM	_____.
0390	SPV.0165 Special 01. Wall Modular Block Gravity Landscape	58.000 SF	_____.	_____.
0392	SPV.0170 Special 01. Proof Rolling	30.000 STA	_____.	_____.
0394	SPV.0180 Special 01. Shredded Hardwood Bark Mulch	20.000 SY	_____.	_____.
0396	SPV.0195 Special 01. Management of Solid Waste	104.000 TON	_____.	_____.
0398	204.0185 Removing Masonry	9.000 CY	_____.	_____.
Section: 0001			Total:	_____.

Total Bid: _____.