



Wisconsin Department of Transportation

Division of Transportation Systems Development

Bureau of Project Development
4822 Madison Yards Way, 4th Floor South
Madison, WI 53705

March 4, 2022

Telephone: (608) 266-1631
Facsimile (FAX): (608) 266-8459

NOTICE TO ALL CONTRACTORS:

Proposal #51: 5163-07-77, WISC 2022069
Genoa - Lacrosse
Sunnyside Dr to Garner Place
STH 35
La Crosse County

Letting of March 8, 2022

This is Addendum No. 02, which provides for the following:

Special Provisions:

Deleted Special Provisions	
Article No.	Description
19	Stone Ditch Checks, Item 628.7515.S

Schedule of Items:

Revised Bid Item Quantities					
Bid Item	Item Description	Unit	Old Quantity	Revised Quantity	Proposal Total
606.0200	Rip Rap Medium	CY	71	684	755
628.2006	Erosion Mat Urban Class I, Type A	SY	30,700	2,300	33,000

Added Bid Item Quantities					
Bid Item	Item Description	Unit	Old Quantity	Revised Quantity	Proposal Total
645.0120	Geotextile Fabric HR	SY	0	2,020	2,020

Deleted Bid Item Quantities					
Bid Item	Item Description	Unit	Old Quantity	Revised Quantity	Proposal Total
628.2033	Erosion Mat Class III, Type B	SY	5,250	-5,250	0
628.7515.S	Stone Ditch Checks	CY	77	-77	0
645.0130	Geotextile Fabric R	SY	930	-930	0

Plan Sheets:

Revised Plan Sheets	
Plan Sheet	Plan Sheet Title (brief description of changes to sheet)
25, 27	Construction Details (Rip rap detail at culverts was updated, rip rap detail for ditches was added, and stone ditch checks detail was removed)
80-85	Erosion Control Sheets (Revised Channel Restoration along north side of USH 14 from STA 147+00 to 162+50 LT)
329,332	Miscellaneous Quantities (Address changes noted above in Schedule of Items)

The responsibility for notifying potential subcontractors and suppliers of these changes remains with the prime contractor.

Sincerely,

Mike Coleman

Proposal Development Specialist
Proposal Management Section

ADDENDUM NO. 02

5163-07-77

March 4, 2022

Special Provisions

DELETE ARTICLE 19. STONE DITCH CHECKS

Schedule of Items

Attached, dated March 4, 2022, are the revised Schedule of Items Pages 1 – 19.

Plan Sheets

The following 8½ x 11-inch sheets are attached and made part of the plans for this proposal:
Revised: 25, 27, 80-85, 329, and 332.

END OF ADDENDUM

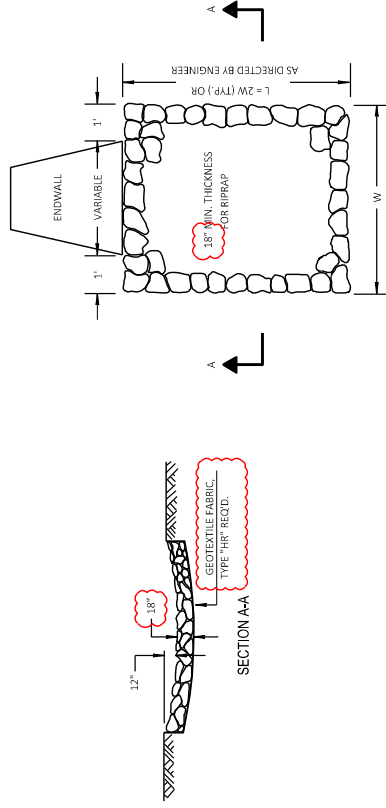

RIPRAP TREATMENT AT CULVERTS

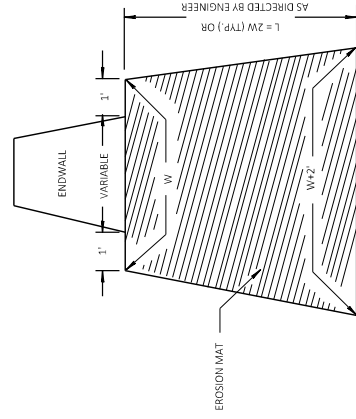

EROSION MAT TREATMENT AT CULVERTS

Addendum No. 02
 ID 5163-07-77
 Revised Sheet 25
 March 4, 2022

PROJECT NO: 5163-07-77	COUNTY: LA CROSSE	CONSTRUCTION DETAILS	SHEET 25	E
FILE NAME: N:\PDS\CD\51630703\SHETS\PLAN\5163-07-77\051001_CD.DWG	PLOT DATE: 3/2/2022 7:59 AM	PLOT BY: CORP/HBE	PLOT SCALE: 1 IN=10 FT	WISDOT/CADD/SHEET 42
LAYOUT NAME: 021001				

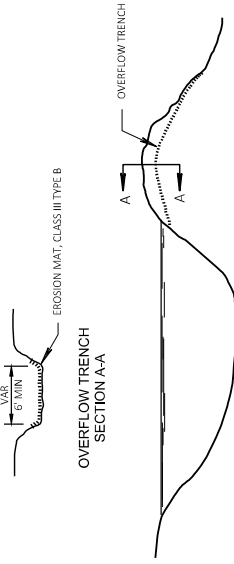

NOTE: EXCAVATION AND BACKFILL FOR SEDIMENT BASIN TO BE PAID FOR UNDER "EXCAVATION COMMON" ITEM. EXACT DIMENSIONS TO BE AS DIRECTED BY THE ENGINEER.)

CLEANING OF SEDIMENT BASINS, WHEN DIRECTED BY THE ENGINEER, IS PAID FOR UNDER THE ITEM OF "CLEANING SEDIMENT BASINS" (CY)

SEDIMENT BASIN AND OUTLET DETAIL

USH 1461 STA 153EB 924, 31 LT

Addendum No. 02
ID 5163-07-77
Revised Sheet 27
March 4, 2022

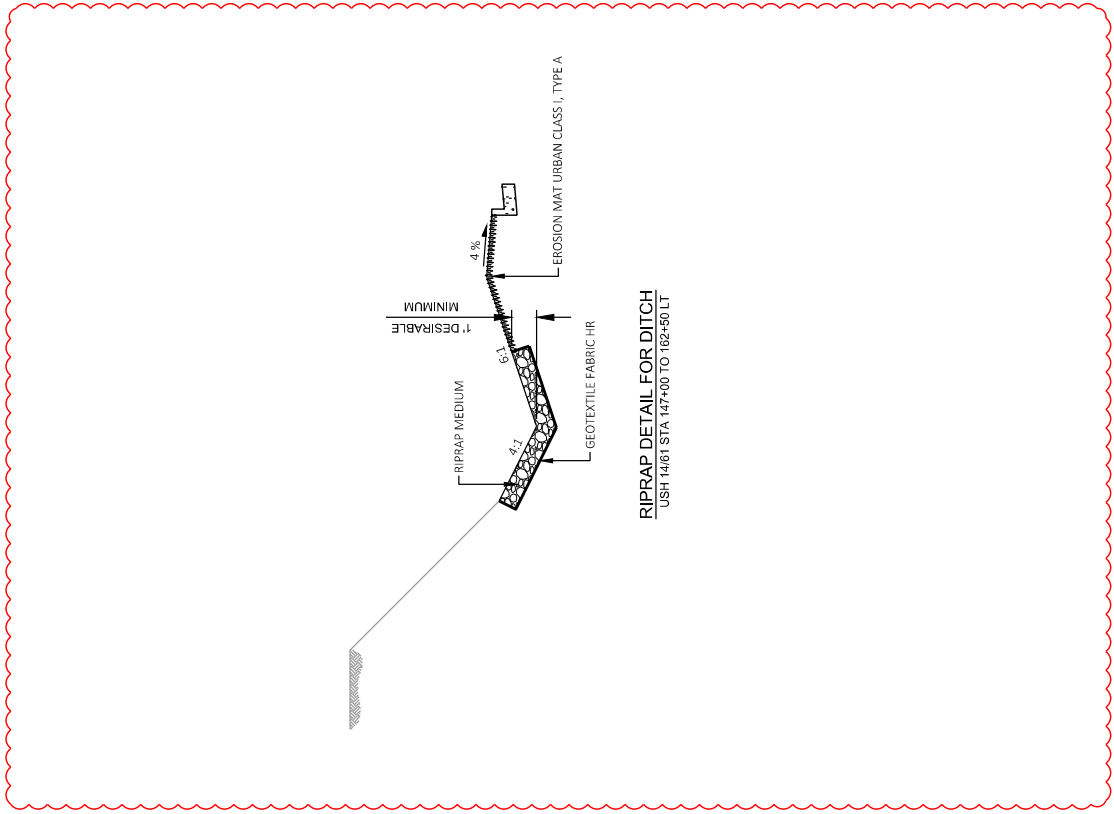
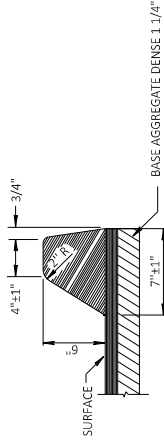

RIPRAP DETAIL FOR DITCH

USH 1461 STA 147+00 TO 162+50 LT

Addendum No. 02
 ID 5163-07-77
 Revised Sheet 80
 March 4, 2022

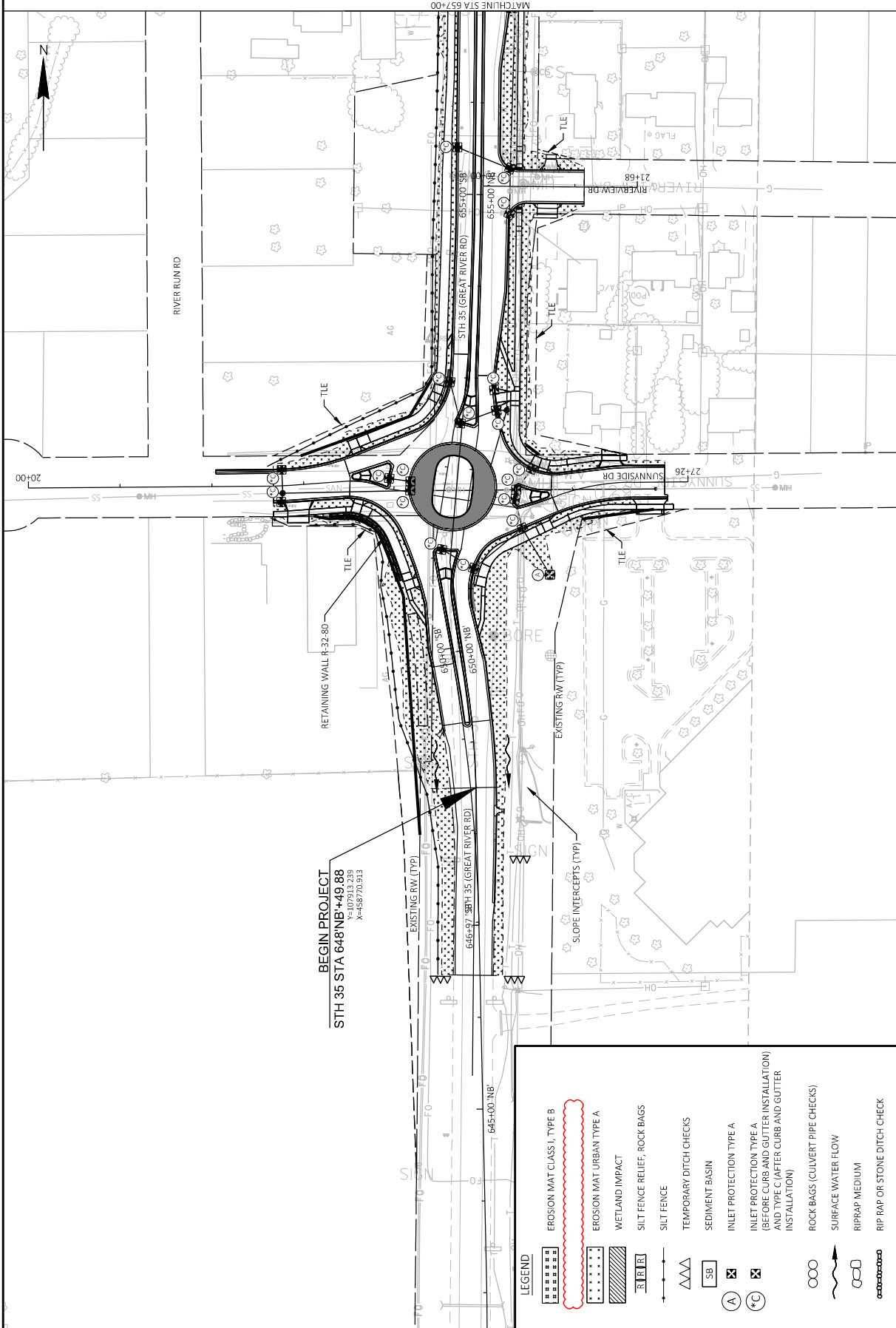

BEGIN PROJECT
 STH 35 STA 648 NB +49.88
 Y=107913.239
 X=458770.913

LEGEND

	EROSION MAT CLASS I, TYPE B
	EROSION MAT URBAN TYPE A
	WETLAND IMPACT
	SILT FENCE RELIEF, ROCK BAGS
	SILT FENCE
	TEMPORARY DITCH CHECKS
	SEDIMENT BASIN
	INLET PROTECTION TYPE A
	INLET PROTECTION TYPE A (BEFORE CURB AND GUTTER INSTALLATION) AND TYPE C (AFTER CURB AND GUTTER INSTALLATION)
	ROCK BAGS (CULVERT PIPE CHECKS)
	SURFACE WATER FLOW
	RIPRAP MEDIUM
	RIP RAP OR STONE DITCH CHECK

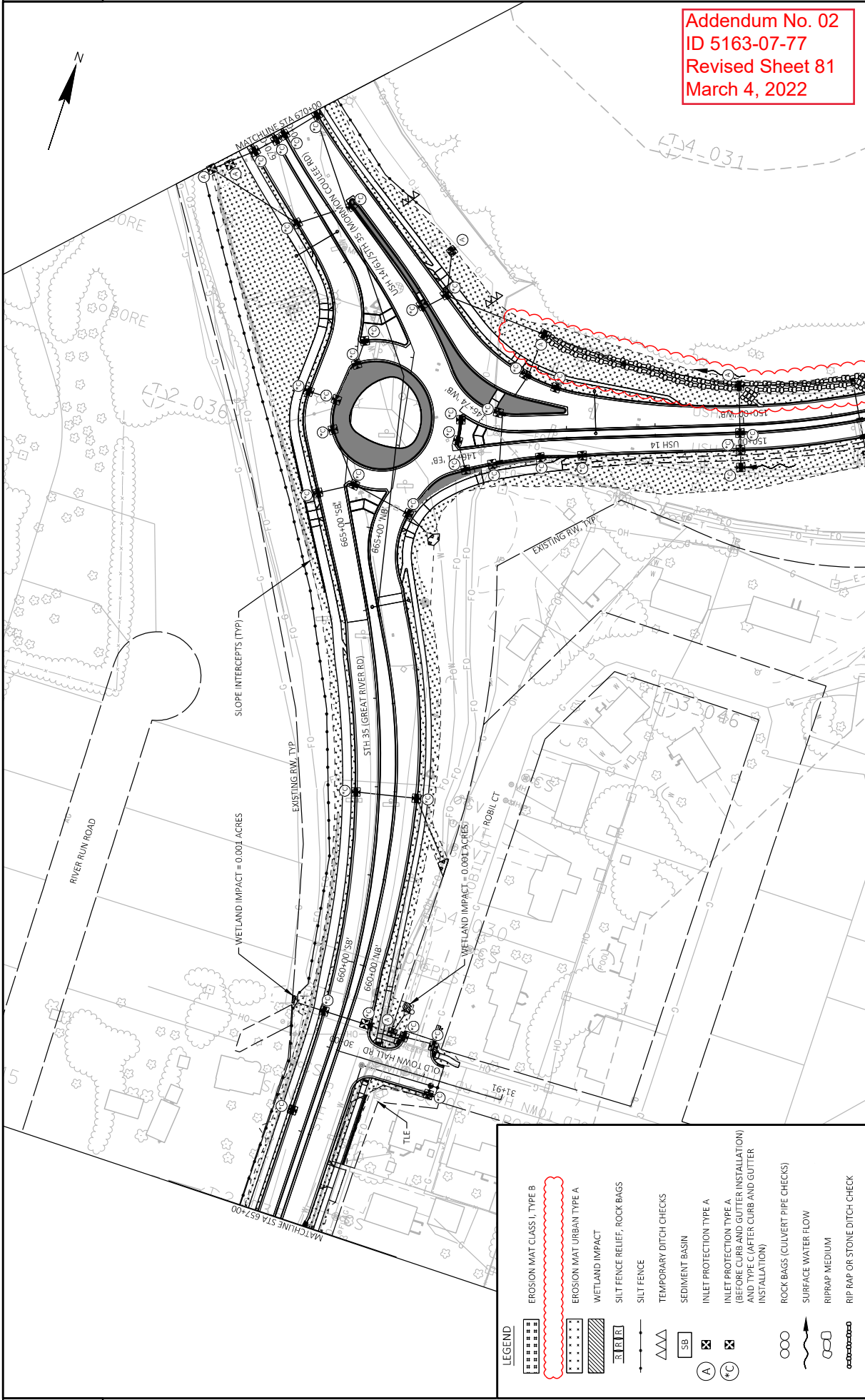

Addendum No. 02
 ID 5163-07-77
 Revised Sheet 81
 March 4, 2022

LEGEND	
[Symbol]	EROSION MAT CLASS 1, TYPE B
[Symbol]	EROSION MAT URBAN TYPE A
[Symbol]	WETLAND IMPACT
[Symbol]	SILT FENCE RELIEF, ROCK BAGS
[Symbol]	SILT FENCE
[Symbol]	TEMPORARY DITCH CHECKS
[Symbol]	SEDIMENT BASIN
[Symbol]	INLET PROTECTION TYPE A
[Symbol]	INLET PROTECTION TYPE A (BEFORE CURB AND GUTTER INSTALLATION) AND TYPE C (AFTER CURB AND GUTTER INSTALLATION)
[Symbol]	ROCK BAGS (CULVERT PIPE CHECKS)
[Symbol]	SURFACE WATER FLOW
[Symbol]	RIPRAP MEDIUM
[Symbol]	RIP RAP OR STONE DITCH CHECK

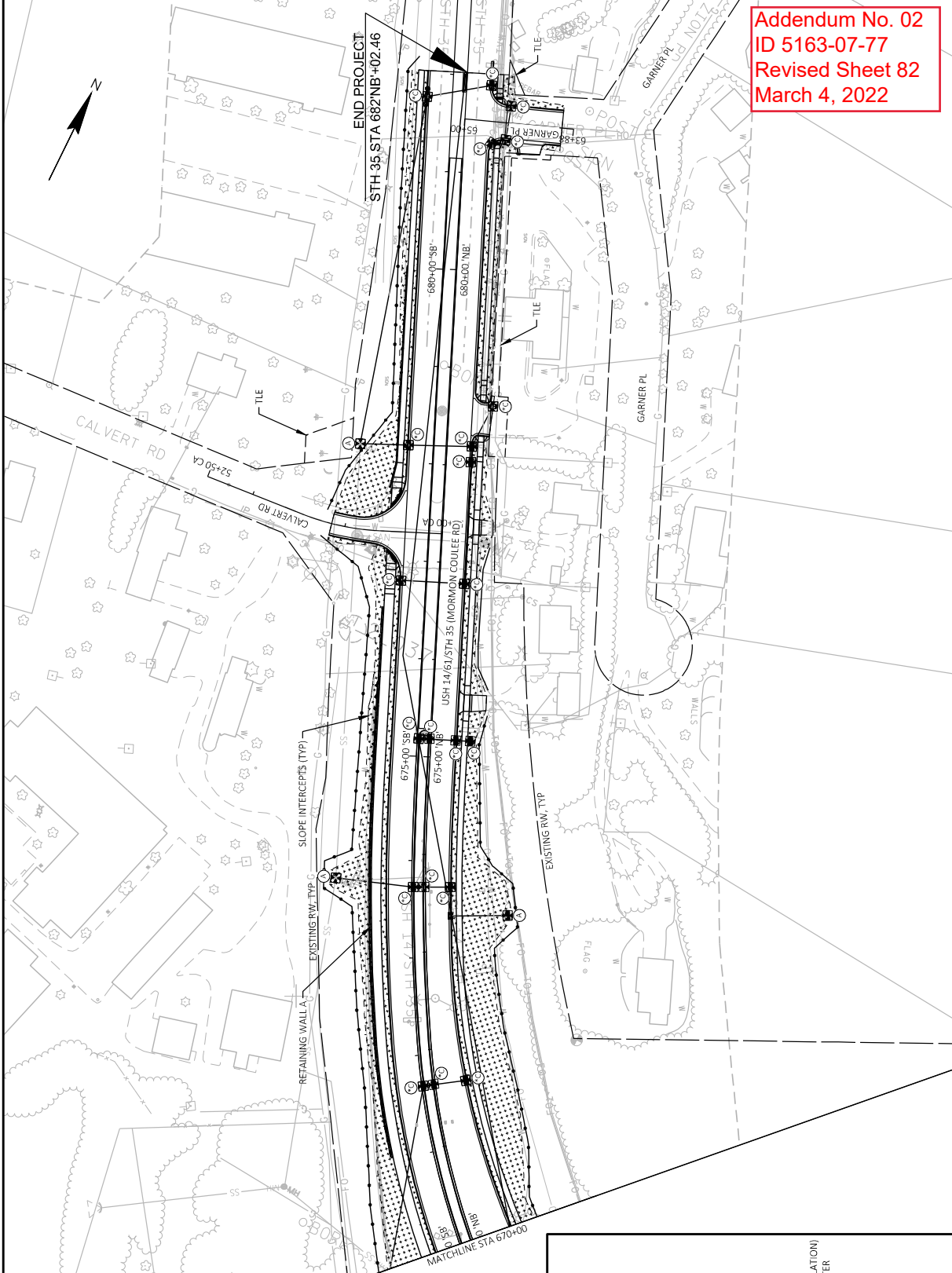

Addendum No. 02
 ID 5163-07-77
 Revised Sheet 82
 March 4, 2022

LEGEND	
	EROSION MAT CLASS 1, TYPE B
	EROSION MAT URBAN TYPE A
	WETLAND IMPACT
	SILT FENCE RELIEF, ROCK BAGS
	SILT FENCE
	TEMPORARY DITCH CHECKS
	SEDIMENT BASIN
	INLET PROTECTION TYPE A
	INLET PROTECTION TYPE A (BEFORE CURB AND GUTTER INSTALLATION) AND TYPE C (AFTER CURB AND GUTTER INSTALLATION)
	ROCK BAGS (CULVERT PIPE CHECKS)
	SURFACE WATER FLOW
	RIPRAP MEDIUM
	RIP RAP OR STONE DITCH CHECK

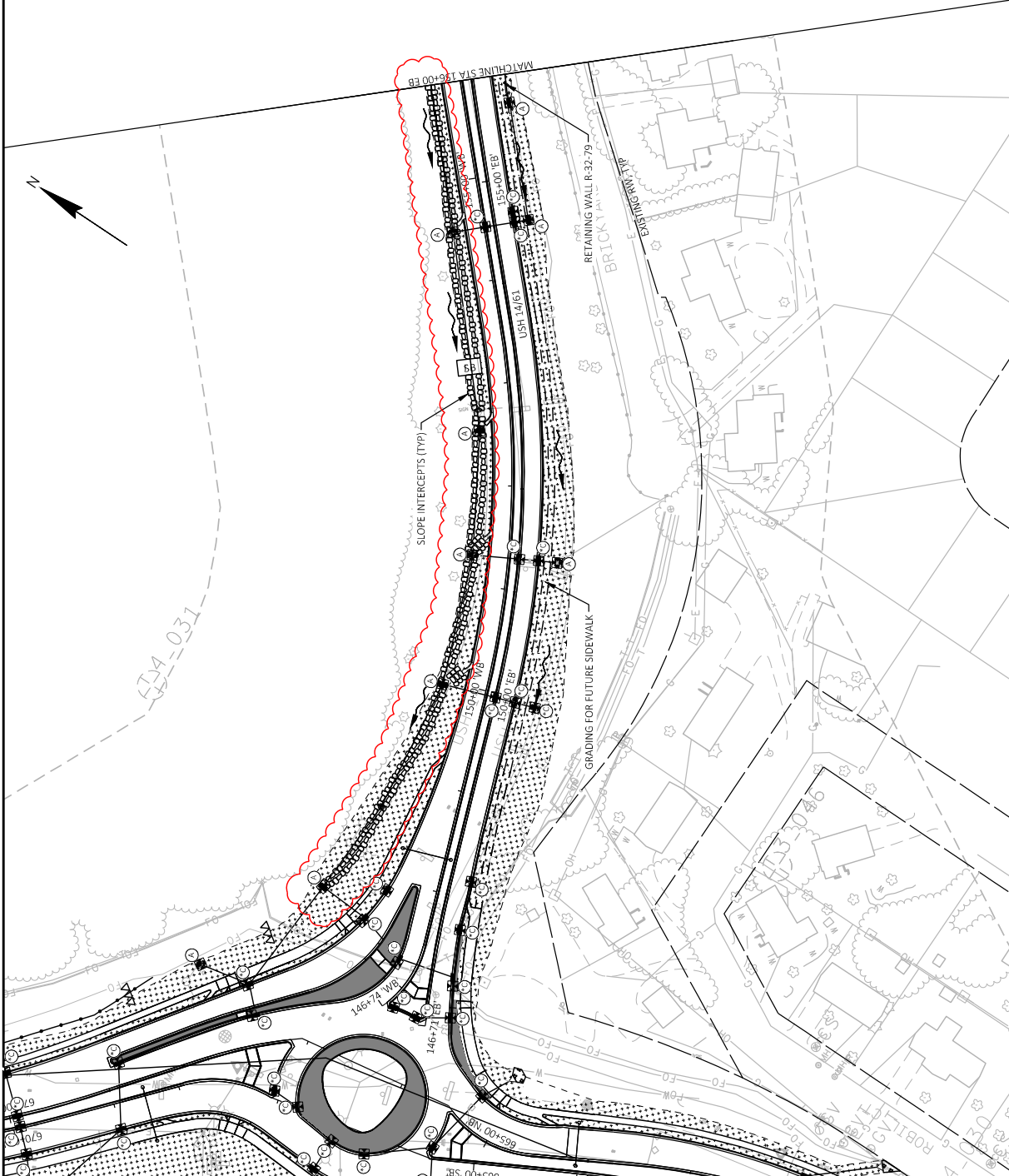

Addendum No. 02
 ID 5163-07-77
 Revised Sheet 83
 March 4, 2022

LEGEND

	EROSION MAT CLASS I, TYPE B
	EROSION MAT URBAN TYPE A
	WETLAND IMPACT
	SILT FENCE RELIEF, ROCK BAGS
	TEMPORARY DITCH CHECKS
	SEDIMENT BASIN
	INLET PROTECTION TYPE A
	INLET PROTECTION TYPE A (BEFORE CURB AND GUTTER INSTALLATION) AND TYPE C (AFTER CURB AND GUTTER INSTALLATION)
	ROCK BAGS (CULVERT PIPE CHECKS)
	SURFACE WATER FLOW
	RIPRAP MEDIUM
	RIP RAP OR STONE DITCH CHECK

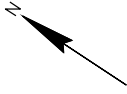

Addendum No. 02
ID 5163-07-77
Revised Sheet 84
March 4, 2022

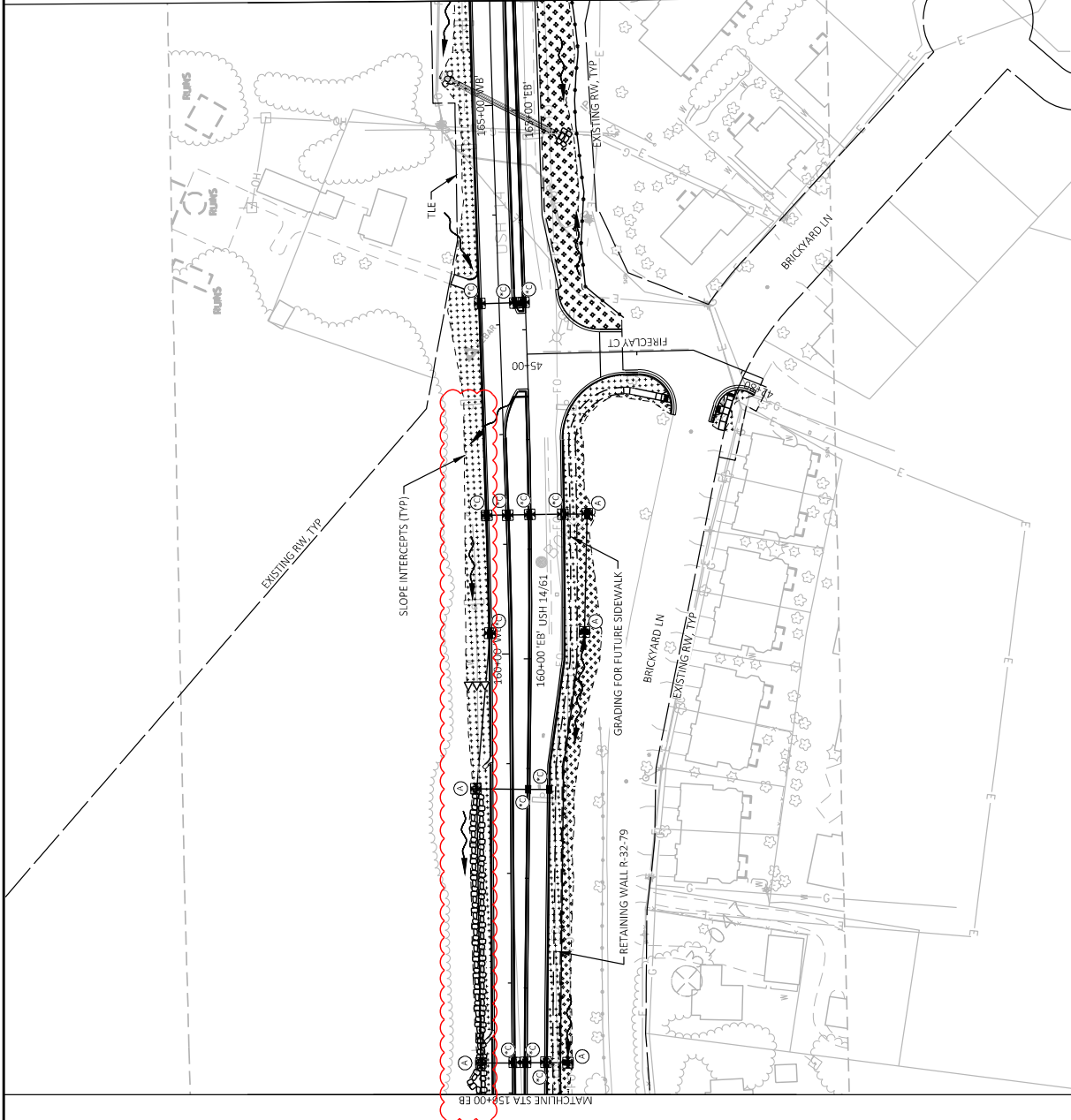

LEGEND

	EROSION MAT CLASS I, TYPE B
	EROSION MAT URBAN TYPE A
	WETLAND IMPACT
	SILT FENCE RELIEF, ROCK BAGS
	SILT FENCE
	TEMPORARY DITCH CHECKS
	SEDIMENT BASIN
	INLET PROTECTION TYPE A
	INLET PROTECTION TYPE A (BEFORE CURB AND GUTTER INSTALLATION) AND TYPE C (AFTER CURB AND GUTTER INSTALLATION)
	ROCK BAGS (CULVERT PIPE CHECKS)
	SURFACE WATER FLOW
	RIPRAP MEDIUM
	RIP RAP OR STONE DITCH CHECK

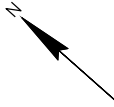

Addendum No. 02
ID 5163-07-77
Revised Sheet 85
March 4, 2022

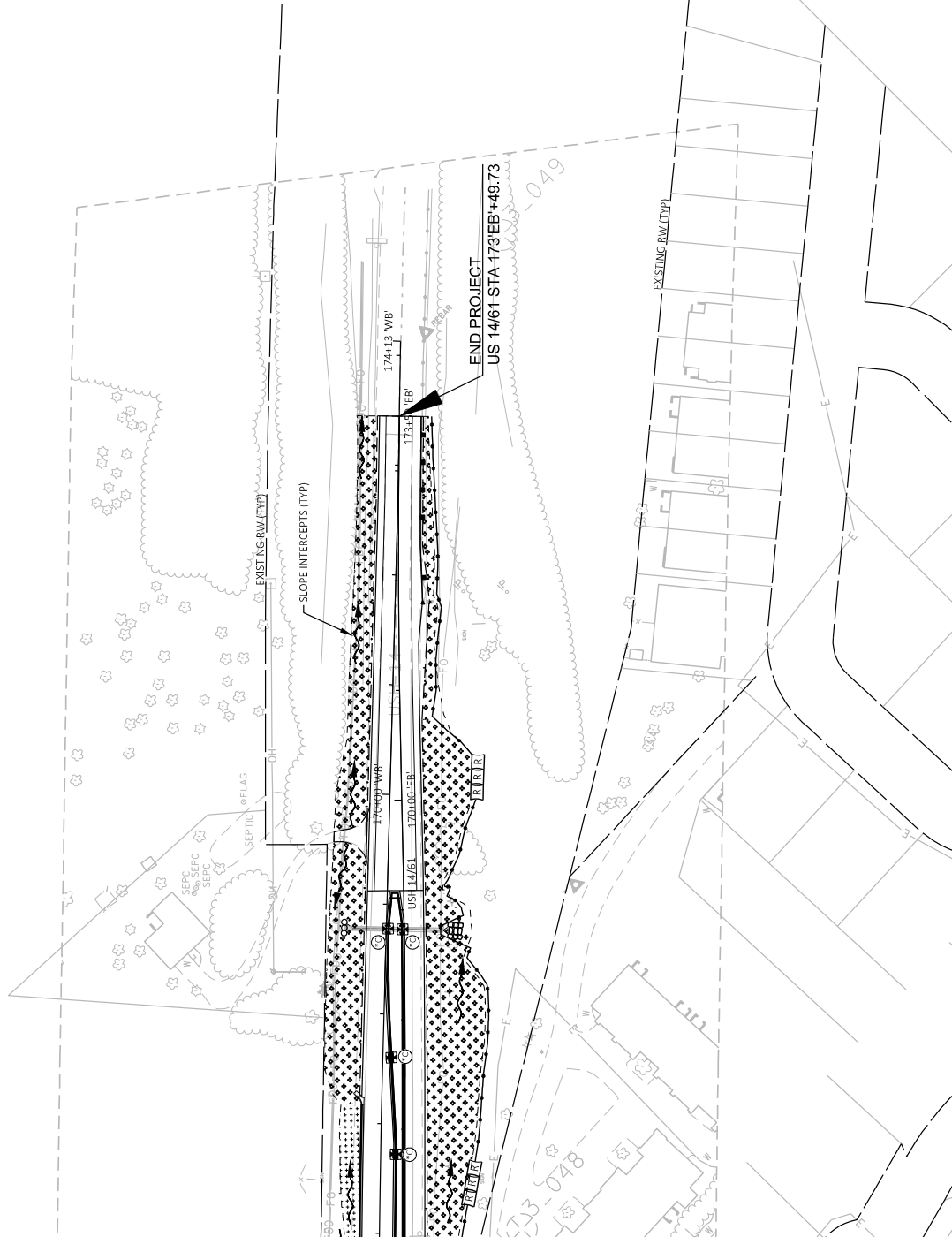

LEGEND

- EROSION MAT CLASS I, TYPE B
- EROSION MAT URBAN TYPE A
- WETLAND IMPACT
- SILT FENCE RELIEF, ROCK BAGS
- SILT FENCE
- TEMPORARY DITCH CHECKS
- SEDIMENT BASIN
- INLET PROTECTION TYPE A
- INLET PROTECTION TYPE A (BEFORE CURB AND GUTTER INSTALLATION) AND TYPE C (AFTER CURB AND GUTTER INSTALLATION)
- ROCK BAGS (CULVERT PIPE CHECKS)
- SURFACE WATER FLOW
- RIPRAP MEDIUM
- RIP RAP OR STONE DITCH CHECK

PROJECT NO: 5163-07-77

FILE NAME: N:\PDS\3\1630703\SHEETPLAN\5163-07-77\02001_EC.DWG

HWY: STH 35

COUNTY: LA CROSSE

EROSION CONTROL

FLY BY: CORP HBE

PLOT NAME:

PLOT DATE: 3/2/2022 4:11 PM

SHEET

85

E

506-RIPRAP & GEOTEXTILE

CATEGORY	STATION	TO	STATION	LOCATION	606.0200		645.0120		REMARKS
					RIPRAP MEDIUM	CY	HR	SY	
0010	164+80	-	-	28.7 RT	7	-	29	-	ENDWALL 1000
0010	168+81	-	-	35.5 RT	9	-	35	-	ENDWALL 1100
0010	149+05	-	160+48	LT	650	1	1,670	-	RIPRAP DITCH
0010	149+05	-	160+48	LT	17	-	101	-	6 CONCRETE FLUMES
0010	UNDISTRIBUTED				72	1	184	-	
	TOTAL 0010				755	2	2,020	-	

612.0406-PIPE UNDERDRAIN

CATEGORY	STATION	TO	STATION	ALIGN	LOCATION	LF	REMARKS
0010	10+00	-	14+91	WALL A	RT	491	612.0406 PIPE UNDERDRAIN WRAPPED 6- INCH
	TOTAL 0010					491	

614-BEAM GUARD

CATEGORY	STATION	TO	STATION	ALIGN	LOCATION	LF	REMARKS
STAGE 2A	673+15	-	674+36	NB	LT	153	204.0165 STEEL PLATE BEAM GUARD
STAGE 3	171+82	-	173+45	EB	RT	160	614.0305 STEEL PLATE BEAM GUARD ENERGY ABSORBING TERMINAL EACH
	TOTAL 0010					313	

Addendum No. 02
 ID 5163-07-77
 Revised Sheet 329
 March 4, 2022

CONTINUED FROM PREVIOUS PAGE

628-INLET PROTECTION

CATEGORY	STATION	LOCATION	628-7005 INLET PROTECTION		628-7015 INLET PROTECTION		STORM SEWER STRUCTURE NO.	REMARKS
			TYPE A	TYPE C	TYPE A	TYPE C		
0010	158+81	48.4 LT	1	-	1	-	410	
0010	158+81	1.5 LT	1	1	1	1	410A	
0010	158+81	17.5 RT	1	1	1	1	410B	
0010	160+23	37.8 LT	1	1	1	1	411	
0010	161+31	40.3 LT	1	1	1	1	412	
0010	161+31	21.3 LT	1	1	1	1	412B	
0010	161+31	1.6 LT	1	1	1	1	412C	
0010	161+31	29.5 RT	1	1	1	1	412D	
0010	161+31	51.0 RT	1	1	1	1	412E	
0010	163+25	41.5 LT	1	1	1	1	413	
0010	163+25	9.5 LT	1	1	1	1	413A	
0010	163+25	1.5 LT	1	1	1	1	413B	
0010	168+83	14.9 LT	1	1	1	1	1101	
0010	167+65	12.9 LT	1	1	1	1	1101A	
0010	166+77	8.8 LT	1	1	1	1	1101B	
0010	168+82	1.5 LT	1	1	1	1	1103	
TOTAL 0010			117				98	

628-7504-TEMP DITCH CHECKS

CATEGORY	STATION	TO	STATION	LOCATION	LF	REMARKS	
							628-7504 TEMPORARY DITCH CHECKS
STAGE 1	642+15	-	649+25	RT	30		
0010	200+00	-	201+50	LT/RT	30		
STAGE 2A THRU 6							
0010	646+46	-	682+02	LT/RT	50		
0010	UNDISTRIBUTED					65	
TOTAL 0010					175		

628-MOB.EC

CATEGORY	LOCATION	EACH	628-1905 MOBILIZATIONS		628-1910 MOBILIZATIONS		REMARKS
			EROSION CONTROL	EMERGENCY CONTROL	EROSION CONTROL	EMERGENCY CONTROL	
0010	PROJECT	8	8	12	8	12	
TOTAL 0010		8	8	12	8	12	

628-CULVERT PIPE CHECK

CATEGORY	STATION	LOCATION	628-7555 CULVERT PIPE CHECKS		REMARKS
			TYPE A	TYPE B	
0010	659+60	57.3 RT	3	3	ENDWALL 112
0010	165+26	25.6 LT	7	7	ENDWALL 1002
0010	168+84	46.0 LT	10	10	ENDWALL 1102
TOTAL 0010			20	20	

628-EROSION CONTROL

CATEGORY	STATION	TO	STATION	LOCATION	SY	SY	REMARKS
STAGE 1	200+09	-	204+78	LT/RT	1,565	0	
STAGE 2 THRU 6							
0010	646+46	-	651+13	LT/RT	0	4,687	BEGIN TO SUNNYSIDE
0010	652+44	-	665+51	LT/RT	30	16,741	SUNNYSIDE TO USH 14/61
0010	667+06	-	682+02	LT/RT	0	11,930	USH 14/61 TO END
0010	146+71	-	167+23	LT/RT	0	4,501	STH 35 TO END
0010	147+40	-	162+46	LT	0	0	
0010	155+58	-	173+48	LT/RT	5,822	0	
0010	10+00	-	13+83	LT	0	548	
0010	20+00	-	23+01	LT	0	177	
UNDISTRIBUTED					1,133	4,346	
TOTAL 0010					8,550	33,000	

628-SILTENCE

CATEGORY	STATION	TO	STATION	LOCATION	628-1504 SILTENCE		628-1520 SILTENCE		628-7570 ROCK BAGS EACH	REMARKS	
					LF	MAINTENANCE	LF	MAINTENANCE			
0010	646+46	-	682+02	LT	6,175	6,175	6,175	6,175	-		
0010	688+25	-	675+50	RT	715	715	715	715	-		
0010	163+08	-	173+50	RT	1,078	1,078	1,078	1,078	170		
0010	UNDISTRIBUTED					132	132	132	132	-	
TOTAL 0010					8,100	8,100	8,100	8,100	170		

Addendum No. 02
ID 5163-07-77
Revised Sheet 332
March 4, 2022



Proposal Schedule of Items

Proposal ID: 20220308051 Project(s): 5163-07-77

Federal ID(s): WISC 2022069

SECTION: 0001 Contract Items

Alt Set ID: Alt Mbr ID:

Proposal Line Number	Item ID Description	Approximate Quantity and Units	Unit Price	Bid Amount
0002	201.0105 Clearing	4.000 STA	_____.	_____.
0004	201.0205 Grubbing	4.000 STA	_____.	_____.
0006	203.0100 Removing Small Pipe Culverts	2.000 EACH	_____.	_____.
0008	204.0100 Removing Concrete Pavement	37,914.000 SY	_____.	_____.
0010	204.0110 Removing Asphaltic Surface	6,866.000 SY	_____.	_____.
0012	204.0115 Removing Asphaltic Surface Butt Joints	1,579.000 SY	_____.	_____.
0014	204.0150 Removing Curb & Gutter	5,982.000 LF	_____.	_____.
0016	204.0155 Removing Concrete Sidewalk	241.000 SY	_____.	_____.
0018	204.0157 Removing Concrete Barrier	1,245.000 LF	_____.	_____.
0020	204.0165 Removing Guardrail	313.000 LF	_____.	_____.
0022	204.0195 Removing Concrete Bases	13.000 EACH	_____.	_____.
0024	204.0210 Removing Manholes	16.000 EACH	_____.	_____.
0026	204.0220 Removing Inlets	61.000 EACH	_____.	_____.
0028	204.0245 Removing Storm Sewer (size) 01. 6-Inch	192.000 LF	_____.	_____.
0030	204.0245 Removing Storm Sewer (size) 02. 8-Inch	28.000 LF	_____.	_____.
0032	204.0245 Removing Storm Sewer (size) 03. 12-Inch	1,819.000 LF	_____.	_____.



Proposal Schedule of Items

Proposal ID: 20220308051 Project(s): 5163-07-77

Federal ID(s): WISC 2022069

SECTION: 0001 Contract Items

Alt Set ID: Alt Mbr ID:

Proposal Line Number	Item ID Description	Approximate Quantity and Units	Unit Price	Bid Amount
0034	204.0245 Removing Storm Sewer (size) 04. 15-Inch	532.000 LF	_____.	_____.
0036	204.0245 Removing Storm Sewer (size) 05. 18-Inch	332.000 LF	_____.	_____.
0038	204.0245 Removing Storm Sewer (size) 06. 24-Inch	2,455.000 LF	_____.	_____.
0040	204.0245 Removing Storm Sewer (size) 07. 30-Inch	610.000 LF	_____.	_____.
0042	204.0245 Removing Storm Sewer (size) 08. 36-Inch	547.000 LF	_____.	_____.
0044	204.0245 Removing Storm Sewer (size) 09. 42-Inch	16.000 LF	_____.	_____.
0046	204.0246 Removing Ancillary Structure (structure) 01. S-32-5	1.000 EACH	_____.	_____.
0048	204.0246 Removing Ancillary Structure (structure) 02. S-32-4	1.000 EACH	_____.	_____.
0050	204.0280 Sealing Pipes	1.000 EACH	_____.	_____.
0052	204.9090.S Removing (item description) 01. Modular Block Gravity Wall, STA, 654+77'EX', LT	79.000 LF	_____.	_____.
0054	204.9090.S Removing (item description) 02. Modular Block Gravity Wall, STA, 655+79'EX', LT	354.000 LF	_____.	_____.
0056	204.9090.S Removing (item description) 03. Modular Block Gravity Wall, STA, 662+56'EX', LT	157.000 LF	_____.	_____.
0058	204.9090.S Removing (item description) 04. Modular Block Gravity Wall, STA, 664+82'EX', LT	211.000 LF	_____.	_____.



Proposal Schedule of Items

Proposal ID: 20220308051 Project(s): 5163-07-77

Federal ID(s): WISC 2022069

SECTION: 0001 Contract Items

Alt Set ID: Alt Mbr ID:

Proposal Line Number	Item ID Description	Approximate Quantity and Units	Unit Price	Bid Amount
0060	204.9090.S Removing (item description) 05. Modular Block Gravity Wall, STA, 667+33'EX', LT	421.000 LF	_____.	_____.
0062	204.9090.S Removing (item description) 06. Modular Block Gravity Wall, STA, 671+78'EX', LT	111.000 LF	_____.	_____.
0064	204.9090.S Removing (item description) 07. Protective Railing	1,485.000 LF	_____.	_____.
0066	205.0100 Excavation Common	46,042.000 CY	_____.	_____.
0068	205.0200 Excavation Rock	175.000 CY	_____.	_____.
0070	211.0400 Prepare Foundation for Asphaltic Shoulders	38.900 STA	_____.	_____.
0072	213.0100 Finishing Roadway (project) 01. 5163-07-77	1.000 EACH	_____.	_____.
0074	305.0110 Base Aggregate Dense 3/4-Inch	4,700.000 TON	_____.	_____.
0076	305.0120 Base Aggregate Dense 1 1/4-Inch	31,328.000 TON	_____.	_____.
0078	312.0110 Select Crushed Material	1,034.000 TON	_____.	_____.
0080	405.0100 Coloring Concrete WisDOT Red	479.000 CY	_____.	_____.
0082	415.0085 Concrete Pavement 8 1/2-Inch	25,477.000 SY	_____.	_____.
0084	415.4100 Concrete Pavement Joint Filling	7,935.000 SY	_____.	_____.
0086	416.0160 Concrete Driveway 6-Inch	282.000 SY	_____.	_____.
0088	416.0512 Concrete Truck Apron 12-Inch	1,465.000 SY	_____.	_____.



Proposal Schedule of Items

Proposal ID: 20220308051 Project(s): 5163-07-77

Federal ID(s): WISC 2022069

SECTION: 0001 Contract Items

Alt Set ID: Alt Mbr ID:

Proposal Line Number	Item ID Description	Approximate Quantity and Units	Unit Price	Bid Amount
0090	416.0610 Drilled Tie Bars	4.000 EACH	_____.	_____.
0092	416.0620 Drilled Dowel Bars	39.000 EACH	_____.	_____.
0094	416.1010 Concrete Surface Drains	4.000 CY	_____.	_____.
0096	450.4000 HMA Cold Weather Paving	877.000 TON	_____.	_____.
0098	455.0605 Tack Coat	535.000 GAL	_____.	_____.
0100	460.2000 Incentive Density HMA Pavement	1,850.000 DOL	1.00000	1,850.00
0102	460.6223 HMA Pavement 3 MT 58-28 S	1,542.000 TON	_____.	_____.
0104	460.6224 HMA Pavement 4 MT 58-28 S	1,342.000 TON	_____.	_____.
0106	465.0105 Asphaltic Surface	481.000 TON	_____.	_____.
0108	465.0120 Asphaltic Surface Driveways and Field Entrances	35.000 TON	_____.	_____.
0110	465.0125 Asphaltic Surface Temporary	3,360.000 TON	_____.	_____.
0112	465.0310 Asphaltic Curb	1,293.000 LF	_____.	_____.
0114	465.0315 Asphaltic Flumes	33.000 SY	_____.	_____.
0116	511.1100 Temporary Shoring	100.000 SF	_____.	_____.
0118	511.1200 Temporary Shoring (structure) 01. R-32-079	2,100.000 SF	_____.	_____.
0120	513.8011 Railing Steel Pedestrian Type C2	1,092.000 LF	_____.	_____.



Proposal Schedule of Items

Proposal ID: 20220308051 Project(s): 5163-07-77

Federal ID(s): WISC 2022069

SECTION: 0001 Contract Items

Alt Set ID: Alt Mbr ID:

Proposal Line Number	Item ID Description	Approximate Quantity and Units	Unit Price	Bid Amount
0122	517.1010.S Concrete Staining (structure) 01. R-32-080	613.000 SF	_____.	_____.
0124	517.1015.S Concrete Staining Multi-Color (structure) 01. R-32-079	2,160.000 SF	_____.	_____.
0126	517.1015.S Concrete Staining Multi-Color (structure) 02. R-32-080	559.000 SF	_____.	_____.
0128	520.2012 Culvert Pipe Temporary 12-Inch	16.000 LF	_____.	_____.
0130	520.2015 Culvert Pipe Temporary 15-Inch	10.000 LF	_____.	_____.
0132	520.2042 Culvert Pipe Temporary 42-Inch	38.000 LF	_____.	_____.
0134	520.8000 Concrete Collars for Pipe	7.000 EACH	_____.	_____.
0136	522.1012 Apron Endwalls for Culvert Pipe Reinforced Concrete 12-Inch	1.000 EACH	_____.	_____.
0138	522.1018 Apron Endwalls for Culvert Pipe Reinforced Concrete 18-Inch	1.000 EACH	_____.	_____.
0140	522.1024 Apron Endwalls for Culvert Pipe Reinforced Concrete 24-Inch	1.000 EACH	_____.	_____.
0142	522.1030 Apron Endwalls for Culvert Pipe Reinforced Concrete 30-Inch	1.000 EACH	_____.	_____.
0144	522.1042 Apron Endwalls for Culvert Pipe Reinforced Concrete 42-Inch	2.000 EACH	_____.	_____.
0146	522.1048 Apron Endwalls for Culvert Pipe Reinforced Concrete 48-Inch	2.000 EACH	_____.	_____.
0148	531.2030 Drilling Shaft 30-Inch	68.000 LF	_____.	_____.



Proposal Schedule of Items

Proposal ID: 20220308051 Project(s): 5163-07-77

Federal ID(s): WISC 2022069

SECTION: 0001 Contract Items

Alt Set ID: Alt Mbr ID:

Proposal Line Number	Item ID Description	Approximate Quantity and Units	Unit Price	Bid Amount
0150	531.2036 Drilling Shaft 36-Inch	40.000 LF	_____.	_____.
0152	531.5410 Foundation Single-Shaft Type TF-I (structure) 01. S-32-078	2.000 EACH	_____.	_____.
0154	531.5410 Foundation Single-Shaft Type TF-I (structure) 02. S-32-079	2.000 EACH	_____.	_____.
0156	531.5420 Foundation Single-Shaft Type TF-II (structure) 01. S-32-077	2.000 EACH	_____.	_____.
0158	532.5410 Truss Full Span 2-Chord Type I (structure) 01. S-32-078	1.000 EACH	_____.	_____.
0160	532.5410 Truss Full Span 2-Chord Type I (structure) 02. S-32-079	1.000 EACH	_____.	_____.
0162	532.5420 Truss Full Span 2-Chord Type II (structure) 01. S-32-077	1.000 EACH	_____.	_____.
0164	601.0105 Concrete Curb Type A	622.000 LF	_____.	_____.
0166	601.0405 Concrete Curb & Gutter 18-Inch Type A	441.000 LF	_____.	_____.
0168	601.0409 Concrete Curb & Gutter 30-Inch Type A	14,737.000 LF	_____.	_____.
0170	601.0411 Concrete Curb & Gutter 30-Inch Type D	6,318.000 LF	_____.	_____.
0172	601.0551 Concrete Curb & Gutter 4-Inch Sloped 36-Inch Type A	1,039.000 LF	_____.	_____.
0174	601.0580 Concrete Curb & Gutter 4-Inch Sloped 36-Inch Type R	660.000 LF	_____.	_____.
0176	601.0600 Concrete Curb Pedestrian	312.000 LF	_____.	_____.
0178	602.0410 Concrete Sidewalk 5-Inch	68,270.000 SF	_____.	_____.



Proposal Schedule of Items

Proposal ID: 20220308051 Project(s): 5163-07-77

Federal ID(s): WISC 2022069

SECTION: 0001 Contract Items

Alt Set ID: Alt Mbr ID:

Proposal Line Number	Item ID Description	Approximate Quantity and Units	Unit Price	Bid Amount
0180	602.0515 Curb Ramp Detectable Warning Field Natural Patina	810.000 SF	_____.	_____.
0182	603.8000 Concrete Barrier Temporary Precast Delivered	2,800.000 LF	_____.	_____.
0184	603.8125 Concrete Barrier Temporary Precast Installed	5,700.000 LF	_____.	_____.
0186	603.8500 Anchoring Concrete Barrier Temporary Precast	1,700.000 LF	_____.	_____.
0188	606.0200 Riprap Medium	755.000 CY	_____.	_____.
0190	608.0342 Storm Sewer Pipe Reinforced Concrete Class III 42-Inch	16.000 LF	_____.	_____.
0192	608.0412 Storm Sewer Pipe Reinforced Concrete Class IV 12-Inch	537.000 LF	_____.	_____.
0194	608.0415 Storm Sewer Pipe Reinforced Concrete Class IV 15-Inch	51.000 LF	_____.	_____.
0196	608.0418 Storm Sewer Pipe Reinforced Concrete Class IV 18-Inch	230.000 LF	_____.	_____.
0198	608.0424 Storm Sewer Pipe Reinforced Concrete Class IV 24-Inch	64.000 LF	_____.	_____.
0200	608.0430 Storm Sewer Pipe Reinforced Concrete Class IV 30-Inch	294.000 LF	_____.	_____.
0202	608.0442 Storm Sewer Pipe Reinforced Concrete Class IV 42-Inch	95.000 LF	_____.	_____.
0204	608.0448 Storm Sewer Pipe Reinforced Concrete Class IV 48-Inch	83.000 LF	_____.	_____.



Proposal Schedule of Items

Proposal ID: 20220308051 Project(s): 5163-07-77

Federal ID(s): WISC 2022069

SECTION: 0001 Contract Items

Alt Set ID: Alt Mbr ID:

Proposal Line Number	Item ID Description	Approximate Quantity and Units	Unit Price	Bid Amount
0206	608.3012 Storm Sewer Pipe Class III-A 12-Inch	2,000.000 LF	_____.	_____.
0208	608.3015 Storm Sewer Pipe Class III-A 15-Inch	264.000 LF	_____.	_____.
0210	608.3018 Storm Sewer Pipe Class III-A 18-Inch	790.000 LF	_____.	_____.
0212	608.3024 Storm Sewer Pipe Class III-A 24-Inch	2,015.000 LF	_____.	_____.
0214	608.3030 Storm Sewer Pipe Class III-A 30-Inch	238.000 LF	_____.	_____.
0216	608.3036 Storm Sewer Pipe Class III-A 36-Inch	695.000 LF	_____.	_____.
0218	608.6008 Storm Sewer Pipe Composite 8-Inch	20.000 LF	_____.	_____.
0220	611.0627 Inlet Covers Type HM	8.000 EACH	_____.	_____.
0222	611.0636 Inlet Covers Type HM-S	1.000 EACH	_____.	_____.
0224	611.0642 Inlet Covers Type MS	26.000 EACH	_____.	_____.
0226	611.0651 Inlet Covers Type S	1.000 EACH	_____.	_____.
0228	611.0652 Inlet Covers Type T	5.000 EACH	_____.	_____.
0230	611.1005 Catch Basins 5-FT Diameter	9.000 EACH	_____.	_____.
0232	611.1006 Catch Basins 6-FT Diameter	6.000 EACH	_____.	_____.
0234	611.2004 Manholes 4-FT Diameter	4.000 EACH	_____.	_____.
0236	611.2005 Manholes 5-FT Diameter	3.000 EACH	_____.	_____.
0238	611.2006 Manholes 6-FT Diameter	2.000 EACH	_____.	_____.



Proposal Schedule of Items

Proposal ID: 20220308051 Project(s): 5163-07-77

Federal ID(s): WISC 2022069

SECTION: 0001 Contract Items

Alt Set ID: Alt Mbr ID:

Proposal Line Number	Item ID Description	Approximate Quantity and Units	Unit Price	Bid Amount
0240	611.2008 Manholes 8-FT Diameter	2.000 EACH	_____.	_____.
0242	611.3901 Inlets Median 1 Grate	8.000 EACH	_____.	_____.
0244	611.3902 Inlets Median 2 Grate	9.000 EACH	_____.	_____.
0246	612.0406 Pipe Underdrain Wrapped 6-Inch	1,056.000 LF	_____.	_____.
0248	614.0305 Steel Plate Beam Guard Class A	113.000 LF	_____.	_____.
0250	614.0370 Steel Plate Beam Guard Energy Absorbing Terminal	1.000 EACH	_____.	_____.
0252	614.0905 Crash Cushions Temporary	9.000 EACH	_____.	_____.
0254	618.0100 Maintenance And Repair of Haul Roads (project) 01. 5163-07-77	1.000 EACH	_____.	_____.
0256	619.1000 Mobilization	1.000 EACH	_____.	_____.
0258	620.0300 Concrete Median Sloped Nose	923.000 SF	_____.	_____.
0260	624.0100 Water	516.000 MGAL	_____.	_____.
0262	625.0500 Salvaged Topsoil	44,100.000 SY	_____.	_____.
0264	628.1504 Silt Fence	8,100.000 LF	_____.	_____.
0266	628.1520 Silt Fence Maintenance	8,100.000 LF	_____.	_____.
0268	628.1905 Mobilizations Erosion Control	8.000 EACH	_____.	_____.
0270	628.1910 Mobilizations Emergency Erosion Control	12.000 EACH	_____.	_____.



Proposal Schedule of Items

Proposal ID: 20220308051 Project(s): 5163-07-77

Federal ID(s): WISC 2022069

SECTION: 0001 Contract Items

Alt Set ID: Alt Mbr ID:

Proposal Line Number	Item ID Description	Approximate Quantity and Units	Unit Price	Bid Amount
0272	628.1920 Cleaning Sediment Basins	2.000 CY	_____.	_____.
0274	628.2004 Erosion Mat Class I Type B	8,550.000 SY	_____.	_____.
0276	628.2006 Erosion Mat Urban Class I Type A	33,000.000 SY	_____.	_____.
0280	628.7005 Inlet Protection Type A	117.000 EACH	_____.	_____.
0282	628.7015 Inlet Protection Type C	98.000 EACH	_____.	_____.
0284	628.7504 Temporary Ditch Checks	175.000 LF	_____.	_____.
0288	628.7555 Culvert Pipe Checks	20.000 EACH	_____.	_____.
0290	628.7570 Rock Bags	170.000 EACH	_____.	_____.
0292	629.0210 Fertilizer Type B	32.600 CWT	_____.	_____.
0294	630.0120 Seeding Mixture No. 20	1,212.000 LB	_____.	_____.
0296	630.0170 Seeding Mixture No. 70	4.000 LB	_____.	_____.
0298	630.0400 Seeding Nurse Crop	7.000 LB	_____.	_____.
0300	630.0500 Seed Water	1,022.000 MGAL	_____.	_____.
0302	634.0612 Posts Wood 4x6-Inch X 12-FT	2.000 EACH	_____.	_____.
0304	634.0614 Posts Wood 4x6-Inch X 14-FT	73.000 EACH	_____.	_____.
0306	634.0616 Posts Wood 4x6-Inch X 16-FT	58.000 EACH	_____.	_____.
0308	634.0618 Posts Wood 4x6-Inch X 18-FT	1.000 EACH	_____.	_____.



Proposal Schedule of Items

Proposal ID: 20220308051 Project(s): 5163-07-77

Federal ID(s): WISC 2022069

SECTION: 0001 Contract Items

Alt Set ID: Alt Mbr ID:

Proposal Line Number	Item ID Description	Approximate Quantity and Units	Unit Price	Bid Amount
0310	634.0620 Posts Wood 4x6-Inch X 20-FT	4.000 EACH	_____.	_____.
0312	634.0812 Posts Tubular Steel 2x2-Inch X 12-FT	3.000 EACH	_____.	_____.
0314	634.0814 Posts Tubular Steel 2x2-Inch X 14-FT	4.000 EACH	_____.	_____.
0316	634.0816 Posts Tubular Steel 2x2-Inch X 16-FT	5.000 EACH	_____.	_____.
0318	637.1220 Signs Type I Reflective SH	368.500 SF	_____.	_____.
0320	637.2210 Signs Type II Reflective H	897.590 SF	_____.	_____.
0322	637.2230 Signs Type II Reflective F	378.260 SF	_____.	_____.
0324	638.2102 Moving Signs Type II	19.000 EACH	_____.	_____.
0326	638.2601 Removing Signs Type I	2.000 EACH	_____.	_____.
0328	638.2602 Removing Signs Type II	82.000 EACH	_____.	_____.
0330	638.3000 Removing Small Sign Supports	88.000 EACH	_____.	_____.
0332	642.5201 Field Office Type C	1.000 EACH	_____.	_____.
0334	643.0300 Traffic Control Drums	70,300.000 DAY	_____.	_____.
0336	643.0410 Traffic Control Barricades Type II	1,000.000 DAY	_____.	_____.
0338	643.0420 Traffic Control Barricades Type III	9,200.000 DAY	_____.	_____.
0340	643.0500 Traffic Control Flexible Tubular Marker Posts	600.000 EACH	_____.	_____.



Proposal Schedule of Items

Proposal ID: 20220308051 Project(s): 5163-07-77

Federal ID(s): WISC 2022069

SECTION: 0001 Contract Items

Alt Set ID: Alt Mbr ID:

Proposal Line Number	Item ID Description	Approximate Quantity and Units	Unit Price	Bid Amount
0342	643.0600 Traffic Control Flexible Tubular Marker Bases	600.000 EACH	_____.	_____.
0344	643.0705 Traffic Control Warning Lights Type A	14,200.000 DAY	_____.	_____.
0346	643.0715 Traffic Control Warning Lights Type C	5,800.000 DAY	_____.	_____.
0348	643.0900 Traffic Control Signs	45,900.000 DAY	_____.	_____.
0350	643.0920 Traffic Control Covering Signs Type II	14.000 EACH	_____.	_____.
0352	643.1050 Traffic Control Signs PCMS	214.000 DAY	_____.	_____.
0354	643.5000 Traffic Control	1.000 EACH	_____.	_____.
0356	644.1420 Temporary Pedestrian Surface Plywood	900.000 SF	_____.	_____.
0358	644.1601 Temporary Pedestrian Curb Ramp	800.000 DAY	_____.	_____.
0360	644.1810 Temporary Pedestrian Barricade	800.000 LF	_____.	_____.
0364	646.1020 Marking Line Epoxy 4-Inch	24,376.000 LF	_____.	_____.
0366	646.3020 Marking Line Epoxy 8-Inch	2,958.000 LF	_____.	_____.
0368	646.5020 Marking Arrow Epoxy	18.000 EACH	_____.	_____.
0370	646.5120 Marking Word Epoxy	1.000 EACH	_____.	_____.
0372	646.6320 Marking Dotted Extension Epoxy 18-Inch	131.000 LF	_____.	_____.
0374	646.6464 Cold Weather Marking Epoxy 4-Inch	24,376.000 LF	_____.	_____.



Proposal Schedule of Items

Proposal ID: 20220308051 Project(s): 5163-07-77

Federal ID(s): WISC 2022069

SECTION: 0001 Contract Items

Alt Set ID: Alt Mbr ID:

Proposal Line Number	Item ID Description	Approximate Quantity and Units	Unit Price	Bid Amount
0376	646.6468 Cold Weather Marking Epoxy 8-Inch	2,958.000 LF	_____.	_____.
0378	646.7120 Marking Diagonal Epoxy 12-Inch	314.000 LF	_____.	_____.
0380	646.7420 Marking Crosswalk Epoxy Transverse Line 6-Inch	680.000 LF	_____.	_____.
0382	646.7520 Marking Crosswalk Epoxy Block Style 24-Inch	330.000 LF	_____.	_____.
0384	646.8120 Marking Curb Epoxy	120.000 LF	_____.	_____.
0386	646.8220 Marking Island Nose Epoxy	8.000 EACH	_____.	_____.
0388	646.9000 Marking Removal Line 4-Inch	19,750.000 LF	_____.	_____.
0390	646.9100 Marking Removal Line 8-Inch	4,600.000 LF	_____.	_____.
0392	649.0105 Temporary Marking Line Paint 4-Inch	53,150.000 LF	_____.	_____.
0394	649.0150 Temporary Marking Line Removable Tape 4-Inch	59,950.000 LF	_____.	_____.
0396	649.0205 Temporary Marking Line Paint 8-Inch	3,300.000 LF	_____.	_____.
0398	649.0250 Temporary Marking Line Removable Tape 8-Inch	1,900.000 LF	_____.	_____.
0400	649.0505 Temporary Marking Arrow Paint	10.000 EACH	_____.	_____.
0402	649.0550 Temporary Marking Arrow Removable Tape	5.000 EACH	_____.	_____.
0404	649.0605 Temporary Marking Word Paint	5.000 EACH	_____.	_____.



Proposal Schedule of Items

Proposal ID: 20220308051 Project(s): 5163-07-77

Federal ID(s): WISC 2022069

SECTION: 0001 Contract Items

Alt Set ID: Alt Mbr ID:

Proposal Line Number	Item ID Description	Approximate Quantity and Units	Unit Price	Bid Amount
0406	649.0650 Temporary Marking Word Removable Tape	5.000 EACH	_____.	_____.
0408	649.0805 Temporary Marking Stop Line Paint 18-Inch	240.000 LF	_____.	_____.
0410	649.0850 Temporary Marking Stop Line Removable Tape 18-Inch	70.000 LF	_____.	_____.
0412	650.4000 Construction Staking Storm Sewer	129.000 EACH	_____.	_____.
0414	650.4500 Construction Staking Subgrade	10,904.000 LF	_____.	_____.
0416	650.5000 Construction Staking Base	5,628.000 LF	_____.	_____.
0418	650.5500 Construction Staking Curb Gutter and Curb & Gutter	6,622.000 LF	_____.	_____.
0420	650.6000 Construction Staking Pipe Culverts	1.000 EACH	_____.	_____.
0422	650.6500 Construction Staking Structure Layout (structure) 01. R-32-079	LS	LUMP SUM	_____.
0424	650.6500 Construction Staking Structure Layout (structure) 02. R-32-080	LS	LUMP SUM	_____.
0426	650.6500 Construction Staking Structure Layout (structure) 03. S-32-077	LS	LUMP SUM	_____.
0428	650.6500 Construction Staking Structure Layout (structure) 04. S-32-078	LS	LUMP SUM	_____.
0430	650.6500 Construction Staking Structure Layout (structure) 05. S-32-079	LS	LUMP SUM	_____.



Proposal Schedule of Items

Proposal ID: 20220308051 Project(s): 5163-07-77

Federal ID(s): WISC 2022069

SECTION: 0001 Contract Items

Alt Set ID: Alt Mbr ID:

Proposal Line Number	Item ID Description	Approximate Quantity and Units	Unit Price	Bid Amount
0432	650.6500 Construction Staking Structure Layout (structure) 06. Wall Modular Block Mechanically Stabilized Earth Landscape, STA. 10+00'WALLA	LS	LUMP SUM	_____.
0434	650.7000 Construction Staking Concrete Pavement	5,276.000 LF	_____.	_____.
0436	650.8500 Construction Staking Electrical Installations (project) 01. 5163-07-77	LS	LUMP SUM	_____.
0438	650.9000 Construction Staking Curb Ramps	15.000 EACH	_____.	_____.
0440	650.9910 Construction Staking Supplemental Control (project) 01. 5163-07-77	LS	LUMP SUM	_____.
0442	650.9920 Construction Staking Slope Stakes	9,594.000 LF	_____.	_____.
0444	652.0225 Conduit Rigid Nonmetallic Schedule 40 2-Inch	7,452.000 LF	_____.	_____.
0446	653.0164 Pull Boxes Non-Conductive 24x42-Inch	58.000 EACH	_____.	_____.
0448	653.0905 Removing Pull Boxes	13.000 EACH	_____.	_____.
0450	654.0105 Concrete Bases Type 5	41.000 EACH	_____.	_____.
0452	654.0224 Concrete Control Cabinet Bases Type L24	3.000 EACH	_____.	_____.
0454	655.0610 Electrical Wire Lighting 12 AWG	12,255.000 LF	_____.	_____.
0456	655.0615 Electrical Wire Lighting 10 AWG	12,728.000 LF	_____.	_____.
0458	655.0620 Electrical Wire Lighting 8 AWG	4,348.000 LF	_____.	_____.



Proposal Schedule of Items

Proposal ID: 20220308051 Project(s): 5163-07-77

Federal ID(s): WISC 2022069

SECTION: 0001 Contract Items

Alt Set ID: Alt Mbr ID:

Proposal Line Number	Item ID Description	Approximate Quantity and Units	Unit Price	Bid Amount
0460	655.0625 Electrical Wire Lighting 6 AWG	7,033.000 LF	_____.	_____.
0462	656.0200 Electrical Service Meter Breaker Pedestal (location) 01. Sunnyside Dr	LS	LUMP SUM	_____.
0464	656.0200 Electrical Service Meter Breaker Pedestal (location) 02. USH 14	LS	LUMP SUM	_____.
0466	656.0200 Electrical Service Meter Breaker Pedestal (location) 03. Fireclay	LS	LUMP SUM	_____.
0468	657.0255 Transformer Bases Breakaway 11 1/2-Inch Bolt Circle	41.000 EACH	_____.	_____.
0470	657.0322 Poles Type 5-Aluminum	41.000 EACH	_____.	_____.
0472	657.0610 Luminaire Arms Single Member 4 1/2-Inch Clamp 6-FT	42.000 EACH	_____.	_____.
0474	657.0710 Luminaire Arms Truss Type 4 1/2-Inch Clamp 12-FT	20.000 EACH	_____.	_____.
0476	659.1120 Luminaires Utility LED B	62.000 EACH	_____.	_____.
0478	659.2124 Lighting Control Cabinets 120/240 24-Inch	3.000 EACH	_____.	_____.
0480	661.0200 Temporary Traffic Signals for Intersections (location) 01. USH 14 & STH 35	LS	LUMP SUM	_____.
0482	690.0150 Sawing Asphalt	5,344.000 LF	_____.	_____.
0484	690.0250 Sawing Concrete	11,004.000 LF	_____.	_____.
0486	715.0720 Incentive Compressive Strength Concrete Pavement	7,645.000 DOL	1.00000	7,645.00



Proposal Schedule of Items

Proposal ID: 20220308051 Project(s): 5163-07-77

Federal ID(s): WISC 2022069

SECTION: 0001 Contract Items

Alt Set ID: Alt Mbr ID:

Proposal Line Number	Item ID Description	Approximate Quantity and Units	Unit Price	Bid Amount
0488	ASP.1T0A On-the-Job Training Apprentice at \$5.00/HR	2,500.000 HRS	5.00000	12,500.00
0490	ASP.1T0G On-the-Job Training Graduate at \$5.00/HR	3,500.000 HRS	5.00000	17,500.00
0492	SPV.0045 Special 01. Temporary Detectable Warning Field	1,600.000 DAY	_____.	_____.
0494	SPV.0060 Special 01. Temporary Pipe Connection	13.000 EACH	_____.	_____.
0496	SPV.0060 Special 02. Removing Lighting Units	13.000 EACH	_____.	_____.
0498	SPV.0060 Special 03. Inlet Covers Flat Temporary	36.000 EACH	_____.	_____.
0500	SPV.0060 Special 04. Concrete Base Railing	151.000 EACH	_____.	_____.
0502	SPV.0060 Special 05. Remove Water Valve Manhole	7.000 EACH	_____.	_____.
0504	SPV.0060 Special 06. Remove Hydrant	2.000 EACH	_____.	_____.
0506	SPV.0060 Special 07. Adjusting Water Valve Manhole	2.000 EACH	_____.	_____.
0508	SPV.0060 Special 08. Adjusting Sanitary Manhole	9.000 EACH	_____.	_____.
0510	SPV.0060 Special 09. Adjusting Water Valve Box	10.000 EACH	_____.	_____.
0512	SPV.0060 Special 10. Install Water Valve Box	6.000 EACH	_____.	_____.
0514	SPV.0060 Special 11. Water Valves	3.000 EACH	_____.	_____.
0516	SPV.0060 Special 12. Install Hydrant	2.000 EACH	_____.	_____.



Proposal Schedule of Items

Proposal ID: 20220308051 Project(s): 5163-07-77

Federal ID(s): WISC 2022069

SECTION: 0001 Contract Items

Alt Set ID: Alt Mbr ID:

Proposal Line Number	Item ID Description	Approximate Quantity and Units	Unit Price	Bid Amount
0518	SPV.0060 Special 13. Connect To Existing Water Main	11.000 EACH	_____.	_____.
0520	SPV.0060 Special 14. Connect to Existing Sanitary Sewer	3.000 EACH	_____.	_____.
0522	SPV.0060 Special 15. Construction Staking Roundabout Sunnyside Dr	1.000 EACH	_____.	_____.
0524	SPV.0060 Special 16. Construction Staking Roundabout USH 14/61	1.000 EACH	_____.	_____.
0526	SPV.0060 Special 17. Remove and Salvage RRFB System	3.000 EACH	_____.	_____.
0528	SPV.0060 Special 18. Temporary Lighting STH 35/14/61 Roundabout	1.000 EACH	_____.	_____.
0530	SPV.0060 Special 19. Temporary Lighting STH 35/Sunnyside Dr Roundabout	1.000 EACH	_____.	_____.
0532	SPV.0060 Special 20. Install Manhole Covers	9.000 EACH	_____.	_____.
0534	SPV.0060 Special 21. Install Inlet Covers	83.000 EACH	_____.	_____.
0536	SPV.0060 Special 22. Catch Basins 4-FT Diameter Special	81.000 EACH	_____.	_____.
0538	SPV.0090 Special 01. Storm Sewer Pipe PVC 6-Inch	59.000 LF	_____.	_____.
0540	SPV.0090 Special 02. Remove Water Main	25.000 LF	_____.	_____.
0542	SPV.0090 Special 03. Water Main 6-Inch	66.000 LF	_____.	_____.
0544	SPV.0090 Special 04. Water Main 8-Inch	3.000 LF	_____.	_____.



Proposal Schedule of Items

Proposal ID: 20220308051 Project(s): 5163-07-77

Federal ID(s): WISC 2022069

SECTION: 0001 Contract Items

Alt Set ID: Alt Mbr ID:

Proposal Line Number	Item ID Description	Approximate Quantity and Units	Unit Price	Bid Amount
0546	SPV.0090 Special 05. Water Main 12-Inch	6.000 LF	_____.	_____.
0548	SPV.0090 Special 06. Sanitary Sewer PVC 8-Inch	132.000 LF	_____.	_____.
0550	SPV.0165 Special 01. Wall Modular Block Gravity R-32-079	2,160.000 SF	_____.	_____.
0552	SPV.0165 Special 02. Wall Modular Block Gravity R-32-080	559.000 SF	_____.	_____.
0554	SPV.0165 Special 03. Wall Modular Block Mechanically Stabilized Earth Landscape, STA. 10+00'WALLA	2,178.000 SF	_____.	_____.
0556	645.0120 Geotextile Type HR	2,020.000 SY	_____.	_____.
Section: 0001			Total:	_____.
			Total Bid:	_____.