



Wisconsin Department of Transportation

Division of Transportation Systems Development

Bureau of Project Development
4822 Madison Yards Way, 4th Floor South
Madison, WI 53705

Telephone: (608) 266-1631
Facsimile (FAX): (608) 266-8459

April 19, 2022

NOTICE TO ALL CONTRACTORS:

Proposal #39: 1016-01-62, WISC 2022379
Tomah - Portage
24th Avenue to Mirror Lake Bridge
IH-90
Juneau and Sauk Counties

Letting of May 10, 2022

This is Addendum No. 01, which provides for the following:

Special Provisions:

Revised Special Provisions	
Article No.	Description
7	Utilities

Schedule of Items:

Revised Bid Item Quantities					
Bid Item	Item Description	Unit	Old Quantity	Revised Quantity	Proposal Total
616.0100	Fence Woven Wire (4.FT)	LF	132,800	2,400	135,200

Plan Sheets:

Revised Plan Sheets	
Plan Sheet	Plan Sheet Title (brief description of changes to sheet)
28	Added 2,400 LF of Fence Woven Wire to Miscellaneous Quantities
38	Updated Location of fence replacement in NW quadrant near CP Railroad. Shows location of new fence STA. 1826+94A to STA. 1850+27A.

The responsibility for notifying potential subcontractors and suppliers of these changes remains with the prime contractor.

Sincerely,

Mike Coleman

Proposal Development Specialist
Proposal Management Section

ADDENDUM NO. 01

1016-01-62

April 19, 2022

Special Provisions

7. Utilities.

Replace entire article language with the following:

This contract comes under the provisions of Wisconsin Administrative Code Chapter Trans 220.

Some of the utility work described below is dependent on prior work being performed by the contractor at a specific site. In such situations, provide the engineer and the affected utility a good faith notice of when the utility is to start work at the site. Provide this notice 14 to 16 calendar days in advance of when the prior work will be completed and the site will be available to the utility owner. Follow-up with a confirmation notice to the engineer and the utility owner not less than three working days before the site will be ready for the utility owner to begin its work.

Alliant Energy – Overhead Electric – The following are not anticipated to conflict with construction:

- Pole locations 1515A-1532A, 1936, 1990, 2100-2101, and 2122-2125 are close to existing/new fencing but appear to be well behind and no conflict.

AT&T Legacy – Communication – The following will conflict with construction:

- Marker poles are close to existing/new fencing and some will conflict with the fence replacement. AT&T Corp. will coordinate with the state contractor to document the marker poles that will be removed due to the fence removal and replacement. Once the fence has been replaced, AT&T will have their contractor come back and replace the marker poles that have been impacted. The AT&T contact is Todd Norman at 608 556 7199.

ATC Mgmt. Inc. – Electric Transmission – The following will conflict with construction:

- There are 69 kV and 345 kV transmission facilities within the project limits. ATC will remove and replace existing electrical grounds (attached to WisDOT fence) at approximately every 4,000 feet on the newly installed fence within a 24-hour period for each location. ATC coordination with the WisDOT Contractor is necessary to maintain a safe reinstallation of ATC assets to the new fence. The WisDOT fence contractor will need to coordinate with ATC on their schedule for replacing the fence. The fence contractor will need to provide notice of construction activities to ensure proper coordination of ATC contractors to replace the electrical grounds in a safe and timely manner. The ATC contact is Robert Weisheim at 262-722-0289.

Northern Natural Gas Company (NNG) – Gas/Petroleum – The following are not anticipated to conflict with construction:

- Two pipelines cross IH 90/94 at approximately Station 2010.

A NNG representative shall be present at all times when excavation work is being performed within 25 feet of the pipelines. Contact Lenny Klass at 608 778-8514 or Leonard.Klass@NNGco.com at least 48 hours in advance to arrange for an observer to be on site.

The following utility owners have facilities within the project area; however, no adjustments are anticipated:

- **City of Wisconsin Dells – Sewer**

- **Frontier Communication**
- **Level 3 Communication**
- **Oakdale Elec Coop**
- **Reedsburg Utility Commission – Communication**
- **Rogers Telecom**
- **Village of Lake Delton – Sewer**
- **Windstream KDL, LLC**

stp-107-065 (20080501)

Schedule of Items

Attached, dated April 19, 2022 are the revised Schedule of Items Page 2.

Plan Sheets

The following 8½ x 11-inch sheets are attached and made part of the plans for this proposal:
Revised: 26 and 36.

END OF ADDENDUM

FENCE SUMMARY (EASTBOUND)				FENCE SUMMARY (WESTBOUND)			
STATION	TO	STATION	LOCATION	REMOVING FENCE LF	616.0100 FENCE WOVEN WIRE (HEIGHT) (01.4-FT)	LF	REMARKS
1380+16	-	1505+00	JUNEAU COUNTY	11,800		900	
1508+00	-	1594+00	MILE 77 - EXIT 79	9,500		12,000	
			EXIT 79 - KOVAL RD			8,400	
1603+00	-	1614+00	KOVAL RD	700		11,800	
1621+00	-	1630+00		800		11,800	
1632+00	-	1640+00		600		11,800	
1642+00	-	1648+00		600		11,800	
1651+50	-	1657+50		600		2,400	NEW FENCE
1660+00	-	1668+00		800		8,400	
1669+00	-	1677+00		800		1,000	
1679+00	-	1686+00		700		1,000	
1689+50	-	1695+50		600		800	
1698+00	-	1701+00		300		400	
1702+50	-	1708+50		600		700	
			63rd STREET			600	
1709+00	-	1724+00		1,500		600	
1736+00	-	1733+00		700		800	
1745+00	-	1742+00		700		700	
1744+00	-	1752+00		800		700	
1755+00	-	1759+00		400		700	
1762+00	-	1769+00		700		700	
1771+00	-	1777+00		600		700	
1780+00	-	1787+00		700		500	
1789+00	-	1797+00		800		300	
1799+00	-	1806+00		700		700	
1808+00	-	1812+00		400		700	
1814+00	-	1820+00		600		700	
			CANADIAN PACIFIC RR				
1821+00	-	1822+00		300		300	
1839+50	-	1843+50	OFF-RAMP EXIT 85	400		700	
1850+00	-	1854+00	ON-RAMP EXIT 85	800		700	
1858+00	-	1866+00		800		300	
1867+00	-	1875+00		800		1,100	
1876+00	-	1885+00		900		900	
1887+50	-	1894+50		700		600	
1896+50	-	1903+50		700		800	
1907+00	-	1921+00		1,400		2,600	
			SAUK COUNTY				
1926+00	-	1934+50		900		73,000	
1935+50	-	1941+00	EXIT 87	900		62,200	
1965+00	-	1969+50	TROUT RD	2,400		132,800	
1990+00	-	2048+00	SPRING BROOK	5,800			
2049+50	-	2070+00		2,100			
			EXIT 89				
2081+00	-	2099+00	XANADU RD	1,800			
2099+20	-	2117+00	MIRROR LAKE	1,800			
2120+50	-	2125+50		500			
2128+00	-	2147+30	ISHNALA RD	2,100			
			SUBTOTAL EASTBOUND =	62,200			
			SAUK COUNTY				
			EXIT 85 - CTH H	8,400		8,400	
			EXIT 87	1,000		1,000	
			EXIT 89	300		300	
			MIRROR LAKE	600		600	
			ISHNALA RD	800		800	
			2148+00A	2,600		2,600	
			SUBTOTAL WESTBOUND =	70,600		73,000	
			SAUK COUNTY				
			EXIT 85 - CTH H	1,000		1,000	
			EXIT 87	1,000		1,000	
			EXIT 89	300		300	
			MIRROR LAKE	600		600	
			ISHNALA RD	800		800	
			2148+00A	2,600		2,600	
			SUBTOTAL WESTBOUND =	62,200		62,200	
			SAUK COUNTY				
			EXIT 85 - CTH H	8,400		8,400	
			EXIT 87	1,000		1,000	
			EXIT 89	300		300	
			MIRROR LAKE	600		600	
			ISHNALA RD	800		800	
			2148+00A	2,600		2,600	
			SUBTOTAL WESTBOUND =	62,200		62,200	
			SAUK COUNTY				
			EXIT 85 - CTH H	8,400		8,400	
			EXIT 87	1,000		1,000	
			EXIT 89	300		300	
			MIRROR LAKE	600		600	
			ISHNALA RD	800		800	
			2148+00A	2,600		2,600	
			SUBTOTAL WESTBOUND =	62,200		62,200	
			SAUK COUNTY				
			EXIT 85 - CTH H	8,400		8,400	
			EXIT 87	1,000		1,000	
			EXIT 89	300		300	
			MIRROR LAKE	600		600	
			ISHNALA RD	800		800	
			2148+00A	2,600		2,600	
			SUBTOTAL WESTBOUND =	62,200		62,200	
			SAUK COUNTY				
			EXIT 85 - CTH H	8,400		8,400	
			EXIT 87	1,000		1,000	
			EXIT 89	300		300	
			MIRROR LAKE	600		600	
			ISHNALA RD	800		800	
			2148+00A	2,600		2,600	
			SUBTOTAL WESTBOUND =	62,200		62,200	
			SAUK COUNTY				
			EXIT 85 - CTH H	8,400		8,400	
			EXIT 87	1,000		1,000	
			EXIT 89	300		300	
			MIRROR LAKE	600		600	
			ISHNALA RD	800		800	
			2148+00A	2,600		2,600	
			SUBTOTAL WESTBOUND =	62,200		62,200	
			SAUK COUNTY				
			EXIT 85 - CTH H	8,400		8,400	
			EXIT 87	1,000		1,000	
			EXIT 89	300		300	
			MIRROR LAKE	600		600	
			ISHNALA RD	800		800	
			2148+00A	2,600		2,600	
			SUBTOTAL WESTBOUND =	62,200		62,200	
			SAUK COUNTY				
			EXIT 85 - CTH H	8,400		8,400	
			EXIT 87	1,000		1,000	
			EXIT 89	300		300	
			MIRROR LAKE	600		600	
			ISHNALA RD	800		800	
			2148+00A	2,600		2,600	
			SUBTOTAL WESTBOUND =	62,200		62,200	
			SAUK COUNTY				
			EXIT 85 - CTH H	8,400		8,400	
			EXIT 87	1,000		1,000	
			EXIT 89	300		300	
			MIRROR LAKE	600		600	
			ISHNALA RD	800		800	
			2148+00A	2,600		2,600	
			SUBTOTAL WESTBOUND =	62,200		62,200	
			SAUK COUNTY				
			EXIT 85 - CTH H	8,400		8,400	
			EXIT 87	1,000		1,000	
			EXIT 89	300		300	
			MIRROR LAKE	600		600	
			ISHNALA RD	800		800	
			2148+00A	2,600		2,600	
			SUBTOTAL WESTBOUND =	62,200		62,200	
			SAUK COUNTY				
			EXIT 85 - CTH H	8,400		8,400	
			EXIT 87	1,000		1,000	
			EXIT 89	300		300	
			MIRROR LAKE	600		600	
			ISHNALA RD	800		800	
			2148+00A	2,600		2,600	
			SUBTOTAL WESTBOUND =	62,200		62,200	
			SAUK COUNTY				
			EXIT 85 - CTH H	8,400		8,400	
			EXIT 87	1,000		1,000	
			EXIT 89	300		300	
			MIRROR LAKE	600		600	
			ISHNALA RD	800		800	
			2148+00A	2,600		2,600	
			SUBTOTAL WESTBOUND =	62,200		62,200	
			SAUK COUNTY				
			EXIT 85 - CTH H	8,400		8,400	
			EXIT 87	1,000		1,000	
			EXIT 89	300		300	
			MIRROR LAKE	600		600	
			ISHNALA RD	800		800	
			2148+00A	2,600		2,600	
			SUBTOTAL WESTBOUND =	62,200		62,200	
			SAUK COUNTY				
			EXIT 85 - CTH H	8,400		8,400	
			EXIT 87	1,000		1,000	
			EXIT 89	300		300	
			MIRROR LAKE	600		600	
			ISHNALA RD	800		800	
			2148+00A	2,600		2,600	
			SUBTOTAL WESTBOUND =	62,200		62,200	
			SAUK COUNTY				
			EXIT 85 - CTH H	8,400		8,400	
			EXIT 87	1,000		1,000	
			EXIT 89	300		300	
			MIRROR LAKE	600		600	
			ISHNALA RD	800		800	
			2148+00A	2,600		2,600	
			SUBTOTAL WESTBOUND =	62,200		62,200	
			SAUK COUNTY				
			EXIT 85 - CTH H	8,400		8,400	
			EXIT 87	1,000		1,000	
			EXIT 89	300		300	
			MIRROR LAKE	600		600	
			ISHNALA RD	800		800	
			2148+00A	2,600		2,600	
			SUBTOTAL WESTBOUND =	62,200		62,200	
			SAUK COUNTY				
			EXIT 85 - CTH H	8,400		8,400	
			EXIT 87	1,000		1,000	

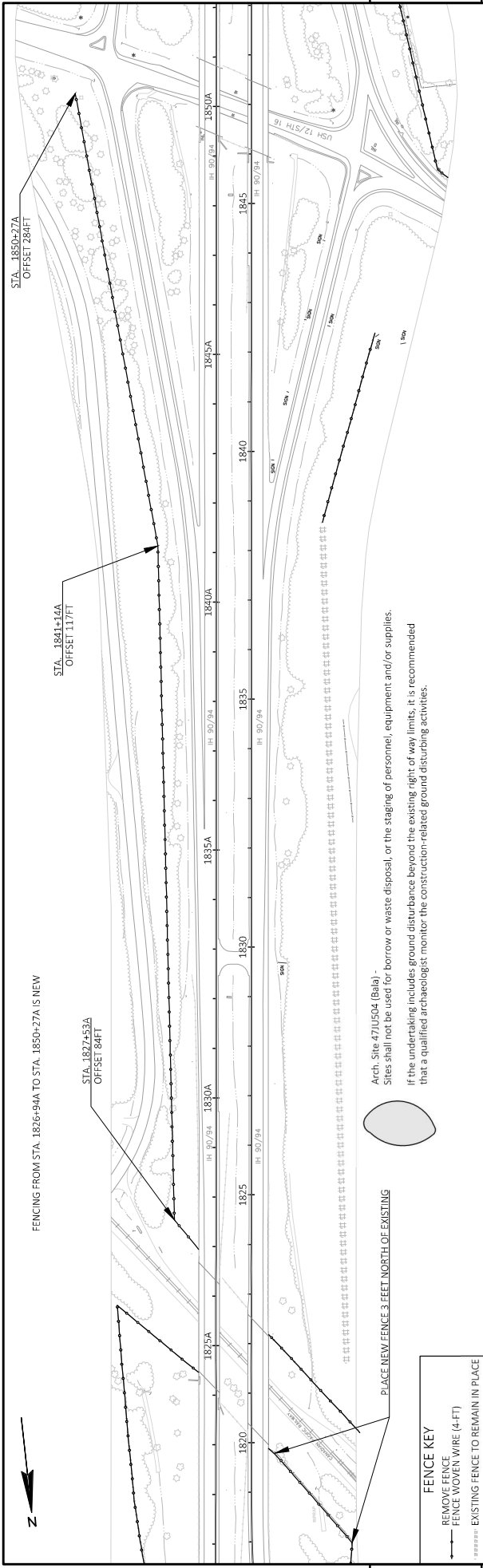

5

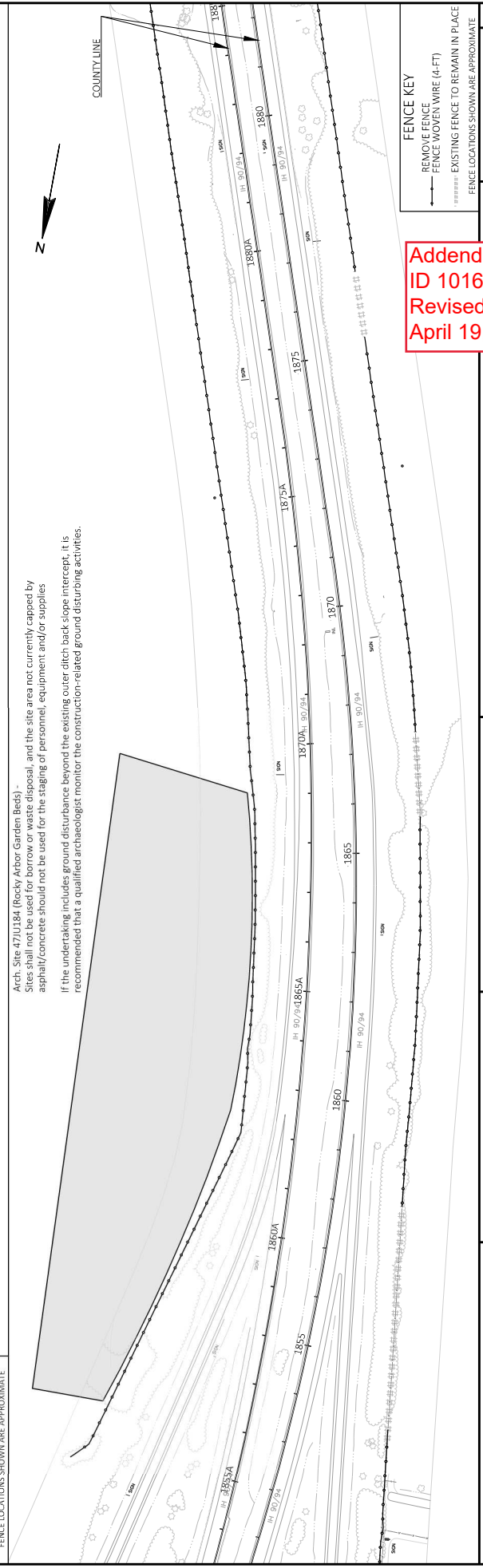

5

Addendum No. 01
ID 1016-01-62
Revised Sheet 38
April 19, 2022

FENCE KEY
 - - - - - REMOVE FENCE
 ——— FENCE WOVEN WIRE (4-FT)
 ||||| EXISTING FENCE TO REMAIN IN PLACE
FENCE LOCATIONS SHOWN ARE APPROXIMATE

PROJECT NO: 1016-01-62
 HWY: IH-90
 COUNTY: JUNEAU
 PLAN
 SHEET 38
 E

FILE NAME : \\LAX31FP2\NBPUBLIC\POS\C30\10160131\SHEETSP\AN\050101-PN_RECOVER.DWG
 LAYOUT NAME - 45
 N:200 FT
 WSDOT/CADD SHEET 44

PLANT DATE : 4/13/2022 2:48 PM
 PLOT BY : DALE, BRIAN D
 PLOT NAME :



Proposal Schedule of Items

Proposal ID: 20220510039 Project(s): 1016-01-62

Federal ID(s): WISC 2022379

SECTION: 0001

Contract Items

Alt Set ID:

Alt Mbr ID:

Proposal Line Number	Item ID Description	Approximate Quantity and Units	Unit Price	Bid Amount
0034	520.9700.S Culvert Pipe Liners (size) 01. 24-INCH	380.000 LF	_____.	_____.
0036	520.9750.S Cleaning Culvert Pipes for Liner Verification	4.000 EACH	_____.	_____.
0038	522.0124 Culvert Pipe Reinforced Concrete Class III 24-Inch	95.000 LF	_____.	_____.
0040	522.1024 Apron Endwalls for Culvert Pipe Reinforced Concrete 24-Inch	2.000 EACH	_____.	_____.
0042	524.0630 Apron Endwalls for Culvert Pipe Salvaged 30-Inch	2.000 EACH	_____.	_____.
0044	616.0100 Fence Woven Wire (height) 01. 4-FT	135,200.000 LF	_____.	_____.
0046	618.0100 Maintenance And Repair of Haul Roads (project) 01. 1016-01-62	1.000 EACH	_____.	_____.
0048	619.1000 Mobilization	1.000 EACH	_____.	_____.
0050	624.0100 Water	100.000 MGAL	_____.	_____.
0052	625.0500 Salvaged Topsoil	200.000 SY	_____.	_____.
0054	628.1504 Silt Fence	300.000 LF	_____.	_____.
0056	628.1520 Silt Fence Maintenance	300.000 LF	_____.	_____.
0058	628.1905 Mobilizations Erosion Control	8.000 EACH	_____.	_____.
0060	628.1910 Mobilizations Emergency Erosion Control	5.000 EACH	_____.	_____.
0062	628.2004 Erosion Mat Class I Type B	750.000 SY	_____.	_____.