



Wisconsin Department of Transportation

November 3, 2022

**Division of Transportation Systems
Development**

Bureau of Project Development
4822 Madison Yards Way, 4th Floor South
Madison, WI 53705

Telephone: (608) 266-1631
Facsimile (FAX): (608) 266-8459

NOTICE TO ALL CONTRACTORS:

**Proposal #31: 2984-00-74, WISC 2023032
C Milwaukee, W Vliet Street
N 27th Street to N 12th Street
Local Street
Milwaukee County**

Letting of November 8, 2022

This is Addendum No. 02, which provides for the following:

Plan Sheets:

Added Plan Sheets	
Plan Sheet	Plan Sheet Title (brief description of changes to sheet)
166A	Street Lighting & Traffic Signal Conduit Details

The responsibility for notifying potential subcontractors and suppliers of these changes remains with the prime contractor.

Sincerely,

Mike Coleman

Proposal Development Specialist
Proposal Management Section

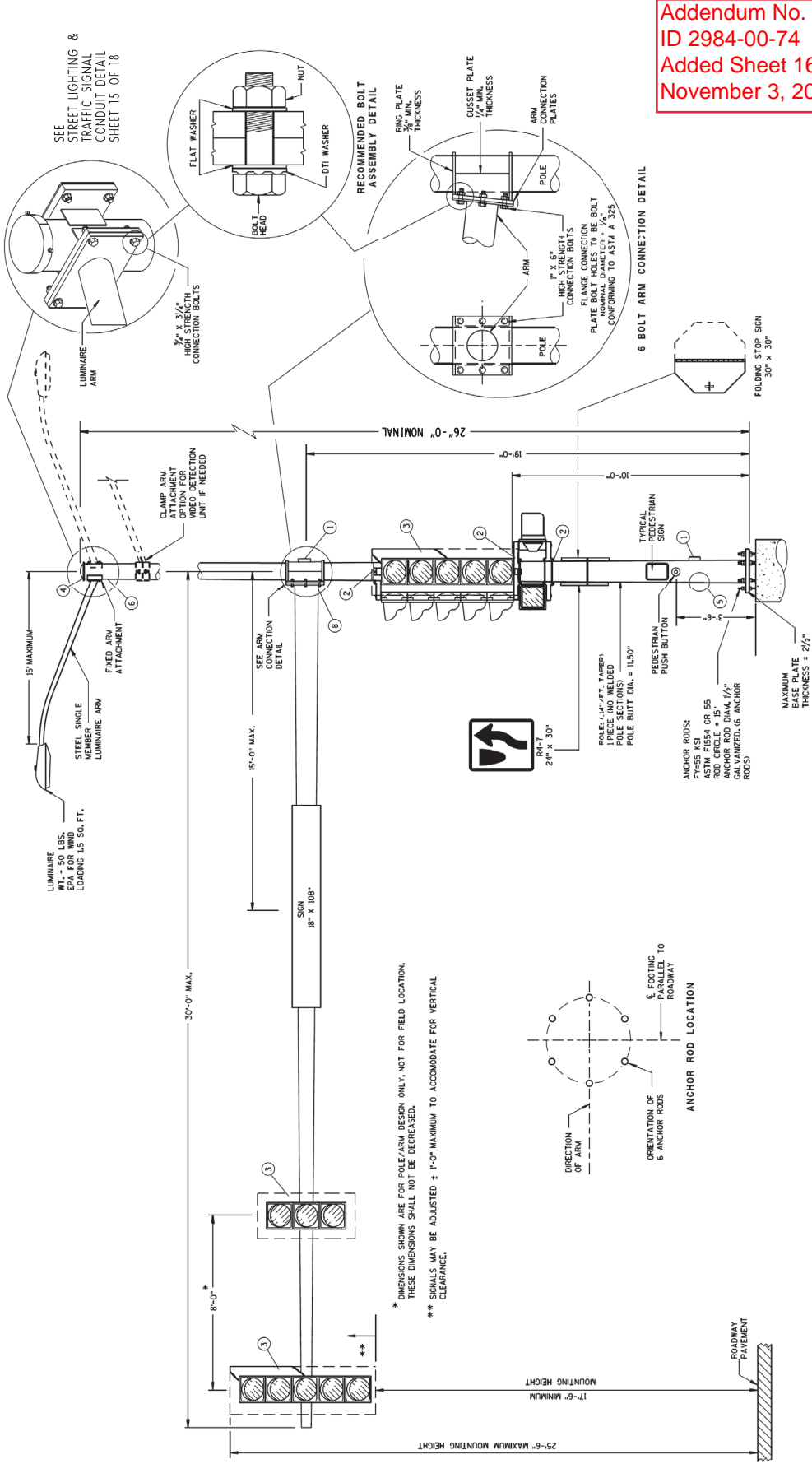

* DIMENSIONS SHOWN ARE FOR POLE/ARM DESIGN ONLY, NOT FOR FIELD LOCATION. THESE DIMENSIONS SHALL NOT BE DECREASED.
 ** SIGNALS MAY BE ADJUSTED ± 1'-0" MAXIMUM TO ACCOMMODATE FOR VERTICAL CLEARANCE.

Addendum No. 02
ID 2984-00-74
Added Sheet 166A
November 3, 2022

TYPE 10 POLE SPECIAL 26 FT.
15'- 30' MONOTUBE ARM
(SPV.0060.274)

PROJECT NO: 2984-00-74	COUNTY: MILWAUKEE	STREET LIGHTING & TRAFFIC SIGNAL CONDUIT DETAILS	SHEET OF	E
FILE NAME : W:\paw\pawgs\2018work\mms\18-27th to 12th (2984-00-74)\Design\TEES Detail.dgn				
PLOT DATE : 07-DEC-2018 13:51				
PLOT BY : cbeck				
PLOT SCALE : 20:000000:1000000				
WISDOT\CADD\SS SHEET 42				