



Wisconsin Department of Transportation

February 6, 2024

Division of Transportation Systems Development

Bureau of Project Development
4822 Madison Yards Way, 4th Floor South
Madison, WI 53705

Telephone: (608) 266-1631
Facsimile (FAX): (608) 266-8459

NOTICE TO ALL CONTRACTORS:

Proposal #29: 6950-04-72
Dexterville – Wisconsin Rapids
Swanson Road to Seneca Road
STH 54
Wood County

6950-04-73
Dexterville – Wisconsin Rapids
CTH G to Swanson Road
STH 54
Wood County

6950-04-82
Dexterville – Wisconsin Rapids
Swanson Road to Seneca Road
STH 54
Wood County

Letting of February 13, 2024

This is Addendum No. 01, which provides for the following:

Special Provisions:

Revised Special Provisions	
Article No.	Description
3	Prosecution and Progress

Schedule of Items:

Revised Bid Item Quantities					
Bid Item	Item Description	Unit	Proposal Total Prior to Addendum	Proposal Quantity Change (-)	Proposal Total After Addendum
643.0300	Traffic Control Drums	Day	5000	4750	9750
643.0420	Traffic Control Barricades Type III	Day	1240	10	1250
643.0705	Traffic Control Warning Lights	Day	1748	12	1760
643.0900	Traffic Control Signs	Day	3588	22	3610
643.1000	Traffic Control Signs Fixed Message	SF	296	-3.75	292.25
643.3350	Temporary Marking Crosswalk Removable Tape 6-inch	LF	2023	536	2559

644.1430	Temporary Pedestrian Surface Plate	SF	752	205	957
644.1440	Temporary Pedestrian Surface Matting	SF	1034	293	1327
644.1601	Temporary Pedestrian Curb Ramp	Day	625	150	775
644.1605	Temporary Pedestrian Detectable Warning Field	SF	234	150	384
644.1810	Temporary Pedestrian Barricade	LF	2574	984	3558

Plan Sheets:

Revised Plan Sheets	
Plan Sheet	Plan Sheet Title (brief description of changes to sheet)
68	Pedestrian Accommodations – Stage 1 – Modified temporary Pedestrian Accommodations
71	Pedestrian Accommodations – Stage 1 – Modified temporary Pedestrian Accommodations
72	Pedestrian Detour – Stage 1 - Modified temporary Pedestrian Accommodations
73	Pedestrian Accommodations – Stage 2 - Modified temporary Pedestrian Accommodations
75	Pedestrian Accommodations – Stage 2 - Modified temporary Pedestrian Accommodations
76	Pedestrian Detour – Stage 2 - Modified temporary Pedestrian Accommodations
77	Bicycle and Pedestrian Detour - Modified temporary Pedestrian Accommodations
91	Miscellaneous Quantities – Changes made to Temporary Pedestrian Accommodation Items and Traffic Control Items and Traffic Control Signs Fixed Message
199	Temporary Signing – Deleted one sign and replaced with a different one.

Added Plan Sheets	
Plan Sheet	Plan Sheet Title (brief description of why sheet was added)
67A	Pedestrian Accommodations – Stage 1 – New sheet for added temporary Ped Accommodations between 7 th Street and 4 th Street
72A	Pedestrian Accommodations – Stage 2 - New sheet for added temporary Ped Accommodations between 7 th Street and 4 th Street

The responsibility for notifying potential subcontractors and suppliers of these changes remains with the prime contractor.

Sincerely,

Mike Coleman

Proposal Development Specialist
Proposal Management Section

ADDENDUM NO. 01

6950-04-72/73/82

February 6, 2024

Special Provisions

3. Prosecution and Progress.

*Replace entire section titled **Construction Staging** with the following:*

Construction Staging

Project 6950-04-72/82:

Stage 1: Mill and overlay STH 54/73/Letendre Avenue eastbound lane, base aggregate, curb ramps. STH 54/73/Wisconsin River Drive remove existing curb & gutter, excavate, and mill.

Stage 2: Mill and overlay STH 54/73/Letendre Avenue westbound lane, base aggregate, curb ramps and pavement marking. STH 54/73/Wisconsin River Drive place new curb and gutter, curb ramps, concrete sidewalk, HMA pavement, grade terrace.

STH 54/73/Letendre Avenue from STH 73 (Port Road) to 3rd Street may be closed for up to 5 days for culvert replacement (Station 113+82). Curb ramp 6 (CR-6) and curb ramp 7 (CR-7) need to be completed and open for use prior to the 5-day closure.

Project 6950-04-73:

Stage 1: Mill STH 54 eastbound & westbound lanes

Stage 2: Overlay STH 54 eastbound & westbound lanes, shoulder base aggregate and pavement marking.

If contract time expires prior to completing all work specified in the contract, additional liquidated damages will be affixed according to standard spec 108.11.

Schedule of Items

Attached, dated February 6, 2024, are the revised Schedule of Items Page 6.

Plan Sheets

The following 8½ x 11-inch sheets are attached and made part of the plans for this proposal:

Revised: 68, 71, 72, 73, 75, 76, 77, 91, and 199

Added: 67A and 72A

END OF ADDENDUM

Addendum No. 01
 ID 6950-04-72
 Revised Sheet 68
 February 6, 2024

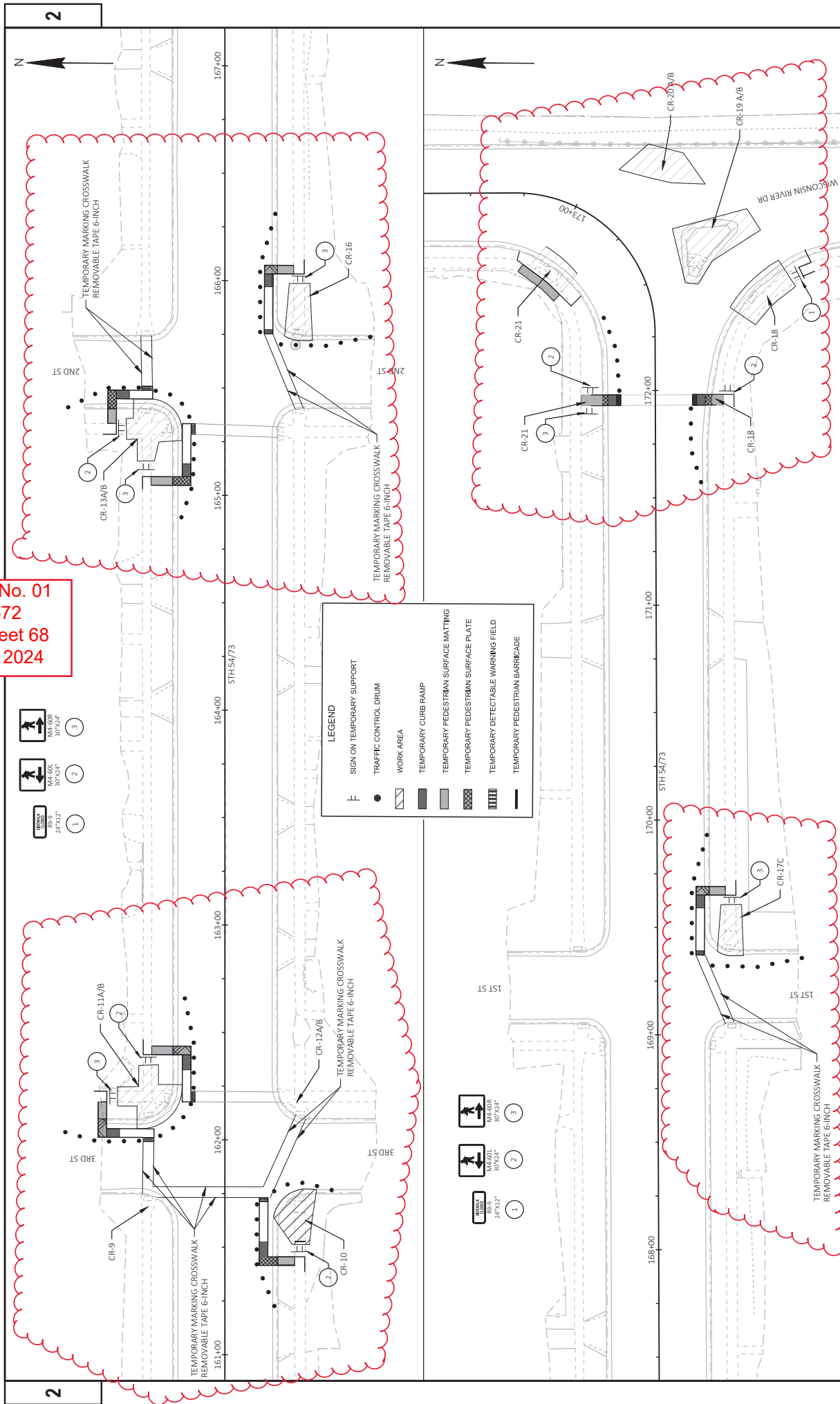

2

2

PROJECT NO: 6950-04-72
 COUNTY: WOOD
 SHEET 68
 PEDESTRIAN ACCOMMODATIONS - STAGE 1

FILE NAME: I:\LEVEL0878_STH 54_72\GIS\SHETS\PLAN\02530-1-C.DWG
 LAYOUT NAME: 01
 PLOT DATE: 1/31/2024 3:53 PM
 PLOT BY: RESHEKE, CARIE
 WISDOT/CADDIS SHEET 44



Addendum No. 01
ID 6950-04-72
Revised Sheet 71
February 6, 2024

LEGEND

F	SIGN ON TEMPORARY SUPPORT
●	TRAFFIC CONTROL DRUM
▨	WORK AREA
▩	TEMPORARY CURB RAMP
▧	TEMPORARY PEDESTRIAN SURFACE MATTING
▦	TEMPORARY PEDESTRIAN SURFACE PLATE
▨	TEMPORARY DETECTABLE WARNING FIELD
—	TEMPORARY PEDESTRIAN BARRICADE

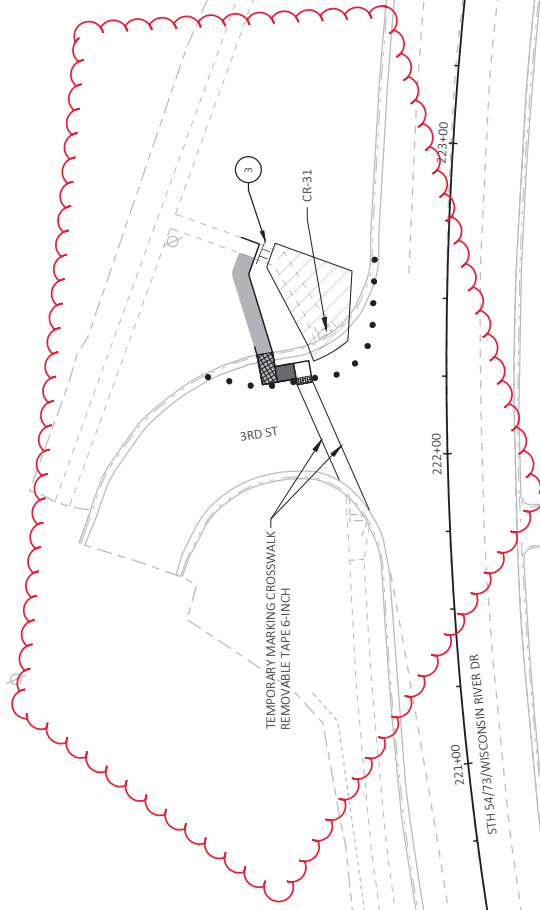

NOTE: SEE LAYOUT FOR "TRAFFIC CONTROL PEDESTRIAN ACCOMMODATION" FOR ADDITIONAL INFORMATION.

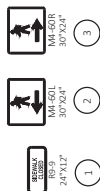

PROJECT NO: 6950-04-72
HWY: STH 54
COUNTY: WOOD
PEDESTRIAN ACCOMMODATIONS - STAGE 1

SHEET 71
E

FILE NAME: I:\1614\0878_STH 54_71\CD\SHSHEEPS\PLAN\0253011C.DWG
LAYOUT NAME: 04
PLOT DATE: 1/31/2024 3:53 PM
PLOT BY: RESHEK, CARIE
PLOT NAME: PEDESTRIAN ACCOMMODATIONS - STAGE 1
PLOT SCALE: 1 IN=40 FT
WISDOT/CADD SHEET 44



Addendum No. 01
ID 6950-04-72
Revised Sheet 72
February 6, 2024

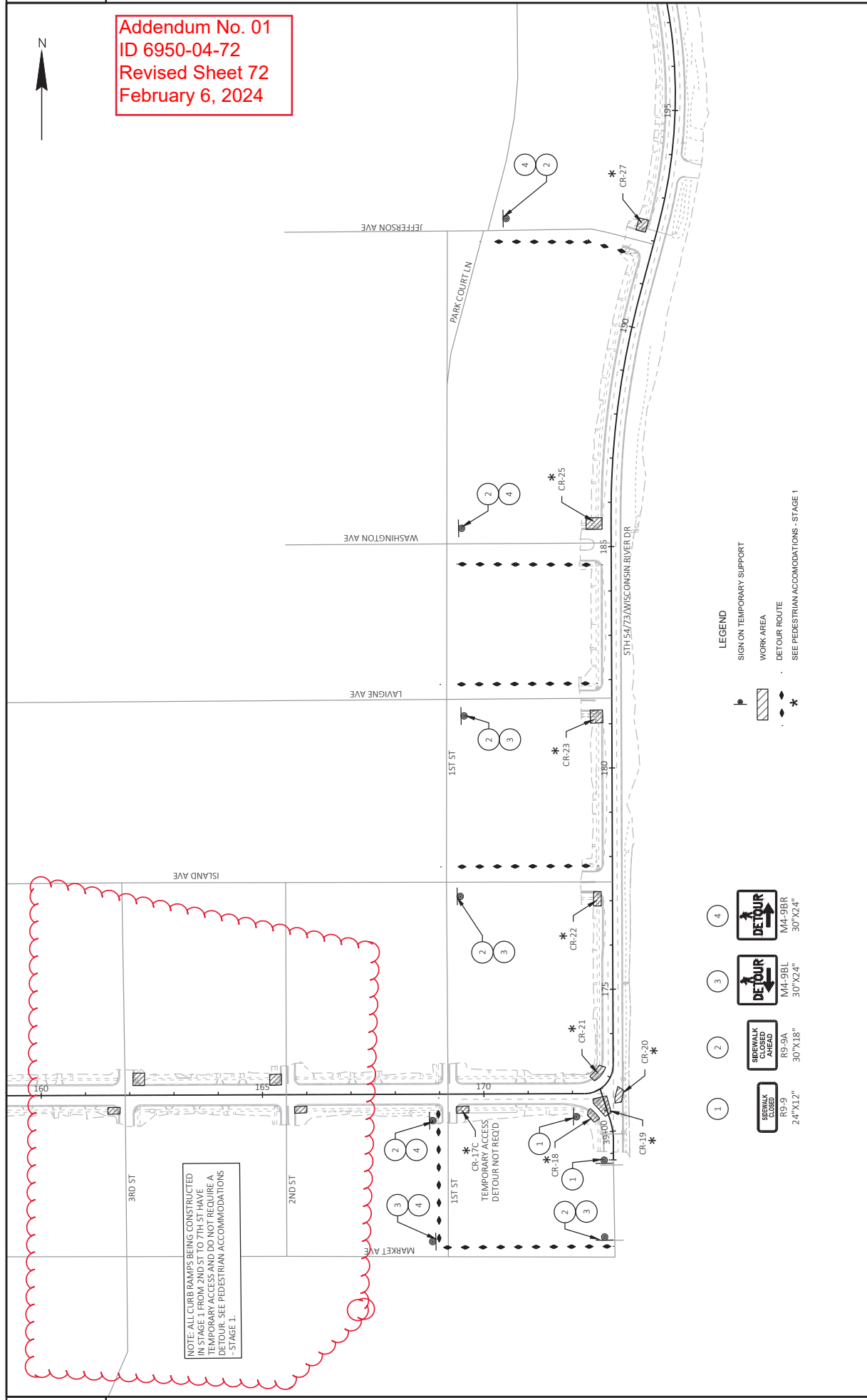

Addendum No. 01
 ID 6950-04-72
 Added Sheet 72A
 February 6, 2024

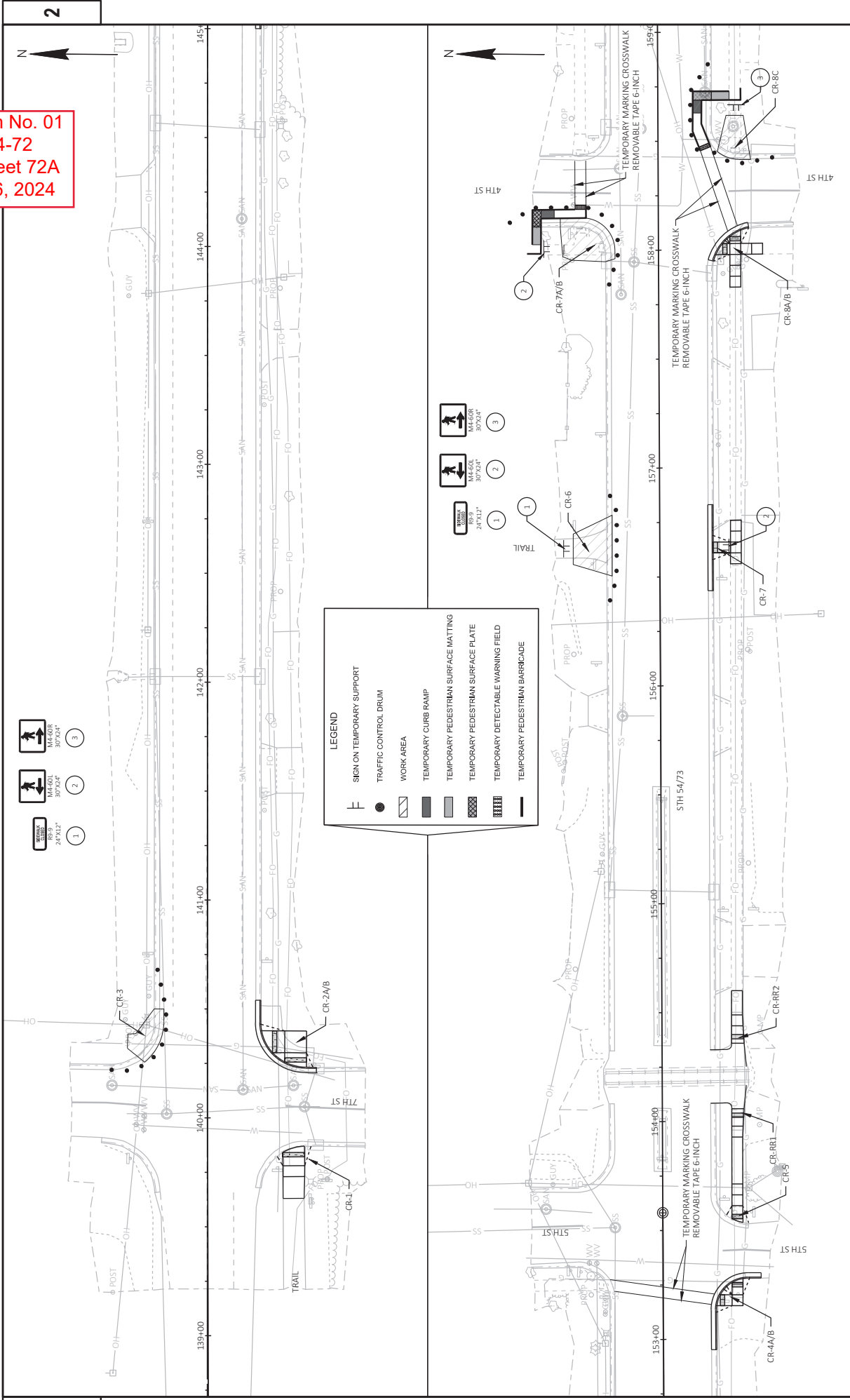

2

PROJECT NO: 6950-04-72
 HWY: STH 54
 COUNTY: WOOD
 PEDESTRIAN ACCOMMODATIONS - STAGE 2
 RESHEKE, CARBE
 PLOT NAME:
 PLOT SCALE: 1"=40' FT
 SHEET 72A
 E

FILE NAME: I:\LEVEL0878_STH54_72ACRSHSHEEPSHAN\02540-1-C.DWG
 LAYOUT NAME - 01.D
 1/31/2024 3:54 PM
 1/31/2024 3:54 PM
 1/31/2024 3:54 PM

Addendum No. 01
 ID 6950-04-72
 Revised Sheet 73
 February 6, 2024

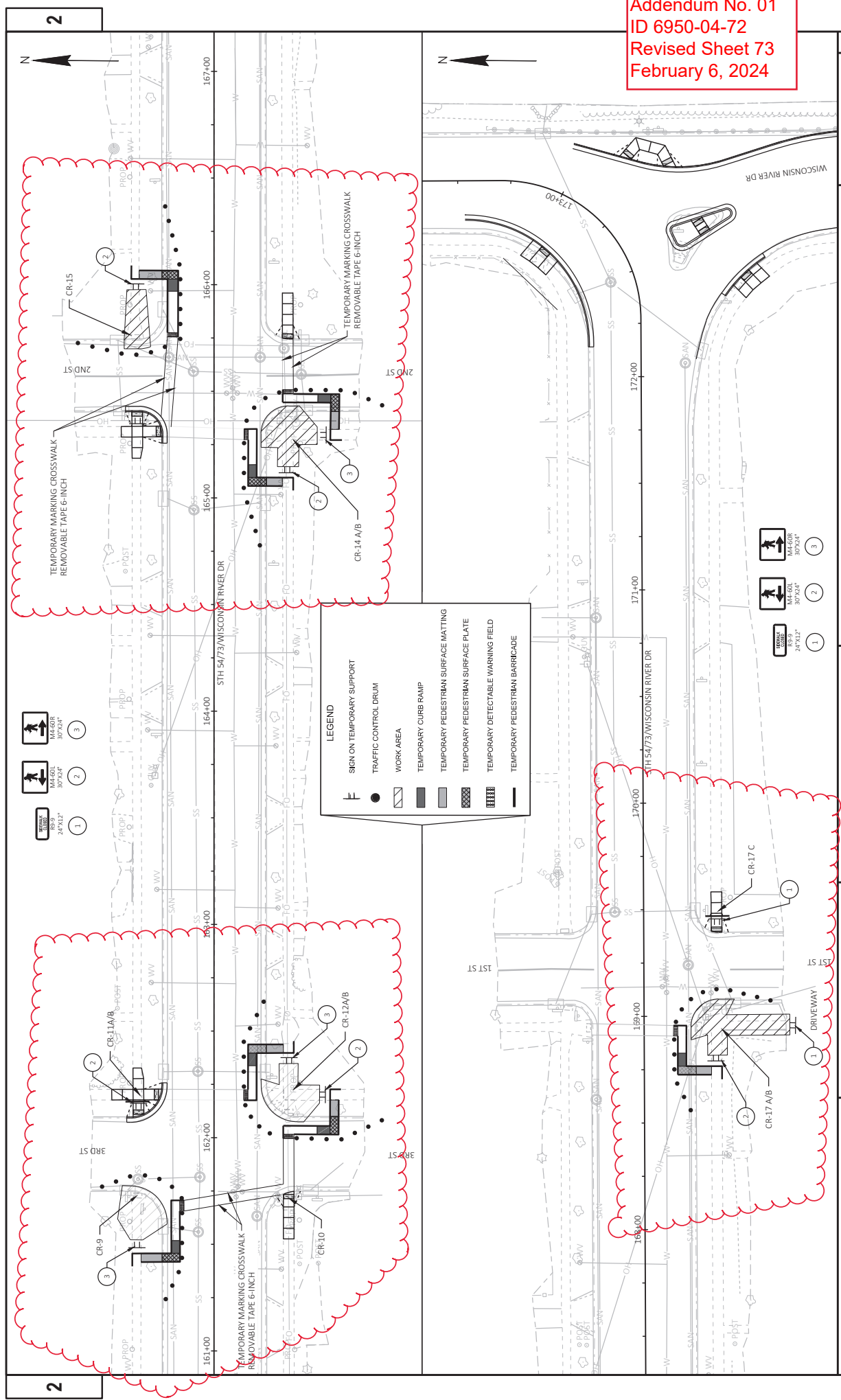

- 1 (1) SIGN ON TEMPORARY SUPPORT
- 2 (2) TRAFFIC CONTROL DRUM
- 3 (3) WORK AREA

LEGEND

- TEMPORARY MARKING CROSSWALK REMOVABLE TAPE 6-INCH
- TEMPORARY PEDESTRIAN SURFACE MATTING
- TEMPORARY PEDESTRIAN SURFACE PLATE
- TEMPORARY DETECTABLE WARNING FIELD
- TEMPORARY PEDESTRIAN BARRICADE

- 1 (1) SIGN ON TEMPORARY SUPPORT
- 2 (2) TRAFFIC CONTROL DRUM
- 3 (3) WORK AREA

Addendum No. 01
 ID 6950-04-72
 Revised Sheet 75
 February 6, 2024

NOTE:
 SEE SDD "TRAFFIC CONTROL,
 PEDESTRIAN ACCOMMODATION"
 FOR ADDITIONAL INFORMATION.

NOTE:
 SIDEWALK GOING TO ALEXANDER
 HOUSE. COMPLETE WORK WHEN ALEXANDER
 HOUSE IS CLOSED TO THE PUBLIC.

- 1 24'x12' RS-9
- 2 30'x24' M4-60L
- 3 30'x24' M4-60R

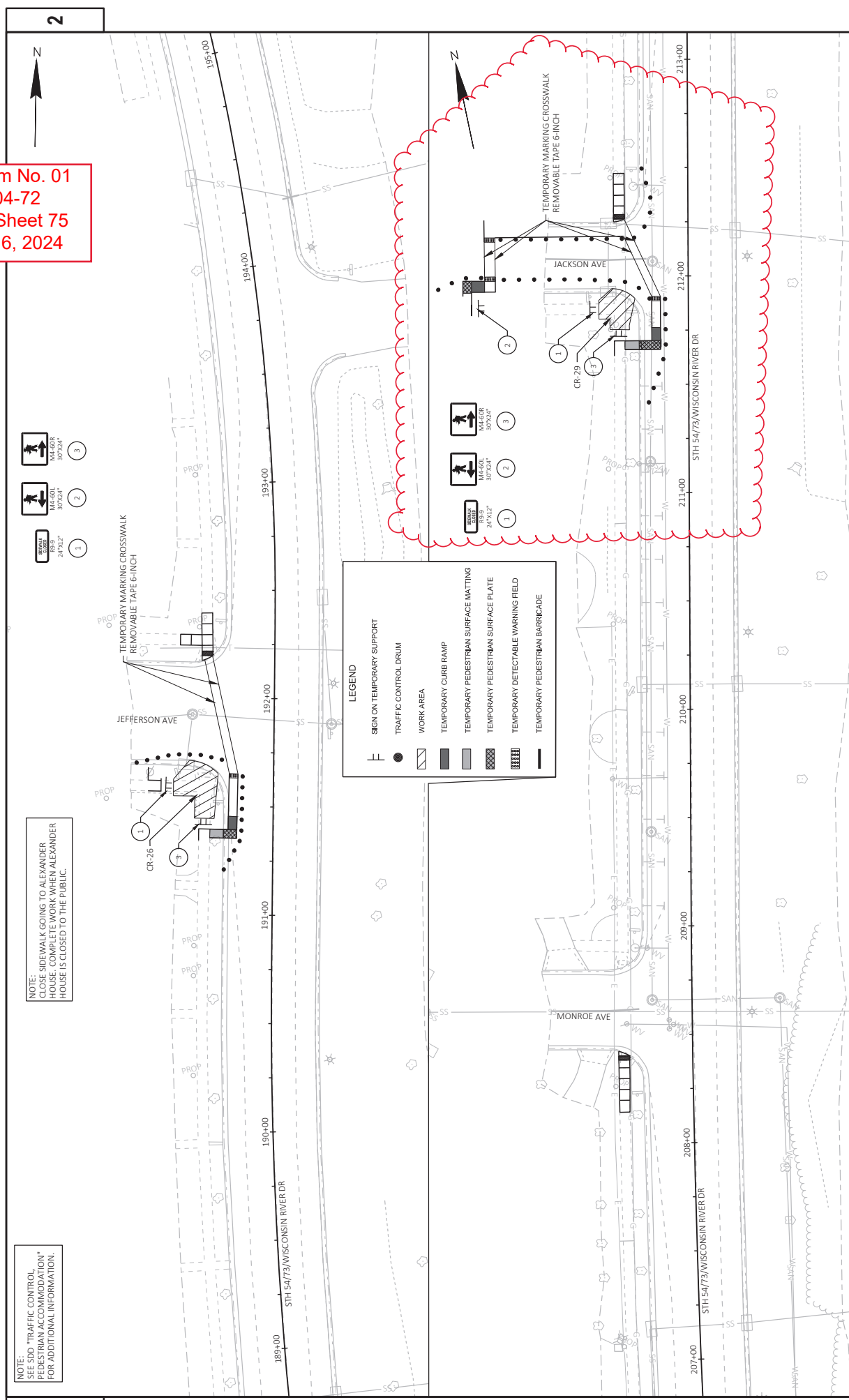

LEGEND

- SIGN ON TEMPORARY SUPPORT
- TRAFFIC CONTROL DRUM
- WORK AREA
- TEMPORARY CURB RAMP
- TEMPORARY PEDESTRIAN SURFACE MATTING
- TEMPORARY PEDESTRIAN SURFACE PLATE
- TEMPORARY DETECTABLE WARNING FIELD
- TEMPORARY PEDESTRIAN BARRICADE



Addendum No. 01
ID 6950-04-72
Revised Sheet 76
February 6, 2024

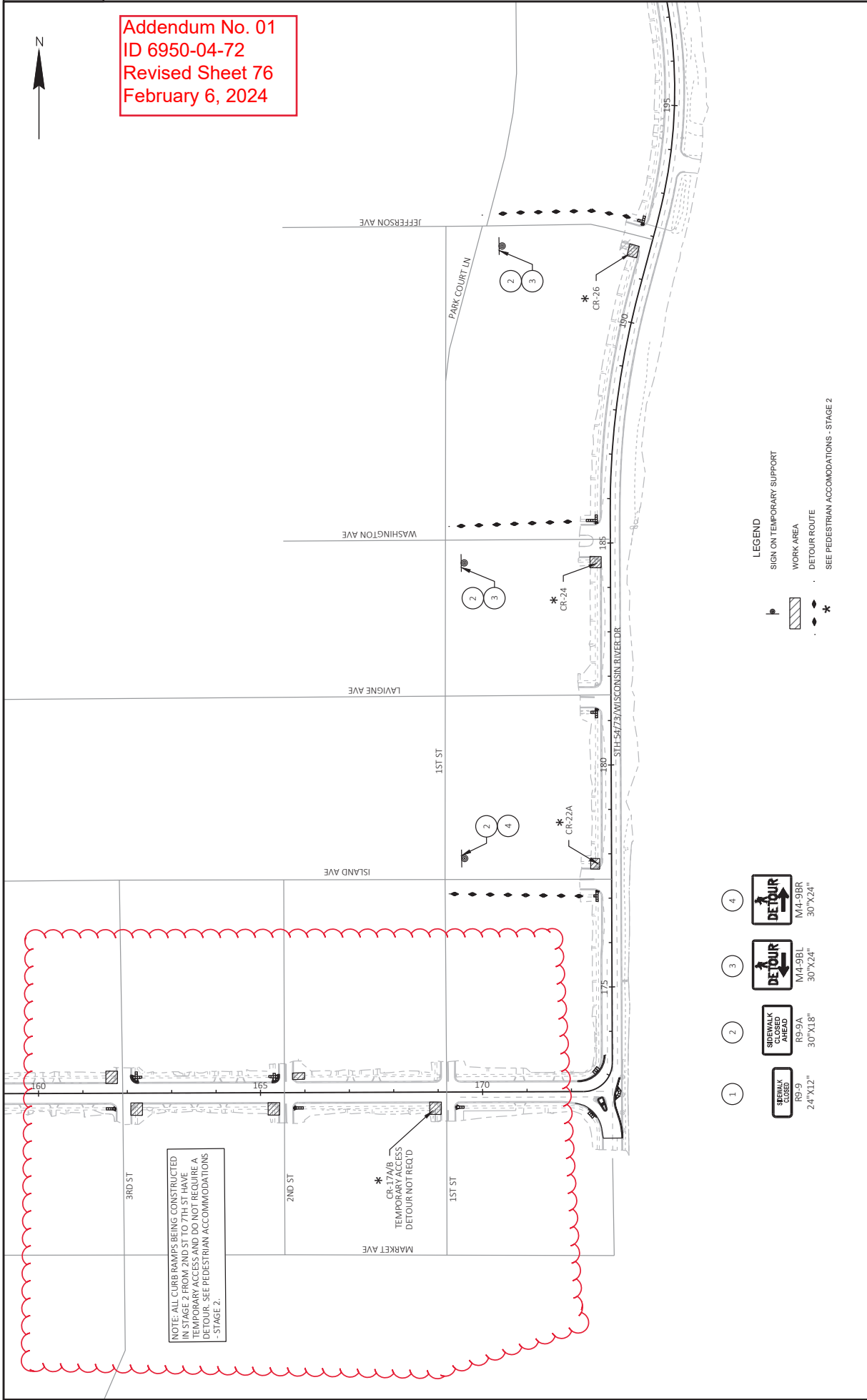

NOTE: ALL CURB RAMPS BEING CONSTRUCTED IN STAGE 2. ALL WORKERS MUST HAVE DETOUR ACCESS AND DO NOT REQUIRE A DETOUR. SEE PEDESTRIAN ACCOMMODATIONS - STAGE 2.

* CR-17A/B
TEMPORARY ACCESS
DETOUR NOT REQ'D

* CR-22A

* CR-24

* CR-26

- 1
- 2
- 3
- 4

- LEGEND
- SIGN ON TEMPORARY SUPPORT
 - WORK AREA
 - DETOUR ROUTE
 - SEE PEDESTRIAN ACCOMMODATIONS - STAGE 2

Addendum No. 01
 ID 6950-04-72
 Revised Sheet 77
 February 6, 2024

2

2

BICYCLE AND PEDESTRIAN DETOUR FOR CULVERT REPLACEMENT

LEGEND

- ◆ DETOUR
- ◆ WORK ZONE
- * STAGE 2 WORK ONLY

ALL SIGNS TO BE ON TEMPORARY SIGN SUPPORTS

1. SIGN 307X18" M4-9AAL 307924"
2. SIGN 307X18" M4-9AAL 307924"
3. SIGN 307X24" M4-9AAL 307924"
4. SIGN 307X24" M4-9AAL 307924"
5. TRAIL CLOSED ALONG HWY 54 AT 771151

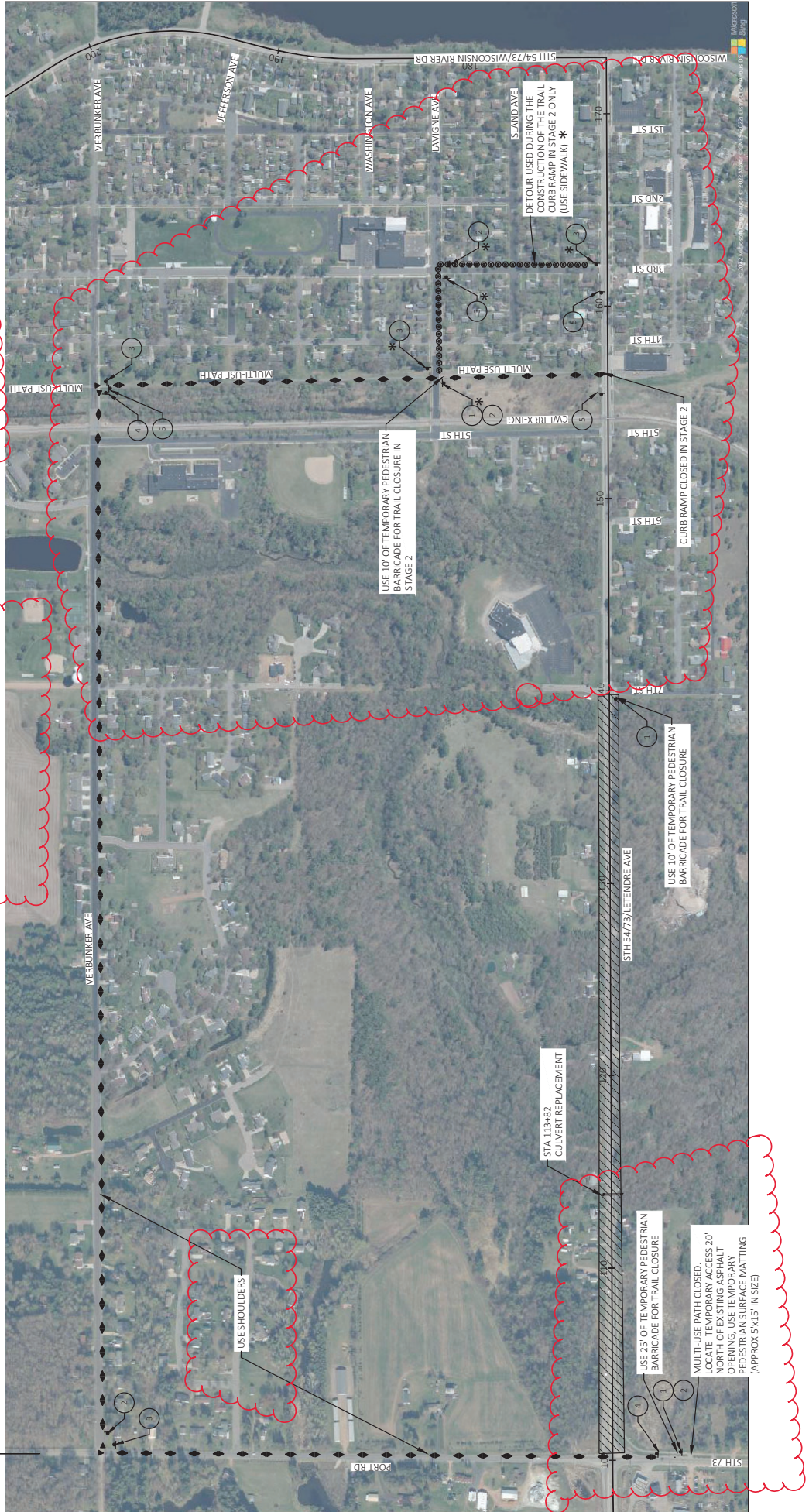

PROJECT NO: 6950-04-72

HWY: STH 54

COUNTY: WOOD

BICYCLE AND PEDESTRIAN DETOUR

SHEET 77

E

FILE NAME: I:\EVAL0078_STH54_73\GIS\SHETS\PLAN\027004-DT.DWG

LAYOUT NAME: 05-01

FLYBY: RESHEKE, CARRE

PLOT DATE: 2/7/2024 2:32 PM

PLOT SCALE: 1 IN=500 FT

WIS007/CADD/SHEET 42

TRAFFIC CONTROL SIGNS FIXED MESSAGE

LOCATION	MESSAGE	SIGN CODE	WxL (INCHES)	SIGN SIZE	TRAFFIC CONTROL SIGNS	FIXED MESSAGE	SF
SEE DETOUR SHEETS FOR LOCATION	"ROAD OPEN TO SENECA RD"	R10-61	60x30	60x30	TRAFFIC CONTROL SIGNS	TRAFFIC CONTROL SIGNS	32.00
SEE DETOUR SHEETS FOR LOCATION	"ROAD OPEN TO NEKOOSA"	R10-61	60x30	60x30	TRAFFIC CONTROL SIGNS	TRAFFIC CONTROL SIGNS	32.00
SEE DETOUR SHEETS FOR LOCATION	"ROAD OPEN TO PORT EDWARDS"	R10-61	78x36	78x36	TRAFFIC CONTROL SIGNS	TRAFFIC CONTROL SIGNS	32.00
SEE DETOUR SHEETS FOR LOCATION	"ROAD OPEN TO PORT EDWARDS"	R10-61	78x36	78x36	TRAFFIC CONTROL SIGNS	TRAFFIC CONTROL SIGNS	32.00
SEE DETOUR SHEETS FOR LOCATION	"ROAD OPEN TO HWY 54 WEST"	R10-61	60x30	60x30	TRAFFIC CONTROL SIGNS	TRAFFIC CONTROL SIGNS	32.00
SEE DETOUR SHEETS FOR LOCATION	"ROAD OPEN TO HWY 54 WEST"	R10-61	60x30	60x30	TRAFFIC CONTROL SIGNS	TRAFFIC CONTROL SIGNS	32.00
SEE DETOUR SHEETS FOR LOCATION	"ROAD OPEN TO HWY 54 AT 7TH ST"	R10-61	30x18	30x18	TRAFFIC CONTROL SIGNS	TRAFFIC CONTROL SIGNS	3.75
SEE DETOUR SHEETS FOR LOCATION	"TRAIL CLOSED ALONG HWY 54 AT 7TH ST"	R10-61	30x18	30x18	TRAFFIC CONTROL SIGNS	TRAFFIC CONTROL SIGNS	3.75
SEE DETOUR SHEETS FOR LOCATION	"TRAIL CLOSED ALONG HWY 54 AT 7TH ST"	R10-61	30x18	30x18	TRAFFIC CONTROL SIGNS	TRAFFIC CONTROL SIGNS	3.75
TOTAL 0010 260.25							

TRAFFIC CONTROL ITEMS

LOCATION	MESSAGE	SIGN CODE	WxL (INCHES)	SIGN SIZE	TRAFFIC CONTROL SIGNS	FIXED MESSAGE	SF
SEE DETOUR SHEETS FOR LOCATION	"ROAD OPEN TO HWY 54 AT 7TH ST"	R10-61	30x18	30x18	TRAFFIC CONTROL SIGNS	TRAFFIC CONTROL SIGNS	3.75
SEE DETOUR SHEETS FOR LOCATION	"TRAIL CLOSED ALONG HWY 54 AT 7TH ST"	R10-61	30x18	30x18	TRAFFIC CONTROL SIGNS	TRAFFIC CONTROL SIGNS	3.75
SEE DETOUR SHEETS FOR LOCATION	"TRAIL CLOSED ALONG HWY 54 AT 7TH ST"	R10-61	30x18	30x18	TRAFFIC CONTROL SIGNS	TRAFFIC CONTROL SIGNS	3.75
TOTAL 0010 260.25							

FIELD OFFICE TYPE B

LOCATION	MESSAGE	SIGN CODE	WxL (INCHES)	SIGN SIZE	TRAFFIC CONTROL SIGNS	FIXED MESSAGE	SF
SEE DETOUR SHEETS FOR LOCATION	"ROAD OPEN TO HWY 54 AT 7TH ST"	R10-61	30x18	30x18	TRAFFIC CONTROL SIGNS	TRAFFIC CONTROL SIGNS	3.75
SEE DETOUR SHEETS FOR LOCATION	"TRAIL CLOSED ALONG HWY 54 AT 7TH ST"	R10-61	30x18	30x18	TRAFFIC CONTROL SIGNS	TRAFFIC CONTROL SIGNS	3.75
SEE DETOUR SHEETS FOR LOCATION	"TRAIL CLOSED ALONG HWY 54 AT 7TH ST"	R10-61	30x18	30x18	TRAFFIC CONTROL SIGNS	TRAFFIC CONTROL SIGNS	3.75
TOTAL 0010 260.25							

Addendum No. 01
 ID 6950-04-72
 Revised Sheet 91
 February 6, 2024

TEMPORARY PEDESTRIAN ACCOMMODATION ITEMS

CURB RAMP #	LOCATION	TRAFFIC CONTROL DRUMS EACH DAY	TEMPORARY MARKING CROSSWALK REMOVABLE TAPE 6-INCH LF	TEMPORARY PEDESTRIAN SURFACE PLATE SF	TEMPORARY PEDESTRIAN SURFACE MATTING SF	TEMPORARY PEDESTRIAN CURB RAMP EACH DAY	TEMPORARY DETECTABLE WARNING FIELD SF	TEMPORARY PEDESTRIAN BARRICADE LF	REMARKS
	NORTH SIDE BETWEEN 7TH & 4TH	7	175	288			60	410	STAGE 1
	NORTH SIDE BETWEEN 5TH & TRAIL		93						STAGE 2
CR-1	SW QUAD 7TH/STH 54	10	250	80	64		20	43	STAGE 1
CR-2A/2B	SE QUAD 7TH/STH 54	13	325						STAGE 1
CR-3	NE QUAD 7TH/STH 54	10	250						STAGE 2
CR-4A/4B	SW QUAD 5TH/STH 54	12	300						STAGE 1
CR-5/RR1/RR2	SE QUAD 5TH/STH 54/RAILROAD	18	450						STAGE 1
CR-6	NORTH TRAIL (156+63)	8	200						STAGE 1
CR-7	SOUTH TRAIL (156+63)	9	225						STAGE 1
CR-7A/7B	NW QUAD 4TH/STH 54	12	300	40	33	1	25	10	STAGE 2
CR-8A/8B	SE QUAD 4TH/STH 54	14	350	42	35	30	1	25	STAGE 1
CR-8C	SE QUAD 4TH/STH 54	12	300	77	33	1	25	10	STAGE 2
CR-9	NW QUAD 3RD/STH 54	14	350	93	34	40	1	25	STAGE 2
CR-10	SW QUAD 3RD/STH 54	13	325	176	35	30	1	25	STAGE 1
CR-11A/11B	NE QUAD 3RD/STH 54	10	250	47	68	105	2	50	STAGE 1
CR-12A/12B	SE QUAD 3RD/STH 54	10	250	48	62	2	50	20	STAGE 2
CR-13A/13B	NW QUAD 2ND/STH 54	10	250	50	69	2	50	20	STAGE 1
CR-14A/14B	SW QUAD 2ND/STH 54	10	250	48	63	2	50	20	STAGE 2
CR-15	NE QUAD 2ND/STH 54	17	425	80	31	43	1	25	STAGE 2
CR-16	SE QUAD 2ND/STH 54	10	250	76	25	29	1	25	STAGE 1
CR-17A/17B	SW QUAD 1ST/STH 54	10	250	48	35	28	1	25	STAGE 2
CR-17C	SE QUAD 1ST/STH 54	10	250	70	25	29	1	25	STAGE 1
CR-18	SW QUAD WISCONSIN RIVER DR/STH 54	5	125		17	25	1	25	STAGE 1
CR-21	NW QUAD WISCONSIN RIVER DR/STH 54	5	125		13	138	1	25	STAGE 1
CR-22	SOUTH ISLAND AVE/STH 54	10	250	108	25	29	1	25	STAGE 1
CR-22A	NORTH ISLAND AVE/STH 54	10	250	100	21	29	1	25	STAGE 2
CR-23	SOUTH LAVIGNE AVE/STH 54	10	250	106	25	28	1	25	STAGE 1
CR-24	NORTH WASHINGTON AVE/STH 54	10	250	160	24	26	1	25	STAGE 2
CR-25	SOUTH WASHINGTON AVE/STH 54	10	250	160	25	25	1	25	STAGE 2
CR-26	SOUTH JEFFERSON AVE/STH 54	10	250	108	25	25	1	25	STAGE 2
CR-27	NORTH JEFFERSON AVE/STH 54	10	250	110	30	26	1	25	STAGE 1
CR-28	SOUTH MONROE AVE/STH 54	10	250	92	41	28	1	25	STAGE 1
CR-29	SOUTH JACKSON AVE/STH 54	38	950	104	62	26	2	50	STAGE 1
CR-30	NORTH JACKSON AVE/STH 54	10	250	76	40	26	1	25	STAGE 2
CR-31	NORTH 3RD ST/STH 54	13	325	79	49	165	1	25	STAGE 1
	BICYCLE AND PEDESTRIAN DETOUR					75			DETOUR
TOTAL 0010		9,750	2,559	957	1,327	775	384	3,538	

ALL ITEMS ON THIS SHEET
 ARE CATEGORY 0.010
 UNLESS OTHERWISE NOTED

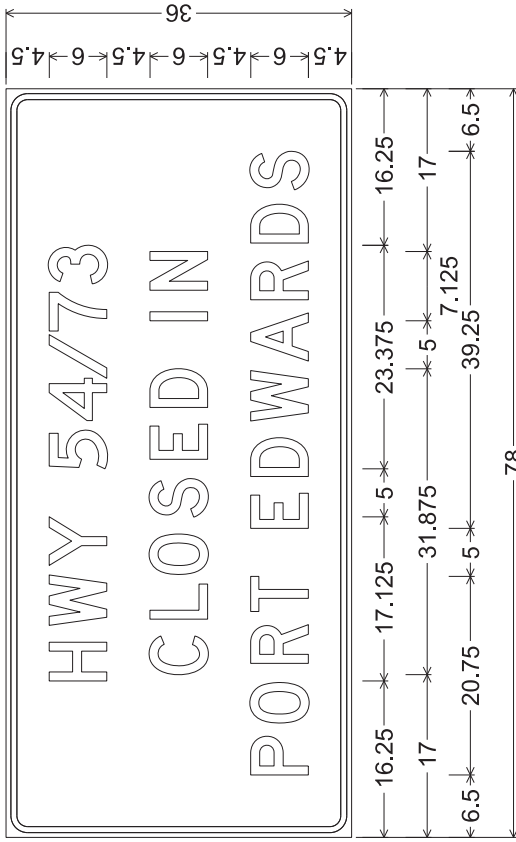

2.250" Radius, 0.625" Border, 0.500" Indent,
 "HWY", D; "54/73", D; "CLOSED", D; "IN", D; "PORT", D; "EDWARDS", D

NOTES

1. Fixed Message Signs Type II - Type F Reflective
2. Color:
 - Background - Orange
 - Message - Black
3. Message Series - C except as noted

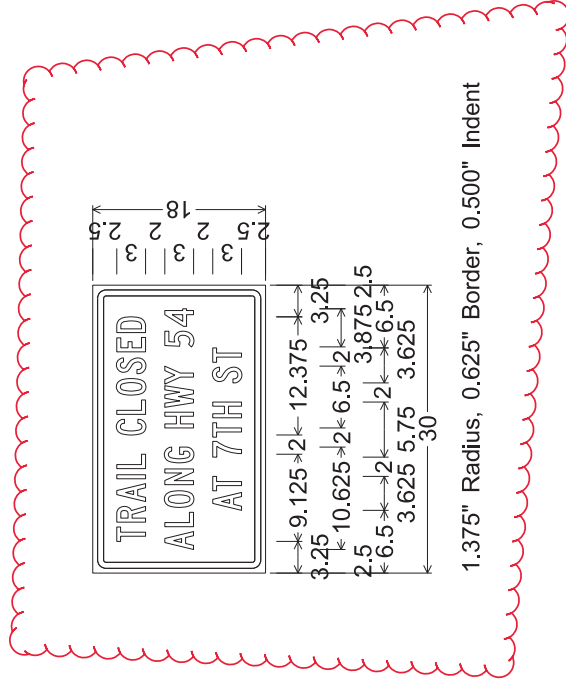

Addendum No. 01
 ID 6950-04-72
 Revised Sheet 199
 February 6, 2024



Proposal Schedule of Items

Proposal ID: 20240213029 Project(s): 6950-04-72, 6950-04-73, 6950-04-82

Federal ID(s): N/A, N/A, N/A

SECTION: 0001 Contract Items

Alt Set ID: Alt Mbr ID:

Proposal Line Number	Item ID Description	Approximate Quantity and Units	Unit Price	Bid Amount
0154	643.0300 Traffic Control Drums	9,750.000 DAY	_____.	_____.
0156	643.0420 Traffic Control Barricades Type III	1,250.000 DAY	_____.	_____.
0158	643.0705 Traffic Control Warning Lights Type A	1,760.000 DAY	_____.	_____.
0160	643.0900 Traffic Control Signs	3,610.000 DAY	_____.	_____.
0162	643.0920 Traffic Control Covering Signs Type II	32.000 EACH	_____.	_____.
0164	643.1000 Traffic Control Signs Fixed Message	292.250 SF	_____.	_____.
0166	643.3165 Temporary Marking Line Paint 6-Inch	32,947.000 LF	_____.	_____.
0168	643.3350 Temporary Marking Crosswalk Removable Tape 6-inch	2,559.000 LF	_____.	_____.
0170	643.5000 Traffic Control	1.000 EACH	_____.	_____.
0172	644.1430 Temporary Pedestrian Surface Plate	957.000 SF	_____.	_____.
0174	644.1440 Temporary Pedestrian Surface Matting	1,327.000 SF	_____.	_____.
0176	644.1601 Temporary Pedestrian Curb Ramp	775.000 DAY	_____.	_____.
0178	644.1605 Temporary Pedestrian Detectable Warning Field	384.000 SF	_____.	_____.
0180	644.1810 Temporary Pedestrian Barricade	3,558.000 LF	_____.	_____.
0182	645.0120 Geotextile Type HR	40.000 SY	_____.	_____.
0184	646.1020 Marking Line Epoxy 4-Inch	694.000 LF	_____.	_____.

