

HIGHWAY WORK PROPOSAL

Wisconsin Department of Transportation
DT1502 01/2020 s.66.0901(7) Wis. Stats

Proposal Number: **029**

<u>COUNTY</u>	<u>STATE PROJECT</u>	<u>FEDERAL</u>	<u>PROJECT DESCRIPTION</u>	<u>HIGHWAY</u>
Wood	6950-04-72	N/A	Dexterville - Wisconsin Rapids; Swanson Road to Seneca Road	STH 054
Wood	6950-04-73	N/A	Dexterville - Wisconsin Rapids; CTH G to Swanson Road	STH 054
Wood	6950-04-82	N/A	Dexterville - Wisconsin Rapids; Swanson Road to Seneca Road	STH 054

ADDENDUM REQUIRED ATTACHED AT BACK

This proposal, submitted by the undersigned bidder to the Wisconsin Department of Transportation, is in accordance with the advertised request for proposals. The bidder is to furnish and deliver all materials, and to perform all work for the improvement of the designated project in the time specified, in accordance with the appended Proposal Requirements and Conditions.

Proposal Guaranty Required: \$75,000.00 Payable to: Wisconsin Department of Transportation	Attach Proposal Guaranty on back of this PAGE.
Bid Submittal Date: February 13, 2024 Time (Local Time): 11:00 am	Firm Name, Address, City, State, Zip Code <h3 style="margin: 0;">SAMPLE</h3> <h3 style="margin: 0;">NOT FOR BIDDING PURPOSES</h3> <p style="margin: 0;">This contract is exempt from federal oversight.</p>
Contract Completion Time July 02, 2024	
Assigned Disadvantaged Business Enterprise Goal 0%	

This certifies that the undersigned bidder, duly sworn, is an authorized representative of the firm named above; that the bidder has examined and carefully prepared the bid from the plans, Highway Work Proposal, and all addenda, and has checked the same in detail before submitting this proposal or bid; and that the bidder or agents, officer, or employees have not, either directly or indirectly, entered into any agreement, participated in any collusion, or otherwise taken any action in restraint of free competitive bidding in connection with this proposal bid.

Do not sign, notarize, or submit this Highway Work Proposal when submitting an electronic bid on the Internet.

Subscribed and sworn to before me this date _____

(Signature, Notary Public, State of Wisconsin)

(Bidder Signature)

(Print or Type Name, Notary Public, State Wisconsin)

(Print or Type Bidder Name)

(Date Commission Expires)

(Bidder Title)

Notary Seal

Type of Work:	For Department Use Only
Grading, Base, Milling, Asphalt Pavement, Culvert Pipe, Storm Sewer, Curb and Gutter, Sidewalk, Concrete Driveway, Guardrail, Signs, Pavement Markings.	
Notice of Award Dated	Date Guaranty Returned

**PLEASE ATTACH
PROPOSAL GUARANTY HERE**

PROPOSAL REQUIREMENTS AND CONDITIONS

The bidder, signing and submitting this proposal, agrees and declares as a condition thereof, to be bound by the following conditions and requirements.

If the bidder has a corporate relationship with the proposal design engineering company, the bidder declares that it did not obtain any facts, data, or other information related to this proposal from the design engineering company that was not available to all bidders.

The bidder declares that they have carefully examined the site of, and the proposal, plans, specifications and contract forms for the work contemplated, and it is assumed that the bidder has investigated and is satisfied as to the conditions to be encountered, as to the character, quality, and quantities of work to be performed and materials to be furnished, and as to the requirements of the specifications, special provisions and contract. It is mutually agreed that submission of a proposal shall be considered conclusive evidence that the bidder has made such examination.

The bidder submits herewith a proposal guaranty in proper form and amount payable to the party as designated in the advertisement inviting proposals, to be retained by and become the property of the owner of the work in the event the undersigned shall fail to execute the contract and contract bond and return the same to the office of the engineer within fourteen (14) days after having been notified in writing to do so; otherwise to be returned.

The bidder declares that they understand that the estimate of quantities in the attached schedule is approximate only and that the attached quantities may be greater or less in accordance with the specifications.

The bidder agrees to perform the said work, for and in consideration of the payment of the amount becoming due on account of work performed, according to the unit prices bid in the following schedule, and to accept such amounts in full payment of said work.

The bidder declares that all of the said work will be performed at their own proper cost and expense, that they will furnish all necessary materials, labor, tools, machinery, apparatus, and other means of construction in the manner provided in the applicable specifications and the approved plans for the work together with all standard and special designs that may be designed on such plans, and the special provisions in the contract of which this proposal will become a part, if and when accepted. The bidder further agrees that the applicable specifications and all plans and working drawings are made a part hereof, as fully and completely as if attached hereto.

The bidder, if awarded the contract, agrees to begin the work not later than ten (10) days after the date of written notification from the engineer to do so, unless otherwise stipulated in the special provisions.

The bidder declares that if they are awarded the contract, they will execute the contract agreement and begin and complete the work within the time named herein, and they will file a good and sufficient surety bond for the amount of the contract for performance and also for the full amount of the contract for payment.

The bidder, if awarded the contract, shall pay all claims as required by Section 779.14, Statutes of Wisconsin, and shall be subject to and discharge all liabilities for injuries pursuant to Chapter 102 of the Statutes of Wisconsin, and all acts amendatory thereto. They shall further be responsible for any damages to property or injury to persons occurring through their own negligence or that of their employees or agents, incident to the performance of work under this contract, pursuant to the Standard Specifications for Road and Bridge Construction applicable to this contract.

In connection with the performance of work under this contract, the contractor agrees to comply with all applicable state and federal statutes relating to non-discrimination in employment. No otherwise qualified person shall be excluded from employment or otherwise be subject to discrimination in employment in any manner on the basis of age, race, religion, color, gender, national origin or ancestry, disability, arrest or conviction record (in keeping with s.111.32), sexual orientation, marital status, membership in the military reserve, honesty testing, genetic testing, and outside use of lawful products. This provision shall include, but not be limited to the following: employment, upgrading, demotion or transfer; recruitment or recruitment advertising; layoff or termination; rates of pay or other forms of compensation, and selection for training, including apprenticeship. The contractor further agrees to ensure equal opportunity in employment to all applicants and employees and to take affirmative action to attain a representative workforce.

The contractor agrees to post notices and posters setting forth the provisions of the nondiscrimination clause, in a conspicuous and easily accessible place, available for employees and applicants for employment.

If a state public official (section 19.42, Stats.) or an organization in which a state public official holds at least a 10% interest is a party to this agreement, this contract is voidable by the state unless appropriate disclosure is made to the State of Wisconsin Ethics Board.

BID PREPARATION

Preparing the Proposal Schedule of Items

A. General

- (1) Obtain bidding proposals as specified in section 102 of the standard specifications prior to 11:45 AM of the last business day preceding the letting. Submit bidding proposals using one of the following methods:
 1. Electronic bid on the internet.
 2. Electronic bid on a printout with accompanying diskette or CD ROM.
 3. Paper bid under a waiver of the electronic submittal requirements.
- (2) Bids submitted on a printout with accompanying diskette or CD ROM or paper bids submitted under a waiver of the electronic submittal requirements govern over bids submitted on the internet.
- (3) The department will provide bidding information through the department's web site at:

<https://wisconsin.gov/Pages/doing-bus/contractors/hcci/bid-let.aspx>

The contractor is responsible for reviewing this web site for general notices as well as information regarding proposals in each letting. The department will also post special notices of all addenda to each proposal through this web site no later than 4:00 PM local time on the Thursday before the letting. Check the department's web site after 5:00 PM local time on the Thursday before the letting to ensure all addenda have been accounted for before preparing the bid. When bidding using methods 1 and 2 above, check the Bid Express™ on-line bidding exchange at <http://www.bidx.com/> after 5:00 PM local time on the Thursday before the letting to ensure that the latest schedule of items Expedite file (*.ebs or *.00x) is used to submit the final bid.

- (4) Interested parties can subscribe to the Bid Express™ on-line bidding exchange by following the instructions provided at the www.bidx.com web site or by contacting:

Info Tech Inc.
5700 SW 34th Street, Suite 1235
Gainesville, FL 32608-5371
email: <mailto:customer.support@bidx.com>

- (5) The department will address equipment and process failures, if the bidder can demonstrate that those failures were beyond their control.
- (6) Contractors are responsible for checking on the issuance of addenda and for obtaining the addenda. Notice of issuance of addenda is posted on the department's web site at:

<https://wisconsin.gov/Pages/doing-bus/contractors/hcci/bid-let.aspx>

or by calling the department at (608) 266-1631. Addenda can ONLY be obtained from the department's web site listed above or by picking up the addenda at the Bureau of Highway Construction, 4th floor, 4822 Madison Yards Way, Madison, WI, during regular business hours.

- (7) Addenda posted after 5:00 PM on the Thursday before the letting will be emailed to the eligible bidders for that proposal. All eligible bidders shall acknowledge receipt of the addenda whether they are bidding on the proposal or not. Not acknowledging receipt may jeopardize the awarding of the project.

B. Submitting Electronic Bids

B.1 On the Internet

- (1) Do the following before submitting the bid:
 4. Have a properly executed annual bid bond on file with the department.
 5. Have a digital ID on file with and enabled by Info Tech Inc. Using this digital ID will constitute the bidder's signature for proper execution of the bidding proposal.
- (2) In lieu of preparing, delivering, and submitting the proposal as specified in 102.6 and 102.9 of the standard specifications, submit the proposal on the internet as follows:
 1. Download the latest schedule of items reflecting all addenda from the Bid Express™ web site.
 2. Use Expedite™ software to enter a unit price for every item in the schedule of items.
 3. Submit the bid according to the requirements of Expedite™ software and the Bid Express™ web site. Do not submit a bid on a printout with accompanying diskette or CD ROM or a paper bid. If the bidder does submit a bid on a printout with accompanying diskette or a paper bid in addition to the internet submittal, the department will disregard the internet bid.
 4. Submit the bid before the hour and date the Notice to Contractors designates.
 5. Do not sign, notarize, and return the bidding proposal described in 102.2 of the standard specifications.
- (3) The department will not consider the bid accepted until the hour and date the Notice to Contractors designates.

B.2 On a Printout with Accompanying Diskette or CD ROM

- (1) Download the latest schedule of items from the Wisconsin pages of the Bid Express web site reflecting the latest addenda posted on the department's web site at:
<https://wisconsin.gov/Pages/doing-bus/contractors/hcci/bid-let.aspx>
 Use Expedite™ software to prepare and print the schedule of items. Provide a valid amount for all price fields. Follow instructions and review the help screens provided on the Bid Express™ web site to assure that the schedule of items is prepared properly.

- (2) Staple an 8 1/2 by 11 inch printout of the Expedite™ generated schedule of items to the other proposal documents submitted to the department as a part of the bidder's sealed bid. As a separate submittal, not in the sealed bid envelope but due at the same time and place as the sealed bid, also provide the Expedite™ generated schedule of items on a 3 1/2 inch computer diskette or CD ROM. Label each diskette or CD ROM with the bidder's name, the 4 character department-assigned bidder identification code from the top of the bidding proposal, and a list of the proposal numbers included on that diskette or CD ROM as indicated in the following example:

Bidder Name

BN00

Proposals: 1, 12, 14, & 22

- (3) If bidding on more than one proposal in the letting, the bidder may include all proposals for that letting on one diskette or CD ROM. Include only submitted proposals with no incomplete or other files on the diskette or CD ROM.
- (4) The bidder-submitted printout of the Expedite™ generated schedule of items is the governing contract document and must conform to the requirements of section 102 of the standard specifications. If a printout needs to be altered, cross out the printed information with ink or typewriter and enter the new information and initial it in ink. If there is a discrepancy between the printout and the diskette or CD ROM, the department will analyze the bid using the printout information.

- (5) In addition to the reasons specified in section 102 of the standard specifications, proposals are irregular and the department may reject them for one or more of the following:
1. The check code printed on the bottom of the printout of the Expedite™ generated schedule of items is not the same on each page.
 2. The check code printed on the printout of the Expedite™ generated schedule of items is not the same as the check code for that proposal provided on the diskette or CD ROM.
 3. The diskette or CD ROM is not submitted at the time and place the department designates.

B Waiver of Electronic Submittal

- (1) The bidder may request a waiver of the electronic submittal requirements. Submit a written request for a waiver in lieu of bids submitted on the internet or on a printout with accompanying diskette or CD ROM. Use the waiver that was included with the paper bid document sent to the bidder or type up a waiver on the bidder's letterhead. The department will waive the electronic submittal requirements for a bidding entity (individual, partnership, joint venture, corporation, or limited liability company) for up to 4 individual proposals in a calendar year. The department may allow additional waivers for equipment malfunctions.
- (2) Submit a schedule of items on paper conforming to section 102 of the standard specifications. The department charges the bidder a \$75 administrative fee per proposal, payable at the time and place the department designates for receiving bids, to cover the costs of data entry. The department will accept a check or money order payable to: "Wisconsin, Dept. of Transportation."
- (3) In addition to the reasons specified in section 102 of the standard specifications, proposals are irregular and the department may reject them for one or more of the following:
 1. The bidder fails to provide the written request for waiver of the electronic submittal requirements.
 2. The bidder fails to pay the \$75 administrative fee before the time the department designates for the opening of bids unless the bidder requests on the waiver that they be billed for the \$75.
 3. The bidder exceeds 4 waivers of electronic submittal requirements within a calendar year.
- (4) In addition to the reasons specified in section 102 of the standard specifications, the department may refuse to issue bidding proposals for future contracts to a bidding entity that owes the department administrative fees for a waiver of electronic submittal requirements.

PROPOSAL BID BOND

DT1303 1/2006

Wisconsin Department of Transportation

Proposal Number	Project Number	Letting Date
Name of Principal		
Name of Surety	State in Which Surety is Organized	

We, the above-named Principal and the above-named Surety, are held and firmly bound unto the State of Wisconsin in the sum equal to the Proposal Guaranty for the total bid submitted for the payment to be made; we jointly and severally bind ourselves, our heirs, executors, administrators, successors and assigns. The condition of this obligation is that the Principal has submitted a bid proposal to the State of Wisconsin acting through the Department of Transportation for the improvement designated by the Proposal Number and Letting Date indicated above.

If the Principal is awarded the contract and, within the time and manner required by law after the prescribed forms are presented for signature, enters into a written contract in accordance with the bid, and files the bond with the Department of Transportation to guarantee faithful performance and payment for labor and materials, as required by law, or if the Department of Transportation shall reject all bids for the work described, then this obligation shall be null and void; otherwise, it shall be and remain in full force and effect. In the event of failure of the Principal to enter into the contract or give the specified bond, the Principal shall pay to the Department of Transportation **within 10 business days of demand** a total equal to the Proposal Guaranty as liquidated damages; the liability of the Surety continues for the full amount of the obligation as stated until the obligation is paid in full.

The Surety, for value received, agrees that the obligations of it and its bond shall not be impaired or affected by any extension of time within which the Department of Transportation may accept the bid; and the Surety does waive notice of any such extension.

IN WITNESS, the Principal and Surety have agreed and have signed by their proper officers and have caused their corporate seals to be affixed this date: **(DATE MUST BE ENTERED)**

PRINCIPAL

(Company Name) **(Affix Corporate Seal)**

(Signature and Title)

(Company Name)

(Signature and Title)

(Company Name)

(Signature and Title)

(Company Name)

(Signature and Title)

(Name of Surety) **(Affix Seal)**

(Signature of Attorney-in-Fact)

NOTARY FOR PRINCIPAL

NOTARY FOR SURETY

(Date)

(Date)

State of Wisconsin)
) ss.
 _____ County)

State of Wisconsin)
) ss.
 _____ County)

On the above date, this instrument was acknowledged before me by the named person(s).

On the above date, this instrument was acknowledged before me by the named person(s).

(Signature, Notary Public, State of Wisconsin)

(Signature, Notary Public, State of Wisconsin)

(Print or Type Name, Notary Public, State of Wisconsin)

(Print or Type Name, Notary Public, State of Wisconsin)

(Date Commission Expires)

(Date Commission Expires)

Notary Seal

Notary Seal

IMPORTANT: A certified copy of Power of Attorney of the signatory agent must be attached to the bid bond.

CERTIFICATE OF ANNUAL BID BOND

DT1305 8/2003

Wisconsin Department of Transportation

Time Period Valid (From/To)
Name of Surety
Name of Contractor
Certificate Holder Wisconsin Department of Transportation

This is to certify that an annual bid bond issued by the above-named Surety is currently on file with the Wisconsin Department of Transportation.

This certificate is issued as a matter of information and conveys no rights upon the certificate holder and does not amend, extend or alter the coverage of the annual bid bond.

Cancellation: Should the above policy be cancelled before the expiration date, the issuing surety will give thirty (30) days written notice to the certificate holder indicated above.

(Signature of Authorized Contractor Representative)

(Date)

CERTIFICATION REGARDING DEBARMENT, SUSPENSION, AND OTHER RESPONSIBILITY MATTERS - PRIMARY COVERED TRANSACTIONS

Instructions for Certification

1. By signing and submitting this proposal, the prospective contractor is providing the certification set out below.
2. The inability of a person to provide the certification required below will not necessarily result in denial of participation in this covered transaction. The prospective contractor shall submit an explanation of why it cannot provide the certification set out below. The certification or explanation will be considered in connection with the department or agency's determination whether to enter into this transaction. However, failure of the prospective contractor to furnish a certification or an explanation shall disqualify such person from participation in this transaction.
3. The certification in this clause is a material representation of fact upon which reliance was placed when the department determined to enter into this transaction. If it is later determined that the contractor knowingly rendered an erroneous certification in addition to other remedies available to the Federal Government the department may terminate this transaction for cause or default.
4. The prospective contractor shall provide immediate written notice to the department to whom this proposal is submitted if at any time the prospective contractor learns that its certification was erroneous when submitted or has become erroneous by reason of changed circumstances.
5. The terms "covered transaction," "debarred," "suspended," "ineligible," "lower tier covered transaction," "participant," "person," "primary covered transaction," "principal," "proposal," and "voluntarily excluded," as used in this clause, have the meanings set out in the Definitions and Coverage sections of the rules implementing Executive Order 12549. You may contact the department to which this proposal is being submitted for assistance in obtaining a copy of those regulations.
6. The prospective contractor agrees by submitting this proposal that, should this contract be entered into, it shall not knowingly enter into any lower tier covered transaction with a person who is debarred, suspended, declared ineligible, or voluntarily excluded from participation in this covered transaction, unless authorized by the department entering into this transaction.
7. The prospective contractor further agrees by submitting this proposal that it will include the clause titled "Certification Regarding Debarment, Suspension, Ineligibility and Voluntary Exclusion-Lower Tier Covered Transaction," which is included as an addendum to PR- 1273 - "Required Contract Provisions Federal Aid Construction Contracts," without modification, in all lower tier covered transactions and in all solicitations for lower tier covered transactions.
8. The contractor may rely upon a certification of a prospective subcontractor/materials supplier that it is not debarred, suspended, ineligible, or voluntarily excluded from the covered transaction, unless it knows that the certification is erroneous. A contractor may decide the method and frequency by which it determines the eligibility of its principals. Each contractor may, but is not required to, check the Disapproval List (telephone # 608/266/1631).

9. Nothing contained in the foregoing shall be construed to require establishment of a system of records in order to render in good faith the certification required by this clause. The knowledge and information of a contractor is not required to exceed that which is normally possessed by a prudent person in the ordinary course of business dealings.
10. Except for transactions authorized under paragraph 6 of these instructions, if a contractor in a covered transaction knowingly enters into a lower tier covered transaction with a person who is suspended, debarred, ineligible or voluntarily excluded from participation in this transaction, in addition to other remedies available to the Federal Government, the department may terminate this transaction for cause or default.

Certification Regarding Debarment, Suspension, and Other Responsibility Matters - Primary Covered Transactions

1. The prospective contractor certifies to the best of its knowledge and belief, that it and its principals:
 - (a) Are not presently debarred, suspended, proposed for debarment, declared ineligible, or voluntarily excluded from covered transactions by any Federal department or agency;
 - (b) Have not within a three-year period preceding this proposal been convicted of or had a civil judgment rendered against them for commission of fraud or a criminal offense in connection with obtaining, attempting to obtain, or performing a public (Federal, State or local) transaction or contract under a public transaction; violation of Federal or State antitrust statutes or commission of embezzlement, theft, forgery, bribery, falsification or destruction of records, making false statements or receiving stolen property;
 - (c) Are not presently indicted for or otherwise criminally or civilly charged by a governmental entity (Federal, State or local) with commission of any of the offense enumerated in paragraph (1)(b) of this certification; and
 - (d) Have not within a three-year period preceding this proposal had one or more public transactions (Federal, State or local) terminated for cause or default.
2. Where the prospective contractor is unable to certify to any of the statements in this certification, such prospective contractor shall attach an explanation to this proposal.

Special Provisions

Table of Contents

Article	Description	Page #
1.	General.....	2
2.	Scope of Work.....	2
3.	Prosecution and Progress.....	2
4.	Traffic.....	4
5.	Holiday and Special Event Work Restrictions.....	5
6.	Utilities.....	5
7.	Work By Others.....	7
8.	Railroad Insurance and Coordination - Wisconsin Central Ltd (CN).....	7
9.	Coordination with Businesses and Residents.....	9
10.	Information to Bidders, U.S. Army Corps of Engineers Section 404 Permit.....	9
11.	Information to Bidders, WPDES Transportation Construction General Permit (TCGP) for Storm Water Discharges.....	9
12.	Public Convenience and Safety.....	9
13.	Property Marks – Protecting and Restoring.....	10
14.	Property Marks – Coordination with County Surveyor.....	10
15.	Environmental Protection, Aquatic Exotic Species Control.....	10
16.	Environmental Protection – Dewatering.....	11
17.	Erosion Control.....	11
18.	Protecting Concrete.....	12
19.	QMP HMA Pavement Nuclear Density.....	12
20.	Asphaltic Surface.....	15
21.	Pipe Culverts.....	15
22.	Storm Sewer.....	15
23.	Adjusting Manhole Covers, Item 611.8110.....	16
24.	Cover Plates Temporary, Item 611.8120.S.....	16
25.	Landmark Reference Monuments.....	16
26.	Field Facilities.....	17
27.	Traffic Control.....	17
28.	Fertilizer for Lawn Type Turf, Item SPV.0030.01.....	18
29.	Reestablish Section Corner Monuments, Item SPV.0060.01.....	19
30.	Adjusting Water Valve Boxes, Item SPV.0060.02.....	19
31.	Temporary Water Diversion, Item SPV.0060.03.....	20
32.	Salvage and Reinstall Lighting Unit, Item SPV.0060.04.....	21
33.	Storm Sewer Repair, Item SPV.0060.05.....	21
34.	Preparing Topsoil For Lawn Type Turf, Item SPV.0180.01.....	22
35.	Removing Distressed Asphaltic Surface Milling, Item SPV.0180.02.....	22

STSP'S Revised June 29, 2023

SPECIAL PROVISIONS

1. General.

Perform the work under this construction contract for Project 6950-04-72, Dexterville - Wisconsin Rapids, Swanson Road to Seneca Road; Project 6950-04-73, Dexterville - Wisconsin Rapids, CTH G to Swanson Road; and Project 6950-04-82, Dexterville – Wisconsin Rapids, Swanson Road to Seneca Road – Utility Adjustments; all projects on STH 54 located in Wood County, Wisconsin as the plans show and execute the work as specified in the State of Wisconsin, Department of Transportation, Standard Specifications for Highway and Structure Construction, 2024 Edition, as published by the department, and these special provisions.

If all or a portion of the plans and special provisions are developed in the SI metric system and the schedule of prices is developed in the US standard measure system, the department will pay for the work as bid in the US standard system.

100-005 (20230629)

2. Scope of Work.

The work under this contract shall consist of excavation, culvert replacement, milling, HMA pavement, curb and gutter, curb ramps, pavement marking and all incidental items necessary to complete the work as shown on the plans and included in the proposal and contract.

104-005 (20090901)

3. Prosecution and Progress.

Begin work within 10 calendar days after the engineer issues a written notice to do so.

Provide the start date to the engineer in writing within a month after executing the contract but at least 14 calendar days before the preconstruction conference. Upon approval, the engineer will issue the notice to proceed within ten calendar days before the approved start date.

To revise the start date, submit a written request to the engineer at least two weeks before the intended start date. The engineer will approve or deny that request based on the conditions cited in the request and its effect on the department's scheduled resources.

Construction Staging

Project 6950-04-72/82:

Stage 1: Mill and overlay STH 54/73/Letendre Avenue eastbound lane, base aggregate, curb ramps. STH 54/73/Wisconsin River Drive remove existing curb & gutter, excavate, and mill.

Stage 2: Mill and overlay STH 54/73/Letendre Avenue westbound lane, base aggregate, curb ramps and pavement marking. STH 54/73/Wisconsin River Drive place new curb and gutter, curb ramps, concrete sidewalk, HMA pavement, grade terrace.

STH 54/73/Letendre Avenue from STH 73 (Port Road) to 3rd Street may be closed for up to 5 days for culvert replacement (Station 113+82). During roadway closure all curb ramps between Port Road and the west side of 3rd Street shall be constructed.

Project 6950-04-73:

Stage 1: Mill STH 54 eastbound & westbound lanes

Stage 2: Overlay STH 54 eastbound & westbound lanes, shoulder base aggregate and pavement marking.

If contract time expires prior to completing all work specified in the contract, additional liquidated damages will be affixed according to standard spec 108.11.

Work Restrictions

A milled surface open to through traffic shall not remain in place for longer than 24 hours or during a weekend or periods included in the holidays and special events restrictions unless adverse weather prevents placement of the asphalt layer. Provide an even cross-sectional profile of each lane prior to reopening to traffic. An uneven profile within each lane is not allowed except within a flagging operation.

Traffic will be allowed to run on the lower layer of new HMA pavement for a maximum of 14 consecutive calendar days before the upper layer of HMA pavement must be in place.

Cease or alter work operations if traffic delays become longer than 15 minutes. The engineer may suspend work operations according to standard spec 108.5 (Limiting Operations) until contractor complies with 15-minute delay period. Continuation of operations will be considered Unauthorized Work per standard spec 105.3.2.3 and the department will not allow additional compensation or additional time due to such suspension of operations.

HMA Paving

Place the lower layer of asphaltic pavements on sideroads before the upper surface layer of asphaltic pavements are placed on the mainline adjacent to the sideroad.

Place the upper surface layer of asphaltic pavement on the sideroads within seven calendar days after the upper surface layer of asphaltic pavement is placed on the mainline.

ncr-108-010 (20131005)

Fish Spawning

There shall be no instream disturbance of Ripple Creek at Station 113+82 as a result of construction activity under or for this contract, from March 1 to June 15 both dates inclusive, in order to avoid adverse impacts upon the spawning of fish species and aquatic organisms.

Any change to this limitation will require submitting a written request by the contractor to the engineer, subsequent review and concurrence by the Department of Natural Resources in the request, and final approval by the engineer. The approval will include all conditions to the request as mutually agreed upon by WisDOT and DNR.

Migratory Birds

No evidence of swallow or other migratory bird nests have been observed on or under the following structures(s) during the preconstruction inspection. However, if nesting is later observed prior to or during construction, the contractor shall implement avoidance/deterrent measures or obtain a depredation permit. All active nests (when eggs or young are present) of migratory birds are protected under the federal Migratory Bird Treaty Act. The nesting season for swallows and other birds is from April 15 to August 31.

- Station 113+82

Wood Turtles and Blanding's Turtles

Wood turtles and Blanding's turtles are known to occur near the project limits. All areas proposed to be graded, must have silt fence installed with turtle turn-around ends (Temporary Exclusion Fencing) to prevent the Blanding's or Wood turtles from entering the project zone to nest. The Temporary Exclusion Fencing (FEF) must be installed prior to their combined active period beginning April 15 and remain in place until November 15.

Northern Long-eared Bat (*Myotis septentrionalis*)

Northern long-eared bats (NLEB) have the potential to inhabit the project limits because they roost in trees, bridges and culverts. Roosts may not have been observed on this project, but conditions to support the species exist. The species and all active roosts are protected by the federal Endangered Species Act. If an individual bat or active roost is encountered during construction operations, stop work, and notify the engineer and the WisDOT Regional Environmental Coordinator (REC).

Ensure all operators, employees, and subcontractors working in areas of known or presumed bat habitat are aware of environmental commitments and avoidance and minimization measures (AMMs) to protect both bats and their habitat.

Direct temporary lighting, if used, away from wooded areas during the bat active season April 1 to October 31, both dates inclusive.

The department has contracted with others and will perform the following operations after October 31 and prior to April 1:

- Cutting down and removing trees.

If there are clearing operations required to remove previously cut trees, submit a schedule and description with the ECIP 14 days prior to the work. The department will determine, based on schedule and scope of work, what additional erosion control measures shall be implemented prior to the start of clearing operations, and list those additional measures in the approval letter for the ECIP.

Contractor means and methods to remove additional trees will not be allowed. If it is determined that additional trees with a 3-inch or greater diameter at breast height (dbh) need to be removed beyond contractor means and methods, notify the engineer to coordinate with the WisDOT REC to determine if consultation with United States Fish and Wildlife Service (USFWS) is required. The contractor must be aware that the WisDOT REC and/or USFWS may not permit modifications.

4. Traffic.

Traffic Staging During Construction Operations

Project 6950-04-72/82:

STH 54/STH 73/Letendre Avenue: Keep STH 54 and side roads open to traffic at all times for milling and paving operations. During construction hours, close up to one lane of traffic, as necessary, with standard flagging operation. During non-working hours open STH 54 and side roads to two lanes of traffic, one in each direction.

Culvert (Station 113+82): Close STH 54/STH 73/Letendre Avenue and detour highway as shown in the plan.

STH 54/STH 73/Wisconsin River Drive: Close roadway and detour traffic as shown in the plan.

Maintain temporary pedestrian access at the beginning and end construction limits during construction. Provide a 4-foot wide minimum temporary sidewalk or equivalent, temporary pedestrian curb ramps, and pedestrian barricade, if needed. Engineer on site can approve eliminating temporary pedestrian curb ramps if an alternative path is deemed reasonable in the field.

Project 6950-04-73:

STH 54: Keep STH 54 and side roads open to traffic at all times for milling and paving operations. During construction hours, close up to one lane of traffic, as necessary, with standard flagging operations. During non-working hours open STH 54 and side roads to two lanes of traffic, one in each direction.

Wisconsin Lane Closure System Advance Notification

Provide the following advance notification to the engineer for incorporation into the Wisconsin Lane Closure System (LCS).

TABLE 108-1 CLOSURE TYPE AND REQUIRED MINIMUM ADVANCE NOTIFICATION

Closure type with height, weight, or width restrictions (available width, all lanes in one direction < 16 feet)	MINIMUM NOTIFICATION
Lane and shoulder closures	7 calendar days
Full roadway closures	7 calendar days
Ramp closures	7 calendar days
Detours	7 calendar days
Closure type without height, weight, or width restrictions (available width, all lanes in one direction ≥ 16 feet)	MINIMUM NOTIFICATION
Shoulder Closures	3 calendar days
Lane closures	3 business days
Ramp closures	3 business days
Modifying all closure types	3 business days

Discuss LCS completion dates and provide changes in the schedule to the engineer at weekly project meetings in order to manage closures nearing their completion date.

5. Holiday and Special Event Work Restrictions.

Do not perform work on, nor haul materials of any kind along or across any portion of the highway carrying STH 54 traffic, and entirely clear the traveled way and shoulders of such portions of the highway of equipment, barricades, signs, lights, and any other material that might impede the free flow of traffic during the following holiday and special event periods:

- From noon Friday, May 24, 2024 to 6:00 AM Tuesday, May 28, 2024 Memorial Day;
- From noon Wednesday, July 3, 2024 to 6:00 AM Monday, July 8, 2024 Independence Day.

stp-107-005 (20210113)

6. Utilities.

This contract comes under the provisions of Administrative Rule Trans 220.

This contract with projects 6950-04-72, 6950-04-73, and 6950-04-82 come under the provision of Administrative Rule Trans 220.

All utilities within the construction limits of Project 6950-04-82 were coordinated under project 6950-04-72. There are no other known utility conflicts within the construction limits.

Additional detailed information regarding the location of vacated, relocated, and/or removed facilities is available in the work plan provided by each utility company or on the permits issued to them. View these documents at the region WisDOT office during normal working hours.

Some of the utility work described below is dependent on prior work being performed by the contractor at a specific site. In such situations, provide the engineer and the affected utility a good faith notice of when the utility is to start work at the site. Provide this notice 14 to 16 calendar days in advance of when the prior work will be completed, and the site will be available to the utility owner. Follow-up with a confirmation notice to the engineer and the utility owner not less than three working days before the site will be ready for the utility owner to begin its work.

Alliant Energy (Electricity)

Alliant Energy has existing overhead and underground electrical lines generally parallel to STH 54 from Station 112+00 to Station 116+00, Station 138+80 to Station 155+60, Station 199+00 to Station 21+80, Station 224+00 to Station 256+60, and Station 486+00 to Station 549+00. Alliant Energy also has overhead or underground electrical line crossings at Station 140+40, Station 143+80, Station 145+35, Station 149+90, Station 151+50, Station 153+75, Station 156+30, Station 158+90, Station 159+75, Station 164+50, Station 165+35, Station 168+100, Station 169+90, Station 199+25, Station 220+50, Station 225+05, Station 229+05, and Station 229+55.

Alliant Energy will provide equipment and hold poles during construction located between Station 113+32 – Station 165+36. No additional conflicts are anticipated.

ATC Management, Inc (Electricity – Transmission)

ATC Management has an existing overhead transmission line crossing at Station 99+25.

No conflicts are anticipated.

Enbridge Energy (Gas/Petroleum)

Enbridge Energy has an existing underground pipeline crossing at Station 500+60.

No conflicts are anticipated.

Port Edwards Wtr Uti (Water)

Port Edwards Wtr Uti has existing water main generally parallel to STH 54 from Station 112+00 to Station 116+00, Station 151+90 to Station 153+20, Station 158+25 to Station 170+75, and Station 199+25 to Station 255+30. Port Edwards Wtr Uti also has water main crossings at Station 112+15, Station 139+90, Station 199+40, Station 153+75, Station 158+25, Station 208+50, and Station 246+10.

Port Edwards Wtr Uti will replace two hydrants along STH 54 between Bruener Avenue and Seneca Road. The hydrants will be installed during construction and are anticipated to be completed in three working days.

No conflicts are anticipated.

Port Edwards WWTF (Sewer)

Port Edwards WWTF has existing sanitary sewer lines generally parallel to STH 54 from Station 112+00 to Station 116+00, Station 140+10 to Station 148+10, Station 157+75 to Station 172+15, Station 199+40 to Station 213+45, and Station 224+00 to 252+30. Port Edwards WWTF also has sanitary sewer line crossings at Station 112+80, Station 115+20, Station 140+10, Station 199+45, Station 208+65, Station 225+80, and Station 252+30.

No conflicts are anticipated.

Solarus (Communication Line)

Solarus has existing underground communications lines generally parallel to STH 54 from Station 139+25 to Station 165+75, Station 199+30 to Station 210+40, and Station 224+00 to Station 254+80. Solarus also has existing communication line crossing at Station 165+75, Station 192+40, Station 209+95, and Station 252+25.

Solarus will relocate an existing fiber optic line from Station 232+00 – Station 240+00 - Right. Work is anticipated to be completed prior to construction and is anticipated to be completed in 10 working days. Solarus also has an existing fiber optic line located under the Ripple Creek culvert and will protect and hold the existing line during the removal and installation of the new culvert. No additional conflicts are anticipated.

Spectrum (Communication Line)

Spectrum has existing overhead and underground communication lines generally parallel to STH 54 from Station 112+00 to Station 116+00, Station 140+40 to Station 153+60, Station 199+80 to Station 210+35, Station 224+00 to Station 234+40, and Station 237+40 to Station 252+25.

Spectrum will install a new fiber optic line along STH 54 between Station 112+35 and Station 115+56 approximately 25 ft. The fiber optic line will be installed prior to construction. No additional conflicts are anticipated.

TDS Telecom (Communication Line)

TDS has existing underground communication lines generally parallel to STH 54 from Station 49+59 to Station 102+00.

No conflicts are anticipated.

WE Energies (Gas/Petroleum)

WE Energies has existing underground gas lines generally parallel to STH 54 from Station 101+50 to Station 158+40, Station 199+60 to Station 216+60, and Station 224+00 to Station 254+80. WE Energies also has existing underground gas line crossings at Station 101+50, Station 101+60 and Station 255+30.

No conflicts are anticipated.

Wisconsin Rapids Water Works and Light Commission (Electricity)

Wisconsin Rapids Water Works and Light Commission has an existing streetlight at Station 255+75 RT.

No conflicts are anticipated.

stp-107-065 (20080501)

7. Work By Others.

Village of Port Edwards

The village of Port Edwards is working to complete a bicycle crossing at the STH 54/73 intersection to allow north/south crossing to Port Road. There will be work by others to complete this work. Coordinate work on this project within this intersection with the Village of Port Edwards, Ben Martinson, PO Box 10, Port Edwards, WI 54469; ben.martinson@portedwardswi.gov; (715) 451-0287.

Alliant Energy Communications

Alliant Energy Communications is working to complete the installation of a new fiber optic line along STH 73 from north to south, crossing STH 54 at approximately Station 99+60. The new fiber optic line will be installed prior to January 2024. No conflicts are anticipated.

Utility Contact:

Laura Seals, E-mail: LauraSeals@alliantenergy.com; phone number: (319) 786-4198

Abe Assefa, E-mail: amassefa@burnsmcd.com; office: (816) 605-772 or cell: (570) 903-6929

8. Railroad Insurance and Coordination - Wisconsin Central Ltd (CN).

A Description

Comply with standard spec 107.17 for all work affecting Wisconsin Central Ltd (CN) property and any existing tracks.

A.1 Railroad Insurance Requirements

In addition to standard spec 107.26, provide railroad protective liability insurance coverage as specified in standard spec 107.17.3 Insurance is filed in the name of Wisconsin Central Ltd and Its Parents (CN).

Notify evidence of the required coverage, and duration to Matthew Turner, Public Projects Officer, 1625 Depot Street, Stevens Point, WI 54481; Telephone (715) 345-2503; E-mail: Matthew.turner@cn.ca.

Also send a copy to the following: Caleb Herrin, NC Region Railroad Coordinator; 1681 Second Ave South, Wisconsin Rapids, WI 54495; Telephone (715) 420-6422; E-mail: caleb.herrin@dot.wi.gov.

Include the following information on the insurance document:

- Project ID: 6950-04-72 & 6950-04-82
- Project Location: Port Edwards, WI
- Route Name: STH54
- Crossing ID: 392710T
- Railroad Subdivision: Valley
- Railroad Milepost: 45.14
- Work Performed on or within 50' of RR right-of-way: Paving and related work.

A.2 Train Operation

Approximately 6 through freight trains operate daily at up to 40 mph. There is minimal switching movements daily.

A.3 Names and Addresses of Railroad Representatives for Consultation and Coordination

Construction Contact

Matthew Turner, Public Works Officer; 1625 Depot Street, Stevens Point, WI 54481; Telephone (715) 345-2503; E-mail matthew.turner@cn.ca for consultation on railroad requirements during construction.

Amend standard spec 108.4 to include the railroad in the distribution of the initial bar chart, and monthly schedule updates. The bar chart shall specifically show work involving coordination with the railroad.

Flagging Contact

Submit by US Mail a "Request for Flagging Services and Cable Location" form with prepayment to: Flagging-US, 17641 South Ashland Avenue, Homewood, IL 60430; Flagging_US@CN.CA. The form can be obtained at:

<https://www.cn.ca/en/safety/utility-installations/>

Requests for flagging and cable locates can take up to five business days after the railroad receives the paperwork. Reference the Wisconsin Milepost and Subdivision located in A.1. Advise Wisconsin Central Ltd (CN) that the flagging services are to be billed at the rate for a public highway project.

Cable Locate Contact

In addition to contacting Diggers Hotline, follow the procedure listed under Flagging Contact.

Wisconsin Central Ltd (CN) will only locate railroad owned facilities buried in the railroad right-of-way. The railroad does not locate any other utilities.

A.4 Work by Railroad

The railroad will perform the work described in this section, except for work described in other special provisions, and will be accomplished without cost to the contractor. **None.**

A.5 Temporary Grade Crossing

If a temporary grade crossing is desired, submit a written request to the railroad representative named in A.3 at least 40 days prior to the time needed. Approval is subject to the discretion of the railroad. The department has made no arrangements for a temporary grade crossing.

stp-107-026 (20230629)

9. Coordination with Businesses and Residents.

The contractor shall arrange and conduct a meeting between the contractor, the department, affected residents, local officials and business people to discuss the project schedule of operations including vehicular and pedestrian access during construction operations. Hold the first meeting at least one week before the start of work under this contract and no further meetings will be required unless directed by the engineer. The contractor shall arrange for a suitable location for meetings that provides reasonable accommodation for public involvement. The department will prepare and coordinate publication of the meeting notices and mailings for meetings. The contractor shall schedule meetings with at least two weeks' prior notice to the engineer to allow for these notifications.

stp-108-060 (20141107)

10. Information to Bidders, U.S. Army Corps of Engineers Section 404 Permit.

The department has assumed coverage under the U.S. Army Corps of Engineers Section 404 Transportation Regional General Permit (TRGP). The department has determined that a pre-construction notification (permit application) to U.S. Army Corps of Engineers and their written verification of TRGP coverage is not necessary for this project.

A copy of the Section 404 Transportation Regional General Permit can be obtained on USACE's website:

<https://www.mvp.usace.army.mil/Portals/57/docs/regulatory/RGP/Transportation.pdf>

If the contractor requires work outside the proposed slope intercepts, based on their method of operation to construct the project, it is the contractor's responsibility to determine whether a pre-construction notification (permit application) and written verification from U.S. Army Corps of Engineers under the Section 404 Transportation Regional General permit is required. If written verification under the TRGP is necessary, submit a pre-construction notification to U.S. Army Corps of Engineers and obtain written verification of permit coverage prior to beginning construction operations requiring the permit. No time extensions as discussed in standard spec 108.10 will be granted for the time required to apply for and obtain the written verification of permit coverage. The contractor must be aware that the U.S. Army Corps of Engineers may not grant the permit request.

stp-107-054 (20230629)

11. Information to Bidders, WPDES Transportation Construction General Permit (TCGP) for Storm Water Discharges.

The department has obtained permit coverage through the Wisconsin Department of Natural Resources to discharge storm water associated with land disturbing construction activities under this contract. Conform to all permit requirements for the project.

This permit is the Wisconsin Pollutant Discharge Elimination System, Transportation Construction General Permit, (WPDES Permit No. WI-S066796-2). The permit can be found at:

<https://widnr.widen.net/s/s5mwp2gd7s/finalsignedwisdotcsgp>

A certificate of permit coverage is available from the regional office by contacting Elizabeth Miller at (715) 315-9237. Post the permit certificate in a conspicuous place at the construction site.

stp-107-056 (20230629)

12. Public Convenience and Safety.

Replace standard spec 107.8 (4) with the following:

Notify the following organizations and departments at least 2 business days before road closures, lane closures, or detours are put into effect:

Wood County Sheriff's Department
Wisconsin State Patrol
Wood County Highway Department
Town of Port Edwards
Port Edwards School District
Port Edwards Post Office

The Wood County Sheriff's Department 911 dispatches all area police, fire and ambulance services, and will relay any notification given by the contractor.

ncr-107-005 (20200729)

13. Property Marks – Protecting and Restoring.

Replace standard spec 107.11.3 (1) with the following:

Protect and carefully preserve all known property and survey marks, land monuments, and right-of-way monuments and marker posts. Notify the engineer of the nature and location of these monuments and markers. Do not disturb or destroy monuments or markers until the engineer has arranged for their referencing or perpetuation.

Reset or replace, to the required standard, any property and survey marks, land monuments, and right-of-way monuments and marker posts that fall outside the construction limits that are shifted, lost or damaged by the contractor during construction operations, as determined by the engineer. If the contractor fails to restore the disturbed monuments or markers within a reasonable time, the department may, upon 48 hours written notice, restore the disturbed monuments or markers. The department will deduct restoration costs from payments due the contractor under the contract.

ncr-107-010 (20110531)

14. Property Marks – Coordination with County Surveyor.

Add the following to standard spec 107.11.3:

Notify the appropriate county surveyor or other appropriate authority, as outlined in state statute 59.74(2)(b), a minimum of thirty days prior to impacting a landmark to coordinate what measures need to be taken to perpetuate the existing section corner and reference monuments that are affected by the project.

Coordinate construction activities necessary to allow the county surveyor or other appropriate authority to tie-out and reinstall the section corner and landmark reference monuments (ties) that are impacted by the project.

ncr-107-015 (20141015)

15. Environmental Protection, Aquatic Exotic Species Control.

Exotic invasive organisms such as VHS, zebra mussels, purple loosestrife, and Eurasian water milfoil are becoming more prolific in Wisconsin and pose adverse effects to waters of the state. Wisconsin State Statutes 30.07, "Transportation of Aquatic Plants and Animals; Placement of Objects in Navigable Waters", details the state law that requires the removal of aquatic plants and zebra mussels each time equipment is put into state waters.

At construction sites that involve navigable water or wetlands, use the follow cleaning procedures to minimize the chance of exotic invasive species infestation. Use these procedures for all equipment that comes in contact with waters of the state and/or infested water or potentially infested water in other states.

Ensure that all equipment that has been in contact with waters of the state, or with infested or potentially infested waters, has been decontaminated for aquatic plant materials and zebra mussels before being used in other waters of the state. Before using equipment on this project, thoroughly disinfect all equipment that has come into contact with potentially infested waters. Guidelines from the Wisconsin Department of Natural Resources for disinfection are available at:

<http://dnr.wi.gov/topic/invasives/disinfection.html>

Use the following inspection and removal procedures:

1. Before leaving the contaminated site, wash machinery and ensure that the machinery is free of all soil and other substances that could possibly contain exotic invasive species;
2. Drain all water from boats, trailers, bilges, live wells, coolers, bait buckets, engine compartments, and any other area where water may be trapped;
3. Inspect boat hulls, propellers, trailers and other surfaces. Scrape off any attached mussels, remove any aquatic plant materials (fragments, stems, leaves, seeds, or roots), and dispose of removed mussels and plant materials in a garbage can before leaving the area or invested waters; and
4. Disinfect your boat, equipment and gear by either:
 - 4.1. Washing with ~212 F water (steam clean), or
 - 4.2. Drying thoroughly for five days after cleaning with soap and water and/or high pressure water, or
 - 4.3. Disinfecting with either 200 ppm (0.5 oz per gallon or 1 Tablespoon per gallon) Chlorine for 10-minute contact time or 1:100 solution (38 grams per gallon) of Virkon Aquatic for 20- to 30-minute contact time. Note: Virkon is not registered to kill zebra mussel veligers nor invertebrates like spiny water flea. Therefore, this disinfect should be used in conjunction with a hot water (>104° F) application.

Complete the inspection and removal procedure before equipment is brought to the project site and before the equipment leaves the project site.

stp-107-055 (20130615)

16. Environmental Protection – Dewatering.

Add the following to standard spec 107.18:

If dewatering is required, treat the water to remove suspended sediments by filtration, settlement or other appropriate best management practice prior to discharge. Submit the proposed means and methods of dewatering for each required location for approval as part of the Erosion Control Implementation Plan (ECIP). Include details of how the intake will be managed to not cause an increase in the background level turbidity prior to treatment and any additional measures necessary to prevent sediments from reaching the project limits or wetlands and waterways.

Guidance on Dewatering can be found on the Wisconsin Department of Natural Resources website located in the Storm Water Construction Technical Standards, Dewatering Code #1061. This document can be found at the WisDNR website:

http://dnr.wi.gov/topic/stormwater/standards/const_standards.html

Work includes furnishing all materials, excavation, maintenance, cleaning, disposal of surplus material and removal of the dewatering system and is incidental to contract work.

ncr-107-025 (20160401)

17. Erosion Control.

Add the following to standard spec 107.20:

Perform construction operations in a timely and diligent manner, continuing all construction operations methodically from the initial topsoil stripping operation through the subsequent grading and finishing to minimize the period of exposure to erosion.

Replace topsoil on disturbed areas, including spot locations such as cross drains, driveways, guardrail and terminals, and intersections, immediately after grading is completed within those areas. Complete finishing operations, which includes seed, fertilizer, erosion mat, mulch, and any other permanent erosion control measures required, within seven calendar days after the placement of topsoil.

ncr-107-050 (20141015)

18. Protecting Concrete.

Add the following to standard spec 415.3.14:

Provide a minimum of one concrete finisher to remain on the project site after final finishing of all concrete surfaces until such time as the concrete has hardened sufficiently to resist surface scarring caused by footprints, handprints, or any other type of imprint, malicious or otherwise. The finisher shall actively and continuously patrol the newly placed concrete, and repair any damage to the surface that might be sustained as described above.

The cost for providing the finisher(s), necessary equipment, and materials shall be considered incidental to the contract unit price for each concrete item.

ncr-415-005 (20141015)

19. QMP HMA Pavement Nuclear Density.

A Description

Replace standard spec 460.3.3.2 (1) and standard spec 460.3.3.2 (4) with the following:

- (1) This special provision describes density testing of in-place HMA pavement with the use of nuclear density gauges. Conform to standard spec 460 except as modified in this special provision.
- (2) Provide and maintain a quality control program defined as all activities and documentation of the following:
 1. Selection of test sites.
 2. Testing.
 3. Necessary adjustments in the process.
 4. Process control inspection.
- (3) Chapter 8 of the department's construction and materials manual (CMM) provides additional detailed guidance for QMP work and describes required procedures.

<https://wisconsin.gov/rdwy/cmm/cm-08-00.pdf>

- (4) The department's Materials Reporting System (MRS) software allows contractors to submit data to the department electronically, estimate pay adjustments, and print selected reports. Qualified personnel may obtain MRS software from the department's web site at:

<http://www.atwoodsystems.com/>

B Materials

B.1 Personnel

- (1) Nuclear gauge owners and personnel using nuclear gauges shall comply with WisDOT requirements according to 460.3.3 and CMM 815.

B.2 Testing

- (1) Conform to WTM T355 and CMM 815 for density testing and gauge monitoring methods. Conform to CMM 815.10.4 for test duration and gauge placement.

B.3 Equipment

B.3.1 General

- (1) Furnish nuclear gauges according to CMM 815.2.
- (2) Furnish nuclear gauges from the department's approved product list at <https://wisconsin.gov/Pages/doing-bus/eng-consultants/cnslt-rsrcs/tools/appr-prod/default.aspx>

B.3.2 Comparison of Nuclear Gauges

B.3.2.1 Comparison of QC and QV Nuclear Gauges

- (1) Compare QC and QV nuclear gauges according to WTM T355.

B.3.2.2 Reference Site Monitoring

- (1) Conduct reference site monitoring for both QC and QV gauges according to WTM T355.

B.4 Quality Control Testing and Documentation

B.4.1 Lot and Sublot Requirements

B.4.1.1 Mainline Traffic Lanes, Shoulders, and Appurtenances

- (1) Divide the pavement into lots and sublots for nuclear density testing according to CMM 815.10.2.
- (2) Determine required number of tests according to CMM 815.10.2.1.
- (3) Determine random testing locations according to CMM 815.10.3.

B.4.1.2 Side Roads, Crossovers, Turn Lanes, Ramps, and Roundabouts

- (1) Divide the pavement into lots and sublots for nuclear density testing according to CMM 815.10.2.
- (2) Determine required number of tests according to CMM 815.10.2.2.
- (3) Determine random testing locations according to CMM 815.10.3.

B.4.2 Pavement Density Determination

B.4.2.1 Mainline Traffic Lanes and Appurtenances

- (1) Calculate the average sublot densities using the individual test results in each sublot.
- (2) If all sublot averages are no more than one percent below the target density, calculate the daily lot density by averaging the results of each random QC test taken on that day's material.
- (3) If any sublot average is more than one percent below the target density, do not include the individual test results from that sublot when computing the lot average density and remove that sublot's tonnage from the daily quantity for incentive. The tonnage from any such sublot is subject to disincentive pay as specified in standard spec 460.5.2.2.

B.4.2.2 Mainline Shoulders

B.4.2.2.1 Width Greater Than 5 Feet

- (1) Determine the pavement density as specified in B.4.2.1.

B.4.2.2.2 Width of 5 Feet or Less

- (1) If all sublot test results are no more than 3.0 percent below the minimum target density, calculate the daily lot density by averaging all individual test results for the day.
- (2) If a sublot test result is more than 3.0 percent below the target density, the engineer may require the unacceptable material to be removed and replaced with acceptable material or allow the nonconforming material to remain in place with a 50 percent pay reduction. Determine the limits of the unacceptable material according to B.4.3.

B.4.2.3 Side Roads, Crossovers, Turn Lanes, Ramps, and Roundabouts

- (1) Determine the pavement density as specified in B.4.2.1.

B.4.2.4 Documentation

- (1) Document QC density test data as specified in CMM 815. Provide the engineer with the data for each lot within 24 hours of completing the QC testing for the lot.

B.4.3 Corrective Action

- (1) Notify the engineer immediately when an individual test is more than 3.0 percent below the specified minimum in standard spec 460.3.3.1. Investigate and determine the cause of the unacceptable test result.
- (2) The engineer may require unacceptable material specified in B.4.3(1) to be removed and replaced with acceptable material or allow the nonconforming material to remain in place with a 50 percent pay reduction. Determine limits of the unacceptable area by measuring density of the layer at 50-foot increments both ahead and behind the point of unacceptable density and at the same offset as the original test site. Continue testing at 50-foot increments until a point of acceptable density is found as specified in standard spec 460.5.2.2(1). Removal and replacement of material may be required if extended testing is in a previously accepted subplot. Testing in a previously accepted subplot will not be used to recalculate a new lot density.
- (3) Compute unacceptable pavement area using the product of the longitudinal limits of the unacceptable density and the full subplot width within the traffic lanes or shoulders.
- (4) Retesting and acceptance of replaced pavement will be as specified in standard spec 105.3.
- (5) Tests indicating density more than 3.0 percent below the specified minimum, and further tests taken to determine the limits of unacceptable area, are excluded from the computations of the subplot and lot densities.
- (6) If two consecutive subplot averages within the same paving pass and same target density are more than one percent below the specified target density, notify the engineer and take necessary corrective action. Document the locations of such sublots and the corrective action that was taken.

B.5 Department Testing

B.5.1 Verification Testing

- (1) The department will have a HTCP certified technician, or ACT working under a certified technician, perform verification testing. The department will test randomly at locations independent of the contractor's QC work. The department will perform verification testing at a minimum frequency of 10 percent of the sublots and a minimum of one subplot per mix design. The sublots selected will be within the active work zone. The contractor will supply the necessary traffic control for the department's testing activities.
- (2) The QV tester will test each selected subplot using the same testing requirements and frequencies as the QC tester.
- (3) If the verification subplot average is not more than one percent below the specified minimum target density, use the QC tests for acceptance.
- (4) If the verification subplot average is more than one percent below the specified target density, compare the QC and QV subplot averages. If the QV subplot average is within 1.0 lb/ft³ of the QC subplot average, use the QC tests for acceptance.
- (5) If the first QV/QC subplot average comparison shows a difference of more than 1.0 lb/ft³ each tester will perform an additional set of tests within that subplot. Combine the additional tests with the original set of tests to compute a new subplot average for each tester. If the new QV and QC subplot averages compare to within 1.0 lb/ft³, use the original QC tests for acceptance.
- (6) If the QV and QC subplot averages differ by more than 1.0 lb/ft³ after a second set of tests, resolve the difference with dispute resolution specified in B.6. The engineer will notify the contractor immediately when density deficiencies or testing precision exceeding the allowable differences are observed.

B.5.2 Independent Assurance Testing

- (1) Independent assurance is unbiased testing the department performs to evaluate the department's verification and the contractor's QC sampling and testing including personnel qualifications, procedures, and equipment. The department will perform the independent assurance review according to the department's independent assurance program.

B.6 Dispute Resolution

- (1) The testers may perform investigation in the work zone by analyzing the testing, calculation, and documentation procedures. The testers may perform gauge comparison according to B.3.2.1.
- (2) The testers may use comparison monitoring according to B.3.2.2 to determine if one of the gauges is out of tolerance. If a gauge is found to be out of tolerance with its reference value, remove the gauge from the project and use the other gauge's test results for acceptance.

- (3) If the testing discrepancy cannot be identified, the contractor may elect to accept the QV subplot density test results or retesting of the subplot in dispute within 48 hours of paving. Traffic control costs will be split between the department and the contractor.
- (4) If investigation finds that both gauges are in error, the contractor and engineer will reach a decision on resolution through mutual agreement.

B.7 Acceptance

- (1) The department will not accept QMP HMA Pavement Nuclear Density if a non-compared gauge is used for contractor QC tests.

C (Vacant)

D (Vacant)

E Payment

E.1 QMP Testing

- (1) Costs for all sampling, testing, and documentation required under this special provision are incidental to the work. If the contractor fails to perform the work required under this special provision, the department may reduce the contractor's pay. The department will administer pay reduction under the Non-performance of QMP administrative item.

E.2 Disincentive for HMA Pavement Density

- (1) The department will administer density disincentives as specified in standard spec 460.5.2.2.

E.3 Incentive for HMA Pavement Density

- (1) The department will administer density incentives as specified in standard spec 460.5.2.3.
stp-460-020 (20230629)

20. Asphaltic Surface.

Replace standard spec 465.2 (1) with the following:

Under the Asphaltic Surface bid item submit a mix design. Furnish asphaltic mixture meeting the requirements specified for HMA Pavement Type HMA MT under standard spec 460.2; except the engineer will not require the contractor to conform to the quality management program specified under standard spec 460.2.8. Use tack coat as required under 450.3.2.7.

ncr-465-005 (20220530)

21. Pipe Culverts.

Replace standard spec 520.3.3(5) with the following:

Provide joint ties at all joints of circular or horizontal elliptical concrete culvert pipes and concrete cattle pass installations, including endwalls. Ties are not required between culverts and concrete masonry endwalls unless shown on plan.

ncr-520-005 (20180319)

22. Storm Sewer.

Replace standard spec 608.3.3(5) with the following:

Provide joint ties at all joints on concrete storm sewer system in-fall and outfall pipes, including endwalls. Ties are not required on installations with concrete masonry endwalls unless the plans show otherwise.

All sawing of existing and new pipe and removal of excess pipe material shall be considered incidental to Storm Sewer Pipe Reinforced Concrete. Ensure new and existing pipes abut uniformly throughout the circumference of the pipe prior to installing Concrete Collars.

23. Adjusting Manhole Covers, Item 611.8110.

This special provision describes adjusting manhole covers conforming to standard spec 611 as modified in this special provision.

Adjust manhole covers located in pavement areas in two separate operations. Initially, remove designated manhole covers along with sufficient pavement to permit installation of temporary cover plate over the opening. Fill the excavated area with asphaltic pavement mixture, which shall remain in place until contract milling and paving operations permit setting the manhole frames to grade. During the second phase, remove the asphaltic pavement mixture surrounding the manhole plus the temporary cover plate, and set the manhole cover to final grade. The department will measure and pay for the items of asphaltic pavement mixture, temporary cover plate, milling, and paving separately.

Supplement standard spec 611.3.7 with the following:

Set the manhole frames so that they comply with the surface requirements of standard spec 450.3.2.9. At the completion of the paving, a 6-foot straightedge shall be placed over the centerline of each manhole frame parallel to the direction of traffic. A measurement shall be made at each side of the frame. The two measurements shall be averaged. If this average is greater than 5/8 inches, reset the manhole frame to the correct plane and elevation. If this average is 5/8 inches or less but greater than 3/8 inches, the manhole frame shall be allowed to remain in place but shall be paid for at 50 percent of the contract unit price.

If the manhole frame is higher than the adjacent pavement, the two measurements shall be made at each end of the straightedge. These two measurements shall be averaged. The same criteria for acceptance and payment as above, shall apply.

stp-611-005 (20200629)

24. Cover Plates Temporary, Item 611.8120.S.

A Description

This special provision describes providing and removing steel plates to cover and support asphaltic pavement and traffic loading at manholes, inlets and similar structures during milling and paving operations.

B Materials

Provide a 0.25 inch minimum thickness steel plate that extends to the outside edge of the existing masonry.

C (Vacant)

D Measurement

The department will measure Cover Plates Temporary as each individual unit, acceptably completed.

E Payment

The department will pay for measured quantities at the contract unit price under the following bid item:

ITEM NUMBER	DESCRIPTION	UNIT
611.8120.S	Cover Plates Temporary	EACH

Payment is full compensation for furnishing, installing, and removing the cover plates.

The steel plates shall become the property of the contractor when no longer needed in the contract work.

stp-611-006 (20151210)

25. Landmark Reference Monuments.

This work shall be competed according to standard spec 621 and the plan details, except as provided in this special provision.

Add the following to standard spec 621.1:

The survey work required to tie out the landmark shall be performed by, or under the direction of, a professional land surveyor. Upon completion of the work, provide the survey notes and the county specified tie sheets to the county surveyor and the engineer. Obtain an example of the specified tie sheets from the county surveyor.

Add the following to standard spec 621.3.1:

Provide four reference monuments for each landmark. Utilize existing concrete or drive-in reference monuments that are outside the construction limits when possible. Existing reference monuments that can be used will not be considered for payment.

Replace standard spec 621.3.2.1 (1) with the following:

Under the Landmark Reference Monuments bid item, install 30-inch stainless steel drive-in monuments with cap stamped as shown on plan details.

Add the following to standard spec 621.3.3:

Protect the reference monuments until construction is completed. Any monuments that are shifted or damaged during construction shall either be replaced or reset, as directed by the engineer, by a professional land surveyor at the contractor's expense.

Replace standard spec 621.5 (2) with the following:

Payment for Landmark Reference Monuments is full compensation for furnishing, placing, and protecting drive-in and existing monuments; for furnishing a professional land surveyor; for performing survey work; for replacing or resetting monuments if necessary; for preparing and delivering survey notes and tie sheets.

ncr-621-005 (20150127)

26. Field Facilities.

Add the following to standard spec 642.3:

Set up the field office within seven days after notice from the engineer.

Provide a parking area large enough to park a minimum of six cars directly adjacent to the field office. The parking area and approach to the field office shall be well drained and consist of a crushed base aggregate or an existing paved surface and shall be ready for use within seven days after the field office is set up.

ncr-642-005 (20160406)

27. Traffic Control.

Add the following to standard spec 643.3.1:

Lighting devices shall be covered or rendered inoperative when not in use.

Provide the engineer and law enforcement (police, sheriff and State Patrol) the current telephone number(s) that the contractor, or their representative, can be contacted, at all times, in the event a safety hazard develops. Repair, replace, or restore the damaged or disturbed traffic control devices within two hours from the time notified or made aware of the damaged or disturbed traffic control devices.

Promptly replace all state-owned signs that are removed by the contractor due to interference with construction operations. At no time may stop signs be removed or moved without flag persons present.

Add the following to standard spec 104.6.1.2.2:

Provide a dedicated person or alternate method to guide traffic travelling alongside or near moving operations such as milling, paving, and shouldering.

ncr-643-005 (20190703)

28. Fertilizer for Lawn Type Turf, Item SPV.0030.01.

A Description

This special provision describes furnishing and incorporating fertilizing material in the soil on areas of seeding or sod.

B Materials

Use fertilizers that are standard, commercial, packaged, or bulk products, in granular or liquid form conforming to Wisconsin Statutes and the Wisconsin Administrative Code Chapter ATCP 40. Ensure that each container of packaged fertilizer is plainly marked with the analysis of the contents showing minimum percentages of total nitrogen, available phosphoric acid, and soluble potash. If furnishing the fertilizer in bulk, include an invoice with each shipment indicating the minimum percentages of total nitrogen, available phosphoric acid, and soluble potash in the contents.

The total of nitrogen, phosphoric acid, and potash shall equal at least 41 percent. At least 80% of the nitrogen shall be water insoluble.

If using fertilizer with a nitrogen, phosphoric acid, and potash total greater than 41 percent, maintain a ratio of 4-1-2 (N-P-K) and apply at a rate that provides the equivalent amount of nitrogen, phosphoric acid, and potash that is provided by a fertilizer with a 41 percent total.

Provide a slow release type fertilizer with a 14-week residual effect after activation into the soil conforming to the following minimum requirements:

- Nitrogen,..... not less than 22%
- Phosphoric Acid,..... not less than 5%
- Potash,.....not less than 10%

C Construction

Uniformly apply the fertilizer to the seeding areas, and incorporate it into the soil by light discing or harrowing. If applying granular fertilizer, ensure it is well pulverized and free from lumps.

If incorporating fertilizer into topsoiled areas, apply it just before, and in conjunction with, final discing or harrowing, or if hand manipulating the topsoil, apply it just before final raking and leveling.

If fertilizing areas to receive sod, spread the fertilizer at the rate specified below uniformly over the soil before placing sod, and then work the fertilizer into the soil while preparing the earth bed as specified in standard spec 631.3.1.

Apply fertilizer containing 41 percent total of nitrogen, phosphoric acid, and potash at 7 pounds per 1000 square feet of area, unless the contract specifies otherwise. For Fertilizer for Lawn Type Turf that contains a different percentage of components, determine the application rate by multiplying the specified rate by a dimensionless factor determined as follows:

Conversion Factor = 41 / New Percentage of Components

D Measurement

The department will measure Fertilizer for Lawn Type Turf by the hundred pounds (CWT), acceptably completed, and it will be measured based on an application rate of 7 pounds per 1000 square feet. The department will not measure fertilizer used for the bid items under standard spec 632. The measured quantity equals the number of hundred-weight (CWT) of material determined by multiplying the actual number of CWT. of material incorporated by the ratio of the actual percentage of fertilizer components used to 41 percent for Fertilizer for Lawn Type Turf.

E Payment

The department will pay for measured quantities at the contract unit price under the following bid item:

ITEM NUMBER	DESCRIPTION	UNIT
SPV.0030.01	Fertilizer for Lawn Type Turf	CWT

Payment is full compensation for providing, hauling, placing, and incorporating the fertilizer into the soil.

ncr-629-005 (20141015)

29. Reestablish Section Corner Monuments, Item SPV.0060.01.

A Description

This special provision describes reestablishing section corner monuments.

B Materials

Provide one of the following survey monuments for each location: A Berntsen Steel Nail Marker, for placement in asphalt pavement; a Berntsen BP1 Brass Marker with anchoring plug for placement in concrete pavement; or a Berntsen Aluminum Break-Off Monument for placement in locations outside the pavement area.

C Construction

C.1 General

All survey work required to reestablish the survey monument from the reference monuments shall be performed by, or under the direction of, a professional land surveyor. Provide an updated county specified tie sheet(s) to the county surveyor and the engineer. Provide county coordinates for all ties and monuments shown on the tie sheet(s). Obtain an example of the specified tie sheet(s) from the corresponding county surveyor.

C.2 Berntsen Steel Nail Marker

Locate the exact position for the monument on the asphalt pavement. Drive the Berntsen Steel Nail Marker into the pavement until the top of the Steel Nail Marker is countersunk below the surrounding finished asphalt pavement as shown on the plan details.

C.3 Berntsen BP1 Brass Marker

Drill a hole in the finished concrete pavement using a Berntsen Survey Marker Countersink Drill Bit, Item # BPMDDL. Insert the ribbed plastic expansion plug into the drilled hole. Tap the brass marker stem into the expansion plug until the top of the brass marker is countersunk below the surrounding finished concrete pavement as shown on the plan details.

C.4 Berntsen Aluminum Break-off Monument

Install according to the pertinent provisions of standard spec 621.3 for Non-Driven Aluminum Monuments and the plan details.

D Measurement

The department will measure Reestablish Section Corner Monuments by each individual section corner monument, acceptably completed.

E Payment

The department will pay for measured quantities at the contract unit price under the following bid item:

ITEM NUMBER	DESCRIPTION	UNIT
SPV.0060.01	Reestablish Section Corner Monuments	EACH

Payment is full compensation for providing survey monuments; all excavation, backfilling, and drilling necessary to place section corner monuments; furnishing a professional land surveyor and all survey work; and preparing and delivering tie sheets.

ncr-621-010 (20150430)

30. Adjusting Water Valve Boxes, Item SPV.0060.02.

A Description

This special provision describes locating, exposing, and protecting existing water valve boxes after the pavement is removed, furnishing and installing water valve box extensions if necessary; and adjusting the water valve boxes to the finished elevation required.

B (Vacant)

C Construction

Furnish and install water valve box extensions to the existing water valve boxes if necessary. Protect the water valve boxes during construction. Clean out the water valve boxes as necessary to assure the valve wrench will fit completely over the valve bolt. Adjust the valve boxes to the required finished elevation.

D Measurement

The department will measure Adjusting Water Valve Boxes by the unit, acceptably completed.

E Payment

The department will pay for measured quantities at the contract unit price under the following bid item:

ITEM NUMBER	DESCRIPTION	UNIT
SPV.0060.02	Adjusting Water Valve Boxes	EACH

Payment is full compensation for locating, exposing, and protecting water valve boxes; furnishing and installing water valve box extensions if necessary; exclusive of water valve boxes; cleaning out the water valve boxes, adjusting water valve boxes to the finished elevation. The contractor shall replace water valve boxes, which are damaged by the contractor’s operations, in kind, at the contractor’s expense.

ncr-611-015 (20130520)

31. Temporary Water Diversion, Item SPV.0060.03.

A Description

This special provision describes diverting the existing flow of Ripple Creek through a temporary diversion device during the new culvert pipe installation.

B Materials

Materials used for the diversion of the existing stream shall consist of non-erodible earthen materials, temporary shoring, or other approved materials according to the pertinent requirements of either standard spec 205-208 or 511. Provide plans for the temporary diversion as part of the Erosion Control Implementation Plan (ECIP) transmittal. Materials used for the channel of the Temporary Water Diversion as well as the materials used for diverting the existing stream will be subject to DNR review and approved with the ECIP.

C Construction

Divert the stream flow while placing the new culvert pipe. All methods of diversion are subject to DOT/DNR approval prior to use. Provide details of how the diversion will be completed in the Erosion Control Implementation Plan for review by Wisconsin DNR and the department. The water diversion must be capable of carrying all stream flows during construction period and must maintain a suitable depth and velocity to allow the passage of migrating fish and aquatic species. Fish that become stranded in dewatered areas or temporary channels should be captured and returned to the active channel immediately.

D Measurement

The department will measure Temporary Water Diversion by each individual project, acceptably completed.

E Payment

The department will pay for measured quantities at the contract unit price under the following bid item:

ITEM NUMBER	DESCRIPTION	UNIT
SPV.0060.03	Temporary Water Diversion	EACH

Payment is full compensation for providing and installing temporary pipes, if required; providing and installing materials to divert flow to the temporary pipe; providing, installing, and removing sheet piling, to divert water, if required; maintaining and removing all materials used in the diversions and excavation to divert water to the new pipes, if required; and for placing, removal, and disposal of Base Aggregate Dense.

32. Salvage and Reinstall Lighting Unit, Item SPV.0060.04.

A Description

This special provision describes salvaging the existing lighting unit and reinstalling it in a new location as shown on the plans and as hereinafter provided.

B (Vacant)

C Construction

Salvage designated transformer base, pole, arm, and luminaire for reuse on this project in accordance with standard spec 204.

Disconnect wire splices in existing transformer base and pull electrical wire out of existing concrete base. Protect wire so that it can be pulled into new concrete base to be constructed.

Cut off existing conduits to allow for reconnection to new conduit installed with new concrete base.

Reinstall transformer base, pole, arm, and luminaire in accordance with standard spec 657.

D Measurement

The department will measure Salvage and Reinstall Lighting Unit by each unit, acceptably completed.

E Payment

The department will pay for measured quantities at the contract unit price under the following bid item:

ITEM NUMBER	DESCRIPTION	UNIT
SPV.0060.04	Salvage and Reinstall Lighting Unit	EACH

Payment is full compensation for compensation for salvaging and reinstalling existing materials.

33. Storm Sewer Repair, Item SPV.0060.05.

A Description

This special provision describes excavating, placing a concrete collar over an existing storm sewer concrete pipe joint, and backfilling. Conform to standard spec 520, as the plans show and as follows.

B Materials

Furnish and use concrete masonry conforming to standard spec 416.2 as modified in standard spec 716. Provide QMP for class III ancillary concrete as specified in standard spec 716. Use trench backfill conforming to standard spec 520.2.5.3.

C Construction

Excavate and expose the joint between the concrete pipes. Provide enough space for a concrete collar per the standard detail drawing. Provide enough extra space as needed for constructability. Construct concrete collars per standard spec 520.3 and as the engineer directs. After the concrete collar has been placed and has achieved initial set, backfill the excavation according to standard spec 520.3.4.1.

D Measurement

The department will measure Storm Sewer Repair by each individual repair, acceptably completed.

E Payment

The department will pay for measured quantities at the contract unit price under the following bid item:

ITEM NUMBER	DESCRIPTION	UNIT
SPV.0060.05	Storm Sewer Repair	EACH

Payment is full compensation for excavating, placing the concrete collar, and for backfilling.

34. Preparing Topsoil For Lawn Type Turf, Item SPV.0180.01.

A Description

This special provision describes preparing the bed of topsoil or salvaged topsoil, for seeding or placing sod.

B (Vacant)

C Construction

Prepare and finish the subgrade so that rocks, concrete debris, or wood larger than three inches in diameter are not present within 1 foot of the finished surface of the topsoil.

Remove or break down all clods and lumps in the topsoil by using harrows or discs, screening, or other appropriate methods to provide a uniformly textured soil, in which 100 percent of the topsoil passes a one-inch sieve and at least 90 percent passes a No. 10 sieve.

Remove rocks, twigs, clods, and other foreign material that will not break down, and dress the entire surface to present a uniform appearance.

Shape the topsoil so that the horizontal or sloped surface between any two points ten feet apart does not vary by more than one inch. Roll with a turf type roller to a uniform minimum compacted depth of 6 inches.

Shape and compact the topsoil adjacent to pavements, sidewalks, and curbs to 1 inch below the top of the abutting surface. Before seeding, correct locations that vary by more than ¼-inch.

D Measurement

The department will measure Preparing Topsoil for Lawn Type Turf acceptably completed in area by the square yard.

E Payment

The department will pay for measured quantities at the contract unit price under the following bid item:

ITEM NUMBER	DESCRIPTION	UNIT
SPV.0180.01	Preparing Topsoil for Lawn Type Turf	SY

Payment is full compensation for preparing the subgrade and topsoil bed for sod or seed as described above.

ncr-625-005 (20150430)

35. Removing Distressed Asphaltic Surface Milling, Item SPV.0180.02.

A Description

This special provision describes removing distressed asphaltic surface by milling at spot locations throughout the project as directed by the engineer.

B (Vacant)

C Construction

Remove the existing distressed asphaltic pavement without incorporating or damaging underlying material or adjacent pavement that will remain in place. Provide a uniform milled surface that is reasonably plane, free of large scarification marks, and has the grade and transverse slope the plans show or the engineer directs.

Use a self-propelled milling machine with depth, grade, and slope controls. Shroud the drum to prevent discharging loosened material into adjacent work areas or live traffic lanes. Provide an engineer-approved dust control system.

Unless using a continuous removal and pick-up operation, do not windrow or store material on the roadway. Clear the roadway of materials and equipment during non-working hours. Clean milled surfaces of material that may adversely affect bond before surfacing. Compact base course at full-depth patch locations. Apply tack coat to horizontal and vertical patch areas.

Install asphaltic surface patching in distressed pavement milling areas prior to opening to traffic. The engineer may waive one or more of these requirements if the highway is closed to traffic or if a particular operation does not endanger traffic.

The contractor may incorporate suitable material into the work or dispose of it outside the project limits.

D Measurement

The department will measure Removing Distressed Asphaltic Surface Milling by the square yard, acceptably completed.

E Payment

The department will pay for measured quantities at the contract unit price under the following bid item:

ITEM NUMBER	DESCRIPTION	UNIT
SPV.0180.02	Removing Distressed Asphaltic Surface Milling	SY

Payment is full compensation for removing the distressed asphaltic surface; cleaning the milled surface; compacting base course; preparing the foundation; and disposing of removed materials.

Tack Coat and Asphaltic Surface Patching will be paid for separately.

ncr-204-015 (20220820)

ADDITIONAL SPECIAL PROVISION 4

This special provision does not limit the right of the department, prime contractor, or subcontractors at any tier to withhold payment for work not acceptably completed or work subject to an unresolved contract dispute.

Payment to First-Tier Subcontractors

Within 10 calendar days of receiving a progress payment for work completed by a subcontractor, pay the subcontractor for that work. The prime contractor may withhold payment to a subcontractor if, within 10 calendar days of receipt of that progress payment, the prime contractor provides written notification to the subcontractor and the department documenting "just cause" for withholding payment.

The prime contractor is not allowed to withhold retainage from payments due subcontractors.

Payment to Lower-Tier Subcontractors

Ensure that subcontracting agreements at all tiers provide prompt payment rights to lower-tier subcontractors that parallel those granted first-tier subcontractors in this provision.

Acceptance and Final Payment

Within 30 calendar days of receiving the semi-final estimate from the department, submit written certification that subcontractors at all tiers are paid in full for acceptably completed work.

Additional Special Provision 6 (ASP-6)

Modifications to the standard specifications

Make the following revisions to the standard specifications:

108 Prosecution and Progress

Add subsection 108.9.4.1 effective with the November 2023 letting:

108.9.4.1 Winter Suspension for Completion Date Contracts

- (1) The contractor may request a winter suspension for a completion date contract. If the department determines weather conditions do not allow for the completion of the remaining work, the department may approve the contractor's request and determine the start date of the winter suspension. The end date of the winter suspension is March 31 or a date mutually agreed upon by both parties. For multi-year contracts, the department will only consider winter suspension for the final year of the contract.
 - (2) During winter suspension, store all materials in a manner that does not obstruct vehicular and pedestrian traffic and protect the materials from damage. Install traffic control and other safety devices necessary to protect the traveling public and pedestrians. Provide suitable drainage and install temporary erosion control where necessary. If the winter suspension begins when liquidated damages are being assessed, or when the work has not progressed as scheduled and would not have been completed prior to the completion date, the cost of necessary pre-suspension work is incidental. If the winter suspension begins prior to the contract completion date, and the work has progressed as scheduled and would have been completed prior to the completion date, the cost of pre-suspension work will be paid as specified under 109.4.
 - (3) For a winter suspension that begins prior to the contract completion date and the work has progressed as scheduled and would have been completed prior to the completion date, the engineer will extend contract time to correspond with the end of the winter suspension and liquidated damages will not be assessed during the winter suspension.
 - (4) For a winter suspension that begins when liquidated damages are being assessed or when the work has not progressed as scheduled and would not have been completed prior to the completion date, the engineer will not extend contract time. Time will be suspended until the end of the winter suspension. Liquidated damages will not be assessed during the winter suspension and liquidated damages will resume at the end of the winter suspension.
-

108.10.2 Excusable, Non-Compensable Delays

108.10.2.1 General

Replace entire section with the following effective with the January 2024 letting:

- (1) Non-compensable delays, 108.10.2.1(3), are excusable delays not the contractor's or the department's fault. The engineer will not pay for the delay costs listed in 109.4.7 for non-compensable delays.
 - (2) For non-compensable delays under calendar day and completion date contracts, the engineer will extend contract time if the conditions specified in 108.10.1 are met. The department will relieve the contractor from associated liquidated damages, as specified in 108.11, if the engineer extends time under 108.10.1.
 - (3) The following are non-compensable delays:
 1. Delays due to earthquakes, other cataclysmic phenomena of nature the contractor cannot foresee and avoid, severe weather or job conditions caused by recent weather as specified in 108.10.2.2.
 2. Extraordinary delays in material deliveries the contractor or their suppliers cannot foresee and forestall resulting from strikes, lockouts, freight embargoes, industry-wide shortages, governmental acts, or sudden disasters.
 3. Delays due to acts of the government, a political subdivision other than the department, or the public enemy.
 4. Delays from fires or epidemics.
 5. Delays from strikes beyond the contractor's power to settle not caused by improper acts or omissions of the contractor, their subcontractors, or their suppliers.
 6. Altered quantities as specified in 109.3.
-

108.10.3 Excusable Compensable Delays

Replace entire section with the following effective with the January 2024 letting:

- (1) Compensable delays are excusable delays due to the department's actions or lack of actions. The engineer will grant a time extension for a compensable delay if the conditions specified in 108.10.1 are met.
- (2) The following are compensable delays:

1. A contract change for revised work as specified for extra work under 104.2.2.1, for a differing site condition under 104.2.2.2, or for significant changes in the character of the work under 104.2.2.4.
 2. A contract change for an engineer-ordered suspension under 104.2.2.3.
 3. The unexpected discovery of human remains, an archaeological find, or historical find consistent with 107.25.
 4. The unexpected discovery of a hazardous substance consistent with 107.24.
 5. The non-completion of work that utilities or other third parties perform, if that work is not completed as specified in the contract.
- (3) For a compensable delay or a time extension, the department will relieve the contractor from associated liquidated damages under 108.11, and will pay the contractor for delay costs determined as follows:
1. Adjust the contract price as specified in 109.4.2 through 109.4.5 for delays under item 1 of 108.10.3(2).
 2. Adjust the contract price as specified in 109.4.7 for delays under items 2 through 5 of 108.10.3(2).

310 Open Graded Base

310.2 Materials

Replace paragraph two with the following effective with the November 2023 letting:

- (2) The contractor may substitute material conforming to the gradation requirements for crushed aggregate specified in Table 310-01 if that material conforms to the fracture requirements for open-graded crushed gravel specified in 301.2.4.5.

TABLE 310-01 COARSE AGGREGATE (% passing by weight)

AASHTO No. 67 ^[1]	
SEIVE	COARSE AGGREGATE (% PASSING by WEIGHT) AASHTO No. 67
2-inch	-
1 1/2-inch	-
1-inch	100
3/4-inch	90 – 100
1/2-inch	-
3/8-inch	20 – 55
No. 4	0 – 10
No. 8	0 – 5
No. 16	-
No. 30	-
No. 50	-
No. 100	-
No. 200	<=1.5

[1] Size according to AASHTO M43.

390 Base Patching

390.4 Measurement

Replace entire section with the following effective with the November 2023 letting:

- (1) The department will measure Removing Pavement for Base Patching by the cubic yard acceptably completed. Measure the depth from the bottom of the adjacent pavement to the top of the patch.
- (2) The department will measure Base Patching Asphaltic by the ton acceptably completed as specified for asphaltic pavement in 450.4.
- (3) The department will measure Base Patching Concrete HES and Base Patching Concrete SHES by the cubic yard acceptably completed. Measure the depth from the bottom of the adjacent pavement to the top of the patch.

390.5 Payment

Replace entire section with the following effective with the November 2023 letting:

- (1) The department will pay for measured quantities at the contract unit price under the following bid items:

<u>ITEM NUMBER</u>	<u>DESCRIPTION</u>	<u>UNIT</u>
390.0100	Removing Pavement for Base Patching	CY
390.0201	Base Patching Asphaltic	TON
390.0305	Base Patching Concrete HES	CY
390.0405	Base Patching Concrete SHES	CY

- (2) Payment for Removing Pavement for Base Patching is full compensation for removing old pavement; for preparing the foundation and bringing up to grade. If the engineer orders the contractor to excavate yielding or unstable subgrade materials and backfill with suitable materials, the department will pay for that work with contract bid items or as agreed upon using 109.4.
- (3) Payment for Base Patching Asphaltic is full compensation for providing and compacting asphaltic mixture including asphaltic binder.
- (4) Payment for Base Patching Concrete HES and Base Patching Concrete SHES is full compensation for providing, curing, and protecting concrete. Payment also includes providing tie bars and dowel bars in unhardened concrete and steel within the patch. For tie bars and dowel bars provided in concrete not placed under the contract, the department will pay separately under the Drilled Tie Bars and Drilled Dowel Bars bid items as specified in 416.5.
- (5) Payment for Base Patching SHES also includes providing test data to the engineer as specified in 416.2.4.
- (6) The department will pay for sawing existing concrete pavement for removal under the Sawing Concrete bid item as specified in 690.5.

460 Hot Mix Asphalt Pavement**460.2.8.2.1.3.1 Contracts with 5000 Tons of Mixture or Greater**

Replace paragraph four with the following effective with the November 2023 letting:

- (4) Use the test methods identified below, or other methods the engineer approves, to perform the following tests at the frequency indicated:

Blended aggregate gradations:

Drum plants:

- Field extraction by ignition oven according to WTM T308, chemical extraction according to AASHTO T-164 method A or B; or automated extraction according to WTM D8159. Gradation of resulting aggregate sample determined according to WTM T30.
- Belt samples, optional for virgin mixtures, obtained from stopped belt or from the belt discharge using an engineer-approved sampling device and performed according to WTM T11 and T27.

Batch plants:

- Field extraction by ignition oven according to WTM T308, chemical extraction according to AASHTO T-164 method A or B; or automated extraction according to WTM D8159. Gradation of resulting aggregate sample determined according to WTM T30.

Asphalt content (AC) in percent:

Determine AC using one of the following methods:

- AC by ignition oven according to WTM T308.
- AC by chemical extraction according to AASHTO T-164 method A or B.
- AC by automated extraction according to WTM D8159.
- If the department is using an ignition oven to determine AC, conform to WTP H003.
- If the department is not using an ignition oven to determine AC, ignition oven correction factor (IOCF) must still be reverified for any of the reasons listed in WTP H003 Table 2 and conform to WTP H-003 sections 3 through 6.
- Gradation of resulting aggregate sample determined according to WTM T30.

Bulk specific gravity of the compacted mixture:

According to WTM T166.

Theoretical maximum specific gravity:

According to WTM T209.

Air voids (Va) by calculation according to WTM T269.

VMA by calculation according to WTM R35.

460.2.8.3.1.4 Department Verification Testing Requirements

Replace paragraph three with the following effective with the November 2023 letting:

- (3) The department will perform testing conforming to the following standards:
 - Bulk specific gravity (G_{mb}) of the compacted mixture according to WTM T166.
 - Maximum specific gravity (G_{mm}) according to WTM T209.
 - Air voids (V_a) by calculation according to WTM T269.
 - VMA by calculation according to WTM R35.
 - Asphalt content by ignition oven according to WTM T308, chemical extraction according to AASHTO T-164 method A or B, or automated extraction according to WTM D8159. If using an ignition oven to determine AC, conform to WTP H-003.

503 Prestressed Concrete Members

503.2.2 Concrete

Replace paragraph five with the following effective with the November 2023 letting:

- (5) Furnish prestressed concrete members cast from air-entrained concrete, except I-type girders may use non-air-entrained concrete. Use type I, IL, IS, IP, IT, II, or III cement. The contractor may replace up to 30 percent of type I, IL, II, or III cement with an equal weight of fly ash, slag, or a combination of fly ash and slag. Ensure that fly ash conforms to 501.2.4.2.2 and slag conforms to 501.2.4.2.3. Use only one source and replacement rate for work under a single bid item. Use a department-approved air-entraining admixture conforming to 501.2.5.2 for air-entrained concrete. Use only coarse aggregate conforming to 310.2(2).

604 Slope Paving

604.2 Materials

Replace paragraph three with the following effective with the November 2023 letting:

- (3) Under the Slope Paving Crushed Aggregate bid item, furnish crushed stone or crushed gravel conforming to the gradation in Table 604-01, but with the additional requirements that at least 75 percent of the particles, by count, have at least one fractured face. Determine fracture according to WTM D5821.

TABLE 604-01 COARSE AGGREGATE (% passing by weight)

AASHTO No. 4^[1]	
SEIVE	COARSE AGGREGATE (% PASSING by WEIGHT) AASHTO No. 4
2-inch	100
1 1/2-inch	90 - 100
1-inch	20 - 55
3/4-inch	0 - 15
1/2-inch	-
3/8-inch	0 - 5
No. 4	-
No. 8	-
No. 16	-
No. 30	-
No. 50	-
No. 100	-
No. 200	≤1.5

^[1] Size according to AASHTO M43.

612 Underdrains**612.3.9 Trench Underdrains**

Replace paragraph one with the following effective with the November 2023 letting:

- (1) Under the Underdrain Trench bid item, excavate and backfill underdrain trenches. Backfill with coarse aggregate gradation conforming to 604.2(3). Before backfilling place geotextile as the plans show.

614 Semi-rigid Barrier Systems and End Treatments**614.2.6 Sand Barrel Arrays**

Replace paragraph one with the following effective with the November 2023 letting:

- (1) Furnish sand barrels from the APL. Use fine aggregate conforming to gradation shown in Table 614-2 mixed with sodium chloride conforming to AASHTO M143. Apply an object marker to front-most barrel in the array.

TABLE 614-2 FINE AGGREGATE GRADATION

SEIVE	FINE AGGREGATE (% PASSING by WEIGHT)
3/8-inch	100
No. 4	90 - 100
No. 8	-
No. 16	45 - 85
No. 30	-
No. 50	5 - 30
No. 100	0 - 10
No. 200	<=3.5

628 Erosion Control**628.2.13 Rock Bags**

Replace paragraph two with the following effective with the November 2023 letting:

- (2) Fill the bags with a clean, sound, hard, durable, engineer-approved coarse aggregate conforming by visual inspection to the gradation specified for coarse aggregate gradation in 604.2(3).

639 Drilling Wells**639.2.1 General**

Replace paragraph two with the following effective with the November 2023 letting:

- (2) For grout use fine aggregate conforming to 501.2.7.2; and gradation conforming to 614.2.6(1); and type I, IL, IS, IP, or IT cement.

652 Electrical Conduit**652.3.1.2 Installing Underground**

Replace paragraph two with the following effective with the November 2023 letting:

- (2) Excavate trenches true to line and grade to provide the conduit uniform bearing throughout its length. Do not backfill the trench before inspecting the conduit. Carefully tamp the backfill in place as specified for placing backfill in layers in 651.3. Place at least 0.7 cubic feet of coarse aggregate gradation conforming to 604.2(3) directly under each drainage hole.

ERRATA**390.3.4 Special High Early Strength Concrete Patching**

Correct errata link in paragraph (1) by changing from 416.3.8 to 416.3.7.

- (1) Construct as specified for special high early strength repairs under 416.3.7 except as follows:
- The contractor may delay removal for up to 14 calendar days after cutting the existing pavement.
 - Open to traffic as specified for concrete base in 320.3.

ADDITIONAL SPECIAL PROVISION 7

A. Reporting 1st Tier and DBE Payments During Construction

1. Comply with reporting requirements specified in the department's Civil Rights Compliance, Contractor's User Manual, Sublets and Payments.
2. Report payments to all DBE firms within 10 calendar days of receipt of a progress payment by the department or a contractor for work performed, materials furnished, or materials stockpiled by a DBE firm. Report the payment as specified in A(1) for all work satisfactorily performed and for all materials furnished or stockpiled.
3. Report payments to all first tier subcontractor relationships within 10 calendar days of receipt of a progress payment by the department for work performed. Report the payment as specified in A(1) for all work satisfactorily performed.
4. All tiers shall report payments as necessary to comply with the DBE payment requirement as specified in A(2).
5. DBE firms must enter all payments to DBE and non-DBE firms regardless of tier.
6. Require all first tier relationships, DBE firms and all other tier relationships necessary to comply with the DBE payment requirement in receipt of a progress payment by contractor to acknowledge receipt of payment as specified in A(1), (2), (3) and (4).
7. All agreements made by a contractor shall include the provisions in A(1), (2), (3), (4), (5), and (6), and shall be binding on all first tier subcontractor relationships, all contractors and subcontractors utilizing DBE firms on the project, and all payments from DBE firms.

B. Costs for conforming to this special provision are incidental to the contract.

NOTE: CRCS Prime Contractor payment is currently not automated and will need to be manually loaded into the Civil Rights Compliance System. Copies of prime contractor payments received (check or ACH) will have to be forwarded to paul.ndon@dot.wi.gov within 5 days of payment receipt to be logged manually.

***Additionally, for information on Subcontractor Sublet assignments, Subcontractor Payments and Payment Tracking, please refer to the CRCS Payment and Sublets manual at:

<https://wisconsindot.gov/Documents/doing-bus/civil-rights/labornwage/crcs-payments-sublets-manual.pdf>

ADDITIONAL SPECIAL PROVISION 9

Electronic Certified Payroll or Labor Data Submittal

- (1) Use the department's Civil Rights Compliance System (CRCS) to electronically submit certified payroll reports for contracts with federal funds and labor data for contracts with state funds only. Details are available online through the department's highway construction contractor information (HCCI) site on the Labor, Wages, and EEO Information page at:
<https://wisconsindot.gov/Pages/doing-bus/civil-rights/labornwage/default.aspx>
- (2) Ensure that all tiers of subcontractors, including all trucking firms, either submit their weekly certified payroll reports (contracts with federal funds) or labor data (contracts with state funds only) electronically through CRCS. These payrolls or labor data are due within seven calendar days following the close of the payroll period. Every firm providing physical labor towards completing the project is a subcontractor under this special provision.
- (3) Upon receipt of contract execution, promptly make all affected firms aware of the requirements under this special provision and arrange for them to receive CRCS training as they are about to begin their submittals. The department will provide training either in a classroom setting at one of our regional offices or by telephone. Contact Paul Ndon at (414) 438-4584 to schedule the training.
- (4) The department will reject all paper submittals for information required under this special provision. All costs for conforming to this special provision are incidental to the contract.
- (5) Firms wishing to export payroll/labor data from their computer system into CRCS should have their payroll coordinator contact Paul Ndon at paul.ndon@dot.wi.gov. Not every contractor's payroll system is capable of producing export files. For details, see Section 4.8 CPR Auto Submit (Data Mapping) on pages 49-50; 66-71 of the CRCS Payroll Manual at:
<https://wisconsindot.gov/Documents/doing-bus/civil-rights/labornwage/crcs-payroll-manual.pdf>

NON-DISCRIMINATION PROVISIONS

During the performance of this contract, the contractor, for itself, its assignees, and successors in interest (hereinafter referred to as the "contractor") agrees as follows:

1. Compliance with Regulations: The contractor (hereinafter includes consultants) will comply with the Acts and the Regulations relative to Non-discrimination in Federally-assisted programs of the U.S. Department of Transportation, Federal Highway Administration, as they may be amended from time to time, which are herein incorporated by reference and made a part of this contract.

2. Non-discrimination: The contractor, with regard to the work performed by it during the contract, will not discriminate on the grounds of race, color, or national origin in the selection and retention of subcontractors, including procurements of materials and leases of equipment. The contractor will not participate directly or indirectly in the discrimination prohibited by the Acts and the Regulations, including employment practices when the contract covers any activity, project, or program set forth in Appendix B of 49 CFR Part 21.

3. Solicitations for Subcontracts, Including Procurements of Materials and Equipment: In all solicitations, either by competitive bidding, or negotiation made by the contractor for work to be performed under a subcontract, including procurements of materials, or leases of equipment, each potential subcontractor or supplier will be notified by the contractor of the contractor's obligations under this contract and the Acts and the Regulations relative to Non-discrimination on the grounds of race, color, or national origin.

4. Information and Reports: The contractor will provide all information and reports required by the Acts, the Regulations, and directives issued pursuant thereto and will permit access to its books, records, accounts, other sources of information, and its facilities as may be determined by the Recipient or the Federal Highway Administration to be pertinent to ascertain compliance with such Acts, Regulations, and instructions. Where any information required of a contractor is in the exclusive possession of another who fails or refuses to furnish the information, the contractor will so certify to the Recipient or the Federal Highway Administration, as appropriate, and will set forth what efforts it has made to obtain the information.

5. Sanctions for Noncompliance: In the event of a contractor's noncompliance with the Non-discrimination provisions of this contract, the Recipient will impose such contract sanctions as it or the Federal Highway Administration may determine to be appropriate, including, but not limited to:

- a. Withholding payments to the contractor under the contract until the contractor complies; and/or
- b. Cancelling, terminating, or suspending a contract, in whole or in part.

6. Incorporation of Provisions: The contractor will include the provisions of paragraphs one through six in every subcontract, including procurements of materials and leases of equipment, unless exempt by the Acts, the Regulations and directives issued pursuant thereto. The contractor will take action with respect to any subcontract or procurement as the Recipient or the Federal Highway Administration may direct as a means of enforcing such provisions including sanctions for noncompliance. Provided, that if the contractor becomes involved in, or is threatened with litigation by a subcontractor, or supplier because of such direction, the contractor may request the Recipient to enter into any litigation to protect the interests of the Recipient. In addition, the contractor may request the United States to enter into the litigation to protect the interests of the United States.

During the performance of this contract, the contractor, for itself, its assignees, and successors in interest (hereinafter referred to as the "contractor") agrees to comply with the following non-discrimination statutes and authorities; including but not limited to:

Pertinent Non-Discrimination Authorities:

- Title VI of the Civil Rights Act of 1964 (42 U.S.C. § 2000d et seq., 78 stat. 252), (prohibits discrimination on the basis of race, color, national origin); and 49 CFR Part 21.
- The Uniform Relocation Assistance and Real Property Acquisition Policies Act of 1970, (42 U.S.C. § 4601), (prohibits unfair treatment of persons displaced or whose property has been acquired because of Federal or Federal-aid programs and projects);
- Federal-Aid Highway Act of 1973, (23 U.S.C. § 324 et seq.), (prohibits discrimination on the basis of sex);
- Section 504 of the Rehabilitation Act of 1973, (29 U.S.C. § 794 et seq.), as amended, (prohibits discrimination on the basis of disability); and 49 CFR Part 27;
- The Age Discrimination Act of 1975, as amended, (42 U.S.C. § 6101 et seq.), (prohibits discrimination on the basis of age);
- Airport and Airway Improvement Act of 1982, (49 USC § 471, Section 47123), as amended, (prohibits discrimination based on race, creed, color, national origin, or sex);
- The Civil Rights Restoration Act of 1987, (PL 100-209), (Broadened the scope, coverage and applicability of Title VI of the Civil Rights Act of 1964, The Age Discrimination Act of 1975 and Section 504 of the Rehabilitation Act of 1973, by expanding the definition of the terms "programs or activities" to include all of the programs or activities of the Federal-aid recipients, sub-recipients and contractors, whether such programs or activities are Federally funded or not);
- Titles II and III of the Americans with Disabilities Act, which prohibit discrimination on the basis of disability in the operation of public entities, public and private transportation systems, places of public accommodation, and certain testing entities (42 U.S.C. §§ 12131-12189) as implemented by Department of Transportation regulations at 49 C.F.R. parts 37 and 38;
- The Federal Aviation Administration's Non-discrimination statute (49 U.S.C. § 47123) (prohibits discrimination on the basis of race, color, national origin, and sex);
- Executive Order 12898, Federal Actions to Address Environmental Justice in Minority Populations and Low-Income Populations, which ensures Non-discrimination against minority populations by discouraging programs, policies, and activities with disproportionately high and adverse human health or environmental effects on minority and low-income populations;
- Executive Order 13166, Improving Access to Services for Persons with Limited English Proficiency, and resulting agency guidance, national origin discrimination includes discrimination because of Limited English proficiency (LEP). To ensure compliance with Title VI, you must take reasonable steps to ensure that LEP persons have meaningful access to your programs (70 Fed. Reg. at 74087 to 74100);
- Title IX of the Education Amendments of 1972, as amended, which prohibits you from discriminating because of sex in education programs or activities (20 U.S.C. 1681 et seq).

BUY AMERICA PROVISION

Buy America (as documented in [88 FR 57750 \(2 CFR part 184 and 200\)](#) from the Office of Management and Budget: [Federal Register: Guidance for Grants and Agreements](#)) shall be domestic products and permanently incorporated in this project as classified in the following three categories, and as noted in the Construction and Materials Manual (CMM):

1. Iron and Steel

All iron and steel manufacturing and coating processes (from the initial melting stage through the application of coatings) must have occurred within the United States. Coating includes epoxy coating, galvanizing, painting and any other coating that protects or enhances the value of a material subject to the requirements of Buy America.

The exemption of the iron and steel manufacturing and coating processes Buy America requirement is the minimal use of foreign materials if the total cost of such material permanently incorporated in the product does not exceed one-tenth of one percent (1/10 of 1%) of the total contract cost or \$2,500.00, whichever is greater. For purposes of this paragraph, the cost is that shown to be the value of the subject products as they are delivered to the project.

2. Manufactured Product

All manufactured products (as defined in CMM 228.5) are covered under a previous waiver from 1983 and are currently exempt from Buy America.

3. Construction Material

All construction materials (as defined in [88 FR 57750 \(2 CFR part 184 and 200\)](#) and as referenced in CMM 228.5) must comply with Buy America. All manufacturing process of construction materials must occur in the United States.

[88 FR 55817 \(DOT-OST-2022-0124\)](#) allows a limited waiver of Buy America requirements for de minimis costs and small grants.

- The Total value of the non-compliant products is no more than the lesser of \$1,000,000 or 5% of total applicable costs for the project¹; or
- The total amount of Federal financial assistance applied to the project, through awards or subaward, is below \$500,000²

The contractor shall take actions and provide documentation conforming to CMM 228.5 to ensure compliance with this Buy America provision.

<https://wisconsin.gov/rdwy/cmm/cm-02-28.pdf>

Upon completion of the project, certify to the engineer, in writing using department form DT4567 that all iron and steel, manufactured products, and construction materials conform to this Buy America provision.

Form DT4567 is available at: <https://wisconsin.gov/Documents/formdocs/dt4567.docx>

Attach a list of iron or steel and construction material exemptions and their associated costs to the certification form.

¹ The de minimis public interest waiver does not apply to iron and steel subject to the requirements of 23 U.S.C. 313 on financial assistance administered by FHWA. The de minimis threshold in 23 CFR 635.410(b)(4) continues to apply for iron and steel.

² The small grant portion of the waiver does not apply to iron, steel, and manufactured goods subject to the requirements of 49 U.S.C. 22905(a).



Proposal Schedule of Items

Proposal ID: 20240213029 Project(s): 6950-04-72, 6950-04-73, 6950-04-82

Federal ID(s): N/A, N/A, N/A

SECTION: 0001 Contract Items

Alt Set ID: Alt Mbr ID:

Proposal Line Number	Item ID Description	Approximate Quantity and Units	Unit Price	Bid Amount
0002	201.0205 Grubbing	2.000 STA	_____.	_____.
0004	203.0220 Removing Structure (structure) 01. 4' X 4' Box	1.000 EACH	_____.	_____.
0006	203.0220 Removing Structure (structure) 02. Timber Bridge	1.000 EACH	_____.	_____.
0008	204.0100 Removing Concrete Pavement	9,108.000 SY	_____.	_____.
0010	204.0110 Removing Asphaltic Surface	2,013.000 SY	_____.	_____.
0012	204.0115 Removing Asphaltic Surface Butt Joints	1,387.000 SY	_____.	_____.
0014	204.0120 Removing Asphaltic Surface Milling	104,070.000 SY	_____.	_____.
0016	204.0150 Removing Curb & Gutter	13,371.000 LF	_____.	_____.
0018	204.0155 Removing Concrete Sidewalk	250.000 SY	_____.	_____.
0020	204.0165 Removing Guardrail	985.000 LF	_____.	_____.
0022	204.0195 Removing Concrete Bases	1.000 EACH	_____.	_____.
0024	204.0220 Removing Inlets	30.000 EACH	_____.	_____.
0026	204.0245 Removing Storm Sewer (size) 01. 12-Inch	374.000 LF	_____.	_____.
0028	204.0245 Removing Storm Sewer (size) 02. 18-Inch	11.000 LF	_____.	_____.
0030	204.0245 Removing Storm Sewer (size) 03. 24-Inch	4.000 LF	_____.	_____.



Proposal Schedule of Items

Proposal ID: 20240213029 Project(s): 6950-04-72, 6950-04-73, 6950-04-82

Federal ID(s): N/A, N/A, N/A

SECTION: 0001 Contract Items

Alt Set ID: Alt Mbr ID:

Proposal Line Number	Item ID Description	Approximate Quantity and Units	Unit Price	Bid Amount
0032	205.0100 Excavation Common	7,779.000 CY	_____.	_____.
0034	211.0101 Prepare Foundation for Asphaltic Paving (project) 01. 6950-04-72	1.000 EACH	_____.	_____.
0036	211.0101 Prepare Foundation for Asphaltic Paving (project) 02. 6950-04-73	1.000 EACH	_____.	_____.
0038	213.0100 Finishing Roadway (project) 01. 6950-04-72	1.000 EACH	_____.	_____.
0040	213.0100 Finishing Roadway (project) 02. 6950-04-73	1.000 EACH	_____.	_____.
0042	305.0110 Base Aggregate Dense 3/4-Inch	2,080.000 TON	_____.	_____.
0044	305.0120 Base Aggregate Dense 1 1/4-Inch	4,960.000 TON	_____.	_____.
0046	455.0605 Tack Coat	11,782.000 GAL	_____.	_____.
0048	460.2000 Incentive Density HMA Pavement	12,710.000 DOL	1.00000	12,710.00
0050	460.6224 HMA Pavement 4 MT 58-28 S	11,311.000 TON	_____.	_____.
0052	460.6424 HMA Pavement 4 MT 58-28 H	8,535.000 TON	_____.	_____.
0054	465.0105 Asphaltic Surface	1,664.000 TON	_____.	_____.
0056	465.0110 Asphaltic Surface Patching	460.000 TON	_____.	_____.
0058	465.0120 Asphaltic Surface Driveways and Field Entrances	184.000 TON	_____.	_____.
0060	465.0565 Asphaltic Rumble Strips, Centerline Sinusoidal	9,312.000 LF	_____.	_____.



Proposal Schedule of Items

Proposal ID: 20240213029 Project(s): 6950-04-72, 6950-04-73, 6950-04-82

Federal ID(s): N/A, N/A, N/A

SECTION: 0001 Contract Items

Alt Set ID: Alt Mbr ID:

Proposal Line Number	Item ID Description	Approximate Quantity and Units	Unit Price	Bid Amount
0062	520.8000 Concrete Collars for Pipe	15.000 EACH	_____.	_____.
0064	522.2343 Culvert Pipe Reinforced Concrete Horizontal Elliptical Class HE-III 43x68-Inch	84.000 LF	_____.	_____.
0066	522.2643 Apron Endwalls for Culvert Pipe Reinforced Concrete Horizontal Elliptical 43x68-Inch	2.000 EACH	_____.	_____.
0068	601.0411 Concrete Curb & Gutter 30-Inch Type D	13,929.000 LF	_____.	_____.
0070	601.0576 Concrete Curb & Gutter 4-Inch Sloped 30-Inch Type J	73.000 LF	_____.	_____.
0072	602.0405 Concrete Sidewalk 4-Inch	5,834.000 SF	_____.	_____.
0074	602.0505 Curb Ramp Detectable Warning Field Yellow	520.000 SF	_____.	_____.
0076	602.0810 Concrete Driveway 6-Inch	933.000 SY	_____.	_____.
0078	606.0300 Riprap Heavy	12.000 CY	_____.	_____.
0080	608.0312 Storm Sewer Pipe Reinforced Concrete Class III 12-Inch	362.000 LF	_____.	_____.
0082	608.0318 Storm Sewer Pipe Reinforced Concrete Class III 18-Inch	24.000 LF	_____.	_____.
0084	608.0324 Storm Sewer Pipe Reinforced Concrete Class III 24-Inch	4.000 LF	_____.	_____.
0086	611.0624 Inlet Covers Type H	25.000 EACH	_____.	_____.
0088	611.0639 Inlet Covers Type H-S	5.000 EACH	_____.	_____.



Proposal Schedule of Items

Proposal ID: 20240213029 Project(s): 6950-04-72, 6950-04-73, 6950-04-82

Federal ID(s): N/A, N/A, N/A

SECTION: 0001 Contract Items

Alt Set ID: Alt Mbr ID:

Proposal Line Number	Item ID Description	Approximate Quantity and Units	Unit Price	Bid Amount
0090	611.3230 Inlets 2x3-FT	30.000 EACH	_____.	_____.
0092	611.8110 Adjusting Manhole Covers	43.000 EACH	_____.	_____.
0094	614.2300 MGS Guardrail 3	325.000 LF	_____.	_____.
0096	614.2330 MGS Guardrail 3 K	375.000 LF	_____.	_____.
0098	614.2610 MGS Guardrail Terminal EAT	2.000 EACH	_____.	_____.
0100	618.0100 Maintenance and Repair of Haul Roads (project) 01. 6950-04-72	1.000 EACH	_____.	_____.
0102	618.0100 Maintenance and Repair of Haul Roads (project) 02. 6950-04-73	1.000 EACH	_____.	_____.
0104	619.1000 Mobilization	1.000 EACH	_____.	_____.
0106	620.0300 Concrete Median Sloped Nose	152.000 SF	_____.	_____.
0108	624.0100 Water	106.000 MGAL	_____.	_____.
0110	625.0100 Topsoil	18,465.000 SY	_____.	_____.
0112	625.0500 Salvaged Topsoil	346.000 SY	_____.	_____.
0114	628.1504 Silt Fence	1,825.000 LF	_____.	_____.
0116	628.1520 Silt Fence Maintenance	3,650.000 LF	_____.	_____.
0118	628.1905 Mobilizations Erosion Control	5.000 EACH	_____.	_____.
0120	628.1910 Mobilizations Emergency Erosion Control	5.000 EACH	_____.	_____.



Proposal Schedule of Items

Proposal ID: 20240213029 Project(s): 6950-04-72, 6950-04-73, 6950-04-82

Federal ID(s): N/A, N/A, N/A

SECTION: 0001 Contract Items

Alt Set ID: Alt Mbr ID:

Proposal Line Number	Item ID Description	Approximate Quantity and Units	Unit Price	Bid Amount
0122	628.2008 Erosion Mat Urban Class I Type B	15,234.000 SY	_____.	_____.
0124	628.7005 Inlet Protection Type A	30.000 EACH	_____.	_____.
0126	628.7015 Inlet Protection Type C	54.000 EACH	_____.	_____.
0128	630.0140 Seeding Mixture No. 40	335.000 LB	_____.	_____.
0130	630.0200 Seeding Temporary	8.000 LB	_____.	_____.
0132	630.0500 Seed Water	430.000 MGAL	_____.	_____.
0134	633.5200 Markers Culvert End	4.000 EACH	_____.	_____.
0136	634.0614 Posts Wood 4x6-Inch X 14-FT	25.000 EACH	_____.	_____.
0138	634.0616 Posts Wood 4x6-Inch X 16-FT	3.000 EACH	_____.	_____.
0140	637.2210 Signs Type II Reflective H	72.000 SF	_____.	_____.
0142	637.2230 Signs Type II Reflective F	18.000 SF	_____.	_____.
0144	638.2102 Moving Signs Type II	36.000 EACH	_____.	_____.
0146	638.2602 Removing Signs Type II	14.000 EACH	_____.	_____.
0148	638.3000 Removing Small Sign Supports	10.000 EACH	_____.	_____.
0150	638.4000 Moving Small Sign Supports	35.000 EACH	_____.	_____.
0152	642.5001 Field Office Type B	1.000 EACH	_____.	_____.



Proposal Schedule of Items

Proposal ID: 20240213029 Project(s): 6950-04-72, 6950-04-73, 6950-04-82

Federal ID(s): N/A, N/A, N/A

SECTION: 0001 Contract Items

Alt Set ID: Alt Mbr ID:

Proposal Line Number	Item ID Description	Approximate Quantity and Units	Unit Price	Bid Amount
0154	643.0300 Traffic Control Drums	5,000.000 DAY	_____.	_____.
0156	643.0420 Traffic Control Barricades Type III	1,240.000 DAY	_____.	_____.
0158	643.0705 Traffic Control Warning Lights Type A	1,748.000 DAY	_____.	_____.
0160	643.0900 Traffic Control Signs	3,588.000 DAY	_____.	_____.
0162	643.0920 Traffic Control Covering Signs Type II	32.000 EACH	_____.	_____.
0164	643.1000 Traffic Control Signs Fixed Message	296.000 SF	_____.	_____.
0166	643.3165 Temporary Marking Line Paint 6-Inch	32,947.000 LF	_____.	_____.
0168	643.3350 Temporary Marking Crosswalk Removable Tape 6-inch	2,023.000 LF	_____.	_____.
0170	643.5000 Traffic Control	1.000 EACH	_____.	_____.
0172	644.1430 Temporary Pedestrian Surface Plate	752.000 SF	_____.	_____.
0174	644.1440 Temporary Pedestrian Surface Matting	1,034.000 SF	_____.	_____.
0176	644.1601 Temporary Pedestrian Curb Ramp	625.000 DAY	_____.	_____.
0178	644.1605 Temporary Pedestrian Detectable Warning Field	234.000 SF	_____.	_____.
0180	644.1810 Temporary Pedestrian Barricade	2,574.000 LF	_____.	_____.
0182	645.0120 Geotextile Type HR	40.000 SY	_____.	_____.
0184	646.1020 Marking Line Epoxy 4-Inch	694.000 LF	_____.	_____.



Proposal Schedule of Items

Proposal ID: 20240213029 Project(s): 6950-04-72, 6950-04-73, 6950-04-82

Federal ID(s): N/A, N/A, N/A

SECTION: 0001 Contract Items

Alt Set ID: Alt Mbr ID:

Proposal Line Number	Item ID Description	Approximate Quantity and Units	Unit Price	Bid Amount
0186	646.2020 Marking Line Epoxy 6-Inch	45,102.000 LF	_____.	_____.
0188	646.2040 Marking Line Grooved Wet Ref Epoxy 6-Inch	43,481.000 LF	_____.	_____.
0190	646.3020 Marking Line Epoxy 8-Inch	88.000 LF	_____.	_____.
0192	646.4020 Marking Line Epoxy 10-Inch	40.000 LF	_____.	_____.
0194	646.4040 Marking Line Grooved Wet Ref Epoxy 10-Inch	789.000 LF	_____.	_____.
0196	646.5020 Marking Arrow Epoxy	17.000 EACH	_____.	_____.
0198	646.5120 Marking Word Epoxy	2.000 EACH	_____.	_____.
0200	646.5220 Marking Symbol Epoxy	9.000 EACH	_____.	_____.
0202	646.5320 Marking Railroad Crossing Epoxy	2.000 EACH	_____.	_____.
0204	646.6120 Marking Stop Line Epoxy 18-Inch	84.000 LF	_____.	_____.
0206	646.7120 Marking Diagonal Epoxy 12-Inch	163.000 LF	_____.	_____.
0208	646.7420 Marking Crosswalk Epoxy Transverse Line 6-Inch	594.000 LF	_____.	_____.
0210	646.7520 Marking Crosswalk Epoxy Block Style 24-Inch	397.000 LF	_____.	_____.
0212	646.8120 Marking Curb Epoxy	166.000 LF	_____.	_____.
0214	646.8220 Marking Island Nose Epoxy	8.000 EACH	_____.	_____.



Proposal Schedule of Items

Proposal ID: 20240213029 Project(s): 6950-04-72, 6950-04-73, 6950-04-82

Federal ID(s): N/A, N/A, N/A

SECTION: 0001 Contract Items

Alt Set ID: Alt Mbr ID:

Proposal Line Number	Item ID Description	Approximate Quantity and Units	Unit Price	Bid Amount
0216	650.4000 Construction Staking Storm Sewer	30.000 EACH	_____.	_____.
0218	650.4500 Construction Staking Subgrade	100.000 LF	_____.	_____.
0220	650.5000 Construction Staking Base	332.000 LF	_____.	_____.
0222	650.5500 Construction Staking Curb Gutter and Curb & Gutter	14,002.000 LF	_____.	_____.
0224	650.6000 Construction Staking Pipe Culverts	1.000 EACH	_____.	_____.
0226	650.8000 Construction Staking Resurfacing Reference	18,600.000 LF	_____.	_____.
0228	650.9000 Construction Staking Curb Ramps	48.000 EACH	_____.	_____.
0230	650.9911 Construction Staking Supplemental Control (project) 01. 6950-04-72	1.000 EACH	_____.	_____.
0232	650.9911 Construction Staking Supplemental Control (project) 02. 6950-04-73	1.000 EACH	_____.	_____.
0234	650.9920 Construction Staking Slope Stakes	8,501.000 LF	_____.	_____.
0236	652.0225 Conduit Rigid Nonmetallic Schedule 40 2-Inch	10.000 LF	_____.	_____.
0238	654.0102 Concrete Bases Type 2	1.000 EACH	_____.	_____.
0240	655.0620 Electrical Wire Lighting 8 AWG	185.000 LF	_____.	_____.
0242	690.0150 Sawing Asphalt	18,075.000 LF	_____.	_____.
0244	690.0250 Sawing Concrete	11,571.000 LF	_____.	_____.



Proposal Schedule of Items

Proposal ID: 20240213029 Project(s): 6950-04-72, 6950-04-73, 6950-04-82

Federal ID(s): N/A, N/A, N/A

SECTION: 0001 Contract Items

Alt Set ID: Alt Mbr ID:

Proposal Line Number	Item ID Description	Approximate Quantity and Units	Unit Price	Bid Amount
0246	740.0440 Incentive IRI Ride	20,360.000 DOL	1.00000	20,360.00
0248	SPV.0030 Special 01. Fertilizer For Lawn Type Turf	12.000 CWT	_____.	_____.
0250	SPV.0060 Special 01. Reestablish Section Corner Monuments	2.000 EACH	_____.	_____.
0252	SPV.0060 Special 02. Adjusting Water Valves	28.000 EACH	_____.	_____.
0254	SPV.0060 Special 03. Temporary Water Diversion	1.000 EACH	_____.	_____.
0256	SPV.0060 Special 04. Salvage And Reinstall Lighting Unit	1.000 EACH	_____.	_____.
0258	SPV.0060 Special 05. Storm Sewer Repair	1.000 EACH	_____.	_____.
0260	SPV.0180 Special 01. Preparing Topsoil For Lawn Type Turf	18,465.000 SY	_____.	_____.
0262	SPV.0180 Special 02. Removing Distressed Asphaltic Surface Milling	2,375.000 SY	_____.	_____.
Section: 0001			Total:	_____.
			Total Bid:	_____.

PLEASE ATTACH ADDENDA HERE



Wisconsin Department of Transportation

January 18, 2024

**Division of Transportation Systems
Development**

Bureau of Project Development
4822 Madison Yards Way, 4th Floor South
Madison, WI 53705

Telephone: (608) 266-1631
Facsimile (FAX): (608) 266-8459

NOTICE TO ALL CONTRACTORS:

ASP-6 Addendum #01

Letting of February 13, 2024

Attached is a copy of the revised ASP-6. This ASP-6 replaces ASP-6 in all proposals in the February 13, 2024 Letting.

The responsibility for notifying potential subcontractors and suppliers of these changes remains with the prime contractors.

Sincerely,

Mike Coleman

Proposal Development Specialist
Proposal Management Section

Additional Special Provision 6 (ASP-6)
Modifications to the standard specifications

Make the following revisions to the standard specifications:

108 Prosecution and Progress

Add subsection 108.9.4.1 effective with the November 2023 letting:

108.9.4.1 Winter Suspension for Completion Date Contracts

- (1) The contractor may request a winter suspension for a completion date contract. If the department determines weather conditions do not allow for the completion of the remaining work, the department may approve the contractor's request and determine the start date of the winter suspension. The end date of the winter suspension is March 31 or a date mutually agreed upon by both parties. For multi-year contracts, the department will only consider winter suspension for the final year of the contract.
 - (2) During winter suspension, store all materials in a manner that does not obstruct vehicular and pedestrian traffic and protect the materials from damage. Install traffic control and other safety devices necessary to protect the traveling public and pedestrians. Provide suitable drainage and install temporary erosion control where necessary. If the winter suspension begins when liquidated damages are being assessed, or when the work has not progressed as scheduled and would not have been completed prior to the completion date, the cost of necessary pre-suspension work is incidental. If the winter suspension begins prior to the contract completion date, and the work has progressed as scheduled and would have been completed prior to the completion date, the cost of pre-suspension work will be paid as specified under 109.4.
 - (3) For a winter suspension that begins prior to the contract completion date and the work has progressed as scheduled and would have been completed prior to the completion date, the engineer will extend contract time to correspond with the end of the winter suspension and liquidated damages will not be assessed during the winter suspension.
 - (4) For a winter suspension that begins when liquidated damages are being assessed or when the work has not progressed as scheduled and would not have been completed prior to the completion date, the engineer will not extend contract time. Time will be suspended until the end of the winter suspension. Liquidated damages will not be assessed during the winter suspension and liquidated damages will resume at the end of the winter suspension.
-

108.10.2 Excusable, Non-Compensable Delays

108.10.2.1 General

Replace entire section with the following effective with the January 2024 letting:

- (1) Non-compensable delays, 108.10.2.1(3), are excusable delays not the contractor's or the department's fault. The engineer will not pay for the delay costs listed in 109.4.7 for non-compensable delays.
 - (2) For non-compensable delays under calendar day and completion date contracts, the engineer will extend contract time if the conditions specified in 108.10.1 are met. The department will relieve the contractor from associated liquidated damages, as specified in 108.11, if the engineer extends time under 108.10.1.
 - (3) The following are non-compensable delays:
 1. Delays due to earthquakes, other cataclysmic phenomena of nature the contractor cannot foresee and avoid, severe weather or job conditions caused by recent weather as specified in 108.10.2.2.
 2. Extraordinary delays in material deliveries the contractor or their suppliers cannot foresee and forestall resulting from strikes, lockouts, freight embargoes, industry-wide shortages, governmental acts, or sudden disasters.
 3. Delays due to acts of the government, a political subdivision other than the department, or the public enemy.
 4. Delays from fires or epidemics.
 5. Delays from strikes beyond the contractor's power to settle not caused by improper acts or omissions of the contractor, their subcontractors, or their suppliers.
 6. Altered quantities as specified in 109.3.
-

108.10.3 Excusable Compensable Delays

Replace entire section with the following effective with the January 2024 letting:

- (1) Compensable delays are excusable delays due to the department's actions or lack of actions. The engineer will grant a time extension for a compensable delay if the conditions specified in 108.10.1 are met.
- (2) The following are compensable delays:

1. A contract change for revised work as specified for extra work under 104.2.2.1, for a differing site condition under 104.2.2.2, or for significant changes in the character of the work under 104.2.2.4.
 2. A contract change for an engineer-ordered suspension under 104.2.2.3.
 3. The unexpected discovery of human remains, an archaeological find, or historical find consistent with 107.25.
 4. The unexpected discovery of a hazardous substance consistent with 107.24.
 5. The non-completion of work that utilities or other third parties perform, if that work is not completed as specified in the contract.
- (3) For a compensable delay or a time extension, the department will relieve the contractor from associated liquidated damages under 108.11, and will pay the contractor for delay costs determined as follows:
1. Adjust the contract price as specified in 109.4.2 through 109.4.5 for delays under item 1 of 108.10.3(2).
 2. Adjust the contract price as specified in 109.4.7 for delays under items 2 through 5 of 108.10.3(2).

310 Open Graded Base

310.2 Materials

Replace paragraph two with the following effective with the November 2023 letting:

- (2) The contractor may substitute material conforming to the gradation requirements for crushed aggregate specified in Table 310-01 if that material conforms to the fracture requirements for open-graded crushed gravel specified in 301.2.4.5.

TABLE 310-01 COARSE AGGREGATE (% passing by weight)

AASHTO No. 67 ^[1]	
SEIVE	COARSE AGGREGATE (% PASSING by WEIGHT) AASHTO No. 67
2-inch	-
1 1/2-inch	-
1-inch	100
3/4-inch	90 – 100
1/2-inch	-
3/8-inch	20 – 55
No. 4	0 – 10
No. 8	0 – 5
No. 16	-
No. 30	-
No. 50	-
No. 100	-
No. 200	<=1.5

[1] Size according to AASHTO M43.

390 Base Patching

390.4 Measurement

Replace entire section with the following effective with the November 2023 letting:

- (1) The department will measure Removing Pavement for Base Patching by the cubic yard acceptably completed. Measure the depth from the bottom of the adjacent pavement to the top of the patch.
- (2) The department will measure Base Patching Asphaltic by the ton acceptably completed as specified for asphaltic pavement in 450.4.
- (3) The department will measure Base Patching Concrete HES and Base Patching Concrete SHES by the cubic yard acceptably completed. Measure the depth from the bottom of the adjacent pavement to the top of the patch.

390.5 Payment

Replace entire section with the following effective with the November 2023 letting:

(1) The department will pay for measured quantities at the contract unit price under the following bid items:

<u>ITEM NUMBER</u>	<u>DESCRIPTION</u>	<u>UNIT</u>
390.0100	Removing Pavement for Base Patching	CY
390.0201	Base Patching Asphaltic	TON
390.0305	Base Patching Concrete HES	CY
390.0405	Base Patching Concrete SHES	CY

- (2) Payment for Removing Pavement for Base Patching is full compensation for removing old pavement; for preparing the foundation and bringing up to grade. If the engineer orders the contractor to excavate yielding or unstable subgrade materials and backfill with suitable materials, the department will pay for that work with contract bid items or as agreed upon using 109.4.
- (3) Payment for Base Patching Asphaltic is full compensation for providing and compacting asphaltic mixture including asphaltic binder.
- (4) Payment for Base Patching Concrete HES and Base Patching Concrete SHES is full compensation for providing, curing, and protecting concrete. Payment also includes providing tie bars and dowel bars in unhardened concrete and steel within the patch. For tie bars and dowel bars provided in concrete not placed under the contract, the department will pay separately under the Drilled Tie Bars and Drilled Dowel Bars bid items as specified in 416.5.
- (5) Payment for Base Patching SHES also includes providing test data to the engineer as specified in 416.2.4.
- (6) The department will pay for sawing existing concrete pavement for removal under the Sawing Concrete bid item as specified in 690.5.

460 Hot Mix Asphalt Pavement

460.2.8.2.1.3.1 Contracts with 5000 Tons of Mixture or Greater

Replace paragraph four with the following effective with the November 2023 letting:

(4) Use the test methods identified below, or other methods the engineer approves, to perform the following tests at the frequency indicated:

Blended aggregate gradations:

Drum plants:

- Field extraction by ignition oven according to WTM T308, chemical extraction according to AASHTO T-164 method A or B; or automated extraction according to WTM D8159. Gradation of resulting aggregate sample determined according to WTM T30.
- Belt samples, optional for virgin mixtures, obtained from stopped belt or from the belt discharge using an engineer-approved sampling device and performed according to WTM T11 and T27.

Batch plants:

- Field extraction by ignition oven according to WTM T308, chemical extraction according to AASHTO T-164 method A or B; or automated extraction according to WTM D8159. Gradation of resulting aggregate sample determined according to WTM T30.

Asphalt content (AC) in percent:

Determine AC using one of the following methods:

- AC by ignition oven according to WTM T308.
- AC by chemical extraction according to AASHTO T-164 method A or B.
- AC by automated extraction according to WTM D8159.
- If the department is using an ignition oven to determine AC, conform to WTP H003.
- If the department is not using an ignition oven to determine AC, ignition oven correction factor (IOCF) must still be reverified for any of the reasons listed in WTP H003 Table 2 and conform to WTP H-003 sections 3 through 6.
- Gradation of resulting aggregate sample determined according to WTM T30.

Bulk specific gravity of the compacted mixture:

According to WTM T166.

Theoretical maximum specific gravity:

According to WTM T209.

Air voids (Va) by calculation according to WTM T269.

VMA by calculation according to WTM R35.

460.2.8.3.1.4 Department Verification Testing Requirements

Replace paragraph three with the following effective with the November 2023 letting:

- (3) The department will perform testing conforming to the following standards:
 - Bulk specific gravity (G_{mb}) of the compacted mixture according to WTM T166.
 - Maximum specific gravity (G_{mm}) according to WTM T209.
 - Air voids (V_a) by calculation according to WTM T269.
 - VMA by calculation according to WTM R35.
 - Asphalt content by ignition oven according to WTM T308, chemical extraction according to AASHTO T-164 method A or B, or automated extraction according to WTM D8159. If using an ignition oven to determine AC, conform to WTP H-003.

460.3.3.2 Pavement Density Determinations

Replace entire section with the following effective with the February 2024 letting:

- (1) The engineer will determine the target maximum density using department procedures described in WTM T355. The engineer will determine density according to CMM 815 and WTM T355 as soon as practicable after compaction and before placement of subsequent layers or before opening to traffic.
- (2) Do not re-roll compacted mixtures with deficient density test results. Do not operate continuously below the specified minimum density. Stop production, identify the source of the problem, and make corrections to produce work meeting the specification requirements.
- (3) A lot is defined as one day's production for each subplot type or one production shift if running 24 hours per day and placed within a single layer for each location and target maximum density category indicated in table 460-3. The lot density is the average of the tests taken for that lot. The department determines the number of tests per lot according to WTP H-002.
- (4) An HTCP-certified Nuclear Density Technician I (NUCDENSITYTEC-I) or a nuclear density ACT working under a NUCDENSITYTEC-I technician, will locate samples and perform the testing. A NUCDENSITYTEC-I technician will coordinate and take responsibility for the work an ACT performs. No more than one ACT can work under a single NUCDENSITYTEC-I technician. The responsible NUCDENSITYTEC-I technician will ensure that sample location and testing is performed correctly, analyze test results, and provide density results to the contractor weekly.

503 Prestressed Concrete Members

503.2.2 Concrete

Replace paragraph five with the following effective with the November 2023 letting:

- (5) Furnish prestressed concrete members cast from air-entrained concrete, except I-type girders may use non-air-entrained concrete. Use type I, IL, IS, IP, IT, II, or III cement. The contractor may replace up to 30 percent of type I, IL, II, or III cement with an equal weight of fly ash, slag, or a combination of fly ash and slag. Ensure that fly ash conforms to 501.2.4.2.2 and slag conforms to 501.2.4.2.3. Use only one source and replacement rate for work under a single bid item. Use a department-approved air-entraining admixture conforming to 501.2.5.2 for air-entrained concrete. Use only coarse aggregate conforming to 310.2(2).

604 Slope Paving

604.2 Materials

Replace paragraph three with the following effective with the November 2023 letting:

- (3) Under the Slope Paving Crushed Aggregate bid item, furnish crushed stone or crushed gravel conforming to the gradation in Table 604-01, but with the additional requirements that at least 75 percent of the particles, by count, have at least one fractured face. Determine fracture according to WTM D5821.

TABLE 604-01 COARSE AGGREGATE (% passing by weight)

AASHTO No. 4^[1]	
SEIVE	COARSE AGGREGATE (% PASSING by WEIGHT) AASHTO No. 4
2-inch	100
1 1/2-inch	90 - 100
1-inch	20 - 55
3/4-inch	0 - 15
1/2-inch	-
3/8-inch	0 - 5
No. 4	-
No. 8	-
No. 16	-
No. 30	-
No. 50	-
No. 100	-
No. 200	<=1.5

[1] Size according to AASHTO M43.

612 Underdrains

612.3.9 Trench Underdrains

Replace paragraph one with the following effective with the November 2023 letting:

- (1) Under the Underdrain Trench bid item, excavate and backfill underdrain trenches. Backfill with coarse aggregate gradation conforming to 604.2(3). Before backfilling place geotextile as the plans show.

614 Semi-rigid Barrier Systems and End Treatments

614.2.6 Sand Barrel Arrays

Replace paragraph one with the following effective with the November 2023 letting:

- (1) Furnish sand barrels from the APL. Use fine aggregate conforming to gradation shown in Table 614-2 mixed with sodium chloride conforming to AASHTO M143. Apply an object marker to front-most barrel in the array.

TABLE 614-2 FINE AGGREGATE GRADATION

SEIVE	FINE AGGREGATE (% PASSING by WEIGHT)
3/8-inch	100
No. 4	90 - 100
No. 8	-
No. 16	45 - 85
No. 30	-
No. 50	5 - 30
No. 100	0 - 10
No. 200	<=3.5

628 Erosion Control**628.2.13 Rock Bags**

Replace paragraph two with the following effective with the November 2023 letting:

- (2) Fill the bags with a clean, sound, hard, durable, engineer-approved coarse aggregate conforming by visual inspection to the gradation specified for coarse aggregate gradation in 604.2(3).

639 Drilling Wells**639.2.1 General**

Replace paragraph two with the following effective with the November 2023 letting:

- (2) For grout use fine aggregate conforming to 501.2.7.2; and gradation conforming to 614.2.6(1); and type I, IL, IS, IP, or IT cement.

652 Electrical Conduit**652.3.1.2 Installing Underground**

Replace paragraph two with the following effective with the November 2023 letting:

- (2) Excavate trenches true to line and grade to provide the conduit uniform bearing throughout its length. Do not backfill the trench before inspecting the conduit. Carefully tamp the backfill in place as specified for placing backfill in layers in 651.3. Place at least 0.7 cubic feet of coarse aggregate gradation conforming to 604.2(3) directly under each drainage hole.

ERRATA

390.3.4 Special High Early Strength Concrete Patching

Correct errata link in paragraph (1) by changing from 416.3.8 to 416.3.7.

- (1) Construct as specified for special high early strength repairs under 416.3.7 except as follows:
 - The contractor may delay removal for up to 14 calendar days after cutting the existing pavement.
 - Open to traffic as specified for concrete base in 320.3.



Wisconsin Department of Transportation

February 6, 2024

Division of Transportation Systems Development

Bureau of Project Development
4822 Madison Yards Way, 4th Floor South
Madison, WI 53705

Telephone: (608) 266-1631
Facsimile (FAX): (608) 266-8459

NOTICE TO ALL CONTRACTORS:

Proposal #29: 6950-04-72
Dexterville – Wisconsin Rapids
Swanson Road to Seneca Road
STH 54
Wood County

6950-04-73
Dexterville – Wisconsin Rapids
CTH G to Swanson Road
STH 54
Wood County

6950-04-82
Dexterville – Wisconsin Rapids
Swanson Road to Seneca Road
STH 54
Wood County

Letting of February 13, 2024

This is Addendum No. 01, which provides for the following:

Special Provisions:

Revised Special Provisions	
Article No.	Description
3	Prosecution and Progress

Schedule of Items:

Revised Bid Item Quantities					
Bid Item	Item Description	Unit	Proposal Total Prior to Addendum	Proposal Quantity Change (-)	Proposal Total After Addendum
643.0300	Traffic Control Drums	Day	5000	4750	9750
643.0420	Traffic Control Barricades Type III	Day	1240	10	1250
643.0705	Traffic Control Warning Lights	Day	1748	12	1760
643.0900	Traffic Control Signs	Day	3588	22	3610
643.1000	Traffic Control Signs Fixed Message	SF	296	-3.75	292.25
643.3350	Temporary Marking Crosswalk Removable Tape 6-inch	LF	2023	536	2559

644.1430	Temporary Pedestrian Surface Plate	SF	752	205	957
644.1440	Temporary Pedestrian Surface Matting	SF	1034	293	1327
644.1601	Temporary Pedestrian Curb Ramp	Day	625	150	775
644.1605	Temporary Pedestrian Detectable Warning Field	SF	234	150	384
644.1810	Temporary Pedestrian Barricade	LF	2574	984	3558

Plan Sheets:

Revised Plan Sheets	
Plan Sheet	Plan Sheet Title (brief description of changes to sheet)
68	Pedestrian Accommodations – Stage 1 – Modified temporary Pedestrian Accommodations
71	Pedestrian Accommodations – Stage 1 – Modified temporary Pedestrian Accommodations
72	Pedestrian Detour – Stage 1 - Modified temporary Pedestrian Accommodations
73	Pedestrian Accommodations – Stage 2 - Modified temporary Pedestrian Accommodations
75	Pedestrian Accommodations – Stage 2 - Modified temporary Pedestrian Accommodations
76	Pedestrian Detour – Stage 2 - Modified temporary Pedestrian Accommodations
77	Bicycle and Pedestrian Detour - Modified temporary Pedestrian Accommodations
91	Miscellaneous Quantities – Changes made to Temporary Pedestrian Accommodation Items and Traffic Control Items and Traffic Control Signs Fixed Message
199	Temporary Signing – Deleted one sign and replaced with a different one.

Added Plan Sheets	
Plan Sheet	Plan Sheet Title (brief description of why sheet was added)
67A	Pedestrian Accommodations – Stage 1 – New sheet for added temporary Ped Accommodations between 7 th Street and 4 th Street
72A	Pedestrian Accommodations – Stage 2 - New sheet for added temporary Ped Accommodations between 7 th Street and 4 th Street

The responsibility for notifying potential subcontractors and suppliers of these changes remains with the prime contractor.

Sincerely,

Mike Coleman

Proposal Development Specialist
Proposal Management Section

ADDENDUM NO. 01

6950-04-72/73/82

February 6, 2024

Special Provisions

3. Prosecution and Progress.

*Replace entire section titled **Construction Staging** with the following:*

Construction Staging

Project 6950-04-72/82:

Stage 1: Mill and overlay STH 54/73/Letendre Avenue eastbound lane, base aggregate, curb ramps. STH 54/73/Wisconsin River Drive remove existing curb & gutter, excavate, and mill.

Stage 2: Mill and overlay STH 54/73/Letendre Avenue westbound lane, base aggregate, curb ramps and pavement marking. STH 54/73/Wisconsin River Drive place new curb and gutter, curb ramps, concrete sidewalk, HMA pavement, grade terrace.

STH 54/73/Letendre Avenue from STH 73 (Port Road) to 3rd Street may be closed for up to 5 days for culvert replacement (Station 113+82). Curb ramp 6 (CR-6) and curb ramp 7 (CR-7) need to be completed and open for use prior to the 5-day closure.

Project 6950-04-73:

Stage 1: Mill STH 54 eastbound & westbound lanes

Stage 2: Overlay STH 54 eastbound & westbound lanes, shoulder base aggregate and pavement marking.

If contract time expires prior to completing all work specified in the contract, additional liquidated damages will be affixed according to standard spec 108.11.

Schedule of Items

Attached, dated February 6, 2024, are the revised Schedule of Items Page 6.

Plan Sheets

The following 8½ x 11-inch sheets are attached and made part of the plans for this proposal:

Revised: 68, 71, 72, 73, 75, 76, 77, 91, and 199

Added: 67A and 72A

END OF ADDENDUM

Addendum No. 01
 ID 6950-04-72
 Added Sheet 67A
 February 6, 2024

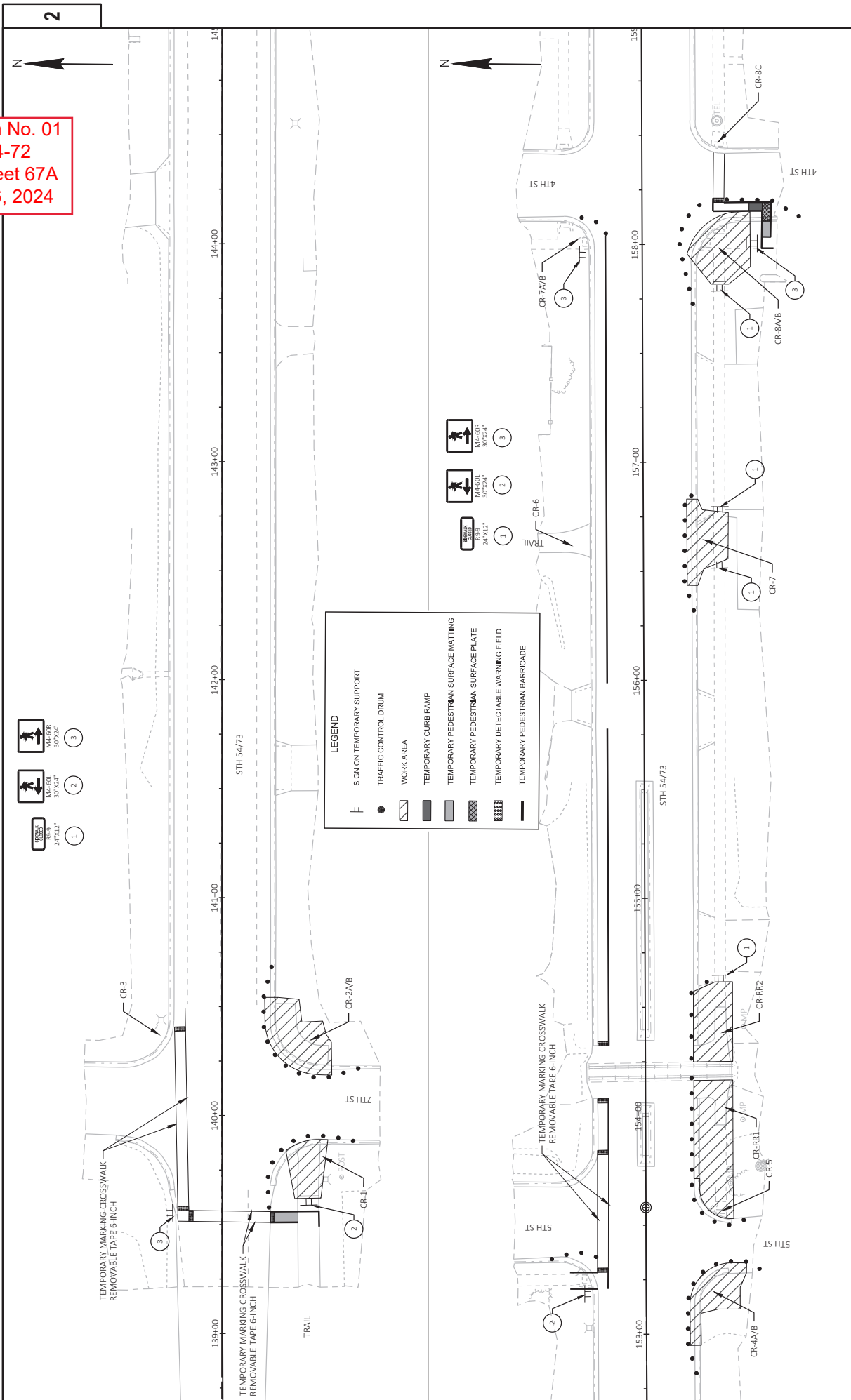

PROJECT NO: 6950-04-72	COUNTY: WOOD	SHEET: 67A
HWY: STH 54	PEDESTRIAN ACCOMMODATIONS - STAGE 1	
FILE NAME: I:\MVA\0878_STH54_72\GIS\SHSHPAN\0250011C.DWG	DATE: 1/31/2024 3:53 PM	PLOT NAME: RESHEKE, CARBE
LAYOUT NAME: -01.D		WISDOT/CADDIS SHEET 44

Addendum No. 01
 ID 6950-04-72
 Revised Sheet 68
 February 6, 2024

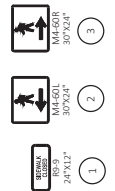
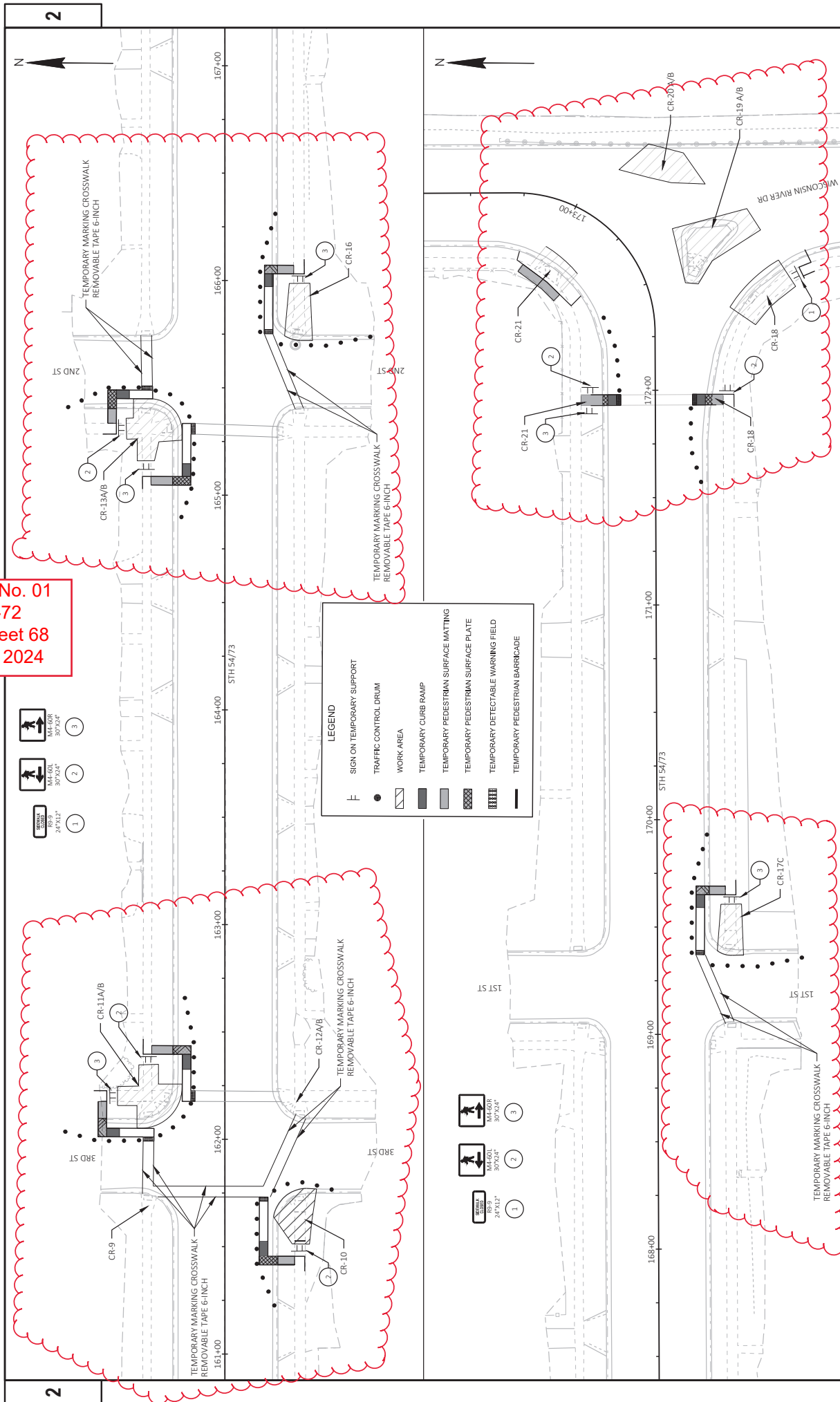

LEGEND

- Sign on temporary support
- Traffic control drum
- Work area
- Temporary curb ramp
- Temporary pedestrian surface matting
- Temporary pedestrian surface plate
- Temporary detectable warning field
- Temporary pedestrian barricade



Addendum No. 01
ID 6950-04-72
Revised Sheet 71
February 6, 2024

LEGEND	
F	SIGN ON TEMPORARY SUPPORT
●	TRAFFIC CONTROL DRUM
	WORK AREA
	TEMPORARY CURB RAMP
	TEMPORARY PEDESTRIAN SURFACE MATTING
	TEMPORARY PEDESTRIAN SURFACE PLATE
	TEMPORARY DETECTABLE WARNING FIELD
	TEMPORARY PEDESTRIAN BARRICADE

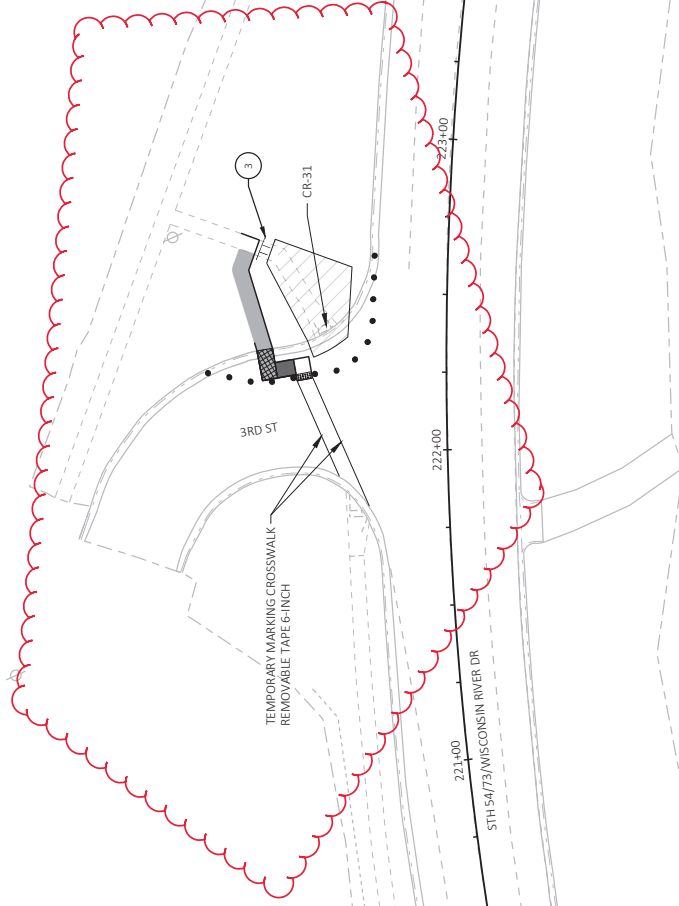

NOTE: SEE LAYOUT FOR "TRAFFIC CONTROL PEDESTRIAN ACCOMMODATION" FOR ADDITIONAL INFORMATION.





Addendum No. 01
ID 6950-04-72
Revised Sheet 72
February 6, 2024

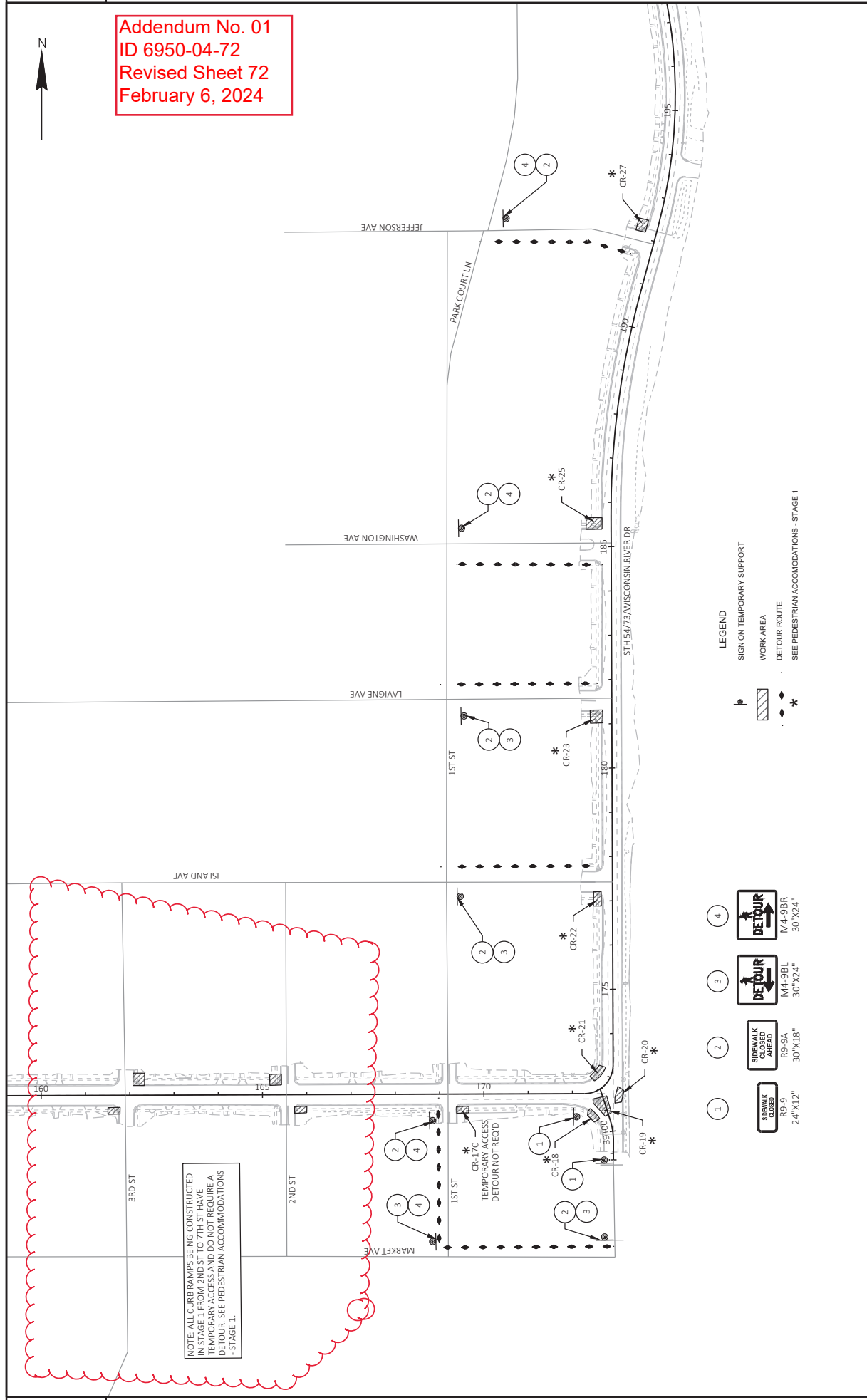

NOTE: ALL CURB RAMPS BEING CONSTRUCTED IN STAGE 1 FROM 2ND ST TO 7TH ST HAVE TEMPORARY ACCESS AND DO NOT REQUIRE A DETOUR. SEE PEDESTRIAN ACCOMMODATIONS - STAGE 1.

- 1 SIGNWALK CLOSED R9-9 24"X12"
- 2 SIGNWALK CLOSED AHEAD R9-9A 30"X18"
- 3 DETOUR M4-9BL 30"X24"
- 4 DETOUR M4-9BR 30"X24"

- LEGEND
- SIGN ON TEMPORARY SUPPORT
 - WORK AREA
 - DETOUR ROUTE
 - SEE PEDESTRIAN ACCOMMODATIONS - STAGE 1

Addendum No. 01
 ID 6950-04-72
 Added Sheet 72A
 February 6, 2024

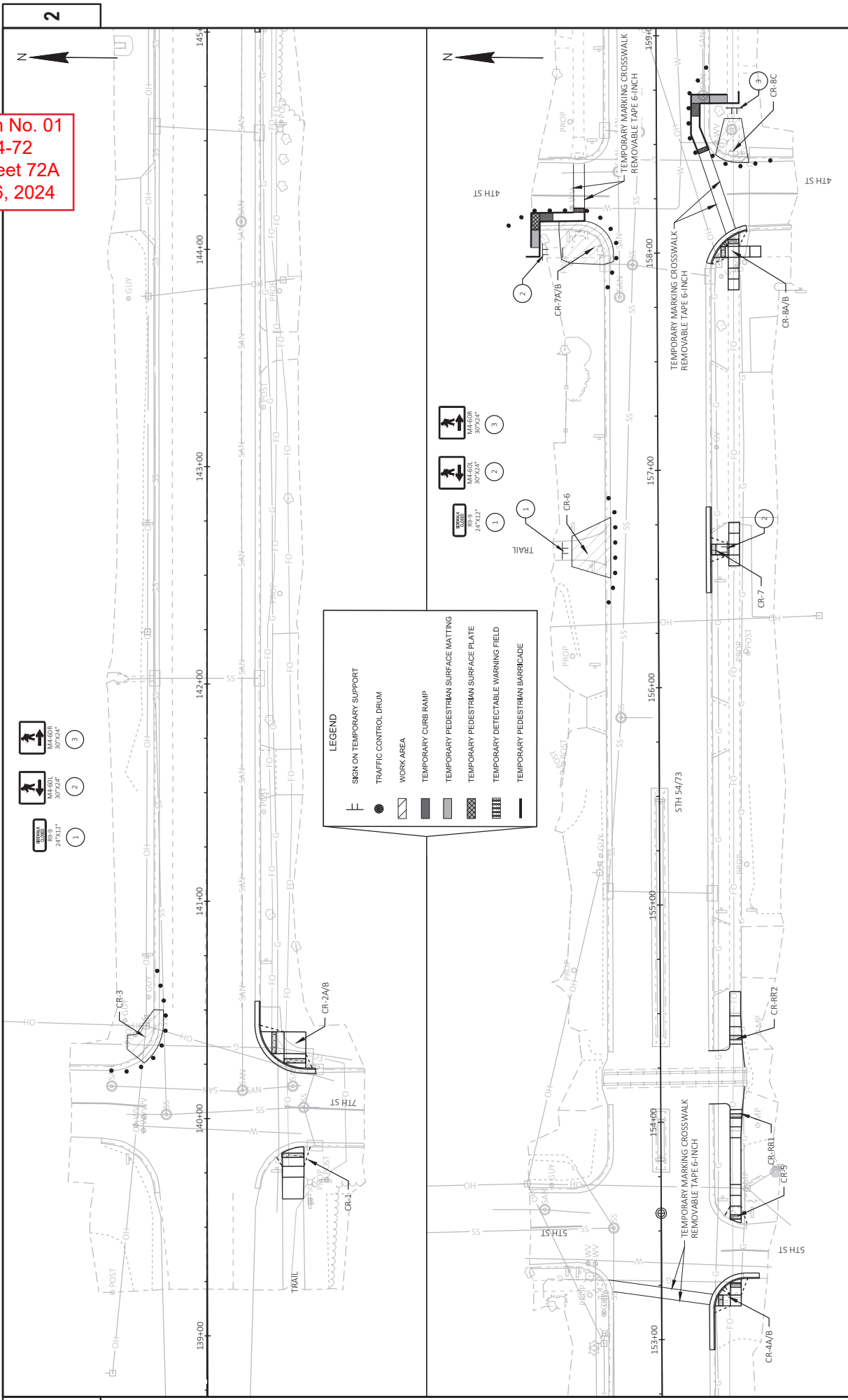

2

2

PROJECT NO: 6950-04-72	COUNTY: WOOD	PEDESTRIAN ACCOMMODATIONS - STAGE 2	SHEET 72A
FILE NAME: I:\LEVEL0878_5TH ST_72A\DRSHEETS\PLAN\02540-1-C.DWG	DATE: 1/31/2024 3:54 PM	DESIGNED BY: RESHEKE, CARIE	DATE: 1/14/2024
LAYOUT NAME: -01.D			

E

Addendum No. 01
 ID 6950-04-72
 Revised Sheet 73
 February 6, 2024

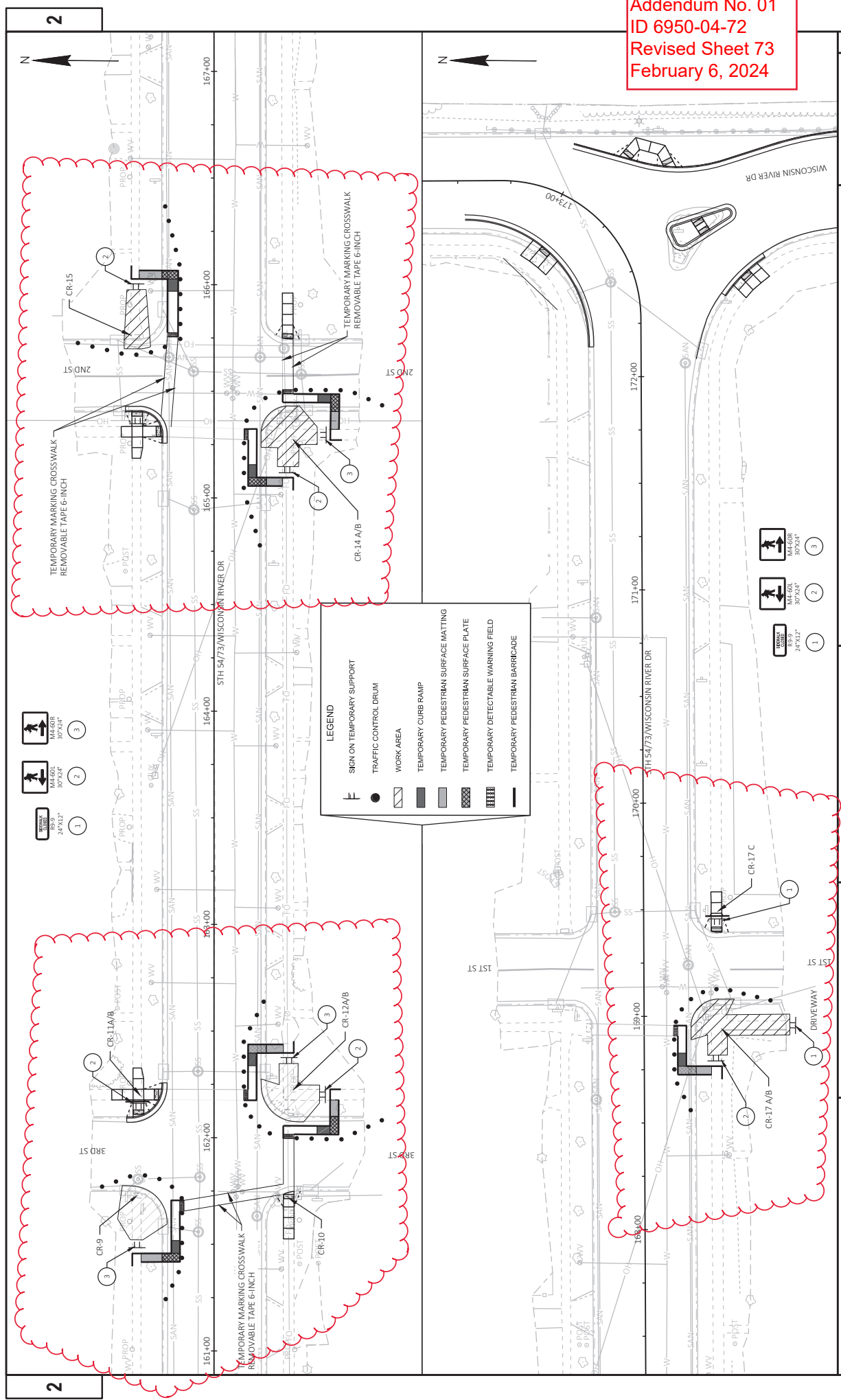

LEGEND

- SIGN ON TEMPORARY SUPPORT
- TRAFFIC CONTROL DRUM
- WORK AREA
- TEMPORARY CURB RAMP
- TEMPORARY PEDESTRIAN SURFACE MATTING
- TEMPORARY PEDESTRIAN SURFACE PLATE
- TEMPORARY DETECTABLE WARNING FIELD
- TEMPORARY PEDESTRIAN BARRICADE

- M4-60L 30"x24" 1
- M4-60R 30"x24" 2
- M4-60L 30"x24" 3
- R9-9 24"x12" 1

- M4-60L 30"x24" 1
- M4-60R 30"x24" 2
- M4-60L 30"x24" 3

2

2

Addendum No. 01
 ID 6950-04-72
 Revised Sheet 75
 February 6, 2024

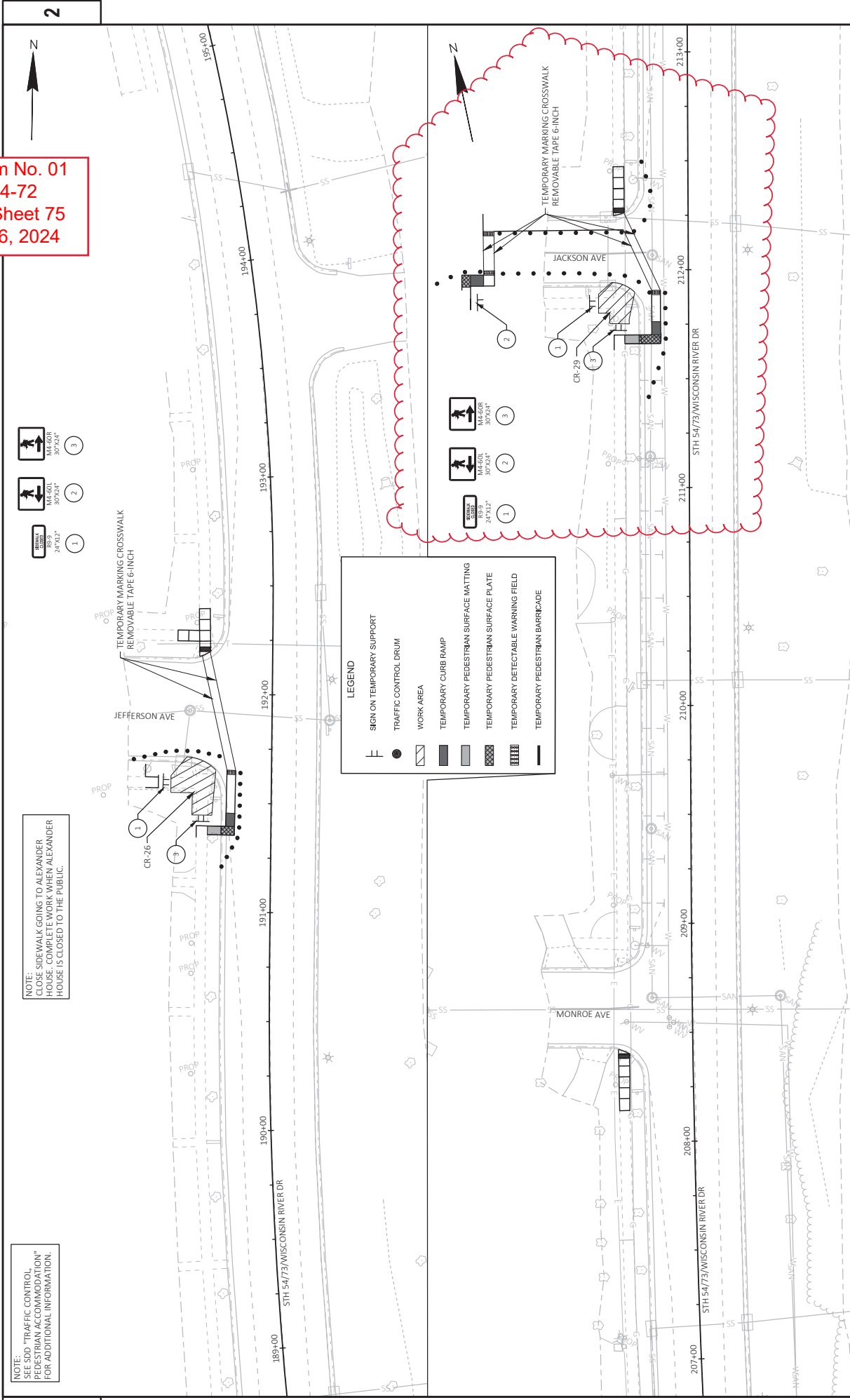

NOTE:
 SEE SDD "TRAFFIC CONTROL,
 PEDESTRIAN ACCOMMODATION"
 FOR ADDITIONAL INFORMATION.

NOTE:
 SIDEWALK GOING TO ALEXANDER
 HOUSE. COMPLETE WORK WHEN ALEXANDER
 HOUSE IS CLOSED TO THE PUBLIC.

LEGEND

	SIGN ON TEMPORARY SUPPORT
	TRAFFIC CONTROL DRUM
	WORK AREA
	TEMPORARY CURB RAMP
	TEMPORARY PEDESTRIAN SURFACE MATTING
	TEMPORARY PEDESTRIAN SURFACE PLATE
	TEMPORARY DETECTABLE WARNING FIELD
	TEMPORARY PEDESTRIAN BARRICADE

- 1
- 2
- 3

- 1
- 2
- 3



Addendum No. 01
ID 6950-04-72
Revised Sheet 76
February 6, 2024

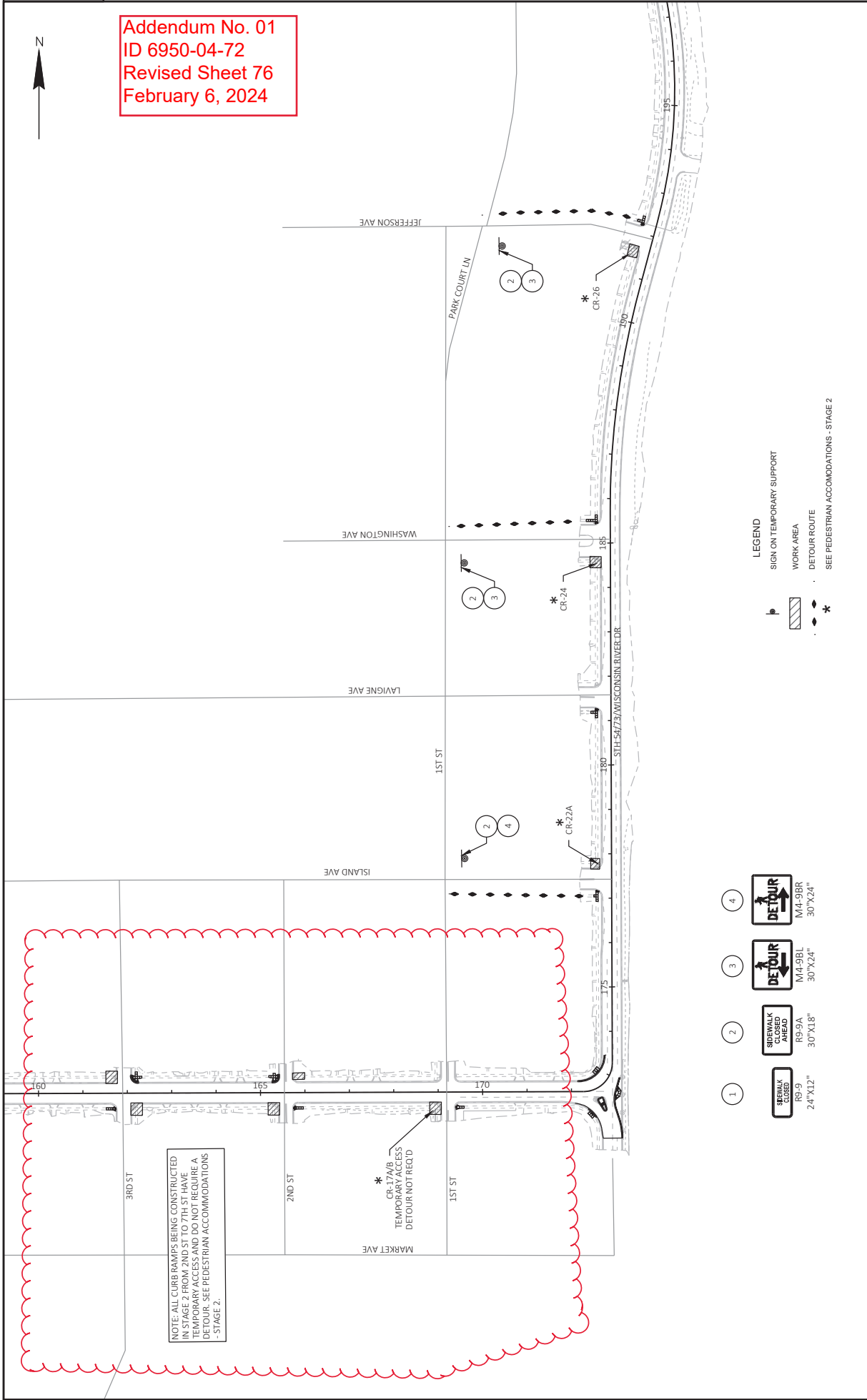

Addendum No. 01
 ID 6950-04-72
 Revised Sheet 77
 February 6, 2024

2

2

BICYCLE AND PEDESTRIAN DETOUR FOR CULVERT REPLACEMENT

LEGEND

- ◆ DETOUR
- ◆ WORK ZONE
- * STAGE 2 WORK ONLY

ALL SIGNS TO BE ON TEMPORARY SIGN SUPPORTS

1. SIGN 307X18" M4-9A1 307924"
2. SIGN 307X18" M4-9A1 307924"
3. SIGN 307X24" M4-9A1 307924"
4. SIGN 307X24" M4-9A1 307924"
5. TRAIL CLOSED ALONG HWY 54 AT 771531

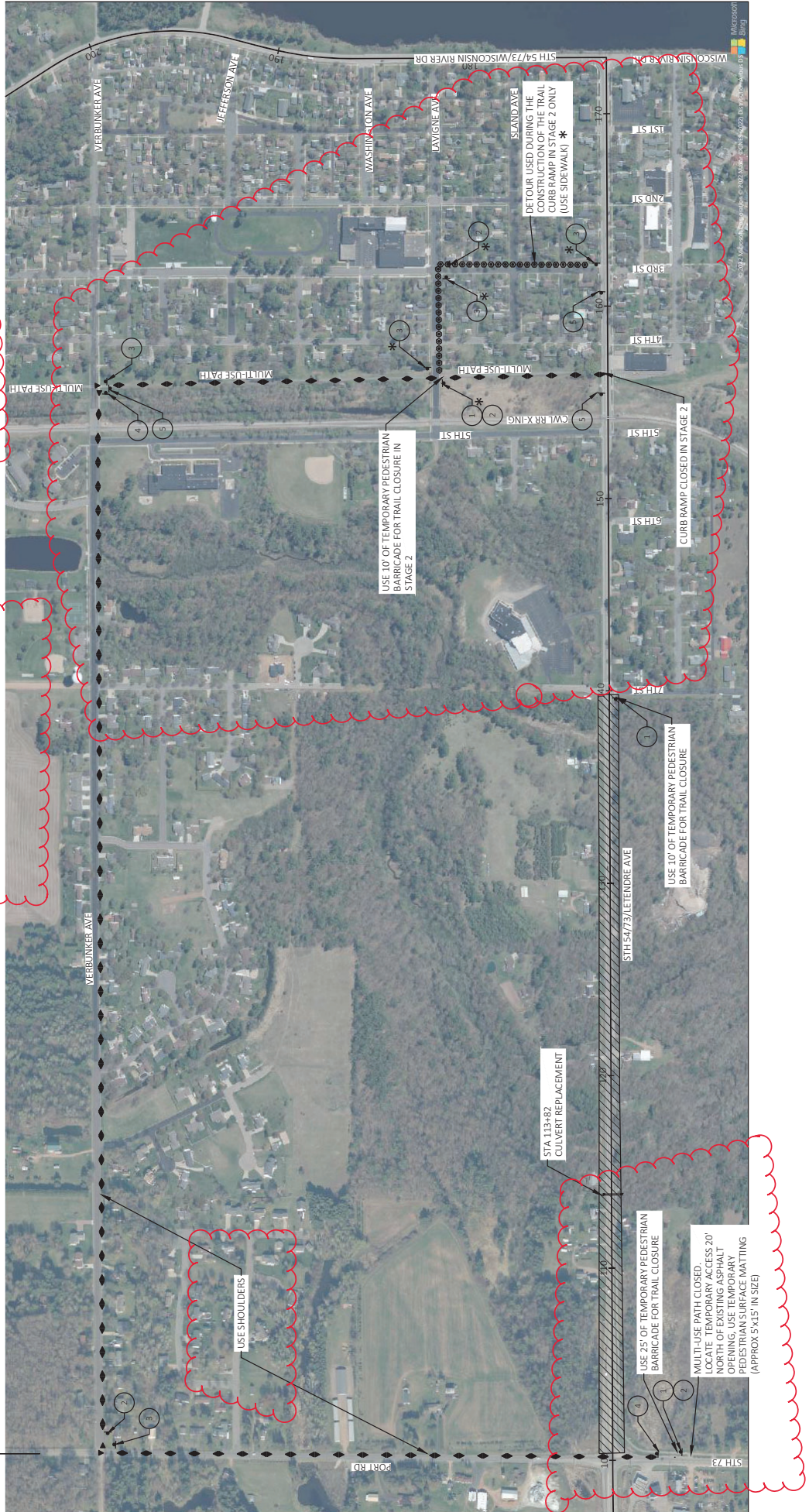

PROJECT NO: 6950-04-72

HWY: STH 54

COUNTY: WOOD

BICYCLE AND PEDESTRIAN DETOUR

SHEET 77

E

FILE NAME: I:\EVAL0878_STH54_27\GIS\SHETS\PLAN\027004-DT.DWG

LAYOUT NAME: 05-01

FLYBY: RESHEKE, CARRE

PLOT DATE: 2/7/2024 2:32 PM

PLOT SCALE: 1 IN=500 FT

WISDOT/CADDIS SHEET 42

TRAFFIC CONTROL SIGNS FIXED MESSAGE

LOCATION	MESSAGE	SIGN CODE	WxL (INCHES)	SIGN SIZE	TRAFFIC CONTROL SIGNS FIXED MESSAGE	SF
SEE DETOUR SHEETS FOR LOCATION	"ROAD OPEN TO SENECA RD"	R10-61	60x30	60x30	643-1000 TRAFFIC CONTROL SIGNS FIXED MESSAGE	32.00
SEE DETOUR SHEETS FOR LOCATION	"ROAD OPEN TO NEKOOSA"	R10-61	60x30	60x30		32.00
SEE DETOUR SHEETS FOR LOCATION	"HWY 54/73 CLOSED IN PORT EDWARDS"	R10-61	78x36	78x36		32.00
SEE DETOUR SHEETS FOR LOCATION	"HWY 54/73 CLOSED IN PORT EDWARDS"	R10-61	78x36	78x36		32.00
SEE DETOUR SHEETS FOR LOCATION	"ROAD OPEN TO HWY 54 WEST"	R10-61	60x30	60x30		32.00
SEE DETOUR SHEETS FOR LOCATION	"ROAD OPEN TO HWY 54 WEST"	R10-61	60x30	60x30		32.00
SEE DETOUR SHEETS FOR LOCATION	"TRAIL CLOSED ALONG HWY 54 AT 7TH ST"	R10-61	30x18	30x18		3.75
SEE DETOUR SHEETS FOR LOCATION	"TRAIL CLOSED ALONG HWY 54 AT 7TH ST"	R10-61	30x18	30x18		3.75
TOTAL 0010 260.25						

TRAFFIC CONTROL ITEMS

LOCATION	MESSAGE	SIGN CODE	WxL (INCHES)	SIGN SIZE	TRAFFIC CONTROL SIGNS COVERING SIGNS	CYCLES EACH
643-0420	643.0705	643.0900	643.0900	643.0920	TRAFFIC CONTROL SIGNS COVERING SIGNS	32
10	50	12	60	2	10	-
18	900	22	1100	48	2400	-
6	300	12	600	284	14200	32
TRAIL DETOUR DURING CULVERT WORK	-	-	-	11	55	-
TEMP PED ACCOMMODATIONS - STAGE 1	-	-	-	47	1175	-
TEMP PED ACCOMMODATIONS - STAGE 2	-	-	-	34	850	-
TOTAL 0010 1,250 1,760 3010 32						

FIELD OFFICE TYPE B

LOCATION	TYPE B	FIELD OFFICE TYPE B
642-5001	0.8	
TOTAL 0010 0.8		

TEMPORARY PEDESTRIAN ACCOMMODATION ITEMS

CURB RAMP #	LOCATION	TRAFFIC CONTROL DRUMS EACH DAY	TEMPORARY MARKING CROSSWALK REMOVABLE TAPE 6-INCH LF	TEMPORARY PEDESTRIAN SURFACE PLATE SF	TEMPORARY PEDESTRIAN SURFACE MATTING SF	TEMPORARY PEDESTRIAN CURB RAMP EACH DAY	TEMPORARY DETECTABLE WARNING FIELD SF	TEMPORARY PEDESTRIAN BARRICADE LF	REMARKS
	NORTH SIDE BETWEEN 7TH & 4TH	7	175	288			60	410	STAGE 1
	NORTH SIDE BETWEEN 5TH & TRAIL		93						STAGE 2
CR-1	SW QUAD 7TH/STH 54	10	250	80	64		20	43	STAGE 1
CR-2A/2B	SE QUAD 7TH/STH 54	13	325						STAGE 1
CR-3	NE QUAD 7TH/STH 54	10	250						STAGE 2
CR-4A/4B	SW QUAD 5TH/STH 54	12	300						STAGE 1
CR-5/RR1/RR2	SE QUAD 5TH/STH 54/RAILROAD	18	450						STAGE 1
CR-6	NORTH TRAIL (156+63)	8	200						STAGE 1
CR-7	SOUTH TRAIL (156+63)	9	225						STAGE 1
CR-7A/7B	NW QUAD 4TH/STH 54	12	300	40	33	1	25	10	STAGE 2
CR-8A/8B	SW QUAD 4TH/STH 54	14	350	42	35	30	1	25	STAGE 1
CR-8C	SE QUAD 4TH/STH 54	12	300	77	33	1	25	10	STAGE 2
CR-9	NW QUAD 3RD/STH 54	14	350	93	34	40	1	25	STAGE 2
CR-10	SW QUAD 3RD/STH 54	13	325	176	35	30	1	25	STAGE 1
CR-11A/11B	NE QUAD 3RD/STH 54	10	250	47	68	105	2	50	STAGE 1
CR-12A/12B	SE QUAD 3RD/STH 54	10	250	48	62	2	50	20	STAGE 2
CR-13A/13B	NW QUAD 2ND/STH 54	10	250	50	69	2	50	20	STAGE 1
CR-14A/14B	SW QUAD 2ND/STH 54	10	250	48	63	2	50	20	STAGE 2
CR-15	NE QUAD 2ND/STH 54	17	425	80	31	43	1	25	STAGE 2
CR-16	SE QUAD 2ND/STH 54	10	250	76	25	29	1	25	STAGE 1
CR-17A/17B	SW QUAD 1ST/STH 54	10	250	48	35	28	1	25	STAGE 2
CR-17C	SE QUAD 1ST/STH 54	10	250	70	25	29	1	25	STAGE 1
CR-18	SW QUAD WISCONSIN RIVER DR/STH 54	5	125		17	25	1	25	STAGE 1
CR-21	NW QUAD WISCONSIN RIVER DR/STH 54	5	125		13	138	1	25	STAGE 1
CR-22	SOUTH ISLAND AVE/STH 54	10	250	108	25	29	1	25	STAGE 1
CR-22A	NORTH ISLAND AVE/STH 54	10	250	100	21	29	1	25	STAGE 2
CR-23	SOUTH LAVIGNE AVE/STH 54	10	250	106	25	28	1	25	STAGE 1
CR-24	NORTH WASHINGTON AVE/STH 54	10	250	160	24	26	1	25	STAGE 2
CR-25	SOUTH WASHINGTON AVE/STH 54	10	250	160	25	25	1	25	STAGE 2
CR-26	SOUTH JEFFERSON AVE/STH 54	10	250	108	25	25	1	25	STAGE 2
CR-27	NORTH JEFFERSON AVE/STH 54	10	250	110	30	26	1	25	STAGE 1
CR-28	SOUTH MONROE AVE/STH 54	10	250	92	41	28	1	25	STAGE 1
CR-29	SOUTH JACKSON AVE/STH 54	38	950	104	62	26	2	50	STAGE 1
CR-30	NORTH JACKSON AVE/STH 54	10	250	76	40	26	1	25	STAGE 2
CR-31	NORTH 3RD ST/STH 54	13	325	79	49	165	1	25	STAGE 1
	BICYCLE AND PEDESTRIAN DETOUR				75				DETOUR
		9,750	2,559	957	1,327	775	384	3,538	
TOTAL 0010									

Addendum No. 01
ID 6950-04-72
Revised Sheet 91
February 6, 2024

ALL ITEMS ON THIS SHEET
ARE CATEGORY 0010
UNLESS OTHERWISE NOTED

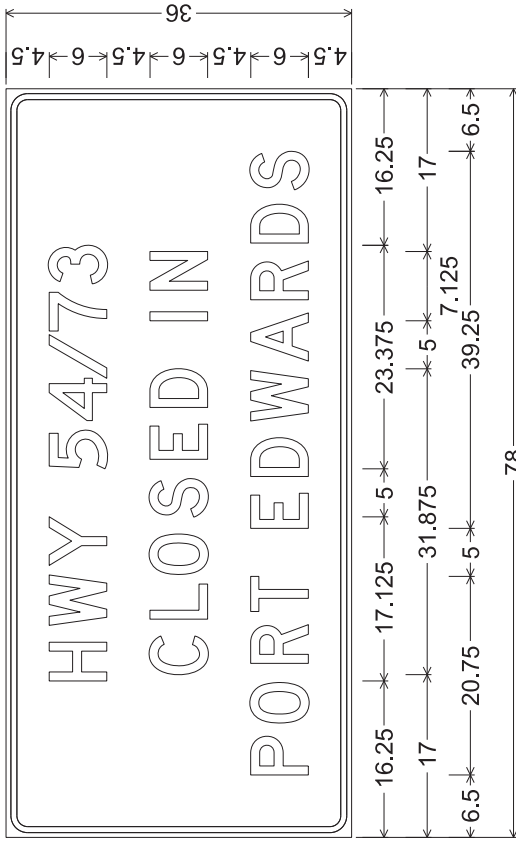

2.250" Radius, 0.625" Border, 0.500" Indent,
 "HWY", D; "54/73", D; "CLOSED", D; "IN", D; "PORT", D; "EDWARDS", D

NOTES

1. Fixed Message Signs Type II - Type F Reflective
2. Color:
 - Background - Orange
 - Message - Black
3. Message Series - C except as noted

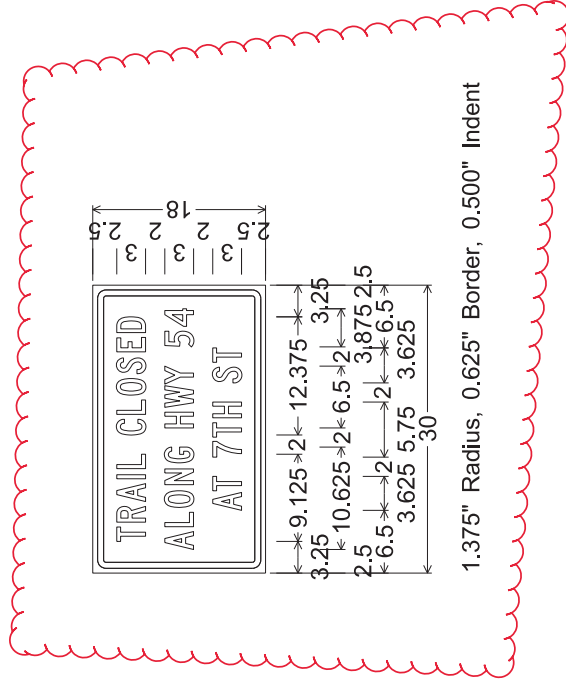

1.375" Radius, 0.625" Border, 0.500" Indent

Addendum No. 01
 ID 6950-04-72
 Revised Sheet 199
 February 6, 2024



Proposal Schedule of Items

Proposal ID: 20240213029 Project(s): 6950-04-72, 6950-04-73, 6950-04-82

Federal ID(s): N/A, N/A, N/A

SECTION: 0001 Contract Items

Alt Set ID: Alt Mbr ID:

Proposal Line Number	Item ID Description	Approximate Quantity and Units	Unit Price	Bid Amount
0154	643.0300 Traffic Control Drums	9,750.000 DAY	_____.	_____.
0156	643.0420 Traffic Control Barricades Type III	1,250.000 DAY	_____.	_____.
0158	643.0705 Traffic Control Warning Lights Type A	1,760.000 DAY	_____.	_____.
0160	643.0900 Traffic Control Signs	3,610.000 DAY	_____.	_____.
0162	643.0920 Traffic Control Covering Signs Type II	32.000 EACH	_____.	_____.
0164	643.1000 Traffic Control Signs Fixed Message	292.250 SF	_____.	_____.
0166	643.3165 Temporary Marking Line Paint 6-Inch	32,947.000 LF	_____.	_____.
0168	643.3350 Temporary Marking Crosswalk Removable Tape 6-inch	2,559.000 LF	_____.	_____.
0170	643.5000 Traffic Control	1.000 EACH	_____.	_____.
0172	644.1430 Temporary Pedestrian Surface Plate	957.000 SF	_____.	_____.
0174	644.1440 Temporary Pedestrian Surface Matting	1,327.000 SF	_____.	_____.
0176	644.1601 Temporary Pedestrian Curb Ramp	775.000 DAY	_____.	_____.
0178	644.1605 Temporary Pedestrian Detectable Warning Field	384.000 SF	_____.	_____.
0180	644.1810 Temporary Pedestrian Barricade	3,558.000 LF	_____.	_____.
0182	645.0120 Geotextile Type HR	40.000 SY	_____.	_____.
0184	646.1020 Marking Line Epoxy 4-Inch	694.000 LF	_____.	_____.

