



Wisconsin Department of Transportation

January 30, 2025

Division of Transportation Systems Development

Bureau of Project Development
4822 Madison Yards Way, 4th Floor South
Madison, WI 53705

Telephone: (608) 266-1631
Facsimile (FAX): (608) 266-8459

NOTICE TO ALL CONTRACTORS:

Proposal #02: 3060-00-74
C Columbus, Ludington Street
Faith Drive to Middleton Street
STH 73
Columbia County

Letting of February 11, 2025

This is Addendum No. 01, which provides for the following:

Schedule of Items:

Added Bid Item Quantities					
Bid Item	Item Description	Unit	Proposal Total Prior to Addendum	Quantity Added	Proposal Total After Addendum
205.0100	Excavation Common	CY	0	127	127

Plan Sheets:

Revised Plan Sheets	
Plan Sheet	Plan Sheet Title (brief description of changes to sheet)
12	Updated two notes to read <i>EXCAVATION IS INCIDENTAL TO THE CONCRETE SIDEWALK BID ITEM.</i>
122	Added MQ table for Excavation Common

Schedule of Items

Attached, dated January 30, 2025, are the revised Schedule of Items Page 7.

Plan Sheets

The following 8½ x 11-inch sheets are attached and made part of the plans for this proposal:

Revised: 12 and 122.

The responsibility for notifying potential subcontractors and suppliers of these changes remains with the prime contractor.

Sincerely,

Mike Coleman

Proposal Development Specialist
Proposal Management Section

END OF ADDENDUM

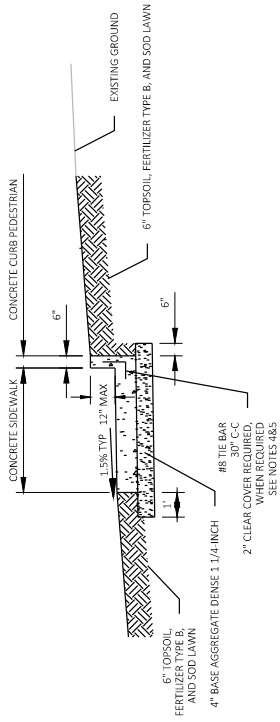

CONCRETE CURB PEDESTRIAN SECTION

- NOTES:
- EXCAVATION IS INCIDENTAL TO THE CONCRETE SIDEWALK BID ITEM.
 - PAYMENT FOR CONCRETE CURB PEDESTRIAN SHALL BE MADE USING THE BID ITEM CONCRETE CURB PEDESTRIAN.
 - THE HEIGHT OF THE CURB SHALL VARY BETWEEN 0 INCHES AND 12 INCHES BASED ON THE GRADES SHOWN ON THE CURB RAMP DETAILS.
 - WHEN THE HEIGHT OF THE PEDESTRIAN CURB IS GREATER THAN 6 INCHES IN HEIGHT THE CURB SHALL BE TIED MONOLITHICALLY WITH THE TIE BARS ARE INCIDENTAL TO THE CONCRETE CURB PEDESTRIAN.
 - WHEN THE HEIGHT OF THE PEDESTRIAN CURB IS 6 INCHES OR LESS IT MAY BE POURED MONOLITHICALLY WITH THE CONCRETE SIDEWALK OR POURED SEPARATELY. WHEN POURED SEPARATELY EXPANSION FELT IS REQUIRED BETWEEN THE CONCRETE SIDEWALK AND CONCRETE CURB PEDESTRIAN. TIE BARS ARE NOT REQUIRED WHEN THE HEIGHT OF THE PEDESTRIAN CURB IS 6 INCHES OR LESS.

Addendum No. 01
 ID 3060-00-74
 Revised Sheet 12
 January 30, 2025

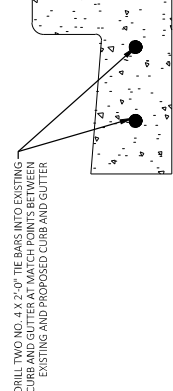

DRILLED TIE BARS AND CURB & GUTTER MATCH POINTS
 CONSTRUCT AT ALL LOCATIONS WHERE PROPOSED CURB & GUTTER MATCHES EXISTING CURB & GUTTER

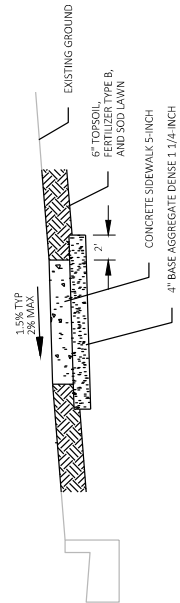

TYPICAL SIDEWALK SECTION

- NOTES:
- PAYMENT FOR CONCRETE SIDEWALK AND BASE AGGREGATE DENSE SHALL BE PAID FOR USING STANDARD BID ITEMS. EXCAVATION IS INCIDENTAL TO THE CONCRETE SIDEWALK BID ITEM.

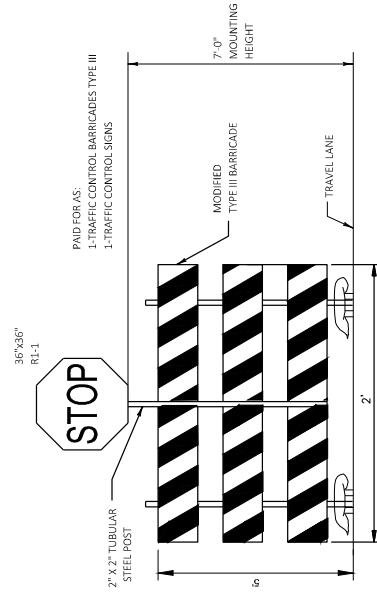

TEMPORARY STOP SIGN

Addendum No. 01
ID 3060-00-74
Revised Sheet 122
January 30, 2025

3

REMOVING CONCRETE

CATEGORY	STATION	TO	STATION	LOCATION	REMOVING CONCRETE CURB & GUTTER LF	REMOVING CONCRETE SIDEWALK SY
0010	63+02	-	65+00	STH 73	10	-
	65+00	-	71+00		200	73
	71+00	-	77+00		248	166
	77+00	-	83+00		75	36
	95+00	-	101+00		86	66
	101+00	-	107+00		304	203
	107+00	-	113+00		185	138
	113+00	-	119+00		149	116
	119+00	-	125+00		165	128
	131+00	-	133+75		144	71
TOTAL 0010					1,566	997
PROJECT TOTAL					1,566	997

GRUBBING

CATEGORY	STATION	TO	STATION	LOCATION	201.0205 GRUBBING STA
0010	106+00	-	107+00	STH 73	1
	120+00	-	121+00		1
TOTAL 0010					2
PROJECT TOTAL					2

REMOVING ASPHALTIC PAVEMENT

CATEGORY	STATION	TO	STATION	LOCATION	REMOVING ASPHALTIC SURFACE SY	REMOVING ASPHALTIC SURFACE BUTT JOINTS SY	REMOVING ASPHALTIC MILLING SY
0010	63+02	-	65+00	STH 73	3	111	694
	65+00	-	71+00		53	72	2592
	71+00	-	77+00		60	33	2600
	77+00	-	83+00		17	-	2168
	83+00	-	89+00		-	-	2200
	89+00	-	95+00		-	221	1905
	95+00	-	101+00		24	45	2627
	101+00	-	107+00		88	130	2860
	107+00	-	113+00		45	178	2460
	113+00	-	119+00		41	191	2169
	119+00	-	125+00		47	56	2269
	125+00	-	131+00		-	113	1609
	131+00	-	133+75		38	126	1124
TOTAL 0010					417	1,276	27,277
0020	63+02	-	65+00	STH 73	-	-	184
	65+00	-	71+00		-	-	436
	71+00	-	77+00		-	-	351
	77+00	-	83+00		-	-	511
	83+00	-	89+00		-	-	490
	89+00	-	95+00		-	-	377
	95+00	-	101+00		-	-	374
	101+00	-	107+00		-	-	342
	107+00	-	113+00		-	-	433
	113+00	-	119+00		-	-	394
	119+00	-	125+00		-	-	389
	125+00	-	131+00		-	-	371
	131+00	-	133+75		-	-	236
TOTAL 0020					0	0	4,898
PROJECT TOTAL					417	1,276	32,175

REMOVING BOULDER

CATEGORY	STATION	TO	STATION	LOCATION	REMOVING BOULDER EACH
0010	102+60	RT	STH 73		1
TOTAL 0010					1
PROJECT TOTAL					1

REMOVING FENCE

CATEGORY	STATION	TO	STATION	LOCATION	REMOVING FENCE LF
0010	102+57	-	102+62	LT	11
TOTAL 0010					11
PROJECT TOTAL					11

EXCAVATION COMMON

CATEGORY	STATION	TO	STATION	LOCATION	EXCAVATION COMMON CY
0010	119+00	-	125+00	STH 73	127
TOTAL 0010					127
PROJECT TOTAL					127

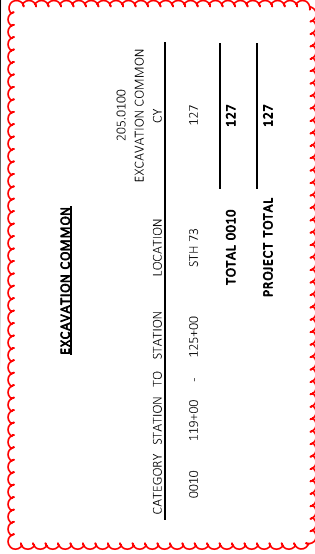

BASE AGGREGATE DENSE

CATEGORY	STATION	TO	STATION	LOCATION	BASE AGGREGATE DENSE 1 1/4-INCH TON
0010	63+02	-	65+00	STH 73	1
	65+00	-	71+00		51
	71+00	-	77+00		78
	77+00	-	83+00		22
	95+00	-	101+00		24
	101+00	-	107+00		103
	107+00	-	113+00		54
	113+00	-	119+00		50
	119+00	-	125+00		223
	131+00	-	133+75		38
TOTAL 0010					644
PROJECT TOTAL					644

PROJECT NO: 3060-00-74

HWY: STH 73

COUNTY: COLUMBIA

MISCELLANEOUS QUANTITIES

SHEET NO: 122

E

FILE NAME : T:\1212709\Civil\306000\4\Sheets\Plan\030201_mrg.dpt

PLOT DATE : 1/29/2025 11:49 AM

PLOT NAME : 030201_mrg

PLOT SCALE : 1:400000=1:000000

WISDOT/CADDSS SHEET 42

3



Proposal Schedule of Items

Proposal ID: 20250211002 Project(s): 3060-00-74

Federal ID(s): N/A

SECTION: 0001 Contract Items

Alt Set ID: Alt Mbr ID:

Proposal Line Number	Item ID Description	Approximate Quantity and Units	Unit Price	Bid Amount
0182	205.0100 Excavation Common	127.000 CY	_____.	_____.
		Section: 0001	Total:	_____.
			Total Bid:	_____.

