



Wisconsin Department of Transportation

Division of Transportation Systems Development

Bureau of Project Development
4822 Madison Yards Way, 4th Floor South
Madison, WI 53705

January 29, 2025

Telephone: (608) 266-1631
Facsimile (FAX): (608) 266-8459

NOTICE TO ALL CONTRACTORS:

Proposal #27: 1130-67-71, WISC 2025324
Appleton – De Pere
I-41 Mnln, CTH JJ – Miners Way TMP
IH 41
Outagamie/Brown Counties

Letting of February 11, 2025

This is Addendum No. 02, which provides for the following:

Schedule of Items:

Revised Bid Item Quantities					
Bid Item	Item Description	Unit	Proposal Total Prior to Addendum	Proposal Quantity Change (-)	Proposal Total After Addendum
608.0418	Storm Sewer Pipe Reinforced Concrete Class IV 18-Inch	LF	489	-2	487
608.0424	Storm Sewer Pipe Reinforced Concrete Class IV 24-Inch	LF	1,513	-122	1,391
SPV.0060.01	Cover Plates	EA	52	3	55

Added Bid Item Quantities					
Bid Item	Item Description	Unit	Proposal Total Prior to Addendum	Quantity Added	Proposal Total After Addendum
611.3003	Inlets 3-FT Diameter	EA	0	3	3

Plan Sheets:

Revised Plan Sheets	
Plan Sheet	Plan Sheet Title (brief description of changes to sheet)
66	New structure and structure locations – plan view
67	New structure and structure locations – profile view
68	New structure and structure locations – plan view
69	New structure and structure locations – profile view
160	Updated Miscellaneous Quantities table with new and revised structures
161	Updated Miscellaneous Quantities table with new structures

162	Updated Miscellaneous Quantities table with revised storm sewer pipe quantities, and stage 2 pipes removed and shown elsewhere.
164	Updated Miscellaneous Quantities table with revised cover plate quantities

Added Plan Sheets	
Plan Sheet	Plan Sheet Title (brief description of why sheet was added)
162A	Miscellaneous quantities table with stage 2 storm sewer pipe quantities

Schedule of Items

Attached, dated January 29, 2025, are the revised Schedule of Items Pages 3, 8, and 9.

Plan Sheets

The following 8½ x 11-inch sheets are attached and made part of the plans for this proposal:

Revised: 66-69, 160-162, 164.

Added: 162A.

The responsibility for notifying potential subcontractors and suppliers of these changes remains with the prime contractor.

Sincerely,

Mike Coleman

Proposal Development Specialist
 Proposal Management Section

END OF ADDENDUM

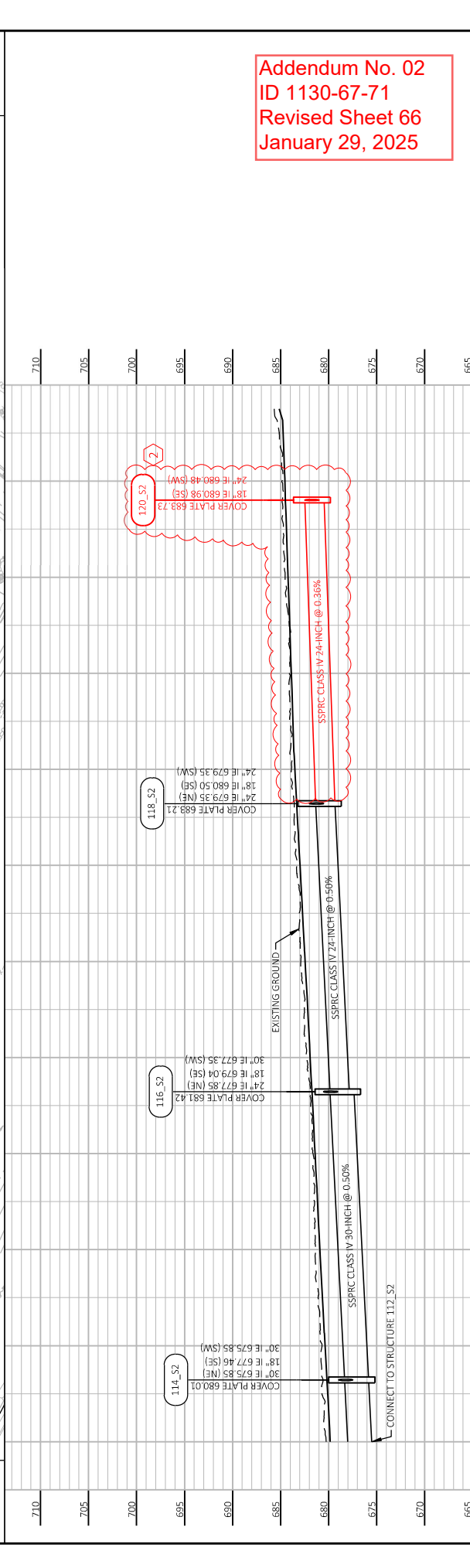
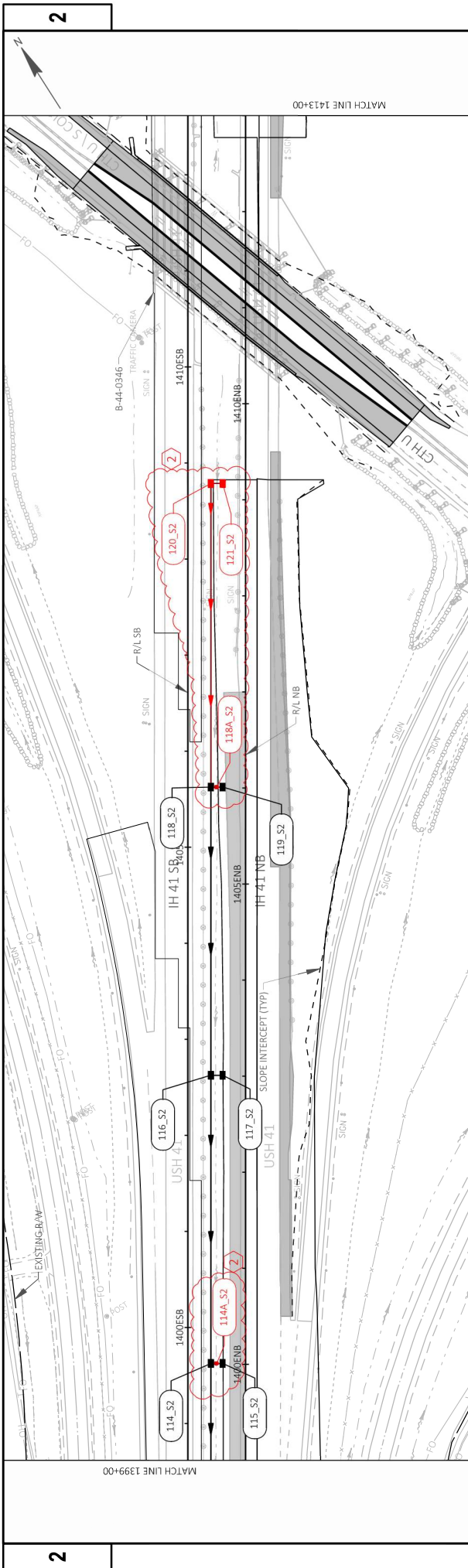

Addendum No. 02
ID 1130-67-71
Revised Sheet 66
January 29, 2025

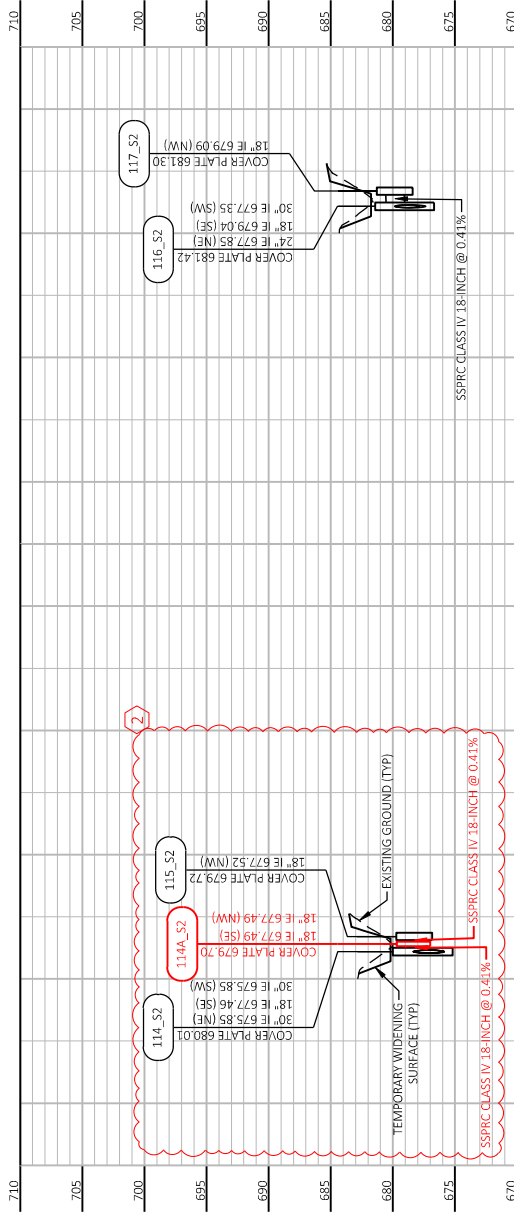

Addendum No. 02
 ID 1130-67-71
 Revised Sheet 67
 January 29, 2025

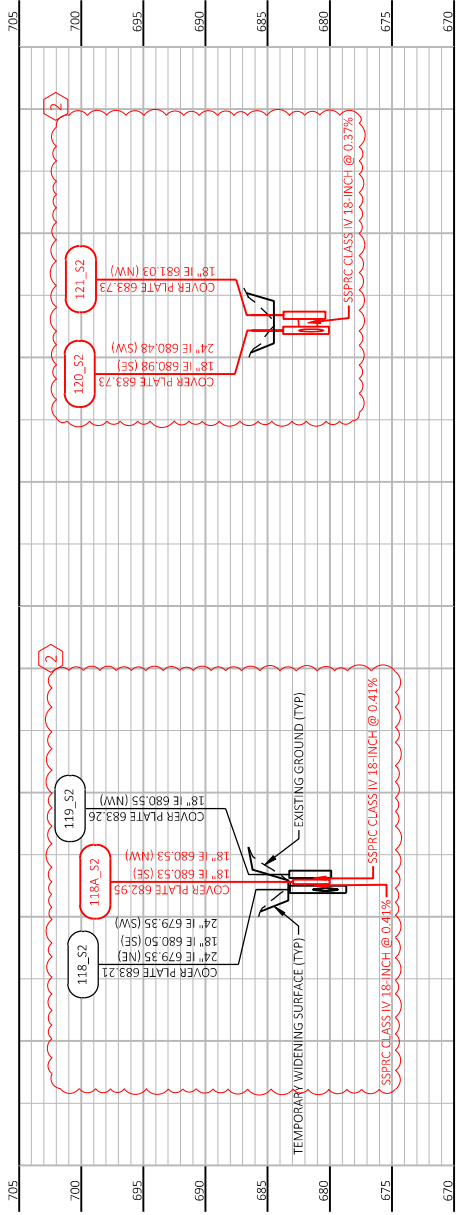

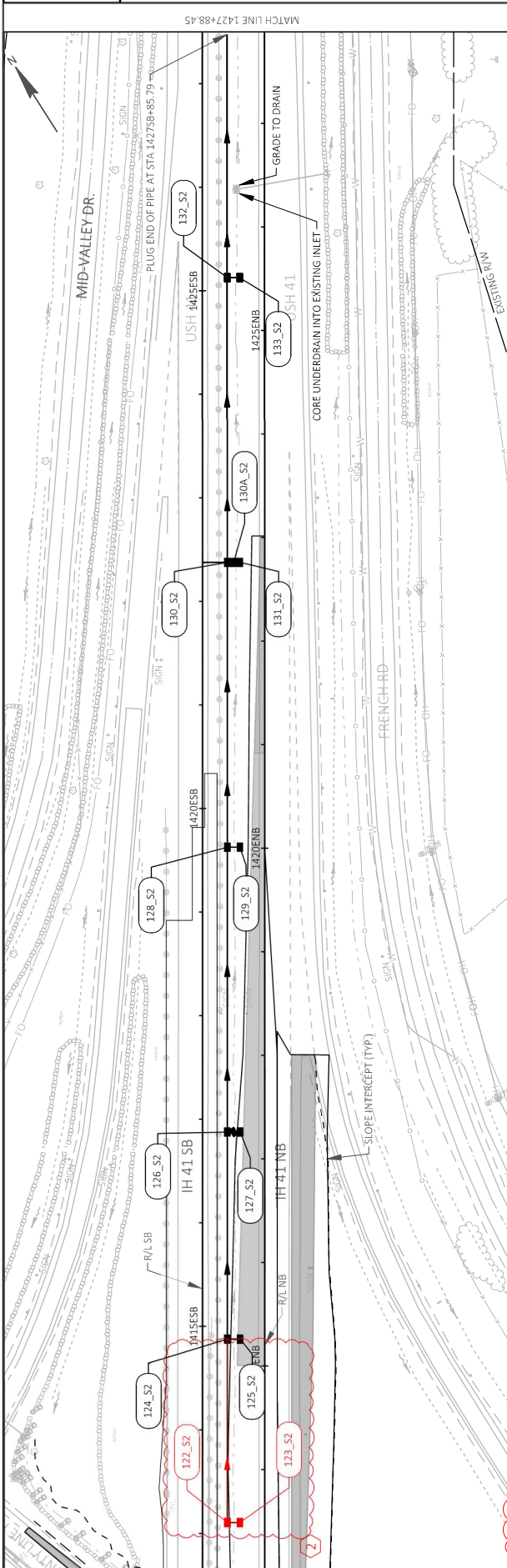

Addendum No. 02
ID 1130-67-71
Revised Sheet 68
January 29, 2025

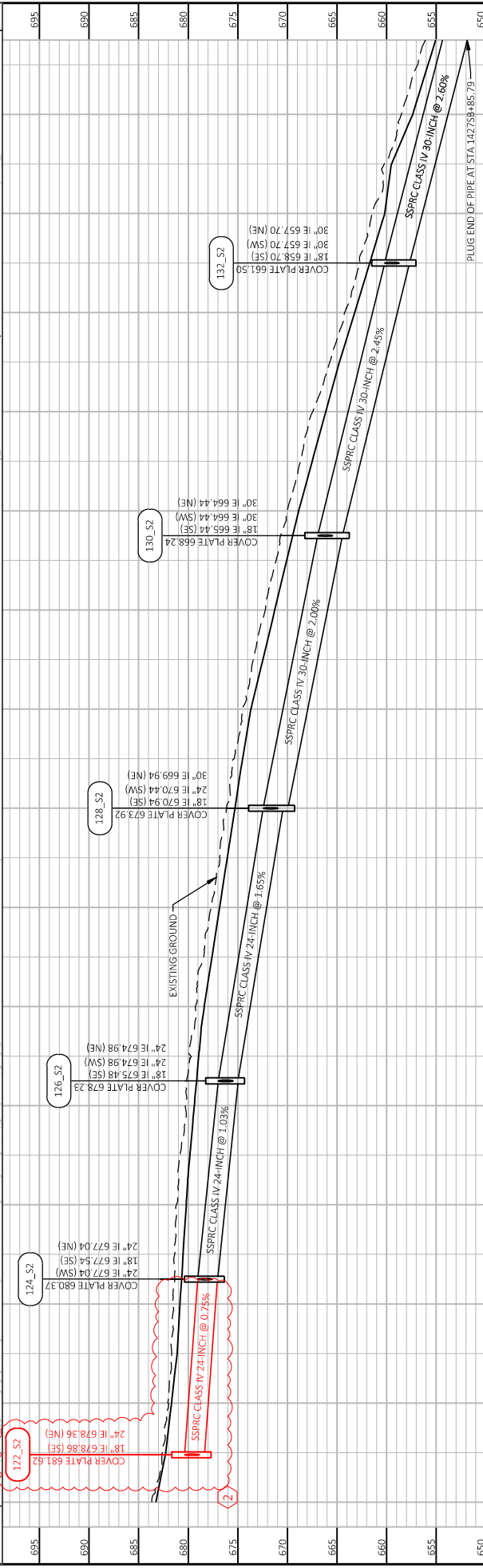

PROJECT NO: 1130-67-71	COUNTY: OUTAGAMIE & BROWN	SHEET: 68
FILE NAME: C:\USERS\BERBERD\CADD\CS\WBSD01\11306701\PROJECT FILES\056\11306770\SHETS\1130-67-71\022803_SS.DWG	PLOT BY: ELIZABETH REGER	PLOT SCALE: 1 IN=100 FT
LAYOUT NAME: 008	PLOT DATE: 1/24/2025 9:56 AM	W:\007\CADD\05 SHEET 41

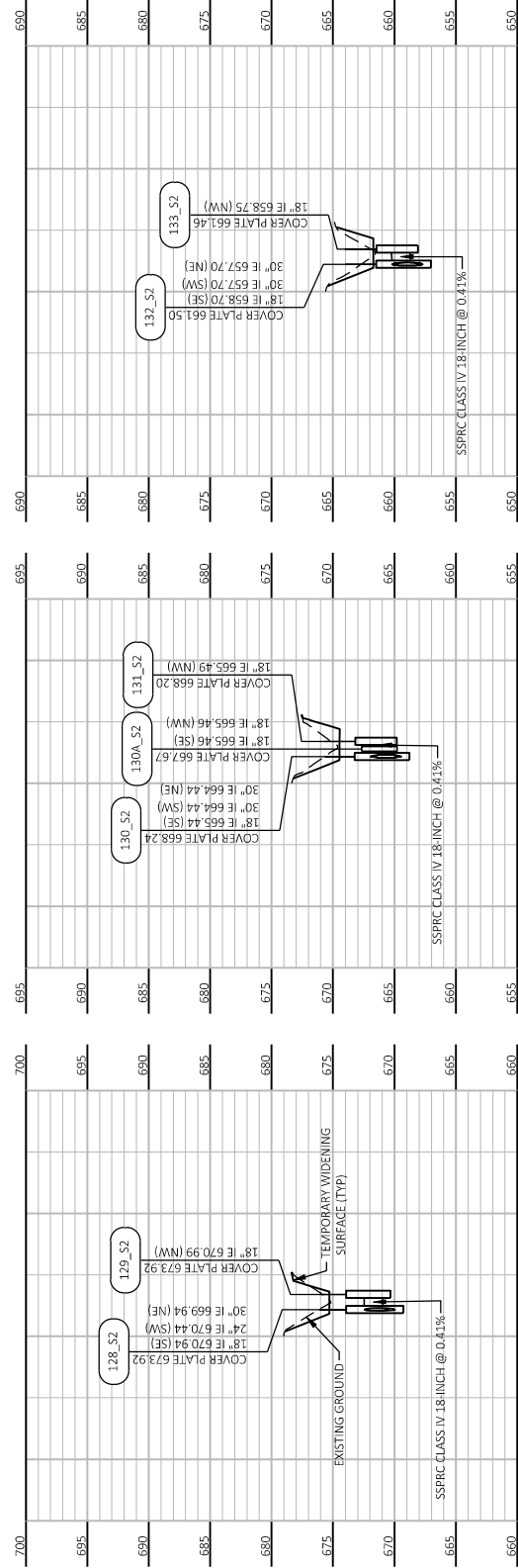
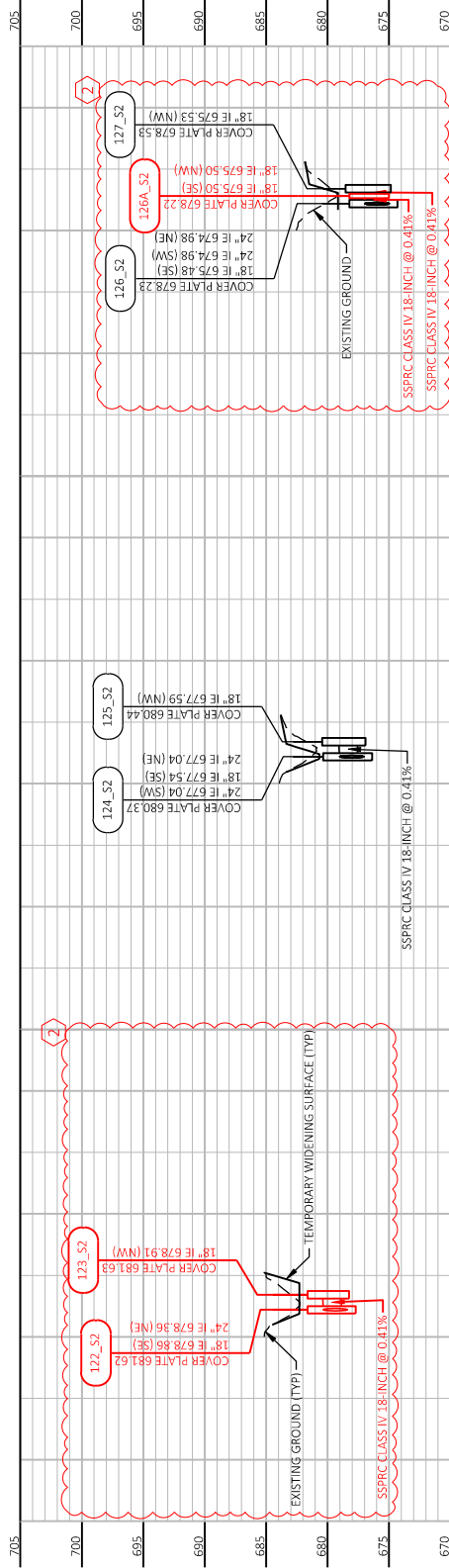

Addendum No. 02
 ID 1130-67-71
 Revised Sheet 69
 January 29, 2025

STORM SEWER STRUCTURES

611.0530 611.0545 611.0606 611.0642 611.2004 611.2005 611.2006 611.2007

CATEGORY	LOCATION	STRUCTURE	STATION	OFFSET	RIM ELEVATION	INVERT ELEVATION	DEPTH FT	MANHOLE COVERS		INLET COVERS		MANHOLES			
								TYPE J	TYPE L	TYPE B	TYPE MS	4-FT DIAMETER	5-FT DIAMETER	6-FT DIAMETER	7-FT DIAMETER
								EACH	EACH	EACH	EACH	EACH	EACH	EACH	
1000	1130-67-71	STAGE 1													
RILESB	100_S1	1243+75.91	6.01 RT		705.34	699.83	4.39			1					
RILESB	100B_S1	1244+23.02	31.98 RT		700.34	697.34	2.60			1					
RILENB	100C_S1	1226+89.46	31.29 LT		696.91	692.40	4.72			2					
RILENB	100D_S1	1219+50.00	31.48 LT		689.65	686.45	3.41			2					
RILENB	104A_S1	1305+72.44	74.10 RT		698.85	695.39	2.84			1					
RILENB	105_S1	1309+56.74	64.41 RT		691.21	688.46	3.00			2					
RILENB	107_S1	1386+61.71	74.88 RT		674.42	671.61	3.12			2					
RILENB	108_S1	1386+58.95	83.44 RT		675.94	671.58	3.82			1					
RILENB	109_S1	1388+80.84	72.74 RT		674.47	672.25	2.44			2					
RILENB	141_S1	1474+33.93	25.50 LT		685.47	683.35	2.31			1					
RILENB	146_S1	1486+25.00	34.52 LT		690.28	686.67	3.61			1					
RILENB	1007A_S1	1466+62.23	31.00 RT		679.32	674.45	3.92			1					
STAGE 1 SUBTOTALS								1	2	2	12	1	0	1	1
1130-67-71 STAGE 2															
RILENB	103A_S2	1279+51.73	11.79 LT		689.63	684.13	4.51			1					
RILENB	110_S2	1394+01.26	36.74 LT		676.35	672.35	4.33							1	
RILENB	111_S2	1394+01.15	24.48 LT		676.11	673.90	2.42							1	
RILENB	112_S2	1397+00.95	36.13 LT		678.18	673.85	4.66							1	
RILENB	113_S2	1397+00.95	23.87 LT		678.11	675.40	2.92							1	
RILENB	114_S2	1400+00.95	36.13 LT		680.01	675.85	4.49							1	
RILENB	114A_S2	1400+00.95	30.00 LT		679.70	677.49	2.42							1	
RILENB	115_S2	1400+00.95	23.87 LT		679.72	677.52	2.41							1	
RILENB	116_S2	1403+00.95	36.13 LT		681.42	677.35	4.40							1	
RILENB	117_S2	1403+00.95	23.87 LT		681.30	679.09	2.41							1	
RILENB	118_S2	1406+00.95	36.13 LT		683.21	679.35	4.11							1	
RILENB	118A_S2	1406+00.95	30.00 LT		682.95	680.53	2.63							1	
RILENB	119_S2	1406+00.95	23.87 LT		683.26	680.55	2.92							1	
RILENB	120_S2	1409+16.97	36.13 LT		683.73	680.48	3.50							1	
RILENB	121_S2	1409+16.97	23.87 LT		683.73	681.03	2.91							1	
RILENB	122_S2	1413+48.87	36.13 LT		681.62	678.36	3.51							1	
RILENB	123_S2	1413+48.88	23.87 LT		681.63	678.91	2.93							1	
RILENB	124_S2	1415+25.95	36.13 LT		680.37	677.04	3.58							1	
RILENB	125_S2	1415+25.95	23.87 LT		680.44	677.59	3.06							1	
RILENB	126_S2	1417+25.95	36.13 LT		678.23	674.98	3.50							1	
RILENB	126A_S2	1417+25.95	30.00 LT		678.22	675.50	2.93							1	
RILENB	127_S2	1417+25.95	23.87 LT		678.53	675.53	3.21							1	
RILENB	128_S2	1420+00.95	36.13 LT		673.92	669.94	4.27							1	
RILENB	129_S2	1420+00.95	23.87 LT		673.92	670.99	3.14							1	
RILENB	130_S2	1422+75.95	36.13 LT		688.24	684.44	4.09							1	
RILENB	130A_S2	1422+75.95	30.00 LT		687.67	685.46	2.21			2					
RILENB	131_S2	1422+75.95	23.87 LT		688.20	685.49	2.92							1	
RILENB	132_S2	1425+50.95	36.13 LT		661.50	657.70	4.09							1	
RILENB	133_S2	1425+50.95	23.87 LT		661.46	658.75	2.92							1	
STAGE 2 SUBTOTALS								1	0	0	2	0	23	2	0
1130-67-71 TOTALS															
								2	2	2	14	1	23	3	1

Addendum No. 02
 ID 1130-67-71
 Revised Sheet 160
 January 29, 2025

Addendum No. 02
ID 1130-67-71
Revised Sheet 161
January 29, 2025

STORM SEWER STRUCTURES

611.3004 611.3901 611.3902

CATEGORY	LOCATION	STRUCTURE	611.3003		INLETS		COMMENTS
			3-FT DIAMETER EACH	4-FT DIAMETER EACH	MEDIAN 1 GRATE EACH	MEDIAN 2 GRATE EACH	
1000	1130-67-71	STAGE 1	2	1	--	--	
		R/LESB 100_S1	--	1	--	--	
		R/LESB 100B_S1	--	1	--	--	1 SLOPE
		R/LENB 100C_S1	--	--	--	--	2 SLOPE
		R/LENB 100D_S1	--	--	--	1	
		R/LENB 104A_S1	--	--	--	--	
		R/LENB 105_S1	--	--	--	1	2 SLOPE
		R/LENB 107_S1	--	--	--	1	2 SLOPE
		R/LENB 108_S1	--	--	--	--	
		R/LENB 109_S1	--	--	--	1	2 SLOPE
		R/LENB 141_S1	--	1	--	--	1 SLOPE
		R/LENB 146_S1	--	1	--	--	1 SLOPE
		R/LENB 1007A_S1	--	--	--	--	
			0	2	2	5	
		1130-67-71 STAGE 2					
		R/LENB 103A_S2	--	--	--	--	COVER PLATE; TO BE COMPLETED IN 1130-67-72
		R/LENB 110_S2	--	--	--	--	COVER PLATE; TO BE COMPLETED IN 1130-67-72
		R/LENB 111_S2	--	--	--	--	COVER PLATE; TO BE COMPLETED IN 1130-67-72
		R/LENB 112_S2	--	--	--	--	COVER PLATE; TO BE COMPLETED IN 1130-67-72
		R/LENB 113_S2	--	--	--	--	COVER PLATE; TO BE COMPLETED IN 1130-67-72
		R/LENB 114_S2	--	--	--	--	COVER PLATE; TO BE COMPLETED IN 1130-67-72
		R/LENB 114A_S2	1	--	--	--	COVER PLATE; TO BE COMPLETED IN 1130-67-72
		R/LENB 115_S2	--	--	--	--	COVER PLATE; TO BE COMPLETED IN 1130-67-72
		R/LENB 116_S2	--	--	--	--	COVER PLATE; TO BE COMPLETED IN 1130-67-72
		R/LENB 117_S2	--	--	--	--	COVER PLATE; TO BE COMPLETED IN 1130-67-72
		R/LENB 118_S2	--	--	--	--	COVER PLATE; TO BE COMPLETED IN 1130-67-72
		R/LENB 118A_S2	1	--	--	--	COVER PLATE; TO BE COMPLETED IN 1130-67-72
		R/LENB 119_S2	--	--	--	--	COVER PLATE; TO BE COMPLETED IN 1130-67-72
		R/LENB 120_S2	--	--	--	--	COVER PLATE; TO BE COMPLETED IN 1130-67-72
		R/LENB 121_S2	--	--	--	--	COVER PLATE; TO BE COMPLETED IN 1130-67-72
		R/LENB 122_S2	--	--	--	--	COVER PLATE; TO BE COMPLETED IN 1130-67-72
		R/LENB 123_S2	--	--	--	--	COVER PLATE; TO BE COMPLETED IN 1130-67-72
		R/LENB 124_S2	--	--	--	--	COVER PLATE; TO BE COMPLETED IN 1130-67-72
		R/LENB 125_S2	--	--	--	--	COVER PLATE; TO BE COMPLETED IN 1130-67-72
		R/LENB 126_S2	--	--	--	--	COVER PLATE; TO BE COMPLETED IN 1130-67-72
		R/LENB 126A_S2	1	--	--	--	COVER PLATE; TO BE COMPLETED IN 1130-67-72
		R/LENB 127_S2	--	--	--	--	COVER PLATE; TO BE COMPLETED IN 1130-67-72
		R/LENB 128_S2	--	--	--	--	COVER PLATE; TO BE COMPLETED IN 1130-67-72
		R/LENB 129_S2	--	--	--	--	COVER PLATE; TO BE COMPLETED IN 1130-67-72
		R/LENB 130_S2	--	--	--	--	COVER PLATE; TO BE COMPLETED IN 1130-67-72
		R/LENB 130A_S2	--	--	--	1	COVER PLATE; 2 SLOPE
		R/LENB 131_S2	--	--	--	--	COVER PLATE; TO BE COMPLETED IN 1130-67-72
		R/LENB 132_S2	--	--	--	--	COVER PLATE; TO BE COMPLETED IN 1130-67-72
		R/LENB 133_S2	--	--	--	--	COVER PLATE; TO BE COMPLETED IN 1130-67-72
		STAGE 2 SUBTOTALS	3	0	0	1	
		1130-67-71 TOTALS	3	2	2	6	

STORM SEWER PIPES

CATEGORY	FROM	TO	INLET ELEVATION	DISCHARGE ELEVATION	SLOPE FT/FT	522.0418		608.0418		608.0430		608.0436		608.2314		608.2324		COMMENTS
						18-INCH CONCRETE CLASS IV	15-INCH	18-INCH	24-INCH	30-INCH	36-INCH	14X23-INCH	24X38-INCH					
1000	1130-67-71 STAGE 1																	
	100_S1	100A_S1	699.30	699.30	0.0100	--	--	53	--	--	--	--	--	--	--	--	--	
	100B_S1	100_S1	700.34	700.08	0.0048	--	54	--	--	--	--	--	--	--	--	--	--	
	100C_S1	RS_01	692.40	692.20	0.0208	--	--	9	--	--	--	--	--	--	--	--	--	
	100D_S1	EX_1	686.45	686.09	0.0250	--	--	14	--	--	--	--	--	--	--	--	--	
	101_S1	RS_02	683.86	683.56	0.0127	--	--	--	8	--	--	--	--	--	--	--	--	
	102_S1	RS_03	684.79	684.67	0.0097	--	--	--	12	--	--	--	--	--	--	--	--	
	104A_S1	104_S1	695.39	694.79	0.0074	--	--	81	--	--	--	--	--	--	--	--	--	
	105_S1	RS_05	688.46	688.38	0.0030	--	--	--	28	--	--	--	--	--	--	--	--	
	106_S1	RS_06	681.13	680.51	0.0692	--	--	--	12	--	--	--	--	--	--	--	--	
	107_S1	108_S1	671.61	671.58	0.0030	--	--	--	--	--	--	--	--	--	--	9	--	
	108_S1	RS_09	671.58	671.55	0.0030	--	--	--	--	11	--	--	--	--	--	--	--	
	109_S1	108_S1	672.25	671.58	0.0030	--	--	--	--	--	--	--	222	--	--	--	--	
	141_S1	140_S1	683.35	683.16	0.0030	--	63	--	--	--	--	--	--	--	--	--	--	
	146_S1	EX_01	686.67	686.00	0.0050	--	--	133	--	--	--	--	--	--	--	--	--	
	1007A_S1	RS_10	674.45	674.33	0.0106	--	--	--	11	--	--	--	--	--	--	--	--	
	1007B_S1	1007A_S1	674.94	674.45	0.0054	--	--	--	--	91	--	--	--	--	--	--	--	
	1007C_S1	1007A_S1	675.94	675.45	0.0114	--	--	43	--	--	--	--	--	--	--	--	--	
	104L_S1	1040_S1	676.37	675.63	0.0164	--	45	--	--	--	--	--	--	--	--	--	--	
	RS_04	104A_S1	695.47	695.39	0.0074	--	--	10	--	--	--	--	--	--	--	--	--	
	RS_08	107_S1	671.79	671.61	0.0110	--	--	--	16	--	--	--	--	--	--	--	--	
						45	117	343	87	102	222	0	222	9				
						STAGE 1 SUBTOTALS												

Addendum No. 02
 ID 1130-67-71
 Revised Sheet 162
 January 29, 2025

STAGE 2 PIPES MOVED TO PAGE 162A

Addendum No. 02
 ID 1130-67-71
 Added Sheet 162A
 January 29, 2025

3

3

STORM SEWER PIPES

CATEGORY	FROM	TO	INLET ELEVATION	DISCHARGE ELEVATION	SLOPE	FT/FT	18-INCH		24-INCH		30-INCH		36-INCH		14X23-INCH		24X38-INCH		COMMENTS	
							LF	LF	LF	LF	LF	LF	LF	LF	LF	LF				
1000	1130-67-71 STAGE 2																			
	103A_S2	103_S2	664.13	663.99	0.0073		--	--	20	--	--	--	--	--	--	--	--	--		
	103B_S2	RS_13	663.50	663.46	0.0040		--	--	6	--	--	--	--	--	--	--	--	--		
	110_S2	PLUG_01	672.35	672.29	0.0050		--	--		12	--	11	--	--	--	--	--	--		
	111_S2	110_S2	673.90	673.85	0.0041		--	--		12	--	--	--	--	--	--	--	--		
	112_S2	110_S2	673.85	672.35	0.0050		--	--			--	--	300	--	--	--	--	--		
	113_S2	112_S2	675.40	675.35	0.0041		--	--		12	--	--	--	--	--	--	--	--		
	114_S2	112_S2	675.85	674.35	0.0050		--	--			--	--	300	--	--	--	--	--		
	114A_S1	114_S2	677.49	677.47	0.0041		--	--	6	--	--	--	--	--	--	--	--	--		
	115_S2	114A_S1	677.52	677.49	0.0041		--	--	6	--	--	--	--	--	--	--	--	--		
	116_S2	114_S2	677.35	675.85	0.0050		--	--			--	--	300	--	--	--	--	--		
	117_S2	116_S2	679.09	679.04	0.0041		--	--		12	--	--	--	--	--	--	--	--		
	118_S2	116_S2	679.35	677.85	0.0050		--	--			--	--	300	--	--	--	--	--		
	118A_S2	118_S2	680.53	680.50	0.0041		--	--	6	--	--	--	--	--	--	--	--	--		
	119_S2	118A_S2	680.55	680.53	0.0041		--	--	6	--	--	--	--	--	--	--	--	--		
	120_S2	118_S2	680.48	679.35	0.0036		--	--			--	--	316	--	--	--	--	--		
	121_S2	120_S2	681.03	680.98	0.0037		--	--		12	--	--	2	--	--	--	--	--		
	122_S2	124_S2	678.36	677.04	0.0075		--	--		2	--	--	177	--	--	--	--	--		
	123_S2	122_S2	678.91	678.86	0.0041		--	--		12	--	--	2	--	--	--	--	--		
	124_S2	126_S2	677.04	674.98	0.0103		--	--			--	--	200	--	--	--	--	--		
	125_S2	124_S2	677.59	677.54	0.0041		--	--		12	--	--	--	--	--	--	--	--		
	126_S2	128_S2	674.98	670.44	0.0165		--	--			--	--	275	--	--	--	--	--		
	126A_S2	126_S2	675.50	675.48	0.0041		--	--	6	--	--	--	--	--	--	--	--	--		
	127_S2	126A_S2	675.53	675.50	0.0041		--	--	6	--	--	--	--	--	--	--	--	--		
	128_S2	130_S2	669.94	664.44	0.0200		--	--			--	--	275	--	--	--	--	--		
	129_S2	128_S2	670.99	670.94	0.0041		--	--		12	--	--	--	--	--	--	--	--		
	130_S2	132_S2	664.44	657.70	0.0245		--	--			--	--	275	--	--	--	--	--		
	131_S2	130A_S2	665.49	665.46	0.0041		--	--		6	--	--	--	--	--	--	--	--		
	130A_S2	130_S2	665.46	665.44	0.0041		--	--		6	--	--	--	--	--	--	--	--		
	132_S2	PLUG_02	657.70	651.59	0.0260		--	--			--	--	235	--	--	--	--	--		
	133_S2	132_S2	658.75	658.70	0.0041		--	--		12	--	--	--	--	--	--	--	--		
	RS_12	103A_S2	664.21	684.13	0.7300		--	--			--	--	10	--	--	--	--	--		
			0				0	144	1304	2	311	0	0	0	0	0	0	0		
			45				117	487	1391	2	1487	222	9							
			1130-67-71 TOTALS																	

TO STA/OFF: 1393ENB+90.26, 36.86' LT

TO STA/OFF: 1427ENB+85.79, 36.13' LT

COVER PLATES

SPV.0060.01

COVER

PLATES

CATEGORY	ROADWAY	STRUCTURE ID	EACH	NOTES
1000	1130-67-71	STAGE 1		
	R/L ENB	EX.51	2	
	STAGE 1 SUBTOTALS			2
1000	1130-67-71	STAGE 2		
	R/L ENB	110_S2	2	
	R/L ENB	111_S2	2	
	R/L ENB	112_S2	2	
	R/L ENB	113_S2	2	
	R/L ENB	114_S2	2	
	R/L ENB	114A_S2	1	
	R/L ENB	115_S2	2	
	R/L ENB	116_S2	2	
	R/L ENB	117_S2	2	
	R/L ENB	118_S2	2	
	R/L ENB	118A_S2	1	
	R/L ENB	119_S2	2	
	R/L ENB	120_S2	2	
	R/L ENB	121_S2	2	
	R/L ENB	122_S2	2	
	R/L ENB	123_S2	2	
	R/L ENB	124_S2	2	
	R/L ENB	125_S2	2	
	R/L ENB	126_S2	2	
	R/L ENB	126A_S2	1	
	R/L ENB	127_S2	2	
	R/L ENB	128_S2	2	
	R/L ENB	129_S2	2	
	R/L ENB	130_S2	2	
	R/L ENB	130A_S3	2	
	R/L ENB	131_S2	2	
	R/L ENB	132_S2	2	
	R/L ENB	133_S2	2	
	STAGE 2 SUBTOTALS			53
	1130-67-71 TOTALS			55

Addendum No. 02
 ID 1130-67-71
 Revised Sheet 164
 January 29, 2025



Proposal Schedule of Items

Proposal ID: 20250211027 Project(s): 1130-67-71

Federal ID(s): WISC 2025324

SECTION: 0001 Contract Items

Alt Set ID: Alt Mbr ID:

Proposal Line Number	Item ID Description	Approximate Quantity and Units	Unit Price	Bid Amount
0058	601.0405 Concrete Curb & Gutter 18-Inch Type A	850.000 LF	_____.	_____.
0060	601.0409 Concrete Curb & Gutter 30-Inch Type A	410.000 LF	_____.	_____.
0062	603.8000 Concrete Barrier Temporary Precast Delivered	70,583.000 LF	_____.	_____.
0064	603.8125 Concrete Barrier Temporary Precast Installed	74,373.000 LF	_____.	_____.
0066	603.8500 Anchoring Concrete Barrier Temporary Precast	1,345.000 LF	_____.	_____.
0068	606.0200 Riprap Medium	35.000 CY	_____.	_____.
0070	608.0412 Storm Sewer Pipe Reinforced Concrete Class IV 12-Inch	14.000 LF	_____.	_____.
0072	608.0415 Storm Sewer Pipe Reinforced Concrete Class IV 15-Inch	117.000 LF	_____.	_____.
0074	608.0418 Storm Sewer Pipe Reinforced Concrete Class IV 18-Inch	487.000 LF	_____.	_____.
0076	608.0424 Storm Sewer Pipe Reinforced Concrete Class IV 24-Inch	1,391.000 LF	_____.	_____.
0078	608.0430 Storm Sewer Pipe Reinforced Concrete Class IV 30-Inch	1,487.000 LF	_____.	_____.
0080	608.0436 Storm Sewer Pipe Reinforced Concrete Class IV 36-Inch	311.000 LF	_____.	_____.
0082	608.2314 Storm Sewer Pipe Reinforced Concrete Horizontal Elliptical Class HE-III 14x23-Inch	222.000 LF	_____.	_____.



Proposal Schedule of Items

Proposal ID: 20250211027 Project(s): 1130-67-71

Federal ID(s): WISC 2025324

SECTION: 0001 Contract Items

Alt Set ID: Alt Mbr ID:

Proposal Line Number	Item ID Description	Approximate Quantity and Units	Unit Price	Bid Amount
0210	645.0130 Geotextile Type R	1,150.000 SY	_____	_____
0212	645.0140 Geotextile Type SAS	31,550.000 SY	_____	_____
0214	645.0220 Geogrid Type SR	31,550.000 SY	_____	_____
0216	646.2020 Marking Line Epoxy 6-Inch	62,655.000 LF	_____	_____
0218	646.4020 Marking Line Epoxy 10-Inch	1,130.000 LF	_____	_____
0220	646.9000 Marking Removal Line 4-Inch	64,525.000 LF	_____	_____
0222	646.9100 Marking Removal Line 8-Inch	1,130.000 LF	_____	_____
0224	646.9300 Marking Removal Special Marking	2.000 EACH	_____	_____
0226	690.0150 Sawing Asphalt	22,230.000 LF	_____	_____
0228	690.0250 Sawing Concrete	560.000 LF	_____	_____
0230	ASP.1T0A On-the-Job Training Apprentice at \$5.00/HR	2,400.000 HRS	5.00000	12,000.00
0232	ASP.1T0G On-the-Job Training Graduate at \$5.00/HR	4,400.000 HRS	5.00000	22,000.00
0234	SPV.0060 Special 01. Cover Plates	55.000 EACH	_____	_____
0236	SPV.0060 Special 02. Reconnect Storm Sewer	13.000 EACH	_____	_____
0238	SPV.0060 Special 03. Storm Sewer Plug	2.000 EACH	_____	_____



Proposal Schedule of Items

Proposal ID: 20250211027 Project(s): 1130-67-71

Federal ID(s): WISC 2025324

SECTION: 0001 Contract Items

Alt Set ID: Alt Mbr ID:

Proposal Line Number	Item ID Description	Approximate Quantity and Units	Unit Price	Bid Amount
0240	SPV.0060 Special 04. Fixed Message Sign Portable Support	2.000 EACH	_____.	_____.
0242	SPV.0060 Special 05. Emergency Response to Traffic Involving Concrete Barrier Temporary	10.000 EACH	_____.	_____.
0244	SPV.0060 Special 06. Emergency Response to Traffic Involving Crash Cushion Temporary	10.000 EACH	_____.	_____.
0246	SPV.0060 Special 07. Crash Cushions Temporary Left in Place	7.000 EACH	_____.	_____.
0248	SPV.0060 Special 08. Construction Staking Survey Project 1130-67-71	1.000 EACH	_____.	_____.
0250	SPV.0075 Special 01. Street Sweeping	175.000 HRS	_____.	_____.
0252	SPV.0090 Special 01. Removal and Salvage of High-Tension Cable Guard and Posts	27,705.000 LF	_____.	_____.
0254	SPV.0090 Special 02. HMA Longitudinal Joint Repair	9,485.000 LF	_____.	_____.
0256	SPV.0090 Special 03. Drain Slotted Vane Permanent	1,548.000 LF	_____.	_____.
0258	SPV.0090 Special 04. Concrete Barrier Temporary Precast Left in Place	29,863.000 LF	_____.	_____.
0260	SPV.0090 Special 05. Safety Fence Special	200.000 LF	_____.	_____.
0262	SPV.0090 Special 06. Removing Asphaltic Surface Rumble Strips	8,210.000 LF	_____.	_____.
0264	611.3003 Inlets 3-FT Diameter	3.000 EACH	_____.	_____.