



Wisconsin Department of Transportation

Division of Transportation Systems Development

Bureau of Project Development
4822 Madison Yards Way, 4th Floor South
Madison, WI 53705

May 4, 2026

Telephone: (608) 266-1631
Facsimile (FAX): (608) 266-8459

NOTICE TO ALL CONTRACTORS:

Proposal #03: 5350-02-65, WISC 2026130
C Janesville, Center Avenue
UP RR Structure B-53-135
USH 51
Rock County

5350-02-75, WISC 2026131
C Janesville, Center Avenue
W State St to WSOR Bridge B-53-154
USH 51
Rock County

Letting of May 12, 2026

This is Addendum No. 01, which provides for the following:

Special Provisions:

Added Special Provisions	
Article No.	Description
32	Abatement of Asbestos Containing Material Barrier Walls, Item 203.0211.S.001
33	Removing and Resetting Tubular Railing Barrier Walls, Item 513.9006.S.001

Schedule of Items:

Revised Bid Item Quantities					
Bid Item	Item Description	Unit	Proposal Total Prior to Addendum	Proposal Quantity Change (-)	Proposal Total After Addendum
204.0100	Removing Concrete Pavement	SY	218	47	265
204.0150	Removing Curb & Gutter	LF	336	193	529
204.0155	Removing Concrete Sidewalk	SY	333	7	340
305.0120	Base Aggregate Dense 1 ¼-Inch	TON	291	79	370
416.0610	Drilled Tie Bars	EACH	245	84	329
601.0417	Concrete Curb & Gutter 30-Inch Type K	LF	534	153	687
602.0405	Concrete Sidewalk 4-Inch	SF	2,723	18	2,741
602.0820	Concrete Driveway 8-Inch	SY	46	40	86
624.0100	Water	MGAL	6	2	8
625.0100	Topsoil	SY	346	197	543
629.0210	Fertilizer Type B	CWT	0.23	0.13	0.36
631.0300	Sod Water	MGAL	9	5	14
631.1000	Sod Lawn	SY	346	197	543
650.5500	Construction Staking Curb Gutter and Curb & Gutter	LF	542	-289	253
690.0250	Sawing Concrete	LF	773	284	1,057

Added Bid Item Quantities					
Bid Item	Item Description	Unit	Proposal Total Prior to Addendum	Quantity Added	Proposal Total After Addendum
203.0211.S.001	Abatement of Asbestos Containing Material Barrier Walls	EACH	0	1	1
204.0157	Removing Concrete Barrier	LF	0	9	9
513.9006.S.001	Removing and Resetting Tubular Railing Barrier Walls	EACH	0	1	1
601.0590	Concrete Curb & Gutter 4-Inch Sloped 36-Inch Type TBTT	LF	0	45	45
603.0105	Concrete Barrier Single-Faced 32-Inch	LF	0	7	7
614.2300	MGS Guardrail 3	LF	0	25	25
614.2500	MGS Thrie Beam Transition	LF	0	39	39
614.2610	MGS Guardrail Terminal EAT	EACH	0	1	1

Plan Sheets:

Revised Plan Sheets	
Plan Sheet	Plan Sheet Title (brief description of changes to sheet)
3	Project Overview (added guardrail)
7	Typical Sections (added dropdown for guardrail)
14	Removal Plan (additional removals related to guardrail)
16, 17	Plan Details (added guardrail and additional survey points, revised survey point table)
24	Erosion Control (added guardrail to background)
25	Storm Sewer (added guardrail to background)
27	Signing & Pavement Marking (added guardrail to background)
44	Traffic Control – Stage 2 (Temporary Pedestrian Access Stage 2D) (added guardrail to background and revised work zone hatching)
52	Temporary Pedestrian Access Overview (Stage 2D) (added guardrail to background and revised work zone hatching)
59 – 61, 64	Miscellaneous Quantities (revised various quantities associated with new guardrail)
168	Cross Sections (revised and added cross sections to depict new guardrail)

Added Plan Sheets	
Plan Sheet	Plan Sheet Title (brief description of why sheet was added)
82A	SDD – Concrete Barrier, Single Faced (With Anchorage)
82B-82E	SDD – Midwest Guardrail System (MGS) Guardrail
82F-82H	SDD – Midwest Guardrail System Energy Absorbing Terminal (MGS)
82I-82L	SDD – Midwest Guardrail System Thrie Beam Transition (MGS)
168A	Cross Sections (added cross sections to depict new guardrail)

The responsibility for notifying potential subcontractors and suppliers of these changes remains with the prime contractor.

Sincerely,

Mike Coleman

Proposal Development Specialist
Proposal Management Section

ADDENDUM NO. 01
5350-02-65, 5350-02-75
May 4, 2026

Special Provisions

32. Abatement of Asbestos Containing Material Barrier Walls, Item 203.0211.S.001.

A Description

This special provision describes abating asbestos containing material on barrier walls adjacent to bridge structures.

B (Vacant)

C Construction

Paul Garvey, License Number All-117079, inspected Structure B-53-154 for asbestos on April 16, 2020. Regulated Asbestos Containing Material (RACM) was found on this structure in the following locations: gray caulk material on parapet wall joint seams and around and below the metal base plates and bolts of the parapet wall rails. This caulk material is considered Category II non-friable ACTM. While not surveyed or quantified, it is assumed that there is caulk material in the parapet wall joints and in the parapet wall rail base plates and bolts for the parapet walls adjacent to the structure.

The RACM on the barrier walls must be abated by a licensed abatement contractor. A copy of the inspection report is included in the bid package or available from Jim Simpson, (608) 246-5628, jim.simpson@dot.wi.gov. According to NR447 and DHS159, ensure that DNR or DHS receives a completed Notification of Demolition and/or Renovation (DNR Form 4500-113 (R 3/20), or subsequent revision) via U.S. mail, hand-delivery, or using the online notification system at least 10 working days before beginning any construction or demolition. Pay all associated fees. Provide a copy of the completed 4500-113 form and the abatement report to Jim Simpson and via email to dothazmatunit@dot.wi.gov or via US mail to DOT BTS-ESS attn: Hazardous Materials Specialist, 5 South S.513.12, PO Box 7965, Madison, WI 53707-7965. In addition, comply with all local or municipal asbestos requirements.

Use the following information to complete WisDNR form 4500-113:

- Site Name: Structure B-53-154, USH 51 over SOO Line RR
- Site Address: 11.4M N JCT STH 81
- Ownership Information: WisDOT Transportation SW Region, 2101 Wright St, Madison, WI 53704
- Contact: Jim Simpson
- Phone: (608) 246-5628
- Age: 35 years. This structure was constructed in 1990
- Area: 3,278 SF of deck

Insert the following paragraph in Section 6.g.:

- If asbestos not previously identified is found or previously non-friable asbestos becomes crumbled, pulverized, or reduced to a powder, stop work immediately, notify the engineer, and the engineer will notify the department's Bureau of Technical Services at (608) 266-1476 for an emergency response as specified in standard spec 107.24. Keep material wet until it is abated or until it is determined to be non-asbestos containing material.

D Measurement

The department will measure Abatement of Asbestos Containing Material Barrier Walls as each continuous location of barrier, acceptably completed.

E Payment

The department will pay for measured quantities at the contract unit price under the following bid item:

ITEM NUMBER	DESCRIPTION	UNIT
203.0211.S.001	Abatement of Asbestos Containing Material Barrier Walls	EACH

Payment is full compensation for submitting necessary forms; removing all asbestos; and for properly disposing of all waste materials.

stp-203-005 (20220628)

33. Removing and Resetting Tubular Railing Barrier Walls, Item 513.9006.S.001.

A Description

This special provision describes removing tubular railing and posts from existing bridge barrier walls adjacent to bridge B-53-154, storing them, and then resetting them when the new barrier wall is complete.

B (Vacant)

C Construction

Remove the tubular railing and posts, taking care not to damage them. Store the tubular railing and posts in an area away from construction activities to preclude damage to them.

In the event that damage does occur to any item that is designated for re-use in the new work, repair or replace the damaged item at no expense to the department.

D Measurement

The department will measure Removing and Resetting Tubular Railing Barrier Walls as each continuous location of barrier, acceptably completed.

E Payment

The department will pay for measured quantities at the contract unit price under the following bid item:

ITEM NUMBER	DESCRIPTION	UNIT
513.9006.S.001	Removing and Resetting Tubular Railing Barrier Walls	EACH

Payment is full compensation for removing the tubular railing and posts; properly storing the tubular railing and posts; and for resetting the tubular railing and posts.

Schedule of Items

Attached, dated May 4, 2026, are the revised Schedule of Items Pages 1 – 9.

Plan Sheets

The following 8½ x 11-inch sheets are attached and made part of the plans for this proposal:

Revised: 3, 7, 14, 16, 17, 24, 25, 27, 44, 52, 59, 60, 61, 64, 168

Added: 168A

END OF ADDENDUM

Addendum No. 01
 ID 5350-02-75
 Revised Sheet 17
 May 4, 2026

POINT DATA						
POINT NUMBER	ALIGNMENT	STATION	OFFSET	Y	X	RADIUS
2-4	51	613+83.6	24.0' LT	263,390.23	490,950.27	
2-9	51	612+10.6	23.8' LT	263,416.90	490,949.68	
2-10	51	612+11.2	50.5' LT	263,416.62	490,923.00	
2-11	51	612+11.3	52.0' LT	263,416.61	490,921.50	
2-13	51	612+13.0	124.4' LT	263,415.86	490,849.09	
2-14	51	612+39.4	132.9' LT	263,441.89	490,839.72	
2-18	51	612+40.7	63.2' LT	263,445.67	490,909.32	
2-19	51	612+41.5	24.3' LT	263,447.79	490,948.17	
2-20	51	612+80.2	24.0' LT	263,486.68	490,947.13	
2-21	51	613+76.3	37.5' LT	263,582.36	490,931.07	
2-22	51	613+76.3	40.0' LT	263,582.29	490,928.57	
2-23	51	613+87.6	32.5' LT	263,599.79	490,935.76	
2-24	51	614+22.6	42.5' LT	263,628.51	490,924.83	
2-25	51	614+22.6	32.5' LT	263,628.78	490,934.83	
2-26	51	614+72.2	24.0' LT	263,692.72	490,941.62	
2-27	51	614+72.2	36.5' LT	263,719.06	490,927.41	
2-31	51	614+25.5	24.0' LT	263,730.94	490,939.18	
2-36	51	614+51.5	24.0' LT	263,756.90	490,937.52	
2-37	51	614+52.5	50.0' LT	263,756.21	490,911.52	
2-38	51	614+52.6	52.8' LT	263,756.14	490,908.75	
2-39	51	614+52.9	60.4' LT	263,755.93	490,901.06	
2-40	51	614+52.6	65.5' LT	263,755.30	490,896.08	
2-41	51	614+78.5	64.5' LT	263,782.29	490,895.36	
2-42	51	614+78.9	59.5' LT	263,781.92	490,900.37	
2-43	51	614+78.6	52.0' LT	263,782.12	490,907.85	
2-44	51	614+78.5	51.4' LT	263,782.14	490,908.41	
2-45	51	614+77.6	25.5' LT	263,782.82	490,934.36	
2-46	51	614+03.5	25.5' LT	263,808.72	490,932.70	
2-55	51	614+80.7	27.0' LT	263,886.70	490,938.00	
2-57	51	612+65.9	19.0' RT	263,474.72	490,990.47	
2-58	51	612+73.2	19.0' RT	263,474.49	490,981.72	
2-59	51	612+67.0	10.2' RT	263,474.49	490,981.72	
2-60	51	612+73.2	10.2' RT	263,480.62	490,981.56	
2-78	51	611+65.1	45.9' RT	263,373.32	491,020.52	
2-79	51	611+97.4	48.1' RT	263,405.68	491,022.07	
2-80	51	611+98.4	80.5' RT	263,408.42	491,054.34	
2-86	51	612+51.8	72.4' RT	263,461.50	491,044.37	
2-88	51	612+73.2	50.0' RT	263,481.69	491,021.32	
2-90	51	612+99.3	45.0' RT	263,507.65	491,015.60	
2-91	51	613+66.6	43.0' RT	263,574.88	491,011.80	
2-92	51	614+04.3	43.0' RT	263,612.55	491,010.79	
2-93	51	614+03.3	54.6' RT	263,611.86	491,022.39	
2-94	51	614+38.3	53.7' RT	263,646.82	491,020.62	
2-95	51	614+69.9	38.9' RT	263,678.02	491,004.90	
2-96	51	614+71.4	38.7' RT	263,679.54	491,004.66	

POINT DATA						
POINT NUMBER	ALIGNMENT	STATION	OFFSET	Y	X	RADIUS
2-97	51	615+27.3	33.0' RT	263,736.39	490,995.91	
2-98	51	615+35.4	32.3' RT	263,744.41	490,994.74	
2-99	51	615+58.5	31.2' RT	263,767.40	490,992.13	
2-100	51	615+67.4	31.3' RT	263,776.32	490,991.67	
2-101	51	615+72.4	33.9' RT	263,781.45	490,993.99	
2-102	51	615+74.9	34.0' RT	263,783.95	490,993.86	
2-103	51	615+78.9	33.4' RT	263,787.91	490,993.08	
2-105	51	616+68.2	2.1' RT	263,875.04	490,957.41	
2-106	51	616+67.1	4.8' RT	263,873.95	490,960.15	
2-107	51	616+54.7	33.5' RT	263,862.42	490,989.24	
2-112	51	612+09.7	298.5' RT	263,427.29	491,271.88	
2-113	51	612+10.2	288.5' RT	263,427.49	491,261.88	
2-114	51	612+31.2	289.7' RT	263,448.49	491,262.31	
2-115	51	612+30.6	299.7' RT	263,448.28	491,272.31	
2-116	51	611+79.4	58.1' LT	263,385.33	490,916.27	27'
2-117	51	612+80.2	64.0' LT	263,485.62	490,907.15	40'
2-118	51	611+62.5	82.8' RT	263,371.55	491,057.48	37'
2-119	51	612+99.3	95.0' RT	263,598.98	491,065.58	52'
2-120	51	615+25.5	51.0' LT	263,739.22	490,912.23	27'
2-121	51	616+03.5	50.5' LT	263,807.13	490,907.75	25'

PROJECT NO: 5350-02-75

HWY: USH 51

COUNTY: ROCK

PLAN DETAILS

SHEET

17

E

FILE NAME: T:\120209\CW\BDS\535002\05\SHEETS\PLAN\DELAVAN\021201\FD.DWG

LAYOUT NAME: 02a-98b

PLOT DATE: 4/27/2026 10:58 AM

PLOT BY: ANT, ANDREW

PLOT NAME:

PLOT SCALE: 1 IN=40 FT

W:\9007\CAD\05\SHEET 42

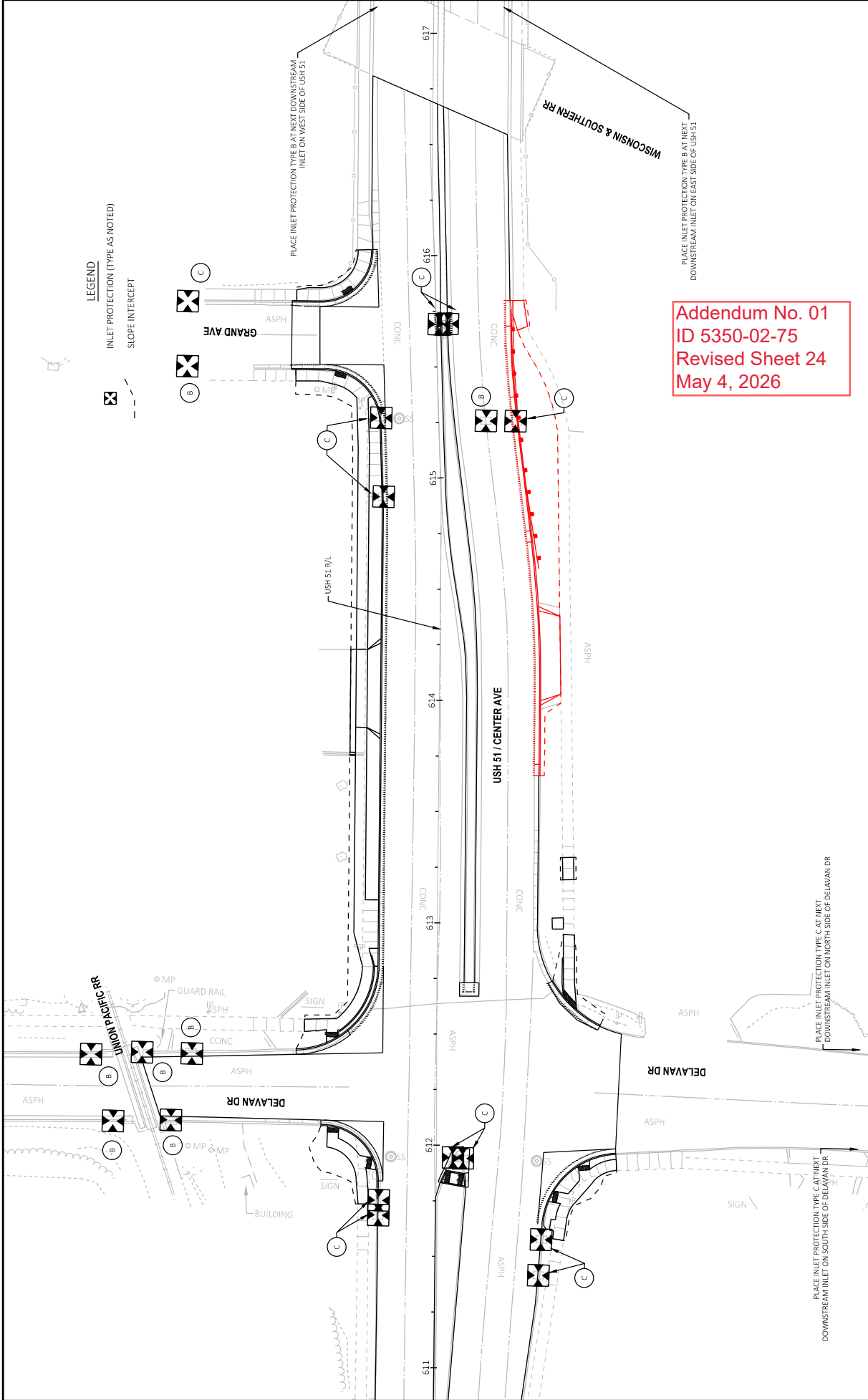

Addendum No. 01
 ID 5350-02-75
 Revised Sheet 24
 May 4, 2026

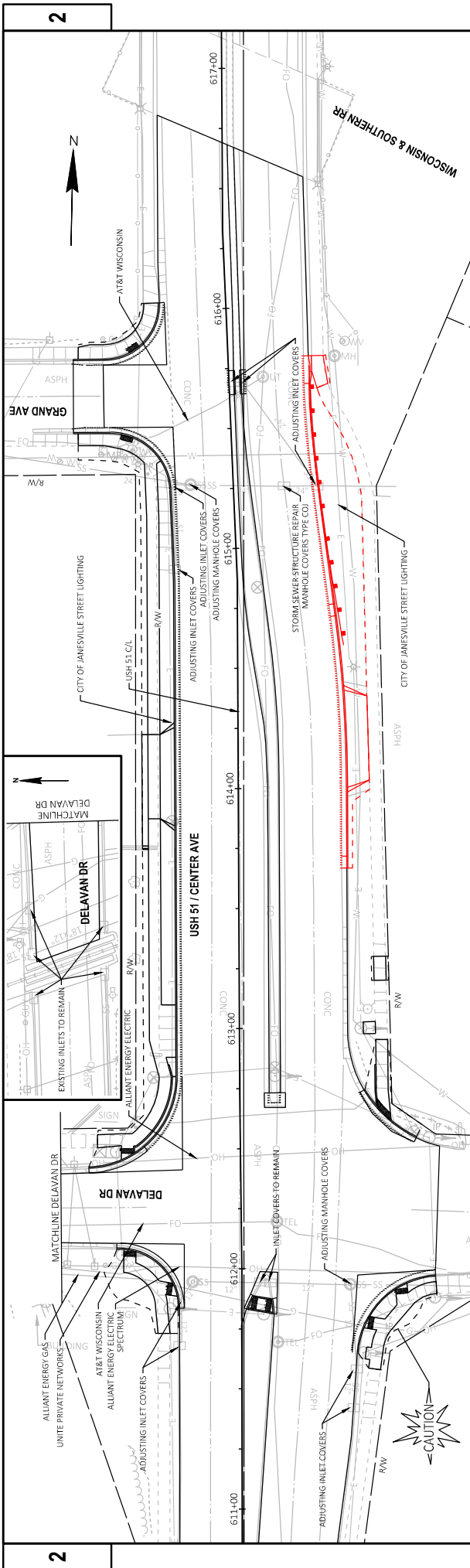

NO PROFILE INFORMATION - STORM SEWER STRUCTURE REPAIRS AND COVER ADJUSTMENTS ONLY

Addendum No. 01
 ID 5350-02-75
 Revised Sheet 25
 May 4, 2026

PROJECT NO: 5350-02-75	COUNTY: ROCK	STORM SEWER	SHEET 25	E
FILE NAME: T:\1302709\CIVIL\BDS\350000\SSHEETS\PLAN\DELAVAL\02250L-SS.DWG	HWY: USH 51	PLOT BY: ART, ANDREW	PLOT NAME: 1 IN=40 FT	WIS007CADDSS SHEET 41
LAYOUT NAME: -01		PLOT DATE: 4/27/2025 10:24 AM		

Addendum No. 01
 ID 5350-02-75
 Revised Sheet 27
 May 4, 2026

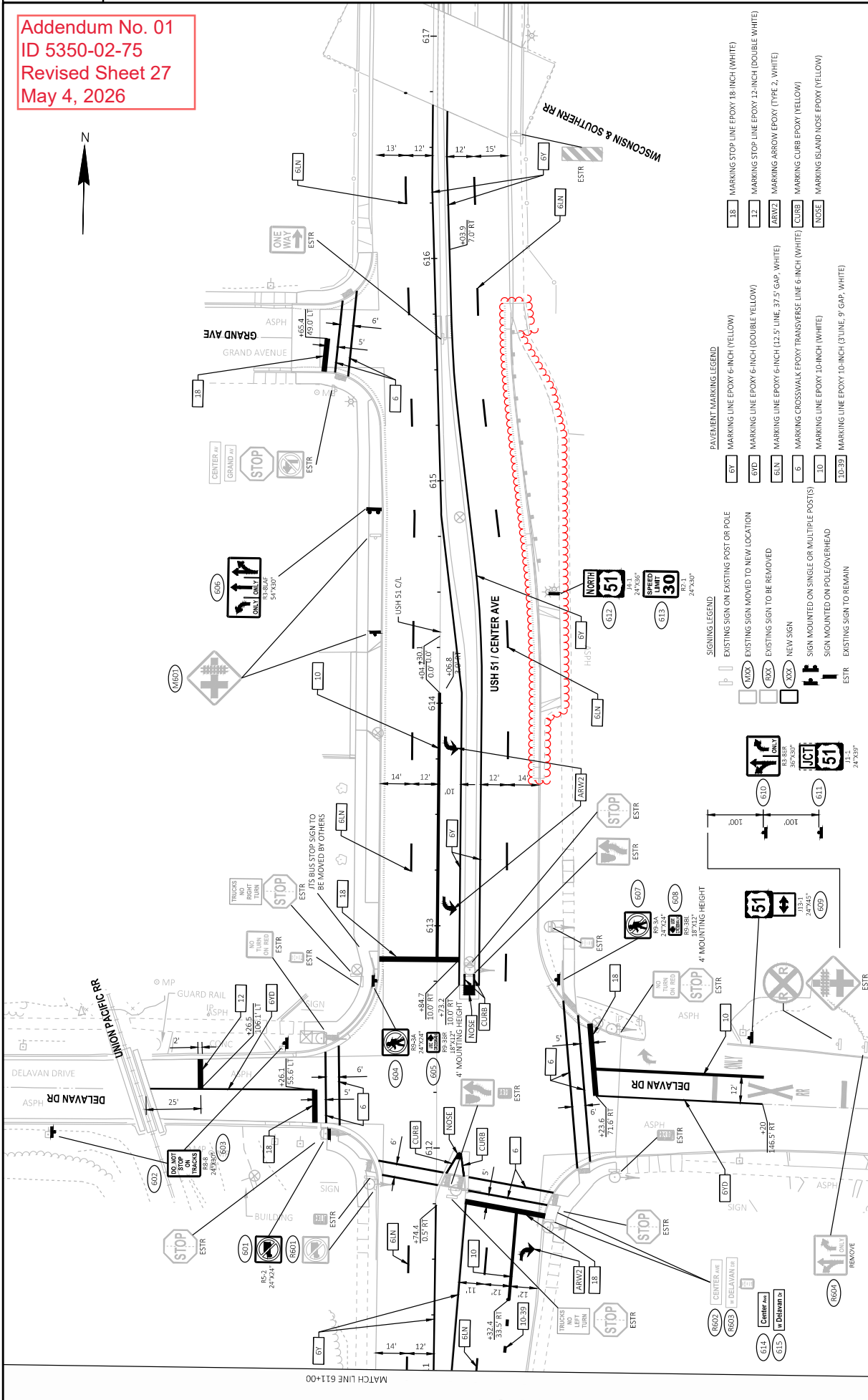

- SIGNING & PAVEMENT MARKING**
- PAVEMENT MARKING LEGEND**
- 18 MARKING STOP LINE EPOXY 18 INCH (WHITE)
 - 12 MARKING STOP LINE EPOXY 12 INCH (DOUBLE WHITE)
 - ARW2 MARKING ARROW EPOXY (TYPE 2, WHITE)
 - CURB MARKING CURB EPOXY (YELLOW)
 - NOSE MARKING ISLAND NOSE EPOXY (YELLOW)
- SIGNING LEGEND**
- EXISTING SIGN ON EXISTING POST OR POLE
 - EXISTING SIGN MOVED TO NEW LOCATION
 - EXISTING SIGN TO BE REMOVED
 - NEW SIGN
 - SIGN MOUNTED ON SINGLE OR MULTIPLE POST(S)
 - SIGN MOUNTED ON POLE/OVERHEAD
 - EXISTING SIGN TO REMAIN
- LEGEND**
- 6V MARKING LINE EPOXY 6 INCH (YELLOW)
 - 6V0 MARKING LINE EPOXY 6 INCH (DOUBLE YELLOW)
 - 6LN MARKING LINE EPOXY 6 INCH (WHITE)
 - 6 MARKING CROSSWALK EPOXY TRANSVERSE LINE 6 INCH (WHITE)
 - 10 MARKING LINE EPOXY 10 INCH (WHITE)
 - 10-39 MARKING LINE EPOXY 10 INCH (3 LINE, 9 GAP, WHITE)

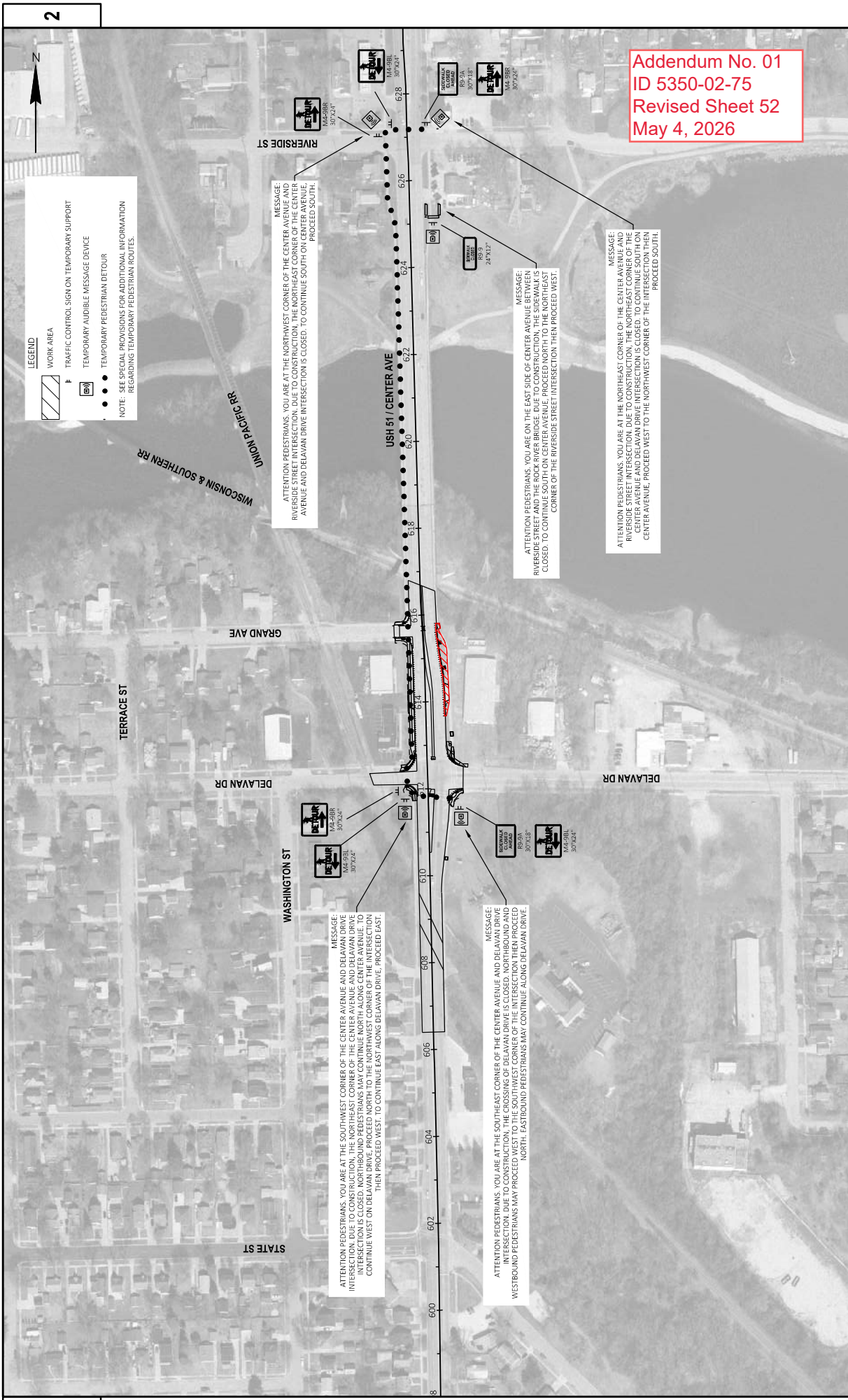

LEGEND

- WORK AREA
- TRAFFIC CONTROL SIGN ON TEMPORARY SUPPORT
- TEMPORARY AUDIBLE MESSAGE DEVICE
- TEMPORARY PEDESTRIAN DETOUR
- NOTE: SEE SPECIAL PROVISIONS FOR ADDITIONAL INFORMATION REGARDING TEMPORARY PEDESTRIAN ROUTES.

Addendum No. 01
ID 5350-02-75
Revised Sheet 52
May 4, 2026

MESSAGE:
 ATTENTION PEDESTRIANS, YOU ARE AT THE SOUTHWEST CORNER OF THE CENTER AVENUE AND DELAVAN DRIVE INTERSECTION. DUE TO CONSTRUCTION, THE NORTHWEST CORNER OF THE CENTER AVENUE AND DELAVAN DRIVE INTERSECTION IS CLOSED. WESTBOUND PEDESTRIANS MAY PROCEED WEST TO THE SOUTHWEST CORNER OF THE INTERSECTION, THEN PROCEED WEST, TO CONTINUE WEST ALONG DELAVAN DRIVE. PROCEED EAST.

MESSAGE:
 ATTENTION PEDESTRIANS, YOU ARE AT THE SOUTHWEST CORNER OF THE CENTER AVENUE AND DELAVAN DRIVE INTERSECTION. DUE TO CONSTRUCTION, THE SOUTHWEST CORNER OF THE INTERSECTION IS CLOSED. WESTBOUND PEDESTRIANS MAY PROCEED WEST TO THE SOUTHWEST CORNER OF THE INTERSECTION, THEN PROCEED WEST, TO CONTINUE WEST ALONG DELAVAN DRIVE.

MESSAGE:
 ATTENTION PEDESTRIANS, YOU ARE AT THE NORTHWEST CORNER OF THE CENTER AVENUE AND RIVERSIDE STREET INTERSECTION. DUE TO CONSTRUCTION, THE NORTHWEST CORNER OF THE CENTER AVENUE AND DELAVAN DRIVE INTERSECTION IS CLOSED. TO CONTINUE SOUTH ON CENTER AVENUE, PROCEED SOUTH.

MESSAGE:
 ATTENTION PEDESTRIANS, YOU ARE ON THE EAST SIDE OF CENTER AVENUE AND DELAVAN DRIVE INTERSECTION. DUE TO CONSTRUCTION, THE SIDEWALK IS CLOSED. TO CONTINUE SOUTH ON CENTER AVENUE, PROCEED NORTH TO THE NORTHEAST CORNER OF THE RIVERSIDE STREET INTERSECTION THEN PROCEED WEST.

MESSAGE:
 ATTENTION PEDESTRIANS, YOU ARE AT THE NORTHEAST CORNER OF THE CENTER AVENUE AND RIVERSIDE STREET INTERSECTION. DUE TO CONSTRUCTION, THE SIDEWALK IS CLOSED. TO CONTINUE SOUTH ON CENTER AVENUE, PROCEED WEST TO THE NORTHWEST CORNER OF THE INTERSECTION THEN PROCEED SOUTH.

REMOVALS

203.0211.5.001	204.0100	204.0105	204.0109.5	204.0115	204.0120	204.0150	204.0155	204.0157
ABATEMENT OF ASBESTOS CONTAINING MATERIAL BARRIER WALLS EACH	REMOVING CONCRETE PAVEMENT	REMOVING CONCRETE JOINTS	REMOVING CONCRETE SURFACE PARTIAL DEPTH	REMOVING ASPHALTIC JOINTS	REMOVING ASPHALTIC MILLING SURFACE	REMOVING CURB & GUTTER	REMOVING CONCRETE SIDEWALK	REMOVING CONCRETE BARRIER
1	265	41	26,238	83	1,967	529	336	9
	265			24	2,381		4	
TOTAL 0010	1	41	26,238	107	4,348	529	340	9

EARTHWORK

205.0100	205.0100	205.0100	205.0100	205.0100	205.0100	205.0100	205.0100	205.0100
EXCAVATION COMMON	EXCAVATION COMMON	EXCAVATION COMMON	EXCAVATION COMMON	EXCAVATION COMMON	EXCAVATION COMMON	EXCAVATION COMMON	EXCAVATION COMMON	EXCAVATION COMMON
CUT EXCAVATION	CUT EXCAVATION	CUT EXCAVATION	CUT EXCAVATION	CUT EXCAVATION	CUT EXCAVATION	CUT EXCAVATION	CUT EXCAVATION	CUT EXCAVATION
83	83	83	83	83	83	83	83	83
612+88 - 615+25	612+88 - 615+25	612+88 - 615+25	612+88 - 615+25	612+88 - 615+25	612+88 - 615+25	612+88 - 615+25	612+88 - 615+25	612+88 - 615+25
TOTAL 0010	83	83	83	83	83	83	83	83

- NOTES:**
 (1) EXCAVATION COMMON IS THE SUM OF THE CUT COLUMN.
 (2) SALVAGED/UNUSABLE PAVEMENT MATERIAL IS INCLUDED IN CUT.
 (3) SALVAGED/UNUSABLE PAVEMENT MATERIAL INCLUDES ASPHALT PAVEMENT, CONCRETE PAVEMENT, CURB & GUTTER, AND CONCRETE SIDEWALK.
 (4) AVAILABLE MATERIAL = CUT - SALVAGED/UNUSABLE PAVEMENT MATERIAL
 (5) THE MASS ORDINATE IS EITHER + OR - QUANTITY. POSITIVE QUANTITY INDICATES AN EXCESS OF MATERIAL. NEGATIVE QUANTITY INDICATES A SHORTAGE OF MATERIAL.
 (6) WASTE = MASS ORDINATE. FACTORS USED TO COMPUTE ANTICIPATED WASTE AND THE COMPUTED WASTE VOLUME IDENTIFIED ARE FOR GENERAL INFORMATION ONLY.

Addendum No. 01
 ID 5350-02-75
 Revised Sheet 59
 May 4, 2026

AGGREGATE

305.0120	624.0100	305.0120	624.0100
BASE	AGGREGATE	BASE	AGGREGATE
DENSE	1 1/4-INCH	DENSE	1 1/4-INCH
TON	MGAL	TON	MGAL
370	8	370	8
TOTAL 0010	370	370	8

CONCRETE BASE & PAVEMENT

320.0145	320.0165	320.0145	320.0165
CONCRETE BASE	CONCRETE PAVEMENT	CONCRETE BASE	CONCRETE PAVEMENT
8-INCH	10-INCH	8-INCH	10-INCH
SY	SY	SY	SY
76	32	76	32
TOTAL 0010	76	76	32

DRILLED TIE BARS

416.0610	416.0610	416.0610	416.0610
DRILLED TIE	DRILLED TIE	DRILLED TIE	DRILLED TIE
BARS	BARS	BARS	BARS
EACH	EACH	EACH	EACH
329	329	329	329
TOTAL 0010	329	329	329

PROJECT NO: 5350-02-75

HWY: USH 51

COUNTY: ROCK

MISCELLANEOUS QUANTITIES

SHEET

59

ASPHALT

455.0605	460.6424	465.0120		
TACK COAT	HMA PAVEMENT	ASPHALTIC SURFACE		
4 MT 58-28 H	DRIVEWAYS AND FIELD	ENTRANCES		
GAL	TON	TON		
0010	605+00 - 611+00	126	263	-
	611+00 - 617+00	267	544	3
UNDISTRIBUTED 4 - - -				
TOTAL 0010			397	807

CONCRETE CURB & GUTTER

601.0417	601.0419	601.0600	601.0590	601.0600	SPV.0090.101
CONCRETE CURB & GUTTER 30-INCH TYPE K	CONCRETE CURB & GUTTER 30-INCH TYPE L	CONCRETE CURB & GUTTER 18-INCH TYPE K	CONCRETE CURB & GUTTER 4-INCH SLOPED 36-INCH TYPE I(BIT)	CONCRETE CURB & GUTTER PEDESTRIAN	CONCRETE CURB & GUTTER 18-INCH TYPE K
LF	LF	LF	LF	LF	LF
0010	611+00 - 617+00	687	45	79	13
TOTAL 0010			687	79	13

CONCRETE ANCILLARY

602.0405	602.0415	602.0515	602.0615	602.0820	620.0300
CONCRETE SIDEWALK 4-INCH 6-INCH	CONCRETE SIDEWALK 4-INCH 6-INCH	CONCRETE SIDEWALK 4-INCH 6-INCH	CONCRETE SIDEWALK 4-INCH 6-INCH	CONCRETE SIDEWALK 4-INCH 6-INCH	CONCRETE SIDEWALK 4-INCH 6-INCH
SF	SF	SF	SF	SF	SF
0010	605+00 - 611+00	35	-	-	-
	611+00 - 617+00	2,706	90	16	20
TOTAL 0010		2,741	90	16	20

STORM SEWER ADJUSTMENTS

#	611.8110	611.8115	SPV.0060.103	SPV.0060.104
ADJUSTING MANHOLE COVERS	ADJUSTING MANHOLE COVERS	ADJUSTING STRUCTURE INLET COVERS	ADJUSTING STRUCTURE INLET COVERS	ADJUSTING STRUCTURE INLET COVERS
EACH	EACH	EACH	EACH	EACH
0010	611+00 - 617+00	3	9	1
TOTAL 0010		3	9	1

ADDITIONAL QUANTITIES SHOWN ELSEWHERE. SEE "MUNICIPAL ADJUSTMENTS" TABLE.

Addendum No. 01
ID 5350-02-75
Revised Sheet 60
May 4, 2026

EROSION CONTROL

628.1905	628.1910	628.7010	628.7015
EROSION CONTROL	EROSION CONTROL	EROSION CONTROL	EROSION CONTROL
EACH	EACH	EACH	EACH
0010	611+00 - 617+00	-	-
	617+00 - 619+00	-	-
UNDISTRIBUTED 5 - 5 - 3 - 4			
TOTAL 0010		5	18

RESTORATION

625.0100	627.0200	629.0210	630.0200	631.0300	631.1000
TOPSOIL MULCHING	FERTILIZER TYPE B	SEEDING TEMPORARY SOD	SEEDING TEMPORARY SOD	SEEDING TEMPORARY SOD	SEEDING TEMPORARY SOD
SF	CWT	LB	MGAL	MGAL	MGAL
0010	605+00 - 611+00	3	0.01	-	1
	611+00 - 617+00	515	0.33	-	12
UNDISTRIBUTED 25 - 20 - 1 - 25					
TOTAL 0010		543	0.36	1	14

Addendum No. 01
 ID 5350-02-65/75
 Added Sheet 82A
 May 4, 2026

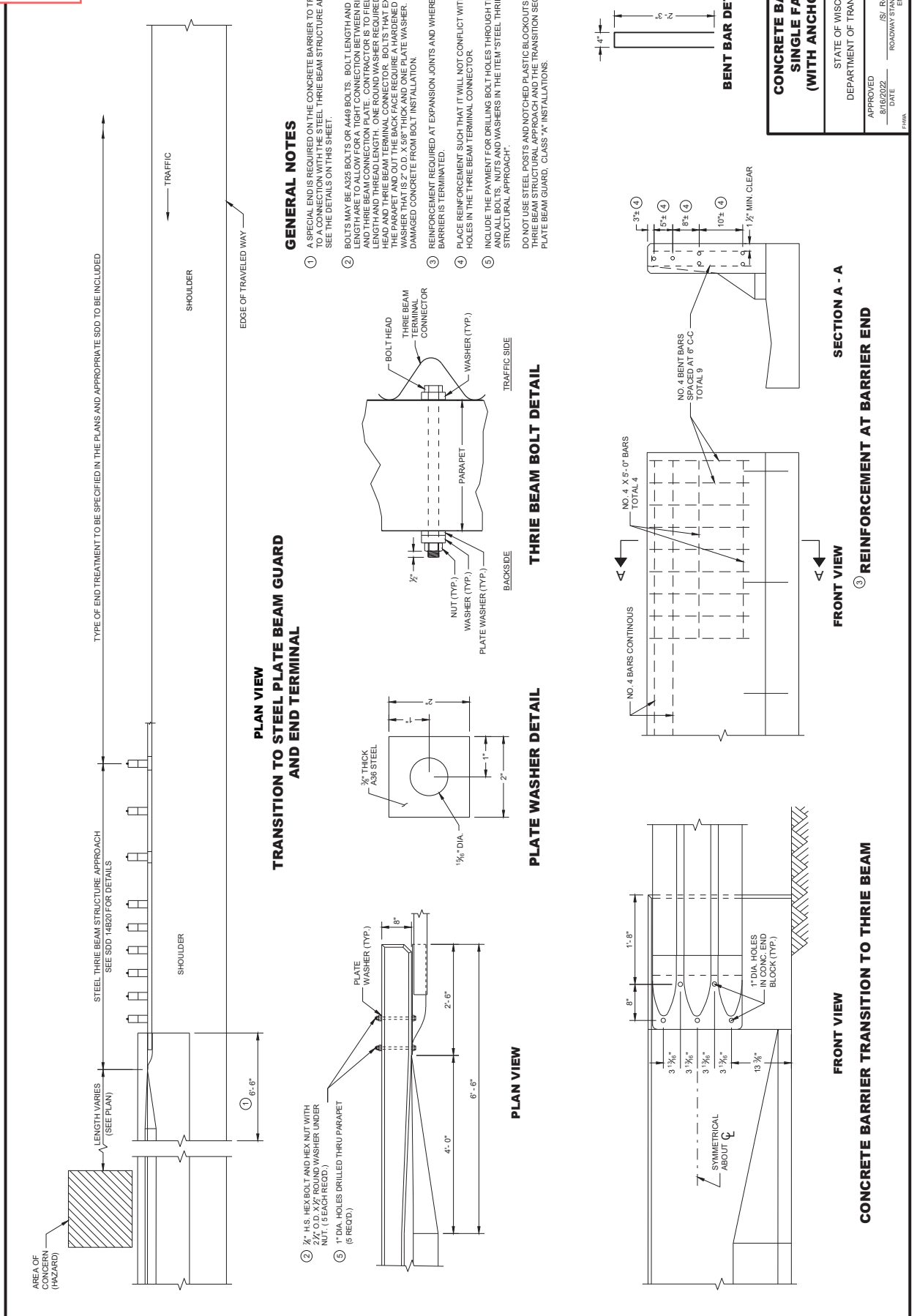

TRANSITION TO STEEL PLATE BEAM GUARD AND END TERMINAL

GENERAL NOTES

- 1 A SPECIAL END IS REQUIRED ON THE CONCRETE BARRIER TO TRANSITION TO A CONNECTION WITH THE STEEL THRIE BEAM STRUCTURE APPROACH. SEE THE DETAILS ON THIS SHEET.
- 2 BOLTS MAY BE A325 BOLTS OR A449 BOLTS. BOLT LENGTH AND THREADING LENGTH ARE TO ALLOW FOR A TIGHT CONNECTION BETWEEN BARRIER AND THRIE BEAM CONNECTION PLATE. CONTRACTOR IS TO FIELD VERIFY BOLT LENGTH AND THREADING LENGTH. BOLT HEADS AND THRIE BEAM TERMINAL HEAD AND THRIE BEAM TERMINAL CONNECTOR BOLTS THAT EXTEND THROUGH THE PARAPET AND OUT THE BACK FACE REQUIRE A HARDENED ROUND STEEL WASHER THAT IS 2" O.D. X 5/8" THICK AND ONE PLATE WASHER. REPAIR ANY DAMAGED CONCRETE FROM BOLT INSTALLATION.
- 3 REINFORCEMENT REQUIRED AT EXPANSION JOINTS AND WHERE CONCRETE BARRIER IS TERMINATED.
- 4 PLACE REINFORCEMENT SUCH THAT IT WILL NOT CONFLICT WITH THE BOLT HOLES IN THE THRIE BEAM TERMINAL CONNECTOR.
- 5 INCLUDE THE PAYMENT FOR DRILLING BOLT HOLES THROUGH THE PARAPET, AND ALL BOLTS, NUTS AND WASHERS IN THE ITEM "STEEL THRIE BEAM STRUCTURAL APPROACH".

DO NOT USE STEEL POSTS AND NOTCHED PLASTIC BLOCKOUTS IN THE STEEL THRIE BEAM STRUCTURAL APPROACH AND THE TRANSITION SECTION OF STEEL PLATE BEAM GUARD. CLASS "A" INSTALLATIONS.

SECTION A - A
REINFORCEMENT AT BARRIER END

CONCRETE BARRIER, SINGLE FACED (WITH ANCHORAGE)

STATE OF WISCONSIN
 DEPARTMENT OF TRANSPORTATION
 APPROVED _____
 DATE 8/16/2022
 FOR ROADWAY STRIPING DEVELOPMENT ENGINEER
 RST, Rodney Taylor
 FPM

- ① WOOD OR STEEL POSTS (W6X9 OR 6X6S) MAY BE USED. DO NOT INTERNALLY WOOD AND STEEL POSTS. INSTALL STEEL POSTS WITH HOLES ON APPROACHING TRAFFIC SIDE.
- ② USE WOOD OR APPROVED PLASTIC BLOCKOUTS. WOOD BLOCKOUTS MAY BE CONSTRUCTED OUT OF TWO OR MORE WOOD BLOCKOUTS. SEE ALTERNATE WOOD BLOCKOUT DETAIL. DIMENSIONS OF APPROVED PLASTIC BLOCKOUTS MAY VARY.
- ③ IF ROCK IS ENCOUNTERED DURING EXCAVATION, PROVIDE A HOLE 12 INCHES IN DIAMETER EXTENDING 20 INCHES DEEP INTO THE ROCK. PLACE APPROXIMATELY 2 1/2 INCHES OF GRANULAR MATERIAL IN THE BOTTOM OF THE HOLE. CUT THE POSTS THE TO LENGTH AND INSTALL. BACKFILL WITH EXCAVATED MATERIAL AND COMPACT. BACKFILL IS TO BE FREE OF LARGE ROCKS.
- ④ WHEN THE DISTANCE FROM BACK OF POST TO SHOULDER HINGE POINT IS LESS THAN 2 FEET INSTALL LONGER POST AT HALF POST SPACING (K).
- ⑤ FOR NEW MGS INSTALLATION TOP OF W-BEAM RAIL TOLERANCE IS ±1". FOR EXISTING MGS INSTALLATION TOP OF W-BEAM IS BETWEEN 27 3/4" TO 32".
- ⑥ WHEN USING STEEL POST AND WOOD BLOCKOUTS INSTALL FOUR 16D GALVANIZED NAILS. INSTALL NAILS AT THE BACK CORNERS OF THE BLOCK AND BEND THE NAILS OVER THE FLANGE OF THE STEEL POST.
- ⑦ TOTAL POST LENGTH FOR TYPE K IS 7'-0". TOTAL POST LENGTH FOR OTHER MGS TYPES IS 6'-0".

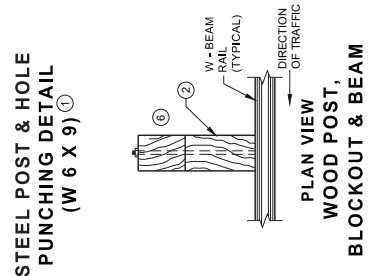
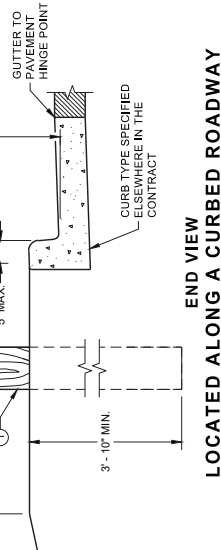
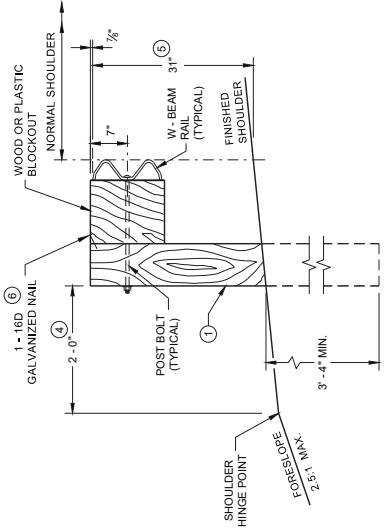
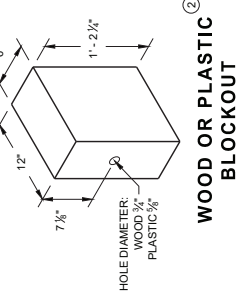
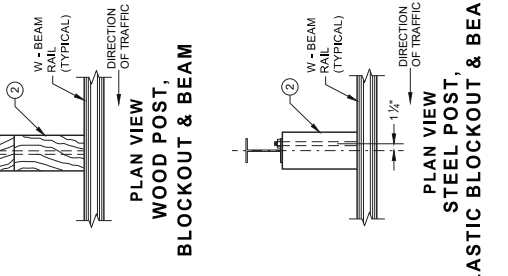
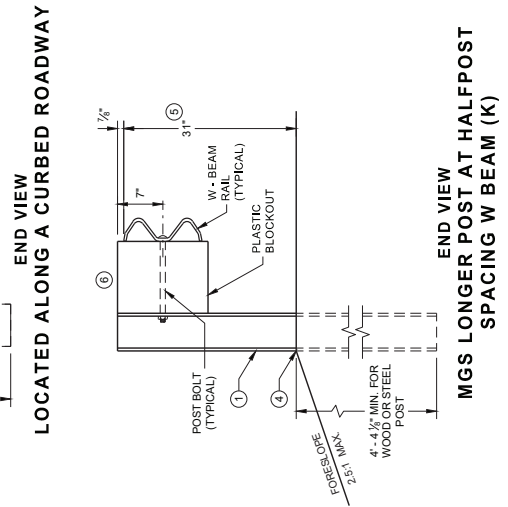
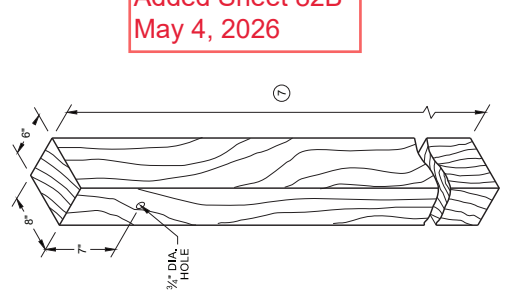
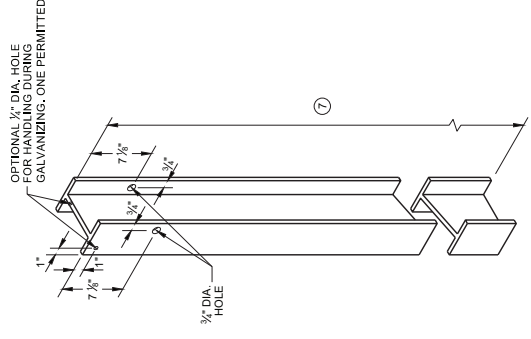
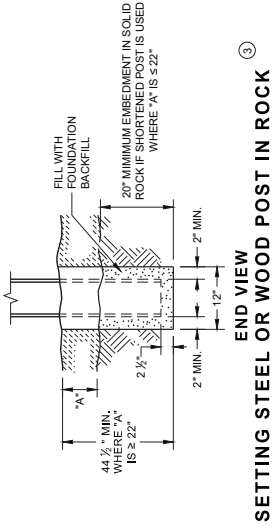

LOCATED ALONG A ROADWAY SHOULDER
 STANDARD INSTALLATION

PLASTIC BLOCKOUT & BEAM
 STEEL POST,
 BLOCKOUT & BEAM

MIDWEST GUARDRAIL SYSTEM
 (MGS) GUARDRAIL

STATE OF WISCONSIN
 DEPARTMENT OF TRANSPORTATION

- GENERAL NOTES**
- ① DO NOT INSTALL REFLECTORS ON THE FIRST 50 FEET OF THE APPROACH END OF THE ENERGY ABSORBING TERMINAL.
 - ② 25 FEET OF HALF POST SPACING IS REQUIRED ON APPROACH AND DEPARTURE ENDS OF QUARTER POST SPACING.

POST BOLTS ARE A 1/2" DIAMETER ASTM A307 GUARDRAIL BOLT. A POST BOLT REFLECTOR IS REQUIRED AT ALL QUARTER POST SPACING LOCATIONS. POST BOLTS MAY BE LONGER IF MULTIPLE BLOCKOUTS ARE BEING USED.

GUARD RAIL SPLICE BOLTS ARE A 1/2" DIAMETER ASTM A307 GUARDRAIL BOLT. A POST BOLT REFLECTOR IS REQUIRED AT ALL QUARTER POST SPACING LOCATIONS. SPLICE BOLTS REQUIRE 1/4" DIAMETER A308A DOUBLE RECESSED (DR) HEAVY HEX NUT.

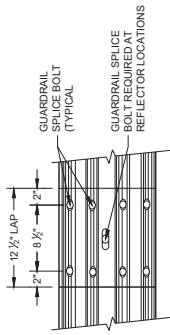

**FRONT VIEW
MID-SPAN BEAM SPLICE**

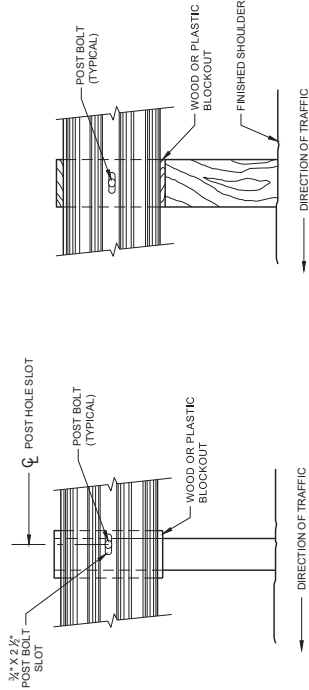

FRONT VIEW AT STEEL POST

FRONT VIEW AT WOOD POST

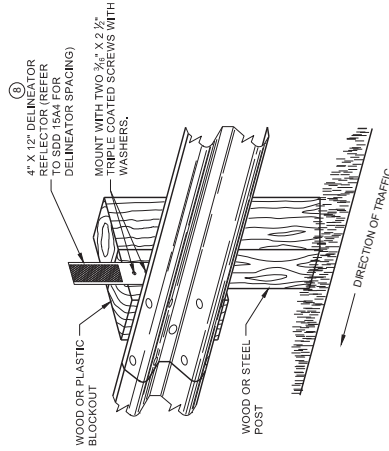

**ONE SIDED REFLECTOR DETAIL
AND TYPICAL INSTALLATION**

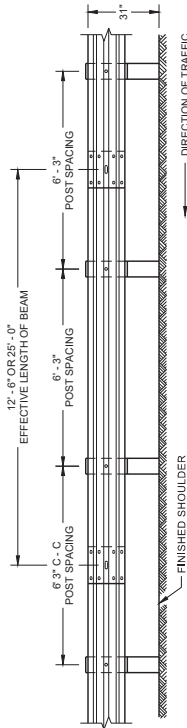

**FRONT VIEW
POST SPACING STANDARD INSTALLATION**

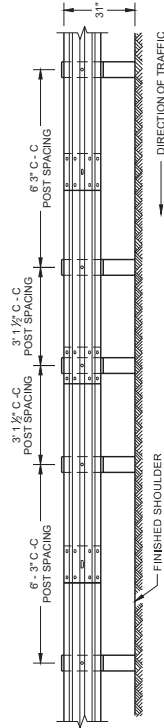

**FRONT VIEW
HALF POST SPACING (HS) AND
HALF POST SPACING WITH LONGER POSTS (K)**

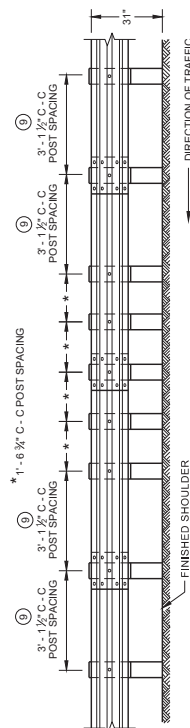

**FRONT VIEW
QUARTER POST SPACING (QS)**

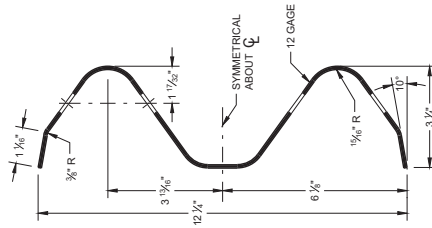

SECTION THRU W-BEAM RAIL

Addendum No. 01
ID 5350-02-65/75
Added Sheet 82C
May 4, 2026

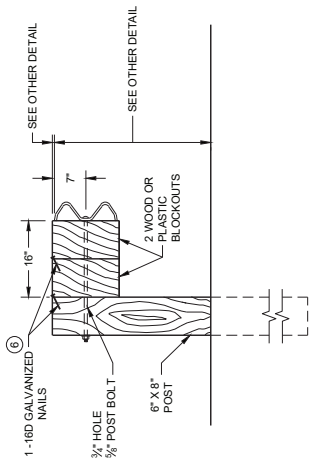

DETAIL FOR 16" BLOCKOUT DEPTH
 IT IS ACCEPTABLE TO USE BLOCKOUTS UP TO 16" DEEP TO INCREASE THE POST OFFSET TO AVOID UNDERGROUND OBSTACLES. THERE IS NO LIMIT TO THE NUMBER OF POSTS THAT CAN HAVE ADDITIONAL BLOCKOUTS UP TO 16" DEEP.

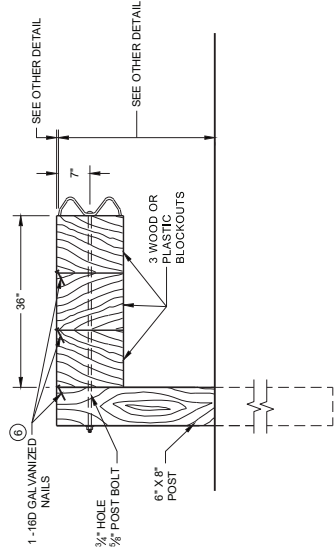

DETAIL FOR 36" BLOCKOUT DEPTH

NOTES:
 UNDER SPECIAL CIRCUMSTANCES, SUCH AS AVOIDING OBSTACLES THAT ARE NOT RELOCATED, IT IS ACCEPTABLE TO INSTALL ADDITIONAL BLOCKOUTS TO OBTAIN UP TO 36" DEPTH FOR ONE OR TWO POSTS IN A SECTION OF GUARDRAIL. DO NOT USE 16" OR 36" BLOCKOUTS IF IT CAUSES THE POST TO BE DRIVEN BEYOND SHOULDER HINGE POINT OR CAUSES A FIXED OBJECT TO BE WITHIN THE DEFLECTION DISTANCE OF THE BARRIER.

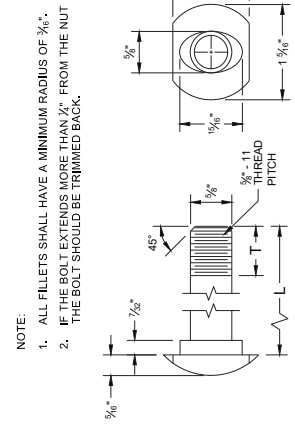

POST BOLT TABLE

L	T (MIN.)
1 1/2"	1 1/4"
2"	1 1/2"
10"	4"
14"	4 1/2"
18"	4"
21"	4 1/2"
25"	4"

ALTERNATE BOLT HEAD

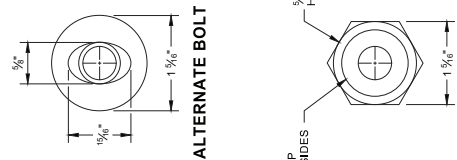

POST BOLT, SPLICE BOLT AND RECESS NUT

WHEN USING STEEL POST AND WOOD BLOCKOUTS, INSTALL FOUR 16D GALVANIZED NAILS. INSTALL NAILS AT THE BACK CORNERS OF THE BLOCK AND BEND THE NAILS OVER THE FLANGE OF THE STEEL POST.

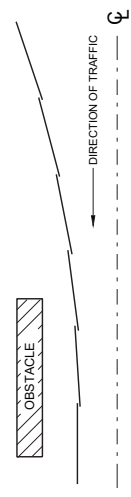

PLAN VIEW BEAM LAPPING DETAIL

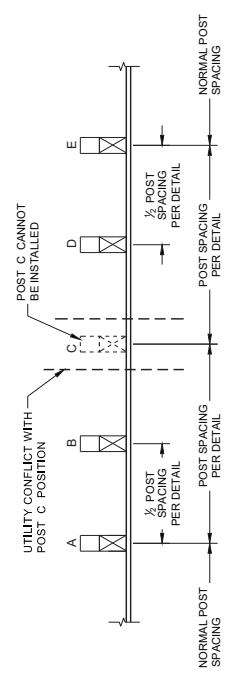

POST DRIVING FOR CONTINUOUS UNDERGROUND OBSTRUCTION

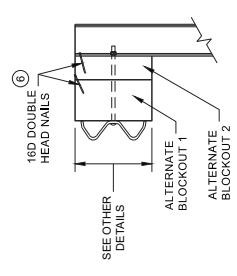

SIDE VIEW

ALTERNATE WOOD BLOCKOUT DETAIL

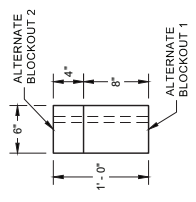

PLAN VIEW

Addendum No. 01
 ID 5350-02-65/75
 Added Sheet 82D
 May 4, 2026

MIDWEST GUARDRAIL SYSTEM (MGS) GUARDRAIL
STATE OF WISCONSIN DEPARTMENT OF TRANSPORTATION
APPROVED _____ DATE _____ BY _____ ROADWAY DEVELOPMENT SUPERVISOR

Addendum No. 01
ID 5350-02-65/75
Added Sheet 82E
May 4, 2026

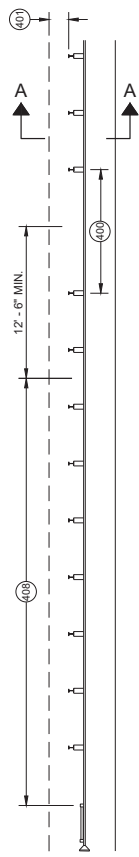

MISSING POST IN MGS GUARDRAIL NEAR END

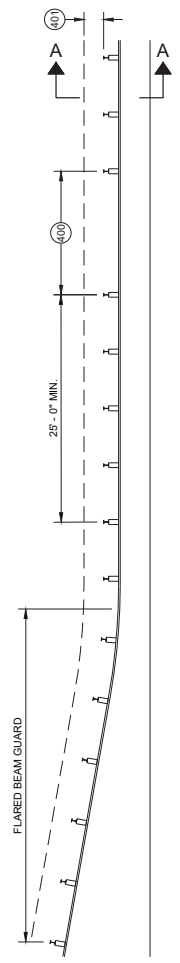

MISSING POST IN MGS GUARDRAIL NEAR FLARED BEAM GUARD

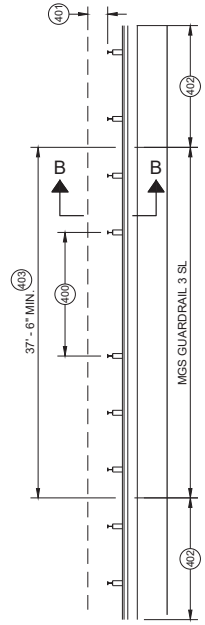

MISSING POST IN SHORT SPAN MGS GUARDRAIL NEAR CURB (SL)

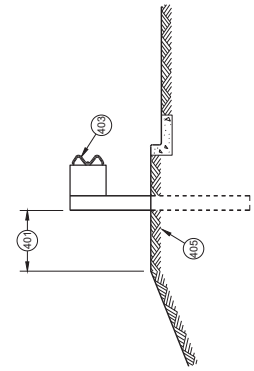

SECTION B - B

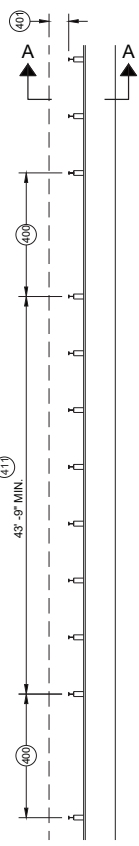

MISSING POST IN MGS GUARDRAIL

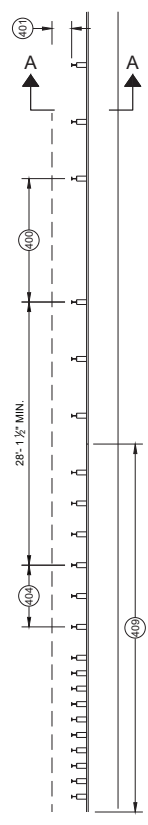

MISSING POST IN MGS GUARDRAIL NEAR AN APPROACH TRANSITION

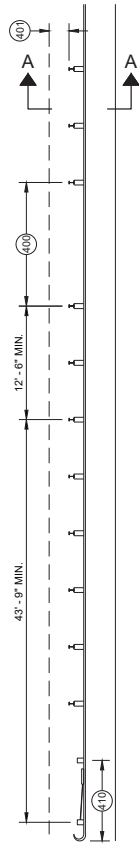

MISSING POST IN MGS GUARDRAIL NEAR A TYPE 2 END TERMINAL

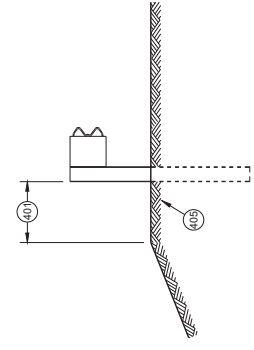

SECTION A - A

- 409 MAX SPAN 12' - 6"
- 401 2' MIN.
- 402 MGS GUARDRAIL 3
- 403 NESTING BEAM GUARD
- 404 ASYMMETRIC TRANSITION
- 405 SOIL WELL DRAINED AND COMPACTED
- 408 SEE OTHER DRAWINGS IN THIS SDD
- 407 SEE OTHER DRAWINGS FOR MIN. SPACING BETWEEN SPANS
- 409 SEE SDD 14B44
- 408 SEE SDD 14B45
- 409 SEE SDD 14B47
- 411 MINIMUM DISTANCE BETWEEN MISSING POST SPANS.

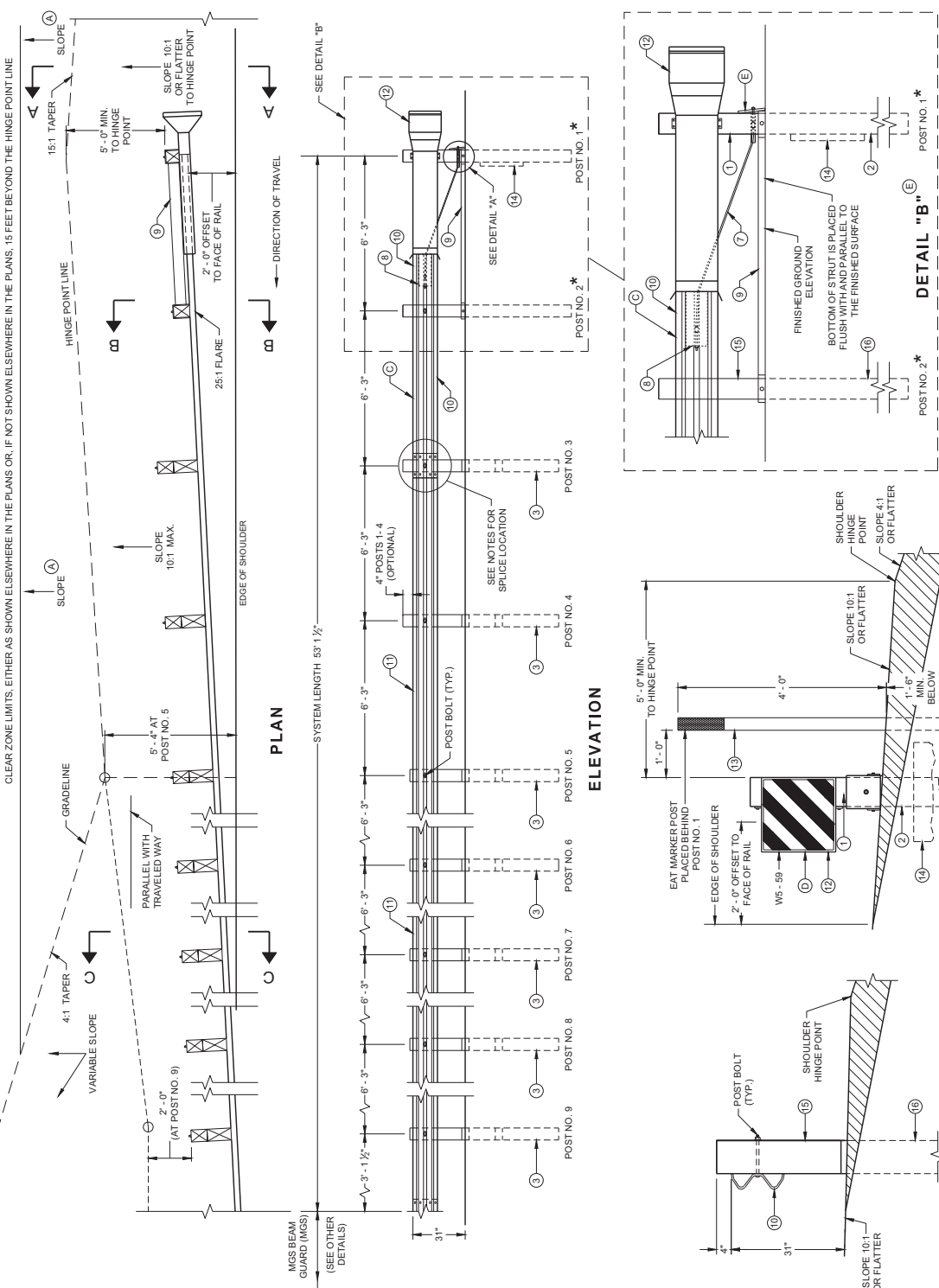

GENERAL NOTES

A THE SLOPE IN THE AREA BOUNDED BY THE GRADELINE, THE HINGE POINT LINE (HPL) AND THE CLEARZONE LIMITS (CZL) SHALL BE 4:1 OR FLATTER.

B AFTER FINAL ASSEMBLY, RECHECK CABLE TO BE SURE IT IS TAUT AND HAS NOT RELAXED.

C DIFFERENT MANUFACTURERS REQUIRE DIFFERENT PERFORATED W-BEAM RAIL END PANELS. SEE MANUFACTURER'S INFORMATION.

D ATTACH ALUMINUM SHEET TO E.A.T. HEAD USING 4 STAINLESS STEEL SELF-TAPPING SCREWS, ONE SCREW PER CORNER.

E HARDWARE MAY VARY BETWEEN MANUFACTURERS. SEE MANUFACTURER'S DRAWING FOR INFORMATION. DIMENSIONS MAY VARY, MANUFACTURER'S INFORMATION.

SEE SDD 14B42 FOR MORE INFORMATION.

* DO NOT ATTACH BLOCKOUTS TO POST 11 AND 2.

DO NOT INSTALL REFLECTORS ON THE FIRST 50 FEET OF THE APPROACH END OF THE ENERGY ABSORBING TERMINAL.

SEE MANUFACTURER'S DRAWING FOR SPLICE LOCATION, HARDWARE DIMENSIONS AND INSTALLATION INSTRUCTIONS.

THE CENTER OF THE UPPER 3/4" DIAMETER HOLE ON POST NUMBER 3 THROUGH POST 9 IS TO BE FLUSH WITH THE GROUND LINE UP TO A MAXIMUM OF 2" ABOVE GROUND LINE. WOOD BLOCKS ON POSTS NUMBERED 3 THROUGH 9 MAY BE ADJUSTED UP TO 3" ABOVE THE TOP OF POST.

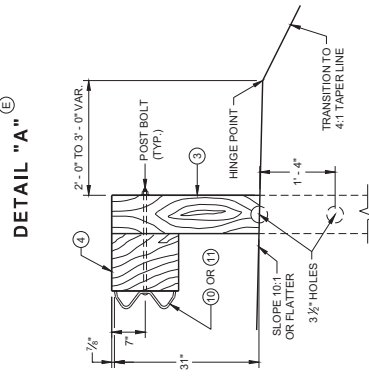
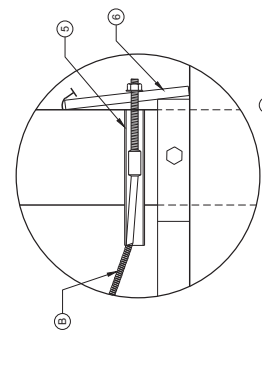

**MIDWEST GUARDRAIL SYSTEM
ENERGY ABSORBING TERMINAL
(MGS)**

STATE OF WISCONSIN
DEPARTMENT OF TRANSPORTATION

Addendum No. 01
ID 5350-02-65/75
Added Sheet 82F
May 4, 2026

82F

SECTION A - A
TYPICAL AT POST NO. 1 *

SECTION B - B
TYPICAL AT POST NO. 2 *

SECTION C - C
TYPICAL AT POST NOS. 3 - 9

BILL OF MATERIALS

PART NO.	DESCRIPTION
MATERIALS PROVIDED BY MGS/EAT MANUFACTURER. SEE MANUFACTURER'S DETAILS FOR MORE INFORMATION.	
1	UPPER POST NO. 1 6" X 6" TUBE
2	LOWER POST NO. 1
3	WOOD CRT
4	WOOD BLOCKOUT
5	PIPE SLEEVE
6	BEARING PLATE
7	BCT CABLE ASSEMBLY
8	ANCHOR CABLE BOX
9	GROUND STRUT
10	PERFORATED W-BEAM RAIL END PANEL, 12'-6" LONG.
11	STANDARD W-BEAM RAIL MULTIPLE SECTIONS REQUIRED.
12	IMPACT HEAD
13	EAT MARKER POST - YELLOW (SEE APPROVED PRODUCTS LIST)
14	SOIL PLATE
15	UPPER POST NO. 2
16	LOWER POST NO. 2

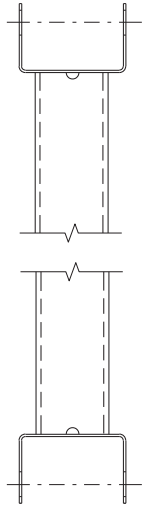

GENERIC GROUND STRUT (E)

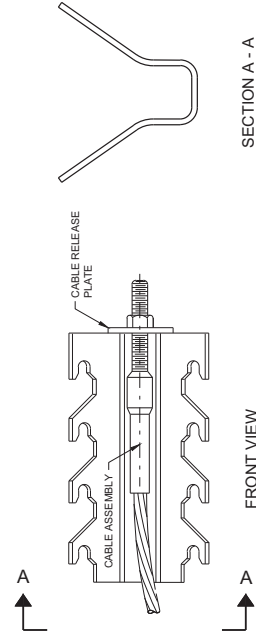

GENERIC ANCHOR CABLE BOX (E)

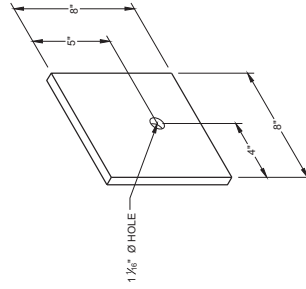

BEARING PLATE (E)

Addendum No. 01
ID 5350-02-65/75
Added Sheet 82G
May 4, 2026

**MIDWEST GUARDRAIL SYSTEM
ENERGY ABSORBING TERMINAL
(MGS)**

STATE OF WISCONSIN
DEPARTMENT OF TRANSPORTATION

82G

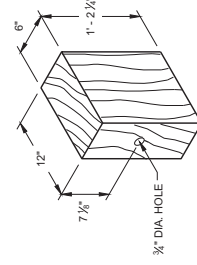

WOOD BLOCKOUT (4)

REQ'D. AT ALL POSTS EXCEPT POST NOS 1 & 2

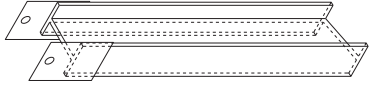

LOWER POST NO. 2 (15)(E)

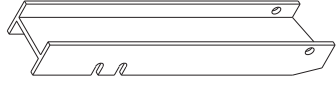

UPPER POST NO. 2 (15)(E)

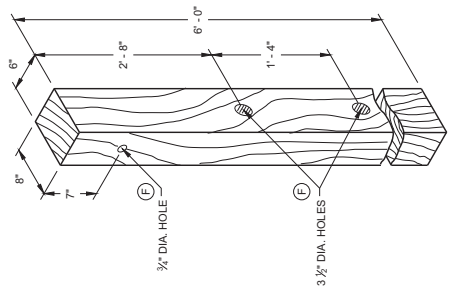

WOOD CRT POST (3)(E)
POSTS NUMBER 3-9

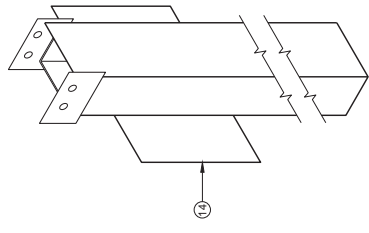

LOWER POST NO. 1 (2)(E)

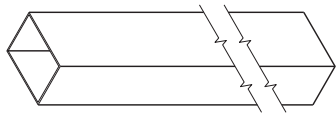

UPPER POST NO. 1 (1)(E)

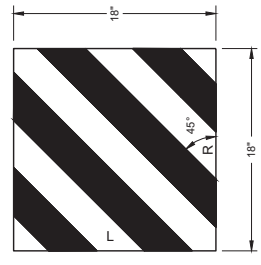

W5 - 59

REFLECTIVE SHEETING DETAIL (E)

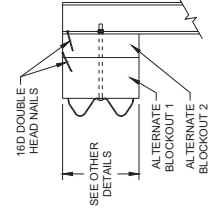

SIDE VIEW

ALTERNATE WOOD BLOCKOUT DETAIL

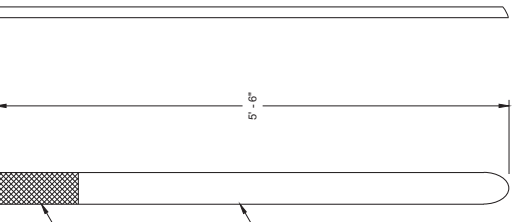

FRONT VIEW

SIDE VIEW

E.A.T. MARKER POST (13)

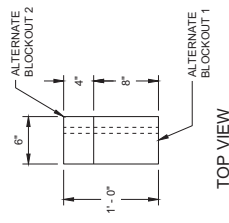

TOP VIEW

Addendum No. 01
ID 5350-02-65/75
Added Sheet 82H
May 4, 2026

MIDWEST GUARDRAIL SYSTEM ENERGY ABSORBING TERMINAL (MGS)

STATE OF WISCONSIN
DEPARTMENT OF TRANSPORTATION

APPROVED: /S/ Rodney Taylor
DATE: 7/2018
ROADWAY SAFETY DEVELOPMENT DIV. SUPERVISOR

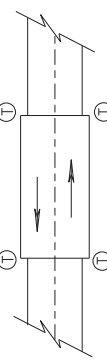

TWO WAY TRAFFIC

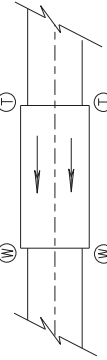

ONE WAY TRAFFIC

GENERAL NOTES

IF ROCK IS ENCOUNTERED, REMOVE ROCK TO FULL DEPTH OF POST PLUS 2 1/2", AND 12" DIAMETER AROUND POST. SEE 14B42 FOR MORE DETAILS.
 TRANSITION USES STEEL POSTS ONLY.
 SEE STANDARD DETAIL DRAWING 14 B 42 FOR MORE INFORMATION.
 POST 2 THROUGH 17 USES STEEL POST ONLY

- ① BRIDGE RAILING TYPE "W" DOES NOT REQUIRE A TERMINAL CONNECTOR.
- ② OPTIONAL CURB AND GUTTER OR DRAINAGE FEATURE SEE PLAN FOR INFORMATION.
- ③ STEEL OR WOOD POST IS ACCEPTABLE AT POST 1. SEE SDD14B42

TYPICAL LOCATIONS OF THRIE BEAM AND W-BEAM CONNECTIONS TO BRIDGE

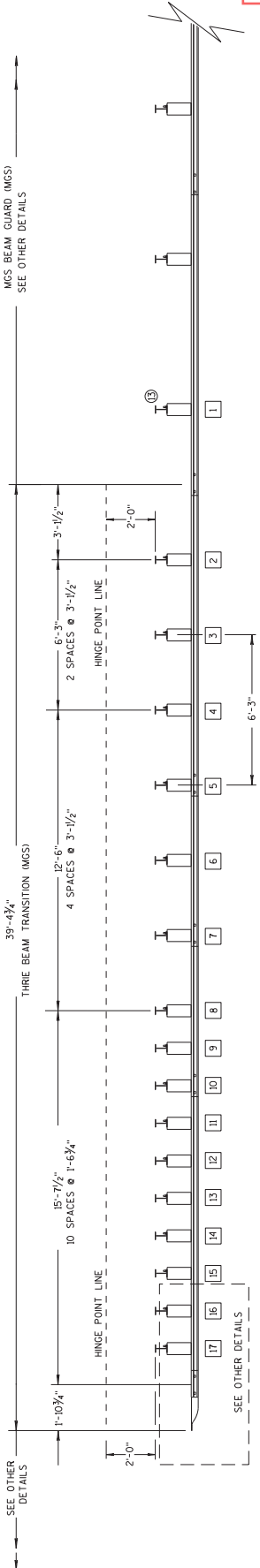

PLAN VIEW

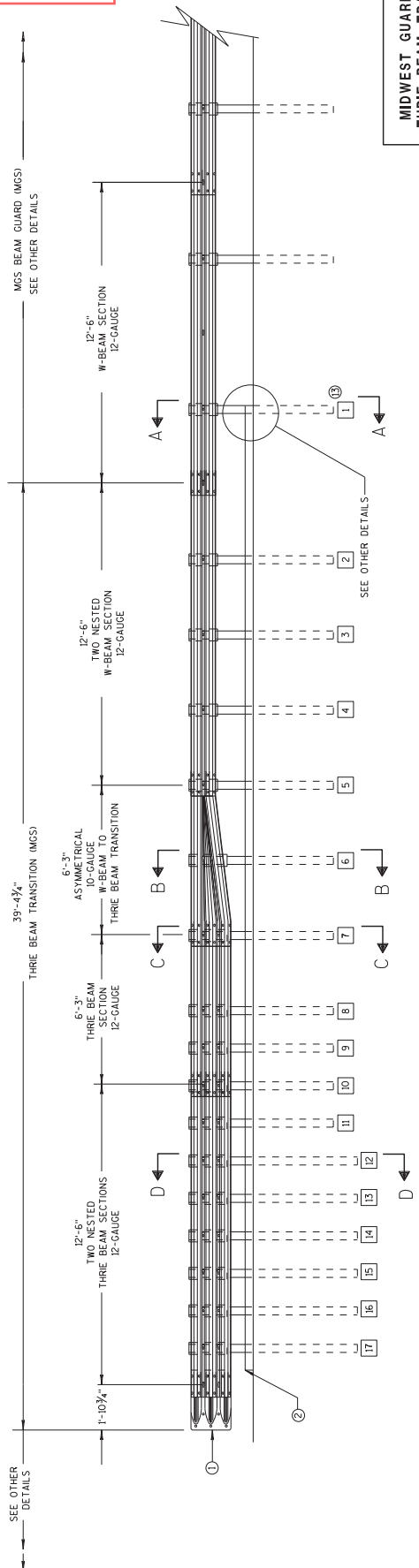

ELEVATION VIEW

Addendum No. 01
 ID 5350-02-65/75
 Added Sheet 821
 May 4, 2026

**MIDWEST GUARDRAIL SYSTEM
 THRIE BEAM TRANSITION (MGS)**

STATE OF WISCONSIN
 DEPARTMENT OF TRANSPORTATION

MIDWEST GUARDRAIL SYSTEM THRIE BEAM TRANSITION

GENERAL NOTES

- (2) OPTIONAL CURB AND GUTTER OR DRAINAGE FEATURE SEE PLAN FOR INFORMATION.
- (3) WHEN USING STEEL POSTS AND WOOD BLOCKOUTS INSTALL FOUR 10D GALVANIZED NAILS AT THE BACK CORNERS OF THE BLOCK AND BEND THE NAILS OVER THE FLANGE OF THE STEEL POST.
- (4) TOLERANCE FOR TOP OF W-BEAM RAIL IS $\pm 1"$.
- (13) STEEL OR WOOD POST IS ACCEPTABLE AT POST 1. SEE SDD 14B42

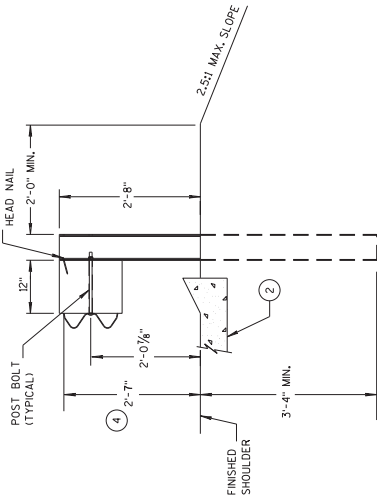

**SECTION A-A
POSTS 1-5**

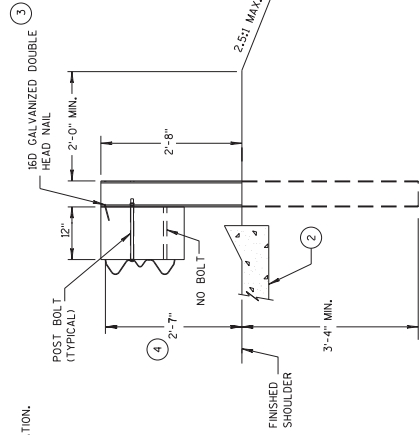

**SECTION B-B
POST 6**

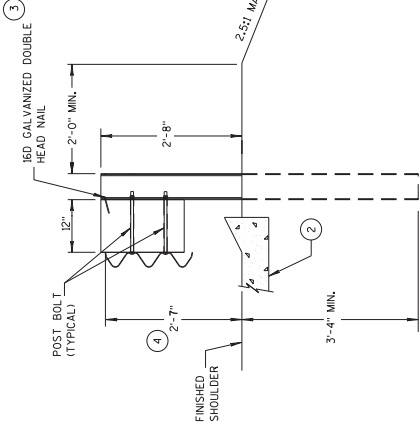

**SECTION C-C
POSTS 7-11**

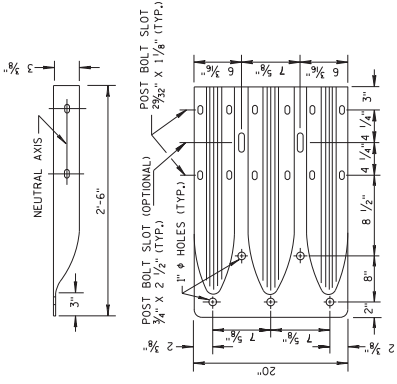

**THRIE BEAM
TERMINAL CONNECTOR**

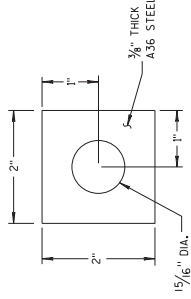
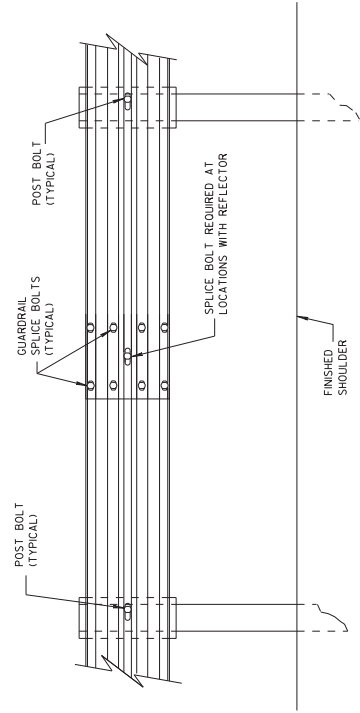
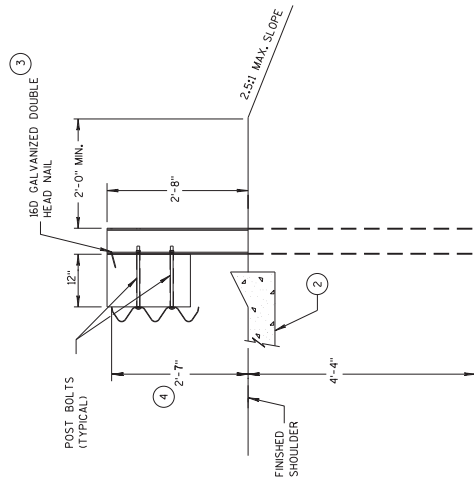

PLATE WASHER DETAIL



SPLICE DETAIL



**SECTION D-D
POSTS 12-17**

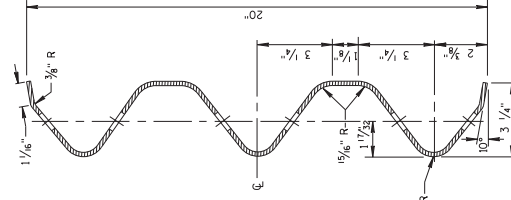

**SECTION THRU THRIE
BEAM RAIL ELEMENT**

Addendum No. 01
ID 5350-02-65/75
Added Sheet 82J
May 4, 2026

MIDWEST GUARDRAIL SYSTEM
THRIE BEAM TRANSITION (MGS)

STATE OF WISCONSIN
DEPARTMENT OF TRANSPORTATION

82J

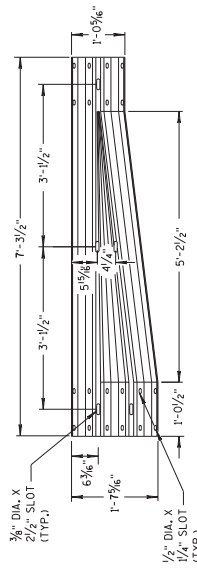

W-BEAM TO THRIE BEAM TRANSITION SECTION

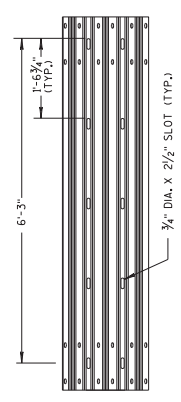

6'-3" THRIE BEAM SECTION

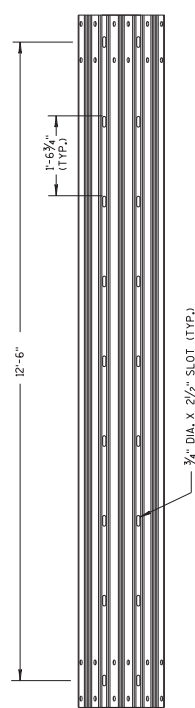

12'-6" THRIE BEAM SECTION

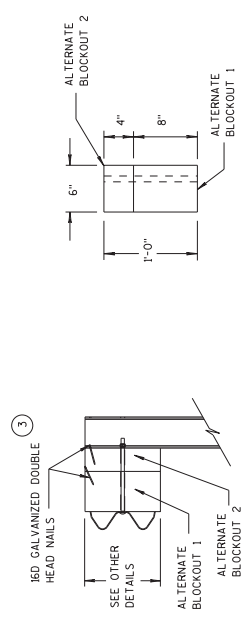

ALTERNATE WOOD BLOCKOUT DETAIL

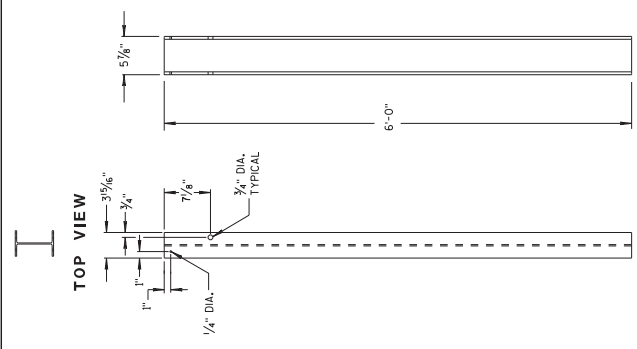

**FRONT VIEW SIDE VIEW
STEEL POSTS 1-5**

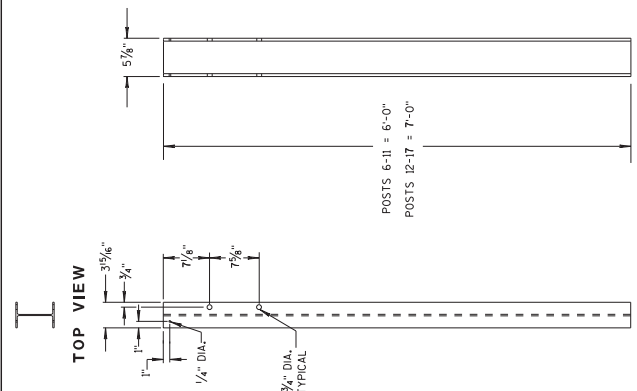

**FRONT VIEW SIDE VIEW
STEEL POSTS 6-17**

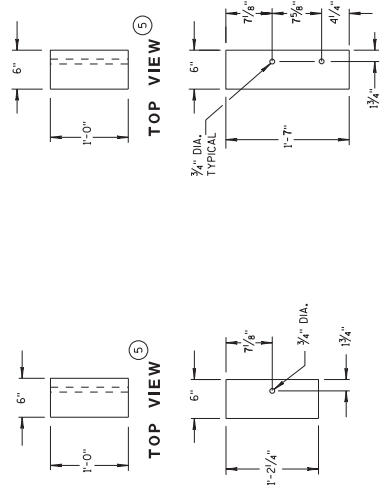

**FRONT VIEW TOP VIEW
BLOCKOUT POSTS 1-5**

**FRONT VIEW TOP VIEW
BLOCKOUT POSTS 6-17**

Addendum No. 01
ID 5350-02-65/75
Added Sheet 82K
May 4, 2026

GENERAL NOTES

- STEEL POSTS ARE W6X9 OR W6X8.5.
- BOLT HOLES FOR POST ARE ON FRONT AND OF SIDE OF POST.
- WHEN USING STEEL POSTS AND WOOD BLOCKOUTS INSTALL FOUR 16D GALVANIZED NAILS, INSTALL NAILS AT THE BACK CORNERS OF THE BLOCK AND BEND THE NAILS OVER THE FLANGE OF THE STEEL POST.
- SEE ALTERNATE WOOD BLOCK DETAIL.
- WOOD BLOCKS MAY BE CONSTRUCTED OUT OF 2 WOOD BLOCKS.
- STEEL OR WOOD POST IS ACCEPTABLE AT POST 1. SEE SDD 4B42.

MIDWEST GUARDRAIL SYSTEM
THRIE BEAM TRANSITION (MGS)
STATE OF WISCONSIN
DEPARTMENT OF TRANSPORTATION

82K

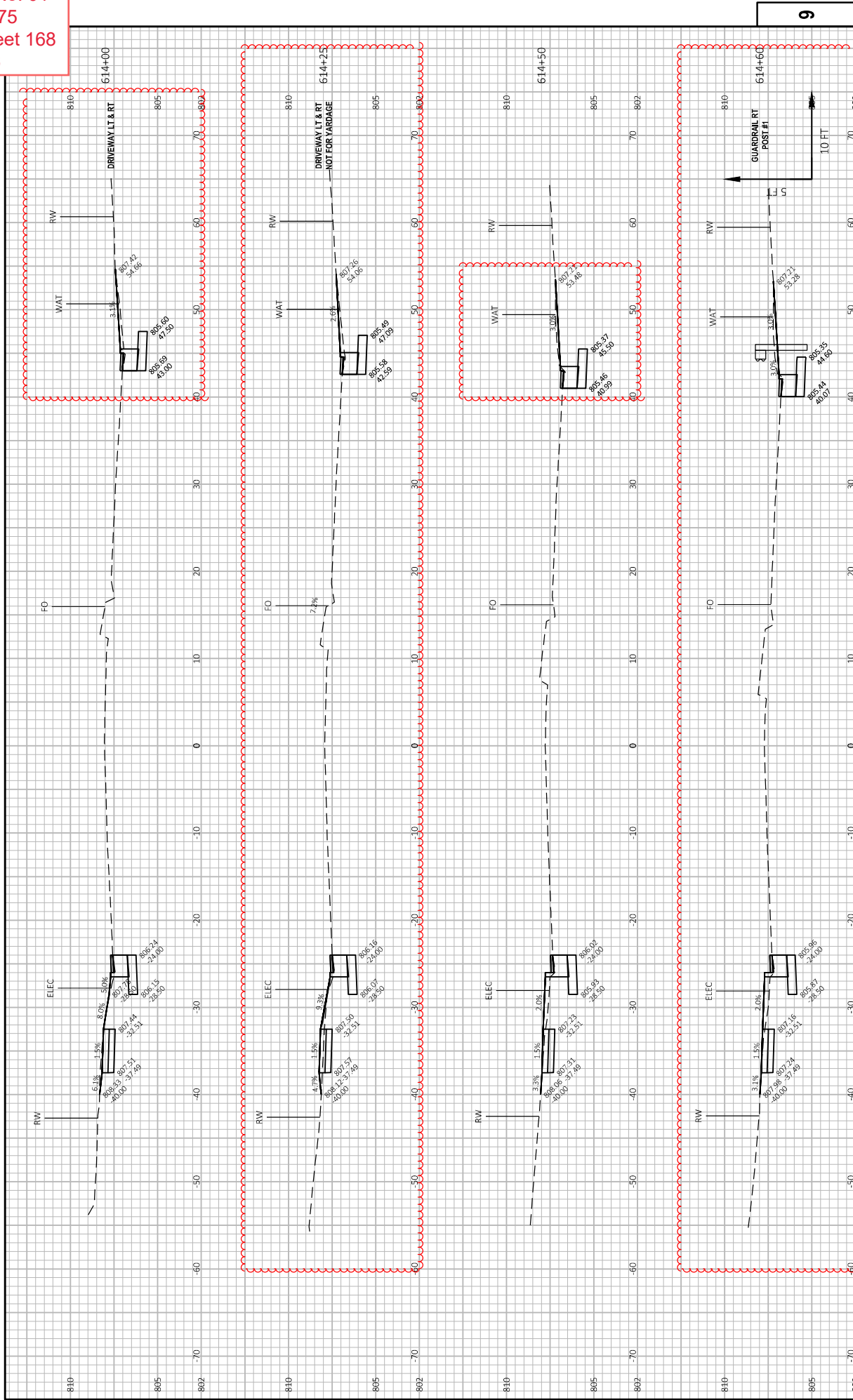

Addendum No. 01
 ID 5350-02-75
 Added Sheet 168A
 May 4, 2026

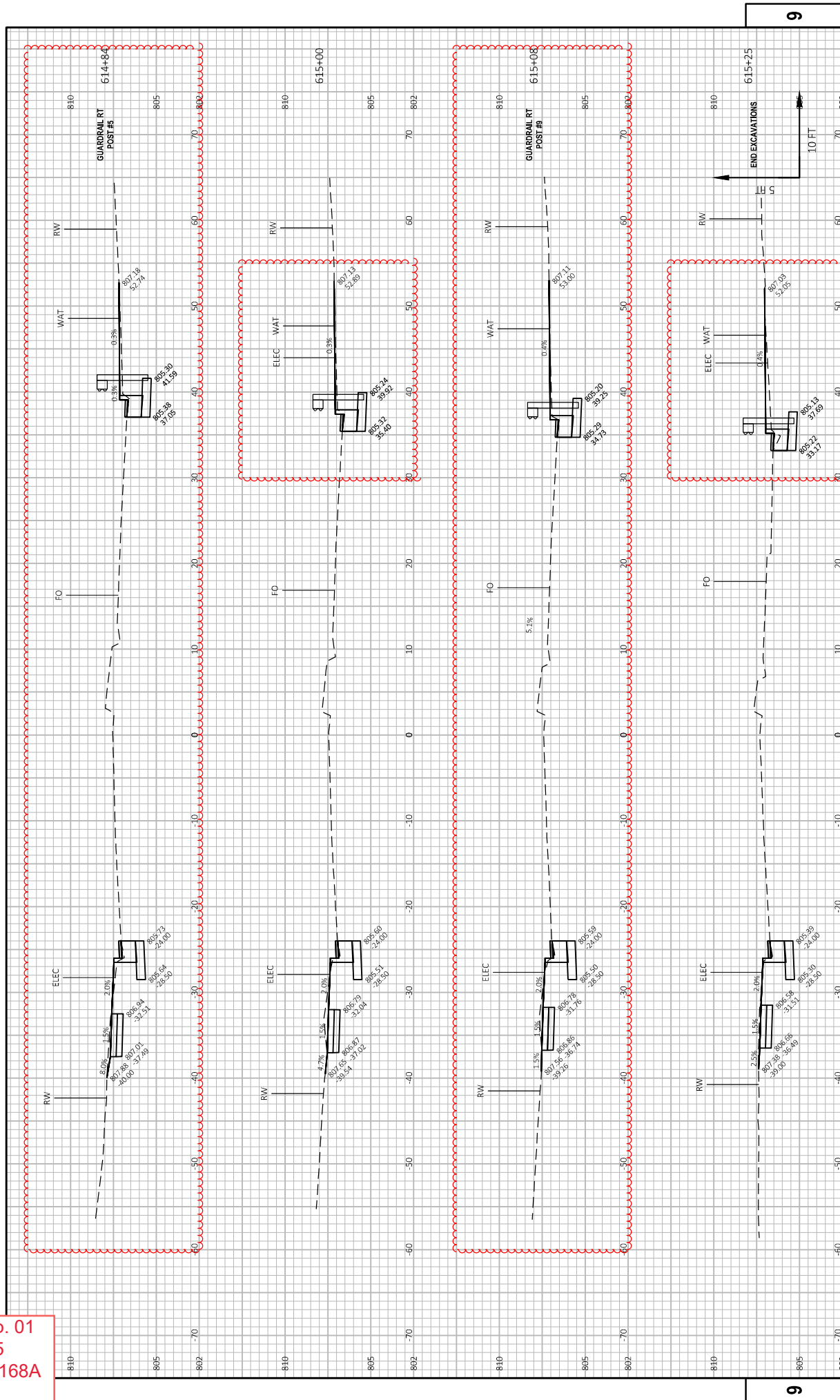



Proposal Schedule of Items

Proposal ID: 20260512003 Project(s): 5350-02-65, 5350-02-75

Federal ID(s): WISC 2026130, WISC 2026131

SECTION: 0001 Contract Items

Alt Set ID: Alt Mbr ID:

Proposal Line Number	Item ID Description	Approximate Quantity and Units	Unit Price	Bid Amount
0002	204.0100 Removing Concrete Pavement	265.000 SY	_____.	_____.
0004	204.0105 Removing Concrete Pavement Butt Joints	41.000 SY	_____.	_____.
0006	204.0109.S Removing Concrete Surface Partial Depth	26,238.000 SF	_____.	_____.
0008	204.0115 Removing Asphaltic Surface Butt Joints	107.000 SY	_____.	_____.
0010	204.0120 Removing Asphaltic Surface Milling	4,348.000 SY	_____.	_____.
0012	204.0150 Removing Curb & Gutter	529.000 LF	_____.	_____.
0014	204.0155 Removing Concrete Sidewalk	340.000 SY	_____.	_____.
0016	205.0100 Excavation Common	83.000 CY	_____.	_____.
0018	213.0100 Finishing Roadway (project) 001. 5350-02-65	1.000 EACH	_____.	_____.
0020	213.0100 Finishing Roadway (project) 002. 5350-02-75	1.000 EACH	_____.	_____.
0022	305.0120 Base Aggregate Dense 1 1/4-Inch	370.000 TON	_____.	_____.
0024	320.0145 Concrete Base 8-Inch	76.000 SY	_____.	_____.
0026	320.0165 Concrete Base 10-Inch	32.000 SY	_____.	_____.
0028	416.0610 Drilled Tie Bars	329.000 EACH	_____.	_____.
0030	416.1725 Concrete Pavement Replacement SHES	67.000 SY	_____.	_____.



Proposal Schedule of Items

Proposal ID: 20260512003 Project(s): 5350-02-65, 5350-02-75

Federal ID(s): WISC 2026130, WISC 2026131

SECTION: 0001 Contract Items

Alt Set ID: Alt Mbr ID:

Proposal Line Number	Item ID Description	Approximate Quantity and Units	Unit Price	Bid Amount
0032	455.0605 Tack Coat	397.000 GAL	_____	_____
0034	460.2000 Incentive Density HMA Pavement	520.000 DOL	1.00000	520.00
0036	460.6424 HMA Pavement 4 MT 58-28 H	807.000 TON	_____	_____
0038	465.0120 Asphaltic Surface Driveways and Field Entrances	3.000 TON	_____	_____
0040	502.3200 Protective Surface Treatment	383.000 SY	_____	_____
0042	502.3215 Protective Surface Treatment Reseal	121.000 SY	_____	_____
0044	509.0301 Preparation Decks Type 1	25.000 SY	_____	_____
0046	509.1200 Curb Repair	133.000 LF	_____	_____
0048	509.1500 Concrete Surface Repair	10.000 SF	_____	_____
0050	509.2500 Concrete Masonry Overlay Decks	22.000 CY	_____	_____
0052	509.9010.S Removing Asphaltic Concrete Deck Overlay (structure) 001. B-53-135	383.000 SY	_____	_____
0054	601.0417 Concrete Curb & Gutter 30-Inch Type K	687.000 LF	_____	_____
0056	601.0419 Concrete Curb & Gutter 30-Inch Type L	25.000 LF	_____	_____
0058	601.0600 Concrete Curb Pedestrian	79.000 LF	_____	_____
0060	602.0405 Concrete Sidewalk 4-Inch	2,741.000 SF	_____	_____



Proposal Schedule of Items

Proposal ID: 20260512003 Project(s): 5350-02-65, 5350-02-75

Federal ID(s): WISC 2026130, WISC 2026131

SECTION: 0001 Contract Items

Alt Set ID: Alt Mbr ID:

Proposal Line Number	Item ID Description	Approximate Quantity and Units	Unit Price	Bid Amount
0062	602.0415 Concrete Sidewalk 6-Inch	371.000 SF	_____.	_____.
0064	602.0515 Curb Ramp Detectable Warning Field Natural Patina	90.000 SF	_____.	_____.
0066	602.0615 Curb Ramp Detectable Warning Field Radial Natural Patina	16.000 SF	_____.	_____.
0068	602.0820 Concrete Driveway 8-Inch	86.000 SY	_____.	_____.
0070	611.8110 Adjusting Manhole Covers	4.000 EACH	_____.	_____.
0072	611.8115 Adjusting Inlet Covers	9.000 EACH	_____.	_____.
0074	619.1000 Mobilization	1.000 EACH	_____.	_____.
0076	620.0300 Concrete Median Sloped Nose	20.000 SF	_____.	_____.
0078	624.0100 Water	8.000 MGAL	_____.	_____.
0080	625.0100 Topsoil	543.000 SY	_____.	_____.
0082	627.0200 Mulching	20.000 SY	_____.	_____.
0084	628.1905 Mobilizations Erosion Control	5.000 EACH	_____.	_____.
0086	628.1910 Mobilizations Emergency Erosion Control	5.000 EACH	_____.	_____.
0088	628.7010 Inlet Protection Type B	12.000 EACH	_____.	_____.
0090	628.7015 Inlet Protection Type C	18.000 EACH	_____.	_____.



Proposal Schedule of Items

Proposal ID: 20260512003 Project(s): 5350-02-65, 5350-02-75

Federal ID(s): WISC 2026130, WISC 2026131

SECTION: 0001 Contract Items

Alt Set ID: Alt Mbr ID:

Proposal Line Number	Item ID Description	Approximate Quantity and Units	Unit Price	Bid Amount
0092	629.0210 Fertilizer Type B	0.360 CWT	_____.	_____.
0094	630.0200 Seeding Temporary	1.000 LB	_____.	_____.
0096	631.0300 Sod Water	14.000 MGAL	_____.	_____.
0098	631.1000 Sod Lawn	543.000 SY	_____.	_____.
0100	634.0616 Posts Wood 4x6-Inch X 16-FT	2.000 EACH	_____.	_____.
0102	634.0809 Posts Tubular Steel 2x2-Inch X 9.5-FT	2.000 EACH	_____.	_____.
0104	634.0811 Posts Tubular Steel 2x2-Inch X 11-FT	5.000 EACH	_____.	_____.
0106	634.0814 Posts Tubular Steel 2x2-Inch X 14-FT	2.000 EACH	_____.	_____.
0108	637.2210 Signs Type II Reflective H	77.750 SF	_____.	_____.
0110	637.2230 Signs Type II Reflective F	9.000 SF	_____.	_____.
0112	638.2102 Moving Signs Type II	2.000 EACH	_____.	_____.
0114	638.2602 Removing Signs Type II	4.000 EACH	_____.	_____.
0116	638.3000 Removing Small Sign Supports	2.000 EACH	_____.	_____.
0118	638.4000 Moving Small Sign Supports	2.000 EACH	_____.	_____.
0120	643.0300 Traffic Control Drums	8,131.000 DAY	_____.	_____.
0122	643.0420 Traffic Control Barricades Type III	2,316.000 DAY	_____.	_____.



Proposal Schedule of Items

Proposal ID: 20260512003 Project(s): 5350-02-65, 5350-02-75

Federal ID(s): WISC 2026130, WISC 2026131

SECTION: 0001 Contract Items

Alt Set ID: Alt Mbr ID:

Proposal Line Number	Item ID Description	Approximate Quantity and Units	Unit Price	Bid Amount
0124	643.0500 Traffic Control Flexible Tubular Marker Posts	25.000 EACH	_____.	_____.
0126	643.0600 Traffic Control Flexible Tubular Marker Bases	25.000 EACH	_____.	_____.
0128	643.0705 Traffic Control Warning Lights Type A	4,632.000 DAY	_____.	_____.
0130	643.0715 Traffic Control Warning Lights Type C	1,105.000 DAY	_____.	_____.
0132	643.0810 Traffic Control Connected Arrow Boards	160.000 DAY	_____.	_____.
0134	643.0900 Traffic Control Signs	6,252.000 DAY	_____.	_____.
0136	643.1050 Traffic Control Signs PCMS	42.000 DAY	_____.	_____.
0138	643.1070 Traffic Control Cones 42-Inch	9,276.000 DAY	_____.	_____.
0140	643.1220 Traffic Control Connected Work Zone Start and End Location Markers	315.000 DAY	_____.	_____.
0142	643.3165 Temporary Marking Line Paint 6-Inch	4,044.000 LF	_____.	_____.
0144	643.3180 Temporary Marking Line Removable Tape 6-Inch	9,389.000 LF	_____.	_____.
0146	643.3265 Temporary Marking Line Paint 10-Inch	70.000 LF	_____.	_____.
0148	643.3280 Temporary Marking Line Removable Tape 10-Inch	100.000 LF	_____.	_____.
0150	643.3305 Temporary Marking Crosswalk Paint 6-inch	167.000 LF	_____.	_____.



Proposal Schedule of Items

Proposal ID: 20260512003 Project(s): 5350-02-65, 5350-02-75

Federal ID(s): WISC 2026130, WISC 2026131

SECTION: 0001 Contract Items

Alt Set ID: Alt Mbr ID:

Proposal Line Number	Item ID Description	Approximate Quantity and Units	Unit Price	Bid Amount
0152	643.3350 Temporary Marking Crosswalk Removable Tape 6-Inch	315.000 LF	_____.	_____.
0154	643.3505 Temporary Marking Arrow Paint	1.000 EACH	_____.	_____.
0156	643.3550 Temporary Marking Arrow Removable Tape	2.000 EACH	_____.	_____.
0158	643.3960 Temporary Marking Removable Mask Out Tape 6-Inch	150.000 LF	_____.	_____.
0160	643.5000 Traffic Control	1.000 EACH	_____.	_____.
0162	644.1430 Temporary Pedestrian Surface Plate	50.000 SF	_____.	_____.
0164	644.1440 Temporary Pedestrian Surface Matting	80.000 SF	_____.	_____.
0166	644.1601 Temporary Pedestrian Curb Ramp	20.000 DAY	_____.	_____.
0168	644.1605 Temporary Pedestrian Detectable Warning Field	130.000 SF	_____.	_____.
0170	644.1810 Temporary Pedestrian Barricade	935.000 LF	_____.	_____.
0172	644.1900.S Temporary Audible Message Devices	230.000 DAY	_____.	_____.
0174	646.2020 Marking Line Epoxy 6-Inch	2,768.000 LF	_____.	_____.
0176	646.4020 Marking Line Epoxy 10-Inch	264.000 LF	_____.	_____.
0178	646.5020 Marking Arrow Epoxy	3.000 EACH	_____.	_____.
0180	646.6020 Marking Stop Line Epoxy 12-Inch	27.000 LF	_____.	_____.



Proposal Schedule of Items

Proposal ID: 20260512003 Project(s): 5350-02-65, 5350-02-75

Federal ID(s): WISC 2026130, WISC 2026131

SECTION: 0001 Contract Items

Alt Set ID: Alt Mbr ID:

Proposal Line Number	Item ID Description	Approximate Quantity and Units	Unit Price	Bid Amount
0182	646.6120 Marking Stop Line Epoxy 18-Inch	135.000 LF	_____.	_____.
0184	646.7420 Marking Crosswalk Epoxy Transverse Line 6-Inch	411.000 LF	_____.	_____.
0186	646.8120 Marking Curb Epoxy	26.000 LF	_____.	_____.
0188	646.8220 Marking Island Nose Epoxy	2.000 EACH	_____.	_____.
0190	646.9002 Marking Removal Line 6-Inch	225.000 LF	_____.	_____.
0192	650.4500 Construction Staking Subgrade	237.000 LF	_____.	_____.
0194	650.5500 Construction Staking Curb Gutter and Curb & Gutter	253.000 LF	_____.	_____.
0196	650.6501 Construction Staking Structure Layout (structure) 001. B-53-135	1.000 EACH	_____.	_____.
0198	650.8000 Construction Staking Resurfacing Reference	1,029.000 LF	_____.	_____.
0200	650.9000 Construction Staking Curb Ramps	12.000 EACH	_____.	_____.
0202	650.9500 Construction Staking Sidewalk (project) 001. 5350-02-75	1.000 EACH	_____.	_____.
0204	650.9911 Construction Staking Supplemental Control (project) 001. 5350-02-75	1.000 EACH	_____.	_____.
0206	650.9920 Construction Staking Slope Stakes	237.000 LF	_____.	_____.
0208	690.0150 Sawing Asphalt	68.000 LF	_____.	_____.



Proposal Schedule of Items

Proposal ID: 20260512003 Project(s): 5350-02-65, 5350-02-75

Federal ID(s): WISC 2026130, WISC 2026131

SECTION: 0001 Contract Items

Alt Set ID: Alt Mbr ID:

Proposal Line Number	Item ID Description	Approximate Quantity and Units	Unit Price	Bid Amount
0210	690.0250 Sawing Concrete	1,057.000 LF		
0212	715.0502 Incentive Strength Concrete Structures	500.000 DOL	1.00000	500.00
0214	ASP.1T0A On-the-Job Training Apprentice at \$5.00/HR	1,200.000 HRS	5.00000	6,000.00
0216	ASP.1T0G On-the-Job Training Graduate at \$5.00/HR	600.000 HRS	5.00000	3,000.00
0218	SPV.0060 Special 101. Utility Line Opening (ULO)	10.000 EACH		
0220	SPV.0060 Special 102. Adjusting Water Valve Boxes	3.000 EACH		
0222	SPV.0060 Special 103. Storm Sewer Structure Repair	1.000 EACH		
0224	SPV.0060 Special 104. Manhole Covers Type COJ	1.000 EACH		
0226	SPV.0060 Special 105. Installing City Supplied Street Name Signs	2.000 EACH		
0228	SPV.0060 Special 401. Near-Surface Mounted Carbon Fiber Reinforcement	22.000 EACH		
0230	SPV.0090 Special 101. Concrete Curb & Gutter 18-Inch Type K	13.000 LF		
0232	SPV.0090 Special 102. Concrete Joint and Crack Plunge Milling and Patching	568.000 LF		
0234	SPV.0090 Special 103. Concrete Joint and Crack Cleaning	1,256.000 LF		



Proposal Schedule of Items

Proposal ID: 20260512003 Project(s): 5350-02-65, 5350-02-75

Federal ID(s): WISC 2026130, WISC 2026131

SECTION: 0001 Contract Items

Alt Set ID: Alt Mbr ID:

Proposal Line Number	Item ID Description	Approximate Quantity and Units	Unit Price	Bid Amount
0236	203.0211.S Abatement of Asbestos Containing Material (structure) 001. Barrier Walls	1.000 EACH	_____.	_____.
0238	204.0157 Removing Concrete Barrier	9.000 LF	_____.	_____.
0240	513.9006.S Removing and Resetting Tubular Railing (structure) 001. Barrier Walls	1.000 EACH	_____.	_____.
0242	601.0590 Concrete Curb & Gutter 4-Inch Sloped 36-Inch Type TBTT	45.000 LF	_____.	_____.
0244	603.0105 Concrete Barrier Single-Faced 32-Inch	7.000 LF	_____.	_____.
0246	614.2300 MGS Guardrail 3	25.000 LF	_____.	_____.
0248	614.2500 MGS Thrie Beam Transition	39.000 LF	_____.	_____.
0250	614.2610 MGS Guardrail Terminal EAT	1.000 EACH	_____.	_____.
Section: 0001			Total:	_____.
			Total Bid:	_____.

