

**GENERAL NOTES**

DETAILS OF CONSTRUCTION, MATERIALS AND WORKMANSHIP NOT SHOWN ON THIS DRAWING SHALL CONFORM TO THE PERTINENT REQUIREMENTS OF THE STANDARD SPECIFICATIONS AND THE APPLICABLE SPECIAL PROVISIONS.

ALL STEEL REINFORCEMENT SHALL BE EMBEDDED 2 INCHES CLEAR UNLESS OTHERWISE SHOWN OR NOTED.

- ① USE A JOINT SEALANT CONFORMING TO STANDARD SPECIFICATION 415.2.6.
- ② NO. 4 X 2' - 0" TIE BARS SPACED AT 12" C-C TO BE PLACED BY BRIDGE CONTRACTOR OR DRILLED TIE BARS PLACED AS DIRECTED BY THE ENGINEER.
- ③ PAVED CONCRETE SHOULDER (SDD 13A03) OR CONCRETE DRAINAGE SLAB.
- ④ CONCRETE PAVEMENT APPROACH SLAB (SHOWN) OR STRUCTURE APPROACH SLAB AND CONCRETE PAVEMENT APPROACH SLAB. SEE SDD 13B02.
- ⑤ PAVED CONCRETE SHOULDER (SDD 13A03) OR ASPHALT SHOULDER.

- ⑥ CONCRETE CURB AND GUTTER 4-INCH SLOPED 36-INCH TYPE TBT OR TBTT. USE TYPE TBTT CURB WITH NO. 4 X 2' - 0" TIE BARS SPACED AT 3' - 0" C-C ONLY WHEN ADJACENT TO CONCRETE PAVEMENTS.
- ⑦ PLACE FLUME BEFORE MSG THRIE BEAM TRANSITION POST 1 (SEE SDD 14B45)
- ⑧ CENTER FLUME BETWEEN POSTS. 6-INCH MINIMUM SEPARATION FROM OUTSIDE EDGE OF FLUME TO POSTS.
- ⑨ MINIMUM REINFORCEMENT SHALL BE 4" X 4" - W3.0 X W3.0 OR NO. 3 BARS LONGITUDINAL AND TRANSVERSE SPACING 12" C-C.
- ⑩ SEE ROADWAY PLANS FOR FLUME LOCATION.
- ⑪ START CURB AND GUTTER TRANSITION OR END SECTION.
- ⑫ DEPRESS FLOW LINE (SEE DETAIL)

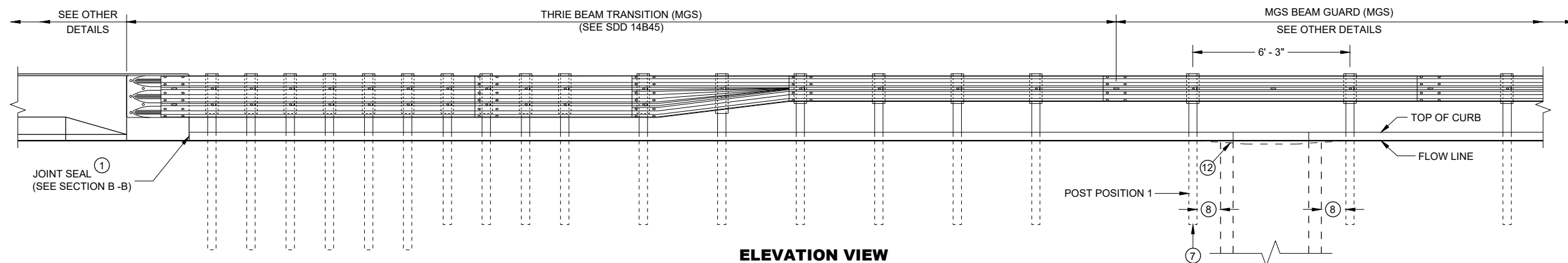
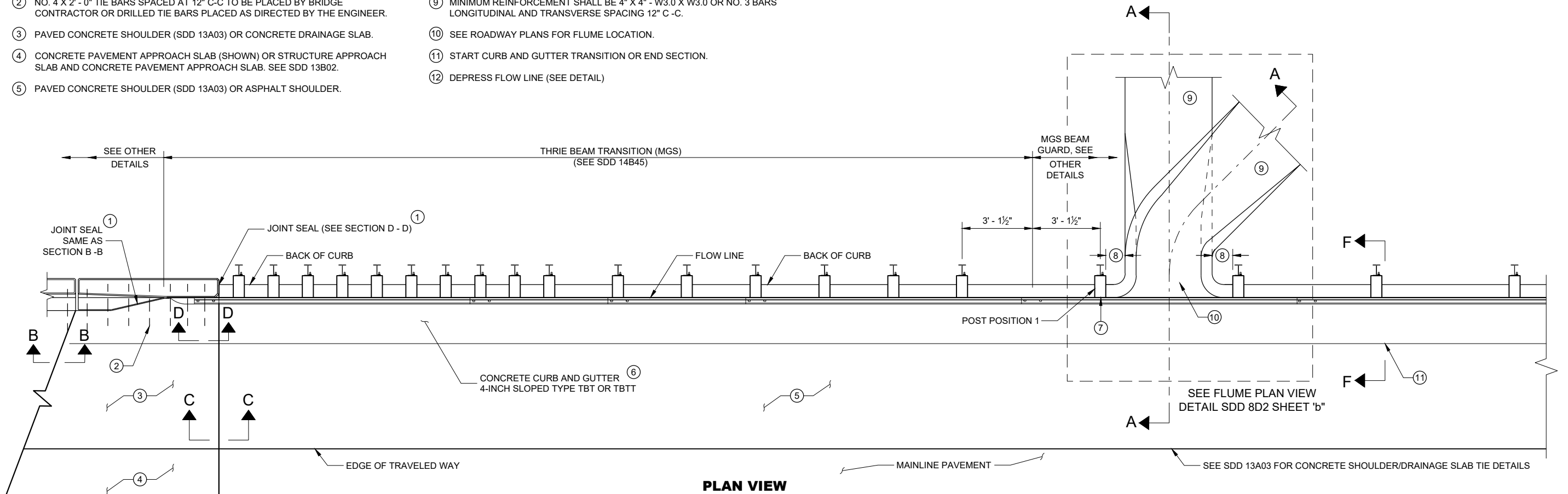

**CONCRETE SURFACE  
DRAINS FLUME TYPE  
AT STRUCTURES**

STATE OF WISCONSIN  
DEPARTMENT OF TRANSPORTATION

6

6

SDD 08D02 - 08a

SDD 08D02 - 08a

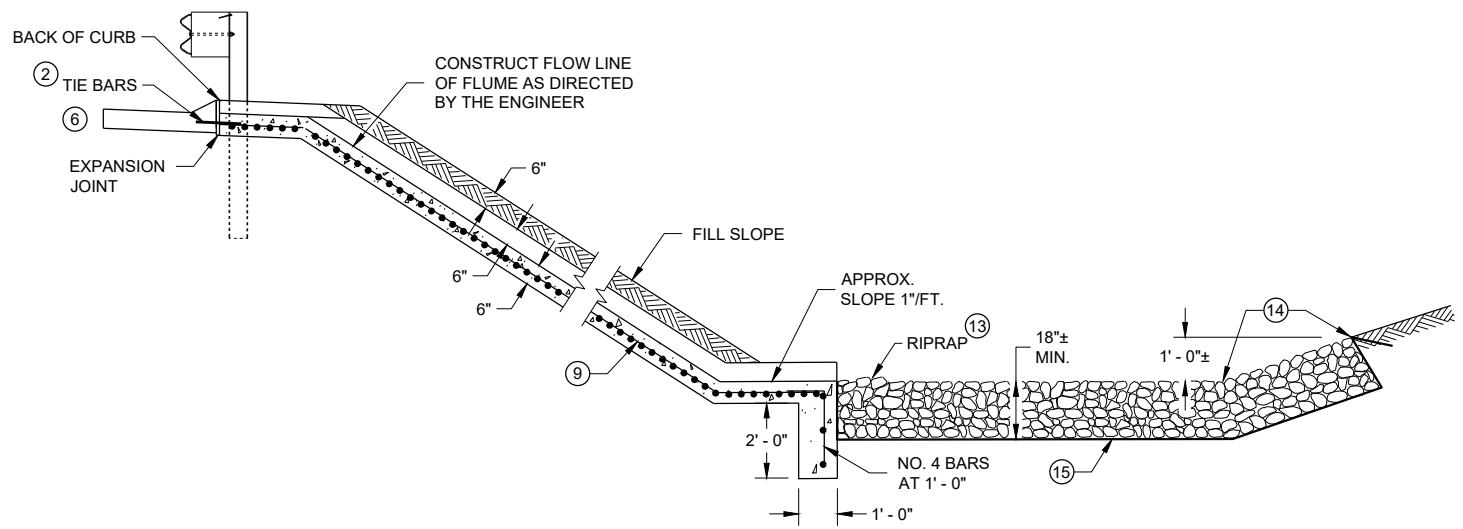

**SECTION A - A**

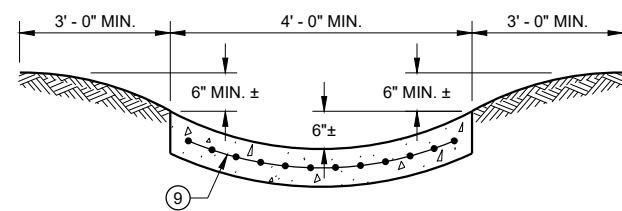

**SECTION G - G**

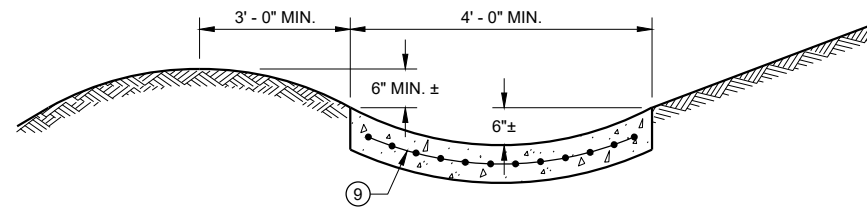

**SECTION H - H**

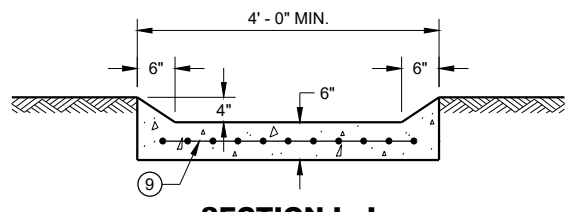

**SECTION I - I**

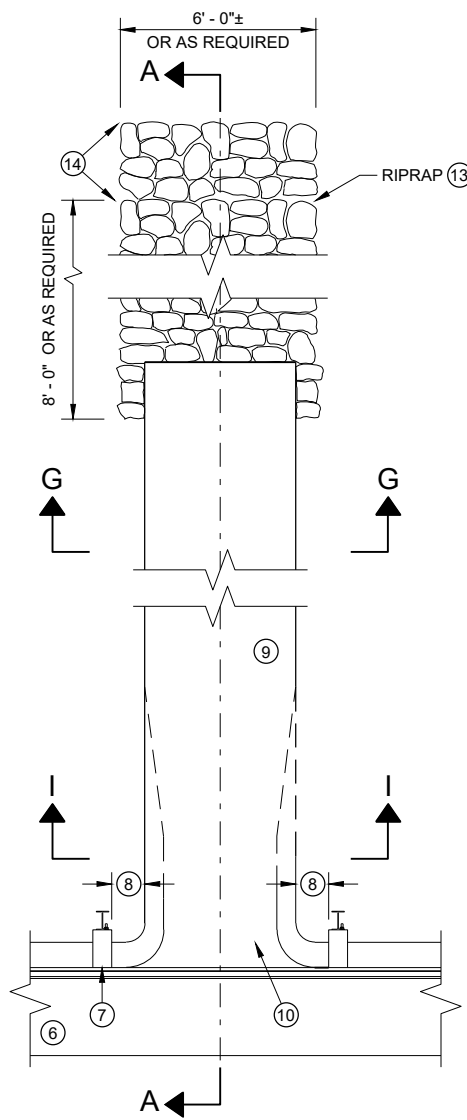

**PLAN VIEW PERPENDICULAR FLUME**

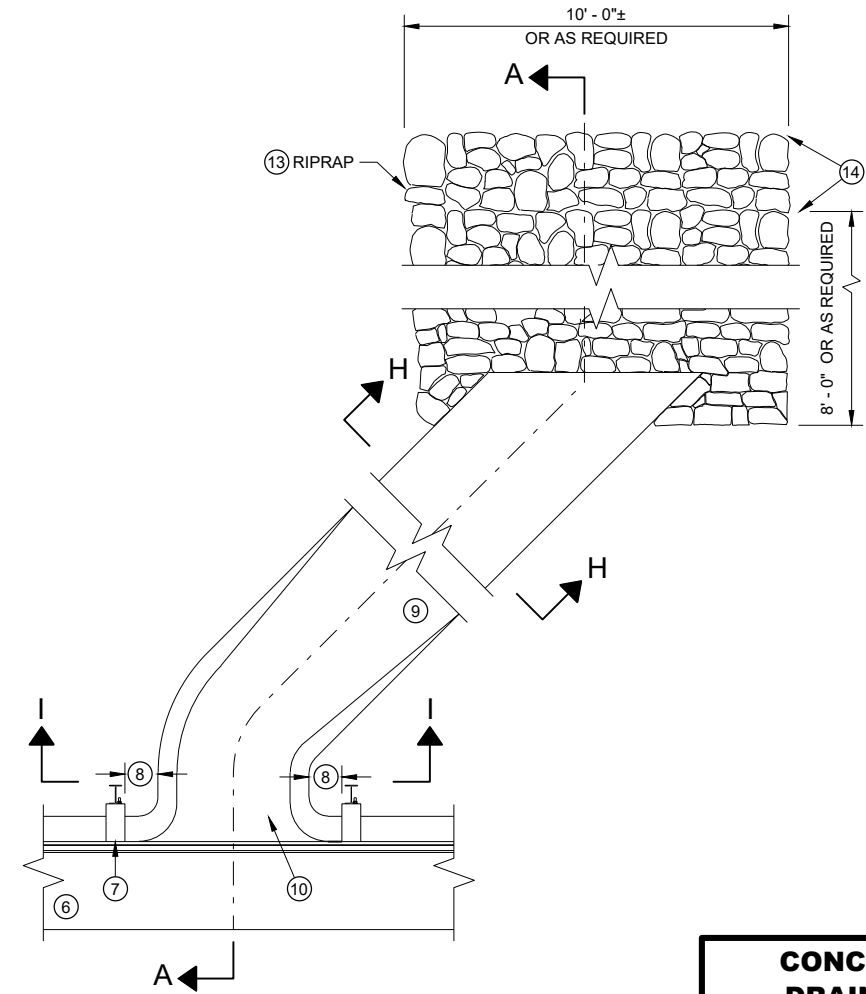

**PLAN VIEW SKEWED FLUME**

**GENERAL NOTES**

DETAILS OF CONSTRUCTION, MATERIALS AND WORKMANSHIP NOT SHOWN ON THIS DRAWING SHALL CONFORM TO THE PERTINENT REQUIREMENTS OF THE STANDARD SPECIFICATIONS AND THE APPLICABLE SPECIAL PROVISIONS.

ALL STEEL REINFORCEMENT SHALL BE EMBEDDED 2 INCHES CLEAR UNLESS OTHERWISE SHOWN OR NOTED.

- USE A JOINT SEALANT CONFORMING TO STANDARD SPECIFICATION 415.2.6.
- NO. 4 X 2'-0" TIE BARS SPACED AT 12" C-C TO BE PLACED BY BRIDGE CONTRACTOR OR DRILLED TIE BARS PLACED AS DIRECTED BY THE ENGINEER.
- PAVED CONCRETE SHOULDER (SDD 13A03) OR CONCRETE DRAINAGE SLAB.
- CONCRETE PAVEMENT APPROACH SLAB (SHOWN) OR STRUCTURE APPROACH SLAB AND CONCRETE PAVEMENT APPROACH SLAB. SEE SDD 13B02 AND STRUCTURE PLANS.
- PAVED CONCRETE SHOULDER (SDD 13A03) OR ASPHALT SHOULDER.
- CONCRETE CURB AND GUTTER 4-INCH SLOPED 36-INCH TYPE TBT OR TBTT. USE TYPE TBTT CURB WITH NO. 4 X 2'-0" TIE BARS SPACED AT 3'-0" C-C ONLY WHEN ADJACENT TO CONCRETE PAVEMENTS.

- PLACE FLUME BEFORE MSG THRIE BEAM TRANSITION POST 1 (SEE SDD 14B45)
- CENTER FLUME BETWEEN POSTS. 6-INCH MINIMUM SEPARATION FROM OUTSIDE EDGE OF FLUME TO POSTS.
- MINIMUM REINFORCEMENT SHALL BE 4" X 4" - W3.0 X W3.0 OR NO. 3 BARS LONGITUDINAL AND TRANSVERSE SPACING 12" C -C.
- SEE ROADWAY PLANS FOR FLUME LOCATION.
- START CURB AND GUTTER TRANSITION OR END SECTION.
- DEPRESS FLOW LINE (SEE DETAIL)
- MEDIUM RIPRAP UNLESS OTHERWISE SPECIFIED.
- LIMITS OF ADDITIONAL RIPRAP WHEN SPECIAL DITCH AS REQUIRED.
- GEOTEXTILE TYPE HR.

6

6

SDD 08D02 - 08b

SDD 08D02 - 08b

**CONCRETE SURFACE DRAINS FLUME TYPE AT STRUCTURES**

STATE OF WISCONSIN  
DEPARTMENT OF TRANSPORTATION

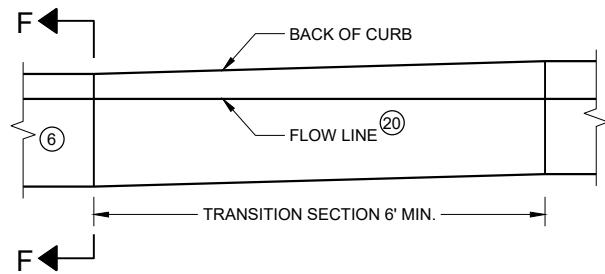

**CURB AND GUTTER TRANSITION SECTION  
CONCRETE CURB AND GUTTER 4-INCH SLOPED  
36 INCH TYPE TBT OR TBTT**

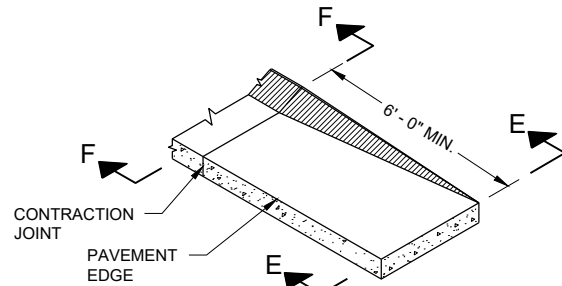

**CURB AND GUTTER END SECTION  
CONCRETE CURB AND GUTTER 4-INCH SLOPED  
36 INCH TYPE TBT OR TBTT**

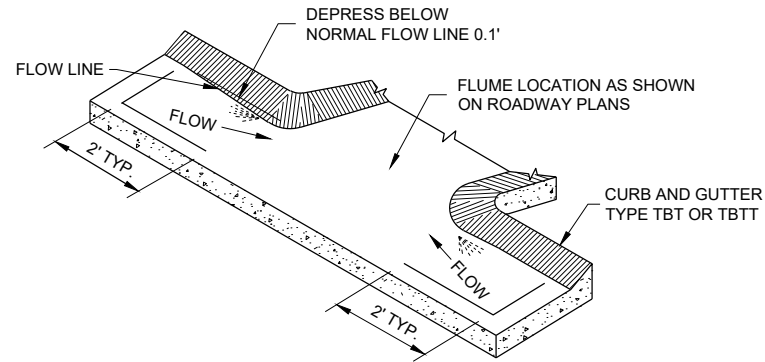

**CURB AND GUTTER FLOW LINE DEPRESSION  
AT FLUMES CONCRETE CURB AND GUTTER  
4-INCH SLOPED 36 INCH TYPE TBT OR TBTT**

**GENERAL NOTES**

DETAILS OF CONSTRUCTION, MATERIALS AND WORKMANSHIP NOT SHOWN ON THIS DRAWING SHALL CONFORM TO THE PERTINENT REQUIREMENTS OF THE STANDARD SPECIFICATIONS AND THE APPLICABLE SPECIAL PROVISIONS.

ALL STEEL REINFORCEMENT SHALL BE EMBEDDED 2 INCHES CLEAR UNLESS OTHERWISE SHOWN OR NOTED.

- ① USE A JOINT SEALANT CONFORMING TO STANDARD SPECIFICATION 415.2.6.
- ② NO. 4 X 2' - 0" TIE BARS SPACED AT 12" C-C TO BE PLACED BY BRIDGE CONTRACTOR OR DRILLED TIE BARS PLACED AS DIRECTED BY THE ENGINEER.
- ③ PAVED CONCRETE SHOULDER (SDD 13A03) OR CONCRETE DRAINAGE SLAB.
- ④ CONCRETE PAVEMENT APPROACH SLAB (SHOWN) OR STRUCTURE APPROACH SLAB AND CONCRETE PAVEMENT APPROACH SLAB. SEE SDD 13B02 AND STRUCTURE PLANS.
- ⑤ PAVED CONCRETE SHOULDER (SDD 13A03) OR ASPHALT SHOULDER.
- ⑥ CONCRETE CURB AND GUTTER 4-INCH SLOPED 36-INCH TYPE TBT OR TBTT. USE TYPE TBTT CURB WITH NO. 4 X 2' - 0" TIE BARS SPACED AT 3' - 0" C-C ONLY WHEN ADJACENT TO CONCRETE PAVEMENTS.
- ⑦ PLACE FLUME BEFORE MSG THRIE BEAM TRANSITION POST 1 (SEE SDD 14B45)
- ⑧ CENTER FLUME BETWEEN POSTS. 6-INCH MINIMUM SEPARATION FROM OUTSIDE EDGE OF FLUME TO POSTS.
- ⑨ MINIMUM REINFORCEMENT SHALL BE 4" X 4" - W3.0 X W3.0 OR NO. 3 BARS LONGITUDINAL AND TRANSVERSE SPACING 12" C-C.
- ⑩ SEE ROADWAY PLANS FOR FLUME LOCATION.
- ⑪ START CURB AND GUTTER TRANSITION OR END SECTION.
- ⑫ DEPRESS FLOW LINE (SEE DETAIL)
- ⑬ MEDIUM RIPRAP UNLESS OTHERWISE SPECIFIED.
- ⑭ LIMITS OF ADDITIONAL RIPRAP WHEN SPECIAL DITCH IS REQUIRED.
- ⑮ GEOTEXTILE TYPE HR.
- ⑯ MINIMUM REINFORCEMENT SHALL BE 6" X 6" - W4.0 X W4.0 OR NO. 3 BARS LONGITUDINAL AND TRANSVERSE SPACING 12" C-C.
- ⑰ MSG THRIE BEAM TRANSITION POST 1. SEE SDD 14B45 FOR ADDITIONAL CONSTRUCTION DETAILS AND ACCEPTABLE MATERIALS.
- ⑱ MAINTAIN WIDTH, THICKNESS AND CROSS SLOPE OF ADJACENT TYPE TBT OR TBTT CURB. SEE NOTE 6 FOR TIE BAR SPACING.
- ⑲ ALIGN FACE OF POST BLOCK WITH FLOW LINE.
- ⑳ MAINTAIN FLOW LINE AT EDGE OF PAVEMENT/FACE OF BEAM GUARD AS APPLICABLE.
- ㉑ DO NOT CONSTRUCT AN EXPANSION JOINT OR INSTALL DOWEL BARS WHEN ABUTTING HMA PAVEMENTS.

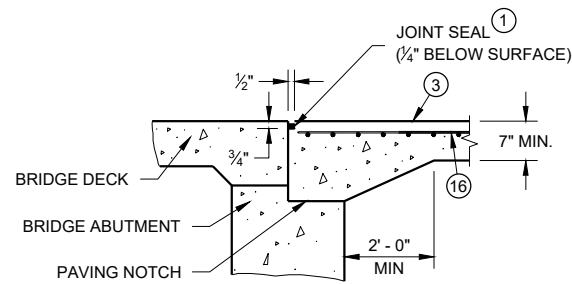

**SECTION B-B**

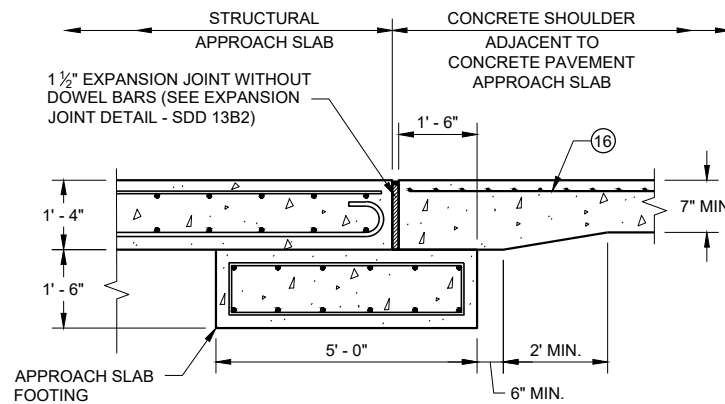

**SECTION C - C  
JOINT DETAIL FOR BRIDGE WITH STRUCTURAL  
APPROACH SLAB AND CONCRETE APPROACH SLAB**

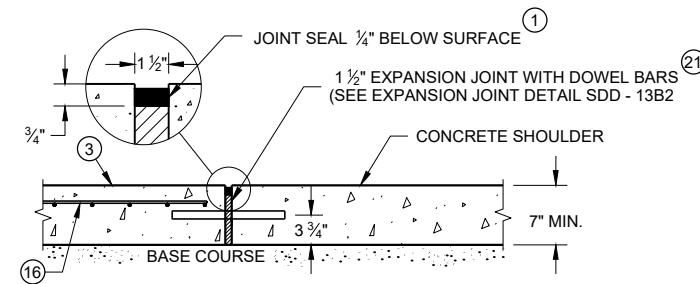

**SECTION C - C  
JOINT DETAIL FOR BRIDGE APPROACH  
WITH CONCRETE SHOULDERS**

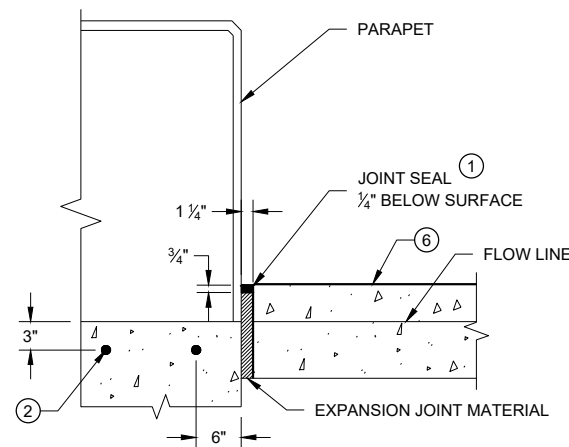

**SECTION D - D**

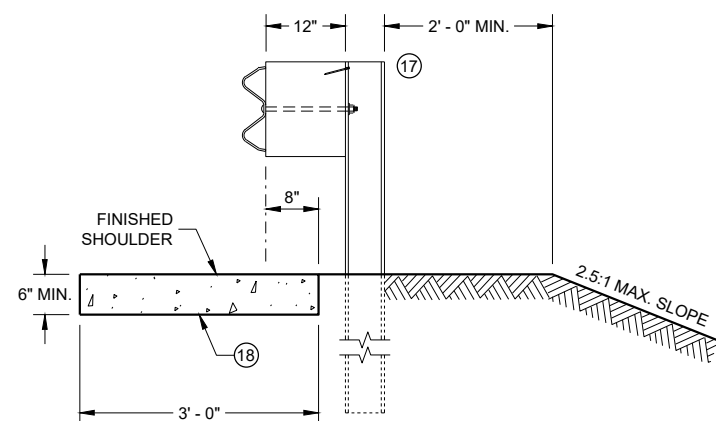

**SECTION E - E**

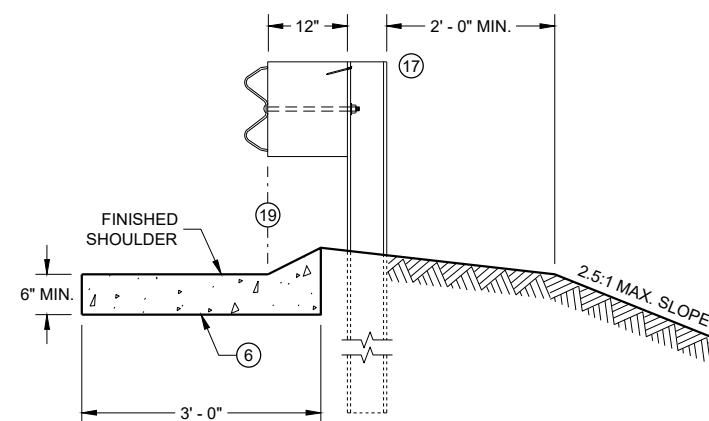

**SECTION F - F**

6

6

SDD08D02 - 08C

SDD08D02 - 08C

**CONCRETE SURFACE  
DRAINS FLUME TYPE  
AT STRUCTURES**

STATE OF WISCONSIN  
DEPARTMENT OF TRANSPORTATION

APPROVED  
May 2023 /S/ Rodney Taylor  
DATE ROADWAY STANDARDS DEVELOPMENT  
ENGINEER

FHWA

*Concrete Surface Drains Flume Type at Structures***References:**

NONE

**Bid items associated with this drawing:**

<u>ITEM NUMBER</u>	<u>DESCRIPTION</u>	<u>UNIT</u>
415.0060 - 0199	Concrete Pavement (Inch).....	SY
415.1080 - 1199	Concrete Pavement HES (Inch) .....	SY
416.0610	Drilled Tie Bars .....	EACH
601.0588	Concrete Curb & Gutter 4-Inch Sloped 36-Inch Type TBT .....	LF
601.0590	Concrete Curb & Gutter 4-Inch Sloped 36-Inch Type TBTT .....	LF
602.3010	Concrete Surface Drains .....	CY
602.3015	Concrete Surface Drains HES .....	CY
606.0200	Riprap Medium .....	CY
645.0120	Geotextile Type HR .....	SY

**Standardized Special Provisions associated with this drawing:**

<u>STSP NUMBER</u>	<u>TITLE</u>
NONE	

**Other SDDs associated with this drawing:**

<a href="#">SDD 13A3</a>	Concrete Pavement Shoulders
<a href="#">SDD 13B2</a>	Concrete Pavement Approach Slab Sheet "a" is required
<a href="#">SDD 13B2</a>	Concrete Pavement Approach Slab Sheet "b" is required with Structure Approach Slabs
<a href="#">SDD 14B45</a>	Midwest Guardrail System (MGS) Thrie Beam Transition Sheets "a"- "c" minimum.

**Design Notes:**

Show flume station and offset locations on roadway plans or storm sewer table. Add a plan note that final placement of the flume must maintain the minimum post separation distances in the standard detail.

Indicate on roadway plans if a perpendicular or angled flume is required for each location.

When tie bars (see general note 2) are not shown in the bridge drawings, include in plans as "drilled tie bars."

**Contact Person:**

Ed Lilla (608) 266-2312