

**PRELIMINARY  
US 8 IMPROVEMENTS**

PROJECT I.D. 1590-18-01  
WIS 55 SOUTH TO WIS 32 SOUTH  
US 8  
FOREST COUNTY  
MAP 1 OF 4

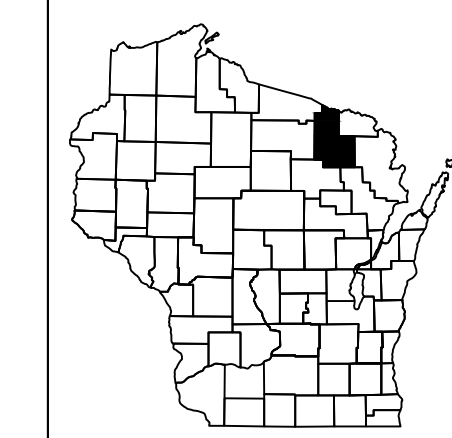

- LEGEND**
- SLOPE INTERCEPT / GRADING LIMITS
  - EXISTING RIGHT-OF-WAY
  - MUNICIPAL BOUNDARY
  - PROPOSED RIGHT-OF-WAY

PRELIMINARY  
PUBLIC INVOLVEMENT  
EXHIBIT DATE: August 4, 2022  
SCALE: 1 INCH = 200 FEET



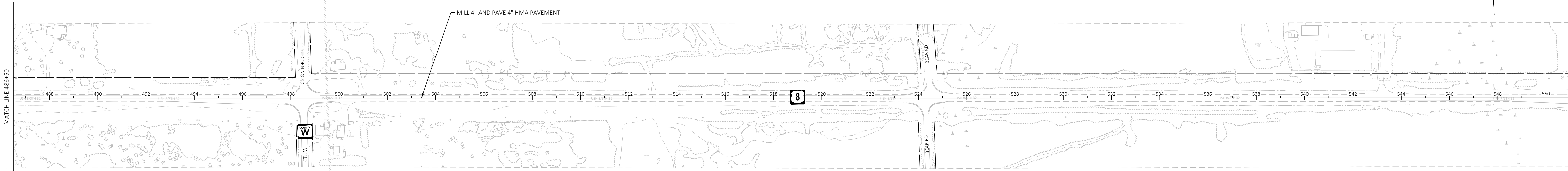

CRANDON

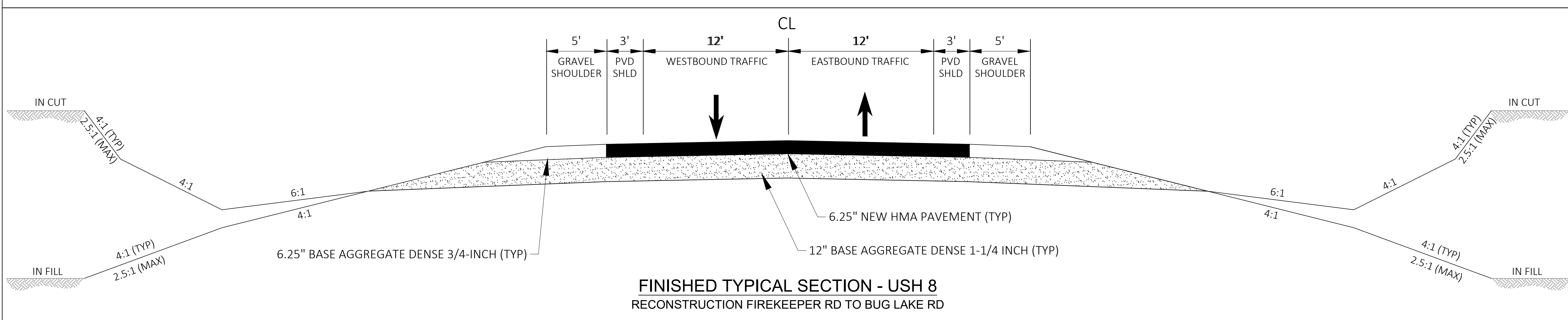
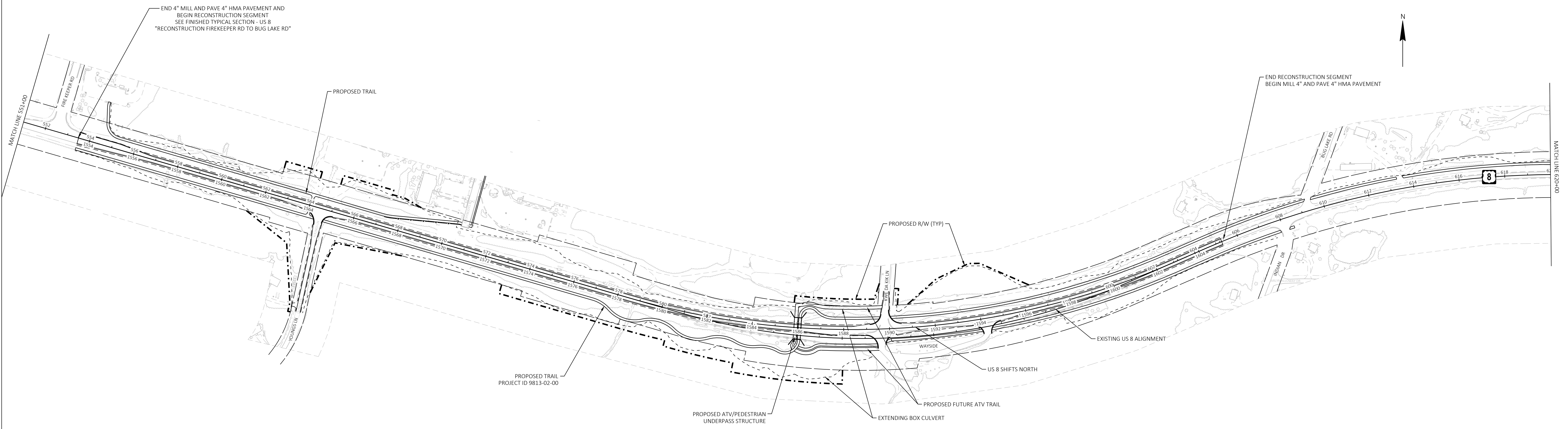

**PRELIMINARY  
US 8 IMPROVEMENTS**

**PROJECT I.D. 1590-18-01**  
**WIS 55 SOUTH TO WIS 32 SOUTH**  
**US 8**  
**FOREST COUNTY**  
**MAP 2 OF 4**

- LEGEND**
- SLOPE INTERCEPT / GRADING LIMITS
  - - - EXISTING RIGHT-OF-WAY
  - MUNICIPAL BOUNDARY
  - - - PROPOSED RIGHT-OF-WAY

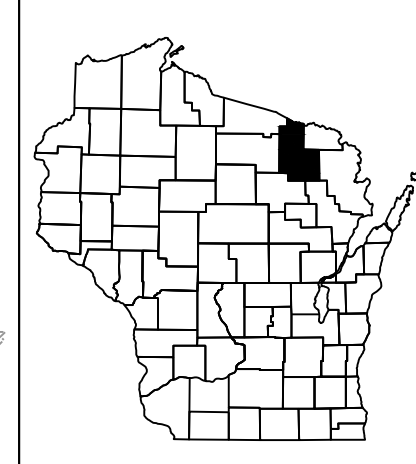

PRELIMINARY  
PUBLIC INVOLVEMENT  
EXHIBIT DATE: August 4, 2022  
SCALE: 1 INCH = 200 FEET



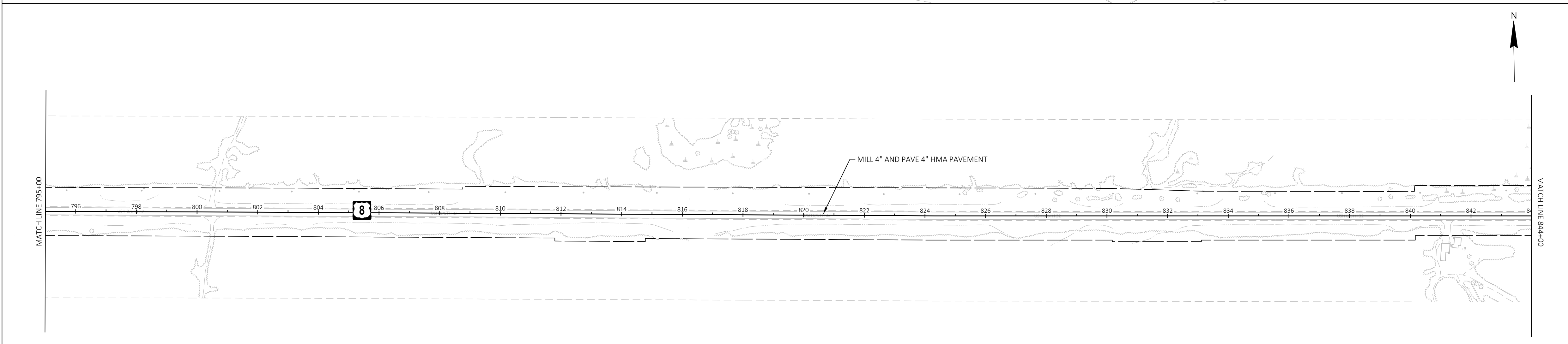
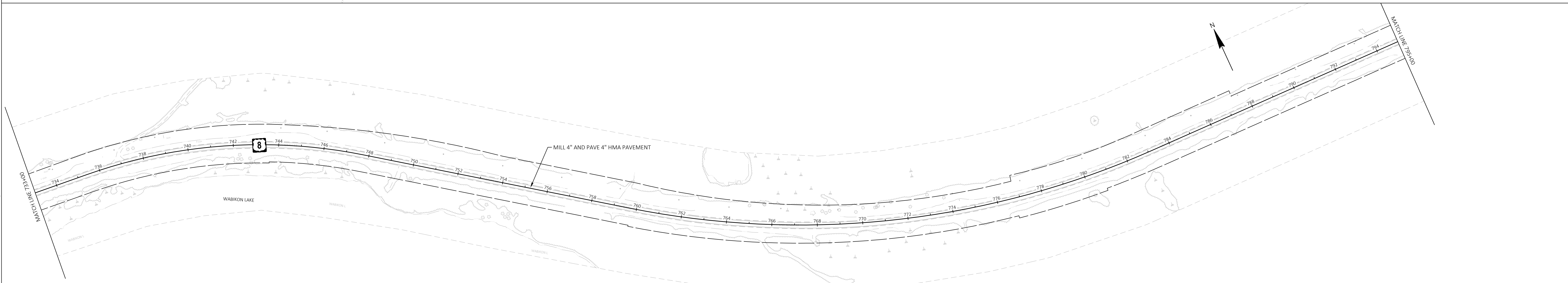
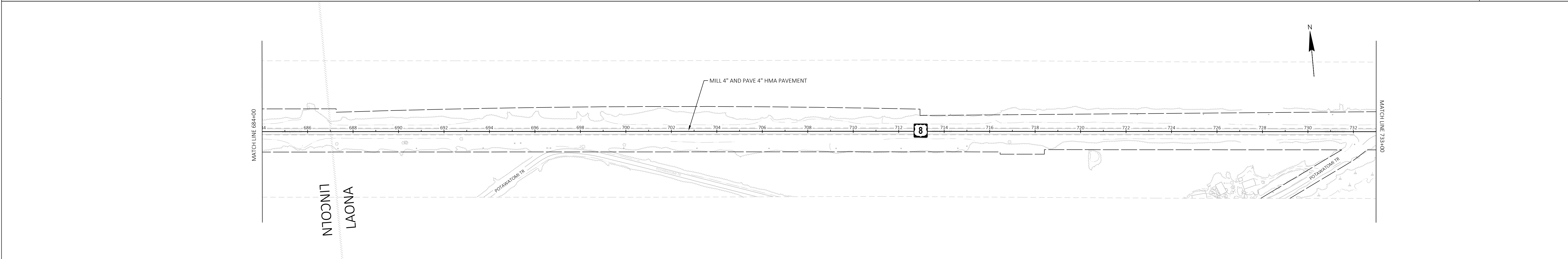
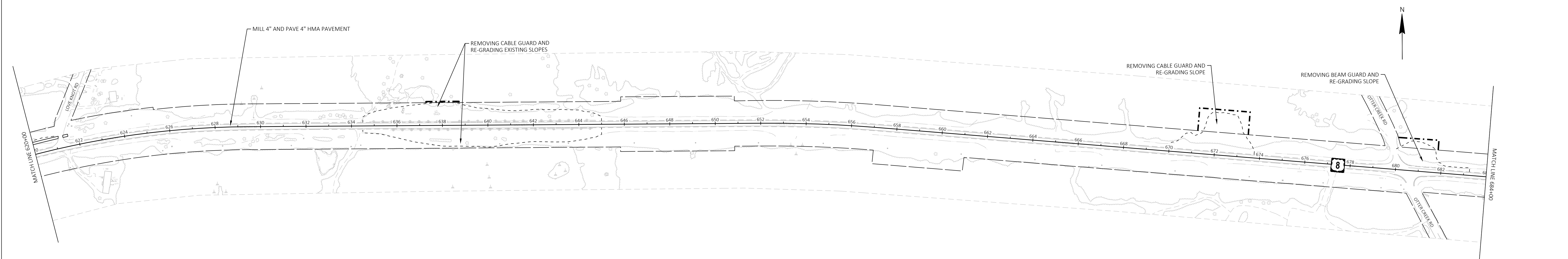

**PRELIMINARY  
US 8 IMPROVEMENTS**

**PROJECT I.D. 1590-18-01  
WIS 55 SOUTH TO WIS 32 SOUTH  
US 8  
FOREST COUNTY  
MAP 3 OF 4**

**LEGEND**

- SLOPE INTERCEPT / GRADING LIMITS
- EXISTING RIGHT-OF-WAY
- MUNICIPAL BOUNDARY
- PROPOSED RIGHT-OF-WAY

PRELIMINARY  
PUBLIC INVOLVEMENT  
EXHIBIT DATE: August 4, 2022  
SCALE: 1 INCH = 200 FEET

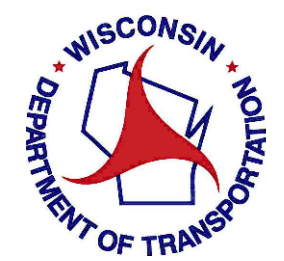

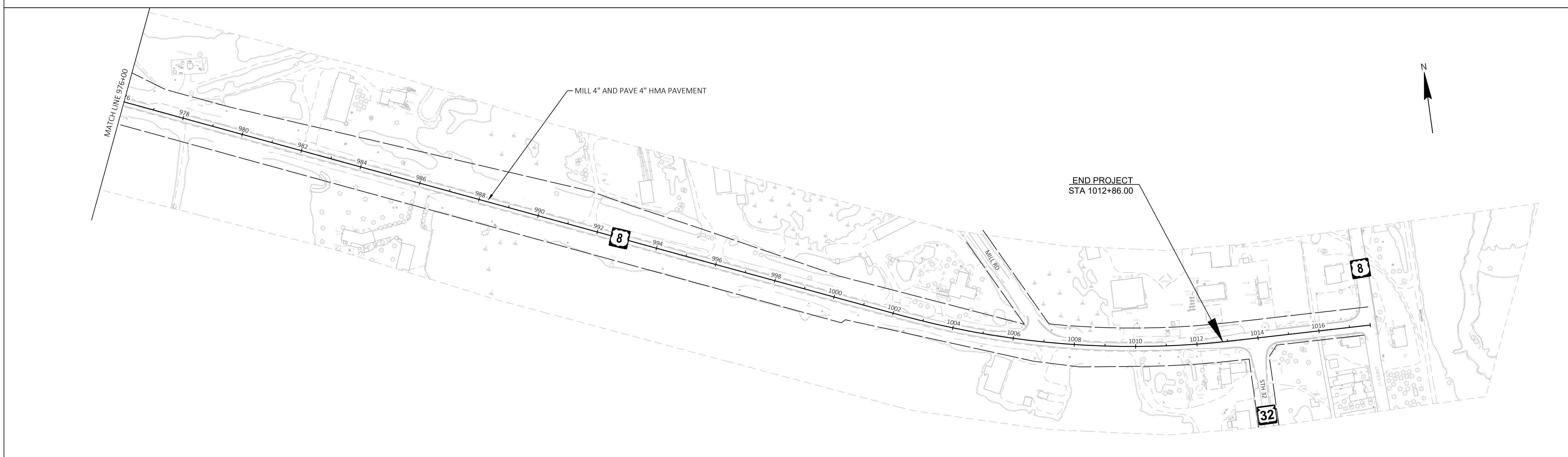
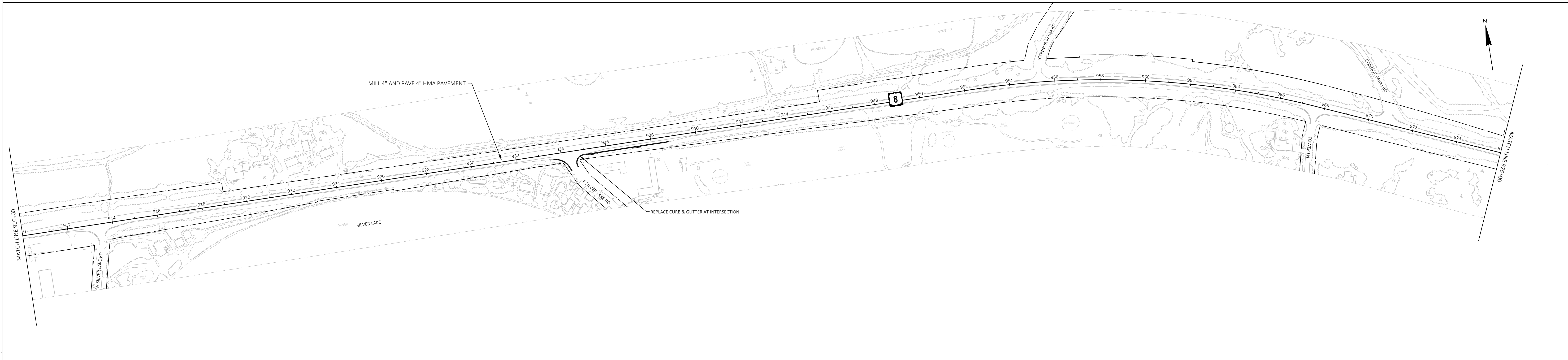
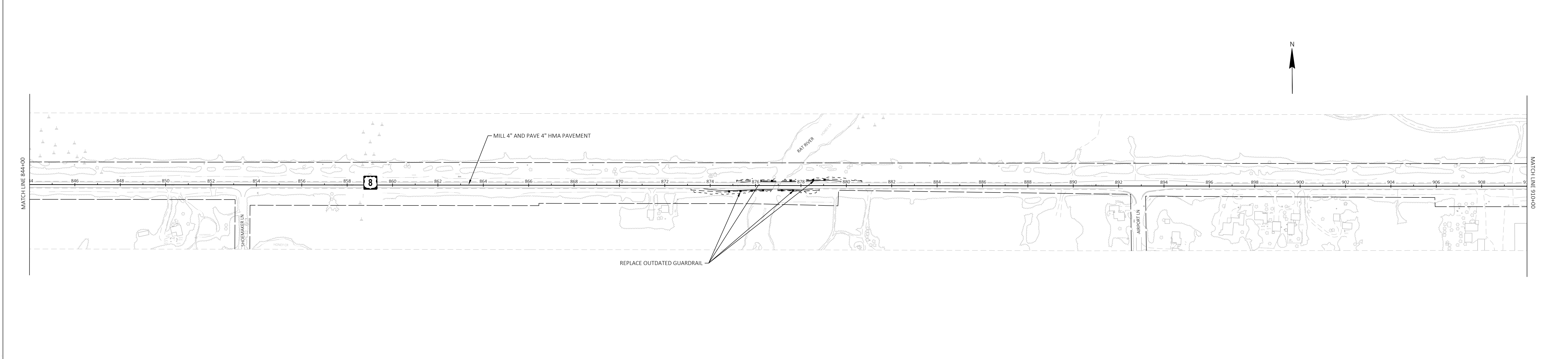

## PRELIMINARY US 8 IMPROVEMENTS

PROJECT I.D. 1590-18-01  
WIS 55 SOUTH TO WIS 32 SOUTH  
US 8  
FOREST COUNTY  
MAP 4 OF 4

**LEGEND**

- SLOPE INTERCEPT / GRADING LIMITS
- - - EXISTING RIGHT-OF-WAY
- MUNICIPAL BOUNDARY
- PROPOSED RIGHT-OF-WAY

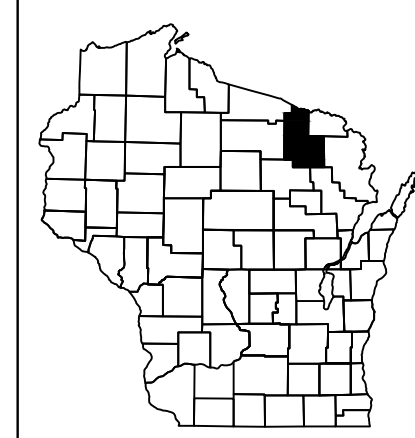

PRELIMINARY  
PUBLIC INVOLVEMENT  
EXHIBIT DATE: August 4, 2022  
SCALE: 1 INCH = 200 FEET

