

**TYPICAL SECTION - STAGE 1**  
 MONROE ST TO 375' SOUTH OF W NORTH ST  
 450' NORTH OF WESTBOUND EXIT RAMP TO PINE ST

**NOTES / LEGEND**  
 \*REQUIRES WIDTH RESTRICTION SIGNING  
 \*\*SHY DISTANCE

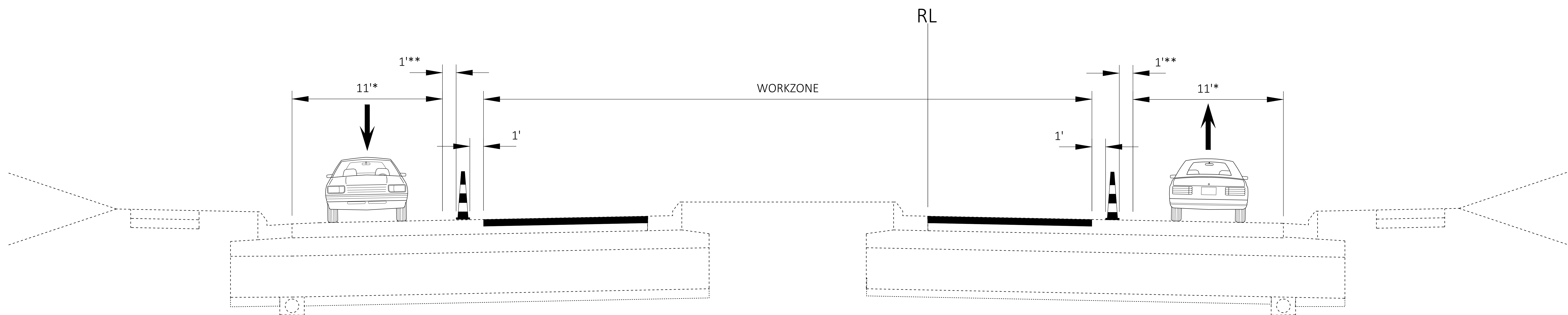

**TYPICAL SECTION WITH RAISED MEDIAN - STAGE 1**  
 375' SOUTH OF W NORTH TO 450' NORTH OF WESTBOUND EXIT RAMP

**WIS 13 IMPROVEMENTS**  
 PROJECT I.D. 1620-00-31/61,  
 1620-03-03/73 & 1620-03-04/74  
 CITY OF COLBY &  
 ABBOTSFORD  
 WIS 13  
 MARATHON COUNTY

