

**WIS 29 IMPROVEMENTS**  
 PROJECT ID: 1053-07-07  
 CLARK CO LINE TO CTH E SOUTH, WB  
 MARATHON COUNTY

PROJECT LOCATION

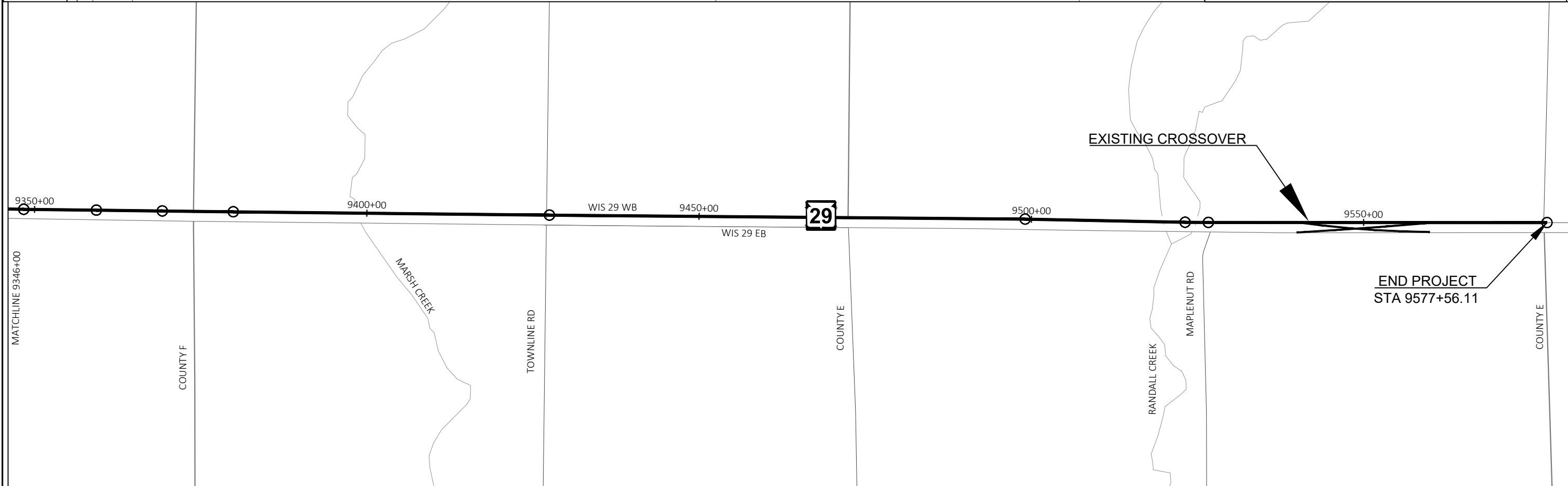

PROJECT NO: 1053-07-77	HWY: WIS 29	COUNTY: MARATHON	PROJECT LOCATION MAP	SHEET	<b>E</b>
------------------------	-------------	------------------	----------------------	-------	----------