

# PUBLIC INVOLVEMENT MEETING

## WIS 23 Freeway Designation and Corridor Preservation Study

County P to WIS 32  
Sheboygan County

Project I.D. 1440-19-00



July 25, 2016

5 to 7 p.m.

**Presentation at 5:15 p.m.**

Riverview Middle School - Cafeteria

Project website

<http://wisconsindot.gov/Pages/projects/by-region/ne/wis23corridorsheb/>

## Purpose of the meeting

Welcome to the WIS 23 freeway designation and corridor preservation study public involvement meeting.

The Wisconsin Department of Transportation (WisDOT), Northeast Region has been working to develop a long range plan for the future of the WIS 23 corridor between County P west of Plymouth and the freeway section near WIS 32 in Sheboygan Falls. This is the 4th public involvement meeting for this study.

The objectives of today's meeting are to:

- Present all alternatives recommended for environmental analysis and review elements of the project that have been updated or changed since the last public meeting.
- Outline the official mapping process
- Discuss upcoming study activities
- Obtain input from corridor residents and travelers

Tonight's meeting will run from 5 to 7 p.m. with a brief presentation at 5:15 p.m. Exhibits of the recommended alternatives and project information will be available for viewing and WisDOT representatives are on hand to discuss the project on an individual basis throughout the evening.

## Corridor study purpose and need

The WIS 23 freeway designation and corridor preservation study was initiated in 2007. The purpose of the corridor preservation study is to prepare a long-range plan showing the ultimate transportation facility including access locations and type.

WIS 23 connects the major population centers of Fond du Lac and Sheboygan and is an important connector route for agriculture, tourism and businesses between the population centers and points west. Long-range transportation improvements will be designed and officially mapped from County P to the freeway section near WIS 32. The resulting long-range transportation improvements will allow for the future conversion of the existing facility to a freeway when the need occurs and funding is available.

The goal of the study is preserve the public investment in WIS 23 by planning for long-term mobility and safety.

Objectives:

1. Map right of way for future construction improvements:
  - Future interchange locations
  - Future grade separation locations
  - Local road system modifications
  - Existing multi-modal facility changes
  - Prepare conceptual plans for future improvements
2. Avoid/minimize local impacts:
  - Existing homes and businesses
  - Farm operations
  - Bicycle and pedestrian facilities
3. Avoid/minimize impacts to:
  - Wetlands
  - Endangered/threatened species
  - Archaeological and historic sites
4. Work in collaboration with local officials, business owners and residents.

## Corridor study information

Over the course of the study, WisDOT has worked with the communities along the corridor to identify locations of future interchanges, local road modifications and any changes needed to existing multi-modal facilities.

Numerous alternatives were reviewed, eliminated and or refined which have ultimately resulted in the recommended alternatives for this project. Alternatives were analyzed in three separate project segments:

- The west segment
- The central segment
- The east segment

These segments were defined geographically based upon the unique characteristics and connectivity of the segments.

Construction of any of the alternatives is not scheduled.

Funding has not yet been secured and the environmental document must be completed. These projects will be constructed when there is a need to improve safety and funding is available.

## What is an Official Map?

The preferred alternatives for the WIS 23 corridor will be identified at the conclusion of the environmental document. Under Wisconsin Statute 84.295, WisDOT can use an official map to designate property needed to convert a state highway to an expressway in the future. Official mapping provides WisDOT the ability to proactively work with land owners in advance of an approved construction project. Official mapping also informs and helps land owners, the public and local communities plan so that their improvements don't conflict with future expressway conversion.

## WIS 23 CORRIDOR PROJECT LOCATION MAP

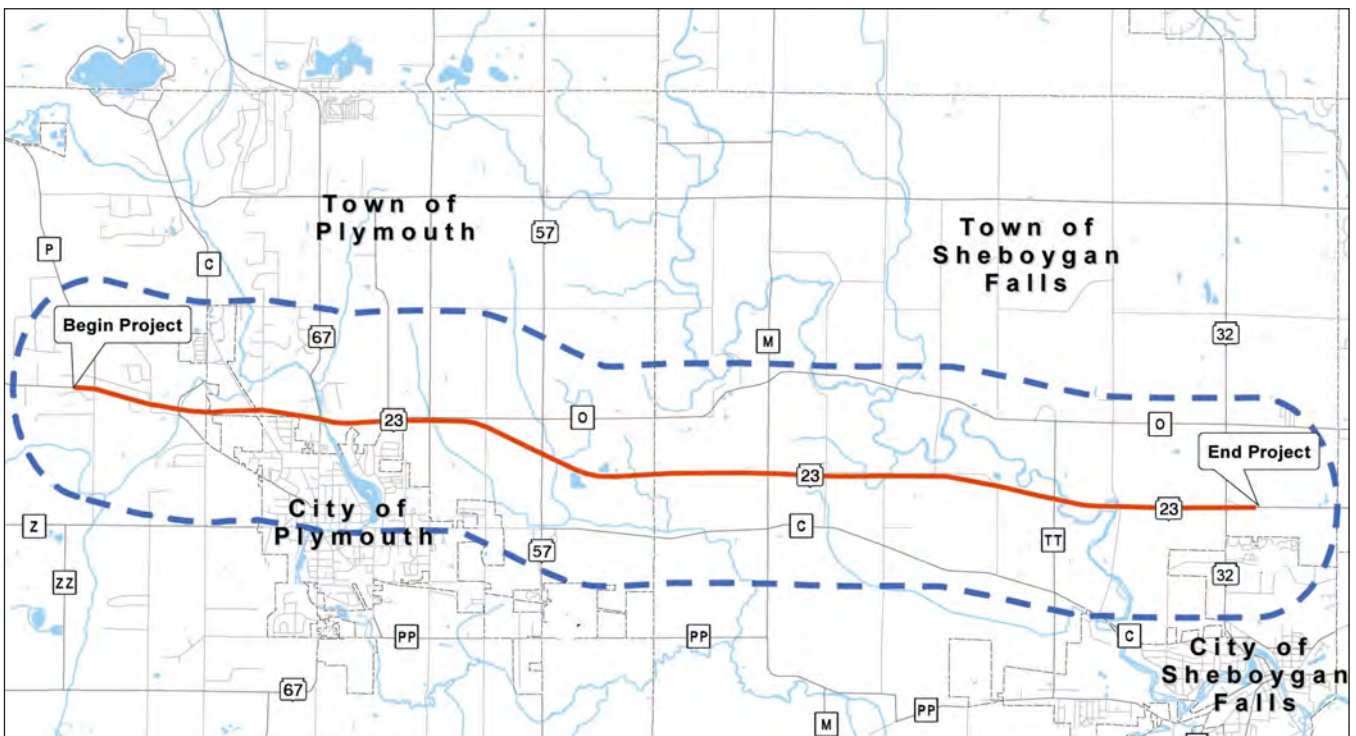

## West, Central and East Segment Alternatives Recommended for Environmental Report

WisDOT evaluated connectivity, costs and environmental impacts associated with numerous alternatives developed for the west, central and east segments.

### West Segment

The west segment is located between County P and County C. The west segment alternative consists of the following:

- County P closed at WIS 23
- Reroute County P down Valley Lane to an intersection with County C north of WIS 23
- Construct new roadway connecting Pioneer Road, Inez Court, and Branch Road to an intersection south of County C
- Pioneer Road, Inez Court and Branch Road access closed at WIS 23

### WEST SEGMENT RECOMMENDED ALTERNATIVE

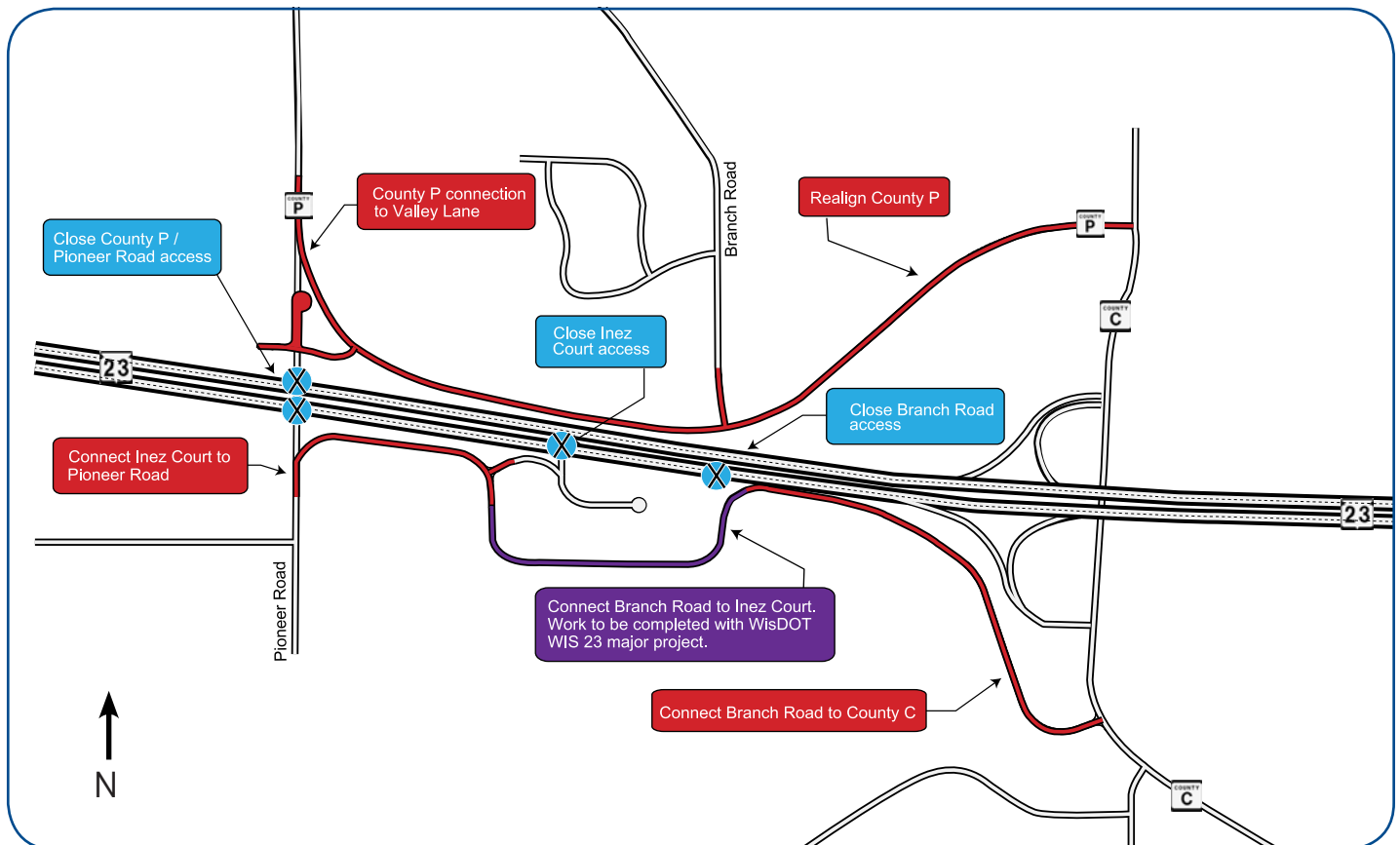

## Central Segment

The central segment is located between WIS 67 and WIS 57. The central segment alternative consists of the following:

- Construct WIS 23 over County E
- Construct Kiley Way between County OJ and Pleasant View Road
- County OJ and Pleasant View Road closed at WIS 23

### CENTRAL SEGMENT RECOMMENDED ALTERNATIVE

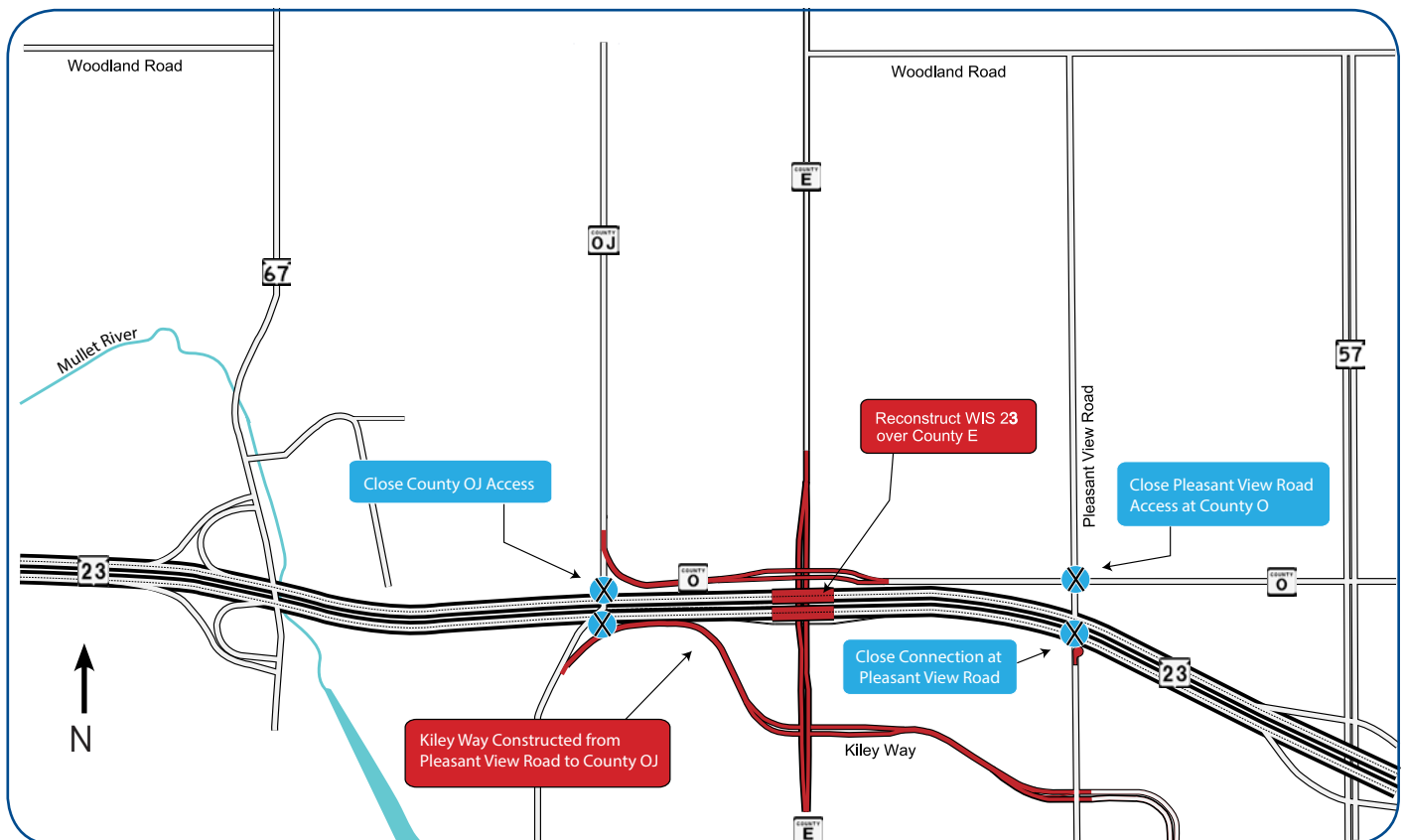

## East Segment

The east segment is located between WIS 57 and WIS 32. The east segment alternative consists of the following:

- Construct overpasses at Willow Road and County M with no direct access to WIS 23
- Hillside Road, Bridgewood Road, Sunset Road and Meadowlark Road access closed at WIS 23
- Construct new diamond interchange west of the intersection of WIS 23 and County TT

### EAST SEGMENT RECOMMENDED ALTERNATIVE: *WILLOW ROAD AND COUNTY M OVERPASS*

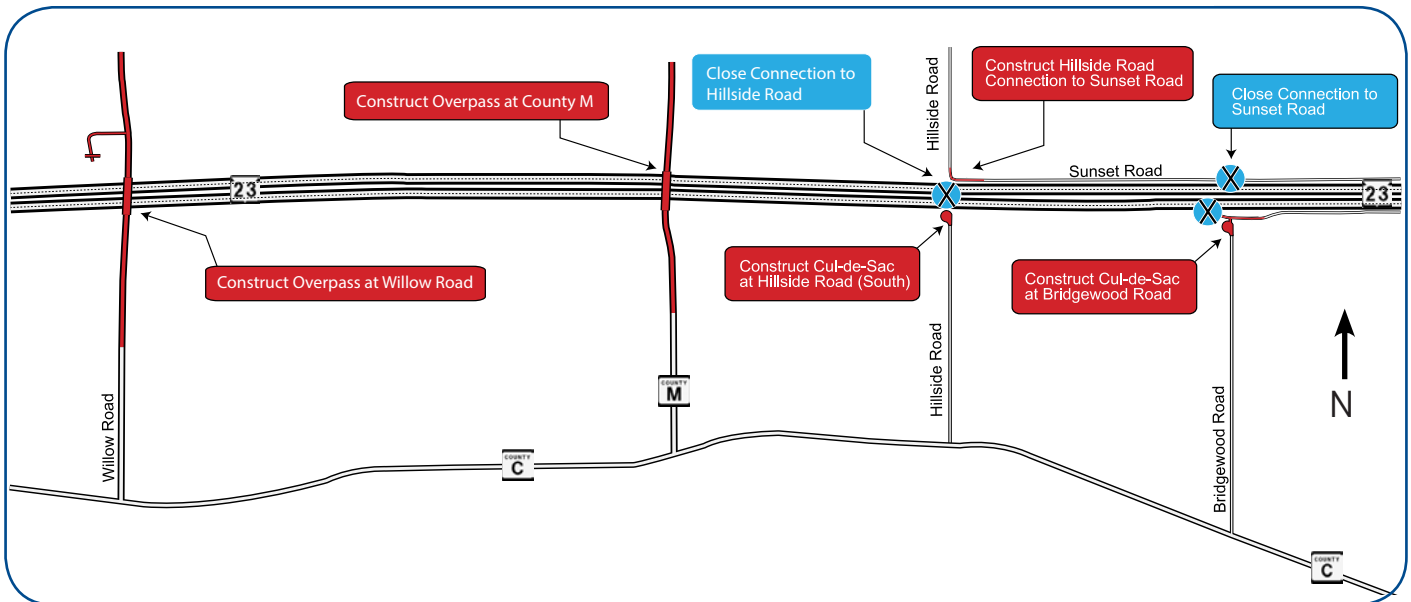

### EAST SEGMENT RECOMMENDED ALTERNATIVE: *COUNTY TT DIAMOND INTERCHANGE*

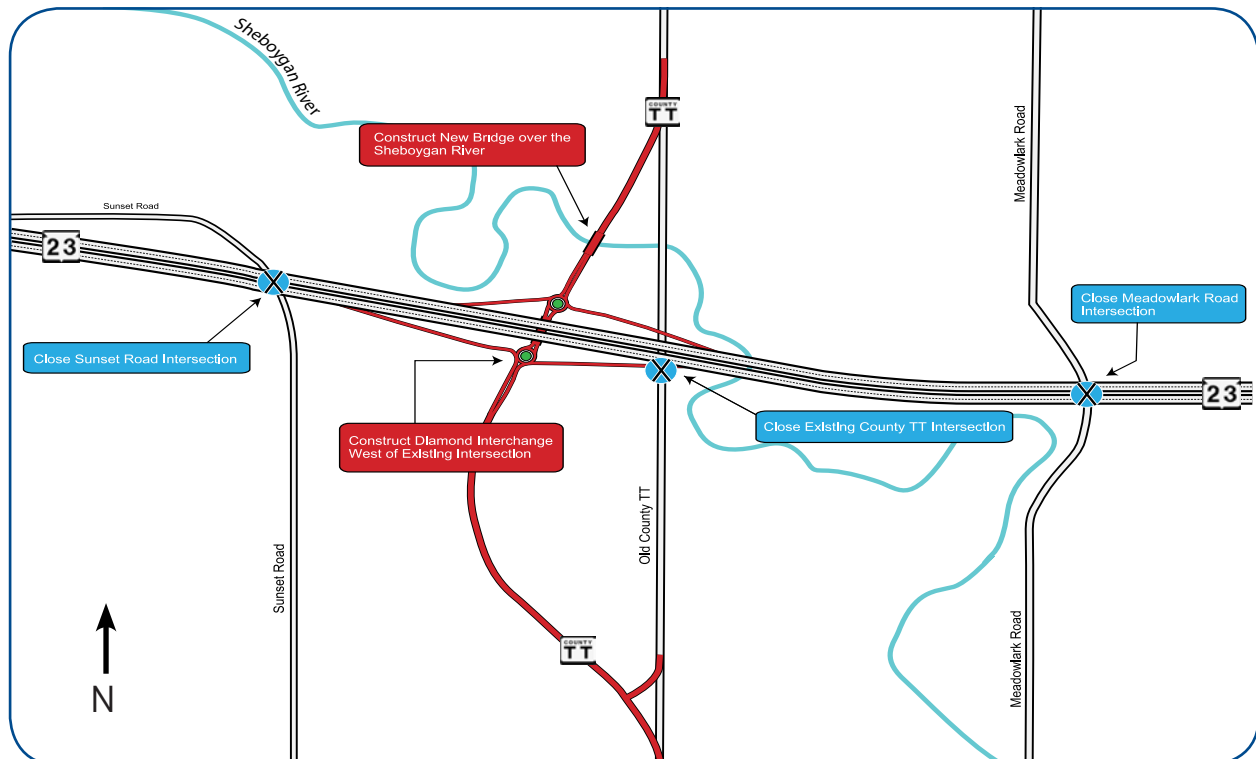

## Project Schedule

WisDOT has completed development of the alternatives and moved forward into preliminary engineering and development of the environmental report, currently scheduled for completion this summer. Official mapping of the right of way will be completed in the fall, followed by a public hearing. Notice of the public hearing will be announced in a future project mailing and on the project website:

<http://wisconsin.gov/Pages/projects/by-region/ne/wis23corridorsheb/>

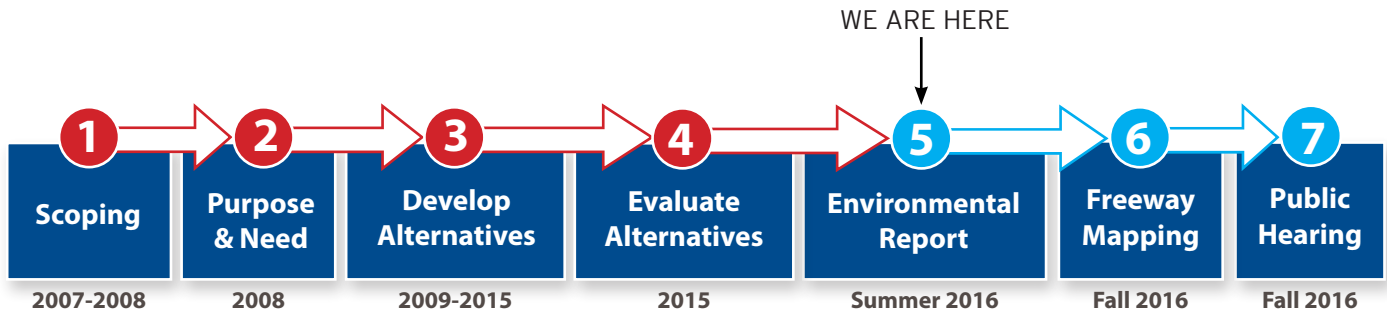

## Public input/comments

We encourage you to talk to the project representatives and ask them questions. Attached to this handout is a sheet for your written comments and input. Please mail any written comments about the project before August 15, 2016 or leave them in the comment box tonight. You can also e-mail your comments to the contacts listed below.

Your comments assist us in developing a project that will serve the needs of the traveling public as well as the needs of the local community. Your input is welcome and appreciated.

For more information, please contact:

**Natasha Gwidt, PE - Project Manager**  
Wisconsin Department of Transportation  
944 Vanderperren Way  
Green Bay, WI 54304  
Phone: (920) 492-4125  
[natasha.gwidt@dot.wi.gov](mailto:natasha.gwidt@dot.wi.gov)

**Mark Kantola - Communications Manager**  
Wisconsin Department of Transportation  
944 Vanderperren Way  
Green Bay, WI 54304  
Phone: (920) 492-4153  
[mark.kantola@dot.wi.gov](mailto:mark.kantola@dot.wi.gov)







↑ AFTER FOLDING, PLEASE SECURE THIS EDGE WITH TAPE BEFORE MAILING ↑

↓ FOLD HERE ↓



NO POSTAGE  
NECESSARY  
IF MAILED  
IN THE  
UNITED STATES



**BUSINESS REPLY MAIL**  
FIRST CLASS MAIL PERMIT NO. 2226 MADISON, WI



POSTAGE WILL BE PAID BY

**NE REGION**  
WISCONSIN DEPARTMENT OF TRANSPORTATION  
944 VANDERPERREN WAY  
GREEN BAY WI 54304

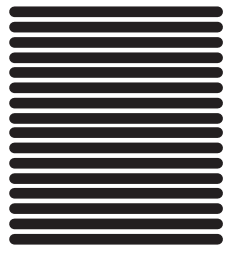

Attn: BUHlg\U; k JXh PE

↑ FOLD HERE ↑

↓ AFTER FOLDING, PLEASE SECURE THIS EDGE WITH TAPE BEFORE MAILING ↓