

TEMPORARY IMPACTS TO WALKER SQUARE PARK

I 43 ON/OFF RAMP REHABILITATION

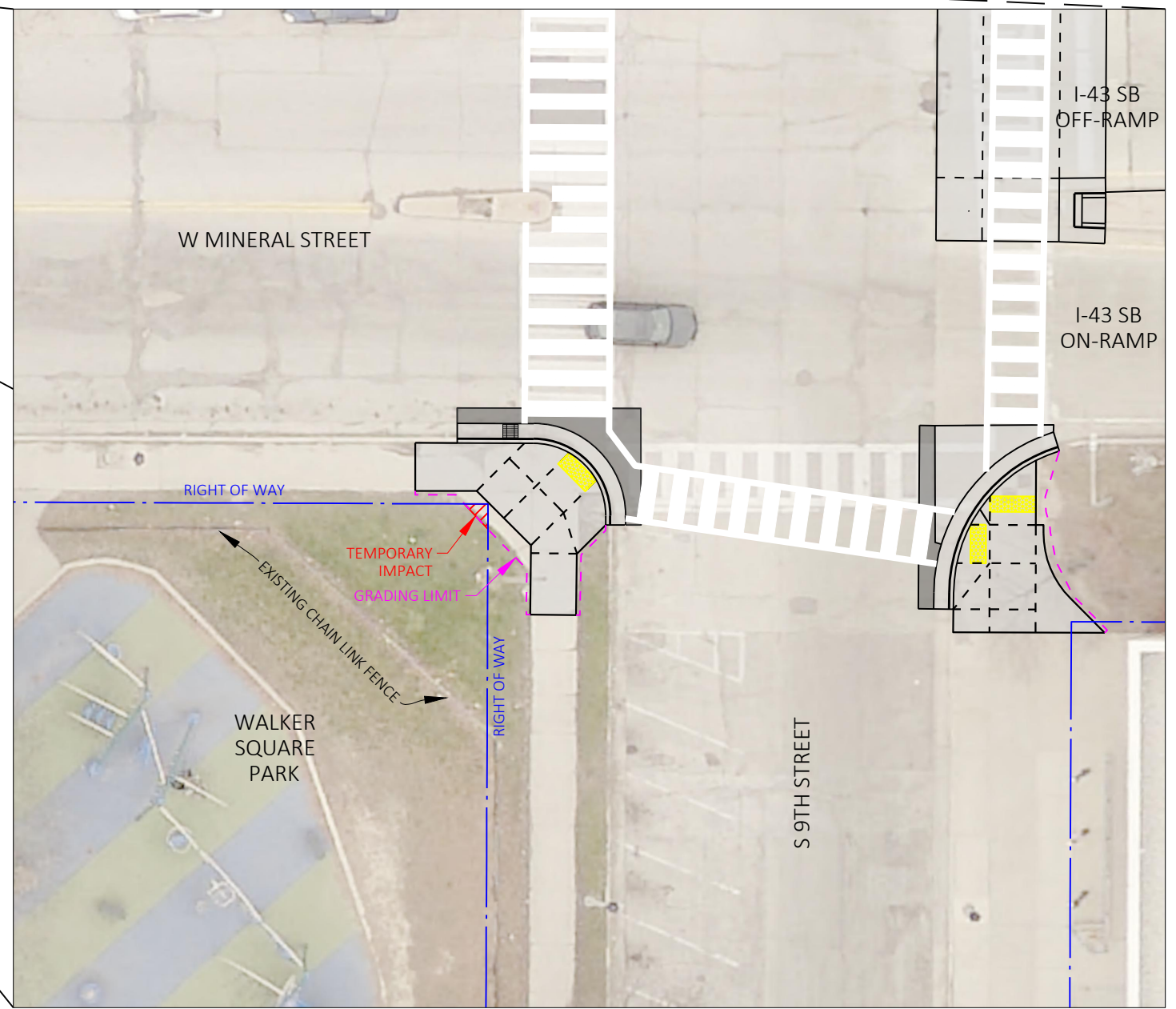

VICINITY MAP



ENLARGEMENT

TEMPORARY IMPACTS:

- REMOVE A SMALL PORTION OF EXISTING SIDEWALK WITHIN WALKER SQUARE PARK
- PROPOSED SIDEWALK WILL BE LOCATED ENTIRELY WITHIN RIGHT OF WAY
- AREA OF EXISTING SIDEWALK REMOVED WILL BE RESTORED WITH SOD LAWN
- TEMPORARY IMPACTS ARE LOCATED OUTSIDE THE FENCED AREA OF THE PARK