

Project 1706-03-00/80

WIS 11 Shullsburg Branch Bridges

Public Information Meeting

Joshua Wellnitz
Project Design Engineer

January 2022



Project Website

WIS 11 bridges over Shullsburg Branch (wisconsindot.gov)

The screenshot shows the Wisconsin Department of Transportation website. The search bar contains the text "WISCONSIN 11 Shullsburg Branch Bridge". The search results section displays "Search Results" with "About 78 results (0.19 seconds)" and a "Sort by: Relevance" dropdown. The top result is titled "WIS 11 bridges over Shullsburg Branch" with a breadcrumb trail: "wisconsindot.gov > Pages > projects > by-region > wis11bridges". The description for this result reads: "The project will replace two bridges on WIS 11 over the Shullsburg Branch near Shullsburg in Lafayette County. One is located near Johnson Road west of ...". Below this, another result is partially visible, titled "Southwest Region Highway Projects and Studies" with a breadcrumb trail: "wisconsindot.gov > Pages > projects > by-region".



Project Staff

- Kurt Johnson, P.E.
 - Project Supervisor
- Joshua Nelson, P.E.
 - Project Manager
- Joshua Wellnitz
 - Project Leader



Project Limits

Bridge B-33-0825 Near Johnson Road



Project Limits

Bridge B-33-0826 Near Judgement Street

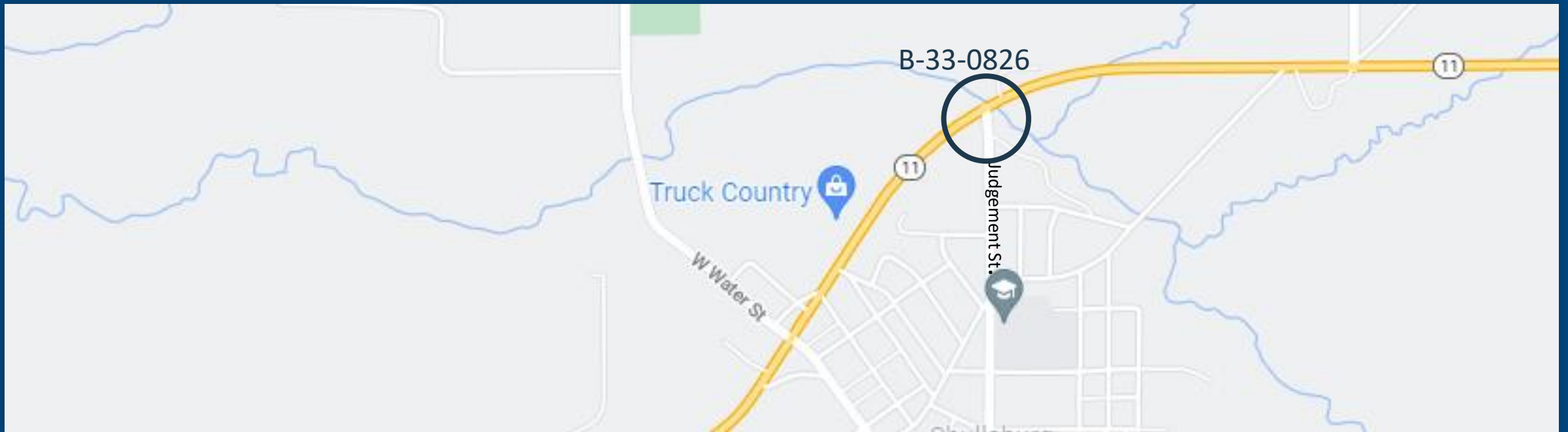

Roadway Conditions

WIS 11

- Traffic
 - 2,990-3,880 – Average Daily Traffic
 - Truck % – 11.6
- Pavement
 - 12-foot travel lanes
 - 8-foot shoulder (3-foot paved)
- Safety
 - No crash flags near project intersection limits



Purpose and Need

Bridge Replacement – B-33-0825

- Bridge Near Johnson Road
 - Built 1947
 - Maintenance 1982
 - Bridge deck is deteriorating
 - Exposed rebar on abutments
 - Girders beginning to rust



Design Overview

Existing Conditions

- B-33-0825
 - Deck length 34 feet
 - Deck width 41 feet
 - Adjacent roadway 12-foot lanes, 3-foot paved shoulder



Design Overview

Proposed Design

- New Bridge Number: B-33-136
 - Deck length 52-ft
 - Deck width 44-ft
 - Structural and concrete approach slabs proposed
 - Polymer overlay will be added after construction (1 month – 1 year)



Purpose and Need

Bridge Replacement – B-33-0826

- Bridge Near Judgement Street
 - Built 1935
 - Maintenance 1996
 - Bridge deck is deteriorating
 - Exposed rebar on abutments
 - Girders beginning to rust



Design Overview

Existing Conditions

- B-33-0826
 - Deck length 42-ft
 - Deck width 41-ft
 - Adjacent roadway 12-ft lanes, 8-ft paved shoulder
 - Judgement Street 10-ft from bridge deck



Design Overview

Proposed Design

- New Bridge Number: B-33-137
 - Deck length 52-ft
 - Deck width 44-ft
 - Concrete approach slabs proposed
 - Polymer overlay will be added after construction (1 month – 1 year)
 - Realignment of Judgement Street



Design Overview

Proposed Design

- Judgment Street
 - 12-foot travel lanes
 - 4-foot shoulder with curb and gutter
 - Realigned further west
 - Increase in Judgement Street elevation
 - Existing guardrails extended to Judgement Street

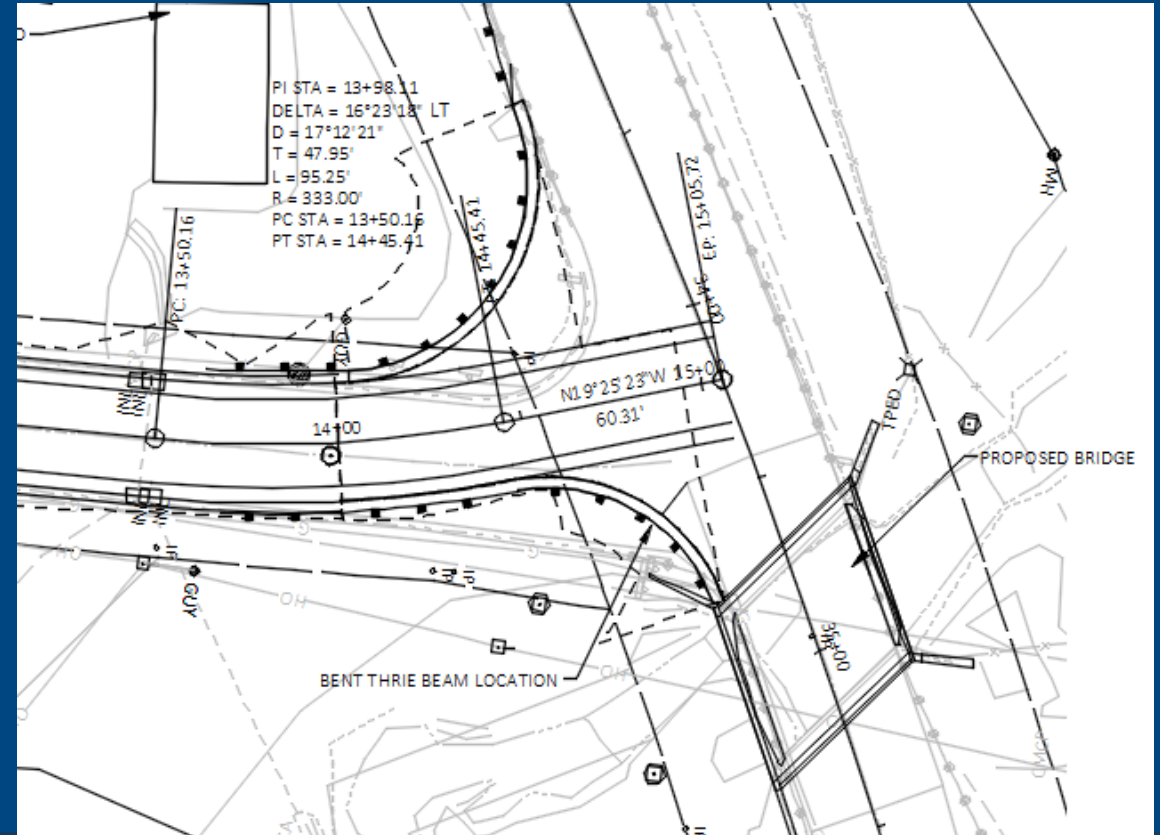

Construction Traffic Impacts

Detour

- Posted detour for WIS 11 through traffic, for project duration
- Access for local Shullsburg traffic will remain open
 - Detour will be staged, closing one bridge at a time



Detour During Construction

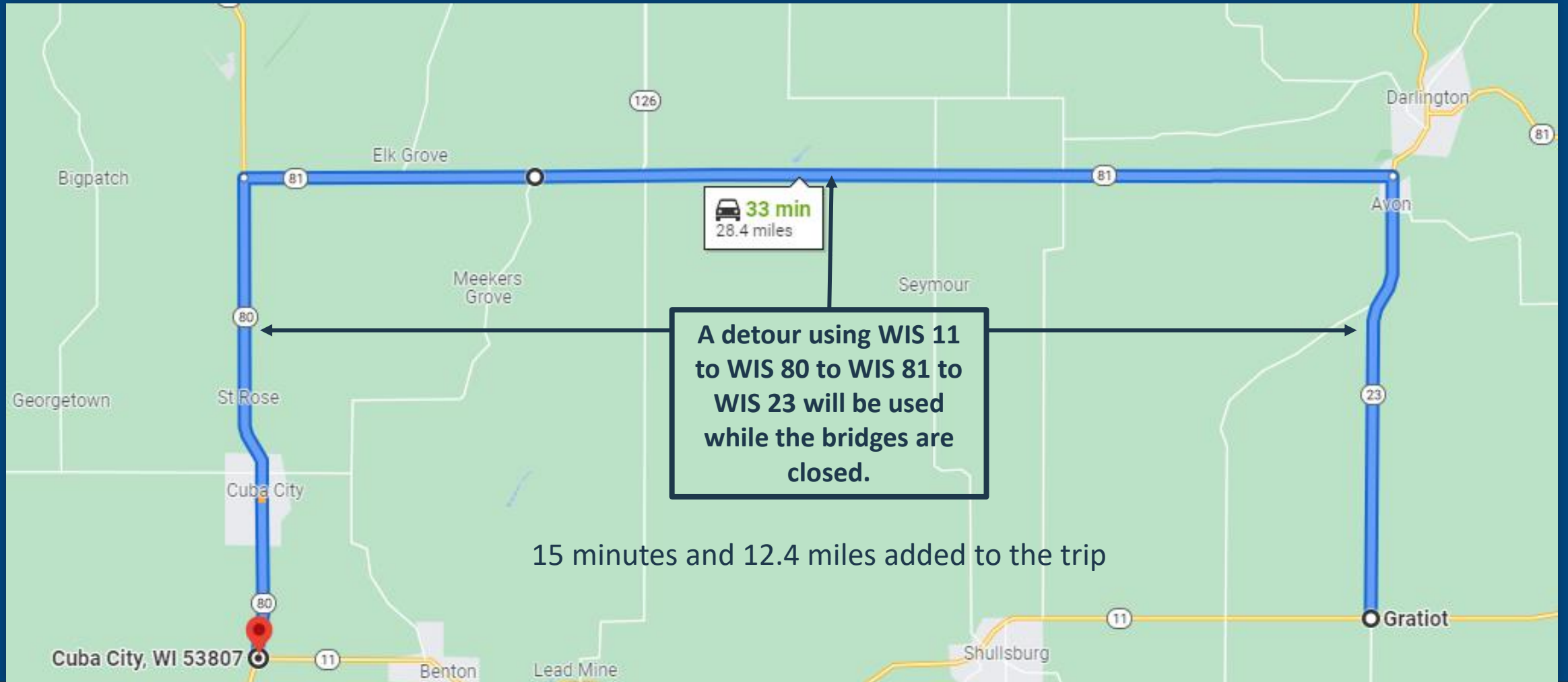

Project Details

Real Estate and Schedule

- Real Estate
 - Real estate acquisition is planned for both project areas
 - Landowners impacted will be contacted with further details
- Schedule
 - Real estate acquisition begins – August 2022
 - Construction – Summer 2025
 - Project completion – End of construction season, 2025



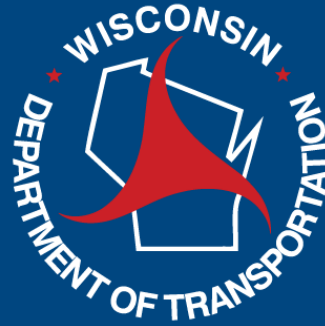

Thank You For Your Time!

Question or Concerns?

Contact Joshua Nelson, Project Manager

By Mail: 2101 Wright Street, Madison WI 53704

By Email: Joshua.Nelson@dot.wi.gov

By Phone: (608 246-3857)

