



WIS 73 Project

WIS 19 to North Marshall Village Limit

Dane County

Public Involvement Meeting
Marshall, WI

August 29, 2023

Presentation agenda

- Project location
- Project purpose and need
- Proposed improvements
- Property impacts
- Traffic control
- Project schedule
- Contact information



Project location



Why do we need this project?

Pavement deterioration

- Extensive cracking and rutting
- Increased maintenance costs
- Poor ride quality
- Safety concerns



Example of rutting and alligator cracking on WIS 73

Why do we need this project?

Americans with Disabilities Act (ADA) Compliance

- Existing curb ramps along WIS 73 are not compliant with the current American Disabilities Act (ADA) standards



Example of non-compliant curb ramp on WIS 73

Why do we need this project?

Structure deficiencies



Existing condition of WIS 73 structure B-13-73 over the Maunasha River



Why do we need this project?

Outdated railroad signal equipment

- Railroad signals at the Wisconsin & Southern Railroad crossing are not functioning with the latest standards



What improvements are proposed?

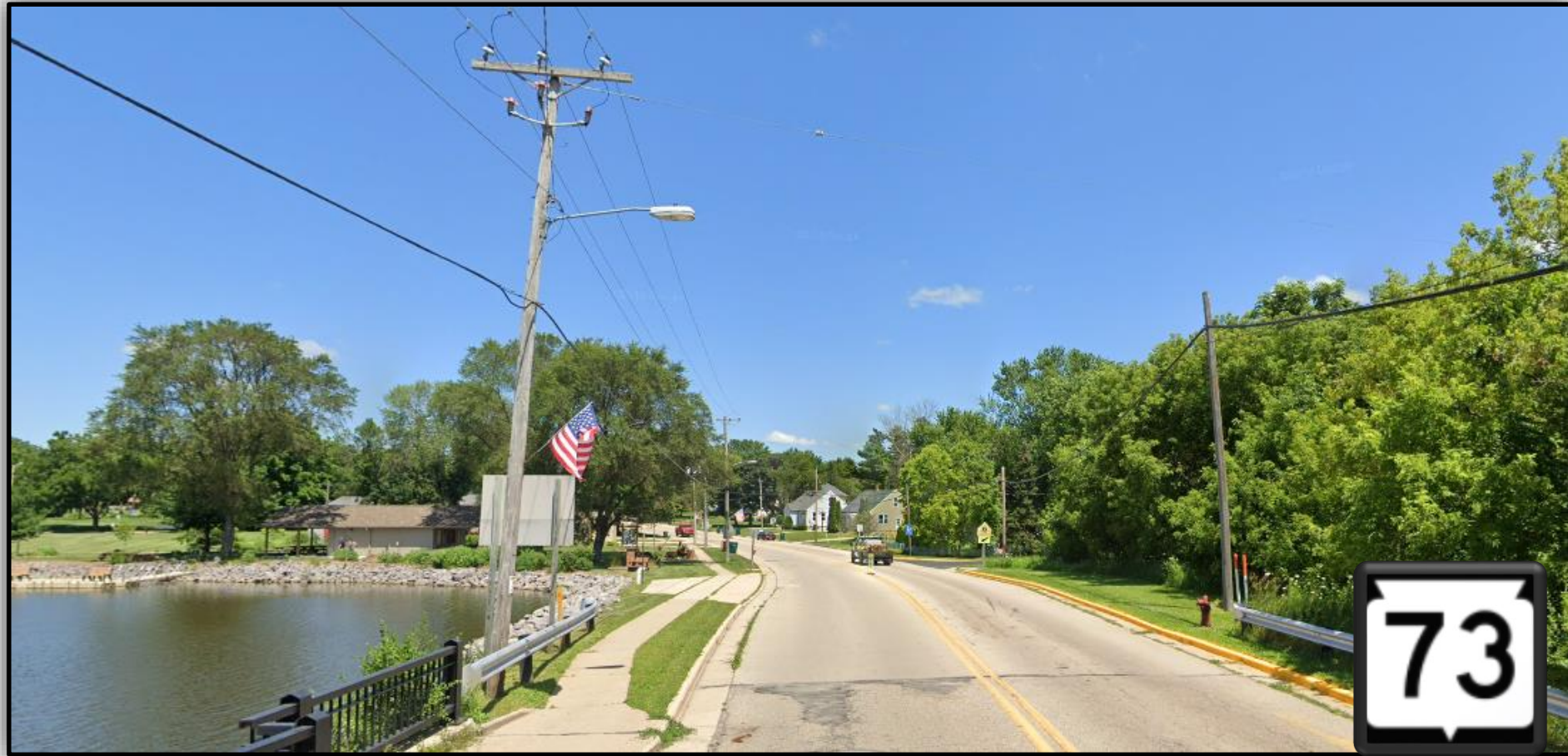

Proposed improvements

Typical Sections – WIS 73

- Pavement replacement
 - Remove 4-inch to 5-inch asphalt
 - Pave 5-inch asphalt
- Existing curb and gutter will remain
- New shoulder aggregate in rural section
- New pavement markings

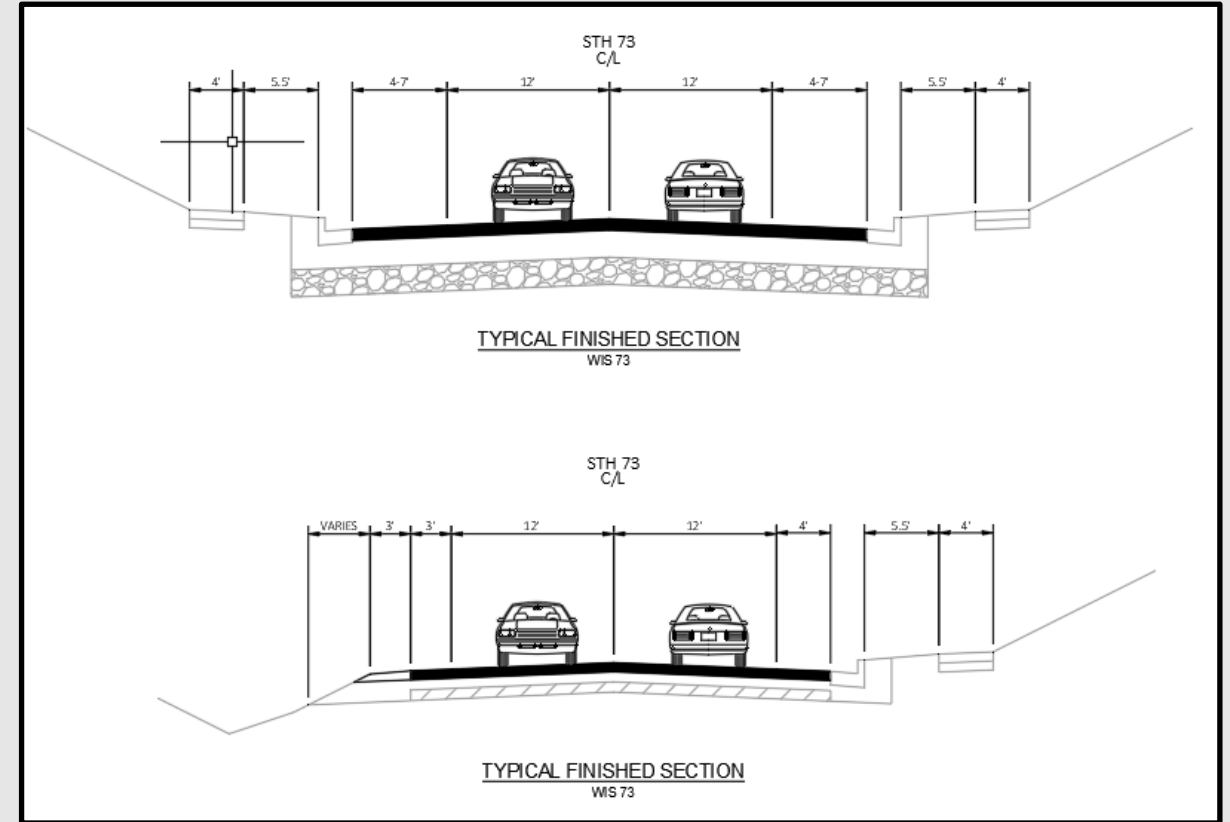

Proposed improvements

Curb ramps

- Curb ramps will be updated to meet current ADA standards



Proposed improvements

Structural improvements

- Bridge over the Maunasha River
 - Install new concrete approach slabs
 - Repair curb
 - Spot surface repair on abutments
 - Paint bridge railing
 - Bridge deck repair



Proposed improvements

Railroad crossing improvements

- At-grade Wisconsin & Southern (WSOR) railroad crossing
 - Replace railroad signals
 - Install new gates



Property impacts

- Temporary easements and permanent right of way will be needed for curb ramp construction
- WisDOT will coordinate with property owners for any permanent or temporary real estate needs

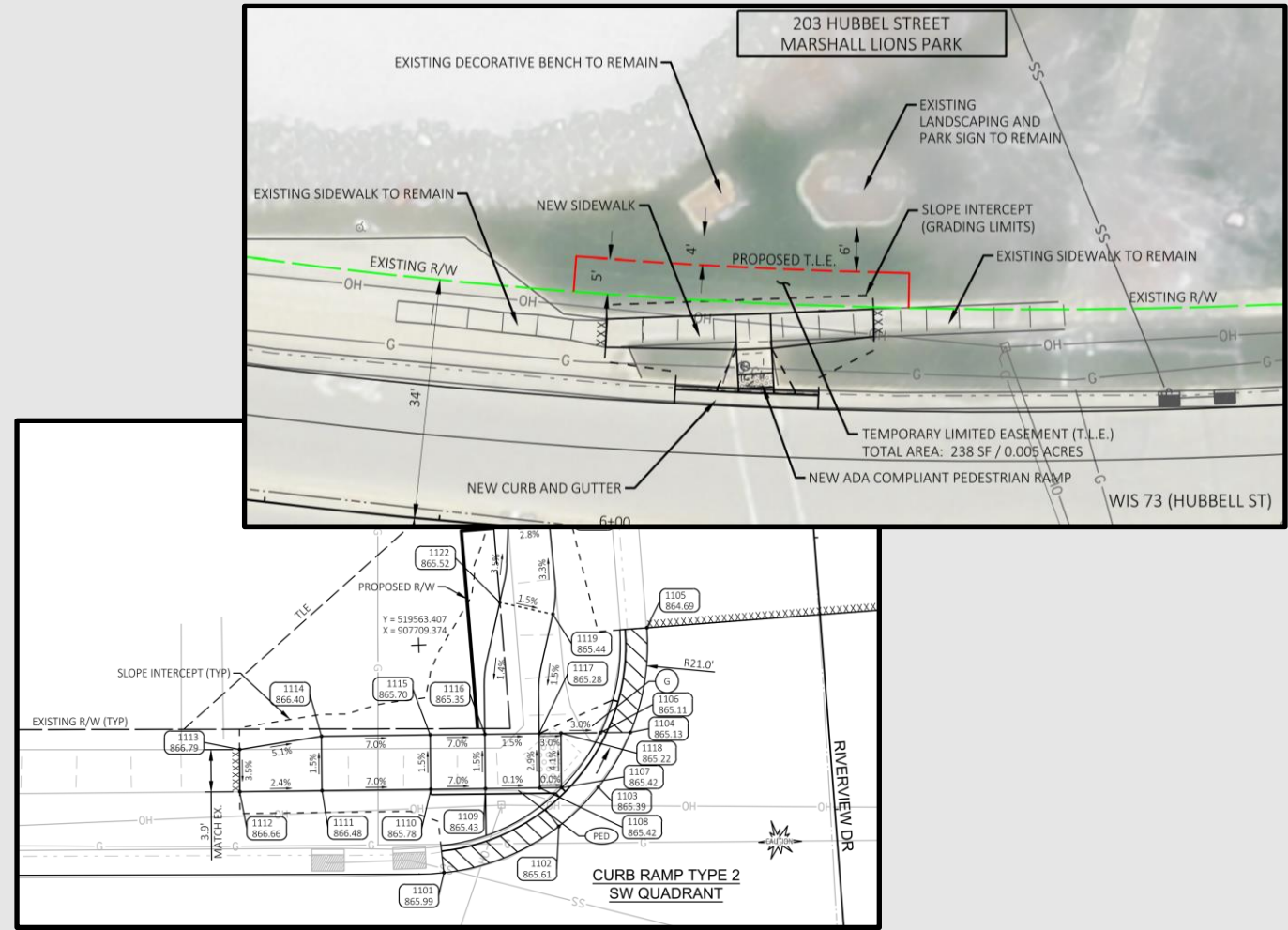

Traffic control

- WIS 73 closed to through traffic during construction
 - Detour route utilizes WIS 19 and WIS 89 for both northbound and southbound traffic
- Access to local properties and businesses will be maintained

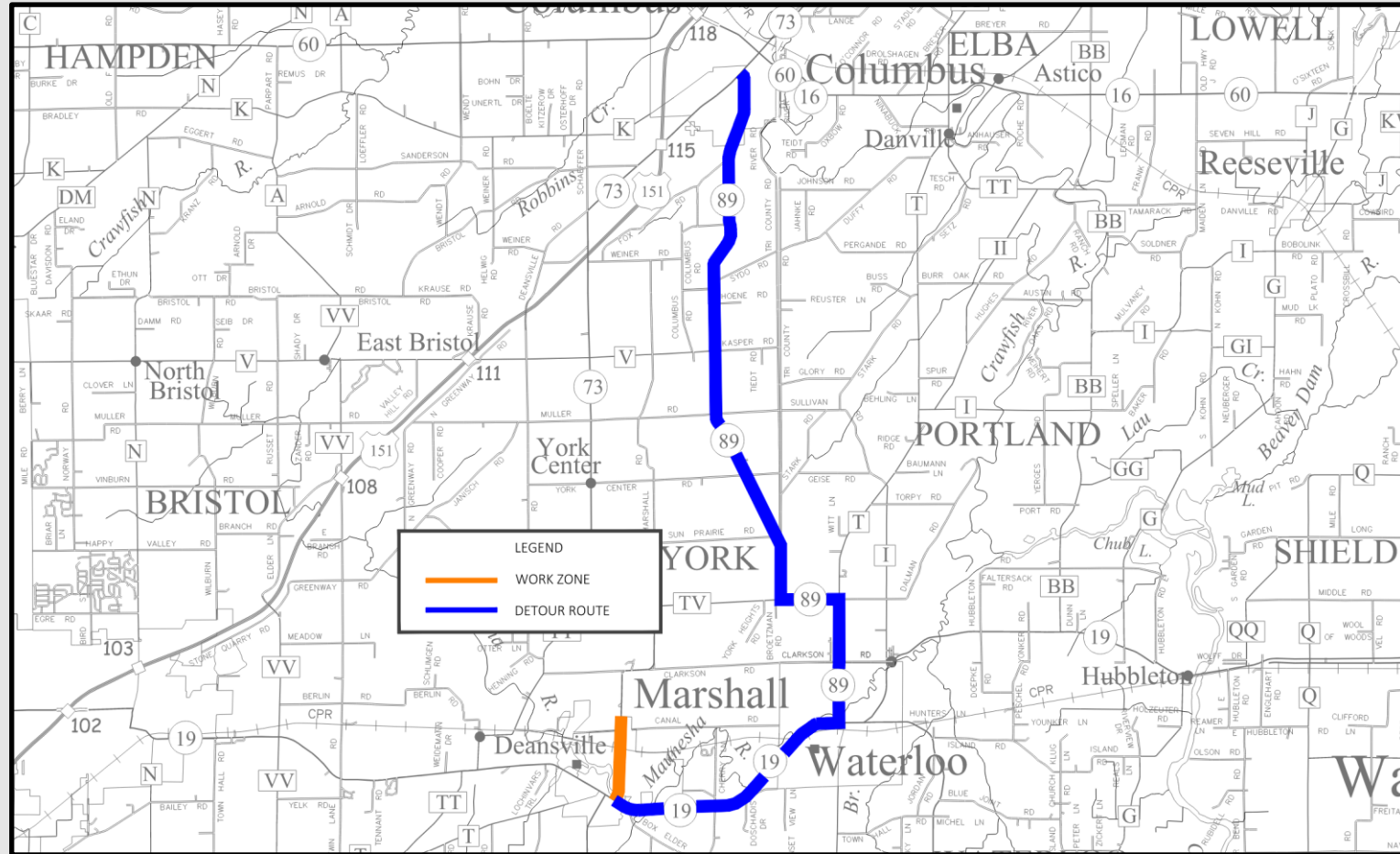

Project schedule

- Recent activity (2021 and beyond)

- Virtual Local Officials Meeting
- Virtual Public Involvement Meeting
- Environmental report signed
- Preliminary structure plan
- Design study report approved
- Plat recorded
- Plans to utilities

October 2021

October 2021

November 2021

November 2021

April 2022

June 2023

July 2023



Project schedule

- Upcoming activities

- Real estate acquisition underway
- Final structure plan
- Final roadway plans
- Anticipated construction

July 2023

August 2024

November 2024

Summer 2025



Thank you for your time

If you have any comments, questions, or concerns please send us an email or give us a call:

Steven Porter, PE

steve.porter@dot.wi.gov

Ph: (608) 243-3366

Tammy Tucker, PE

ttucker@cbssquaredinc.com

Office (920) 574-3135 Ext: 5021

Cell (262) 613-8999

Written comments can also be mailed to Steve Porter's attention at 2101 Wright St, Madison, WI 53704

