

NOTES

1. Sign is Type II - Type H Reflective
2. Color:  
Background - Green  
Message - White
3. Message Series - C
4. D9-52L is the same as D9-52R except the arrow is reversed.
5. Substitute appropriate site name and optically adjust spacing as required to achieve proper balance. When necessary to accommodate name, lengthen board by 6" increments. Minimum board width is 36".

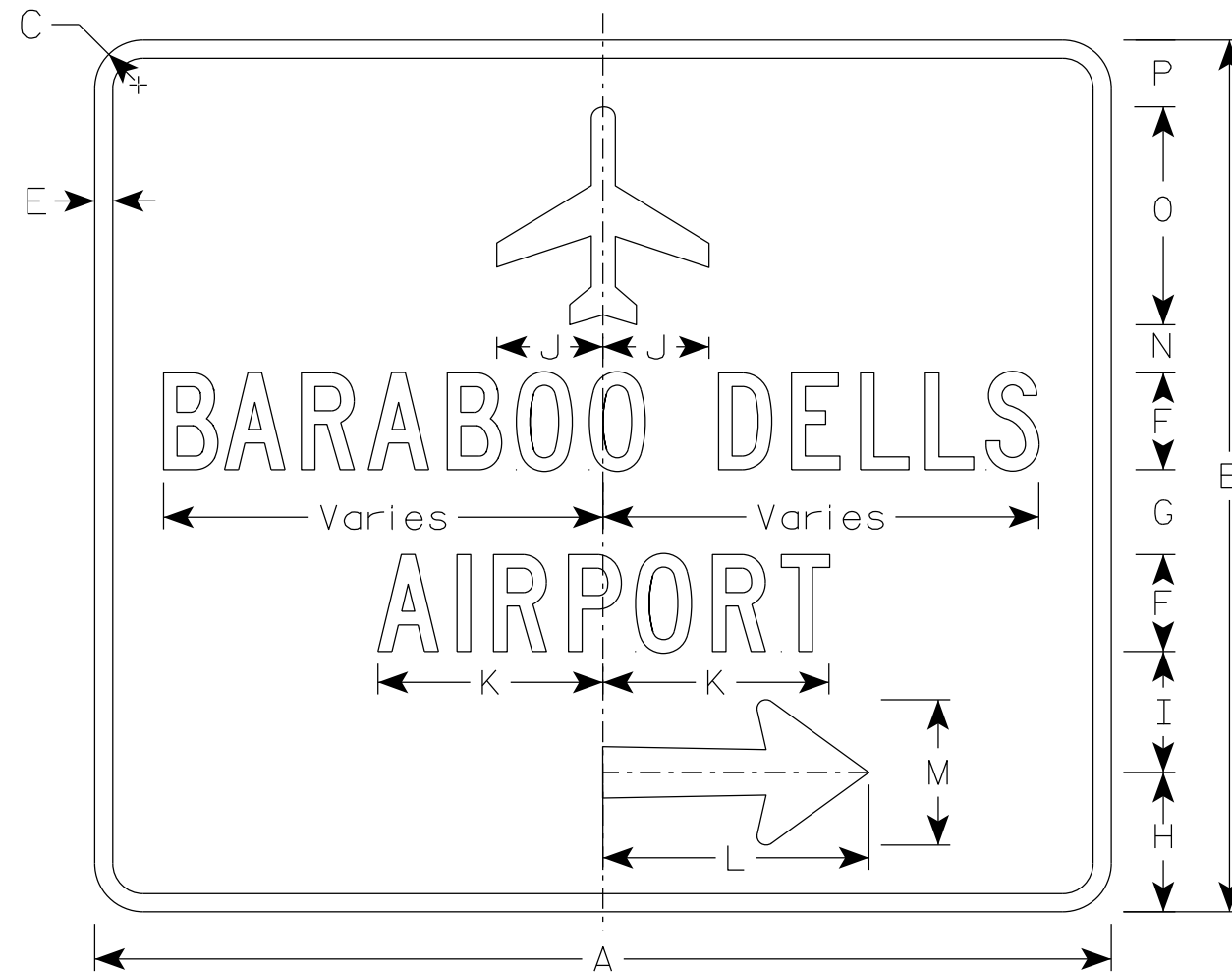

D9-52R

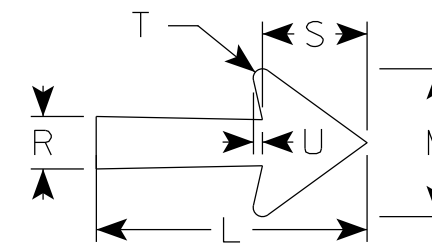

Arrow Detail

SIZE	A	B	C	D	E	F	G	H	I	J	K	L	M	N	O	P	Q	R	S	T	U	V	W	X	Y	Z	Area sq. ft.
1																											
2	Varies	36	2 1/4		3/4	4	3 1/2	5 3/4	5	4 3/8	9 1/4	11	6	2	9	2 3/4		2	4 1/4	3/8	3/8						Varies
3	Varies	48	3		1	6	4	7	7	5 7/8	13 7/8	15	8	3	12	3		3	5 3/4	1/2	1/2						Varies
4																											
5																											

PROJECT NO: \_\_\_\_\_ SHEET NO: **E**