

NOTES

1. Sign is Type II - Type H Reflective
2. Color:
Background - White
Message - Black
3. Message Series - Line 1- Series C
Lines 2 and 3 - Series D

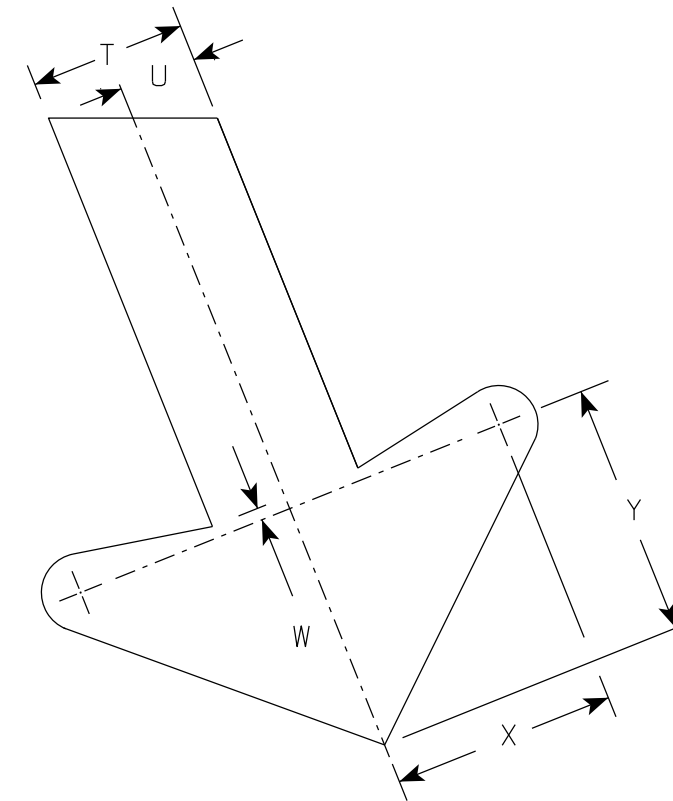
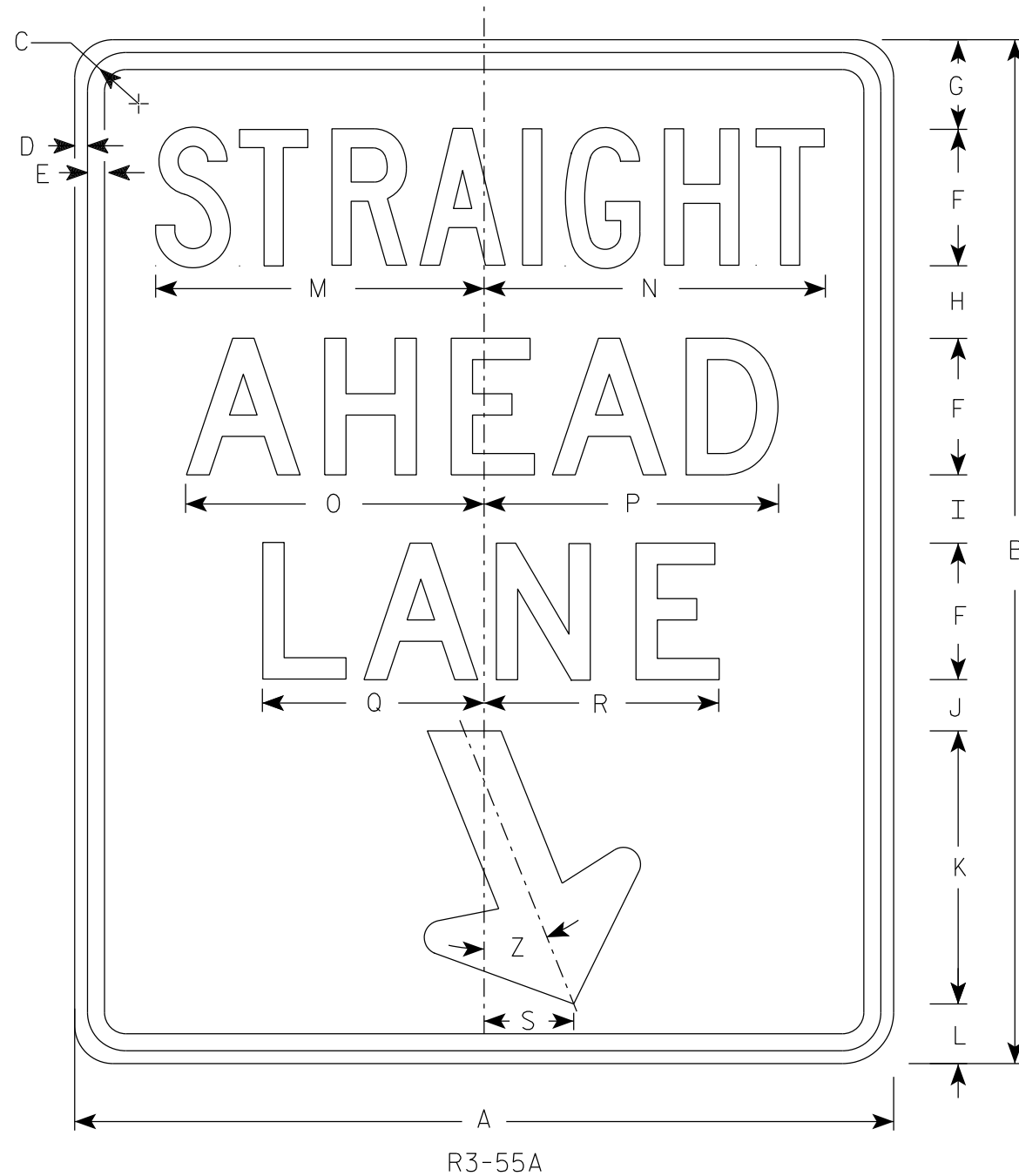

ARROW DETAIL

SIZE	A	B	C	D	E	F	G	H	I	J	K	L	M	N	O	P	Q	R	S	T	U	V	W	X	Y	Z	Area sq. ft.
1																											
2S	24	30	1 1/2	3/8	1/2	4	2 5/8	2 1/8	2	2	1 1/2	8	9 5/8	10	8 3/4	8 5/8	6 1/2	6 7/8	2 5/8	2	1	1/2	1/4	2 7/8	3 1/4	22°	5.0
2M	24	30	1 1/2	3/8	1/2	4	2 5/8	2 1/8	2	2	1 1/2	8	9 5/8	10	8 3/4	8 5/8	6 1/2	6 7/8	2 5/8	2	1	1/2	1/4	2 7/8	3 1/4	22°	5.0
3	36	48	1 7/8	1/2	5/8	6	4 1/2	3 3/4	3 5/8	3 5/8	2 7/8	12	14 1/2	14 7/8	13 1/8	12 7/8	9 3/4	10 1/4	4	3	1 1/2	3/4	3/8	4 1/4	4 7/8	22°	12.0
4																											
5																											

STANDARD SIGN
R3-55A

WISCONSIN DEPT OF TRANSPORTATION

APPROVED *Matthew R. Rauch*
For State Traffic Engineer

DATE 2/23/23 PLATE NO. R3-55A.6

PROJECT NO: _____ HWY: _____ COUNTY: _____ SHEET NO: **E**

7

7