

NOTES

1. Sign is Type II - Type H Reflective
2. Color:  
Background - White  
Message - Black
3. Message Series - C
4. R53-51R is same as R53-51L except that the arrow is reversed.

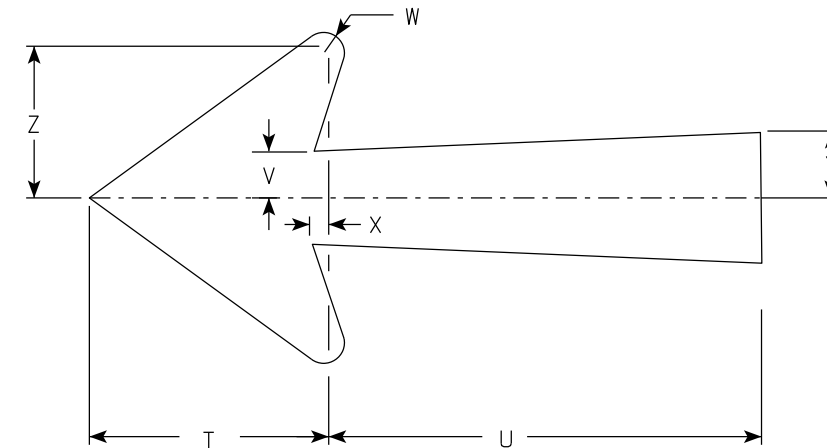
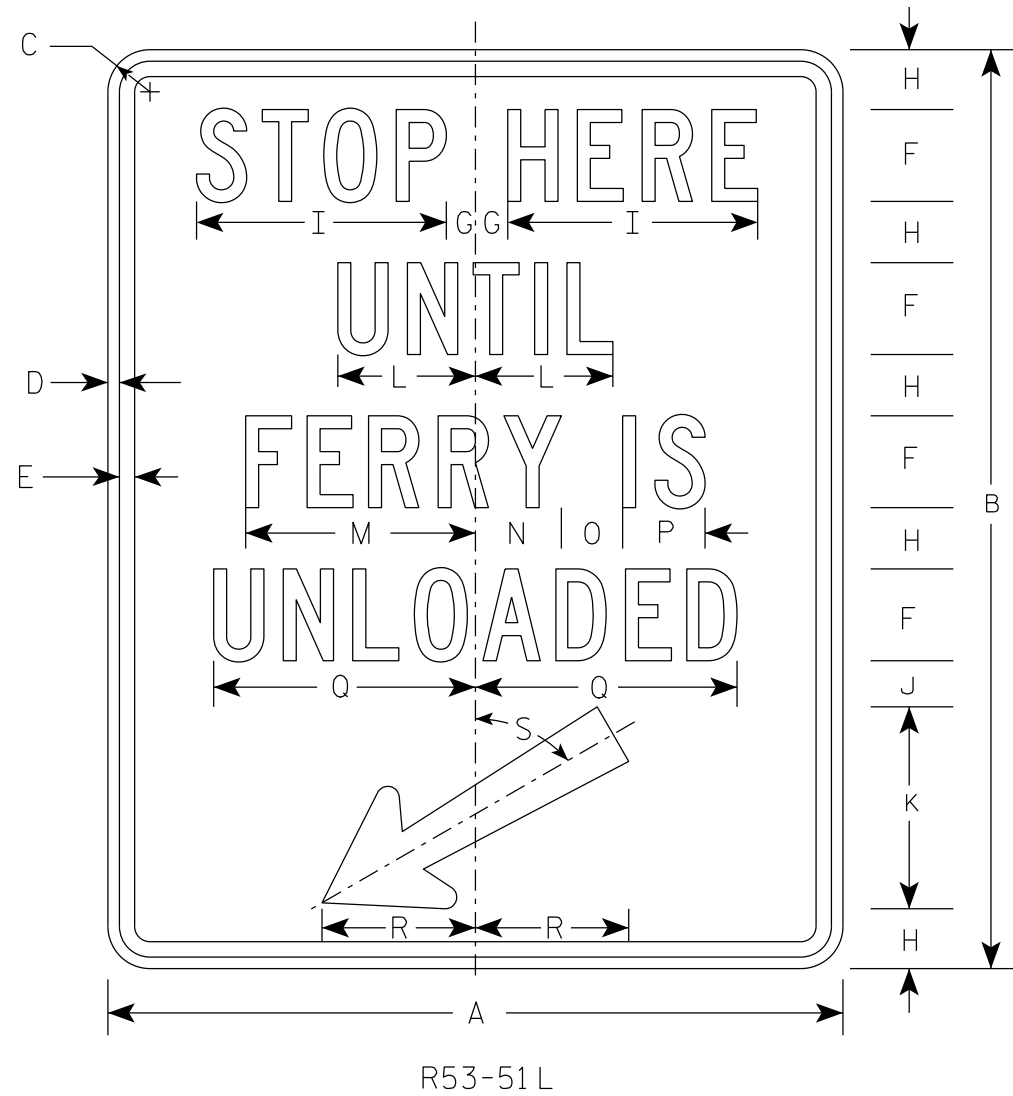

SIZE	A	B	C	D	E	F	G	H	I	J	K	L	M	N	O	P	Q	R	S	T	U	V	W	X	Y	Z	Area sq. ft.
1																											
2S	24	30	1 1/2	3/8	1/2	3	1	2	8 1/2	1 1/2	6 1/2	4 1/2	7 1/2	2 3/4	2	2 3/4	8 1/2	5	60°	5 1/4	9 3/8	1	1/2	3/8	1 3/8	3	5.0
2M	24	30	1 1/2	3/8	1/2	3	1	2	8 1/2	1 1/2	6 1/2	4 1/2	7 1/2	2 3/4	2	2 3/4	8 1/2	5	60°	5 1/4	9 3/8	1	1/2	3/8	1 3/8	3	5.0
3																											
4																											
5																											

STANDARD SIGN  
R53-51

WISCONSIN DEPT OF TRANSPORTATION

APPROVED *Matthew R Rauch*  
For State Traffic Engineer

DATE 2/9/24 PLATE NO. R53-51.7

PROJECT NO: \_\_\_\_\_ HWY: \_\_\_\_\_ COUNTY: \_\_\_\_\_ SHEET NO: **E**

7

7