

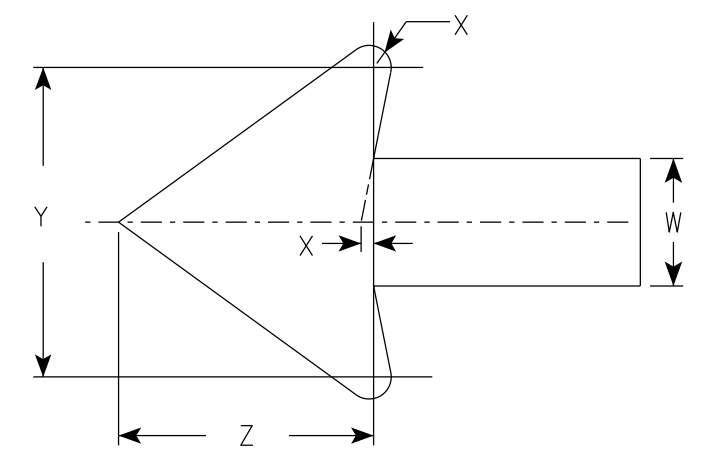

R7-53

NOTES

1. Sign is Type II - Type H Reflective
2. Color:  
Background - White  
Message - Red
3. Message Series - See Note 4
4. Lines 1, 3 and 4 are series C, line 2 is series B.
5. R7-53D (double arrow)  
R7-53L (left arrow)  
R7-53R (right arrow)



ARROW DETAIL

7

7

SIZE	A	B	C	D	E	F	G	H	I	J	K	L	M	N	O	P	Q	R	S	T	U	V	W	X	Y	Z	Area sq. ft.
1	12	18	1 1/2	3/8	3/8	3	1 7/8	2	7/8	5/8	1 1/2	2 1/2	2	2	4 7/8	4 7/8	2 5/8	1 3/4	1/4	4 1/2	2 3/8	3 7/8	3/4	1/8	1 3/4	1 1/2	1.5
2S	18	24	1 1/2	3/8	1/2	4	2 1/2	2 1/2	1 1/4	1	2	3 1/4	2 3/4	2 5/8	7 1/8	7	3 3/8	1 1/2	5/8	5 3/8	3	5 7/8	1 1/8	1/4	2 5/8	2 1/4	3.0
2M	24	30	1 1/2	3/8	1/2	5	3	3	2	1 1/4	2 1/2	4	3 1/4	3 3/8	9 1/4	9 1/4	4	2	5/8	6 5/8	3 5/8	7 3/4	1 1/2	1/4	3 1/2	3	5.0
3	24	30	1 1/2	3/8	1/2	5	3	3	2	1 1/4	2 1/2	4	3 1/4	3 3/8	9 1/4	9 1/4	4	2	5/8	6 5/8	3 5/8	7 3/4	1 1/2	1/4	3 1/2	3	5.0
4																											
5																											

STANDARD SIGN  
R7-53

WISCONSIN DEPT OF TRANSPORTATION

APPROVED *Matthew R Rauch*  
for State Traffic Engineer

DATE 11/9/23 PLATE NO. R7-53.7

PROJECT NO: \_\_\_\_\_ HWY: \_\_\_\_\_ COUNTY: \_\_\_\_\_ SHEET NO: **E**