

NOTES

1. Sign is Type II - Type H Reflective
2. Color:
Background - Sign is white Type H Reflective; paraplegic background is blue.
Message - Legend and border are green; paraplegic symbol is white
3. Message Series - Lines 1 & 2 are Series B
Lines 3, 4, 5 & 6 are Series C
4. R7-8R (RIGHT ARROW)
R7-8L (LEFT ARROW)

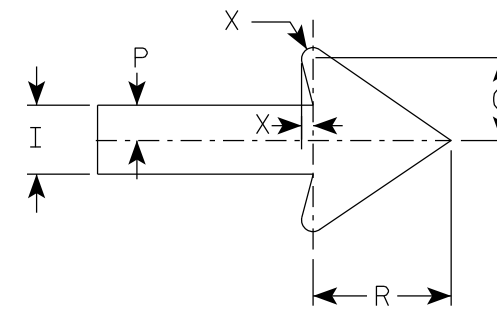
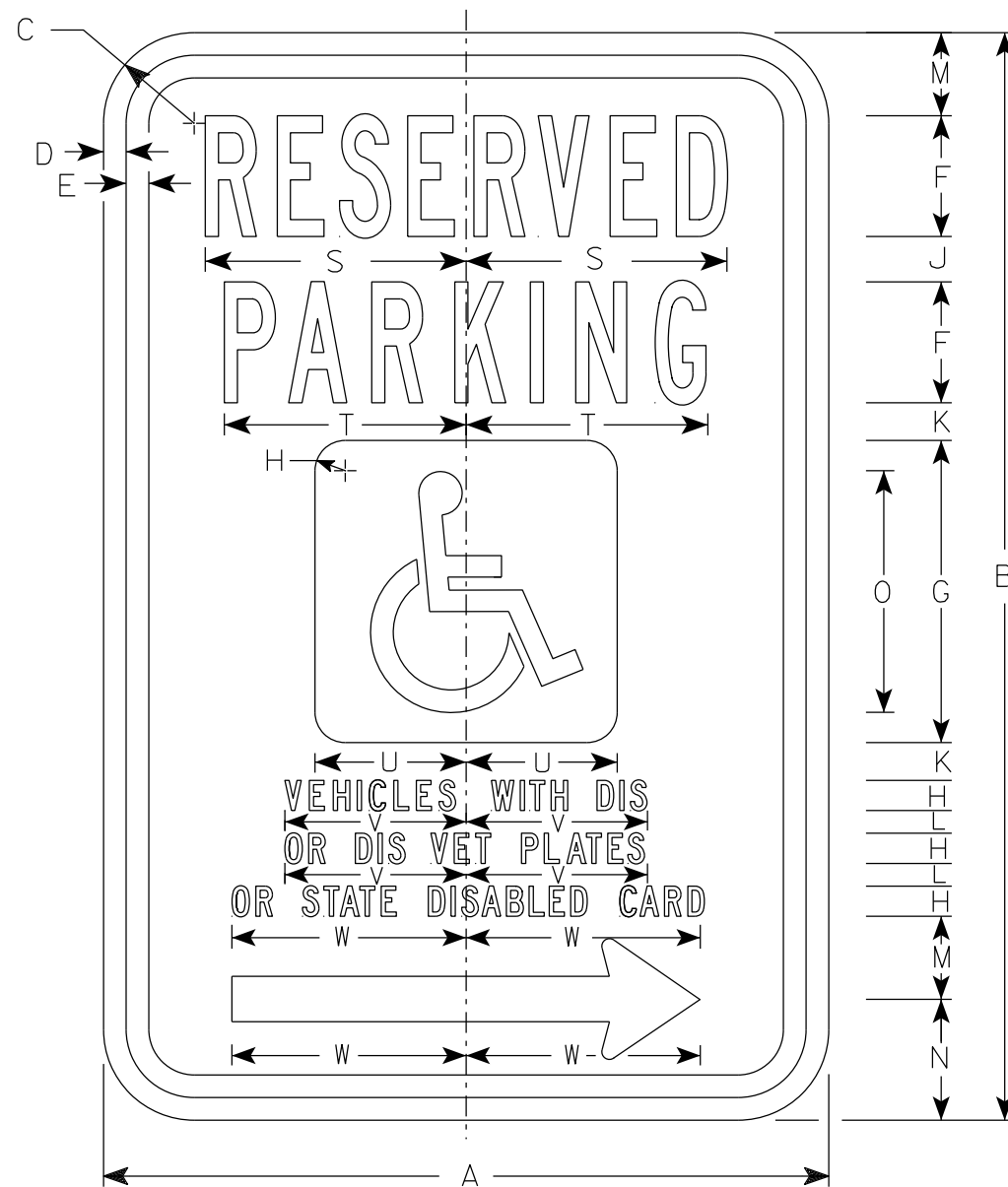

Arrow Detail

R7-8R

SIZE	A	B	C	D	E	F	G	H	I	J	K	L	M	N	O	P	Q	R	S	T	U	V	W	X	Y	Z	Area sq. ft.
1																											
2S	12	18	1 1/2	3/8	3/8	2	5	1/2	3/4	3/4	5/8	3/8	1 3/8	2	4	3/8	7/8	1 1/2	4 3/8	4	2 1/2	3	3 7/8	3/16			1.5
2M	18	24	1 1/2	3/8	1/2	3	6	3/4	1 1/8	7/8	5/8	1/2	1 7/8	2 7/8	5	5/8	1 3/8	2 1/4	6 1/2	5 3/8	3	4 1/2	5 7/8	1/8			3.0
3	18	24	1 1/2	3/8	1/2	3	6	3/4	1 1/8	7/8	5/8	1/2	1 7/8	2 7/8	5	5/8	1 3/8	2 1/4	6 1/2	5 3/8	3	4 1/2	5 7/8	1/8			3.0
4																											
5																											

STANDARD SIGN
R7-8

WISCONSIN DEPT OF TRANSPORTATION

APPROVED *Matthew R Rauch*
for State Traffic Engineer

DATE 11/9/23 PLATE NO. R7-8.7