

NOTES

1. Sign is Type II - Type H Reflective
2. Color:
Background - White
Message - Red
3. Message Series - Lines 1, 3, 4, & 5 are series D
Line 2 is series C
4. Substitute appropriate numeral for distance & adjust spacing to achieve proper balance.
5. R8-51L (Left arrow)
R8-51R (Right arrow)
R8-51D (Double arrow)

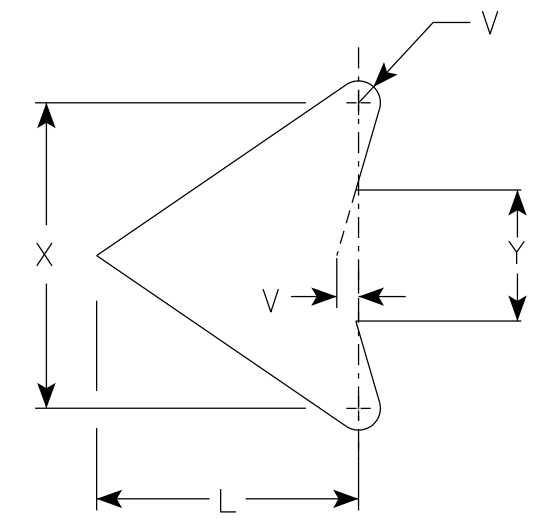

Arrow Detail

R8-51

* SEE NOTE 4

SIZE	A	B	C	D	E	F	G	H	I	J	K	L	M	N	O	P	Q	R	S	T	U	V	W	X	Y	Z	Area sq. ft.
1	18	24	1 1/2	3/8	1/2	2 1/4	3	1 1/4	1 1/2	1 1/2	1	2 1/4	4	3 1/4	3 3/8	6 7/8	3 3/8	4 5/8	5 1/4	5 1/8	5 7/8	1/4	1 1/4	2 5/8	1 1/8		3.0
2S	24	30	1 1/2	3/8	1/2	2 1/2	4	1 3/4	2 1/4	2	1 1/4	3	4	4	3 3/8	9 1/8	4 1/2	6 1/4	7	6 7/8	7 3/4	1/4	1 3/4	3 1/2	1 1/2		5.0
2M	24	30	1 1/2	3/8	1/2	2 1/2	4	1 3/4	2 1/4	2	1 1/4	3	4	4	3 3/8	9 1/8	4 1/2	6 1/4	7	6 7/8	7 3/4	1/4	1 3/4	3 1/2	1 1/2		5.0
3	24	30	1 1/2	3/8	1/2	2 1/2	4	1 3/4	2 1/4	2	1 1/4	3	4	4	3 3/8	9 1/8	4 1/2	6 1/4	7	6 7/8	7 3/4	1/4	1 3/4	3 1/2	1 1/2		5.0
4	36	48	1 7/8	1/2	5/8	4 1/2	6	2 1/2	3	3	2	4 1/2	8	6 1/2	6 5/8	13 5/8	7 1/4	9 1/2	11 1/4	11	11 5/8	3/8	2 3/4	5 1/4	2 1/4		12.0
5																											

STANDARD SIGN
R8-51

WISCONSIN DEPT OF TRANSPORTATION

APPROVED *Matthew R. Rauch*
for State Traffic Engineer

DATE 1/11/24 PLATE NO. R8-51.8

PROJECT NO: _____ HWY: _____ COUNTY: _____ SHEET NO: **E**