

NOTES

1. Sign is Type II - Type F Reflective
2. Color:
Background - Yellow
Message - Black
3. W1-10L is the same as W1-10R except the arrow is reversed along the vertical centerline.

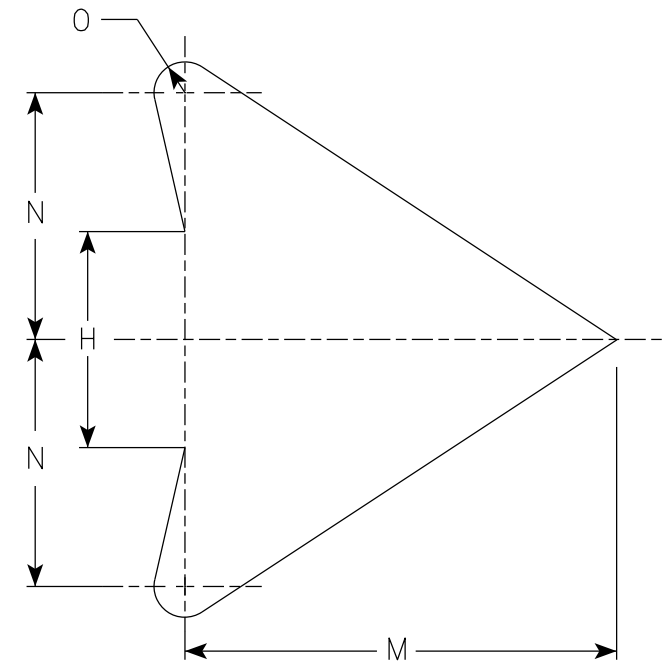
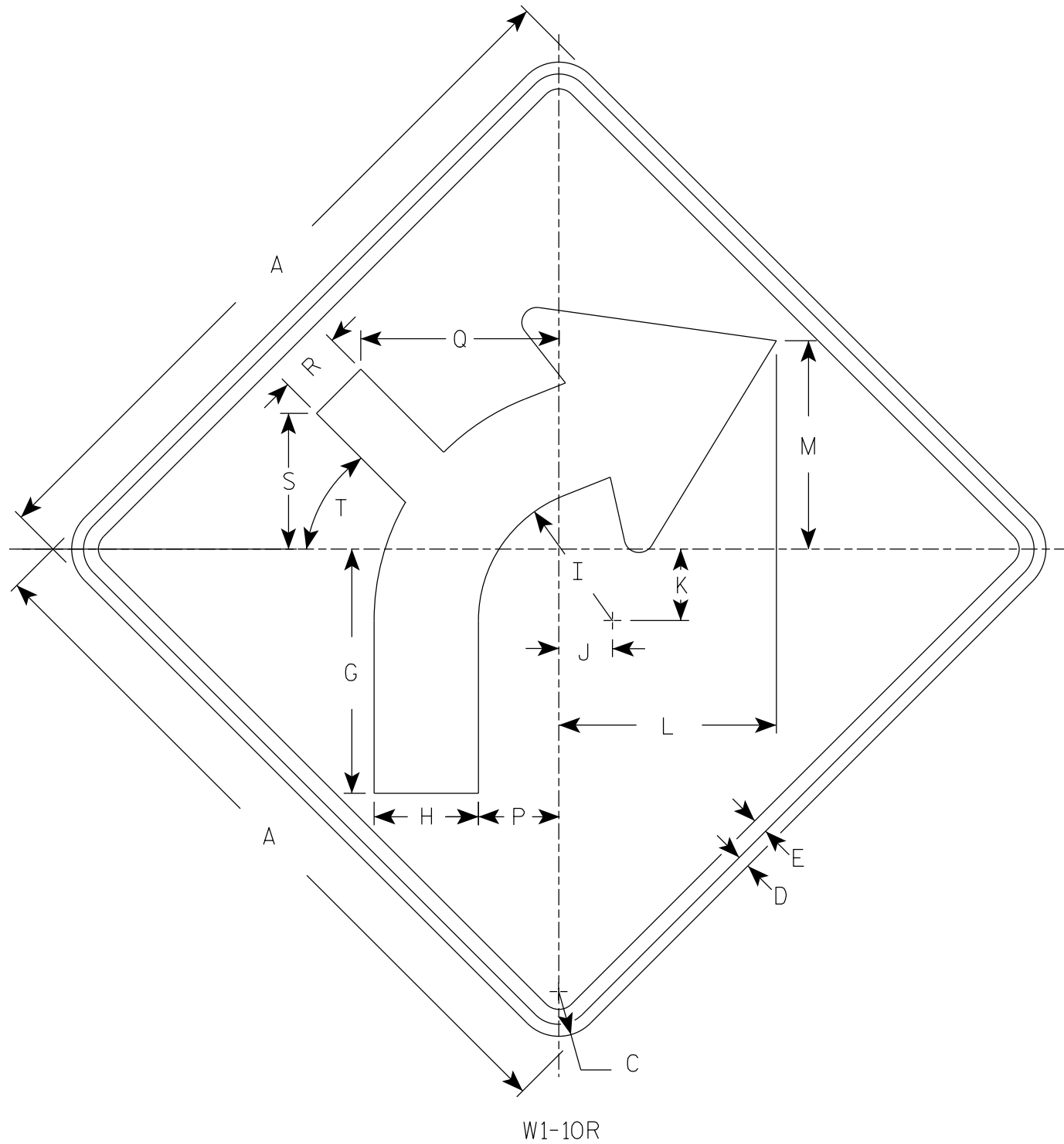

ARROW DETAIL

W1-10R

SIZE	A	B	C	D	E	F	G	H	I	J	K	L	M	N	O	P	Q	R	S	T	U	V	W	X	Y	Z	Area sq. ft.
1	24		1 1/2	3/8	1/2		8 1/4	3 1/2	4 1/2	1 3/4	2 3/8	7 1/4	7	4	1/2	2 5/8	6 5/8	2 1/8	4 1/2	45°							4.0
2S	30		1 7/8	1/2	5/8		10 1/4	4 3/8	5 5/8	2 1/4	3	9 1/8	8 3/4	5	5/8	3 3/8	8 3/8	2 5/8	5 3/4	45°							6.25
2M	36		2 1/4	5/8	3/4		12 3/8	5 1/4	6 3/4	2 5/8	3 1/2	10 7/8	10 1/2	6	3/4	4	10	3 1/4	6 7/8	45°							9.0
3	36		2 1/4	5/8	3/4		12 3/8	5 1/4	6 3/4	2 5/8	3 1/2	10 7/8	10 1/2	6	3/4	4	10	3 1/4	6 7/8	45°							9.0
4	36		2 1/4	5/8	3/4		12 3/8	5 1/4	6 3/4	2 5/8	3 1/2	10 7/8	10 1/2	6	3/4	4	10	3 1/4	6 7/8	45°							9.0
5	48		3	3/4	1		16 1/2	7	9	3 1/2	4 5/8	14 1/2	14	8	1	5 3/8	13 1/4	4 1/4	9 1/8	45°							16.0

STANDARD SIGN
W1-10

WISCONSIN DEPT OF TRANSPORTATION

APPROVED *Matthew R. Rauch*
for State Traffic Engineer

DATE 6/15/2023 PLATE NO. W1-10.4

PROJECT NO: _____ HWY: _____ COUNTY: _____ SHEET NO: **E**