

- NOTES**
1. Sign is Type II - Type F Reflective
  2. Color:  
Background - Orange  
Message - Black
  3. W24-1AR is the same as W24-1AL except reversed along the vertical centerline.

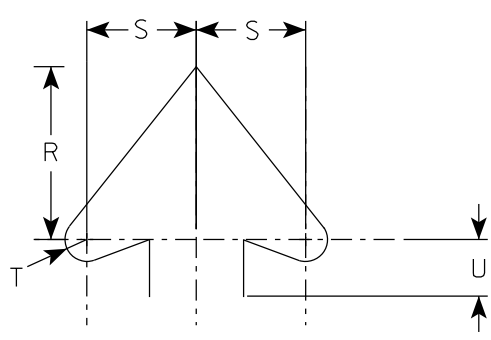

Arrowhead Detail

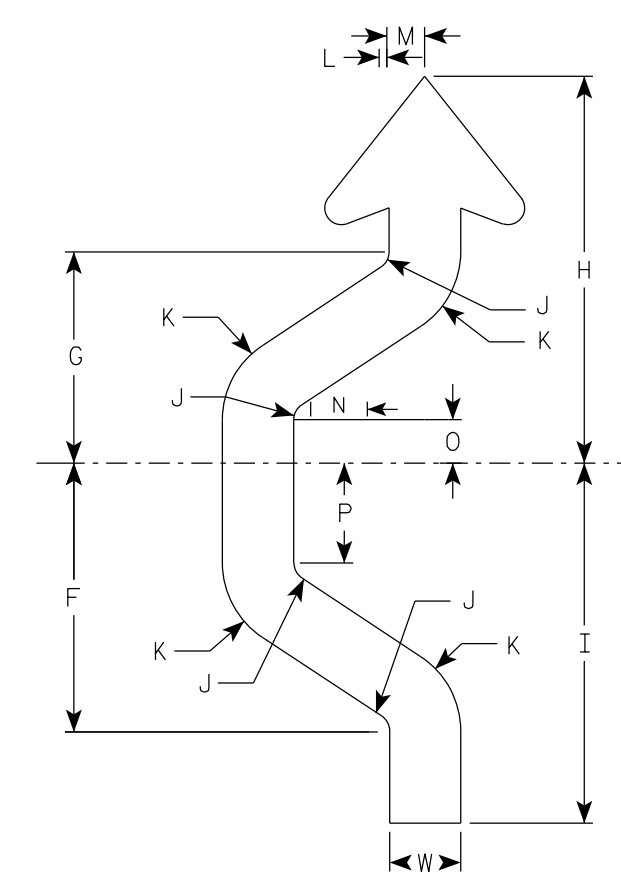

Arrow Detail

SIZE	A	B	C	D	E	F	G	H	I	J	K	L	M	N	O	P	Q	R	S	T	U	V	W	X	Y	Z	Area sq. ft.
1	36		2 1/4	5/8	1/2	9 1/2	7 1/2	13 3/4	12 3/4	5/8	3 1/8	3/8	1 5/8	2 3/8	1 1/2	3 1/2		4 5/8	3	5/8	1 1/2	4 3/4	2 1/2				9.0
2S	48		3	1	3/4	12 7/8	10 1/8	18 1/2	17 1/4	7/8	4 1/4	3/8	2 1/8	3 1/4	2	4 3/4		6 1/4	4	3/4	2 1/8	6 1/4	3 3/8				16.0
2M	48		3	1	3/4	12 7/8	10 1/8	18 1/2	17 1/4	7/8	4 1/4	3/8	2 1/8	3 1/4	2	4 3/4		6 1/4	4	3/4	2 1/8	6 1/4	3 3/8				16.0
3	48		3	1	3/4	12 7/8	10 1/8	18 1/2	17 1/4	7/8	4 1/4	3/8	2 1/8	3 1/4	2	4 3/4		6 1/4	4	3/4	2 1/8	6 1/4	3 3/8				16.0
4	48		3	1	3/4	12 7/8	10 1/8	18 1/2	17 1/4	7/8	4 1/4	3/8	2 1/8	3 1/4	2	4 3/4		6 1/4	4	3/4	2 1/8	6 1/4	3 3/8				16.0
5	48		3	1	3/4	12 7/8	10 1/8	18 1/2	17 1/4	7/8	4 1/4	3/8	2 1/8	3 1/4	2	4 3/4		6 1/4	4	3/4	2 1/8	6 1/4	3 3/8				16.0

STANDARD SIGN  
W24-1AL

WISCONSIN DEPT OF TRANSPORTATION

APPROVED *Matthew R. Rauch*  
For State Traffic Engineer

DATE 1/22/2024 PLATE NO. W24-1AL.3

PROJECT NO: \_\_\_\_\_ HWY: \_\_\_\_\_ COUNTY: \_\_\_\_\_ SHEET NO: \_\_\_\_\_ **E**

7

7