

NOTES

1. Sign is Type II -Type F Reflective
2. Color:
Background - Orange
3. Corners may be square or rounded when base material is plywood. When base material is metal the corners shall be rounded.

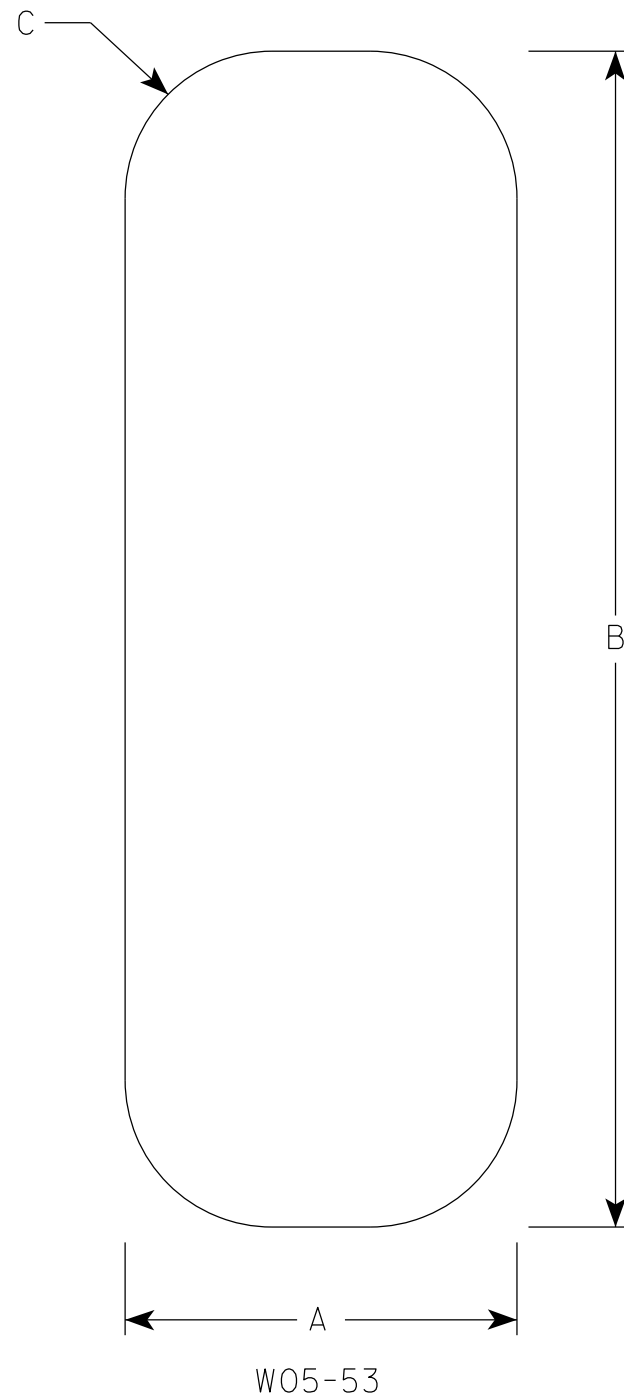

7

7

SIZE	A	B	C	D	E	F	G	H	I	J	K	L	M	N	O	P	Q	R	S	T	U	V	W	X	Y	Z	Area sq. ft.
1																											
2S	4	12	1 1/2																								.33
2M	4	12	1 1/2																								.33
3																											
4																											
5																											

STANDARD SIGN
W05-53

WISCONSIN DEPT OF TRANSPORTATION

APPROVED *Matthew R Rauch*
for State Traffic Engineer

DATE 3/27/24 PLATE NO. W05-53.2

PROJECT NO: _____ HWY: _____ COUNTY: _____ SHEET NO: **E**