



Traffic Signal Design Manual

ORIGINATOR Director, Bureau of Highway Operations		5-2-2
CHAPTER 5	Signal Plan Format	
SECTION 2	Temporary Plan Format	
SUBJECT 2	Partial-Temporary Signal Plan	

Partial-temporary signals are generally used at an existing signal when only one approach is to be reconstructed. The signal is a hybrid of existing permanent signal equipment (standard bases, poles, mast arms, etc.) and temporary supports (wood poles, span wire, etc.). The use of these types of installations are generally dependent on the type of improvement project or construction staging that will be performed.

Since the partial-temporary signal will be wired into an existing, permanent signal, the Regional Traffic Engineer **shall** be contacted prior to plan development. When partial-temporary signal indications will be connected to the state-owned signal, the final wiring connections **shall** be performed by state-forces.

The partial-temporary signal plan **shall** indicate the entire signalized intersection. Existing signal equipment **shall** be gray-shaded. Temporary equipment **shall** be shown in standard line weights. The required plan elements listed in TSDM Subject 5-2-1 **shall** be used. Refer to Figure 1 for an example of a partial-temporary signal plan.

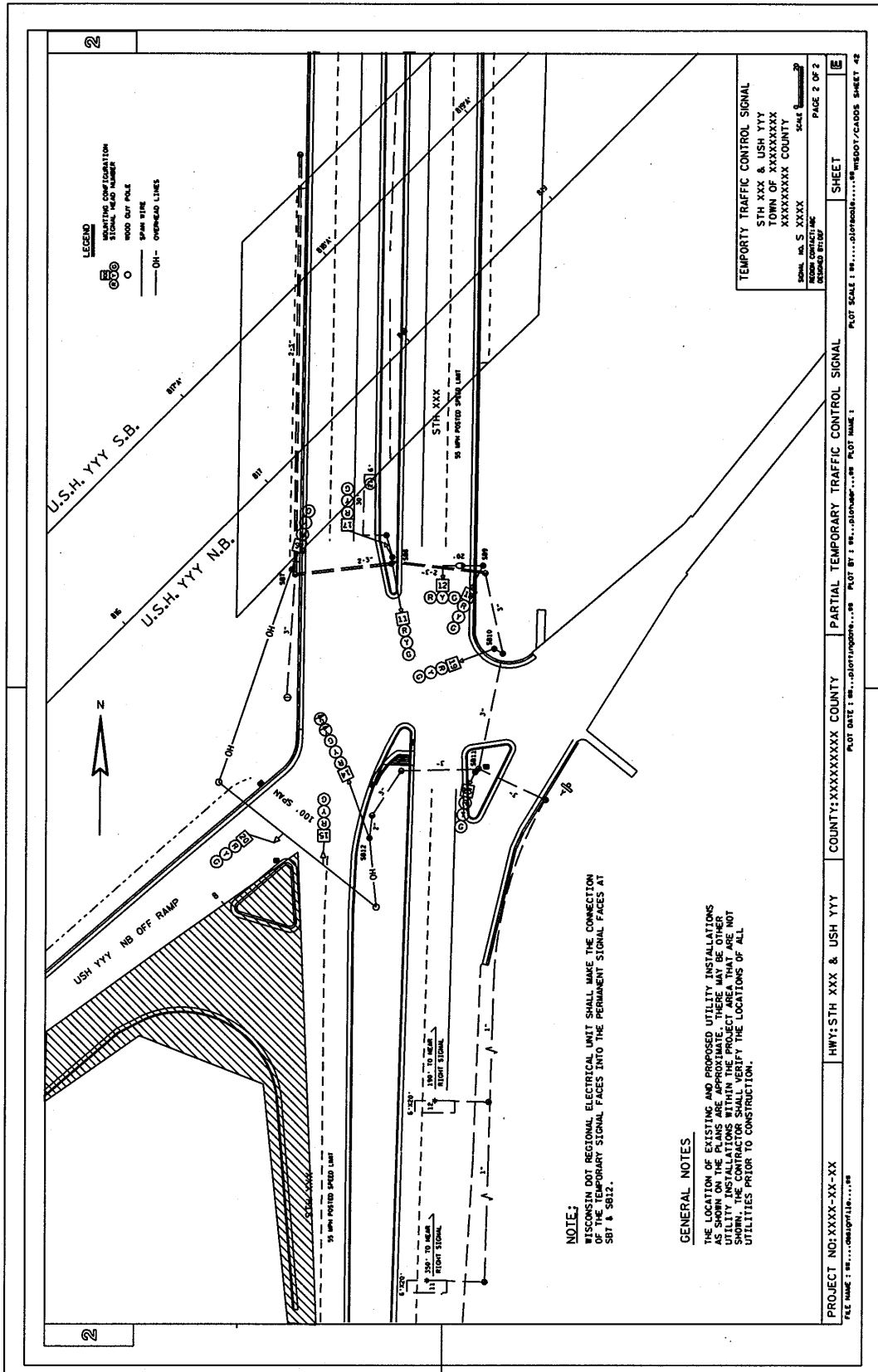

Figure 1. Partial-Temporary Signal Plan Example