



# Wisconsin Department of Transportation

April 9, 2015

**Division of Transportation Systems Development**

Bureau of Project Development  
 4802 Sheboygan Avenue, Rm 601  
 P O Box 7916  
 Madison, WI 53707-7916

Telephone: (608) 266-1631  
 Facsimile (FAX): (608) 266-8459

**NOTICE TO ALL CONTRACTORS:**

**Proposal #32: 8160-00-70, WISC 2015198**  
**Ashland - Bayfield**  
**USH 2 – Thompson Creek**  
**STH 13**  
**Bayfield County**

**8160-03-61**  
**Ashland - Bayfield**  
**USH 2 – 7<sup>th</sup> Street**  
**STH 13**  
**Bayfield County**

**Letting of April 14, 2015**

This is Addendum No. 1, which provides for the following:

**Special Provisions**

Revised Special Provisions	
Article No.	Description
3	Prosecution and Progress
4	Traffic

Added Special Provisions	
Article No.	Description
40	Removing Asphaltic Surface Additional Mill, Special, Item SPV.0180.02

Deleted Special Provisions	
Article No.	Description
36	Removing Asphaltic Surface 6-Foot Milling, Special, Item SPV.0180.01

**Schedule of Items**

Revised Bid Item Quantities					
Bid Item	Item Description	Unit	Old Quantity	Revised Quantity	Proposal Total
204.0115	Removing Asphaltic Surface Butt Joints	SY	451	629	629
204.0120	Removing Asphaltic Surface Milling	SY	140,768	133,311	133,311
455.0605	Tack Coat	GAL	16,319	16,371	16,371
465.0105	Asphaltic Surface	TON	2357	4859	5317
SPV.0195.01	HMA Pavement Type E-3 Special	TON	21,606	15,902	15,902
SPV.0195.02	HMA Pavement Type SMA Special	TON	9067	9039	9039
SPV.0195.03	SMA Pavement Compaction Acceptance	TON	9067	9039	9039

Added Bid Item Quantities					
Bid Item	Item Description	Unit	Old Quantity	Revised Quantity	Proposal Total
SPV.0180.02	Removing Asphaltic Surface Additional Mill, Special	SY	0	21,000	21,000

Deleted Bid Item Quantities					
Bid Item	Item Description	Unit	Old Quantity	Revised Quantity	Proposal Total
SPV.0180.01	Removing Asphaltic Surface 6-Foot Milling, Special	SY	14,000	0	0

### Plan Sheets

Revised Plan Sheets	
Plan Sheet	Plan Sheet Title (brief description of changes to sheet)
5	Revised finished typical sections and added note
6	Revised note for Side Road Butt Joint detail
8	New Butt Joint detail for mill depth transition
34	Revised miscellaneous quantity table—Removing Asphaltic Surface Butt Joints
35	Revised miscellaneous quantity table—Removing Asphaltic Surface Milling
38	Revised miscellaneous quantity table—Pavement Items
45	Revised miscellaneous quantity table – Milling items
47	Added notes for milling depth change
49	Added notes for milling depth change

Added Plan Sheets	
Plan Sheet	Plan Sheet Title (brief description of why sheet was added)
5A	New finished typical sections and added note
38A	Continuation of miscellaneous quantity table for pavement items

### Other

Revise the contract time for completion from 30 working days to a completion date of July 17, 2015.

The responsibility for notifying potential subcontractors and suppliers of these changes remains with the prime contractor.

Sincerely,

*Mike Coleman*

Proposal Development Specialist  
Proposal Management Section

**ADDENDUM NO. 1**  
**8160-00-70 & 8160-03-61**  
**April 9, 2015**

**Special Provisions**

**3. Prosecution and Progress**

*Replace paragraph 6 with the following:*

Regarding Removing Asphaltic Surface Milling and HMA/Asphaltic Pavement operations: Before milling operations begin on any lanes, the contractor shall mill out trenches/notches across the shoulders for drainage to the width, depth and at locations as specified by the engineer. Do not allow traffic to travel on milled surfaces for more than 10 days. For the Removing Asphaltic Pavement Additional Mill, Special areas, the void must be filled up with asphaltic surface even to the milled surface of the work done under Removing Asphaltic Surface Milling before traffic is allowed back on the area.

**4. Traffic**

*Replace paragraph 1 with the following:*

STH 13 and connecting side roads will be open to two-way traffic during night time and weekend hours. The contractor may restrict traffic to a single lane within construction work zones during weekday daylight hours. This lane shall be kept free of all equipment and materials, and the minimum width including shoulders, shall be 15 feet. No more than two single lane restrictions will be allowed on STH 13 at any one time and such restrictions shall be a minimum of one mile apart. Supplement flaggers with a pilot vehicle to facilitate traffic flow through the area of construction operations for each lane restriction exceeding one mile in length. After July 6<sup>th</sup>, 2015, single lane restrictions will only be allowed from Monday at 6:00 AM until Friday at 12:00 PM each week, and will be controlled by flaggers. Flagger operations shall be in accordance with the Standard Detail Drawing "Traffic Control for Lane Closure (Suitable for Moving Operations)" and the ATSSA Flagger Handbook.

**36. Deleted**

**40. Removing Asphaltic Surface Additional Mill, Special, Item SPV.0180.02.**

**A Description**

This work shall be in accordance to the plan, the pertinent requirements of standard spec 204 and as hereinafter provided.

**B (Vacant)**

**C (Vacant)**

**D Measurement**

The department will measure Removing Asphaltic Surface Additional Mill, Special by the square yard, acceptably completed.

**E Payment**

The department will pay for measured quantities at the contract unit price under the following bid item:

ITEM NUMBER	DESCRIPTION	UNIT
SPV.0180.02	Removing Asphaltic Surface Additional Mill, Special	SY

Payment is full compensation conforming to standard spec 204.

**Schedule of Items**

Attached, dated April 9, 2015, are the revised Schedule of Items Pages 1, 3, 12, and 13.

**Plan Sheets**

The following 8½ x 11-inch sheets are attached and made part of the plans for this proposal:  
Revised: Highway Work Proposal, 5, 6, 8, 34, 35, 38, 45, 47 and 49.  
Added: 5A and 38A.

END OF ADDENDUM

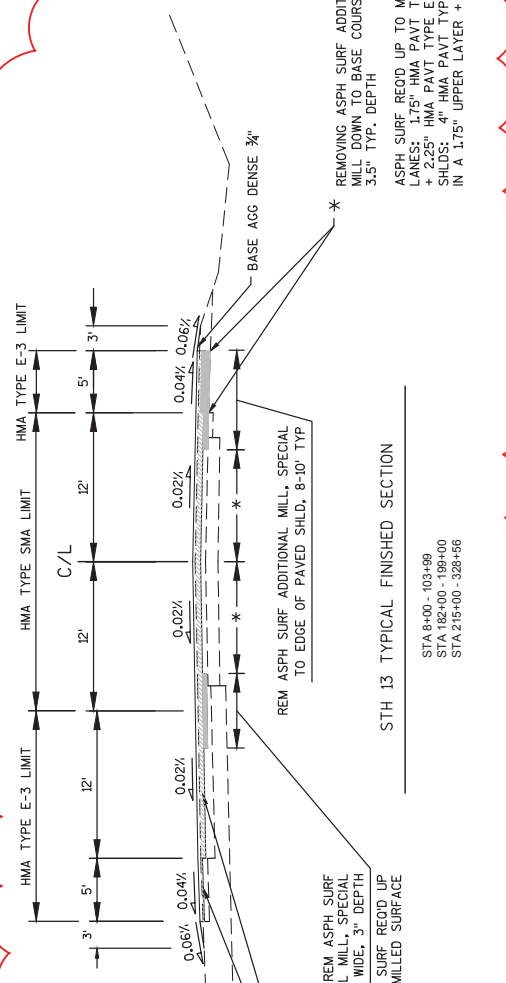

REMOVING ASPH SURF MILLING, 3" ON LANES AND 3/4" ON SHLDS FOR DRIVING LANES, INCLUDING PASSING LANE: 1.75" HMA PAVT TYPE SMA SPEC (UPPER LAYER) + 2.25" HMA PAVT TYPE E-3 SPEC (LOWER LAYER) REOD IN A 1.75" UPPER LAYER + 2.25" LOWER LAYER

FOR TURN & BYPASS LANES: 4" HMA PAVT TYPE E-3 SPEC REOD, (PLACED IN A 1.75" UPPER LAYER + 2.25" LOWER LAYER)

FOR SHLDS: 1.75" HMA PAVT TYPE E-3 SPEC REOD, UPPER LAYER

REMOVING ASPH SURF ADDITIONAL MILL, SPECIAL MILL DOWN TO BASE COURSE WITHIN THIS AREA 3.5" TYP. DEPTH

ASPH SURF REOD UP TO MILLED SURFACE LANES: 1.75" HMA PAVT TYPE SMA SPEC (UPPER LAYER) + 2.25" HMA PAVT TYPE E-3 SPEC (LOWER LAYER) REOD SHLDS: 4" HMA PAVT TYPE E-3 SPEC REOD, (PLACED IN A 1.75" UPPER LAYER + 2.25" LOWER LAYER)

REM ASPH SURF ADDITIONAL MILL, SPECIAL TO EDGE OF PAVED SHLD, 8-10' TYP

STH 13 TYPICAL FINISHED SECTION

STA 8+00 - 103+69  
STA 182+00 - 199+00  
STA 215+00 - 328+56

\* NOTE: REMOVING ASPHALTIC SURFACE ADDITIONAL MILL, SPECIAL OFFSET FROM CL AS SPECIFIED BY ENGINEER IN THE FIELD, NORM 7'-9"

LENGTHS GIVEN BELOW ARE UNDISTRIBUTED WITHIN THE GIVEN STATION RANGES EXACT LOCATIONS TO BE MARKED IN THE FIELD BY ENGINEER

- STA 8+00-29+50 AND 30+32-61+62 SB 2350 FT NB 3500 FT
- STA 61+62-112+73 AND 112+95-114+65 SB 3650 FT NB 2650 FT
- STA 114+65-167+45 SB 1875 FT NB 2000 FT
- STA 167+45-220+25 SB 1100 FT NB 1100 FT
- STA 220+25-220+99 AND 221+98-274+09 SB 1350 FT NB 650 FT
- STA 274+09-328+56 SB 675 FT NB 100 FT

NOTES: CENTERLINE AND TYPE 1 SHOULDER RUMBLE STRIPS ARE REQUIRED ON THE FINISHED SURFACE.

BEFORE MILLING OPERATIONS BEGIN ON ANY LANES, TRENCHES OR NOTCHES WILL BE MILLED OUT ACROSS THE SHOULDERS FOR DRAINAGE PURPOSES TO THE WIDTH, DEPTH AND AT LOCATIONS AS SPECIFIED BY THE ENGINEER.

Addendum No. 1  
IDs 8160-00-70 &  
8160-03-61  
Revised Sheet 5  
April 9, 2015

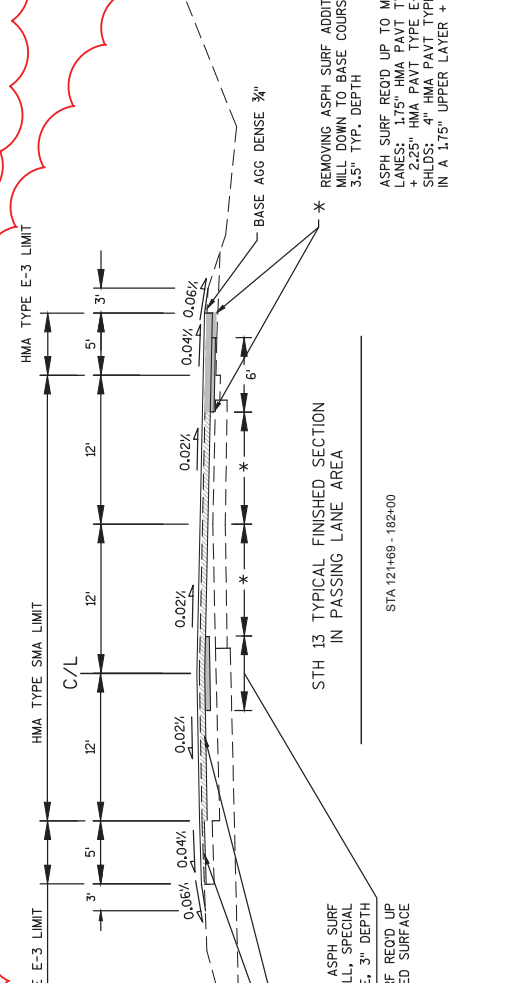

REMOVING ASPH SURF MILLING, 3" ON LANES AND 3/4" ON SHLDS FOR DRIVING LANES, INCLUDING PASSING LANE: 1.75" HMA PAVT TYPE SMA SPEC (UPPER LAYER) + 2.25" HMA PAVT TYPE E-3 SPEC (LOWER LAYER) REOD IN A 1.75" UPPER LAYER + 2.25" LOWER LAYER

FOR TURN & BYPASS LANES: 4" HMA PAVT TYPE E-3 SPEC REOD, (PLACED IN A 1.75" UPPER LAYER + 2.25" LOWER LAYER)

FOR SHLDS: 1.75" HMA PAVT TYPE E-3 SPEC REOD, UPPER LAYER

REMOVING ASPH SURF ADDITIONAL MILL, SPECIAL MILL DOWN TO BASE COURSE WITHIN THIS AREA 3.5" TYP. DEPTH

ASPH SURF REOD UP TO MILLED SURFACE LANES: 1.75" HMA PAVT TYPE SMA SPEC (UPPER LAYER) + 2.25" HMA PAVT TYPE E-3 SPEC (LOWER LAYER) REOD SHLDS: 4" HMA PAVT TYPE E-3 SPEC REOD, (PLACED IN A 1.75" UPPER LAYER + 2.25" LOWER LAYER)

STH 13 TYPICAL FINISHED SECTION IN PASSING LANE AREA

STA 121+69 - 182+00

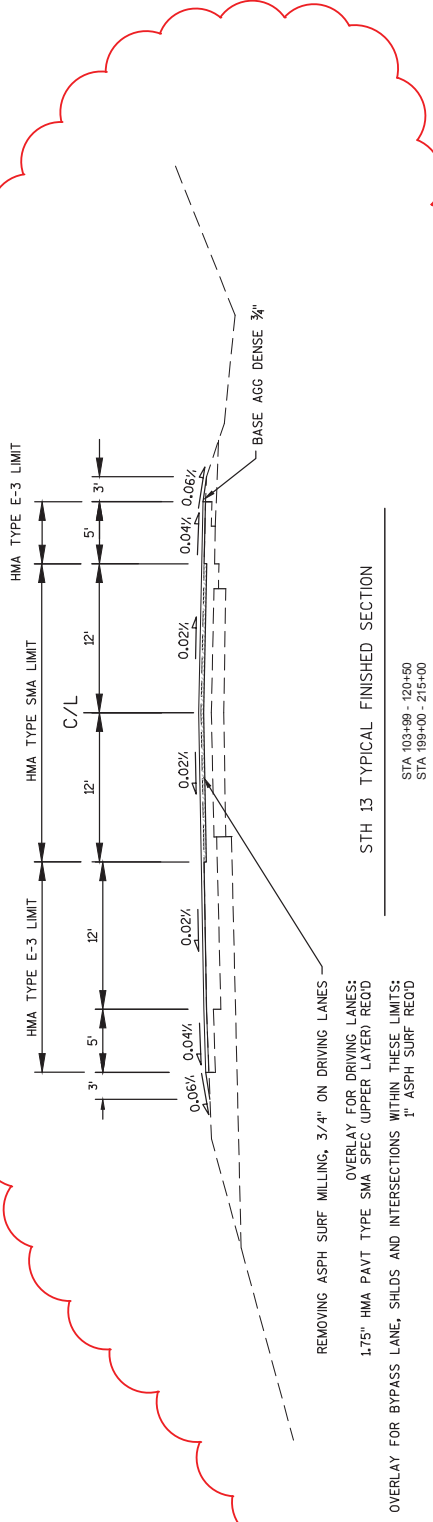

REMOVING ASPH SURF MILLING, 3/4" ON DRIVING LANES  
OVERLAY FOR DRIVING LANES:  
1.75" HMA PAVT TYPE SMA SPEC (UPPER LAYER) REOD  
OVERLAY FOR BYPASS LANE, SHLDS AND INTERSECTIONS WITHIN THESE LIMITS:  
1" ASPH SURF REOD

NOTES: CENTERLINE AND TYPE I, SHOULDER RUMBLE STRIPS, ARE REQUIRED ON THE FINISHED SURFACE.

BEFORE MILLING OPERATIONS BEGIN ON ANY LANES, TRENCHES OR NOTCHES WILL BE MILLED OUT ACROSS THE SHOULDERS FOR DRAINAGE PURPOSES TO THE WIDTH, DEPTH AND AT LOCATIONS AS SPECIFIED BY THE ENGINEER.

Addendum No. 1  
IDs 8160-00-70 &  
8160-03-61  
Added Sheet 5A  
April 9, 2015

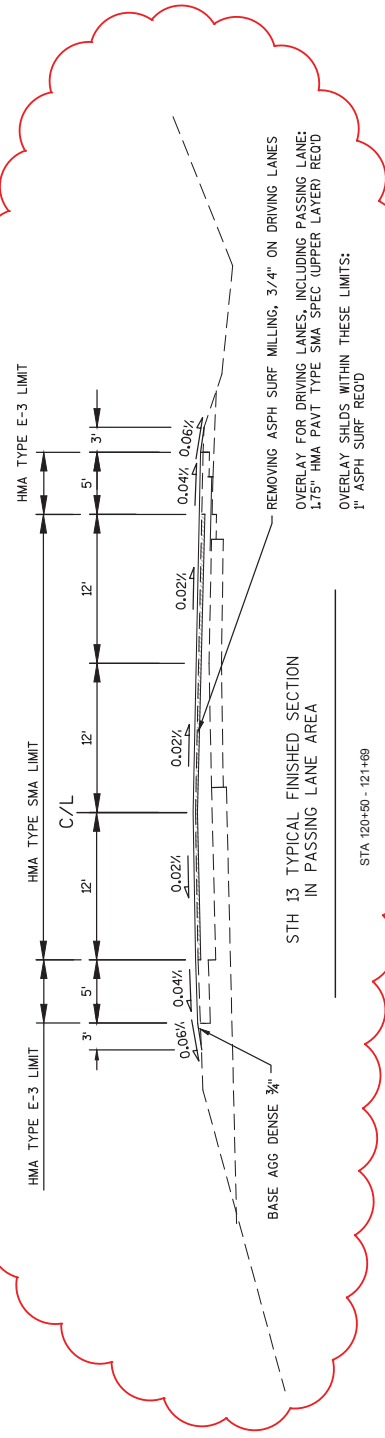

REMOVING ASPH SURF MILLING, 3/4" ON DRIVING LANES  
OVERLAY FOR DRIVING LANES, INCLUDING PASSING LANE:  
1.75" HMA PAVT TYPE SMA SPEC (UPPER LAYER) REOD  
OVERLAY SHLDS WITHIN THESE LIMITS:  
1" ASPH SURF REOD

STH 13

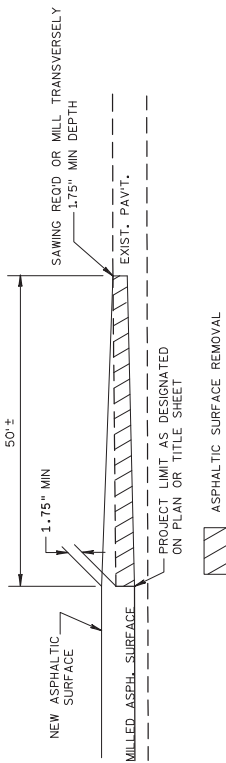

**OVERLAP JOINT, BUTTED DETAIL**

STA 8+00

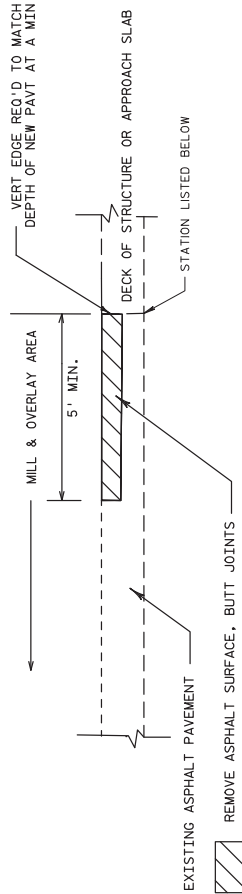

**DETAIL FOR BUTT JOINTS AT ENDS OF WORK AREAS AND STRUCTURE LOCATIONS**

STA 29+50 STA 30+32  
STA 112+73 STA 112+95  
STA 328+36

**SIDE ROAD LOCATION'S REQUIRING BUTT JOINTS**

- CHERRYVILLE ROAD STA. 27+54.6 LT
- MISSION SPRINGS RD STA. 78+35.7 RT
- NOLANDER ROAD STA. 164+63.4 LT
- WEDAL ROAD STA. 217+15.1 LT
- LAKE SHORE DRIVE STA. 233+52.2 RT
- LAKE SHORE DRIVE STA. 232+24.5 RT
- LAKE SHORE DRIVE STA. 281+76.9 RT
- SUMMIT AVENUE STA. 320+83.2 RT
- THOMPSON ROAD STA. 320+83.6 LT
- FUR FARM ROAD STA. 327+78.8 LT
- ONDOSAGON ROAD STA. 54+78.8 LT
- BIRCH GROVE ROAD STA. 184+76.8 RT
- BONO CREEK ROAD STA. 199+75.7 RT
- OLSEN ROAD STA. 222+77.5 RT
- ENGLE ROAD STA. 242+06.8 LT
- NEVERS ROAD STA. 268+44.1 LT
- FANNING ROAD STA. 294+90.4 LT
- FALKNER ROAD STA. 303+70.0 LT
- BIGLOW STREET STA. 320+83.0 RT

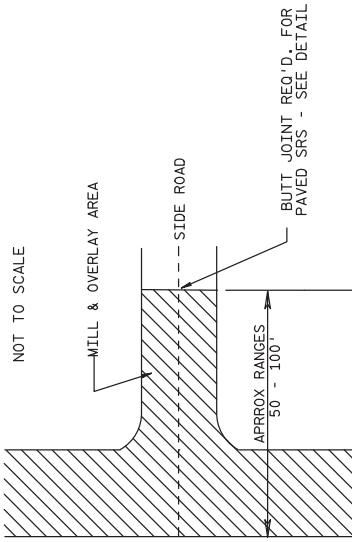

**SIDE ROAD DETAIL - NO CURB & GUTTER**

NOTE: IF THE EXISTING SIDEROAD CONSISTS OF A BASE COURSE SURFACE, THE NEW ASPHALT SHALL BE PLACED TO THE END OF THE FARTHER EXISTING SIDEROAD RADIUS.

NOT TO SCALE

STH 13

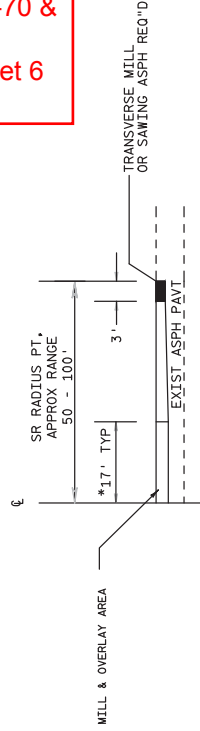

**SIDE ROAD BUTT JOINT DETAIL**

REMOVE MATERIAL UNDER ITEM 'REMOVING ASPHALT SURFACE, BUTT JOINTS' MATERIAL SHALL NOT BE REMOVED UNDER THIS ITEM UNTIL 24 HOURS BEFORE SIDEROAD PAVING.

SIDEROAD PAVEMENT DEPTH SHALL MATCH AT MAINLINE PAVEMENT EDGE AND BE TAPERED TO 2" MINIMUM AT JOINT, EXCEPT AT BONO CREEK AND WEDAL ROADS WHERE 1" JOINT IS REQ'D

\*EDGE OF PAVED SHOULDER ALONG ML

Addendum No. 1  
IDs 8160-00-70 &  
8160-03-61  
Revised Sheet 6  
April 9, 2015

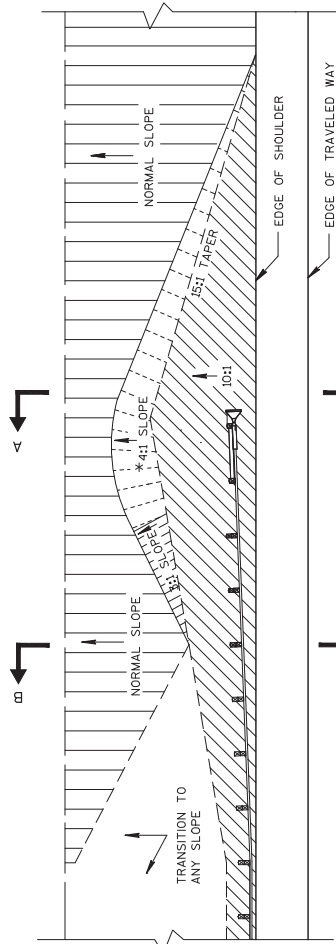

PLAN VIEW

\*A 3:1 MAXIMUM SLOPE MAY BE USED FOR INSTALLATIONS ON EXISTING HIGHWAYS.

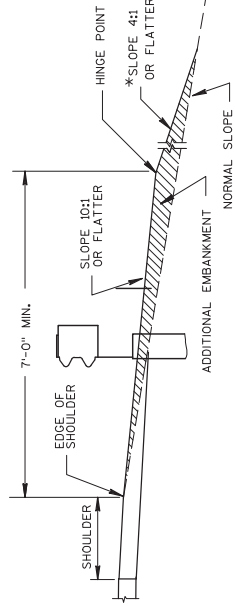

SECTION A-A

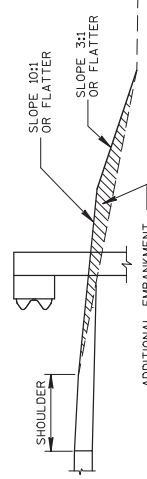

SECTION B-B

FILL AREA AT BEAM GUARD

Addendum No. 1  
 IDs 8160-00-70 &  
 8160-03-61  
 Revised Sheet 8  
 April 9, 2015

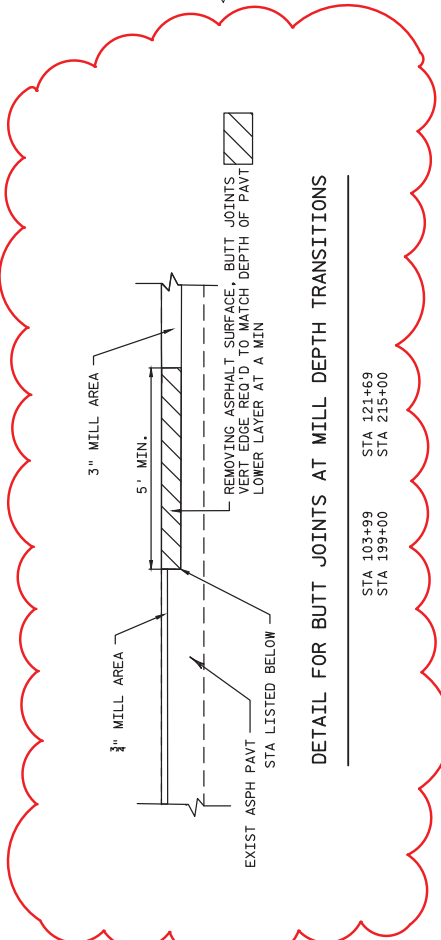

DETAIL FOR BUTT JOINTS AT MILL DEPTH TRANSITIONS

STA 103+99  
STA 199+00  
STA 121+69  
STA 215+00

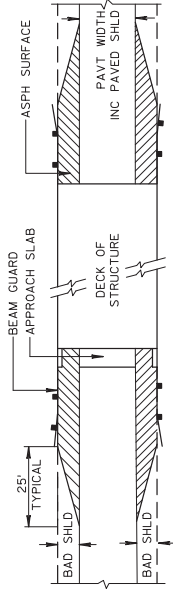

DETAIL FOR ASPHALTIC SHOULDERS AT STRUCTURES

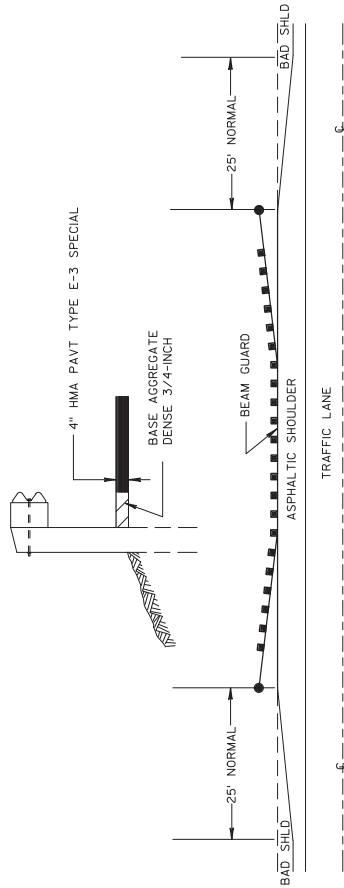

DETAIL FOR ASPHALTIC SHOULDER TAPERS AT BEAM GUARD



ROADSIDE CLEARING

CATEGORY	STATION TO	STATION	LOCATION	202.0105 STA	DIST FROM CL
0010	61+00	-	LT	3	45'
0010	64+00	-	LT & RT	6	45'
0010	70+00	-	LT	4	45'
0010	80+00	-	RT	4	45'
0010	90+00	-	RT	5	45'
0010	97+00	-	RT*	6	45'
0010	117+00	-	RT	3	45'
0010	155+00	-	RT	2	45'
0010	158+00	-	RT	1	45'
0010	214+00	-	LT	16	55'
0010	247+50	-	LT	2	60'
0010	252+00	-	LT	1	60'
0010	257+00	-	LT	6	65'
0010	266+00	-	LT	1	65'
0010	270+00	-	LT	4	65'
0010	274+00	-	LT	4	45'
0010	283+00	-	LT	11	65'
0010	299+00	-	LT	4	45'
0010	302+00	-	LT & RT	7	45' LT, 55' RT
0010	309+00	-	LT & RT	7	100' LT, 55' RT
0010	316+00	-	LT & RT	3	55'
0010	321+50	-	RT	2	45'
TOTAL 0010					102

\*FOR CULVERT WORK, EXTEND CLEARING LIMITS AT 102+65 - 102+95 RT TO 50'

REMOVING PAVEMENT

CATEGORY	STATION	LOC	204.0100 SY	REMARKS
0010	13+00	LT	33	CONCRETE RUMBLE PAD
TOTAL 0010				33

REMOVING ASPHALTIC SURFACE BUTT JOINTS

CATEGORY	STATION	LOCATION	204.0115 SY	REMARKS
0010	8+00	CL	189	34' x50'
0010	27+54.6	SR Lt, Cherryville Rd	8	24' x5'
0010	29+50	CL, Whittlesey Creek	22	39' x5'
0010	30+32	CL, Whittlesey Creek	22	39' x5'
0010	54+78.8	SR Lt, Ondessagon Rd	8	24' x5'
0010	78+93.7	SR Rt, Mission Springs Rd	8	24' x5'
0010	84+76.8	SR Rt, Birch Grove Rd	8	24' x5'
0010	84+83.4	SR Lt, Noland Rd	8	24' x5'
0010	103+99.0	CL, Mill depth change	22	39' x5'
0010	112+73	CL, Boyd Creek	22	39' x5'
0010	112+95	CL, Boyd Creek	22	39' x5'
0010	121+69	CL, Mill depth change	22	39' x5'
0010	199+00	CL, Mill depth change	22	39' x5'
0010	199+75.7	SR Rt, Bono Creek Rd	53	24' x20'
0010	211+75.7	SR Lt, Wedal Rd	53	24' x20'
0010	215+00.0	CL, Mill depth change	22	39' x5'
0010	223+77.5	SR Rt, Ol sen Rd	8	24' x5'
0010	233+32.2	SR Rt, Lake Shore Drive	8	24' x5'
0010	242+06.8	SR Lt, Engoe Rd	8	24' x5'
0010	252+24.5	SR Rt, Lake Shore Drive	8	24' x5'
0010	268+44.1	SR Lt, Nevers Rd	8	24' x5'
0010	281+76.9	SR Rt, Lake Shore Drive	8	24' x5'
0010	204+90.4	SR Lt, Wannebo Rd	8	24' x5'
0010	204+99.2	SR Rt, Summit Ave	8	24' x5'
0010	305+70.0	SR Lt, Faulkner Rd	8	24' x5'
0010	320+83.0	SR Rt, Bliglow Street	8	24' x5'
0010	320+89.6	SR Lt, Thompson Rd	8	24' x5'
0010	327+18.8	SR Lt, Fur Farm Rd	8	24' x5'
0010	328+36	CL, Thompson Creek	22	39' x5'
TOTAL 0010				629

Addendum No. 1  
IDs 8160-00-70 &  
8160-03-61  
Revised Sheet 34  
April 9, 2015

REMOVING ASPHALTIC SURFACE MILLING

CATEGORY	STATION TO	STATION	LOC	SY	REMARKS
0010	8+00 -	29+50	ML	8122	Cherryville Road
0010	27+55	-	SR	412	
0010	30+32 -	51+00	ML	7812	Bypass lane inc.
0010	51+00 -	55+00	ML	2044	Ondossagon Road
0010	54+79	-	SR	325	
0010	55+00 -	60+00	ML	2944	Rt turn and bypass lane inc.
0010	60+00 -	103+99	ML	16618	
0010	78+94	-	SR	141	Mission Springs Road
0010	103+99	112+73	ML	2331	Reduced mill depth, nic shlds
0010	112+95	121+69	ML	2331	Reduced mill depth, nic shlds
0010	121+69 -	182+00	ML	30825	Passing lane inc.
0010	182+00 -	185+60	ML	1360	
0010	184+77	-	SR	211	Birch Grove Road
0010	184+83	-	SR	599	Nolander Road
0010	185+60 -	187+60	ML	911	Rt turn lane inc.
0010	187+60 -	199+00	ML	4307	
0010	199+00	208+30	ML	2480	Reduced mill depth, nic shlds & byp lane
0010	208+30 -	215+00	ML	1787	Reduced mill depth, nic shlds & byp lane
0010	215+00	216+30	ML	664	
0010	216+30 -	220+94	ML	1753	
0010	221+98 -	249+50	ML	10396	
0010	223+78	-	SR	388	Olsen Road
0010	233+32	-	SR	61	Lake Shore Drive
0010	242+07	-	SR	372	Engoe Road
0010	249+50 -	251+80	ML	1048	Right turn lane inc.
0010	251+80 -	264+80	ML	4911	
0010	252+24	-	SR	191	Lake Shore Drive
0010	264+80 -	272+40	ML	3884	Bypass lane inc.
0010	268+44	-	SR	258	Nevers Road
0010	272+40 -	278+70	ML	2380	
0010	278+70 -	284+50	ML	2964	Bypass lane inc.
0010	281+77	-	SR	90	Lake Shore Drive
0010	284+50 -	318+00	ML	12656	
0010	294+90	-	SR	240	Wannebo Road
0010	294+99	-	SR	120	Summit Avenue
0010	305+70	-	SR	163	Faulkner Road
0010	318+00 -	320+20	ML	1002	Right turn lane inc.
0010	320+20 -	328+56	ML	3158	
0010	320+83	-	SR	620	Biglow Street
0010	320+90	-	SR	278	Thompson Road
0010	327+19	-	SR	152	Fur Farm Road
				TOTAL 0010	133,311

PROJECT NO: 8160-00-70

HWY: STH 13

COUNTY: BAYFIELD

MISCELLANEOUS QUANTITIES

SHEET 2 OF 12

SHEET: 35

E

REMOVING CURB & GUTTER

CATEGORY	STATION	LOC	LF	REMARKS
0010	54+50	LT	50	ONDOSAGON RD
0010	55+00	LT	80	ONDOSAGON RD
0010	241+70	LT	70	ENGOE ROAD
0010	242+50	LT	86	ENGOE ROAD
TOTAL 0010			286	

SALVAGED RAIL

CATEGORY	STATION TO	STATION	LOC	LF	REMARKS
0010	29+00	-	LT	70	WHITILESEY CREEK
0010	29+00	-	RT	70	WHITILESEY CREEK
0010	30+10	-	LT	70	WHITILESEY CREEK
0010	30+10	-	RT	70	WHITILESEY CREEK
0010	112+00	-	LT	70	BOYD CREEK
0010	112+00	-	RT	70	BOYD CREEK
0010	113+00	-	LT	70	BOYD CREEK
0010	113+00	-	RT	70	BOYD CREEK
0010	203+80	-	LT	628	BONO CREEK
0010	203+80	-	RT	682	BONO CREEK
0010	253+80	-	LT	260	GUILLEY @ CULV INLET
0010	260+60	-	LT	234	GUILLEY @ CULV INLET
0010	271+66	-	LT	190	GUILLEY @ CULV INLET
TOTAL 0010				2554	

Addendum No. 1  
IDs 8160-00-70 &  
8160-03-61  
Revised Sheet 35  
April 9, 2015

Addendum No. 1  
 IDs 8160-00-70 &  
 8160-03-61  
 Revised Sheet 38  
 April 9, 2015

CATEGORY	STATION TO	STATION	LOC	TACK COAT GAL	ASPHALTIC SURFACE TON	SPV. 0195.01 LOWER LAY: ALL LANES & SHLDS HMA PAVEMENT TYPE E-3 SPECIAL		SPV. 0195.01 UPPER LAY: AUX LANES & SHLDS HMA PAVEMENT TYPE E-3 SPECIAL		SPV. 0195.02 UPPER LAY: THRU & PASS LANES HMA PAVEMENT TYPE SMA SPECIAL		SPV. 0195.03 SMA PAVT COMPACTION ACCEPTANCE TON	REMARKS
						TON	TON	TON	TON	TON	TON		
0010	8+00	- 29+50	ML	975	717	975	232	69	557	557	557	557	Cherryville Road
0010	27+55	- 51+00	SR	37	689	937	223	223	536	536	536	536	Bypass lane inc in E-3
0010	30+32	- 55+00	ML	181	200	181	95	95	104	104	104	104	Ondossagon Road
0010	51+00	- 60+00	ML	29	333	54	54	54	130	130	130	130	Rt turn & bypass lane inc in E-3
0010	54+79	- 103+99	SR	227	1466	1994	475	501	1140	1140	1140	1140	Mission Springs Road inc tapers
0010	55+00	- 112+73	ML	198	54	265	227	227	227	227	227	227	Reduced pavt thick area
0010	78+94	- 182+00	SR	198	59	198	227	227	2345	2345	2345	2345	Reduced pavt thick area
0010	103+99	- 185+60	ML	198	3016	2734	651	39	93	93	93	93	Passing lane inc in E-3 & SMA
0010	112+95	- 184+77	ML	198	120	19	45	45	100	100	100	100	Birch Grove Road inc tapers
0010	121+69	- 184+83	ML	54	100	54	37	37	52	52	52	52	Nolander Road
0010	121+69	- 187+60	ML	91	380	517	123	123	296	296	296	296	Rt turn lane inc in E-3
0010	185+60	- 199+00	ML	57	57	211	241	241	241	241	241	241	Reduced pavt thick area
0010	187+60	- 208+30	ML	211	29	211	29	29	174	174	174	174	Bono Creek Road inc tapers,
0010	199+00	- 215+00	SR	20	91	20	91	91	174	174	174	174	reduced pavt thick area
0010	199+76	- 211+76	ML	205	33	205	33	33	34	34	34	34	Reduced pavt thick area
0010	208+30	- 216+30	ML	25	65	25	31	31	60	60	60	60	Wedal Road inc tapers, reduced
0010	211+76	- 220+94	SR	25	155	33	120	120	120	120	120	120	pavt thick area
0010	215+00	- 249+50	ML	80	917	1248	297	297	713	713	713	713	Bypass lane inc in E-3
0010	216+30	- 249+50	ML	210	75	35	75	75	60	60	60	60	Olson Road inc tapers
0010	221+98	- 251+80	ML	35	20	17	20	20	34	34	34	34	Lake Shore Drive inc tapers
0010	223+78	- 251+80	SR	35	115	17	42	42	60	60	60	60	Engoe Road
0010	233+32	- 264+80	SR	5	433	17	140	140	337	337	337	337	Right turn lane inc in E-3
0010	242+07	- 272+40	SR	33	380	345	181	181	197	197	197	197	Lake Shore Drive
0010	249+50	- 278+70	ML	33	210	23	53	53	163	163	163	163	Bypass lane inc in E-3
0010	251+80	- 284+50	ML	104	290	286	210	210	150	150	150	150	Lake Shore Drive inc tapers
0010	251+80	- 318+00	ML	589	1117	8	362	362	869	869	869	869	
0010	252+24	- 318+00	SR	17	362	1519	362	362	869	869	869	869	
0010	264+80	- 318+00	ML	345	1117	1519	362	362	869	869	869	869	
0010	268+44	- 318+00	ML	23	1117	1519	362	362	869	869	869	869	
0010	272+40	- 318+00	ML	23	1117	1519	362	362	869	869	869	869	
0010	272+40	- 318+00	ML	23	1117	1519	362	362	869	869	869	869	
0010	278+70	- 318+00	ML	263	1117	1519	362	362	869	869	869	869	
0010	281+77	- 318+00	SR	8	1117	1519	362	362	869	869	869	869	
0010	284+50	- 318+00	ML	1519	1117	1519	362	362	869	869	869	869	

PAVEMENT ITEM QUANTITIES AND TOTALS CONTINUED ON NEXT SHEET.

PROJECT NO: 8160-00-70	HWY: STH 13	COUNTY: BAYFIELD	MISCELLANEOUS QUANTITIES	SHEET 5 OF 12	SHEET: 38
------------------------	-------------	------------------	--------------------------	---------------	-----------

FILE NAME: N:\PDS\...030200\_mq.ppk PLOT DATE: June 14, 1911 PLOT BY: A.R.H. PLOT NAME: PLOT SCALE: 1:1

CATEGORY	STATION TO	STATION	LOC	TACK COAT GAL	465.0605	465.0105	SPV.0195.01 LOWER LAY; ALL LANES & SHLDS HMA PAVEMENT TYPE E-3 SPECIAL	SPV.0195.01 UPPER LAY; AUX LANES & SHLDS HMA PAVEMENT TYPE E-3 SPECIAL	SPV.0195.02 UPPER LAY; THRU & PASS LANES HMA PAVEMENT TYPE SMA SPECIAL	SPV.0195.03 SMA PAVT COMPACTION ACCEPTANCE	REMARKS
0010	294+90		SR	22							Wannebo Road inc tapers
0010	294+99		SR	11							Summit Avenue inc tapers
0010	305+70		SR	15							Faulkner Road inc tapers
0010	318+00	- 320+20	ML	100		110				57	Right turn Lane inc in E-3
0010	320+20	- 328+56	ML	379		279				217	
0010	320+83		SR	56							Biglow Street
0010	320+90		SR	25							Thompson Road inc tapers
0010	327+19		SR	14							Fur Farm Road
0010	8+00	- 328+56	ML	1,904		4512					Additonal mill areas
0010	54+50		LT		1						C&G replacement-lower layer
0010	55+00		LT		2						C&G replacement-lower layer
0010	241+70		LT		2						C&G replacement-lower layer
0010	242+50		LT		2						C&G replacement-lower layer
0010	13+00		ML		17						Rumble pad replacement
TOTAL 0010				16,371	4859	15,902			9039	9039	

Addendum No. 1  
 IDs 8160-00-70 &  
 8160-03-61  
 Added Sheet 38A  
 April 9, 2015

MORE PAVEMENT ITEM QUANTITIES ON PREVIOUS SHEET.

CONCRETE CURB AND GUTTER CURE AND SEAL TREATMENT

CATEGORY	STATION	LOC	SPV. 0090.02 LF	REMARKS
0010	54+50	LT	50	ONDOSSAGON RD
0010	55+00	LT	80	ONDOSSAGON RD
0010	241+70	LT	70	ENGOE ROAD
0010	242+50	LT	86	ENGOE ROAD
TOTAL 0010			286	

REHEATING HMA PAVMENT LONGITUDINAL JOINTS SPECIAL

CATEGORY	STATION TO	STATION	LOC	SPV. 0170.01 STA
0010	8+00	-	29+70	ML 22
0010	30+12	-	112+73	ML 83
0010	112+95	-	220+94	ML 108
0010	221+98	-	328+56	ML 107
TOTAL 0010				319

REMOVING ASPHALTIC SURFACE ADDITIONAL MILL SPECIAL

CATEGORY	STATION TO	STATION	LOC	SPV. 0180.02 SY
0010	8+00	-	328+56	ML 21000
TOTAL 0010				21,000

Addendum No. 1  
IDs 8160-00-70 &  
8160-03-61  
Revised Sheet 45  
April 9, 2015

CONSTRUCTION STAKING SUPPLEMENTAL CONTROL 8160-00-70

CATEGORY	LOCATIONS	650.9910 LS
0010	PROJECT AREA	1
TOTAL 0010		1

SAWING ASPHALT

CATEGORY	STATION	LOC	690.0150 LF	REMARKS
0010	21+96	LT	12.6	PE
0010	54+50	LT	50	C&G
0010	55+00	LT	80	C&G
0010	241+70	LT	70	C&G
0010	242+50	LT	86	C&G
0010	70+15	RT	10.7	PE
0010	75+38	LT	34.4	CE
0010	76+66	RT	10	PE
0010	125+10	RT	12	PE
0010	145+30	LT	18	PE
0010	146+48	RT	11.4	PE
0010	150+40	RT	16	PE
0010	150+76	RT	8	PE
0010	157+52	RT	10	PE
0010	176+42	RT	10.5	PE
0010	180+60	RT	12.5	PE
0010	189+70	RT	12	PE
0010	198+12	RT	14	PE
0010	225+70	LT	16	PE
0010	251+75	LT	10	PE
0010	271+44	LT	8.2	PE
0010	284+18	LT	9.3	PE
TOTAL 0010			522	

**Addendum No. 1**  
**IDs 8160-00-70 &**  
**8160-03-61**  
**Revised Sheet 47**  
**April 9, 2015**

STA.	CROSS SLOPE	
	LEFT	RIGHT
STA. 80+57.78	-0.020	-0.020
STA. 81+08.89	-0.020	0.000
STA. 81+60.00	-0.020	0.020
STA. 82+00.89	-0.036	0.036
STA. 86+49.43	-0.036	0.036
STA. 86+90.32	-0.020	0.020
STA. 87+41.43	-0.020	0.000
STA. 87+92.54	-0.020	-0.020

PI STA = 84+25.53  
 Y = 464854.12  
 X = 801875.47  
 DELTA = 73°37'29"  
 D = 129.43'  
 T = 255.32  
 L = 509.88  
 R = 383.145  
 PC STA = 84+70.22  
 PT STA = 86+80.10  
 SE = 3.6%



NORTHERN NATURAL GAS  
 PIPELINE CROSSING  
 CAUTION

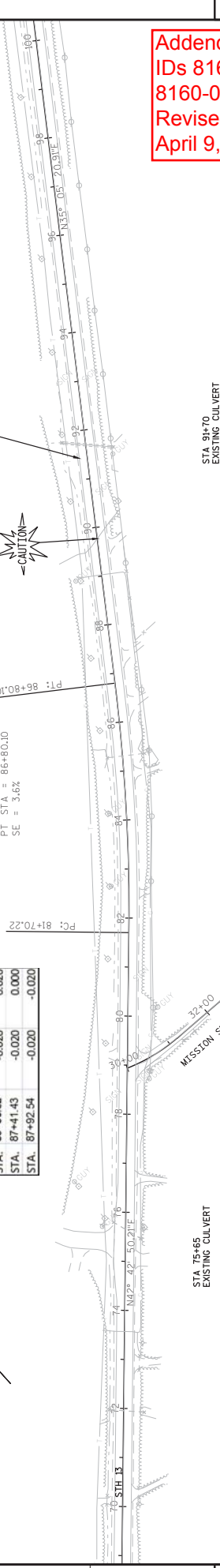

5

5

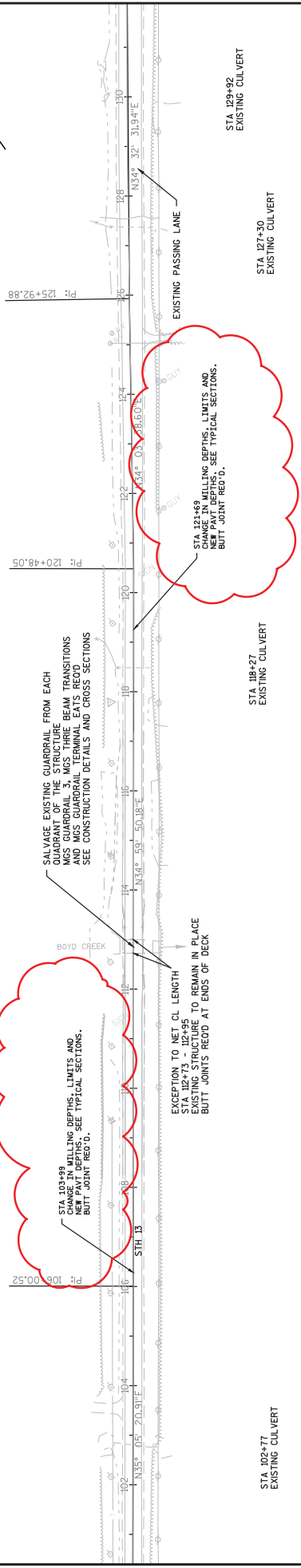

Addendum No. 1  
 IDS 8160-00-70 &  
 8160-03-61  
 Revised Sheet 49  
 April 9, 2015

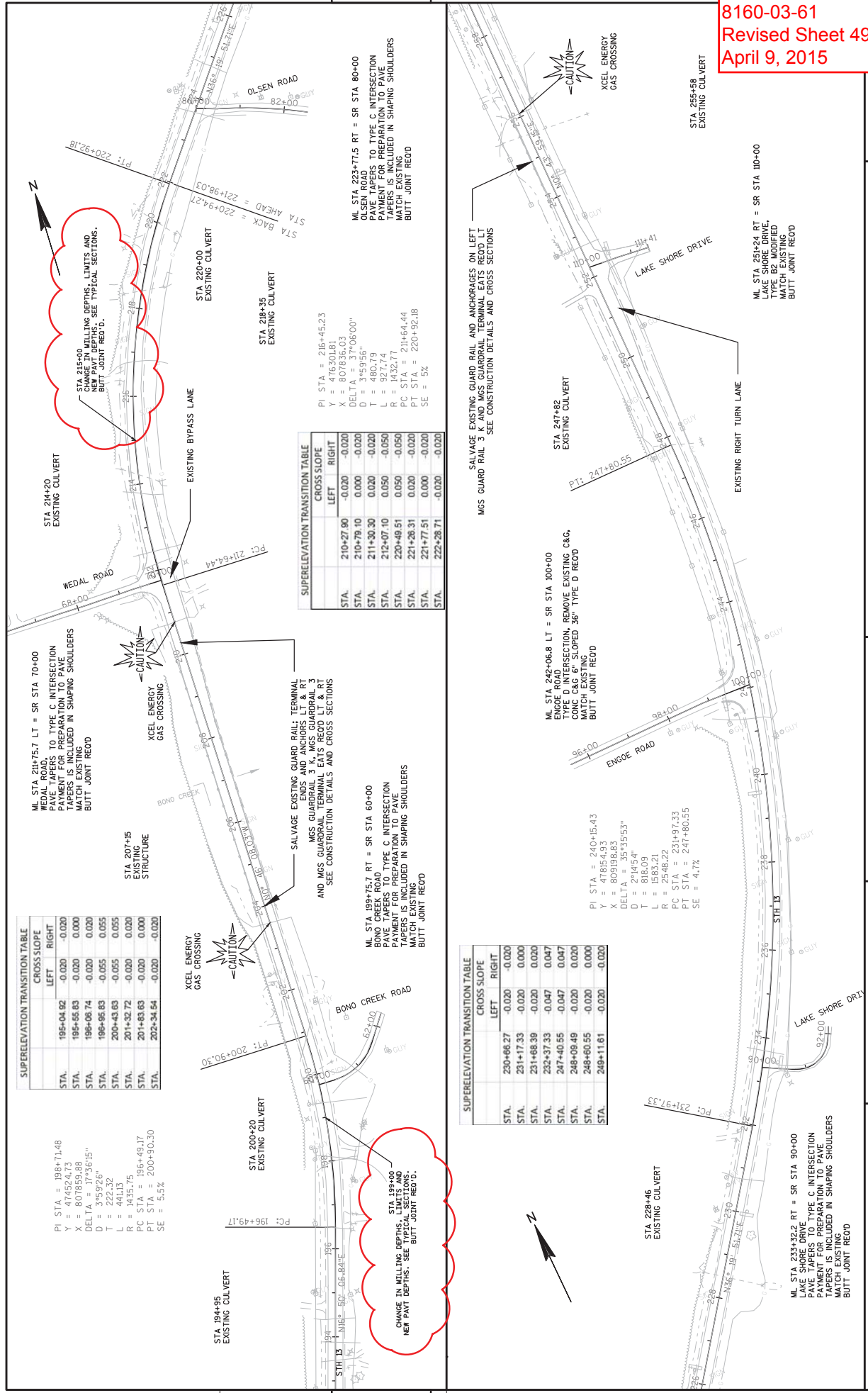

**SUPERELEVATION TRANSITION TABLE**

STA.	CROSS SLOPE	
	LEFT	RIGHT
195+04.92	-0.020	-0.020
195+56.83	0.000	0.000
196+08.74	-0.020	0.000
196+36.15	0.000	0.000
196+86.83	-0.055	0.055
200+43.63	-0.055	0.055
201+32.72	-0.000	0.000
201+83.63	-0.000	0.000
202+34.54	-0.020	-0.020

PI STA = 198+71.48  
 Y = 47452.473  
 X = 807859.88  
 DELTA = 17°36'15"  
 D = 3°59'26"  
 T = 222.32  
 L = 441.13  
 PC STA = 195+15.15  
 PT STA = 196+49.17  
 SE = 5.5%

**SUPERELEVATION TRANSITION TABLE**

STA.	CROSS SLOPE	
	LEFT	RIGHT
210+27.90	-0.020	-0.020
210+79.10	0.000	-0.020
211+30.30	0.020	-0.020
212+07.10	0.050	-0.050
220+49.51	0.050	-0.050
221+28.31	0.020	-0.020
221+77.51	0.000	-0.020
222+28.71	-0.020	-0.020

PI STA = 216+45.23  
 X = 4763301.81  
 Y = 807836.03  
 DELTA = 37°06'00"  
 D = 3°59'56"  
 T = 480.79  
 L = 921.74  
 R = 1432.77  
 PC STA = 211+64.44  
 PT STA = 220+92.18  
 SE = 5%

**SUPERELEVATION TRANSITION TABLE**

STA.	CROSS SLOPE	
	LEFT	RIGHT
230+66.27	-0.020	-0.020
231+17.33	-0.020	0.000
231+68.39	-0.020	0.020
232+37.33	-0.047	0.047
247+40.55	-0.047	0.047
248+09.49	-0.020	0.020
248+60.55	-0.020	0.000
249+11.61	-0.020	-0.020

PI STA = 240+15.43  
 X = 4781954.93  
 Y = 809198.83  
 DELTA = 35°35'53"  
 D = 2°14'54"  
 T = 818.09  
 L = 1583.21  
 R = 2546.22  
 PC STA = 231+37.33  
 PT STA = 247+60.55  
 SE = 4.7%

STA 184+95  
 CHANGE IN MILLING DEPTHS, LIMITS AND  
 NEW PAV DEPTHS. SEE TYPICAL SECTIONS.  
 BUTT JOINT REQ'D.

STA 215+00  
 CHANGE IN MILLING DEPTHS, LIMITS AND  
 BUTT JOINT REQ'D.

## SCHEDULE OF ITEMS

REVISED:

CONTRACT:  
20150414032PROJECT(S):  
8160-00-70  
8160-03-61FEDERAL ID(S):  
WISC 2015198  
N/A

CONTRACTOR : \_\_\_\_\_

LINE NO	ITEM DESCRIPTION	APPROX. QUANTITY AND UNITS	UNIT PRICE		BID AMOUNT	
			DOLLARS	CTS	DOLLARS	CTS

SECTION 0001 Misc Construction;Culvert Replace  
Repair Clean

0010	201.0105 Clearing	2.000 STA	.	.	.	.
0020	201.0205 Grubbing	7.000 STA	.	.	.	.
0030	202.0105 Roadside Clearing	102.000 STA	.	.	.	.
0040	203.0100 Removing Small Pipe Culverts	9.000 EACH	.	.	.	.
0050	204.0100 Removing Pavement	33.000 SY	.	.	.	.
0060	204.0115 Removing Asphaltic Surface Butt Joints	629.000 SY	.	.	.	.
0070	204.0120 Removing Asphaltic Surface Milling	133,311.000 SY	.	.	.	.
0080	204.0150 Removing Curb & Gutter	286.000 LF	.	.	.	.
0090	204.0245 Removing Storm Sewer (size) 01. 30-Inch	38.000 LF	.	.	.	.



## SCHEDULE OF ITEMS

REVISED:

CONTRACT:  
20150414032PROJECT(S):  
8160-00-70  
8160-03-61FEDERAL ID(S):  
WISC 2015198  
N/A

CONTRACTOR : \_\_\_\_\_

LINE NO	ITEM DESCRIPTION	APPROX. QUANTITY AND UNITS	UNIT PRICE		BID AMOUNT	
			DOLLARS	CTS	DOLLARS	CTS
0200	305.0500 Shaping Shoulders	319.000 STA	.		.	
0210	350.0145 Subbase 12-Inch	1,674.000 SY	.		.	
0220	440.4410.S Incentive IRI Ride	26,487.000 DOL	1.00000		26487.00	
0230	455.0605 Tack Coat	16,371.000 GAL	.		.	
0240	465.0105 Asphaltic Surface	5,317.000 TON	.		.	
0250	465.0110 Asphaltic Surface Patching	1,600.000 TON	.		.	
0260	465.0120 Asphaltic Surface Driveways and Field Entrances	204.000 TON	.		.	
0270	465.0425 Asphaltic Shoulder Rumble Strips 2-Lane Rural	58,998.000 LF	.		.	
0280	465.0475 Asphalt Center Line Rumble Strips 2-Lane Rural	25,296.000 LF	.		.	
0290	520.0118 Culvert Pipe Class III 18-Inch	48.000 LF	.		.	
0300	520.4024 Culvert Pipe Temporary 24-Inch	8.000 LF	.		.	

## SCHEDULE OF ITEMS

REVISED:

CONTRACT:  
20150414032PROJECT(S):  
8160-00-70  
8160-03-61FEDERAL ID(S):  
WISC 2015198  
N/A

CONTRACTOR : \_\_\_\_\_

LINE NO	ITEM DESCRIPTION	APPROX. QUANTITY AND UNITS	UNIT PRICE		BID AMOUNT	
			DOLLARS	CTS	DOLLARS	CTS
1130	ASP.1T0G On-the-Job Training Graduate at \$5. 00/HR	630.000 HRS	5.00000		3150.00	
1140	SPV.0090 Special 01. Regrade Ditch	657.000 LF	.		.	
1150	SPV.0090 Special 02. Concrete Curb And Gutter Cure And Seal Treatment	286.000 LF	.		.	
1160	SPV.0105 Special 01. Milling And Removing Temporary Wedge Joint	LUMP	LUMP		.	
1170	SPV.0105 Special 02. Prepare Foundation For Asphaltic Paving, Special	LUMP	LUMP		.	
1180	SPV.0105 Special 03. Material Vehicle Transfer	LUMP	LUMP		.	
1190	SPV.0170 Special 01. Reheating Hma Pavment Longitudinal Joints Special	319.000 STA	.		.	
1210	SPV.0195 Special 01. Hma Pavement Type E-3 Special	15,902.000 TON	.		.	
1220	SPV.0195 Special 02. Hma Pavement Type Sma Special	9,039.000 TON	.		.	
1230	SPV.0195 Special 03. Sma Pavement Compaction Acceptance	9,039.000 TON	.		.	

SCHEDULE OF ITEMS

REVISED:

CONTRACT:  
20150414032

PROJECT(S):  
8160-00-70  
8160-03-61

FEDERAL ID(S):  
WISC 2015198  
N/A

CONTRACTOR : \_\_\_\_\_

LINE NO	ITEM DESCRIPTION	APPROX. QUANTITY AND UNITS	UNIT PRICE		BID AMOUNT	
			DOLLARS	CTS	DOLLARS	CTS
1240	SPV.0180 Special 02. Removing Asphaltic Surface Additional Mill, Special	21,000.000 SY	.		.	
	SECTION 0001 TOTAL				.	
	TOTAL BID				.	