



Wisconsin Department of Transportation

August 21, 2015

Division of Transportation Systems Development

Bureau of Project Development
 4802 Sheboygan Avenue, Rm 601
 P O Box 7916
 Madison, WI 53707-7916

Telephone: (608) 266-1631
 Facsimile (FAX): (608) 266-8459

NOTICE TO ALL CONTRACTORS:

Proposal #06: 2475-00-70, WISC 2015 488
Orchard Road, Village of Germantown
Donges Bay Road Intersection
STH 145
Washington County

Letting of September 15, 2015

This is Addendum No. 01, which provides for the following:

Special Provisions

Revised Special Provisions	
Article No.	Description
5	Traffic

Schedule of Items

Revised Bid Item Quantities – ID 2475-00-70					
Bid Item	Item Description	Unit	Old Quantity	Revised Quantity	Proposal Total
643.1000	Traffic Control Signs Fixed Message	SF	644	-364	280
643.1050	Traffic Control Signs PCMS	DAYS	308	58	366
643.3000	Traffic Control Detour Signs	DAYS	6,110	13,366	19,476

Plan Sheets

Revised Plan Sheets	
Plan Sheet	Plan Sheet Title (brief description of changes to sheet)
95	Traffic Control Overview – Phase 2; PCMS notes revised.
150	Miscellaneous Quantities; 643.1000, 643.1050, 643.3000 quantities revised.

Added Plan Sheets	
Plan Sheet	Plan Sheet Title (brief description of why sheet was added)
122A	Traffic Control Detail: Fixed Message Signs; Sign No. 2000 removed
122B	Detour Route Signing – Phase 1; Detour route signing separated into specific phase.
122C	Detour Route Signing – Phase 2; Detour route signing separated into specific phase.
122D	Detour Route Signing – Phases 3 and 4; Detour route signing separated into specific phase.

Deleted Plan Sheets	
Plan Sheet	Plan Sheet Title (brief description of why sheet was deleted)
123	Traffic Control Detail: Fixed Message Signs; Sign No. 2000 removed
124	Detour Route Signing – Phase 1 through 4; Detour route signing not broken out by phase.

The responsibility for notifying potential subcontractors and suppliers of these changes remains with the prime contractor.

Sincerely,

Mike Coleman

Proposal Development Specialist
Proposal Management Section

ADDENDUM NO. 01

2475-00-70

August 21, 2015

Special Provisions

5. Traffic

Replace entire article language with the following:

General

The construction sequence, including the associated traffic control, shall be substantially accomplished as detailed in the Traffic Control Plans, and as described herein.

Maintain access at all times to all driveways located along the STH 145 and Donges Bay Road, and all the other side roads within the project limits unless otherwise noted in the plans. Notify the property occupant 5 days in advance of the driveway reconstruction to verify closure or staged driveway construction methods. Some driveways with adequate width will be built half at a time, with the 1st half receiving high early strength concrete.

Coordinate traffic requirements under this contract with other adjacent and concurrent department or local municipality projects. Implementing and coordinate with other contractors all traffic control as shown on the plans. Modifications to the traffic control plan may be required by the engineer to be safe and consistent with adjacent work by others. Project ID 2712-00-71 will be constructed concurrently. The contractors shall coordinate with each other to eliminate any duplication, eliminate conflicting traffic control, and to provide the least impact to the residents.

Unless detailed in the plans, do not begin or continue any work that closes traffic lanes outside the allowed time periods specified in this article.

Do not store equipment, vehicles, or materials on adjacent streets beyond the project limits without specific approval of the engineer.

Advanced Notification

Provide the following minimum advance notification to the engineer for incorporation into the Wisconsin Lane Closure System.

Local Street openings/closings	7 calendar days
Project Start	14 calendar days
Construction stage changes	14 calendar days
Detours	14 calendar days

Notify the engineer and WisDOT Statewide Traffic Operations Center (414-227-2142) if there are any changes in the schedule, early completions, or cancellations of scheduled work.

Staging

Perform construction operations on STH 145 in stages as shown in the traffic control/construction staging plan. The construction stages are:

Project ID 2475-00-70

A summary of the work within each stage is as follows:

Phase 1

STH 145 is open to through traffic in both directions. STH 145 is a two lane rural roadway, one lane in each direction. Donges Bay Road will be open on the west leg of the intersection and closed on the east leg, with a hard closure. Donges Bay Road is also a two lane rural roadway, with one lane in each direction.

The detour route signing for Phase 1 shall be in place as shown in the plans when the east leg of the intersection is closed to through traffic. Donges Bay Road traffic will be directed to Pilgrim Road, STH 167, Eisenhower Drive, and Washington Drive as the detour route during the closure. Detour signs shall be covered at the end of Phase 1 when the east leg of the intersection is open to traffic.

Phase 2

Phase 2 will close STH 145, north of Donges Bay Road, for a 4 week period between the hours of 9:00am and 4:00pm. STH 145, south of Donges Bay Road, will remain open during Phase 2. Donges Bay Road will be open to through traffic along both east and west legs of the intersection. Northbound traffic on STH 145 will have the option of following a detour along the east or west leg of the intersection.

The detour route signing for Phase 2 shall be in place as shown in the plans when the north leg of the intersection is closed to through traffic. STH 145 traffic will be directed to STH 167, Eisenhower Drive, and Washington Drive as the detour route during the closure. When the detour route is not in use (outside of the hours 9:00am to 4:00pm), detour signs shall be covered and changeable message signs turned off. Detour signs shall be removed at the end of Phase 2 when the north leg of the intersection is open to traffic.

Phase 3

Keep the 2 lanes of STH 145 open (one NB, one SB) to through traffic throughout this phase. No turns will be permitted at Donges Bay Road, since a hard closure at the side road will be in place. Donges Bay Road will have a soft closure at the far east and west project limits, permitting local traffic to access Donges Bay Road from the far west and far east end construction limits. The hard closure / detour will remain in effect until the end of Phase 4.

The detour route signing for Phase 3 shall be in place as shown in the plans when the east and west legs of the intersection are closed to through traffic. Donges Bay Road traffic will be directed to Pilgrim Road, STH 167, Eisenhower Drive, and Washington Drive as the detour route during the closure. Detour signs shall remain in place at the end of Phase 3 for Phase 4.

Phase 4

Keep the 2 lanes of STH 145 open (one NB, one SB) to through traffic throughout this phase. Southbound STH 145 traffic will now be shifted onto the new roadway, east of the existing STH 145. Southbound STH 145 traffic will travel on temporary pavement in many areas, including the south leg median, central island, north median and temporary pavement along the far north end of the north leg. Donges Bay Road remains closed at STH 145 with a hard closure, while the construction limits still have the soft closure, "closed to through traffic" signage. At the end of Phase 4, the hard closure at STH 145 and Donges Bay Road intersection is removed and Donges Bay Road is fully open to traffic. Full operation of the roundabout circle is not permitted however. Maintain sidewalk closures throughout this stage, through the end of the project. All roadways are now open to through traffic with the exception of the roundabout lane on the north side and south side. No left turn movements will be permitted until the end of Phase 5.

The detour route signing for Phase 4 shall be in place as shown in the plans when the east and west legs of the intersection are closed to through traffic. Donges Bay Road traffic will be directed to

Pilgrim Road, STH 167, Eisenhower Drive, and Washington Drive as the detour route during the closure. Detour signs shall be removed at the end of Phase 4 when the intersection is open to traffic.

Phase 5

Restrict use in sidewalks, paths and ramps and maintain closure of these areas until the end of Phase 5.

STH 145 and Donges Bay Road are open to traffic, with one lane in each direction. The roundabout circle and through or left movements are prohibited. Phase 5 also requires an inside / outside traffic control switch in order to fully complete the proposed paving and median work. Complete the paving from the northbound reference line out to the east to a logical joint or match line, between stations 481NB+25 and 484NB+50. This work must be completed while the northbound traffic is still out on the temporary paving from installed in Phase 3, utilized in Phase 4. Maintain the northbound through traffic on the Phase 4 northbound lane layout until the proposed northbound through lane work is completed. The initial work zone area for this northbound STH 145 Phase 5 is crosshatched and noted on the plan set. This work zone area must be completed before sliding traffic over; pulling out temporary pavement and completing the outside curb line, sidewalk and providing restoration.

Phase 5 traffic control shows one side of the switch, inside pavement marking that will be used once the proposed through lane and likely the shoulder are paved.

Schedule of Items

Attached, dated August 21, 2015, are the revised Schedule of Items Page 12.

Plan Sheets

The following 8½ x 11-inch sheets are attached and made part of the plans for this proposal:

Revised: 95, and 150.

Added: 122A – 122D.

END OF ADDENDUM

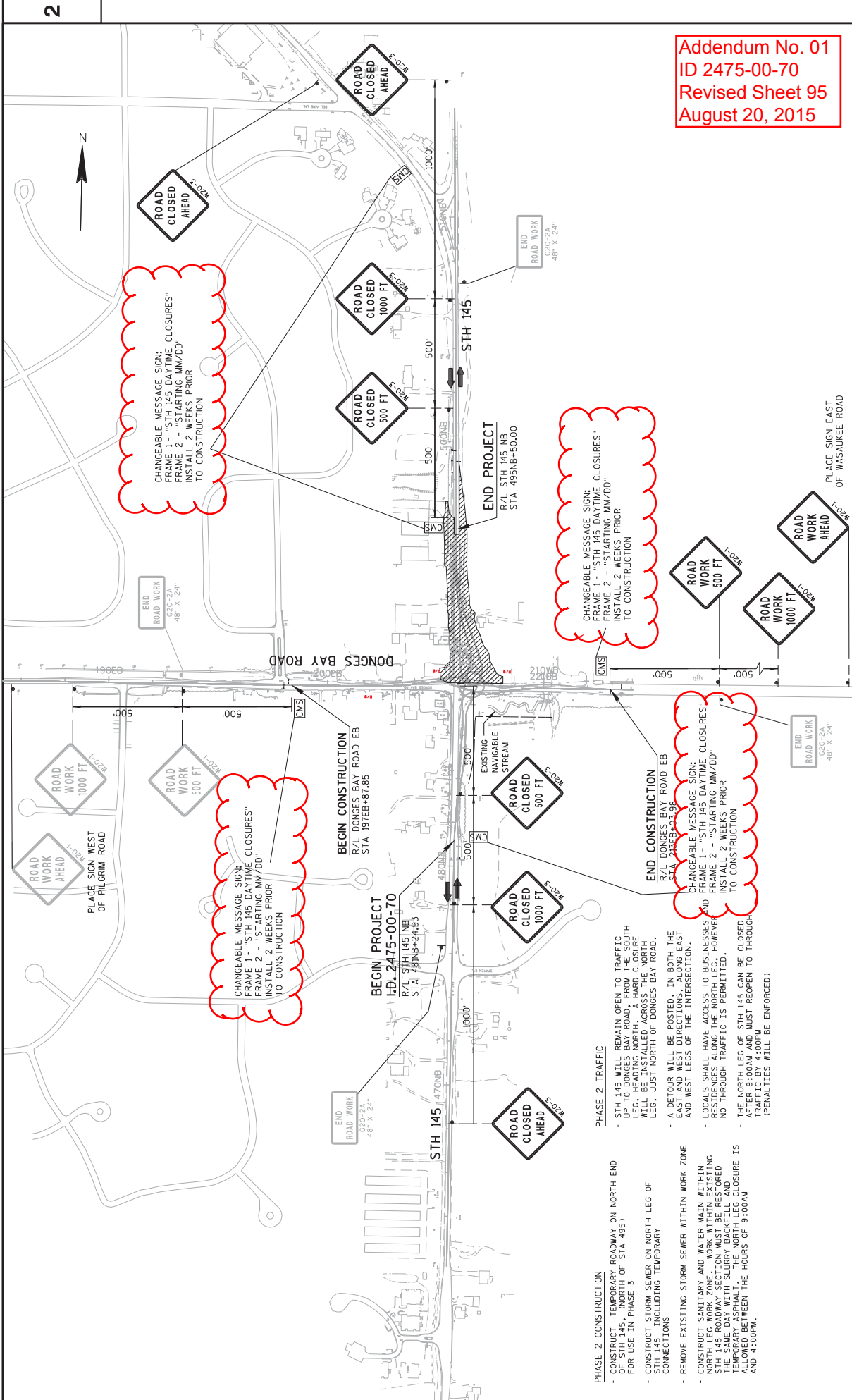

Addendum No. 01
 ID 2475-00-70
 Revised Sheet 95
 August 20, 2015

- PHASE 2 CONSTRUCTION**
- CONSTRUCT TEMPORARY ROADWAY ON NORTH END OF STH 145 (NORTH OF STA 435) FOR USE IN PHASE 3
 - CONSTRUCT STORM SEWER ON NORTH LEG OF STH 145, INCLUDING TEMPORARY CONNECTIONS
 - REMOVE EXISTING STORM SEWER WITHIN WORK ZONE
 - CONSTRUCT SANITARY AND WATER MAIN WITHIN NORTH LEG WORK ZONE
 - CONSTRUCT STORM SEWER WITHIN EXISTING STH 145 ROADWAY SECTION MUST BE RESTORED THE SAME DAY WITH SLURRY BACKFILL AND TEMPORARY ASPHALT. THE NORTH LEG CLOSURE IS TO BE IN EFFECT BETWEEN THE HOURS OF 9:00AM AND 4:00PM.
- PHASE 2 TRAFFIC**
- STH 145 WILL REMAIN OPEN TO TRAFFIC UP TO DONAGES BAY ROAD, FROM THE SOUTH LEG, HEADING NORTH. A HARD CLOSURE WILL BE INSTALLED ON DONAGES BAY ROAD, JUST NORTH OF DONAGES BAY ROAD.
 - A DETOUR WILL BE POSTED. IN BOTH THE EAST AND WEST DIRECTIONS ALONG EAST AND WEST LEGS OF THE INTERSECTION.
 - LOCALS SHALL HAVE ACCESS TO BUSINESSES AND RESIDENCES ALONG THE NORTH LEG, HOWEVER NO THROUGH TRAFFIC IS PERMITTED.
 - THE NORTH LEG OF STH 145 CAN BE CLOSED AFTER 9:00AM AND MUST REOPEN TO THROUGH TRAFFIC BY 4:00PM (PENALTIES WILL BE ENFORCED)

NOTES

1. ALL SIGNS TO HAVE STANDARD REFLECTIVE SHEETING - REFERENCE: "WISDOT STANDARD SPECIFICATIONS FOR ROAD AND BRIDGE CONSTRUCTION," LATEST EDITION.
2. AFTER SIGNS HAVE BEEN LOCATED IN THE FIELD, BUT BEFORE INSTALLATION, THE SIGNING AND MARKING SUPERVISOR SHALL VERIFY EACH SIGN LOCATION.
3. ALL SIGNS TO BE MOUNTED ON WOODEN POST SUPPORTS (4"x6"). THE NUMBER OF POSTS REQUIRED FOR EACH LAYOUT IS SHOWN.
4. POSTS SHALL MEET THE BREAKAWAY REQUIREMENTS OF SECTION 643.2.9.1 OF THE STANDARD SPECIFICATIONS AND SIGN PLATE A4-11.
5. SIGNS ON THIS SHEET TO BE PAID UNDER THE ITEM "TRAFFIC CONTROL SIGNS FIXED MESSAGE".
6. SIGNS SHALL BE BLACK NON-REFLECTIVE MESSAGE ON ORANGE REFLECTIVE BACKGROUND UNLESS OTHERWISE NOTED.
7. ALL SIGNS SHALL HAVE CAPITAL LETTERS AND NUMERALS:
12" CAPS SHALL BE SERIES "D"
8. CONTRACTOR SHALL SUBMIT SHOP DRAWINGS TO ENGINEER FOR REVIEW PRIOR TO MANUFACTURING.
9. SIGN BASE MATERIAL SHALL BE ACCORDING TO SECTION 637.2.1.2.
10. DIMENSIONS ARE IN INCHES UNLESS OTHERWISE NOTED.

(XXX) = STON NUMBER

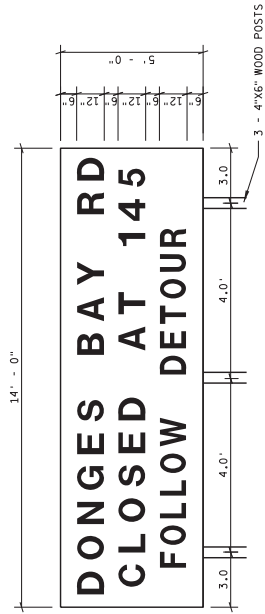

2001

Addendum No. 01
 ID 2475-00-70
 Added Sheet 122A
 August 20, 2015

PROJECT NO: 2475-00-70

HWY: STH 145

COUNTY: WASHINGTON

TRAFFIC CONTROL DETAIL: FIXED MESSAGE SIGNS

SHEET 122A

E

FILE NAME : F:\NM1-2050B STH 145\roads\Cds\or027000_FMS.dgn

PLOT DATE : 13-AUG-2015 09:37

PLOT BY : rkempke

PLOT SCALE : 100:1

WISDOT/CADDS SHEET 42

1	ROAD CLOSED THRU TRAFFIC 60" X 30" R11-4	2	MO4-8 24" X 12" M3-2 24" X 12" MI-95A 24" X 30" BAY ROAD MO5-1L 21" X 21"	3	MO4-8 24" X 12" M3-2 24" X 12" MI-95A 24" X 30" BAY ROAD MO5-1R 21" X 21"	4	MO4-8 24" X 12" M3-2 24" X 12" MI-95A 24" X 30" BAY ROAD MO5-1R 21" X 21"	5	MO4-8 24" X 12" M3-2 24" X 12" MI-95A 24" X 30" BAY ROAD MO5-1R 21" X 21"		
6	MO4-8 24" X 12" M3-2 24" X 12" MI-95A 24" X 30" BAY ROAD MO5-1 21" X 21"	7	MO4-8 24" X 12" M3-2 24" X 12" MI-95A 24" X 30" BAY ROAD MO5-1 21" X 21"	8	MO4-8 24" X 12" M3-2 24" X 12" MI-95A 24" X 30" BAY ROAD MO5-1L 21" X 21"	9	MO4-8 24" X 12" M3-2 24" X 12" MI-95A 24" X 30" BAY ROAD MO5-1R 21" X 21"	10	MO4-8 24" X 12" M3-2 24" X 12" MI-95A 24" X 30" BAY ROAD MO5-1R 21" X 21"	11	MO4-8 24" X 12" M3-2 24" X 12" MI-95A 24" X 30" BAY ROAD MO5-1 21" X 21"
12	MO4-8 24" X 12" M3-4 24" X 12" MI-95A 24" X 30" BAY ROAD MO5-1 21" X 21"	13	MO4-8 24" X 12" M3-4 24" X 12" MI-95A 24" X 30" BAY ROAD MO5-1 21" X 21"	14	MO4-8 24" X 12" M3-4 24" X 12" MI-95A 24" X 30" BAY ROAD MO5-1 21" X 21"	15	W20-2 48" X 48" M3-2 24" X 12" MI-95A 24" X 30" BAY ROAD	16	W20-2 48" X 48" M3-2 24" X 12" MI-95A 24" X 30" BAY ROAD		

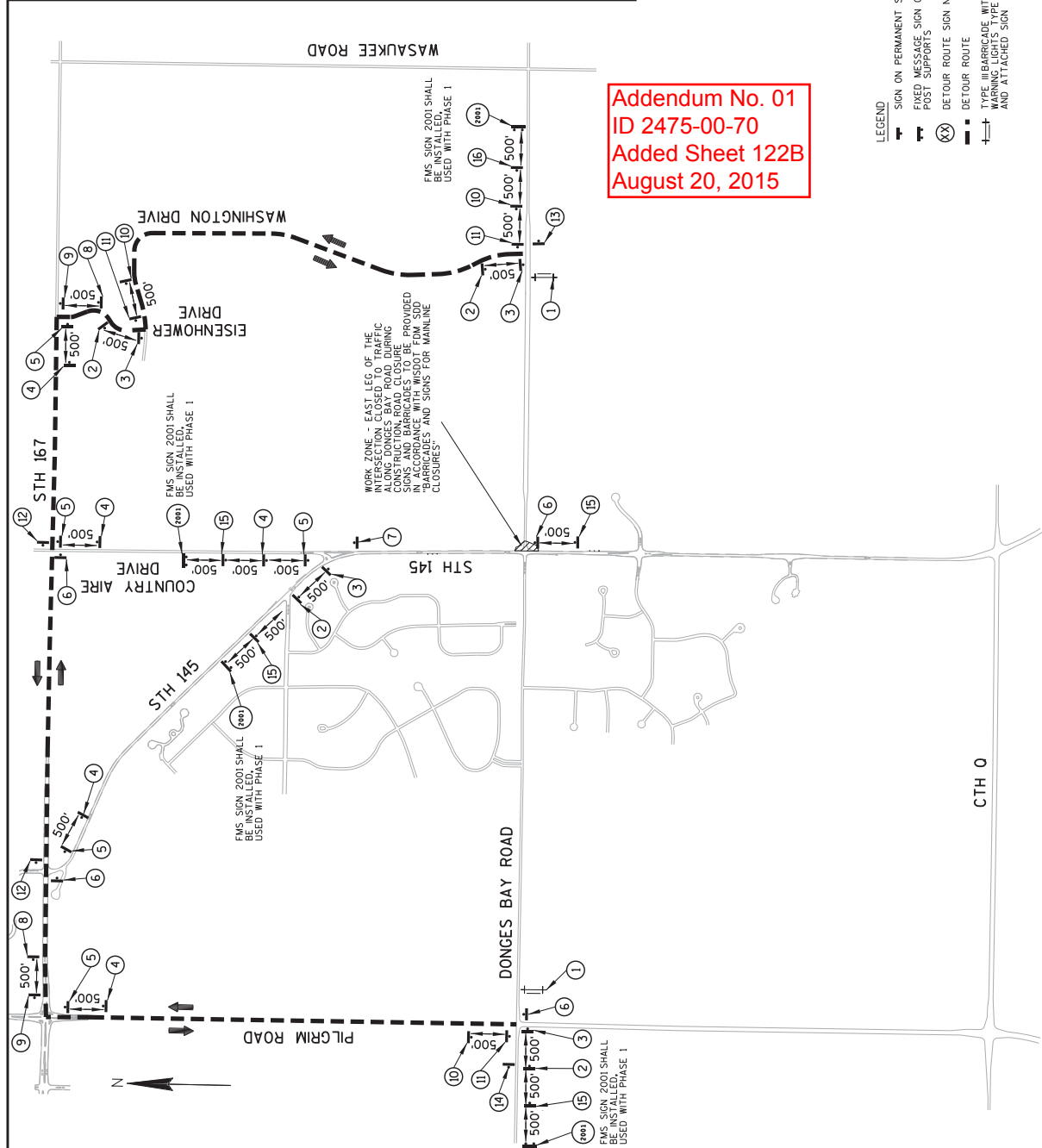

Addendum No. 01
ID 2475-00-70
Added Sheet 122B
August 20, 2015

NOTES

- EXISTING SIGNS SHOWN IN GRAYSHADE
- THE EXACT LOCATION AND SPACING OF SIGNS SHALL BE ADJUSTED TO FIT FIELD CONDITIONS AS APPROVED BY THE ENGINEER
- ADJUST THE LOCATION OF THE DETOUR ROUTE SIGNS TO CORRESPOND WITH EXISTING ASSEMBLIES
- THE SPACING BETWEEN TRAFFIC CONTROL AND DETOUR ROUTE SIGNS SHOULD BE ADJUSTED TO AVOID CONFLICT WITH AND TO PROVIDE A MINIMUM OF 100 FEET CLEARANCE TO EXISTING SIGNS THAT WILL REMAIN IN PLACE
- ANY SIGNS TEMPORARY OR EXISTING WHICH CONFLICT WITH TRAFFIC CONTROL "IN USE" SHALL BE REMOVED OR COVERED AS NEEDED AND AS APPROVED BY THE ENGINEER
- "MO" SIGNS ARE THE SAME AS "W" SIGNS EXCEPT THE BACKGROUND IS ORANGE

LEGEND

- SIGN ON PERMANENT SUPPORT
- FIXED MESSAGE SIGN ON WOOD POST SUPPORTS
- DETOUR ROUTE SIGN NUMBER
- DETOUR ROUTE
- TYPE III BARRICADE WITH WARNING LIGHTS TYPE A AND ATTACHED SIGN

(000) SEE FIXED MESSAGE SIGN (FMS) DETAILS

1	MO4-8 24" X 12" DETOUR NORTH 145	MO4-8 24" X 12" DETOUR NORTH 145	MO4-8 24" X 12" DETOUR NORTH 145	MO4-8 24" X 12" DETOUR NORTH 145	MO4-8 24" X 12" DETOUR NORTH 145
2	MI-6 24" X 24" MO5-IL 21" X 21"	MI-6 24" X 24" MO5-IL 21" X 21"	MI-6 24" X 24" MO5-IL 21" X 21"	MI-6 24" X 24" MO5-IL 21" X 21"	MI-6 24" X 24" MO5-IL 21" X 21"
3	MO4-8 24" X 12" DETOUR NORTH 145	MO4-8 24" X 12" DETOUR NORTH 145	MO4-8 24" X 12" DETOUR NORTH 145	MO4-8 24" X 12" DETOUR NORTH 145	MO4-8 24" X 12" DETOUR NORTH 145
4	MI-6 24" X 24" MO5-JR 21" X 21"	MI-6 24" X 24" MO5-JR 21" X 21"	MI-6 24" X 24" MO5-JR 21" X 21"	MI-6 24" X 24" MO5-JR 21" X 21"	MI-6 24" X 24" MO5-JR 21" X 21"
5	MO4-8 24" X 12" DETOUR NORTH 145	MO4-8 24" X 12" DETOUR NORTH 145	MO4-8 24" X 12" DETOUR NORTH 145	MO4-8 24" X 12" DETOUR NORTH 145	MO4-8 24" X 12" DETOUR NORTH 145

6	MO4-8 24" X 12" DETOUR SOUTH 145	MO4-8 24" X 12" DETOUR SOUTH 145	MO4-8 24" X 12" DETOUR SOUTH 145	MO4-8 24" X 12" DETOUR SOUTH 145	MO4-8 24" X 12" DETOUR SOUTH 145
7	MI-6 24" X 24" MO6-1 21" X 21"	MI-6 24" X 24" MO6-1 21" X 21"	MI-6 24" X 24" MO6-1 21" X 21"	MI-6 24" X 24" MO6-1 21" X 21"	MI-6 24" X 24" MO6-1 21" X 21"
8	MO4-8 24" X 12" DETOUR SOUTH 145	MO4-8 24" X 12" DETOUR SOUTH 145	MO4-8 24" X 12" DETOUR SOUTH 145	MO4-8 24" X 12" DETOUR SOUTH 145	MO4-8 24" X 12" DETOUR SOUTH 145
9	MI-6 24" X 24" MO6-1 21" X 21"	MI-6 24" X 24" MO6-1 21" X 21"	MI-6 24" X 24" MO6-1 21" X 21"	MI-6 24" X 24" MO6-1 21" X 21"	MI-6 24" X 24" MO6-1 21" X 21"
10	MO4-8 24" X 12" DETOUR SOUTH 145	MO4-8 24" X 12" DETOUR SOUTH 145	MO4-8 24" X 12" DETOUR SOUTH 145	MO4-8 24" X 12" DETOUR SOUTH 145	MO4-8 24" X 12" DETOUR SOUTH 145

11	MI-6 24" X 24" MO6-1 21" X 21"	MI-6 24" X 24" MO6-1 21" X 21"	MI-6 24" X 24" MO6-1 21" X 21"	MI-6 24" X 24" MO6-1 21" X 21"	MI-6 24" X 24" MO6-1 21" X 21"
12	MI-6 24" X 24" MO6-1 21" X 21"	MI-6 24" X 24" MO6-1 21" X 21"	MI-6 24" X 24" MO6-1 21" X 21"	MI-6 24" X 24" MO6-1 21" X 21"	MI-6 24" X 24" MO6-1 21" X 21"
13	MO4-8 24" X 12" DETOUR SOUTH 145	MO4-8 24" X 12" DETOUR SOUTH 145	MO4-8 24" X 12" DETOUR SOUTH 145	MO4-8 24" X 12" DETOUR SOUTH 145	MO4-8 24" X 12" DETOUR SOUTH 145
14	MI-6 24" X 24" MO6-1 21" X 21"	MI-6 24" X 24" MO6-1 21" X 21"	MI-6 24" X 24" MO6-1 21" X 21"	MI-6 24" X 24" MO6-1 21" X 21"	MI-6 24" X 24" MO6-1 21" X 21"

15	MO4-8 24" X 12" DETOUR SOUTH 145	MO4-8 24" X 12" DETOUR SOUTH 145	MO4-8 24" X 12" DETOUR SOUTH 145	MO4-8 24" X 12" DETOUR SOUTH 145	MO4-8 24" X 12" DETOUR SOUTH 145
16	MI-6 24" X 24" MO6-1 21" X 21"	MI-6 24" X 24" MO6-1 21" X 21"	MI-6 24" X 24" MO6-1 21" X 21"	MI-6 24" X 24" MO6-1 21" X 21"	MI-6 24" X 24" MO6-1 21" X 21"
17	MI-6 24" X 24" MO6-1 21" X 21"	MI-6 24" X 24" MO6-1 21" X 21"	MI-6 24" X 24" MO6-1 21" X 21"	MI-6 24" X 24" MO6-1 21" X 21"	MI-6 24" X 24" MO6-1 21" X 21"
18	MI-6 24" X 24" MO6-1 21" X 21"	MI-6 24" X 24" MO6-1 21" X 21"	MI-6 24" X 24" MO6-1 21" X 21"	MI-6 24" X 24" MO6-1 21" X 21"	MI-6 24" X 24" MO6-1 21" X 21"

Addendum No. 01
ID 2475-00-70
Added Sheet 122C
August 20, 2015

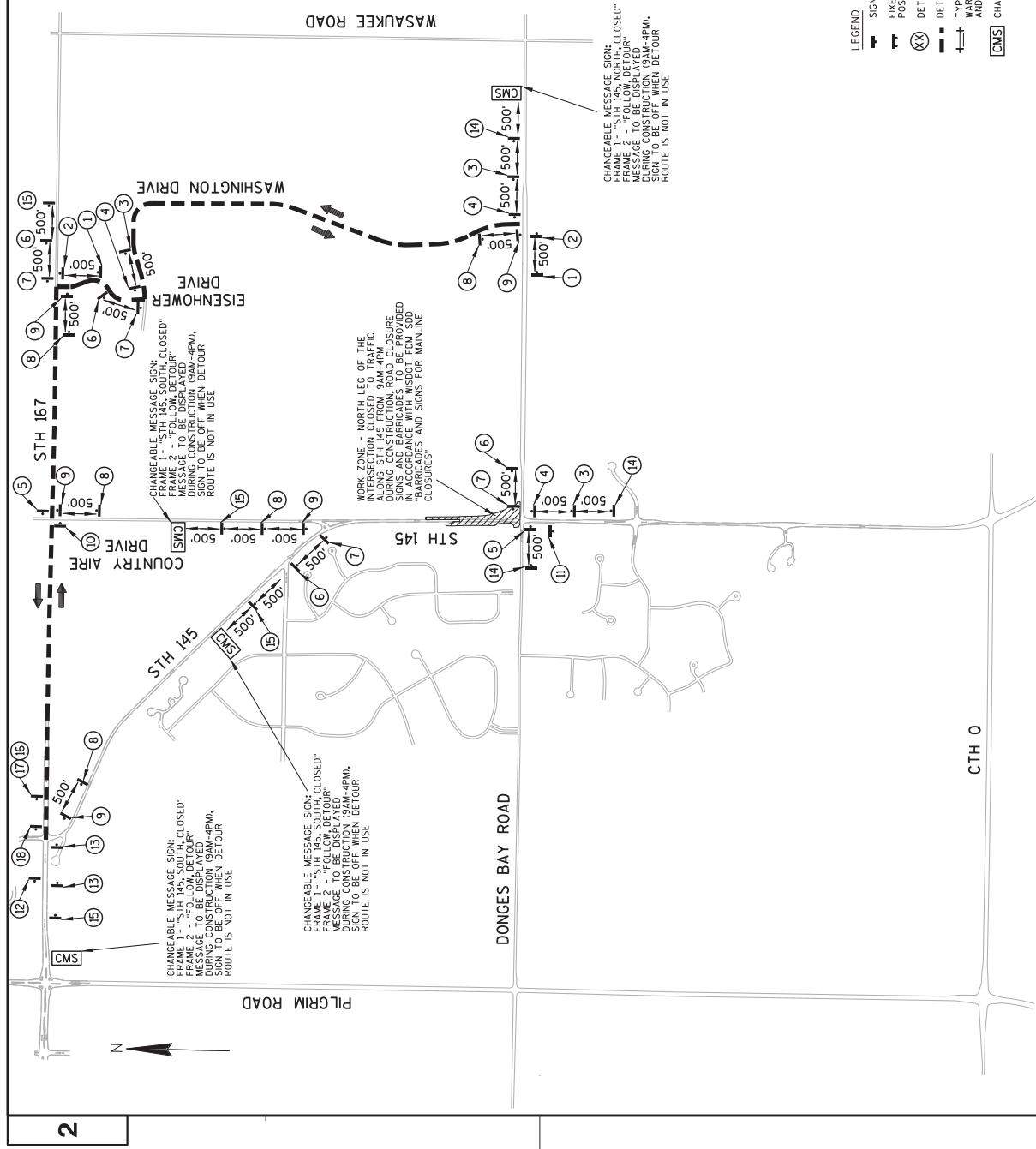

CHANGEABLE MESSAGE SIGN:
 FRAME 1 - "STH 145, SOUTH, CLOSED"
 FRAME 2 - "FOLLOW, DETOUR"
 MESSAGE ON BELTLINE 19AM-4PM.
 SIGN TO BE OFF WHEN DETOUR
 ROUTE IS NOT IN USE

CHANGEABLE MESSAGE SIGN:
 FRAME 1 - "STH 145, SOUTH, CLOSED"
 FRAME 2 - "FOLLOW, DETOUR"
 MESSAGE ON BELTLINE 19AM-4PM.
 SIGN TO BE OFF WHEN DETOUR
 ROUTE IS NOT IN USE

WORK ZONE - NORTH LEG OF THE
 INTERSECTION CLOSED TO TRAFFIC
 ALONG STH 145 FROM 9AM-4PM
 SIGNS AND BARRICADES TO BE PROVIDED
 IN ACCORDANCE WITH WISDOT FDM SDD
 TRUCKS AND SIGNS FOR MAINLINE
 CLOSURES

CHANGEABLE MESSAGE SIGN:
 FRAME 1 - "STH 145, NORTH, CLOSED"
 FRAME 2 - "FOLLOW, DETOUR"
 MESSAGE ON BELTLINE 19AM-4PM.
 SIGN TO BE OFF WHEN DETOUR
 ROUTE IS NOT IN USE

- LEGEND**
- ➔ SIGN ON PERMANENT SUPPORT
 - ➔ FIXED MESSAGE SIGN ON WOOD POST SUPPORTS
 - ⊗ DETOUR ROUTE SIGN NUMBER
 - ➔ DETOUR ROUTE
 - ➔ TYPE III BARRICADE WITH WARNING LIGHTS TYPE A AND ATTACHED SIGN
 - ☐ CMS CHANGEABLE MESSAGE SIGN

NOTES

- 1) EXISTING SIGNS SHOWN IN GRAYSHADE
- 2) THE EXACT LOCATION AND SPACING OF SIGNS SHALL BE ADJUSTED TO FIT FIELD CONDITIONS AS APPROVED BY THE ENGINEER
- 3) ADJUST THE LOCATION OF THE DETOUR ROUTE SIGNS TO CORRESPOND WITH EXISTING ASSEMBLIES
- 4) THE SPACING BETWEEN TRAFFIC CONTROL AND DETOUR ROUTE SIGNS SHALL BE ADJUSTED TO PROVIDE ADEQUATE CLEARANCE TO EXISTING SIGNS THAT WILL REMAIN IN PLACE
- 5) ANY SIGNS, TEMPORARY OR EXISTING, WHICH CONFLICT WITH TRAFFIC CONTROL "IN USE", SHALL BE REMOVED OR COVERED AS NEEDED AND AS APPROVED BY THE ENGINEER
- 6) "MO" SIGNS ARE THE SAME AS "M" SIGNS EXCEPT THE BACKGROUND IS ORANGE

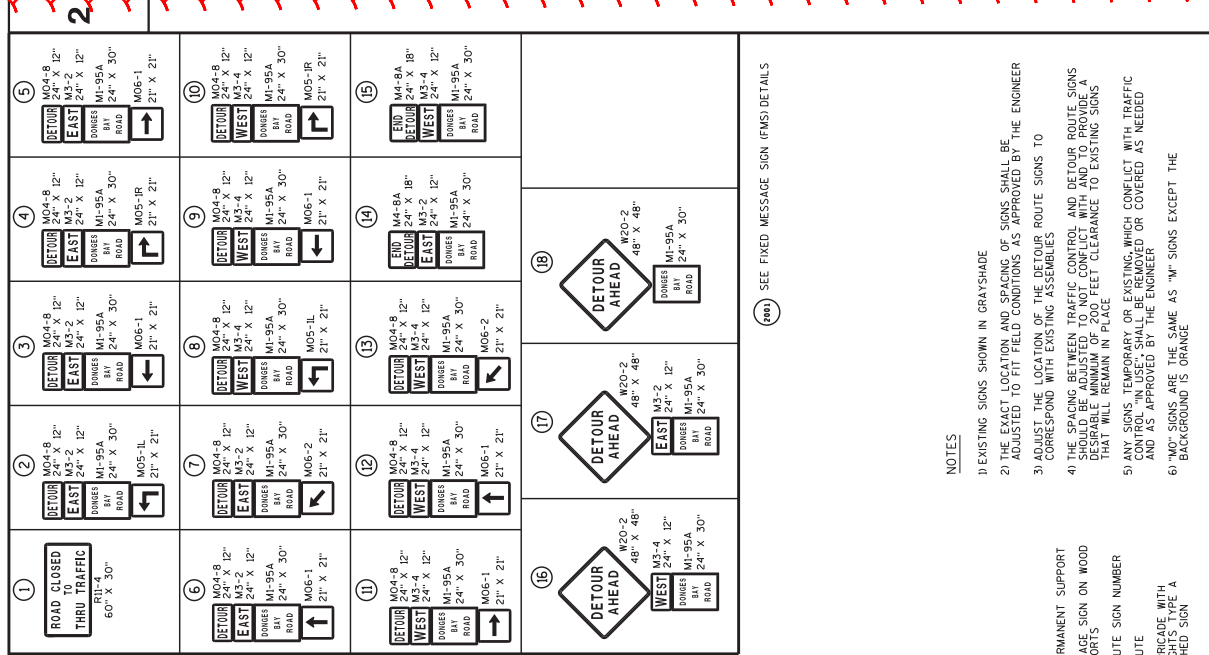

Addendum No. 01
ID 2475-00-70
Added Sheet 122D
August 20, 2015

①	②	③	④	⑤	
ROAD CLOSED THRU TRAFFIC 60" X 30" R11-4	MO4-8 12" M4-2 12" M3-2 12" MI-95A BY ROAD 24" X 30" MO5-1L 21" X 21"	MO4-8 12" M4-2 12" M3-2 12" MI-95A BY ROAD 24" X 30" MO5-1L 21" X 21"	MO4-8 12" M4-2 12" M3-2 12" MI-95A BY ROAD 24" X 30" MO5-1R 21" X 21"	MO4-8 12" M4-2 12" M3-2 12" MI-95A BY ROAD 24" X 30" MO6-1 21" X 21"	MO4-8 12" M4-2 12" M3-2 12" MI-95A BY ROAD 24" X 30" MO6-1 21" X 21"
⑥	⑦	⑧	⑨	⑩	⑪
MO4-8 12" M4-2 12" M3-2 12" MI-95A BY ROAD 24" X 30" MO6-1 21" X 21"	MO4-8 12" M4-2 12" M3-2 12" MI-95A BY ROAD 24" X 30" MO6-2 21" X 21"	MO4-8 12" M4-2 12" M3-2 12" MI-95A BY ROAD 24" X 30" MO6-2 21" X 21"	MO4-8 12" M4-2 12" M3-2 12" MI-95A BY ROAD 24" X 30" MO6-1 21" X 21"	MO4-8 12" M4-2 12" M3-2 12" MI-95A BY ROAD 24" X 30" MO6-1 21" X 21"	MO4-8 12" M4-2 12" M3-2 12" MI-95A BY ROAD 24" X 30" MO6-1 21" X 21"
⑫	⑬	⑭	⑮	⑯	⑰
MO4-8 12" M4-2 12" M3-4 12" MI-95A BY ROAD 24" X 30" MO6-1 21" X 21"	MO4-8 12" M4-2 12" M3-4 12" MI-95A BY ROAD 24" X 30" MO6-2 21" X 21"	MO4-8 12" M4-2 12" M3-4 12" MI-95A BY ROAD 24" X 30" MO6-2 21" X 21"	MO4-8 12" M4-2 12" M3-4 12" MI-95A BY ROAD 24" X 30" MO6-1 21" X 21"	MO4-8 12" M4-2 12" M3-4 12" MI-95A BY ROAD 24" X 30" MO6-1 21" X 21"	MO4-8 12" M4-2 12" M3-4 12" MI-95A BY ROAD 24" X 30" MO6-1 21" X 21"
⑱	⑲	⑳	SEE FIXED MESSAGE SIGN (FMS) DETAILS		
MO4-8 12" M4-2 12" M3-4 12" MI-95A BY ROAD 24" X 30" MO6-1 21" X 21"	MO4-8 12" M4-2 12" M3-4 12" MI-95A BY ROAD 24" X 30" MO6-1 21" X 21"	MO4-8 12" M4-2 12" M3-4 12" MI-95A BY ROAD 24" X 30" MO6-1 21" X 21"			

NOTES

- 1) EXISTING SIGNS SHOWN IN GRAYSHADE
- 2) THE EXACT LOCATION AND SPACING OF SIGNS SHALL BE ADJUSTED TO FIT FIELD CONDITIONS AS APPROVED BY THE ENGINEER
- 3) ADJUST THE LOCATION OF THE DETOUR ROUTE SIGNS TO CORRESPOND WITH EXISTING ASSEMBLIES
- 4) THE SPACING BETWEEN TRAFFIC CONTROL AND DETOUR ROUTE SIGNS SHOULD BE ADJUSTED TO NOT CONFLICT WITH AND TO PROVIDE A MINIMUM OF 100 FEET CLEARANCE TO EXISTING SIGNS THAT WILL REMAIN IN PLACE
- 5) ANY SIGNS TEMPORARILY OR EXISTING WHICH CONFLICT WITH TRAFFIC CONTROL "IN USE", SHALL BE REMOVED OR COVERED AS NEEDED AND AS APPROVED BY THE ENGINEER
- 6) "MO" SIGNS ARE THE SAME AS "M" SIGNS EXCEPT THE BACKGROUND IS ORANGE

LEGEND

- SIGN ON PERMANENT SUPPORT
- FIXED MESSAGE SIGN ON WOOD POST SUPPORTS
- ⊗ DETOUR ROUTE SIGN NUMBER
- DETOUR ROUTE
- TRAFFIC BARRICADE WITH WARNING SIGN (TYPE A AND ATTACHED SIGN)

Addendum No. 01
ID 2475-00-70
Revised Sheet 150
August 20, 2015

TRAFFIC CONTROL ITEMS

CATEGORY	STAGE	DURATION DAYS	643.0300		643.0420		643.0705		643.0715		643.0800		643.0900		643.1050		643.3000			
			TRAFFIC CONTROL DRUMS	TRAFFIC CONTROL TYPE II	WARNING LIGHTS TYPE A	WARNING LIGHTS TYPE C	TRAFFIC CONTROL TYPE I	TRAFFIC CONTROL TYPE II	TRAFFIC CONTROL TYPE I	TRAFFIC CONTROL TYPE II	TRAFFIC CONTROL TYPE I	TRAFFIC CONTROL TYPE II	TRAFFIC CONTROL TYPE I	TRAFFIC CONTROL TYPE II	TRAFFIC CONTROL TYPE I	TRAFFIC CONTROL TYPE II	TRAFFIC CONTROL TYPE I	TRAFFIC CONTROL TYPE II	TRAFFIC CONTROL TYPE I	TRAFFIC CONTROL TYPE II
			EACH	DAYS	EACH	DAYS	EACH	DAYS	EACH	DAYS	EACH	DAYS	EACH	DAYS	EACH	DAYS	EACH	DAYS	EACH	DAYS
0010	PHASE 1	2	15	30	10	20	20	40	15	30	1	2	19	38	4	56	163	326		
	PHASE 2	20	14	280	9	180	18	360	14	280	--	--	22	440	5	170	155	3,100		
	PHASE 3	40	34	1,360	35	1,400	70	2,800	34	1,360	--	--	31	1,240	4	56	200	8,000		
	PHASE 4	40	34	1,360	42	1,680	84	3,360	34	1,360	1	40	36	1,440	4	56	200	8,000		
	PHASE 5	18	70	1,260	6	108	12	216	70	1,260	2	36	16	288	--	--	--	--		
	UNDISTRIBUTED #	10	18	180	11	112	22	224	18	180	2	28	25	264	2	28	5	50		
TOTALS				4,470		3,500		7,000		4,470		106		3,710		366		19,476		

NOTE: POMS ARE UNDISTRIBUTED FOR EACH STAGE
= UNDISTRIBUTED DAYS DO NOT COUNT TOWARDS WORKING DAYS TOTAL IN CONTRACT

TRAFFIC CONTROL SIGNS FIXED MESSAGE

CATEGORY	PHASE	LOCATION	FMS SIGN NO.	643.1000 SF	REMARKS
0010	1,3 AND 4	SOUTH LEG	2001	140	MOUNT ON MULTIPLE POST, INSTALL IN PHASE 1, COVER PHASE 2, UNCOVER PHASE 3
0010	1,3 AND 4	NORTH LEG	2001	140	MOUNT ON MULTIPLE POST, INSTALL IN PHASE 1, COVER PHASE 2, UNCOVER PHASE 3
TOTALS			280		

SEDIMENT BASIN

CATEGORY	ROADWAY	628.1104 EROSION BALES EACH	SPV.0180.02 GEOTEXTILE FABRIC TYPE FF SY
0010	STH 145	--	--
	UNDISTRIBUTED	20	50
TOTAL		20	50

* ADDITIONAL QUANTITIES LISTED ELSEWHERE

TEMPORARY COVER PLATE ITEMS

CATEGORY	ROADWAY	LOCATION	OFFSET	611.8120.S EACH	REMARKS
0010	STH 145 NB	482NB+11	17' RT	1	INSTALL ALL IN PHASE 3,
		482NB+24	17' RT	1	REMOVE IN PHASE 5
		484NB+25	LT&RT	4	
		489NB+91	16' LT	2	
		492NB+25	6' LT	1	
		493NB+25	25' RT	1	
TOTALS				10	

TRAFFIC CONTROL ITEMS (PROJECT)

CATEGORY	PROJECT	643.0100 TRAFFIC CONTROL	643.2000 TRAFFIC CONTROL
0010	STH 145 / DONGES BAY RD	1	1
TOTAL		1	1

SCHEDULE OF ITEMS

REVISED:

CONTRACT:
20150915006PROJECT(S):
2475-00-70FEDERAL ID(S):
WISC 2015488

CONTRACTOR : _____

LINE NO	ITEM DESCRIPTION	APPROX. QUANTITY AND UNITS	UNIT PRICE		BID AMOUNT	
			DOLLARS	CTS	DOLLARS	CTS
1200	643.0420 Traffic Control Barricades Type III	3,500.000 DAY
1210	643.0705 Traffic Control Warning Lights Type A	7,000.000 DAY
1220	643.0715 Traffic Control Warning Lights Type C	4,470.000 DAY
1230	643.0800 Traffic Control Arrow Boards	106.000 DAY
1240	643.0900 Traffic Control Signs	3,710.000 DAY
1250	643.1000 Traffic Control Signs Fixed Message	280.000 SF
1260	643.1050 Traffic Control Signs PCMS	366.000 DAY
1270	643.2000 Traffic Control Detour (project) 01. 2475-00-70	1.000 EACH
1280	643.3000 Traffic Control Detour Signs	19,476.000 DAY
1290	645.0111 Geotextile Fabric Type DF Schedule A	375.000 SY
1300	645.0120 Geotextile Fabric Type HR	326.000 SY