

# Wisconsin Department of Transportation

October 30, 2015

## Division of Transportation Systems Development

Bureau of Project Development  
4802 Sheboygan Avenue, Rm 601  
P O Box 7916  
Madison, WI 53707-7916

Telephone: (608) 266-1631  
Facsimile (FAX): (608) 266-8459

### NOTICE TO ALL CONTRACTORS:

**Proposal #12: 1330-24-70, WISC 2015 573  
Grand Av/Branch St, City of Hartford  
E Monroe Ave to Sumner St (STH 60)  
STH 83  
Washington County**

**1330-24-71  
Grand Av/Branch St, City of Hartford  
E Monroe Ave to Sumner St (STH 60)–Utility Improvements  
STH 83  
Washington County**

### Letting of November 10, 2015

This is Addendum No. 01, which provides for the following:

#### Special Provisions

Revised Special Provisions	
Article No.	Description
3	Prosecution and Progress
10	Maintaining Drainage

#### Schedule of Items

Revised Bid Item Quantities – ID 1330-24-70					
Bid Item	Item Description	Unit	Old Quantity	Revised Quantity	Proposal Total
204.0210	Removing Manholes	EACH	30	2	32
415.0070	Concrete Pavement 7-Inch	SY	22,150	-2460	19,690
611.0530	Manhole Covers Type J	EACH	44	2	46
611.2006	Manholes 6-FT Diameter	EACH	19	2	21
690.0150	Sawing Asphalt	LF	5325	860	6185
690.0250	Sawing Concrete	LF	540	1000	1540
715.0415	Incentive Strength Concrete Pavement	DOL	1,292	-143	1,149

Added Bid Item Quantities – ID 1330-24-70					
Bid Item	Item Description	Unit	Old Quantity	Revised Quantity	Proposal Total
520.4018	Culvert Pipe Temporary 18-Inch	LF	0	200	200
520.4024	Culvert Pipe Temporary 24-Inch	LF	0	198	198

## Plan Sheets

Revised Plan Sheets	
Plan Sheet	Plan Sheet Title (brief description of changes to sheet)
108	Stage 1 Overview traffic control notes were reworded to provide more detail for the storm sewer construction.
109	Stage 1A traffic control notes were reworded to provide more detail for the storm sewer construction.
136	Removing Manholes quantity changed from 30 EACH to 32 EACH.
137	Removing Manholes quantity changed from 30 EACH to 32 EACH.
140	Concrete Pavement 7-Inch quantity changed from 22,150 SY to 19,690 SY and Incentive Strength Concrete Pavement quantity changed from 1,292 DOL to 1,149 DOL. Added table for Culvert Pipe Temporary 18-Inch and 24-Inch quantities
148	Manholes 6-FT Diameter quantity changed from 19 EACH to 21 EACH and Manhole Covers Type J quantity changed from 44 EACH to 46 EACH.
150	Manholes 6-FT Diameter quantity changed from 19 EACH to 21 EACH and Manhole Covers Type J quantity changed from 44 EACH to 46 EACH.
161	Sawing asphalt quantity changed from 5325 LF to 6185 LF. Sawing concrete quantity changed from 540 LF to 1540 LF.

The responsibility for notifying potential subcontractors and suppliers of these changes remains with the prime contractor.

Sincerely,

*Mike Coleman*

Proposal Development Specialist  
Proposal Management Section

**ADDENDUM NO. 01**  
**1330-24-70, 1330-24-71**  
**October 30, 2015**

**Special Provisions**

**3. Prosecution and Progress**

*Replace paragraph four under section titled C Schedule of Operations with the following:*

Stage 1 construction of STH 83 just south of Kossuth St. to STH 60, as shown on the plans, can't be fully closed to traffic until July 5<sup>th</sup> to minimize impacts to businesses and local events, however some minor work can be conducted under flagging operations to allow for temporary or full sections of storm sewer to be put in place with temporary asphalt. The City of Hartford uses STH 83 (Main Street) for the Memorial Day parade, July 4<sup>th</sup> parade, and high school homecoming parade during the second week in October.

**10. Maintaining Drainage**

*Replace paragraph two with the following:*

Use bid items as shown in the plans to maintain drainage.

**Schedule of Items**

Attached, dated October 30, 2015, are the revised Schedule of Items Pages 1, 3, 6, 7, 18, 22, and 23.

**Plan Sheets**

The following 8½ x 11-inch sheets are attached and made part of the plans for this proposal:  
Revised: pages 108, 109, 136, 137, 140, 148, 150, and 161

END OF ADDENDUM

Addendum No. 01  
 ID 1330-24-70  
 Revised Sheet 108  
 October 30, 2015

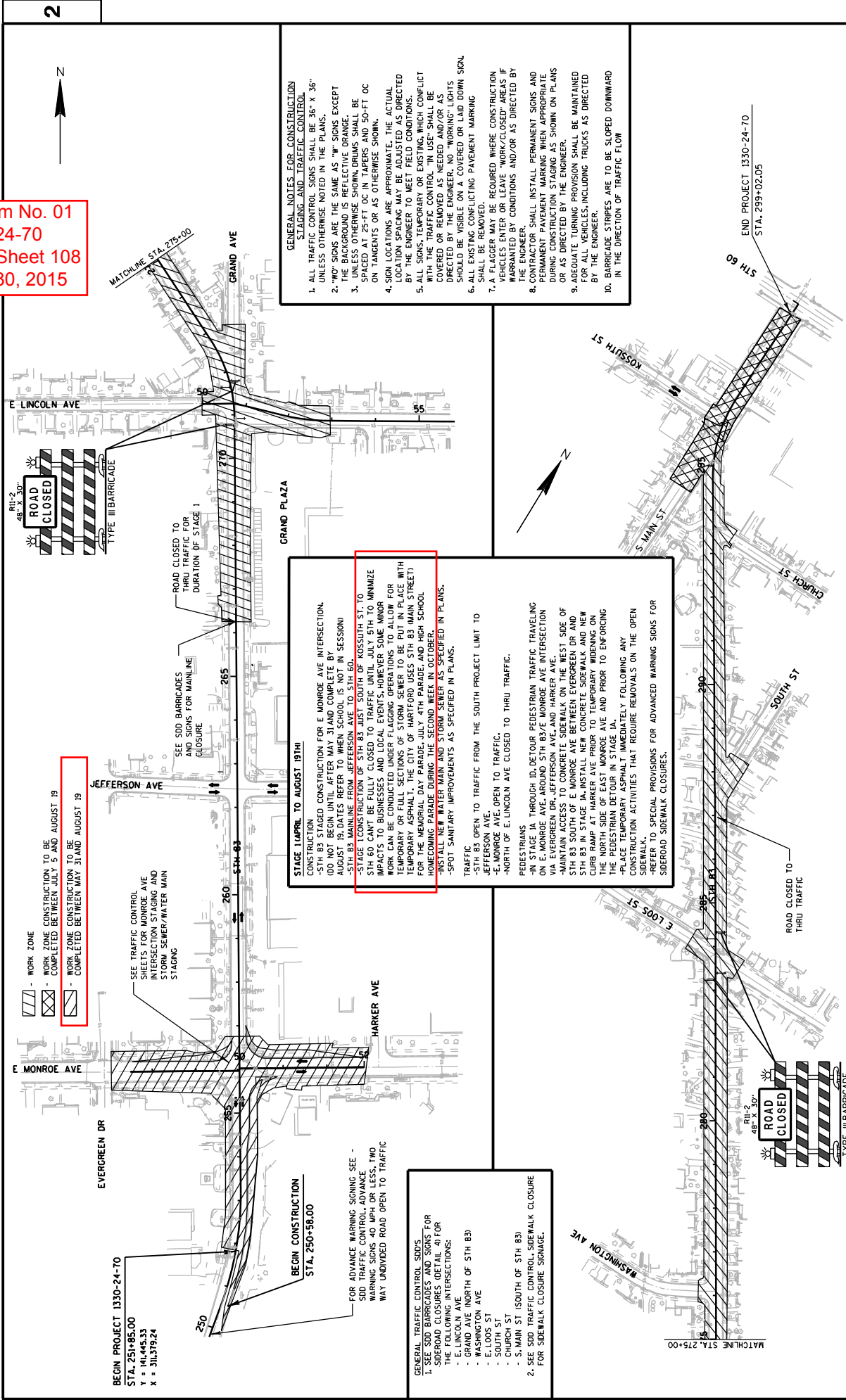

WORK ZONE  
 WORK ZONE CONSTRUCTION TO BE COMPLETED BETWEEN JULY 5 AND AUGUST 19  
 WORK ZONE CONSTRUCTION TO BE COMPLETED BETWEEN MAY 31 AND AUGUST 19

SEE TRAFFIC CONTROL SHEETS FOR MONROE AVE INTERSECTION STAGING AND STORM SEWER/WATER MAIN STAGING

FOR ADVANCE WARNING SIGNING SEE - SDD TRAFFIC CONTROL ADVANCE TWO WAY UNDIVIDED ROAD OPEN TO TRAFFIC

GENERAL TRAFFIC CONTROL SIGNS  
 1. SEE SDD BARRICADES AND SIGNS FOR THE FOLLOWING INTERSECTIONS:  
 - E LINCOLN AVE  
 - GRAND AVE (NORTH OF 5TH B3)  
 - WASHINGTON AVE  
 - E LOOS ST  
 - SOUTH ST  
 - S MAIN ST  
 - SOUTH ST (SOUTH OF 5TH B3)  
 2. SEE SDD TRAFFIC CONTROL SIDEWALK CLOSURE FOR SIDEWALK CLOSURE SIGNAGE.

STAGE 1 APRIL TO AUGUST 19TH  
 CONSTRUCTION  
 -5TH B3 STAGED CONSTRUCTION FOR E MONROE AVE INTERSECTION. (DO NOT BEGIN UNTIL AFTER MAY 31 AND COMPLETE BY AUGUST 19, DATES REFER TO WHEN SCHOOL IS NOT IN SESSION)  
 -STAGE CONSTRUCTION OF 5TH B3 JUST SOUTH OF S. KOSSUTH ST. TO 5TH B3 CANT BE FULLY CLOSED TO TRAFFIC UNTIL JULY 5TH TO MINIMIZE IMPACTS TO BUSINESSES AND LOCAL EVENTS. HOWEVER, SOME MINOR WORK CAN BE CONDUCTED UNDER FLAGGING OPERATIONS TO ALLOW FOR TEMPORARY OR FULL SECTIONS OF STORM SEWER TO BE PUT IN PLACE WITH TEMPORARY ASPHALT. THE CITY OF HARTFORD USES 5TH B3 MAIN STREET FOR THE MEMORIAL DAY PARADE, JULY 4TH PARADE, AND HIGH SCHOOL HOMEcoming PARADE DURING THE SECOND WEEK IN OCTOBER.  
 -INSTALL NEW WATER MAIN AND STORM SEWER AS SPECIFIED IN PLANS.  
 -SPOT SANITARY IMPROVEMENTS AS SPECIFIED IN PLANS.  
 TRAFFIC  
 -5TH B3 OPEN TO TRAFFIC FROM THE SOUTH PROJECT LIMIT TO JEFFERSON AVE. OPEN TO TRAFFIC.  
 -NORTH OF E LINCOLN AVE CLOSED TO THRU TRAFFIC.  
 PEDESTRIANS  
 -IN STAGE 1A THROUGH 1D, DETOUR PEDESTRIAN TRAFFIC TRAVELING ON E MONROE AVE AROUND 5TH B3/E MONROE AVE INTERSECTION.  
 -MAINTAIN ACCESS TO CONCRETE SIDEWALK ON THE WEST SIDE OF 5TH B3 SOUTH OF E MONROE AVE BETWEEN EVERGREEN DR AND CURB RAMP AT HARKER AVE PRIOR TO TEMPORARY WIDENING ON THE NORTH SIDE OF EAST MONROE AVE AND PRIOR TO ENFORCING THE PEDESTRIAN DETOUR IN STAGE 1A.  
 -PLACE TEMPORARY ASPHALT IMMEDIATELY FOLLOWING ANY CONSTRUCTION ACTIVITIES THAT REQUIRE REMOVALS ON THE OPEN SIDEWALK.  
 -REFER TO SPECIAL PROVISIONS FOR ADVANCED WARNING SIGNS FOR SIDEWALK CLOSURES.

GENERAL NOTES FOR CONSTRUCTION STAGING AND TRAFFIC CONTROL  
 1. ALL TRAFFIC CONTROL SIGNS SHALL BE 36" X 36" UNLESS OTHERWISE NOTED IN THE PLANS.  
 2. "W" SIGNS ARE THE SAME AS "M" SIGNS EXCEPT THE BACKGROUND IS REFLECTIVE ORANGE.  
 3. UNLESS OTHERWISE SHOWN, DRUMS SHALL BE SPACED AT 25-FT OC IN TAPERS AND 50-FT OC ON TANGENTS OR AS OTHERWISE SHOWN.  
 4. SIGN LOCATIONS ARE APPROXIMATE. THE ACTUAL LOCATION SPACING MAY BE ADJUSTED AS DIRECTED BY THE ENGINEER OR EXISTING WHICH CONFLICT WITH THE TRAFFIC CONTROL IN USE. SHALL BE COORDINATED BY THE ENGINEER. NO "WORKING" LIGHTS SHOULD BE VISIBLE ON A COVERED OR LAD-DOWN SIGN.  
 5. ALL EXISTING CONFLICTING PAVEMENT MARKING SHALL BE REMOVED.  
 6. A FLAGGER MAY BE REQUIRED WHERE CONSTRUCTION VEHICLES ENTER OR LEAVE "WORK/CLOSED" AREAS IF WARRANTED BY CONDITIONS AND/OR AS DIRECTED BY THE ENGINEER.  
 7. CONTRACTOR SHALL INSTALL PERMANENT SIGNS AND PERMANENT PAVEMENT MARKING WHEN APPROPRIATE. ALL PERMANENT SIGNS AND PAVEMENT MARKING SHALL BE AS DIRECTED BY THE ENGINEER.  
 8. ADEQUATE TURNING PROVISION SHALL BE MAINTAINED FOR ALL VEHICLES, INCLUDING TRUCKS AS DIRECTED BY THE ENGINEER.  
 9. BARRICADE STRIPES ARE TO BE SLOPED DOWNWARD IN THE DIRECTION OF TRAFFIC FLOW.

BEGIN PROJECT 1330-24-70  
 STA. 251+85.00  
 Y = 41.445.33  
 X = 311.379.24

PROJECT NO: 1330-24-70  
 HWY: STH 83  
 COUNTY: WASHINGTON  
 TRAFFIC CONTROL - STAGE 1 OVERVIEW  
 SHEET 108 E

FILE NAME : J:\ACT\pvs\1330-24-00 5TH B3\mdu\025001.tc.s1.dgn  
 PLOT DATE : 10/28/2015  
 PLOT BY : pvs...plotuser...88  
 PLOT NAME :  
 PLOT SCALE : 309.0909 ' / 1" WISDOT/CADD SHEET 42



REMOVING STORM SEWER

PROJECT ID	STAGE	ROADWAY	STA	STA	LOC	204.0210		204.0220		204.0245.01		204.0245.02		204.0245.03		204.0245.04		204.0245.05		204.0245.06		204.0245.07		204.0245.08		204.0245.09		204.0245.10									
						REMOVING MANHOLES EACH	REMOVING INLETS EACH	SEWER LF	STORM LF	REMOVING SEWER LF	STORM LF	REMOVING SEWER LF	STORM LF	REMOVING SEWER LF	STORM LF	REMOVING SEWER LF	STORM LF	REMOVING SEWER LF	STORM LF	REMOVING SEWER LF	STORM LF	REMOVING SEWER LF	STORM LF	REMOVING SEWER LF	STORM LF	REMOVING SEWER LF	STORM LF	REMOVING SEWER LF	STORM LF	REMOVING SEWER LF	STORM LF	REMOVING SEWER LF	STORM LF				
STAGE 1																																					
1330-24-70		STH 83	270+42	-	270+43	LT	1																														
		STH 83	270+42	-	270+43	RT	1																														
		STH 83	270+42	-	270+75	RT	2																														
		STH 83	270+78	-	270+79	LT																															
		LINCOLN AVE	50+88	-	52+40	RT	1																														
		LINCOLN AVE	52+40	-	52+42	RT																															
		LINCOLN AVE	52+40	-	52+35	LT	1																														
		STH 83	270+78	-	272+31	RT	1																														
		STH 83	272+31	-	272+32	RT	1																														
		STH 83	272+31	-	272+54	LT	1																														
		STH 83	272+31	-	272+72	RT																															
		STH 83	283+28	-	283+88	RT	1																														
		STH 83	283+71	-	283+88	LT	1																														
		STH 83	283+71	-	284+01	LT																															
		STH 83	283+88	-	284+24	LT																															
		STH 83	283+88	-	286+73	RT	1																														
		STH 83	286+73	-	286+73	LT																															
		STH 83	286+73	-	286+74	RT	1																														
		STH 83	286+73	-	287+70	RT	1																														
		STH 83	287+70	-	288+24	RT	1																														
		STH 83	287+70	-	288+22	RT																															
		STH 83	288+22	-	288+27	RT	1																														
		STH 83	287+70	-	291+10	RT	1																														
		STH 83	291+10	-	293+60	RT	1																														
		STH 83	293+60	-	293+22	RT	1																														
		STH 83	293+60	-	293+58	RT																															
		STH 83	293+60	-	295+13	RT	1																														
		STH 83	295+13	-	294+81	LT																															
		STH 83	295+13	-	294+86	LT																															
		STH 83	295+13	-	295+23	RT	1																														
		STH 83	295+13	-	295+69	RT	1																														
		MAIN ST	10+20	-	10+63	LT	1																														
		MAIN ST	10+63	-	10+74	LT	1																														
		MAIN ST	10+74	-	11+35	LT	1																														
		MAIN ST	11+35	-	11+37	LT	1																														
		MAIN ST	11+35	-	11+66	LT																															
		STH 83	295+69	-	295+85	LT																															
		STH 83	295+85	-	297+76	RT	1																														
		STH 83	296+55	-	296+55	RT	1																														
		STH 83	297+47	-	297+46	LT	1																														
		STH 83	297+76	-	299+00	LT	1																														
		STH 83	297+76	-	297+76	RT	1																														
		STH 83	298+38	-	298+38	LT	1																														
		STH 83	298+77	-	298+77	LT	1																														
		STH 83	298+99	-	298+77	RT	1																														
		STH 83	298+99	-	299+00	RT	1																														
STAGE 1 SUBTOTALS							26	59			463			1,699	165																						
ALL ITEMS CATEGORY 0010 UNLESS NOTED OTHERWISE																																					

Addendum No. 01  
ID 1330-24-70  
Revised Sheet 136  
October 30, 2015



CONCRETE PAVEMENT

PROJECT ID.	STAGE	ROADWAY	STATION	STATION	STATION	CY	SY	DOL
1330-24-70								
STAGE 1								
		STH 83	266+25	-	298+94	46	12,100	706
STAGE 1B								
		STH 83	251+85	-	255+29	620	620	36
		STH 83/MONROE AVE	255+37	-	256+05	13	475	28
		MONROE AVE	48+80	-	49+55	---	325	19
		MONROE AVE	50+55	-	51+55	---	300	18
		STAGE 1B SUBTOTALS				13	1,720	100
STAGE 1C								
		STH 83	251+85	-	255+82	5	845	49
		STH 83	256+05	-	256+17	---	120	7
		MONROE AVE	48+80	-	49+55	3	100	6
		MONROE AVE	50+55	-	51+55	8	135	8
		STAGE 1C SUBTOTALS				8	1,200	70
STAGE 1D								
		STH 83	255+81	-	255+82	---	190	11
		STH 83	256+17	-	256+57	---	355	21
		MONROE AVE	48+80	-	49+55	5	55	3
		MONROE AVE	50+55	-	51+55	11	180	11
		STAGE 1D SUBTOTALS				5	780	46
STAGE 2								
		STH 83	256+57	-	266+25	14	3,890	227
TOTAL (1330-24-70)								
						86	19,690	1,149

ALL ITEMS CATEGORY 0010 UNLESS NOTED OTHERWISE

Addendum No. 01  
 ID 1330-24-70  
 Revised Sheet 140  
 October 30, 2015

DRILLED DOWEL & TIE BARS

PROJECT ID.	ROADWAY	LOCATION	EACH	416.0610	416.0620
1330-24-70					
	STH 83	299+02	--	--	34
	STH 83	TYPE H INLETS	22	--	--
	STH 83	UNDISTRIBUTED	43	43	41
			65	65	75
TOTAL (1330-24-70)					

ALL ITEMS CATEGORY 0010 UNLESS NOTED OTHERWISE

CULVERT PIPE TEMPORARY

PROJECT ID.	STAGE	LOCATION	FROM STR	TO STR	INLET ELEV	DISCH ELEV	SLOPE	LF	COMMENT
1330-24-70									
	STAGE 1A	STH 83 STA 251+85 - 256+50						40	TEMPORARY PIPE FOR MAINTAINING DRAINAGE TO EXISTING INLETS IN TEMPORARY WIDENING AREA
	STAGE 1A	E MONROE AVE						60	TEMPORARY PIPE FOR MAINTAINING DRAINAGE TO EXISTING INLETS IN TEMPORARY WIDENING AREA
	STAGE 1	STH 83, STA 294+71, 7 RT TO STA 295+75, 6' LT	247	258	983.19	982.54	0.065	100	TEMPORARY PIPE FOR MAINTAINING DRAINAGE FOR WORK ON STH 83 FROM JUST SOUTH OF KOSSUTH TO STH 60
	STAGE 1	STH 83, STA 296+75, 6' LT TO STA 295+85, 20' LT	258	EX. WH	982.54	982.42	0.065	18	TEMPORARY PIPE FOR MAINTAINING DRAINAGE FOR WORK ON STH 83 FROM JUST SOUTH OF KOSSUTH TO STH 60
		UNDISTRIBUTED						100	
TOTAL (1330-24-70)									198

ALL ITEMS CATEGORY 0010 UNLESS NOTED OTHERWISE







SAWING PAVEMENT

PROJECT ID.	STAGE	ROADWAY	STATION	STATION	LOCATION	690.0150 SAWING ASPHALT		690.0250 SAWING CONCRETE	
						LF	LF	LF	LF
STAGE 1									
STH 83			266+25	- 266+25	---	37	---	---	---
STH 83			266+68	- 266+84	LT	---	16	---	---
STH 83			268+56	- 268+74	LT	---	18	---	---
STH 83			268+88	- 269+20	RT	35	---	---	---
LINCOLN AVE			50+00	- 50+00	---	31	---	10	---
LINCOLN AVE			51+35	- 51+65	RT	30	---	---	---
LINCOLN AVE			51+98	- 52+27	RT	33	---	---	---
LINCOLN AVE			52+58	- 52+88	RT	32	---	---	---
LINCOLN AVE			52+92	- 52+92	---	37	---	10	---
GRAND AVE			12+11	- 12+11	---	29	---	10	---
STH 83			273+45	- 273+67	LT	22	---	---	---
STH 83			275+62	- 275+71	RT	---	9	---	---
WASHINGTON AVE			275+87	- 276+34	LT	31	---	10	---
STH 83			277+25	- 277+36	RT	11	---	---	---
STH 83			278+11	- 278+22	RT	11	---	---	---
STH 83			279+43	- 279+52	RT	---	9	---	---
STH 83			280+21	- 280+31	RT	10	---	---	---
STH 83			280+24	- 280+37	LT	---	13	---	---
STH 83			281+70	- 281+80	LT	---	10	---	---
STH 83			282+30	- 282+39	LT	9	---	---	---
LOOS ST			10+00	- 10+00	---	30	---	10	---
LOOS ST			11+26	- 11+26	---	31	---	10	---
STH 83			284+52	- 284+63	RT	12	---	---	---
STH 83			286+09	- 286+20	RT	---	11	---	---
STH 83			286+49	- 286+62	LT	---	12	---	---
STH 83			287+14	- 287+34	LT	---	22	---	---
STH 83			287+56	- 287+81	LT	---	32	---	---
SOUTH ST			11+06	- 11+06	---	31	---	10	---
STH 83			288+32	- 288+83	RT	---	73	---	---
STH 83			292+39	- 292+57	LT	18	---	---	---
STH 83			293+12	- 293+17	RT	---	5	---	---
STH 83			293+22	- 293+42	RT	25	---	---	---
STH 83			293+42	- 293+50	RT	---	9	---	---
STH 83			293+50	- 297+86	RT	423	---	41	---
STH 83			293+63	- 293+78	LT	15	---	---	---
MAIN ST			10+00	- 10+00	---	35	---	10	---
KOSSUTH ST			295+89	- 296+30	LT	27	---	20	---
STH 83			296+30	- 297+22	LT	105	---	---	---
STH 83			298+69	- 299+02	LT	---	47	---	---
STH 83			298+72	- 299+02	RT	---	46	---	---
STH 83			299+02	- 299+02	---	---	38	---	---
STAGE 1 SUBTOTALS						1,101	---	520	---

Addendum No. 01  
 ID 1330-24-70  
 Revised Sheet 161  
 October 30, 2015

SAWING PAVEMENT (CONTINUED)

PROJECT ID.	STAGE	ROADWAY	STATION	STATION	LOCATION	690.0150 SAWING ASPHALT		690.0250 SAWING CONCRETE	
						LF	LF	LF	LF
STAGE 1A									
STH 83			250+99	- 255+76	RT	495	---	---	---
STH 83 STAGED STORM SEWER			251+85	- 256+50	L/T/R/T	---	---	1,000	---
MONROE AVE			47+54	- 49+83	LT	257	---	---	---
MONROE AVE			47+54	- 49+75	L/T/R/T	380	---	---	---
STAGE STORM SEWER			50+15	- 52+81	LT	320	---	---	---
MONROE AVE			50+50	- 52+81	L/T/R/T	480	---	---	---
STAGE 1A SUBTOTALS						1,932	---	1,000	---
STAGE 1B									
STH 83			251+85	- 256+05	---	578	---	---	---
MONROE AVE			47+54	- 52+81	LT	526	---	---	---
STAGE 1B SUBTOTALS						1,104	---	---	---
STAGE 1C									
STH 83			251+85	- 255+67	RT	397	---	---	---
MONROE AVE			47+54	- 52+81	LT	526	---	---	---
STAGE 1C SUBTOTALS						923	---	---	---
STAGE 1D									
STH 83			256+57	- 256+57	---	37	---	---	---
STAGE 2									
STH 83			256+46	- 262+09	RT	632	---	---	---
STH 83			260+33	- 260+59	LT	26	---	---	---
JEFFERSON AVE			262+11	- 262+73	RT	37	---	10	---
JEFFERSON AVE			262+12	- 262+76	LT	37	---	10	---
STH 83			263+74	- 265+96	LT	225	---	---	---
STH 83			264+28	- 264+53	RT	25	---	---	---
STH 83			265+11	- 265+73	RT	71	---	---	---
STH 83			265+80	- 266+16	RT	35	---	---	---
STAGE 2 SUBTOTALS						1,088	---	20	---
TOTAL (1330-24-70)						6,185	---	1,540	---

ALL ITEMS CATEGORY 0010 UNLESS NOTED OTHERWISE

SCHEDULE OF ITEMS

REVISED:

CONTRACT:  
20151110012

PROJECT(S):  
1330-24-70  
1330-24-71

FEDERAL ID(S):  
WISC 2015573  
N/A

CONTRACTOR : \_\_\_\_\_

LINE NO	ITEM DESCRIPTION	APPROX. QUANTITY AND UNITS	UNIT PRICE		BID AMOUNT	
			DOLLARS	CTS	DOLLARS	CTS

SECTION 0001 ROADWAY ITEMS

0010	201.0120 Clearing	134.000 ID	.	.	.	.
0020	201.0220 Grubbing	134.000 ID	.	.	.	.
0030	204.0100 Removing Pavement	13,200.000 SY	.	.	.	.
0040	204.0110 Removing Asphaltic Surface	1,600.000 SY	.	.	.	.
0050	204.0150 Removing Curb & Gutter	5,915.000 LF	.	.	.	.
0060	204.0155 Removing Concrete Sidewalk	6,250.000 SY	.	.	.	.
0070	204.0195 Removing Concrete Bases	21.000 EACH	.	.	.	.
0080	204.0210 Removing Manholes	32.000 EACH	.	.	.	.
0090	204.0220 Removing Inlets	48.000 EACH	.	.	.	.
0100	204.0245 Removing Storm Sewer (size) 01. 6-INCH	59.000 LF	.	.	.	.

## SCHEDULE OF ITEMS

REVISED:

CONTRACT:  
20151110012PROJECT(S):  
1330-24-70  
1330-24-71FEDERAL ID(S):  
WISC 2015573  
N/A

CONTRACTOR : \_\_\_\_\_

LINE NO	ITEM DESCRIPTION	APPROX. QUANTITY AND UNITS	UNIT PRICE		BID AMOUNT	
			DOLLARS	CTS	DOLLARS	CTS
0210	205.0501.S Excavation, Hauling, and Disposal of Petroleum Contaminated Soil	383.000 TON	.		.	
0220	213.0100 Finishing Roadway (project) 01. 1330-24-70	1.000 EACH	.		.	
0230	305.0120 Base Aggregate Dense 1 1/4-Inch	12,765.000 TON	.		.	
0240	311.0110 Breaker Run	19,890.000 TON	.		.	
0250	405.0100 Coloring Concrete Red	86.000 CY	.		.	
0260	415.0070 Concrete Pavement 7-Inch	19,690.000 SY	.		.	
0270	415.0210 Concrete Pavement Gaps	9.000 EACH	.		.	
0280	416.0170 Concrete Driveway 7-Inch	900.000 SY	.		.	
0290	416.0610 Drilled Tie Bars	65.000 EACH	.		.	
0300	416.0620 Drilled Dowel Bars	75.000 EACH	.		.	

## SCHEDULE OF ITEMS

REVISED:

CONTRACT:  
20151110012PROJECT(S):  
1330-24-70  
1330-24-71FEDERAL ID(S):  
WISC 2015573  
N/A

CONTRACTOR : \_\_\_\_\_

LINE NO	ITEM DESCRIPTION	APPROX. QUANTITY AND UNITS	UNIT PRICE		BID AMOUNT	
			DOLLARS	CTS	DOLLARS	CTS
0520	608.0324 Storm Sewer Pipe Reinforced Concrete Class III 24-Inch	2,431.000 LF	.		.	
0530	608.0330 Storm Sewer Pipe Reinforced Concrete Class III 30-Inch	504.000 LF	.		.	
0540	608.0336 Storm Sewer Pipe Reinforced Concrete Class III 36-Inch	767.000 LF	.		.	
0550	611.0530 Manhole Covers Type J	46.000 EACH	.		.	
0560	611.0606 Inlet Covers Type B	7.000 EACH	.		.	
0570	611.0624 Inlet Covers Type H	11.000 EACH	.		.	
0580	611.0642 Inlet Covers Type MS	5.000 EACH	.		.	
0590	611.0651 Inlet Covers Type S	3.000 EACH	.		.	
0600	611.0660 Inlet Covers Type WM	70.000 EACH	.		.	
0610	611.0666 Inlet Covers Type Z	3.000 EACH	.		.	
0620	611.2004 Manholes 4-FT Diameter	36.000 EACH	.		.	

## SCHEDULE OF ITEMS

REVISED:

CONTRACT:  
20151110012PROJECT(S):  
1330-24-70  
1330-24-71FEDERAL ID(S):  
WISC 2015573  
N/A

CONTRACTOR : \_\_\_\_\_

LINE NO	ITEM DESCRIPTION	APPROX. QUANTITY AND UNITS	UNIT PRICE		BID AMOUNT	
			DOLLARS	CTS	DOLLARS	CTS
0630	611.2006 Manholes 6-FT Diameter	21.000 EACH	.		.	
0640	611.3003 Inlets 3-FT Diameter	3.000 EACH	.		.	
0650	611.3004 Inlets 4-FT Diameter	23.000 EACH	.		.	
0660	611.3225 Inlets 2x2.5-FT	52.000 EACH	.		.	
0670	611.3901 Inlets Median 1 Grate	5.000 EACH	.		.	
0680	611.8110 Adjusting Manhole Covers	1.000 EACH	.		.	
0690	611.8115 Adjusting Inlet Covers	2.000 EACH	.		.	
0700	611.8120.S Cover Plates Temporary	9.000 EACH	.		.	
0710	612.0106 Pipe Underdrain 6-Inch	1,503.000 LF	.		.	
0720	612.0206 Pipe Underdrain Unperforated 6-Inch	451.000 LF	.		.	

## SCHEDULE OF ITEMS

REVISED:

CONTRACT:  
20151110012PROJECT(S):  
1330-24-70  
1330-24-71FEDERAL ID(S):  
WISC 2015573  
N/A

CONTRACTOR : \_\_\_\_\_

LINE NO	ITEM DESCRIPTION	APPROX. QUANTITY AND UNITS	UNIT PRICE		BID AMOUNT	
			DOLLARS	CTS	DOLLARS	CTS
1780	658.0605 Led Modules 12-Inch Yellow Ball	12.000 EACH	.		.	
1790	658.0610 Led Modules 12-Inch Green Ball	12.000 EACH	.		.	
1800	658.0620 Led Modules 12-Inch Yellow Arrow	6.000 EACH	.		.	
1810	658.0625 Led Modules 12-Inch Green Arrow	6.000 EACH	.		.	
1820	658.0635 Led Modules Pedestrian Countdown Timer 16-Inch	8.000 EACH	.		.	
1830	658.5069 Signal Mounting Hardware (location) 01. STH 83 & E MONROE AVE	LUMP	LUMP		.	
1840	659.1125 Luminaires Utility LED C	4.000 EACH	.		.	
1850	690.0150 Sawing Asphalt	6,185.000 LF	.		.	
1860	690.0250 Sawing Concrete	1,540.000 LF	.		.	
1870	715.0415 Incentive Strength Concrete Pavement	1,149.000 DOL	1.00000		1149.00	



## SCHEDULE OF ITEMS

REVISED:

CONTRACT:  
20151110012PROJECT(S):  
1330-24-70  
1330-24-71FEDERAL ID(S):  
WISC 2015573  
N/A

CONTRACTOR : \_\_\_\_\_

LINE NO	ITEM DESCRIPTION	APPROX. QUANTITY AND UNITS	UNIT PRICE		BID AMOUNT	
			DOLLARS	CTS	DOLLARS	CTS
2190	SPV.0090 Special 07. PAVEMENT MARKING GROOVED PREFORMED THERMOPLASTIC 4-INCH, YELLOW	2,874.000 LF	.	.	.	.
2200	SPV.0105 Special 01. REMOVE TRAFFIC SIGNALS STH 83 & E MONROE AVE	LUMP	LUMP	.	.	.
2210	SPV.0105 Special 02. REMOVE LOOP DETECTION WIRE & LEAD-IN CABLE	LUMP	LUMP	.	.	.
2220	SPV.0105 Special 03. INSTALL STATE FURNISHED TRAFFIC SIGNAL CABINET (STH 83 & E MONROE AVE)	LUMP	LUMP	.	.	.
2230	SPV.0105 Special 04. CONCRETE PAVEMENT JOINT LAYOUT	LUMP	LUMP	.	.	.
2240	SPV.0105 Special 05. SANITARY SEWER ABANDONMENT	LUMP	LUMP	.	.	.
2250	SPV.0105 Special 06. WATER MAIN ABANDONMENT	LUMP	LUMP	.	.	.
2260	SPV.0180 Special 01. CONCRETE PAVEMENT HES 7-INCH	925.000 SY	.	.	.	.
2270	SPV.0195 Special 01. MANAGEMENT OF SOLID WASTE	613.000 TON	.	.	.	.
2280	520.4018 Culvert Pipe Temporary 18-Inch	200.000 LF	.	.	.	.

SCHEDULE OF ITEMS

REVISED:

CONTRACT:  
20151110012

PROJECT(S):  
1330-24-70  
1330-24-71

FEDERAL ID(S):  
WISC 2015573  
N/A

CONTRACTOR : \_\_\_\_\_

LINE NO	ITEM DESCRIPTION	APPROX. QUANTITY AND UNITS	UNIT PRICE		BID AMOUNT	
			DOLLARS	CTS	DOLLARS	CTS
2290	520.4024 Culvert Pipe Temporary 24-Inch	198.000 LF	.		.	
	SECTION 0001 TOTAL				.	
	TOTAL BID				.	