



# Wisconsin Department of Transportation

April 1, 2016

**Division of Transportation Systems Development**

Bureau of Project Development  
 4802 Sheboygan Avenue, Rm 601  
 P O Box 7916  
 Madison, WI 53707-7916

Telephone: (608) 266-1631  
 Facsimile (FAX): (608) 266-8459

**NOTICE TO ALL CONTRACTORS:**

**Proposal #09: 2673-00-70, WISC 2016 092**  
**South Nicholson Road**  
**Bridge over Oak Creek**  
**(B-40-920)**  
**Local Street**  
**Milwaukee County**

**2987-00-70, WISC 2016 095**  
**West Marquette Avenue**  
**Bridge over North Branch Oak Creek**  
**(B-40-919)**  
**Local Street**  
**Milwaukee County**

**Letting of April 12, 2016**

This is Addendum No. 01, which provides for the following:

**Schedule of Items**

Added Bid Item Quantities					
Bid Item	Item Description	Unit	Old Quantity	Revised Quantity	Proposal Total
643.0420	Traffic Control Barricades Type III	Day	0	7,200	7,200
550.0010	Pre-Boring Unconsolidated Materials	LF	0	48	48

Deleted Bid Item Quantities					
Bid Item	Item Description	Unit	Old Quantity	Revised Quantity	Proposal Total
643.0410	Traffic Control Barricades Type II	Day	7,200	-7,200	0

**Plan Sheets**

Revised Plan Sheets	
Plan Sheet	Plan Sheet Title (brief description of changes to sheet)
	ID 2673-00-70
12	Miscellaneous Quantities – Pay Item Revised as shown above
	ID 2987-00-70
14	Miscellaneous Quantities – Pay Item Revised as shown above
47	Misc. Details and General Notes – Added Pay Item to Quantities Table

**Schedule of Items**

Attached, dated April 1, 2016, are the revised Schedule of Items Pages 7 and 11.

**Plan Sheets**

The following 8½ x 11-inch sheets are attached and made part of the plans for this proposal:

Revised:

2673-00-70: 12

2987-00-70: 14 and 47.

The responsibility for notifying potential subcontractors and suppliers of these changes remains with the prime contractor.

Sincerely,

*Mike Coleman*

Proposal Development Specialist  
Proposal Management Section

END OF ADDENDUM

EROSION CONTROL											
LOCATION	(LF)	(SY)	(SY)	(EA)	(EA)	(EA)	(EA)	(EA)	(EA)	(EA)	(EA)
PROJECT	-	70	-	4	2	-	-	86	-	-	-
NW BRIDGE	20	-	89	-	-	62	-	89	-	3	-
NE BRIDGE	20	-	134	-	-	84	-	134	-	4	-
SW BRIDGE	20	-	112	-	-	74	-	112	-	4	-
SE BRIDGE	20	-	90	-	-	68	-	90	-	3	-
SETTLING BASIN	-	-	-	-	-	-	-	-	-	-	32
UNDISTRIBUTED	20	-	15	-	-	12	-	15	-	6	-
TOTALS	100	70	440	4	2	300	4	440	90	20	10

PERMANENT SIGNING, TYPE II					
SIGN LOCATION	SIGN CODE	SIGN TYPE	TYPE II SIGN SIZE	W [IN]	H [IN]
23+08 LT	W5-52L		12	36	3
23+76 LT	W5-52R		12	36	3
23+20 RT	W5-52R		12	36	3
23+88 RT	W5-52L		12	36	3
TOTALS				4	12

CONSTRUCTION STAKING											
LOCATION	(EA)	(LF)	(LF)	(LF)	(EA)	(EA)	(EA)	(EA)	(EA)	(EA)	(EA)
PROJECT	8	66	66	66	85	1	132	-	-	-	-
UNDISTRIBUTED	0	4	4	4	5	-	8	-	-	-	-
TOTALS	8	70	70	70	90	1	140	-	-	-	-

PAVEMENT MARKING		
LOCATION	(LF)	(LF)
STA 22+75 TO STA 24+25	300	37.5
UNDISTRIBUTED	-	12.5
TOTALS	300	50

TRAFFIC CONTROL						
STAGE	CALANDAR DAYS	#	(DAYS)	#	(DAYS)	COMMENTS
PROJECT	240	18	4320	16	3840	8 1920
UNDISTRIBUTED	80	60	40	1	5	40
TOTALS	4400	3900	1960	5	2200	

TRAFFIC CONTROL						
ITEM	DESCRIPTION	(EA)	(EA)	(EA)	(EA)	(EA)
ITEM 643.0420	TRAFFIC CONTROL BARRICADES TYPE III	16	1920	8	1920	16
ITEM 643.0705	TRAFFIC CONTROL SIGNS TYPE II	16	1920	8	1920	16
ITEM 643.0920	TRAFFIC CONTROL COVERING SIGNS	5	40	5	40	5
ITEM 643.3000	TRAFFIC CONTROL DETOUR SIGNS	9	2160	9	2160	9
ITEM 690.0150	SAWING ASPHALT	24	24	24	24	24
TOTALS		60	7200	36	7200	60

SAWING		
LOCATION	(LF)	(LF)
STA. 22+75	24	24
STA. 24+25	24	24
UNDISTRIBUTED	2	2
TOTALS	50	50

ALL ITEMS CATEGORY 010 UNLESS OTHERWISE NOTED

STAGE	CALANDAR DAYS	#	(DAYS)	#	(DAYS)	#	(DAYS)	CYCLE	(EA)	COMMENTS
PROJECT	153	18	2754	16	2448	8	1224	-	-	
UNDISTRIBUTED		46	52		52	1	5		5	
<b>TOTALS</b>		<b>2,800</b>	<b>2,500</b>		<b>1,276</b>		<b>5</b>		<b>5</b>	

LOCATION	(LF)	COMMENTS
STA 12+35 TO STA 14+35	50	CENTERLINE
UNDISTRIBUTED	-	-
<b>TOTALS</b>	<b>50</b>	

LOCATION	(EA)	(LF)	(LF)	(LS)	(LF)	(LF)	COMMENTS
PROJECT	18	117	117	1	1	234	
UNDISTRIBUTED	-	13	13	-	-	26	
<b>TOTALS</b>	<b>18</b>	<b>130</b>	<b>130</b>	<b>1</b>	<b>1</b>	<b>260</b>	

LOCATION	(EA)	(LF)	COMMENTS
WATER, EAST ABUTMENT	1		LOCATE
SEWER, EA STA ABUTMENT	1		UTILITY
WATER, WEST ABUTMENT	1		LINE
SEWER, WEST ABUTMENT	1		(EACH)
<b>TOTALS</b>	<b>4</b>		

LOCATION	(LF)	(EA)	(EA)	(LUMP)	COMMENTS
STA 12+65 to STA 12+83	19	-	-	-	Redirect existing wires to new pull box
STA 12+74 to STA 12+83	-	1	12	1	
STA 12+74 to STA 12+83	8	-	24	-	
STA 12+83	-	1	48	-	
STA 12+83 to STA 13+46	6	-	222	-	See Structure plans for additional quantities
S/A 13+46	-	1	48	-	
STA 13+46 to STA 14+50	79	-	237	-	
S/A 14+50	-	1	48	-	
STA 13+46 to STA 14+28	3	-	9	-	
UNDISTRIBUTED	5	-	27	-	
<b>TOTALS</b>	<b>120</b>	<b>3</b>	<b>675</b>	<b>1</b>	

LOCATION	(LF)	(LF)	COMMENTS
PROJECT	80	10	
UNDISTRIBUTED	5	5	
<b>TOTALS</b>	<b>85</b>	<b>15</b>	

Addendum No. 01  
ID 2987-00-70  
Revised Sheet 14  
April 1, 2016

ALL ITEMS CATEGORY 010 UNLESS OTHERWISE NOTED

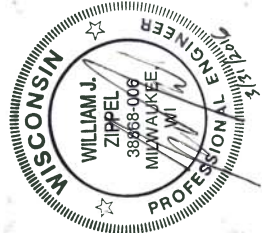
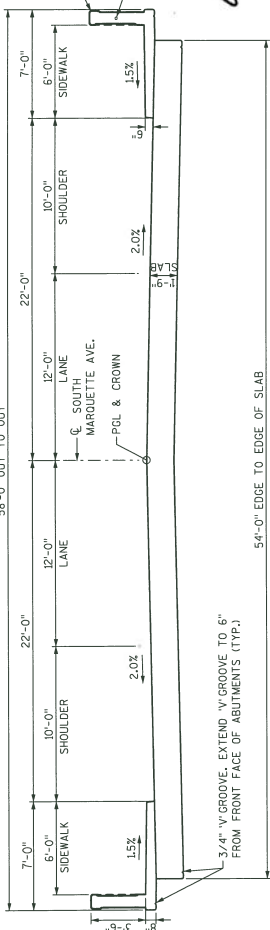

*William C. Decker*  
SDR  
04/01/16

**BRIDGE CROSS SECTION**

1. DRAWINGS SHALL NOT BE SCALED.
2. BAR STEEL REINFORCEMENT SHALL BE EMBEDDED 2' CLEAR UNLESS OTHERWISE SHOWN OR NOTED.
3. SLAB FALSING SHALL BE SUPPORTED ON PILES OR THE SUBSTRUCTURE UNLESS AN ALTERNATE METHOD IS APPROVED BY THE ENGINEER.
4. THE FIRST OR FIRST TWO DIGITS OF THE BAR MARK SIGNIFIES THE BAR SIZE.
5. THE SLOPE OF THE FILL IN FRONT OF THE ABUTMENTS SHALL BE COVERED WITH HEAVY RIPRAP AND GEOTEXTILE FABRIC TYPE 'HR' TO THE EXTENT SHOWN ON SHEET 1 AND IN THE ABUTMENT DETAILS.
6. THE UPPER LIMITS OF EXCAVATION FOR STRUCTURES FOR THE ABUTMENTS SHALL BE THE BOTTOM OF SLOPE PROTECTION.
7. AT THE BACKFACE OF ABUTMENT ALL VOLUME WHICH CANNOT BE PLACED IN PLACE SHALL BE BACKFILLED WITH HEAVY RIPRAP AND GEOTEXTILE FABRIC TYPE 'HR' TO THE EXTENT SHOWN ON SHEET 1 AND IN THE ABUTMENT DETAILS.
8. PROTECTIVE SURFACE TREATMENT TO BE APPLIED TO THE ENTIRE TOP OF DECK AND THE FRONT FACE AND TOP OF THE SIDEWALKS AND PARAPETS.
9. THE QUANTITY FOR BACKFILL STRUCTURE, BID ITEM 200.0000, IS CALCULATED BASED ON THE APPLICABLE FIGURES 12.6-1 AND 12.6-2 IN THE WISCONSIN DEPARTMENT OF TRANSPORTATION BRIDGE MANUAL.

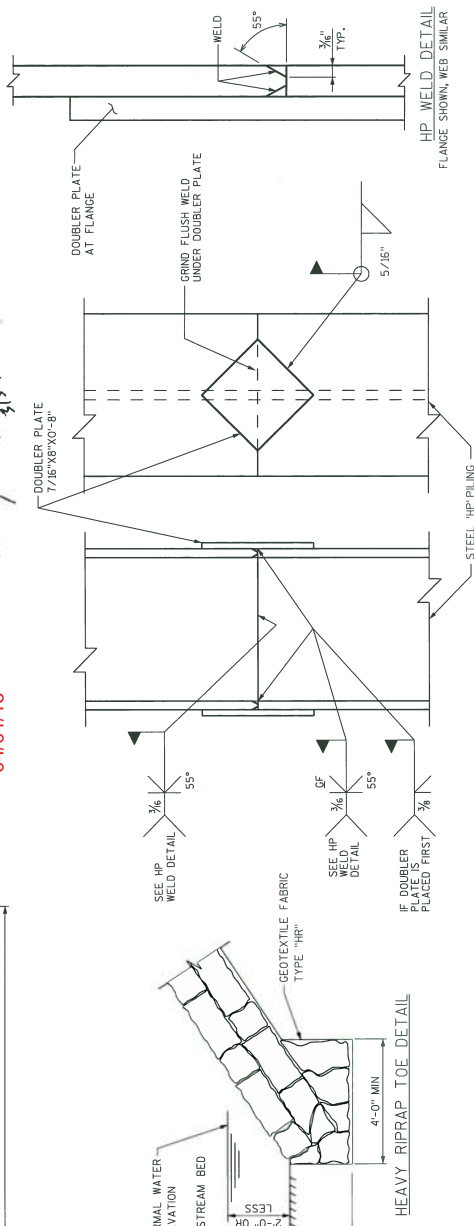

Addendum No. 01  
ID 2987-00-70  
Revised Sheet 47  
April 1, 2016

**TOTAL ESTIMATE OF QUANTITIES**

BID NO.	BID ITEMS	UNIT	W ABUT	E ABUT	SUPER	TOTAL
203.0600.5	REMOVING OLD STRUCTURE OVER WATERWAY WITH MINIMAL DEBRIS ( STATION 13+01.89)	LS				1
206.1000	EXCAVATION FOR STRUCTURES BRIDGES (B-40-919)	LS				1
210.0100	BACKFILL STRUCTURE	CY	59	59		118
502.0100	CONCRETE MASONRY BRIDGES	CY	44	44		88
502.3200	PROTECTIVE SURFACE TREATMENT	SY	3660	3660		7320
505.0400	BAR STEEL REINFORCEMENT FOR STRUCTURES	LB	1760	1760		3520
516.0500	RUBBERIZED MEMBRANE WATERPROOFING	SY	13	13		26
517.0500.5	ARCHITECTURAL SURFACE TREATMENT (B-40-919)	SY	42	42		84
550.0000	PRE-BORING UNCONSOLIDATED MATERIALS	LF	24	24		48
550.1120	PILING STEEL HP 12-INCH X 53 LB	LF	495	495		990
606.0300	RRAP-HEAVY	CY	35	35		70
612.0406	PIPE UNDERDRAIN WRAPPED 6-INCH	LF	94	94		188
645.0120	GEOTEXTILE FABRIC TYPE HR	SY	50	50		100
652.0125	CONDUIT RIGID METALLIC SCHEDULE 40 2-INCH	LF	26	26		52
652.0225	CONDUIT RIGID METALLIC SCHEDULE 40 2-INCH	LF	50	50		100
853.0208	JUNCTION BOXES 8X8X8-INCH	EACH			2	2
	NAME PLATE					
	JOINT FILLER - 1/2" x 1/2"					
	NON-BITUMINOUS JOINT SEALER					
	NON-BID ITEMS					

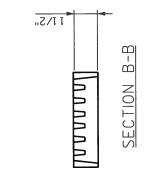

\* NOTE: DIMENSIONS ARE APPROXIMATE. THE GRATE IS SIZED TO FIT INTO A PIPE COUPLING. RODENT SHIELD SO SLOTS ARE VERTICAL. THE RODENT SHIELD SHALL BE A PVC GRATE SIMILAR TO THIS DETAIL. THE GRATE IS COMMERCIALY AVAILABLE AS A FLOOR STRAINER. A PIPE COUPLING IS REQUIRED FOR THE ATTACHMENT OF THE SHIELD TO THE EXPOSED END OF THE PIPE UNDERDRAIN. THE SHIELD SHALL BE FASTENED TO THE PIPE COUPLING WITH TWO OR MORE NO. 10 X 1-INCH STAINLESS STEEL SHEET METAL SCREWS.

THE RODENT SHIELD, PIPE COUPLING, AND SCREWS SHALL BE CONSIDERED INCIDENTAL TO THE BID ITEM "PIPE-UNDERDRAIN WRAPPED 6-INCH".

**RODENT SHIELD**

NO.	DATE	REVISION	BY
3/23/2016		ADD PREBORING PAY ITEM	WJZ

STRUCTURE B-40-919  
DRAWN BY: WJZ  
CHECKED BY: WJZ

MISC. DETAILS & GENERAL NOTES  
SHEET 3 OF 8

## SCHEDULE OF ITEMS

REVISED:

CONTRACT:  
20160412009PROJECT(S):  
2673-00-70  
2987-00-70FEDERAL ID(S):  
WISC 2016092  
WISC 2016095

CONTRACTOR : \_\_\_\_\_

LINE NO	ITEM DESCRIPTION	APPROX. QUANTITY AND UNITS	UNIT PRICE		BID AMOUNT	
			DOLLARS	CTS	DOLLARS	CTS
0620	630.0120 Seeding Mixture No. 20	20.000 LB	.		.	
0630	630.0140 Seeding Mixture No. 40	10.000 LB	.		.	
0640	630.0200 Seeding Temporary	20.000 LB	.		.	
0650	634.0612 Posts Wood 4x6-Inch X 12-FT	8.000 EACH	.		.	
0660	637.2210 Signs Type II Reflective H	24.000 SF	.		.	
0670	642.5001 Field Office Type B	1.000 EACH	.		.	
0680	643.0100 Traffic Control (project) 01. 2987-00-70	1.000 EACH	.		.	
0690	643.0100 Traffic Control (project) 02. 2673-00-70	1.000 EACH	.		.	
0710	643.0705 Traffic Control Warning Lights Type A	6,400.000 DAY	.		.	
0720	643.0900 Traffic Control Signs	3,236.000 DAY	.		.	

SCHEDULE OF ITEMS

REVISED:

CONTRACT:  
20160412009

PROJECT(S):  
2673-00-70  
2987-00-70

FEDERAL ID(S):  
WISC 2016092  
WISC 2016095

CONTRACTOR : \_\_\_\_\_

LINE NO	ITEM DESCRIPTION	APPROX. QUANTITY AND UNITS	UNIT PRICE		BID AMOUNT	
			DOLLARS	CTS	DOLLARS	CTS
1040	SPV.0180 Special 01. Geotextile Fabric Type FF	64.000 SY	.		.	
1050	SPV.0195 Special 01. Excav Haul & Disposal of VOC Contam Soil & Dewatering of VOC Contam Water	680.000 TON	.		.	
1060	550.0010 Pre-Boring Unconsolidated Materials	48.000 LF	.		.	
1070	643.0420 Traffic Control Barricades Type III	7,200.000 DAY	.		.	
	SECTION 0001 TOTAL				.	
	TOTAL BID				.	