



Wisconsin Department of Transportation

December 6, 2016

Division of Transportation Systems Development

Bureau of Project Development
 4802 Sheboygan Avenue, Rm 601
 P O Box 7916
 Madison, WI 53707-7916

Telephone: (608) 266-1631
 Facsimile (FAX): (608) 266-8459

NOTICE TO ALL CONTRACTORS:

Proposal #25: 4190-16-71, WISC 2016 485
Ashland Ave., De Pere & Ashwaubenon
8th Street – Lombardi Avenue
STH 32
Brown County

4190-16-72, WISC 2016 486
Ashland Ave., De Pere & Ashwaubenon
8th Street – Lombardi Avenue
STH 32
Brown County

Letting of December 13, 2016

This is Addendum No. 01, which provides for the following:

Schedule of Items

Revised Bid Item Quantities					
Bid Item	Item Description	Unit	Old Quantity	Revised Quantity	Proposal Total
205.0100	Common Excavation	CY	2,446	904	3,350
208.0100	Borrow	CY	321	547	868
305.0120	Base Aggregate 1 ¼-Inch	TON	3,191	320	3,511
455.0605	Tack Coat	GAL	8,068	67	8,135
460.4110.S	Reheating HMA Pavement Longitudinal Joint	LF	134,041	1,200	135,241
460.6223	HMA Pavement Lower Layer 3 MT 58-28S	TON	18,995	202	19,197
460.6424	HMA Pavement Upper Layer 4 MT 58-28H	TON	12,269	108	12,377
625.0500	Salvaged Topsoil	SY	2,805	680	3,485
628.1504	Silt Fence	LF	5,300	610	5,910
628.1520	Silt Fence Maintenance	LF	5,300	610	5,910
628.2002	Erosion Mat Class I Type A	SY	1,165	680	1,845
629.0210	Fertilizer Type B	CWT	1.9	0.40	2.3
630.0140	Seeding Mixture No. 40	LB	50	13	63
630.0200	Seeding Temporary	LB	76	18	94
637.2230	Signs Type II Reflective Type F	SF	459.54	59.68	519.22
638.2602	Removing Signs Type II	EACH	232	13	235
638.3000	Removing Small Sign Supports	EACH	186	-1	185
690.0150	Sawing Asphalt	LF	4,067	616	4,683

Plan Sheets

Revised Plan Sheets	
Plan Sheet	Plan Sheet Title (brief description of changes to sheet)
21	Erosion Control Plan – added erosion control for right turn lane extension
32	Permanent Signing – revised signing plan
34	Permanent Signing – revised signing plan
36	Permanent Signing – revised signing plan
38	Permanent Signing – revised signing plan
39	Permanent Signing – revised signing plan
88	Miscellaneous Quantities – revised earthwork quantities
89	Miscellaneous Quantities – revised base aggregate quantities
91	Miscellaneous Quantities – revised asphaltic material quantities
92	Miscellaneous Quantities – revised asphaltic material quantities
94	Miscellaneous Quantities – revised erosion control and landscaping quantities
105	Miscellaneous Quantities – revised permanent signing quantities
107	Miscellaneous Quantities – revised permanent signing quantities
108	Miscellaneous Quantities – revised permanent signing quantities
109	Miscellaneous Quantities – revised permanent signing quantities
110	Miscellaneous Quantities – revised permanent signing quantities
140	Miscellaneous Quantities – revised sawing quantities
331	Earthwork Data – revised earthwork data
332	Earthwork Data – revised earthwork data
333	Earthwork Data – revised earthwork data

Added Plan Sheets	
Plan Sheet	Plan Sheet Title (brief description of why sheet was added)
7A	Typical Sections – added typical section for lengthened right turn lane
11A	STH 32 and Parkview Road Right Turn Lane – added sheet for right turn lane
251A	Permanent Signing – added no train horn sign detail
334A - 334H	Cross Sections: Added STH 32 and Parkview Road Right Turn Lane

Schedule of Items

Attached, dated December 7, 2016, are the revised Schedule of Items Pages 1 – 3, 6, 7, and 13.

Plan Sheets

The following 8½ x 11-inch sheets are attached and made part of the plans for this proposal:

Revised: 21, 32, 34, 36, 38, 39, 88, 89, 91, 92, 94, 105, 107 - 110, 140, and 331 - 333

Added: 7A, 11A, 251A, and 334A – 334H

The responsibility for notifying potential subcontractors and suppliers of these changes remains with the prime contractor.

Sincerely,

Mike Coleman

Proposal Development Specialist
Proposal Management Section

END OF ADDENDUM

STH 32 NB R

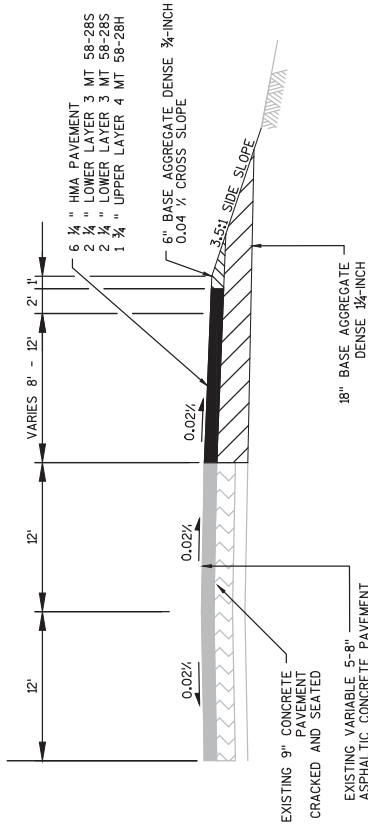

PROPOSED TYPICAL SECTION STH 32 NORTHBOUND RIGHT TURN LANE

STA 38+01NB TO STA 39+51NB

STH 32 NB R

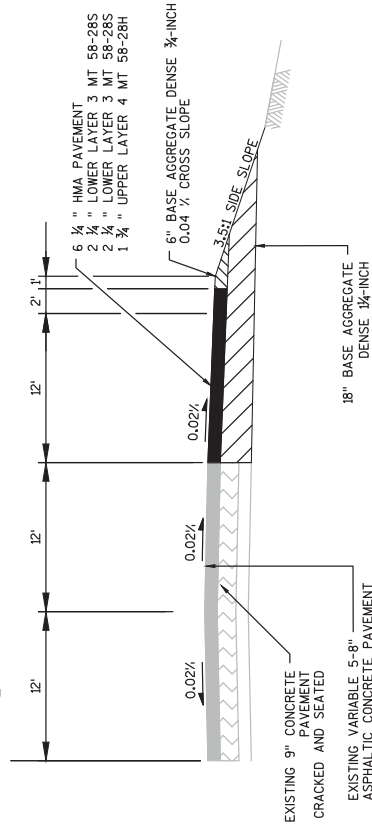

PROPOSED TYPICAL SECTION STH 32 NORTHBOUND RIGHT TURN LANE

STA 39+51NB TO STA 44+01NB

Addendum No. 01
ID 4190-16-71
Added Sheet 7A
December 7, 2016

Addendum No. 01
 ID 4190-16-71
 Added Sheet 11A
 December 7, 2016

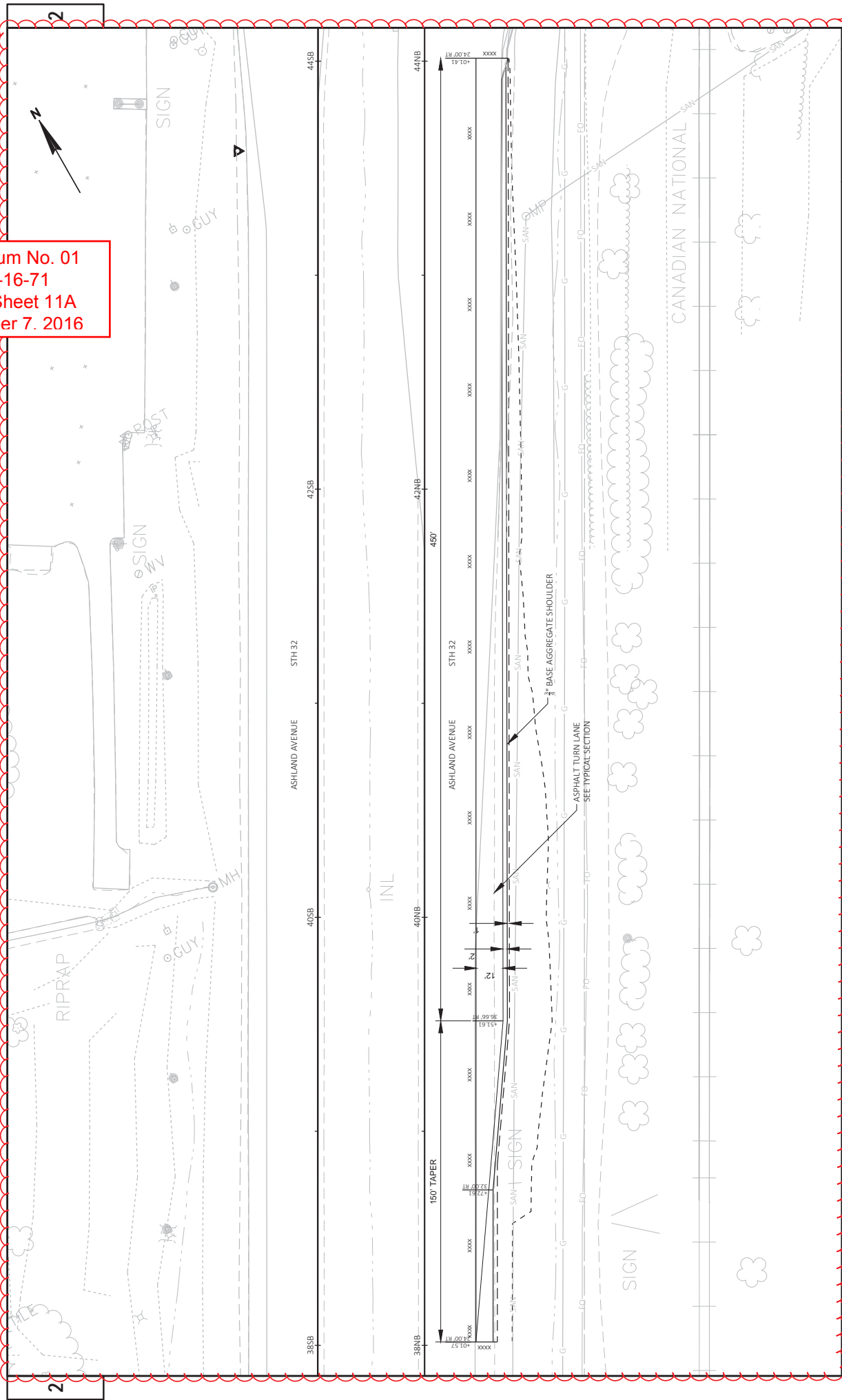

Addendum No. 01
 ID 4190-16-71
 Revised Sheet 21
 December 7, 2016

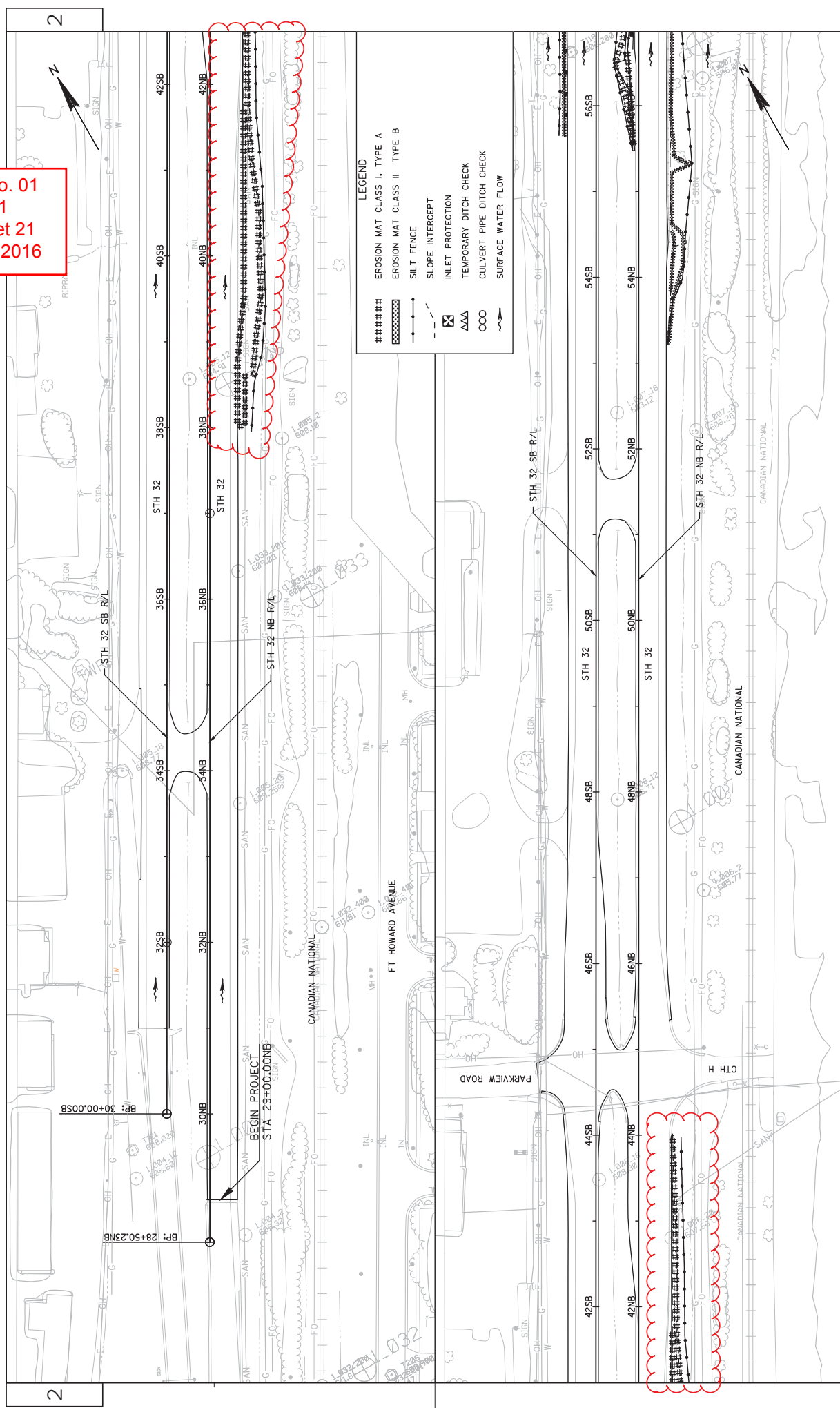

Addendum No. 01
 ID 4190-16-71
 Revised Sheet 32
 December 7, 2016

SIGNING NOTES

WHEN AN EXISTING STOP SIGN AND SUPPORT IS TO BE REMOVED AND A NEW STOP SIGN AND SUPPORT ERRECTED THE WORK SHALL BE DONE CONCURRENTLY. FOR OTHER SIGNS AND SUPPORTS THAT ARE TO BE ERRECTED THE WORK SHALL BE DONE CONCURRENTLY WITH THE STOP SIGN AND SUPPORT. THE ERRECTION OF THE NEW SIGN/SUPPORT SHOULD BE DONE AS CONCURRENTLY AS POSSIBLE. IN NO CASE SHALL A NEW SIGN/SUPPORT BE DOWN FOR MORE THAN 24 HOURS AND THERE SHALL NOT BE MORE THAN ONE SIGN OF THE SAME LEGEND MISSING IN A ROW.

WOOD POSTS SIZES, FOR TYPE II SIGNING, ARE ESTIMATED LENGTHS AND THE ACTUAL LENGTH WILL BE DETERMINED IN THE FIELD. PLACED UNDER STAGE * SHALL HAVE A MINIMUM OF 6'10" OF CLEARANCE ABOVE THE ROADWAY. THIS WILL ALLOW FOR THE PLACEMENT OF FUTURE SIGNS BENEATH THE STOP SIGN.

THE NUMBER OF "NO PASSING ZONE" SIGNS (W-14-3) ARE ESTIMATED AND THE ACTUAL NUMBER WILL BE DETERMINED AFTER THE ROADWAYS HAVE BEEN SPOTTED.

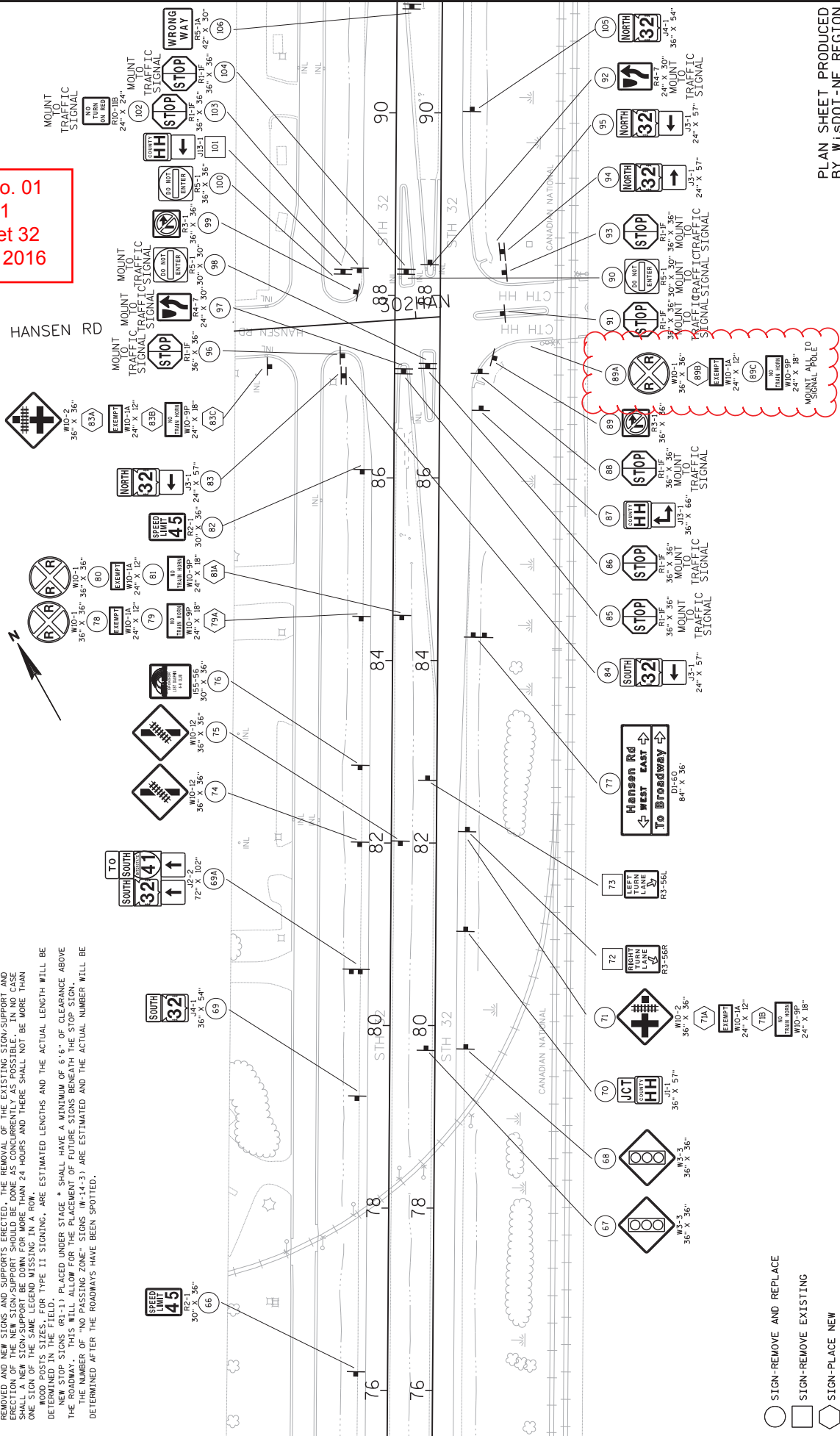

- SIGN-REMOVE AND REPLACE
- SIGN-REMOVE EXISTING
- SIGN-PLACE NEW

PROJECT NO: 4190-16-71 FILE NAME : N:\sdp\Traffic\SIGNING\Projects\4190-16-71 STH 32 Ashland Ave\02205_ds.dgn	COUNTY: BROWN PERMANENT SIGNING PLOT BY : doters PLOT DATE : 30-NOV-2016 15:22	HWY: STH 32 SIGNING PLOT NAME : PLOT SCALE : 100:1	SHEET 32 E WISDOT/CADDS SHEET 42
--	---	---	--

Addendum No. 01
 ID 4190-16-71
 Revised Sheet 34
 December 7, 2016

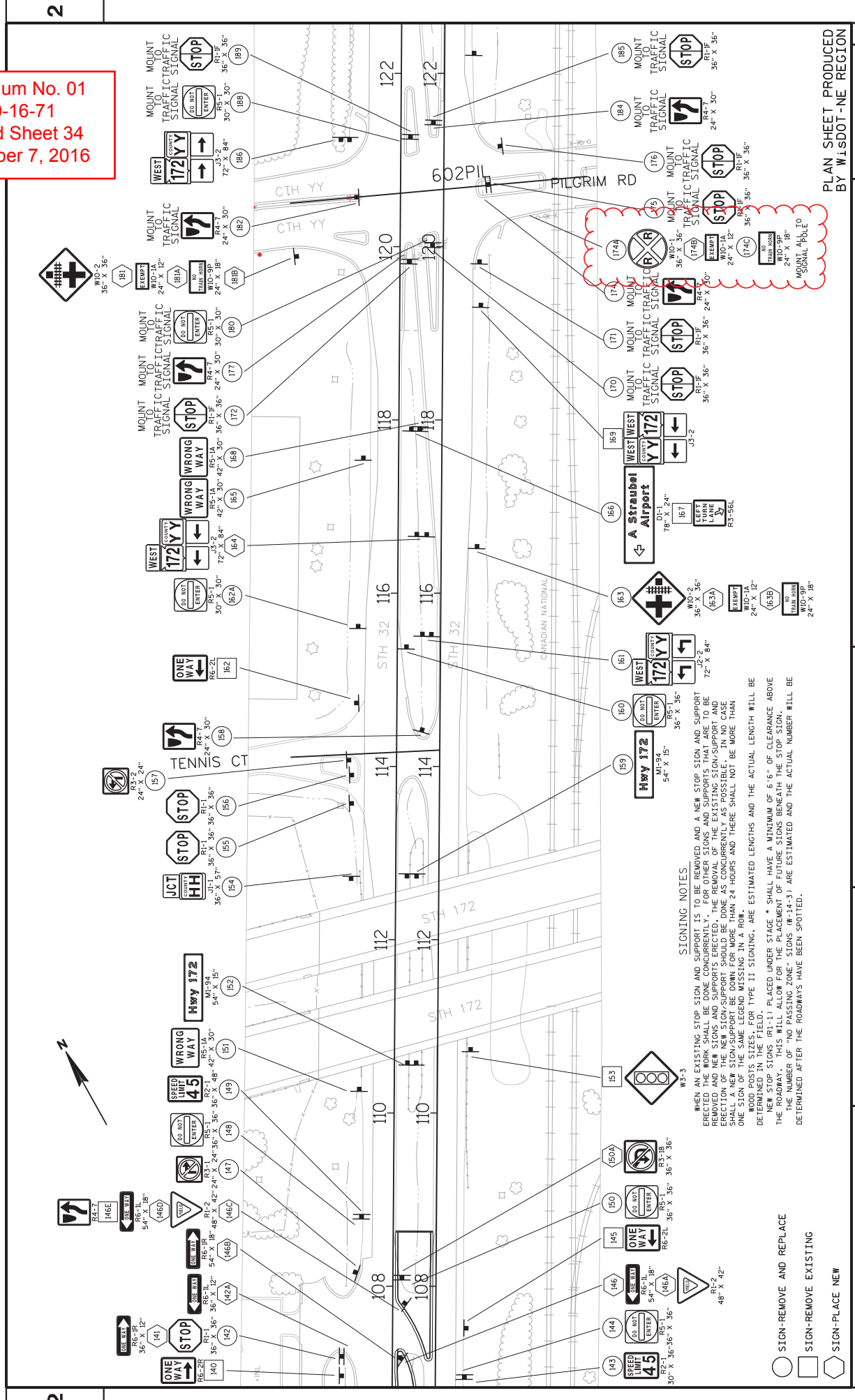

SIGNING NOTES

WHEN AN EXISTING STOP SIGN AND SUPPORT IS TO BE REMOVED AND A NEW STOP SIGN AND SUPPORT ERRECTED THE WORK SHALL BE DONE CONCURRENTLY FOR OTHER SIGNS AND SUPPORTS THAT ARE TO BE REMOVED AND NEW SIGNS AND SUPPORTS ERRECTED. THE REMOVAL OF THE EXISTING SIGN/SUPPORT AND ERECTION OF THE NEW SIGN/SUPPORT SHOULD BE DONE AS CONCURRENTLY AS POSSIBLE. IN NO CASE SHALL A NEW SIGN/SUPPORT BE DOWN FOR MORE THAN 24 HOURS AND THERE SHALL NOT BE MORE THAN ONE SIGN/SUPPORT ON THE ROADWAY AT ANY ONE TIME.

WOOD POSTS SIZES FOR TYPE 11 SIGNING, ARE ESTIMATED LENGTHS AND THE ACTUAL LENGTH WILL BE DETERMINED IN THE FIELD.

NEW STOP SIGNS (R1-1) SHALL HAVE A MINIMUM OF 6'6" OF CLEARANCE ABOVE THE ROADWAY. THIS WILL ALLOW FOR THE PLACEMENT OF FUTURE SIGNS BENEATH THE STOP SIGN. THE NUMBER OF "NO PASSING ZONE" SIGNS (W-14-3) ARE ESTIMATED AND THE ACTUAL NUMBER WILL BE DETERMINED AFTER THE ROADWAYS HAVE BEEN SPOTTED.

- SIGN-REMOVE AND REPLACE
- SIGN-REMOVE EXISTING
- ◇ SIGN-PLACE NEW

Addendum No. 01
ID 4190-16-71
Revised Sheet 36
December 7, 2016

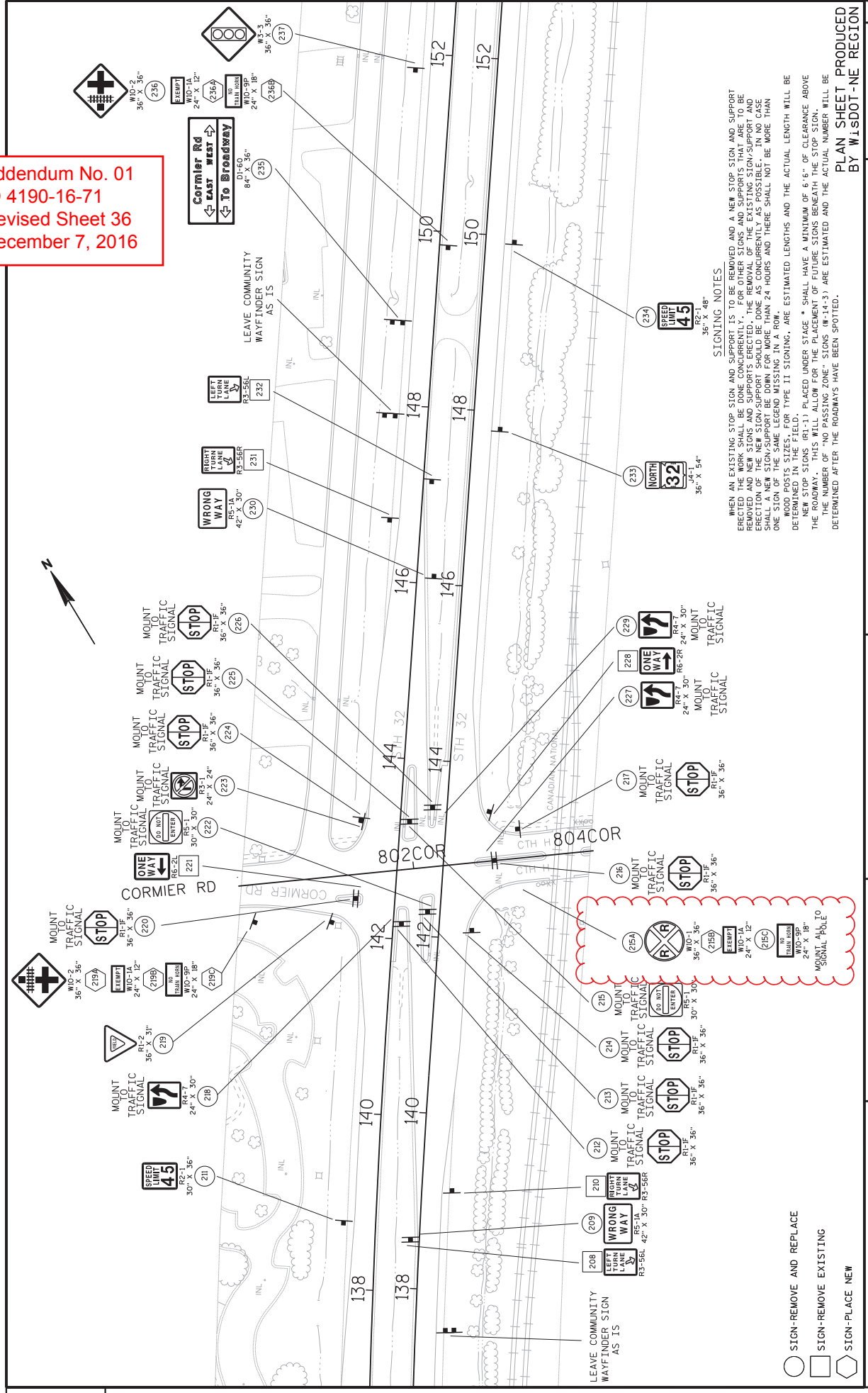

SIGNING NOTES:

WHEN AN EXISTING STOP SIGN AND SUPPORT IS TO BE REMOVED AND A NEW STOP SIGN AND SUPPORT IS TO BE ERRECTED, THE EXISTING SIGN AND SUPPORT SHALL BE REMOVED AND NEW SIGNS AND SUPPORTS ERRECTED. THE REMOVAL OF THE EXISTING SIGN/SUPPORT AND ERRECTON OF THE NEW SIGN/SUPPORT SHOULD BE DONE AS CONCURRENTLY AS POSSIBLE. IN NO CASE SHALL A NEW SIGN/SUPPORT BE DOWN FOR MORE THAN 24 HOURS AND THERE SHALL NOT BE MORE THAN ONE SIGN OFF THE SAME LEGEND MISSING IN A ROW.

WHEN A SIGN OR SIGN SUPPORT OF TYPE II SIGNING, ARE ESTIMATED LENGTHS AND THE ACTUAL LENGTH WILL BE DETERMINED IN THE FIELD.

NEW STOP SIGNS (R1-1) PLACED UNDER STAGE * SHALL HAVE A MINIMUM OF 6'6" OF CLEARANCE ABOVE THE ROADWAY. THIS WILL ALLOW FOR THE PLACEMENT OF FUTURE SIGNS BENEATH THE STOP SIGN.

THE NUMBER OF "NO PASSING ZONE" SIGNS (W-14-3) ARE ESTIMATED AND THE ACTUAL NUMBER WILL BE DETERMINED AFTER THE ROADWAYS HAVE BEEN SPOTTED.

- SIGN-REMOVE AND REPLACE
- SIGN-REMOVE EXISTING
- ◇ SIGN-PLACE NEW

Addendum No. 01
 ID 4190-16-71
 Revised Sheet 38
 December 7, 2016

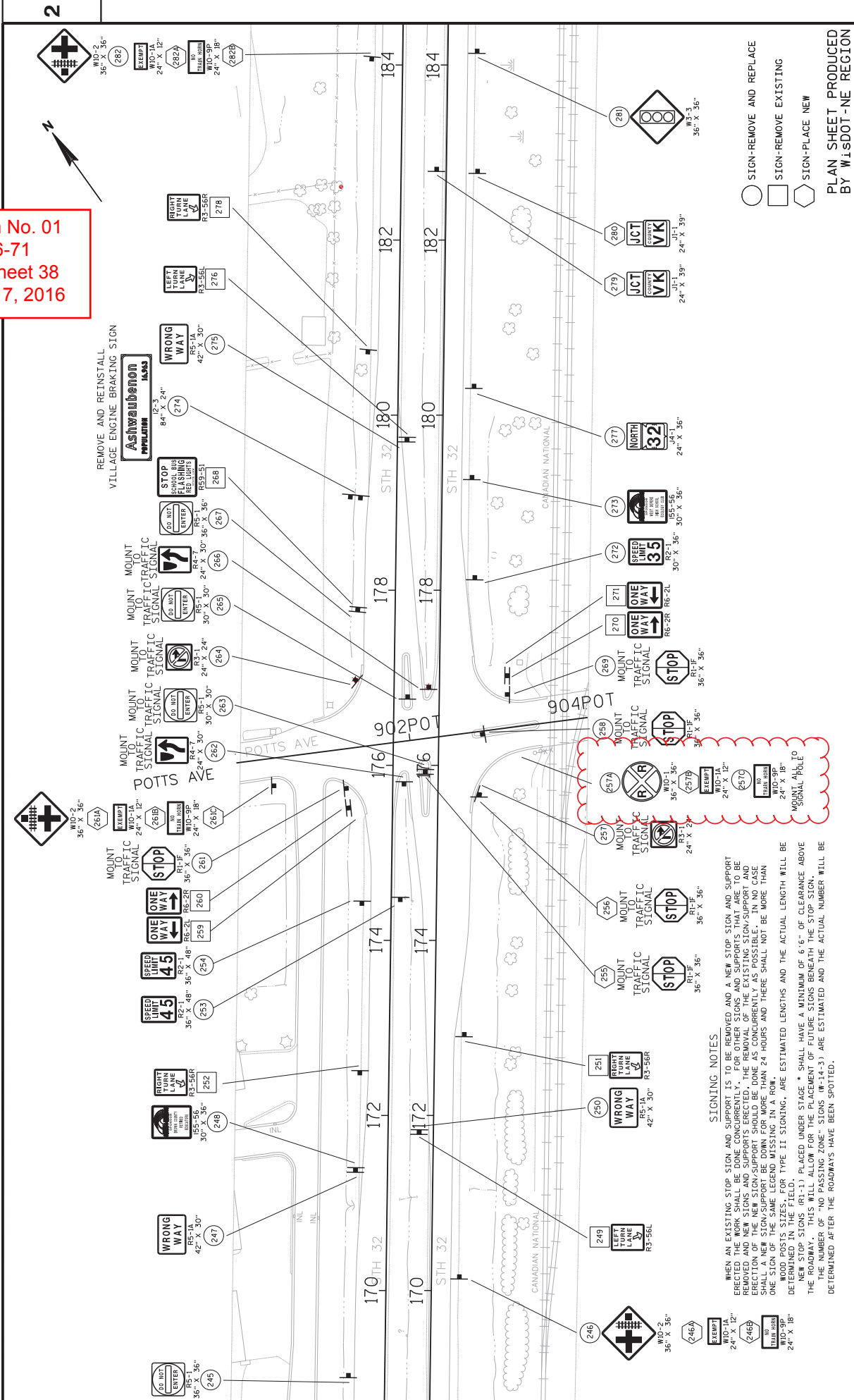

SIGNING NOTES

WHEN AN EXISTING STOP SIGN AND SUPPORT IS TO BE REMOVED AND A NEW STOP SIGN AND SUPPORT ERRECTED THE WORK SHALL BE DONE CONCURRENTLY. FOR OTHER SIGNS AND SUPPORTS THAT ARE TO BE ERRECTED THE WORK SHALL BE DONE CONCURRENTLY WITH THE STOP SIGN AND SUPPORT. THE ERRECTION OF THE NEW SIGN/SUPPORT SHOULD BE DONE AS CONCURRENTLY AS POSSIBLE IN NO CASE SHALL A NEW SIGN/SUPPORT BE DOWN FOR MORE THAN 24 HOURS AND THERE SHALL NOT BE MORE THAN ONE SIGN OF THE SAME LEGEND MISSING IN A ROW.

WOOD POSTS SIZES, FOR TYPE II SIGNING, ARE ESTIMATED LENGTHS AND THE ACTUAL LENGTH WILL BE DETERMINED IN THE FIELD. PLACED UNDER STAGE * SHALL HAVE A MINIMUM OF 6.15' OF CLEARANCE ABOVE THE ROADWAY. THIS WILL ALLOW FOR THE PLACEMENT OF FUTURE SIGNS BENEATH THE STOP SIGN.

THE NUMBER OF "NO PASSING ZONE" SIGNS (W-14-3) ARE ESTIMATED AND THE ACTUAL NUMBER WILL BE DETERMINED AFTER THE ROADWAYS HAVE BEEN SPOTTED.

- SIGN-REMOVE AND REPLACE
- SIGN-REMOVE EXISTING
- ◡ SIGN-PLACE NEW

PLAN SHEET PRODUCED BY WISDOT-NE REGION



Addendum No. 01
 ID 4190-16-71
 Revised Sheet 39
 December 7, 2016

SIGNING NOTES

WHEN AN EXISTING STOP SIGN AND SUPPORT IS TO BE REMOVED AND A NEW STOP SIGN AND SUPPORT ERRECTED THE WORK SHALL BE DONE CONCURRENTLY. FOR OTHER SIGNS AND SUPPORTS THAT ARE TO BE REMOVED AND NEW SIGNS AND SUPPORTS ERRECTED, THE REMOVAL OF THE EXISTING SIGN-SUPPORT AND ERRECTION OF THE NEW SIGN-SUPPORT SHOULD BE DONE AS CONCURRENTLY AS POSSIBLE. IN NO CASE SHALL THE NEW SIGN-SUPPORT BE ERRECTED MORE THAN 24 HOURS AND THERE SHALL NOT BE MORE THAN ONE SIGN OF THE SAME LEGEND MISSING IN A ROW.

WOOD POSTS SIZES, FOR TYPE II SIGNING, ARE ESTIMATED LENGTHS AND THE ACTUAL LENGTH WILL BE DETERMINED IN THE FIELD.

NEW STOP SIGNS (R1-1) PLACED UNDER STAGE 2 SHALL HAVE A MINIMUM OF 6'-6" OF CLEARANCE ABOVE THE ROADWAY. THIS WILL ALLOW FOR THE PLACEMENT OF FUTURE SIGNS BENEATH THE STOP SIGN. THE NUMBER OF TWO PASSING ZONE SIGNS (W14-3) ARE ESTIMATED AND THE ACTUAL NUMBER WILL BE DETERMINED AFTER THE ROADWAYS HAVE BEEN SPOTTED.

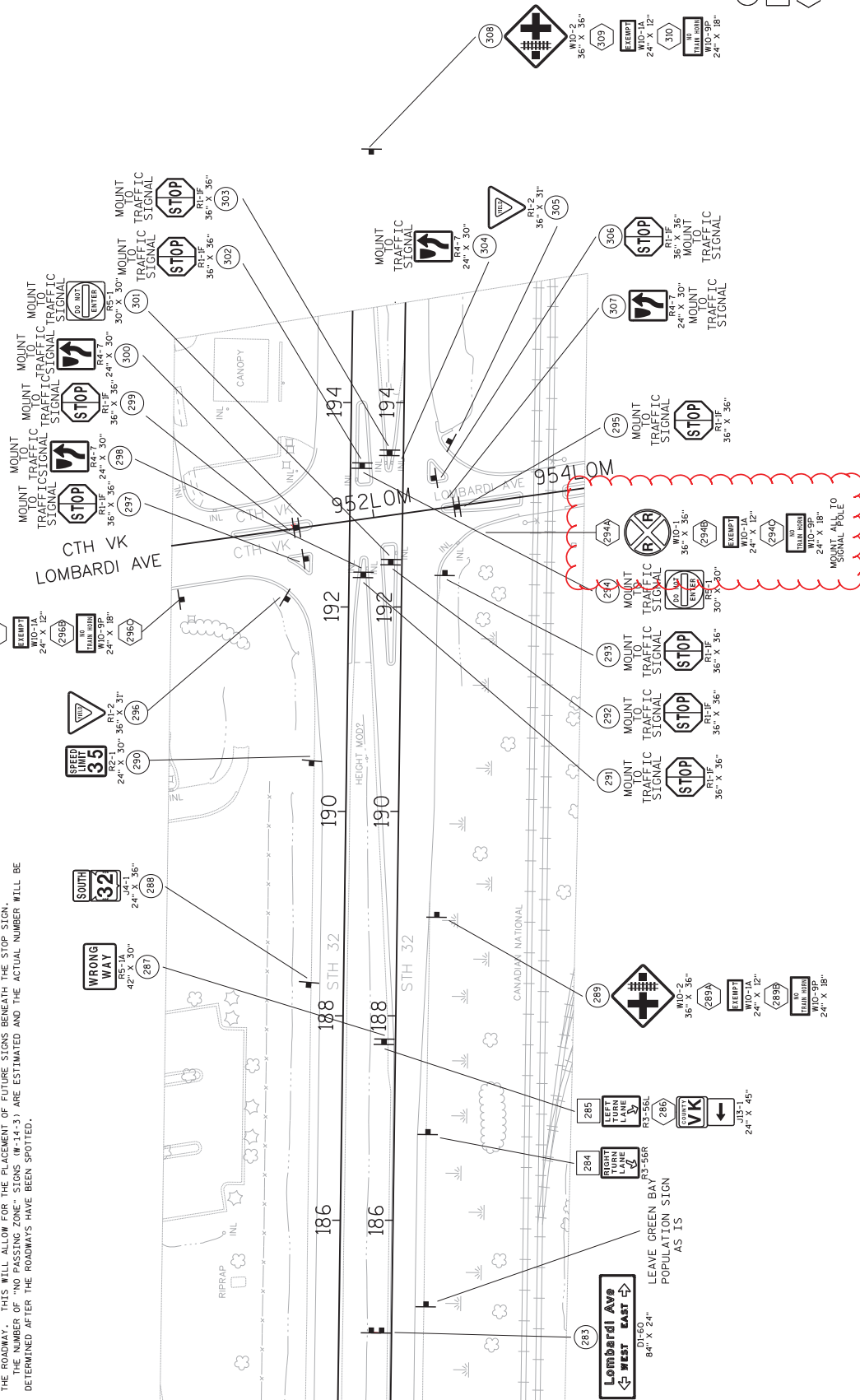

- SIGN-REMOVE AND REPLACE
- SIGN-REMOVE EXISTING
- ◡ SIGN-PLACE NEW

PLAN SHEET PRODUCED BY WISDOT-NE REGION

SHEET 39

PERMANENT SIGNING

COUNTY: BROWN

HWY: STH 32

PROJECT NO: 4190-16-71

FILE NAME : N:\sdp\Traffic\SIGNING\Projects\4190-16-71 STH 32 Ashland Ave\02212.ps.dgn

PLOT DATE : 30-NOV-2016 15:22

PLOT BY : dotets

PLOT SCALE : 100:1

WISDOT/CADDS SHEET 42

Division	From/To Station	Location	Common Excavation (Item # 205.0100)		Salvaged/Unusable Pavement Material (4)	Available Material (5)	Unexpanded Fill	Expanded Fill (13)		Mass Ordinate +/- (14)	Waste	Borrow	Comment:
			Cut (2)	EBS Excavation (3)				Factor	Factor 1.25				
Division 1													
NB Bridge	53+21 - 61+62	STH 32	130	0	0	130	300	373	-243	0	243		
SB Bridge	55+63 - 63+15	STH 32	206	0	0	206	308	385	-179	0	179		
Outfall Channel W. Ditch	61+03 - 61+55	STH 32	60	0	60	0	100	125	-125	0	125		Remove stone and misc materials
Division 1 Subtotal			396	0	60	336	708	883	-547	0	547		
Division 2													
Railroad NB and SB	77+25 - 79+50	STH 32	1,342	0	433	909	0	0	909	909	0		
Division 2 Subtotal			1,342	0	433	909	0	0	909	909	0		
Division 3													
Left Turn Lane	102+71 - 108+60	STH 32	1,044	0	183	861	946	1,182	-321	0	321		
Division 3 Subtotal			1,044	0	183	861	946	1,182	-321	0	321		
Division 4													
Right Turn Lane Parkview	38+01 - 44+01	STH 32	568	0	62	506	84	105	401	401	0		
Division 4 Subtotal			568	0	62	506	84	105	401	401	0		
Grand Total			3,350	0	738	2,612	1,738	2,170	442	1,310	868		
Total Common Excavation			3,350	0	738	2,612	1,738	2,170	442	1,310	868		

Addendum No. 01
ID 4190-16-71
Revised Sheet 88
December 7, 2016

- 1) Common Excavation is the sum of the Cut and EBS Excavation columns. Item number 205.0100
 - 2) Salvaged/Unusable Pavement Material is included in Cut.
 - 4) Salvaged/Unusable Pavement Material
 - 5) Available Material = Cut - Salvaged/Unusable Pavement Material
 - 13) Expanded Fill Factor = 1.25
- Depending on selections:
- Expanded Fill = (Unexpanded Fill - Rock * Rock Factor - Reduced Marsh - Reduced EBS) * Fill Factor**
 Expanded Fill = (Unexpanded Fill - Rock * Rock Factor - Reduced EBS) * Fill Factor
 Expanded Fill = (Unexpanded Fill - Rock * Rock Factor - Reduced Marsh) * Fill Factor
 Expanded Fill = (Unexpanded Fill - Rock * Rock Factor) * Fill Factor
- 14) The Mass Ordinate + or - Qty calculated for the Division. Plus quantity indicates an excess of material within the Division. Minus indicates a shortage of material within the Division.

Addendum No. 01
 ID 4190-16-71
 Revised Sheet 89
 December 7, 2016

BASE_AGGREGATE_DENSE

STATION	TO	STATION	LOCATION	305.0110 BASE AGGREGATE DENSE 3/4-1 INCH TON	305.0120 BASE AGGREGATE DENSE 1 1/4-1 INCH TON	305.0500 SHAPING SHOULDERS STA	312.0110 SELECT CRUSHED MATERIAL TON	REMARKS
CATEGORY 0010								
NORTHBOUND								
28+97 NB	-	46+00 NB	STH 32	54	--	34	--	BEGINNING OF PROJECT TO PARKVIEW ROAD
38+01 NB	-	44+01 NB	STH 32	--	320	--	--	RIGHT TURN LANE EXTENSION TO PARKVIEW ROAD
46+00 NB	-	59+25 NB	STH 32	42	--	27	--	PARKVIEW ROAD TO SOUTH EDGE OF NEW BRIDGE DECK
58+49 NB	-	59+55 NB	STH 32	1	174	--	--	SHOULDER W/DENING NB SE QUADRANT
59+25 NB	-	59+55 NB	STH 32	1	26	--	--	SHOULDER W/DENING NB SW QUADRANT
60+85 NB	-	61+63 NB	STH 32	1	114	--	--	SHOULDER W/DENING NB NW QUADRANT
60+85 NB	-	61+42 NB	STH 32	1	88	--	--	SHOULDER W/DENING NB NE QUADRANT
61+42 NB	-	78+00 NB	STH 32	52	--	33	--	NORTH EDGE OF NEW BRIDGE DECK TO SOUTH RAILROAD CROSSING APPROACH
78+00 NB	-	79+50 NB	STH 32	5	200	3	580	RAILROAD CROSSING
79+50 NB	-	86+00 NB	STH 32	20	--	13	--	NORTH RAILROAD CROSSING APPROACH TO HANSEN ROAD
90+00 NB	-	100+25 NB	STH 32	32	--	21	--	HANSEN ROAD TO VANDERPERREN WAY
104+25 NB	-	118+50 NB	STH 32	45	--	29	--	VANDERPERREN WAY TO PILGRIM WAY
122+50 NB	-	141+00 NB	STH 32	58	--	37	--	PILGRIM WAY TO CORMIER ROAD
144+50 NB	-	174+50 NB	STH 32	94	--	60	--	CORMIER ROAD TO MIKE MCCARTHY WAY
178+50 NB	-	190+75 NB	STH 32	39	--	25	--	MIKE MCCARTHY WAY TO LOMBARDI AVENUE
SUBTOTAL NORTHBOUND LANES				446	922	280	580	
SOUTHBOUND								
28+97 SB	-	46+00 SB	STH 32	54	--	34	--	BEGINNING OF PROJECT TO PARKVIEW ROAD
46+00 SB	-	58+75 SB	STH 32	40	--	26	--	PARKVIEW ROAD TO SOUTH EDGE OF NEW BRIDGE DECK
58+63 SB	-	59+55 SB	STH 32	1	161	--	--	SHOULDER W/DENING SB SW QUADRANT
58+75 SB	-	59+55 SB	STH 32	2	78	--	--	SHOULDER W/DENING SB SE QUADRANT
60+85 SB	-	61+83 SB	STH 32	1	168	--	--	SHOULDER W/DENING SB NW QUADRANT
60+85 SB	-	60+95 SB	STH 32	1	13	--	--	SHOULDER W/DENING SB NE QUADRANT
60+95 SB	-	77+25 SB	STH 32	51	--	33	--	NORTH EDGE OF NEW BRIDGE DECK TO SOUTH RAILROAD CROSSING APPROACH
77+25 SB	-	78+77 SB	STH 32	5	200	3	620	RAILROAD CROSSING
78+77 SB	-	86+00 SB	STH 32	23	--	14	--	NORTH RAILROAD CROSSING APPROACH TO HANSEN ROAD
90+00 SB	-	100+25 SB	STH 32	32	--	21	--	HANSEN ROAD TO VANDERPERREN WAY
104+25 SB	-	118+50 SB	STH 32	45	--	29	--	VANDERPERREN WAY TO PILGRIM WAY
122+50 SB	-	141+00 SB	STH 32	58	--	37	--	PILGRIM WAY TO CORMIER ROAD
144+50 SB	-	174+50 SB	STH 32	94	--	60	--	CORMIER ROAD TO MIKE MCCARTHY WAY
178+50 SB	-	190+75 SB	STH 32	39	--	25	--	MIKE MCCARTHY WAY TO LOMBARDI AVENUE
SUBTOTAL SOUTHBOUND LANES				446	620	280	620	
LEFT TURN LANE								
102+68 NB	-	108+93 NB	STH 32	--	1,969	--	--	LEFT TURN LANE NORTH OF VANDERPERREN WAY
TOTAL				892	3,511	560	1,200	

PROJECT NO: 4190-16-71 HWY: STH 32 COUNTY: BROWN MISCELLANEOUS QUANTITIES SHEET: 89

FILE NAME: _____ PLOT DATE: _____ PLOT BY: DUNS, ALEXANDER T PLOT SCALE: 1:1 E

Addendum No. 01
 ID 4190-16-71
 Revised Sheet 91
 December 7, 2016

ASPHALTIC MATERIALS

STATION	TO STATION	GAL	TON	TON	TON	TON	LF	TON	TON	TON	REMARKS
CATEGORY 0010											
NORTHBOUND											
29+00 NB	- 46+00 NB	411	164	118	896	706	6,800	465.0110	465.0105	465.0110	BEGINNING OF PROJECT TO PARKVIEW ROAD
38+01 NB	- 44+01 NB	68	--	--	202	109	1,200	---	---	---	RIGHT TURN LANE EXTENSION TO PARKVIEW ROAD
46+00 NB	- 59+72 NB	281	185	133	539	430	5,487	---	---	---	PARKVIEW ROAD TO SOUTH EDGE OF NEW BRIDGE DECK
60+69 NB	- 78+00 NB	360	232	167	698	556	6,923	---	---	---	N EDGE OF BRIDGE DECK TO S RAILROAD CROSSING APPROACH
78+00 NB	- 79+50 NB	44	36	14	108	42	600	175	---	---	RAILROAD CROSSING; ASPHALTIC SURFACE UNDER RAILROAD
79+50 NB	- 86+00 NB	144	52	38	320	252	2,600	---	---	---	NORTH RAILROAD CROSSING APPROACH TO HANSEN ROAD
86+00 NB	- 90+00 NB	164	14	10	527	201	1,600	---	---	---	HANSEN ROAD INTERSECTION; PLACE 6" ASPHALT
90+00 NB	- 100+25 NB	211	133	96	411	327	4,100	---	---	---	HANSEN ROAD TO VANDERPERREN WAY
100+25 NB	- 104+25 NB	137	50	36	403	140	1,600	---	---	---	VANDERPERREN WAY INTERSECTION; PLACE 6" ASPHALT
104+25 NB	- 118+50 NB	306	147	106	643	508	5,700	---	---	---	VANDERPERREN WAY TO PILGRIM WAY
118+50 NB	- 122+50 NB	168	11	8	543	207	1,600	5	---	---	PILGRIM WAY INTERSECTION; PLACE 6" ASPHALT
122+50 NB	- 141+00 NB	388	234	169	767	610	7,400	---	---	---	PILGRIM WAY TO CORMIER ROAD
141+00 NB	- 144+50 NB	147	6	4	481	185	1,400	---	---	---	CORMIER ROAD INTERSECTION; PLACE 6" ASPHALT
144+50 NB	- 174+50 NB	615	390	281	1,198	955	12,000	---	---	---	CORMIER ROAD TO MIKE MCCARTHY WAY
174+50 NB	- 178+50 NB	160	3	2	525	203	1,600	---	---	---	MIKE MCCARTHY WAY INTERSECTION; PLACE 6" ASPHALT
178+50 NB	- 190+75 NB	263	122	88	558	441	4,900	---	---	---	MIKE MCCARTHY WAY TO LOMBARDI AVENUE
190+75 NB	- 195+00 NB	164	--	--	541	210	1,700	---	---	---	LOMBARDI AVENUE INTERSECTION/EOP; PLACE 6" ASPHALT
SUBTOTAL NORTHBOUND LANES		4,029	1,780	1,269	9,360	6,084	67,210	180	---	---	
SOUTHBOUND											
31+00 SB	- 46+00 SB	325	156	112	684	541	6,000	---	---	---	BEGINNING OF PROJECT TO PARKVIEW ROAD
46+00 SB	- 59+72 SB	282	158	114	570	453	5,487	---	---	---	PARKVIEW ROAD TO SOUTH EDGE OF NEW BRIDGE DECK
60+69 SB	- 77+25 SB	374	164	118	800	632	6,623	---	---	---	N EDGE OF BRIDGE DECK TO S RAILROAD CROSSING APPROACH
77+25 SB	- 78+77 SB	45	37	15	110	43	608	175	---	---	RAILROAD CROSSING; ASPHALTIC SURFACE UNDER RAILROAD
78+77 SB	- 86+00 SB	143	95	68	274	218	2,892	---	---	---	NORTH RAILROAD CROSSING APPROACH TO HANSEN ROAD
86+00 SB	- 90+00 SB	164	9	7	532	204	1,600	---	---	---	HANSEN ROAD INTERSECTION; PLACE 6" ASPHALT
90+00 SB	- 100+25 SB	219	113	82	452	358	4,100	---	---	---	HANSEN ROAD TO VANDERPERREN WAY
100+25 SB	- 104+25 SB	137	9	6	444	170	1,600	---	---	---	VANDERPERREN WAY INTERSECTION; PLACE 6" ASPHALT
104+25 SB	- 118+50 SB	312	130	93	675	533	5,700	---	---	---	VANDERPERREN WAY TO PILGRIM WAY
118+50 SB	- 122+50 SB	168	7	5	547	211	1,600	---	---	---	PILGRIM WAY INTERSECTION; PLACE 6" ASPHALT
122+50 SB	- 141+00 SB	413	148	107	918	722	7,400	---	---	---	PILGRIM WAY TO CORMIER ROAD
141+00 SB	- 144+50 SB	147	5	4	481	185	1,400	---	---	---	CORMIER ROAD INTERSECTION; PLACE 6" ASPHALT
144+50 SB	- 174+50 SB	624	314	226	1,297	1,027	12,000	---	---	---	CORMIER ROAD TO MIKE MCCARTHY WAY
174+50 SB	- 178+50 SB	248	8	6	519	199	1,600	---	---	---	MIKE MCCARTHY WAY INTERSECTION; PLACE 6" ASPHALT
178+50 SB	- 190+75 SB	160	133	96	506	402	4,900	---	---	---	MIKE MCCARTHY WAY TO LOMBARDI AVENUE
190+75 SB	- 195+80 SB	202	10	7	656	252	2,020	---	---	---	LOMBARDI AVENUE INTERSECTION/EOP; PLACE 6" ASPHALT
SUBTOTAL SOUTHBOUND LANES		3,960	1,497	1,065	9,466	6,149	65,530	175	---	---	

ASPHALTIC MATERIALS (CONTINUED)

455. 0605	TACK COAT	460. 5223	HMA PAVEMENT LOWER LAYER	460. 5224	HMA PAVEMENT UPPER LAYER	460. 6223	HMA PAVEMENT LOWER LAYER	460. 6424	HMA PAVEMENT UPPER LAYER	460. 4110. S	REHEATING HMA PAVEMENT	465. 0105	ASPHALTIC SURFACE	465. 0110	ASPHALTIC SURFACE	REMARKS
TO STATION	GAL	TON	TON	TON	TON	TON	TON	TON	TON	LF	LF	TON	TON	TON	TON	
102+68 NB - 108+93 NB	146	--	--	--	371	--	144	--	155	2, 501	--	200	--	200	--	LEFT TURN LANE NORTH OF VANDERPERREN WAY
UNDI STRIBUTED	--	--	--	--	--	--	--	--	--	--	--	--	--	--	--	AS NEEDED: LOCATIONS TO BE DETERMINED IN FIELD

TOTAL	8, 135	3, 277	2, 334	19, 197	12, 377	135, 241	510	200	200							
--------------	---------------	---------------	---------------	----------------	----------------	-----------------	------------	------------	------------	--	--	--	--	--	--	--

EROSION CONTROL

625. 0500	SALVAGED TOPSOIL	628. 1104	EROSION BALES	628. 1504	SILT FENCE	628. 1520	SILT FENCE MAINTENANCE	628. 2002	EROSION MAT CLASS I	628. 2023	EROSION MAT CLASS II	628. 7015	INLET PROTECTION TYPE C	628. 7504	TEMPORARY DITCH CHECKS	628. 7555	CULVERT PIPE CHECKS	628. 7570	ROCK BAGS EACH
STATION TO STATION	LOCATION	LOCATION	EACH	LF	LF	LF	LF	SY	SY	SY	SY	EACH	EACH	EACH	EACH	EACH	EACH	EACH	EACH
38+01NB - 44+01NB	E DI TCH	E DI TCH	--	610	610	610	680	--	620	620	620	--	--	--	1	--	--	--	--
53+20NB - 59+55NB	E DI TCH	E DI TCH	--	640	640	640	640	--	530	530	530	--	--	1	--	--	--	--	--
55+65SB - 59+60SB	W DI TCH	W DI TCH	--	400	400	400	400	--	150	150	150	--	--	1	--	--	--	--	--
55+47NB - 59+53NB	MEDI AN	MEDI AN	--	410	410	410	150	--	50	50	50	--	--	--	--	--	--	--	--
58+73SB - 59+59SB	MEDI AN	MEDI AN	--	100	100	100	100	--	--	--	--	--	--	--	--	--	--	--	--
59+60NB - 59+60NB	S RIVER BANK	S RIVER BANK	--	120	120	120	120	--	--	--	--	--	--	--	--	--	--	--	--
60+85NB - 60+85NB	N RIVER BANK	N RIVER BANK	--	120	120	120	100	--	--	--	--	--	--	--	--	--	--	--	--
60+85NB - 61+63NB	MEDI AN	MEDI AN	--	90	90	90	100	--	140	140	140	--	--	--	--	--	--	--	--
60+85NB - 61+40NB	E DI TCH	E DI TCH	--	70	70	70	350	--	--	--	--	--	--	1	--	--	--	--	--
60+85SB - 63+15SB	W DI TCH	W DI TCH	--	240	240	240	115	--	750	750	750	--	--	1	--	--	--	--	--
60+85SB - 63+00SB	MEDI AN	MEDI AN	--	230	230	230	750	--	--	--	--	--	--	4	5	--	--	--	--
77+25NB - 79+50NB	NB & SB	NB & SB	--	620	620	620	530	--	--	--	--	11	1	5	--	--	--	--	--
101+50NB - 108+90NB	MEDI AN	MEDI AN	--	--	--	--	530	--	--	--	--	--	--	--	--	--	--	--	--
107+95NB - 113+15NB	E DI TCH	E DI TCH	--	530	530	530	280	--	--	--	--	--	--	--	--	--	--	--	--
110+40SB - 113+15SB	W DI TCH	W DI TCH	--	280	280	280	800	--	--	--	--	--	--	--	--	--	--	--	--
123+00NB - 130+70NB	E DI TCH	E DI TCH	--	800	800	800	650	--	--	--	--	--	--	--	--	--	--	--	--
125+85SB - 132+30SB	W DI TCH	W DI TCH	--	650	650	650	30	--	--	--	--	--	--	10	--	--	--	--	50
UNDI STRIBUTED	PROJECT	PROJECT	--	--	--	--	--	--	--	--	--	--	--	--	--	--	--	--	--

TOTAL	3, 485	30	5, 910	5, 910	5, 910	1, 845	1, 640	11	20	10	50
--------------	---------------	-----------	---------------	---------------	---------------	---------------	---------------	-----------	-----------	-----------	-----------

Addendum No. 01
 ID 4190-16-71
 Revised Sheet 92
 December 7, 2016

LANDSCAPING

STATION TO STATION	LOCATION	FERTILIZER TYPE B CWT	SEEDING MIXTURE NO. 40 LB	SEEDING TEMPORARY LB	REMARKS
38+01NB - 44+01NB	STH 32	0.4	12	18	PARKVIEW ROAD RIGHT TURN LANE EXTENSION
53+20NB - 59+55NB	STH 32	0.4	11	17	ASHWAUBENON CREEK NB LANES EAST DITCH
55+65SB - 59+60SB	STH 32	0.3	10	14	ASHWAUBENON CREEK SB LANES WEST DITCH
55+47NB - 59+53NB	STH 32	0.1	3	4	ASHWAUBENON CREEK NB LANES MEDIAN DITCH
58+73SB - 59+59SB	STH 32	0.1	1	2	ASHWAUBENON CREEK SB LANES MEDIAN DITCH
60+85NB - 61+63NB	STH 32	0.1	2	3	ASHWAUBENON CREEK NB LANES MEDIAN DITCH
60+85NB - 61+40NB	STH 32	0.1	3	3	ASHWAUBENON CREEK NB LANES EAST DITCH
60+85SB - 63+15SB	STH 32	0.2	6	9	ASHWAUBENON CREEK SB LANES WEST DITCH
60+85SB - 63+00SB	STH 32	0.1	2	3	ASHWAUBENON CREEK SB LANES MEDIAN DITCH
77+25NB - 79+50NB	STH 32	0.5	14	20	RAILROAD CROSSING RECONSTRUCTION NB & SB

TOTAL

2.3

63

94

Addendum No. 01
 ID 4190-16-71
 Revised Sheet 94
 December 7, 2016

Addendum No. 01
 ID 4190-16-71
 Revised Sheet 105
 December 7, 2016

ERECTOR & REMOVAL OF PERMANENT SIGNING, TYPE II

STGN NO.	LOCATION	STGN CODE	W X H	637.2210 SIGNS TYPE II REFLECTIVE TYPE H S.F.	637.2215 SIGNS TYPE II FOLDING REFLECTIVE TYPE H S.F.	637.2230 SIGNS TYPE II REFLECTIVE TYPE F S.F.	634.0612 POSTS WOOD 4X6X12	634.0614 POSTS WOOD 4X6X14	634.0616 POSTS WOOD 4X6X16	634.0618 POSTS WOOD 4X6X18	638.2602 REMOVING SIGNS TYPE II	638.3000 REMOVING SMALL SIGN SUPPORTS	REMARKS
78	STH 32, S. OF HANSEN RD	W10-1	36" X 36"	---	---	7.07	---	---	---	---	1	1	MOUNT BELOW SIGN #78, PART OF REMOVAL FOR SIGN #78
79	"	W10-1A	24" X 12"	---	---	3.00	---	---	---	---	---	---	MOUNT BELOW SIGN #79
79A	"	W10-9P	24" X 18"	---	---	2.00	---	---	---	---	---	---	MOUNT BELOW SIGN #80
80	"	W10-1	36" X 36"	---	---	7.07	---	---	---	---	1	1	MOUNT BELOW SIGN #81
81	"	W10-1A	24" X 12"	---	---	2.00	---	---	---	---	---	---	MOUNT BELOW SIGN #82
81A	"	W10-9P	24" X 18"	---	---	3.00	---	---	---	---	---	---	MOUNT BELOW SIGN #83
82	"	R2-1	30" X 36"	7.50	---	---	---	---	---	---	1	1	NORTH STH 32, SEE PLAN SHEET, PART OF REMOVAL FOR SIGN #84
83	HANSEN RD	J3-1	24" X 57"	9.50	---	---	---	---	---	---	---	---	MOUNT BELOW SIGN #85
83A	"	W10-2	36" X 36"	---	---	9.00	---	---	---	---	---	---	MOUNT BELOW SIGN #86
83B	"	W10-1A	24" X 12"	---	---	2.00	---	---	---	---	---	---	MOUNT BELOW SIGN #87
83C	"	W10-9P	24" X 18"	---	---	3.00	---	---	---	---	---	---	MOUNT ON BACK OF SIGN #83, SOUTH STH 32, SEE PLAN SHEET
84	"	J3-1	24" X 57"	9.50	---	---	---	---	---	---	1	1	MOUNT TO TRAFFIC SIGNAL, PART OF REMOVAL FOR SIGN #97
85	STH 32, AT HANSEN RD INTERSECTION	R1-1F	36" X 36"	---	7.46	---	---	---	---	---	---	---	MOUNT TO TRAFFIC SIGNAL, PART OF REMOVAL FOR SIGN #98
86	"	R1-1F	36" X 36"	---	7.46	---	---	---	---	---	---	---	CTH HH, SEE PLAN SHEET
87	"	J13-1	36" X 66"	16.50	---	---	---	---	---	---	1	1	MOUNT TO TRAFFIC SIGNAL
88	"	R1-1F	36" X 36"	---	7.46	---	---	---	---	---	1	1	MOUNT TO TRAFFIC SIGNAL
89	"	R3-1	36" X 36"	9.00	---	---	---	---	---	---	1	1	MOUNT TO TRAFFIC SIGNAL
89A	"	W10-1	36" X 36"	---	7.07	---	---	---	---	---	1	1	MOUNT BELOW SIGN #89A, PART OF REMOVAL FOR SIGN #89A
89B	"	W10-1A	24" X 12"	---	---	2.00	---	---	---	---	---	---	MOUNT BELOW SIGN #89B
89C	"	W10-9P	24" X 18"	---	---	3.00	---	---	---	---	---	---	MOUNT TO TRAFFIC SIGNAL
90	CTH HH	R5-1	30" X 30"	6.25	7.46	---	---	---	---	---	1	1	MOUNT TO TRAFFIC SIGNAL
91	"	R1-1F	36" X 36"	---	7.46	---	---	---	---	---	1	1	MOUNT TO TRAFFIC SIGNAL
92	STH 32, AT HANSEN RD INTERSECTION	R4-7	24" X 30"	5.00	---	---	---	---	---	---	1	1	MOUNT TO TRAFFIC SIGNAL
93	CTH HH	R1-1F	36" X 36"	---	7.46	---	---	---	---	---	1	1	MOUNT TO TRAFFIC SIGNAL
94	"	J3-1	24" X 57"	9.50	---	---	---	---	---	---	1	1	NORTH STH 32, SEE PLAN SHEET
95	"	J3-1	24" X 57"	9.50	---	---	---	---	---	---	1	1	MOUNT TO TRAFFIC SIGNAL
96	HANSEN RD	R1-1F	36" X 36"	---	7.46	---	---	---	---	---	1	1	MOUNT ON BACK OF SIGN #94, PART OF REMOVAL FOR SIGN #94
97	STH 32, AT HANSEN RD INTERSECTION	R4-7	24" X 30"	5.00	---	---	---	---	---	---	1	1	MOUNT TO TRAFFIC SIGNAL
98	"	R5-1	30" X 30"	6.25	---	---	---	---	---	---	1	1	MOUNT TO TRAFFIC SIGNAL
99	"	R3-1	36" X 36"	9.00	---	---	---	---	---	---	1	1	MOUNT TO TRAFFIC SIGNAL
100	"	R5-1	36" X 36"	9.00	---	---	---	---	---	---	1	1	MOUNT TO TRAFFIC SIGNAL
101	"	J13-1	---	---	---	---	---	---	---	---	---	---	PART OF REMOVAL FOR SIGN #100
102	"	R10-11B	24" X 24"	4.00	---	---	---	---	---	---	1	1	MOUNT TO TRAFFIC SIGNAL
103	"	R1-1F	36" X 36"	---	7.46	---	---	---	---	---	---	---	MOUNT TO TRAFFIC SIGNAL, PART OF REMOVAL FOR SIGN #102
104	"	R1-1F	36" X 36"	---	7.46	---	---	---	---	---	---	---	MOUNT TO TRAFFIC SIGNAL, PART OF REMOVAL FOR SIGN #90
105	STH 32, N. OF HANSEN RD	J4-1	36" X 54"	13.50	---	---	---	---	---	---	1	1	NORTH STH 32, SEE PLAN SHEET
106	"	R5-1A	42" X 30"	8.75	---	---	---	---	---	---	1	1	MOUNT ON BACK OF SIGN #107, PART OF REMOVAL FOR SIGN #107
107	"	W10-2	36" X 36"	---	9.00	---	---	---	---	---	1	1	MOUNT BELOW SIGN #107
107A	"	W10-1A	24" X 12"	---	2.00	---	---	---	---	---	---	---	MOUNT BELOW SIGN #107A
107B	"	W10-9P	24" X 18"	---	3.00	---	---	---	---	---	---	---	MOUNT BELOW SIGN #107A
108	"	R3-56R	---	---	---	---	---	---	---	---	1	1	CTH HH, SEE PLAN SHEET
109	"	J13-1	24" X 45"	7.50	---	---	---	---	---	---	1	1	THETA PHI ALPHA
110	"	R3-56L	---	---	---	---	---	---	---	---	1	1	45 MPH
111	"	I55-56	30" X 36"	7.50	---	---	---	---	---	---	1	1	SEE SIGN DETAIL SHEET
112	"	R2-1	36" X 48"	12.00	---	---	---	---	---	---	1	1	JCT STH 172
113	"	D1-60	84" X 36"	21.00	---	---	---	---	---	---	1	1	JCT STH 172
114	"	J1-1	36" X 57"	14.25	---	---	---	---	---	---	1	1	JCT STH 172
115	"	J1-1	36" X 57"	14.25	---	---	---	---	---	---	1	1	JCT STH 172
PAGE SUBTOTALS				214.25	59.68	64.21	0	8	8	3	28	20	

PLAN SHEET PRODUCED
 BY WisDOT - NE REGION

PROJECT NUMBER: 4190-16-71

HWY: STH 32

COUNTY: BROWN

MISCELLANEOUS QUANTITIES

SHEET 105

E

ERECTION & REMOVAL OF PERMANENT SIGNING - TYPE II

SIGN NO.	LOCATION	SIGN CODE	W X H	637.2210 SIGNS TYPE II REFLECTIVE TYPE H S.F.	637.2215 SIGNS TYPE II FOLDING REFLECTIVE TYPE H S.F.	637.2230 SIGNS TYPE II REFLECTIVE TYPE F S.F.	634.0614		634.0618		638-2602 REMOVING SIGNS TYPE II EACH	638-3000 REMOVING SMALL SIGN SUPPORTS EACH	REMARKS
							POSTS WOOD 4X6X14	POSTS WOOD 4X6X18	POSTS WOOD 4X6X14	POSTS WOOD 4X6X18			
150A	STH 32, N. OF CTH HW/VANDERBERN WAY	R3-18	36" X 36"	9.00									MOUNT ON BACK OF SIGN #150
151	"	R5-1A	42" X 30"	8.75									HWY 172, SEE SIGN DETAIL SHEET
152	"	MI-94	54" X 15"	5.63									
153	"	W3-3											
154	STH 32, S. OF CTH YY	J1-1	36" X 57"	14.25									JCT. CTH HH
155	TENNIS COURT	R1-1	30" X 30"	5.18									
156	TENNIS COURT	R1-1	30" X 30"	5.18									
157	"	R3-2	24" X 24"	4.00									
158	STH 32, S. OF CTH YY	R4-7	24" X 30"	5.00									HWY 172, SEE SIGN DETAIL SHEET
159	"	MI-94	54" X 15"	5.63									
160	"	R5-1	36" X 36"	9.00									
161	"	R2-2	72" X 84"	42.00									WEST CTH YY, WEST STH 172, SEE PLAN SHEET
162	"	R6-2L											
162A	"	R5-1	36" X 36"	9.00									
163	"	W10-2											MOUNT BELOW SIGN #163
163A	"	W10-JA	24" X 12"										MOUNT BELOW SIGN #163A
163B	"	W10-9P	24" X 18"										WEST CTH YY, WEST STH 172, SEE PLAN SHEET
164	"	J3-2	72" X 84"	42.00									
165	"	R5-1A	42" X 30"	8.75									A. STRAUBEL AIRPORT, SEE SIGN DETAIL SHEET
166	"	D1-1	78" X 24"	13.00									PART OF REMOVAL FOR SIGN #166
167	"	R3-56L											MOUNT ON BACK OF SIGN #166, PART OF REMOVAL FOR SIGN #166
168	"	R5-1A	42" X 30"	8.75									MOUNT TO TRAFFIC SIGNAL
169	"	J3-2											MOUNT TO TRAFFIC SIGNAL
170	"	R1-1F	36" X 36"										MOUNT TO TRAFFIC SIGNAL
171	"	R1-1F	36" X 36"										MOUNT TO TRAFFIC SIGNAL
172	"	R1-1F	30" X 30"										MOUNT TO TRAFFIC SIGNAL
173	CTH YY	R1-2	36" X 31"	3.88									MOUNT TO TRAFFIC SIGNAL
174	PILGRIM RD	R4-7	24" X 30"	5.00									MOUNT TO TRAFFIC SIGNAL
174A	"	W10-1	36" X 36"										MOUNT BELOW SIGN #174A, PART OF REMOVAL FOR SIGN #174A
174B	"	W10-JA	24" X 12"										MOUNT BELOW SIGN #174B
174C	"	W10-9P	24" X 18"										MOUNT TO TRAFFIC SIGNAL, PART OF REMOVAL FOR SIGN #174
175	"	R1-1F	30" X 30"										MOUNT TO TRAFFIC SIGNAL
176	"	R1-1F	30" X 30"										MOUNT TO TRAFFIC SIGNAL
177	"	R4-7	24" X 30"	5.00									MOUNT TO TRAFFIC SIGNAL, PART OF REMOVAL FOR SIGN #172
178	VACANT												
179	VACANT												
180	STH 32, INTERSECTION OF CTH YY	R5-1	30" X 30"	6.25									MOUNT TO TRAFFIC SIGNAL, PART OF REMOVAL FOR SIGN #170
181	"	W10-2	36" X 36"										
181A	"	W10-JA	24" X 12"										MOUNT BELOW SIGN #181
181B	"	W10-9P	24" X 18"										MOUNT BELOW SIGN #181A
182	CTH YY	R4-7	24" X 30"	5.00									MOUNT TO TRAFFIC SIGNAL, PART OF REMOVAL FOR SIGN #181
183	VACANT												
184	STH 32, INTERSECTION OF CTH YY	R4-7	24" X 30"	5.00									MOUNT TO TRAFFIC SIGNAL
185	"	R1-1F	30" X 30"										MOUNT TO TRAFFIC SIGNAL, PART OF REMOVAL FOR SIGN #184
186	"	J3-2	72" X 84"	42.00									WEST CTH YY, WEST STH 172, SEE PLAN SHEET
187	VACANT												
188	STH 32, INTERSECTION OF CTH YY	R5-1	30" X 30"	6.25									MOUNT TO TRAFFIC SIGNAL
189	"	R1-1F	36" X 36"										MOUNT TO TRAFFIC SIGNAL, PART OF REMOVAL FOR SIGN #188
190	STH 32, N. OF CTH YY	R4-1	36" X 54"	13.50									NORTH STH 32
191	"	R5-1A	42" X 30"	8.75									MOUNT ON BACK OF SIGN #192, PART OF REMOVAL FOR SIGN #192
192	"	W10-2	36" X 36"										
192A	"	W10-JA	24" X 12"										MOUNT BELOW SIGN #192
192B	"	W10-9P	24" X 18"										MOUNT BELOW SIGN #192A
193	"	R5-1A	42" X 30"	8.75									
194	"	R3-56R											
195	"	R3-56L											
196	"	D9-52	36" X 36"	9.00									A. STRAUBEL AIRPORT, SEE SIGN DETAIL SHEET
PAGE SUBTOTALS				313.49	52.22	54.07	11	6	2	9	33	25	

Addendum No. 01
ID 4190-16-71
Revised Sheet 108
December 7, 2016

ERECTION & REMOVAL OF PERMANENT SIGNING, TYPE II

SIGN NO.	LOCATION	SIGN CODE	W X H	637, 2210 SIGNS TYPE II REFLECTIVE TYPE H	637, 2215 SIGNS TYPE II FOLDING REFLECTIVE TYPE H S.F.	637, 2230 SIGNS TYPE II REFLECTIVE TYPE F S.F.	634, 0612 POSTS WOOD 4X6X14 EACH	634, 0614 POSTS WOOD 4X6X16 EACH	634, 0616 POSTS WOOD 4X6X18 EACH	638, 2602 REMOVING SMALL SIGN SUPPORTS EACH	638, 3000 REMOVING SMALL SIGN SUPPORTS EACH	REMARKS
197	STH 32, N. OF CTH YY	J2-2	72" X 84"	42.00					2	1	1	EAST STH 172, WEST STH 172, SEE PLAN SHEET
198	"	J2-2	72" X 102"	51.00					2	1	1	SOUTH STH 32, SEE PLAN SHEET
199	"	R2-1	36" X 48"	12.00				1		1	1	45 MPH
200	"	W3-3	36" X 36"		9.00					1	1	
201	"	J1-2	72" X 37"	28.50						1	1	JCT STH 172, JCT CTH YY
202	"	W3-3	36" X 36"		9.00					1	1	
203	"	W3-3	36" X 36"		9.00					1	1	
204	"	R5-1	36" X 36"		9.00					1	1	
205	"	W10-2	36" X 36"		9.00					1	1	
205A	"	W10-1A	24" X 12"		2.00							MOUNT BELOW SIGN #205
205B	"	W10-9P	24" X 18"		3.00							MOUNT BELOW SIGN #205A
206	"	R5-1A	42" X 30"	8.75						1	1	
207	"	D1-60	84" X 36"	21.00						2	2	SEE SIGN DETAIL SHEET
208	"	R3-56L										PART OF REMOVAL FOR SIGN #209
209	"	R5-1A	42" X 30"	8.75						1	1	
210	"	R3-56R										
211	"	R2-1	30" X 36"	7.50						1	1	45 MPH
212	STH 32, INTERSECTION OF CTH H/CORMIER RD	R1-1F	36" X 36"		7.46							MOUNT TO TRAFFIC SIGNAL
213	"	R1-1F	36" X 36"		7.46							MOUNT TO TRAFFIC SIGNAL
214	"	R1-1F	36" X 36"		7.46							MOUNT TO TRAFFIC SIGNAL
215	"	R5-1	30" X 30"	6.25						1	1	
215A	"	W10-1	36" X 36"		7.07							MOUNT BELOW SIGN #215A, PART OF REMOVAL FOR SIGN #215A
215B	"	W10-1A	24" X 12"		2.00							MOUNT BELOW SIGN #215B
215C	"	W10-9P	24" X 18"		3.00							MOUNT TO TRAFFIC SIGNAL
216	CTH H	R1-1F	36" X 36"		7.46							MOUNT TO TRAFFIC SIGNAL
217	"	R1-1F	36" X 36"		7.46							MOUNT TO TRAFFIC SIGNAL
218	STH 32, INTERSECTION OF CTH H/CORMIER RD	R4-7	24" X 30"	5.00								MOUNT TO TRAFFIC SIGNAL, PART OF REMOVAL FOR SIGN #212
219	"	R1-2	36" X 31"	3.88								
219A	CORMIER RD	W10-2	36" X 36"		9.00							MOUNT BELOW SIGN #219A
219B	"	W10-1A	24" X 12"		2.00							MOUNT BELOW SIGN #219B
219C	"	W10-9P	24" X 18"		3.00							MOUNT TO TRAFFIC SIGNAL
220	"	R1-1F	36" X 36"		7.46							MOUNT TO TRAFFIC SIGNAL
221	"	R6-2L										PART OF REMOVAL FOR SIGN #220
222	STH 32, INTERSECTION OF CTH H/CORMIER RD	R5-1	30" X 30"	6.25								MOUNT TO TRAFFIC SIGNAL, PART OF REMOVAL FOR SIGN #213
223	"	R3-1	24" X 24"	4.00								MOUNT TO TRAFFIC SIGNAL
224	"	R1-1F	36" X 36"		7.46							MOUNT TO TRAFFIC SIGNAL, PART OF REMOVAL FOR SIGN #223
225	"	R1-1F	36" X 36"		7.46							MOUNT TO TRAFFIC SIGNAL, PART OF REMOVAL FOR SIGN #215
226	"	R1-1F	36" X 36"		7.46							MOUNT TO TRAFFIC SIGNAL
227	"	R4-7	24" X 30"	5.00								MOUNT TO TRAFFIC SIGNAL, PART OF REMOVAL FOR SIGN #216
228	CTH H	R6-2R										MOUNT TO TRAFFIC SIGNAL, PART OF REMOVAL FOR SIGN #226
229	"	R4-7	24" X 30"	5.00								MOUNT TO TRAFFIC SIGNAL, PART OF REMOVAL FOR SIGN #226
230	STH 32, N. OF CTH H/CORMIER RD	R5-1A	42" X 30"	8.75								
231	"	R3-56R										
232	"	R3-56L										
233	"	J4-1	36" X 54"	13.50								NORTH STH 32
234	"	R2-1	36" X 48"	12.00								45 MPH
235	"	D1-60	84" X 36"	21.00								SEE SIGN DETAIL SHEET
236	"	W10-2	36" X 36"		9.00							
236A	"	W10-1A	24" X 12"		2.00							MOUNT BELOW SIGN #236
236B	"	W10-9P	24" X 18"		3.00							MOUNT BELOW SIGN #236A
237	"	W3-3	36" X 36"		9.00							
PAGE SUBTOTALS				279.13	67.14	90.07	3	10	3	7	34	22

Addendum No. 01
 ID 4190-16-71
 Revised Sheet 109
 December 7, 2016

ERECTION & REMOVAL OF PERMANENT SIGNING - TYPE II

STGN NO.	LOCATION	STGN CODE	W X H	637-2210 SIGNS TYPE II REFLECTIVE TYPE H S.F.	637-2215 SIGNS TYPE II FOLDING REFLECTIVE TYPE H S.F.	637-2230 SIGNS TYPE II REFLECTIVE TYPE F S.F.	634-0612 POSTS WOOD 4X6X12 EACH	634-0614 POSTS WOOD 4X6X14 EACH	634-0616 POSTS WOOD 4X6X16 EACH	634-0618 POSTS WOOD 4X6X18 EACH	638-2602 REMOVING SIGNS TYPE II EACH	638-3000 REMOVING SMALL SIGN SUPPORTS EACH	REMARKS
238	STH 32, N. OF CTH H/CORMIER RD	R2-1	36" X 48"	12.00									45 MPH
239	"	R2-1	36" X 48"	12.00									45 MPH
240	MORRIS AVE	R6-2R	36" X 12"	3.00									MOUNT ABOVE SIGN #242
241	"	R6-1R	36" X 30"	5.18									
242	"	R1-1	30" X 30"	5.00									
243	"	R6-2R	24" X 30"	5.18									
244	"	R1-1	30" X 30"	9.00									
245	STH 32, N. OF MORRIS AVE	R5-1	36" X 36"	8.75									MOUNT BELOW SIGN #246
246	"	W10-2	36" X 36"	7.50									MOUNT BELOW SIGN #246A
246A	"	W10-1A	24" X 12"	3.00									MOUNT ON BACK OF SIGN #248, PART OF REMOVAL FOR SIGN #248
247	"	R5-1A	42" X 30"	7.50									BROWN COUNTY RETIRED EDUCATORS
248	"	I55-56	30" X 36"	8.75									
249	"	R3-56L	42" X 30"	8.75									PART OF REMOVAL FOR SIGN #249
250	"	R5-1A	42" X 30"										
251	"	R3-56R											
252	"	R3-56R											
253	STH 32, S. OF POTTS AVE	R2-1	36" X 48"	12.00									45 MPH
254	"	R2-1	36" X 48"	12.00									45 MPH
255	STH 32, INTERSECTION OF POTTS AVE	R1-1F	36" X 36"	7.46									MOUNT TO TRAFFIC SIGNAL
256	"	R1-1F	36" X 36"	7.46									MOUNT TO TRAFFIC SIGNAL
257	"	R3-1	24" X 24"	4.00									MOUNT TO TRAFFIC SIGNAL
257A	"	W10-1	36" X 36"	7.07									MOUNT BELOW SIGN #257A, PART OF REMOVAL FOR SIGN #257A
257B	"	W10-1A	24" X 12"	2.00									MOUNT BELOW SIGN #257B
257C	"	W10-9P	24" X 18"	3.00									MOUNT TO TRAFFIC SIGNAL
258	POTTS AVE	R1-1F	36" X 36"	7.46									MOUNT TO TRAFFIC SIGNAL
259	"	R6-2L											
260	"	R6-2R											PART OF REMOVAL FOR SIGN #259
261	"	R1-1F	36" X 36"	7.46									MOUNT TO TRAFFIC SIGNAL
261A	"	W10-2	36" X 36"	9.00									MOUNT TO TRAFFIC SIGNAL
261B	"	W10-1A	24" X 12"	2.00									MOUNT BELOW SIGN #261A
261C	"	W10-9P	24" X 18"	3.00									MOUNT TO TRAFFIC SIGNAL
262	STH 32, INTERSECTION OF POTTS AVE	R4-7	24" X 30"	5.00									MOUNT TO TRAFFIC SIGNAL
263	"	R5-1	30" X 30"	6.25									MOUNT TO TRAFFIC SIGNAL
264	"	R3-1	24" X 24"	4.00									MOUNT TO TRAFFIC SIGNAL
265	"	R5-1	30" X 30"	6.25									MOUNT TO TRAFFIC SIGNAL
266	"	R4-7	24" X 30"	5.00									MOUNT TO TRAFFIC SIGNAL
267	STH 32, N. OF POTTS AVE	R5-1	36" X 36"	9.00									PART OF REMOVAL FOR SIGN #267
268	"	R59-51											MOUNT TO TRAFFIC SIGNAL
269	POTTS AVE	R1-1F	30" X 30"	7.46									
270	"	R6-2R											
271	"	R6-2L											
272	STH 32, N. OF POTTS AVE	R2-1	30" X 36"	7.50									PART OF REMOVAL FOR SIGN #270
273	"	I55-56	30" X 36"	7.50									35 MPH, REMOVE FROM SIGNAL AND PLACE ON OWN POST
274	"	I2-3	84" X 24"	14.00									WEST DEPERE HIGH SCHOOL ECOLOGY CLUB
275	"	R5-1A	42" X 30"	8.75									ASHWAUBENON POP. 16,963, SEE SIGN DETAIL SHEET
276	"	R3-56L											PART OF REMOVAL FOR SIGN #275
277	"	J4-1	24" X 36"	6.00									NORTH_STH_32
278	"	R3-56R		171.61	37.30	40.07	4	9	3	2	33	22	
PAGE SUBTOTALS													

Addendum No. 01
 ID 4190-16-71
 Revised Sheet 110
 December 7, 2016

ERECTION & REMOVAL OF PERMANENT SIGNING, TYPE II

SIGN NO.	LOCATION	SIGN CODE	W X H	637.2210 SIGNS TYPE II REFLECTIVE TYPE H S.F.	637.2215 SIGNS TYPE II FOLDING TYPE H S.F.	637.2230 SIGNS TYPE II REFLECTIVE TYPE F S.F.	634.0612 POSTS WOOD 4X6X12 EACH	634.0614 POSTS WOOD 4X6X14 EACH	634.0616 POSTS WOOD 4X6X16 EACH	634.0618 POSTS WOOD 4X6X18 EACH	638.2602 REMOVING SIGNS TYPE II EACH	638.3000 REMOVING SMALL SIGN SUPPORTS EACH	REMARKS
279	STH 32, S. OF CTH VK/LOMBARDI AVE	J1-1	24" X 39"	6.50	---	---	1	---	---	---	---	---	JCT CTH VK
280	"	J1-1	24" X 39"	6.50	---	---	---	---	---	---	---	---	JCT CTH VK
281	"	W3-3	36" X 36"	---	---	9.00	1	---	---	---	1	---	---
282	"	W10-2	36" X 36"	---	---	9.00	---	1	---	---	1	---	---
282A	"	W10-1A	24" X 12"	---	---	2.00	---	---	---	---	---	---	MOUNT BELOW SIGN #282
282B	"	W10-9P	24" X 18"	---	---	3.00	---	---	---	---	---	---	MOUNT BELOW SIGN #282A
283	"	D1-60	84" X 24"	14.00	---	---	2	---	---	---	1	2	SEE SIGN DETAIL SHEET
284	"	R3-56R	---	---	---	---	---	---	---	---	1	1	---
285	"	R3-56L	---	---	---	---	---	---	---	---	1	1	---
286	"	J13-1	24" X 45"	7.50	---	---	1	---	---	---	---	---	CTH VK, SEE PLAN SHEET
287	"	R5-1A	42" X 30"	8.75	---	---	---	---	---	---	---	---	MOUNT ON BACK OF SIGN #286, PART OF REMOVAL FOR SIGN #285
288	"	J4-1	24" X 36"	6.00	---	---	1	---	---	---	1	---	SOUTH STH 32
289	"	W10-2	36" X 36"	---	---	9.00	---	1	---	---	1	---	---
289A	"	W10-1A	24" X 12"	---	---	2.00	---	---	---	---	---	---	MOUNT BELOW SIGN #289
289B	"	W10-9P	30" X 15"	---	---	3.13	---	---	---	---	1	1	MOUNT BELOW SIGN #289A
290	"	R2-1	24" X 30"	5.00	---	---	1	---	---	---	---	---	35 MPH
291	STH 32, INTERSECTION OF CTH VK/LOMBARDI AVE	R1-1F	36" X 36"	---	7.46	---	---	---	---	---	1	---	MOUNT TO TRAFFIC SIGNAL
292	"	R1-1F	36" X 36"	---	7.46	---	---	---	---	---	1	---	MOUNT TO TRAFFIC SIGNAL
293	"	R1-1F	36" X 36"	---	7.46	---	---	---	---	---	1	---	MOUNT TO TRAFFIC SIGNAL
294	"	R5-1	30" X 30"	6.25	---	---	---	---	---	---	1	---	MOUNT TO TRAFFIC SIGNAL
294A	"	W10-1	36" X 36"	---	---	7.07	---	---	---	---	---	---	MOUNT TO SIGNAL POLE
294B	"	W10-1A	24" X 12"	---	---	2.00	---	---	---	---	---	---	MOUNT BELOW SIGN #294A
294C	"	W10-9P	30" X 15"	---	---	3.13	---	---	---	---	---	---	MOUNT BELOW SIGN #294B
295	LOMBARDI AVE	R1-1F	36" X 36"	---	7.46	---	---	---	---	---	1	---	MOUNT TO TRAFFIC SIGNAL
296	CTH VK/LOMBARDI AVE	R1-2	36" X 31"	3.88	---	---	1	---	---	---	---	---	---
296A	"	W10-2	36" X 36"	---	---	9.00	---	1	---	---	---	---	MOUNT BELOW SIGN #296A
296B	"	W10-1A	24" X 12"	---	---	2.00	---	---	---	---	---	---	MOUNT BELOW SIGN #296B
296C	"	W10-9P	30" X 15"	---	---	3.13	---	---	---	---	---	---	MOUNT TO TRAFFIC SIGNAL
297	"	R1-1F	36" X 36"	---	7.46	---	---	---	---	---	1	---	MOUNT TO TRAFFIC SIGNAL
298	"	R4-7	24" X 30"	5.00	---	---	---	---	---	---	---	---	MOUNT TO TRAFFIC SIGNAL, PART OF REMOVAL FOR SIGN #291
299	"	R1-1F	36" X 36"	---	7.46	---	---	---	---	---	1	---	MOUNT TO TRAFFIC SIGNAL
300	"	R4-7	24" X 30"	5.00	---	---	---	---	---	---	---	---	MOUNT TO TRAFFIC SIGNAL
301	STH 32, INTERSECTION OF CTH VK/LOMBARDI AVE	R5-1	30" X 30"	6.25	---	---	---	---	---	---	---	---	MOUNT TO TRAFFIC SIGNAL, PART OF REMOVAL FOR SIGN #299
302	"	R1-1F	36" X 36"	---	7.46	---	---	---	---	---	---	---	MOUNT TO TRAFFIC SIGNAL, PART OF REMOVAL FOR SIGN #292
303	"	R1-1F	36" X 36"	---	7.46	---	---	---	---	---	1	---	MOUNT TO TRAFFIC SIGNAL, PART OF REMOVAL FOR SIGN #294
304	"	R4-7	24" X 30"	5.00	---	---	---	---	---	---	---	---	MOUNT TO TRAFFIC SIGNAL
305	LOMBARDI AVE	R1-2	36" X 31"	3.88	---	---	1	---	---	---	1	---	MOUNT TO TRAFFIC SIGNAL, PART OF REMOVAL FOR SIGN #303
306	"	R1-1F	36" X 36"	5.00	---	---	---	---	---	---	1	---	MOUNT TO TRAFFIC SIGNAL
307	"	R4-7	24" X 30"	5.00	---	---	---	---	---	---	1	---	MOUNT TO TRAFFIC SIGNAL, PART OF REMOVAL FOR SIGN #295
308	STH 32, N. OF CTH VK	W10-2	36" X 36"	---	---	9.00	---	---	---	---	1	---	MOUNT TO TRAFFIC SIGNAL
309	"	W10-1A	24" X 12"	---	---	2.00	---	---	---	---	---	---	MOUNT TO TRAFFIC SIGNAL, PART OF REMOVAL FOR SIGN #295
310	"	W10-9P	30" X 15"	---	---	3.13	---	---	---	---	---	---	MOUNT BELOW SIGN #308
310	PROJECT - 10 SIGNS FOR RAILROAD	R15-3	24" X 12"	---	---	20.00	---	---	---	---	---	---	MOUNT BELOW SIGN #309
PAGE SUBTOTALS				94.51	67.14	97.59	1	8	1	4	20	11	GIVE SIGNS TO PROJECT CONSTRUCTION LEADER
PROJECT TOTALS				1984.21	298.40	519.22	44	70	28	46	235	185	

Addendum No. 01
 ID 4190-16-71
 Revised Sheet 140
 December 7, 2016

3

SAWING (CONTINUED)		690.0150		690.0250		REMARKS	
STATION	TO STATION	LOCATION	LF	SAWING ASPHALT	SAWING CONCRETE	LF	LF
CATEGORY 0010							
SOUTHBOUND LANES							
31+00SB	- 31+00SB	STH 32	35				SB SOUTH PAVING LIMITS
58+63SB	- 59+60SB	STH 32	105				SAW CUT FOR SHOULDER WIDENING WEST SIDE
58+75SB	- 59+60SB	STH 32	90				SAW CUT FOR SHOULDER WIDENING EAST SIDE
60+80SB	- 60+96SB	STH 32	20				SAW CUT FOR SHOULDER WIDENING EAST SIDE
60+80SB	- 61+83SB	STH 32	110				SAW CUT FOR SHOULDER WIDENING WEST SIDE
75+80SB	- 75+80SB	STH 32	35				SB SOUTH RAILROAD CROSSING APPROACH
79+63SB	- 79+63SB	STH 32	35				SB NORTH RAILROAD CROSSING APPROACH
86+00SB	- 86+00SB	STH 32	35				6" PAVING LIMITS S OF HANSEN ROAD
90+00SB	- 90+00SB	STH 32	55				6" PAVING LIMITS N OF HANSEN ROAD
100+25SB	- 100+25SB	STH 32	35				6" PAVING LIMITS S OF VANDERPERREN WAY
104+25SB	- 104+25SB	STH 32	55				6" PAVING LIMITS N OF VANDERPERREN WAY
102+75SB	- 108+95SB	STH 32	620				SB LANE FOR LEFT TURN LANE
106+60SB	- 108+10SB	STH 32	150				ACCESS DRIVE TO FRONTAGE ROAD
116+00SB	- 116+00SB	STH 32	35				STAGE 5 LIMITS N OF TENNIS COURT
118+50SB	- 118+50SB	STH 32	35				6" PAVING LIMITS S OF PILGRIM WAY
122+50SB	- 122+50SB	STH 32	50				6" PAVING LIMITS N OF PILGRIM WAY
141+00SB	- 141+00SB	STH 32	35				6" PAVING LIMITS S OF CORMIER ROAD
144+50SB	- 144+50SB	STH 32	50				6" PAVING LIMITS N OF CORMIER ROAD
174+50SB	- 174+50SB	STH 32	35				6" PAVING LIMITS S OF MIKE MCCARTHY WAY
178+50SB	- 178+50SB	STH 32	50				6" PAVING LIMITS N OF MIKE MCCARTHY WAY
190+75SB	- 190+75SB	STH 32	35				6" PAVING LIMITS S OF LOMBARDI AVENUE
195+80SB	- 195+80SB	STH 32	50				SB NORTH PAVING LIMITS
SUBTOTAL SOUTHBOUND LANES			1,755			0	
SIDE ROADS							
10+35 PAR	- 10+35 PAR	PARKVIEW ROAD	35				WEST LEG OF INTERSECTION PAVING LIMITS
12+75PAR	- 12+75PAR	PARKVIEW ROAD	30				EAST LEG OF PAVING LIMITS TO W. TIMBER
21+05 BAE	- 21+05 BAE	BAETEN ROAD	50				WEST LEG OF INTERSECTION PAVING LIMITS
51+27 TEN	- 51+27 TEN	TENNIS COURT	130				WEST LEG OF INTERSECTION PAVING LIMITS
70+89 WIL	- 70+89 WIL	WILLARD DRIVE	40				WEST LEG OF INTERSECTION PAVING LIMITS
87+73 MOR	- 87+73 MOR	MORRIS AVENUE	45				WEST LEG OF INTERSECTION PAVING LIMITS
40+52 VAN	- 41+25 VAN	VANDERPERREN ROAD	--			410	WEST LEG OF INTERSECTION
80+40 COR	- 81+25 COR	CORMIER ROAD	--			360	WEST LEG OF INTERSECTION
SUBTOTAL SIDE ROADS			330			770	
TOTAL			4,683			915	

SAWING		690.0150		690.0250		REMARKS	
STATION	TO STATION	LOCATION	LF	SAWING ASPHALT	SAWING CONCRETE	LF	LF
CATEGORY 0010							
NORTHBOUND LANES							
29+00NB	- 29+00NB	STH 32	35				NB SOUTH PAVING LIMITS
38+01NB	- 44+01NB	STH 32	616				RIGHT TURN LANE EXTENSION TO PARKVIEW ROAD
44+49NB	- 44+53NB	STH 32	20			5	CURB AND GUTTER REMOVAL AT PARKVIEW MEDIAN
58+49NB	- 59+60NB	STH 32	120				SAW CUT FOR SHOULDER WIDENING EAST SIDE
59+25NB	- 59+60NB	STH 32	40				SAW CUT FOR SHOULDER WIDENING WEST SIDE
60+80NB	- 61+41NB	STH 32	70				SAW CUT FOR SHOULDER WIDENING EAST SIDE
60+80NB	- 61+63NB	STH 32	90				SAW CUT FOR SHOULDER WIDENING WEST SIDE
63+90NB	- 64+00NB	STH 32	25			5	CURB AND GUTTER REMOVAL AT BAETEN ROAD MEDIAN
76+25NB	- 76+25NB	STH 32	35				NB SOUTH RAILROAD CROSSING APPROACH
80+21NB	- 80+21NB	STH 32	35				NB NORTH RAILROAD CROSSING APPROACH
86+00NB	- 86+00NB	STH 32	50				6" PAVING LIMITS S OF HANSEN ROAD
90+00NB	- 90+00NB	STH 32	35				6" PAVING LIMITS N OF HANSEN ROAD
100+25NB	- 100+25NB	STH 32	50				6" PAVING LIMITS S OF VANDERPERREN WAY
102+13NB	- 102+20NB	STH 32	--			5	CURB AND GUTTER REMOVAL AT VANDERPERREN
102+75NB	- 108+95NB	STH 32	620				NB LANE FOR LEFT TURN LANE
102+75NB	- 102+75NB	STH 32	50				LEFT TURN LANE SOUTH LIMITS
104+25NB	- 104+25NB	STH 32	35				6" PAVING LIMITS N OF VANDERPERREN WAY
116+00NB	- 116+00NB	STH 32	35				STAGE 5 LIMITS N OF TENNIS COURT
118+50NB	- 118+50NB	STH 32	55				6" PAVING LIMITS S OF PILGRIM WAY
119+02NB	- 120+05NB	STH 32	230				PILGRIM WAY CURB REPLACEMENT NB LEFT TURN LANE
121+17NB	- 121+24NB	STH 32	45			10	MEDIAN CURB & GUTTER AND ISLAND FOR PED XING
122+50NB	- 122+50NB	STH 32	35				6" PAVING LIMITS N OF PILGRIM WAY
141+00NB	- 141+00NB	STH 32	55				6" PAVING LIMITS S OF CORMIER ROAD
144+50NB	- 144+50NB	STH 32	35				6" PAVING LIMITS N OF CORMIER ROAD
174+50NB	- 174+50NB	STH 32	55				6" PAVING LIMITS S OF MIKE MCCARTHY WAY
175+46NB	- 175+61NB	STH 32	--			50	EAST LEG OF MIKE MCCARTHY WAY INTERSECTION
175+95NB	- 176+15NB	STH 32	--			70	EAST LEG OF MIKE MCCARTHY WAY INTERSECTION
178+50NB	- 178+50NB	STH 32	35				6" PAVING LIMITS N OF MIKE MCCARTHY WAY
190+75NB	- 190+75NB	STH 32	57				6" PAVING LIMITS S OF LOMBARDI AVENUE
195+00NB	- 195+00NB	STH 32	35				NB NORTH PAVING LIMITS
SUBTOTAL NORTHBOUND LANES			2,598			145	

TOTAL 4,683 915

MISCELLANEOUS QUANTITIES

COUNTY: BROWN

HWY: STH 32

PROJECT NO: 4190-16-71

SHEET: 140

E

FILE NAME: PLOT BY: DUNS, ALEXANDER T PLOT DATE: PLOT SCALE: 1:1

3

SIGN W10-9P

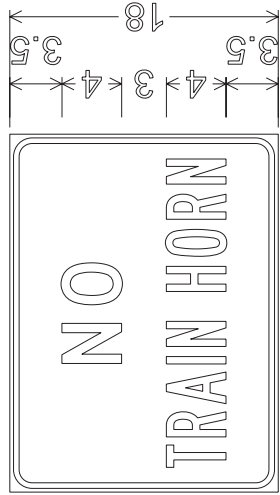

8.625 | 6.75 | 8.625

← 9.875 → | 8.875 |

1.625 2 24 1.625

1.500" Radius, 0.375" Border, 0.250" Indent

⁶⁶NO⁹⁹ D;

⁶⁶TRAIN⁹⁹ B; ⁶⁶HORN⁹⁹ B

NOTES

1. Sign is Type II - Type F Reflective
2. Color:
Background - Yellow
Message - Black
3. Message Series - As noted

7

7

Addendum No. 01
ID 4190-16-71
Added Sheet 251A
December 7, 2016

NB Ashwaubenon Creek Bridge

STATION	AREA (SF)		Incremental Vol (CY) (Unadjusted)				Cumulative Vol (CY)			Mass Ordinate
	Cut	Salvaged/Unusable Pavement Material	Fill	Cut	Salvaged/Unusable Pavement Material	Fill	Cut	Salvaged/Unusable Pavement Material	Expanded Fill 1.25	
53+21.13	0.00	0	0.00	0	0	0	0	0	0	0.00
53+25	0.00	0	0.01	0	0	0	0	0	0	0.00
53+50	0.00	0	0.00	0	0	0	0	0	0	0.00
53+75	0.00	0	0.05	0	0	0	0	0	0	-0.03
54+00	0.00	0	1.56	0	0	1	0	0	1	-0.96
54+25	0.00	0	0.09	0	0	1	0	0	2	-1.92
54+39.68	0.00	0	3.38	0	0	1	0	0	3	-3.10
54+50	0.00	0	2.60	0	0	1	0	0	5	-4.53
54+65	0.00	0	0.11	0	0	1	0	0	5	-5.47
54+75	0.00	0	0.08	0	0	0	0	0	6	-5.52
54+90	0.00	0	0.03	0	0	0	0	0	6	-5.55
55+00	0.00	0	0.09	0	0	0	0	0	6	-5.58
55+25	0.00	0	0.44	0	0	0	0	0	6	-5.88
55+47.62	0.00	0	0.00	0	0	0	0	0	6	-5.88
55+50	0.00	0	0.00	0	0	0	0	0	6	-6.14
55+75	0.00	0	0.00	0	0	0	0	0	6	-6.14
56+00	0.00	0	0.01	0	0	0	0	0	6	-6.14
56+25	0.00	0	0.00	0	0	0	0	0	6	-6.14
56+50	0.00	0	0.00	0	0	0	0	0	6	-6.14
56+66.06	0.00	0	0.42	0	0	0	0	0	6	-6.14
56+75	0.00	0	0.00	0	0	0	0	0	6	-6.14
57+00	0.00	0	0.17	0	0	0	0	0	6	-6.24
57+25	0.00	0	2.51	0	0	1	0	0	8	-7.79
57+50	0.00	0	5.39	0	0	4	0	0	12	-12.29
57+75	0.00	0	6.09	0	0	5	0	0	19	-18.56
58+00	0.00	0	8.74	0	0	6	0	0	27	-26.54
58+25	0.00	0	10.39	0	0	9	0	0	38	-37.79
58+50	24.87	0	10.15	13	0	10	13	0	50	-36.95
58+75	22.98	0	19.48	22	0	14	35	0	68	-32.29
59+00	19.43	0	39.86	20	0	27	55	0	102	-46.40
59+25	34.14	0	68.29	16	0	50	71	0	164	-92.74
59+50	31.41	0	106.29	14	0	81	85	0	265	-179.80
59+55	29.99	0	123.79	3	0	22	88	0	293	-204.54
60+85.92	19.16	0	100.95	0	0	0	88	0	293	-204.54
61+00	19.25	0	48.18	10	0	39	98	0	341	-243.16
61+25	20.48	0	3.56	18	0	24	116	0	371	-255.10
61+50	5.89	0	0.00	12	0	2	128	0	373	-245.16
61+62	3.83	0	0.00	2	0	0	130	0	373	-243.16

Addendum No. 01
ID 4190-16-71
Revised Sheet 331
December 7, 2016

SB Ashwaubenon Creek Bridge

STATION	AREA (SF)		Incremental Vol (CY) (Unadjusted)			Cumulative Vol (CY)			Mass Ordinate
	Cut	Salvaged/Unusable Pavement Material	Fill	Cut	Salvaged/Unusable Pavement Material	Fill	Cut	Salvaged/Unusable Pavement Material	
55+63.73	0.00	0	0.00	0	0	0	0	0	0.00
55+75	0.00	0	0.00	0	0	0	0	0	0.00
56+00	0.00	0	0.00	0	0	0	0	0	0.00
56+25	0.00	0	0.01	0	0	0	0	0	-0.01
56+50	0.00	0	0.01	0	0	0	0	0	-0.02
56+75	0.00	0	0.02	0	0	0	0	0	-0.04
57+00	0.00	0	0.14	0	0	0	0	0	-0.13
57+25	0.00	0	0.57	0	0	0	0	1	-0.55
57+50	0.00	0	1.44	0	0	1	0	2	-1.71
57+75	0.00	0	4.28	0	0	3	0	5	-5.03
58+00	0.00	0	7.02	0	0	5	0	12	-11.57
58+25	0.00	0	5.90	0	0	6	0	19	-19.04
58+50	0.00	0	3.67	0	0	4	0	25	-24.58
58+75	43.98	0	6.76	30	0	5	30	31	-0.61
59+00	41.67	0	12.32	38	0	9	68	42	26.34
59+25	36.98	0	35.92	36	0	22	104	70	34.43
59+50	29.64	0	98.03	31	0	62	135	147	-12.08
59+75	0.00	0	0.00	0	0	45	135	204	-68.81
60+00	0.00	0	0.00	0	0	0	135	204	-68.81
60+25	0.00	0	0.00	0	0	0	135	204	-68.81
60+50	0.00	0	0.00	0	0	0	135	204	-68.81
60+75	0.00	0	0.00	0	0	0	135	204	-68.81
61+00	17.74	0	75.38	9	0	35	144	247	-103.44
61+25	20.18	0	34.86	18	0	51	162	311	-149.24
61+50	23.11	0	17.49	20	0	24	182	342	-159.54
61+75	27.97	0	6.87	24	0	11	206	356	-149.63
62+00	0.00	0	3.03	0	0	5	206	361	-155.36
62+25	0.00	0	0.80	0	0	2	206	364	-157.58
62+50	0.00	0	1.90	0	0	1	206	365	-159.14
62+75	0.00	0	8.06	0	0	5	206	371	-164.90
63+00	0.00	0	7.98	0	0	7	206	380	-174.19
63+15.37	0.00	0	5.28	0	0	4	206	385	-178.90

Addendum No. 01
ID 4190-16-71
Revised Sheet 332
December 7, 2016

Addendum No. 01
 ID 4190-16-71
 Revised Sheet 333
 December 7, 2016

Railroad Crossing NB and SB

STATION	AREA (SF)			Incremental Vol (CY) (Unadjusted)			Cumulative Vol (CY)			Mass Ordinate
	Cut	Salvaged/Unusable Pavement Material	Fill	Cut	Salvaged/Unusable Pavement Material	Fill	Cut	Salvaged/Unusable Pavement Material	Expanded Fill 1.25	
77+25	110.00	52.00	0.00	0	0	0	0	0	0	0.00
77+35	110.00	52.00	0.00	41	19	0	41	19	0	21.48
77+50	110.00	52.00	19.85	61	29	0	102	48	0	53.70
77+75	113.00	52.00	23.81	103	48	0	205	96	0	108.80
78+00	222.00	52.00	10.39	155	48	0	360	144	0	215.74
78+04	220.80	52.00	10.22	36	9	0	397	153	0	243.53
78+10	221.83	52.00	8.86	49	12	0	446	165	0	281.16
78+25	245.29	52.00	0.00	126	28	0	572	193	0	379.13
78+50	249.78	52.00	0.00	229	48	0	801	241	0	560.18
78+73	226.27	52.00	25.89	204	45	0	1,005	285	0	719.75
78+75	112.70	52.00	1.57	12	4	0	1,017	289	0	727.76
78+81	112.07	52.00	2.20	23	11	0	1,040	299	0	740.06
79+00	115.44	52.00	23.56	82	38	0	1,122	337	0	784.66
79+25	121.58	52.00	22.28	110	48	0	1,231	385	0	846.25
79+50	116.99	52.00	0.00	110	48	0	1,342	433	0	908.54

Right Turn Lane Parkway

STATION	AREA (SF)			Incremental Vol (CY) (Unadjusted)			Cumulative Vol (CY)			Mass Ordinate
	Cut	Salvaged/Unusable Pavement Material	Fill	Cut	Salvaged/Unusable Pavement Material	Fill	Cut	Salvaged/Unusable Pavement Material	Expanded Fill 1.25	
38+25	25.01	0	0.02	0	0	0	0	0	0	0.00
38+50	24.88	0	0.19	23	0	0	23	0	0	22.98
38+75	24.25	0	0.76	23	0	0	46	0	1	45.17
39+00	23.76	0	3.97	22	0	2	68	0	3	64.66
39+25	23.76	0	9.95	22	0	6	90	0	11	78.60
39+50	24.57	0	14.18	22	0	11	112	0	25	87.01
39+75	24.48	0	12.13	23	0	12	135	0	41	94.49
40+00	27.32	0	6.60	24	0	9	159	0	51	107.64
40+25	25.79	1	8.98	25	0	7	184	0	61	122.83
40+50	24.14	1	9.86	23	1	9	207	1	71	134.02
40+75	25.44	2	4.73	23	2	7	230	3	80	146.93
41+00	29.42	3	0.73	25	2	3	255	5	83	166.96
41+25	25.87	3	3.59	26	3	2	281	8	86	187.26
41+50	26.63	4	2.86	24	3	3	305	11	89	204.51
41+75	27.94	5	2.11	25	4	2	330	15	92	223.01
42+00	27.90	5	2.41	26	4	2	356	20	95	241.84
42+25	28.22	6	2.21	26	5	2	382	25	97	260.22
42+50	28.39	6	1.81	26	5	2	408	30	100	278.85
42+75	28.55	6	1.44	26	5	2	435	35	102	298.04
43+00	28.68	6	0.98	26	5	1	461	40	103	317.84
43+25	28.87	6	0.54	27	5	1	488	46	104	338.31
43+50	28.96	6	0.27	27	5	0	515	51	104	359.33
43+75	28.88	6	0.16	27	5	0	541	56	105	380.56
44+00	29.31	6	0.05	27	5	0	568	62	105	402.08

Addendum No. 01
 ID 4190-16-71
 Added Sheet 334A
 December 7, 2016

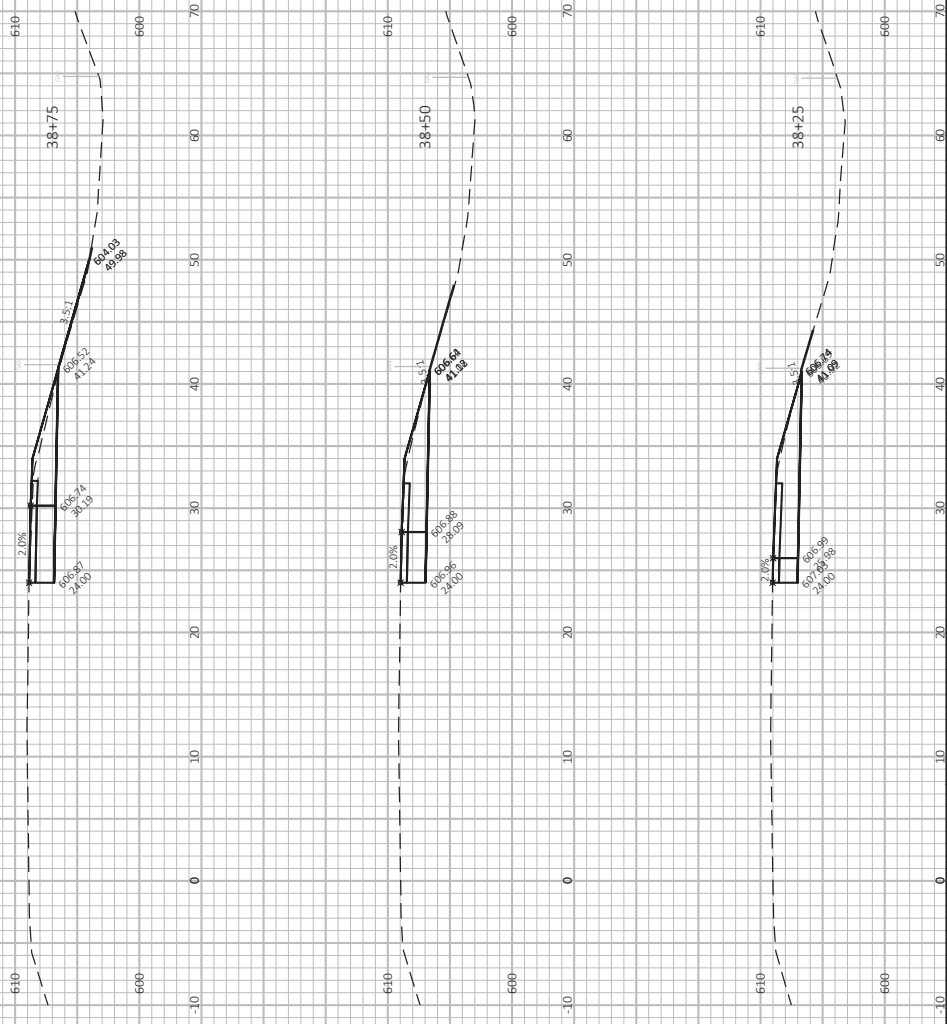

Addendum No. 01
 ID 4190-16-71
 Added Sheet 334B
 December 7, 2016

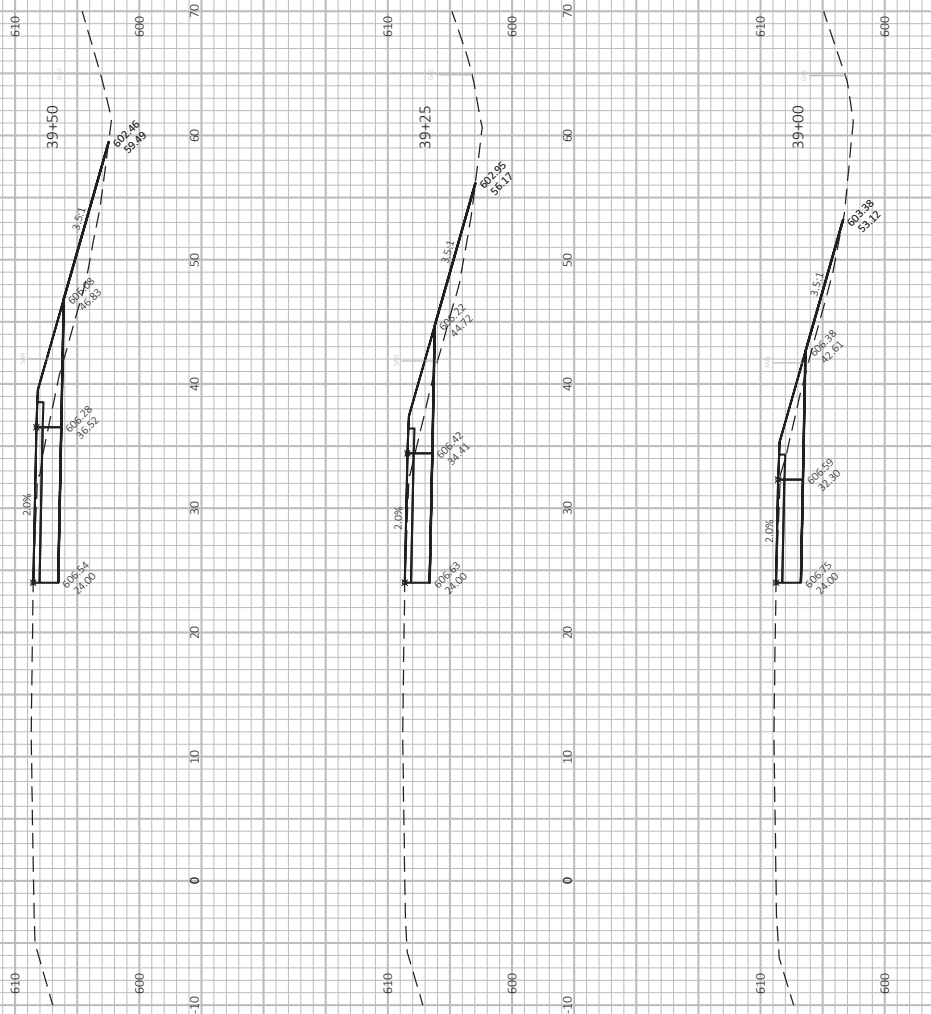

Addendum No. 01
 ID 4190-16-71
 Added Sheet 334C
 December 7, 2016

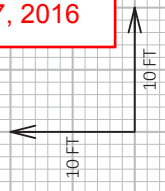
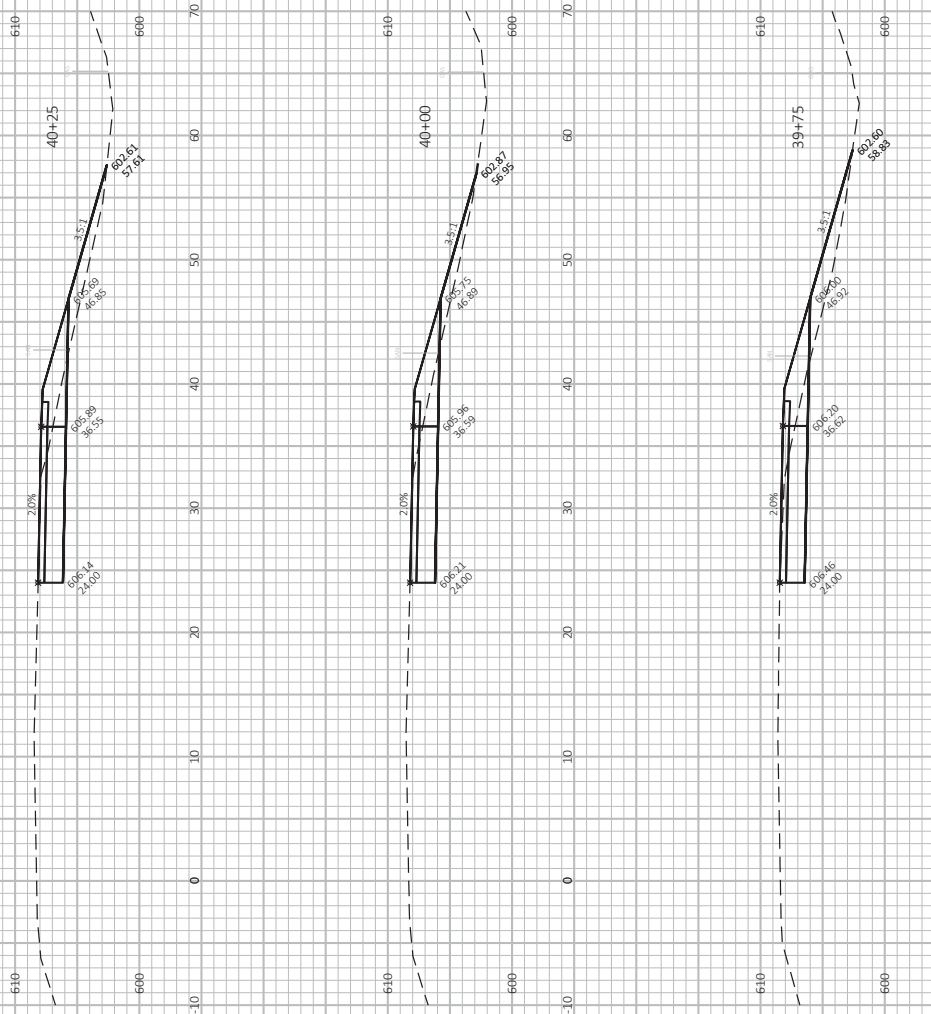

Addendum No. 01
 ID 4190-16-71
 Added Sheet 334D
 December 7, 2016

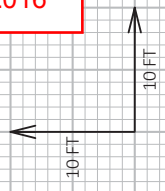
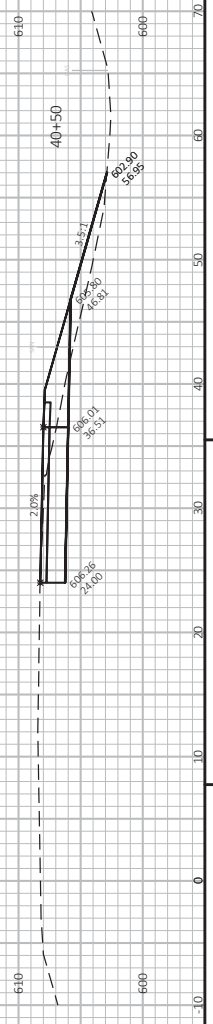
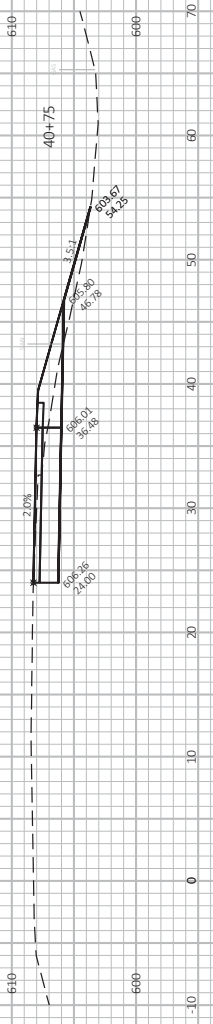
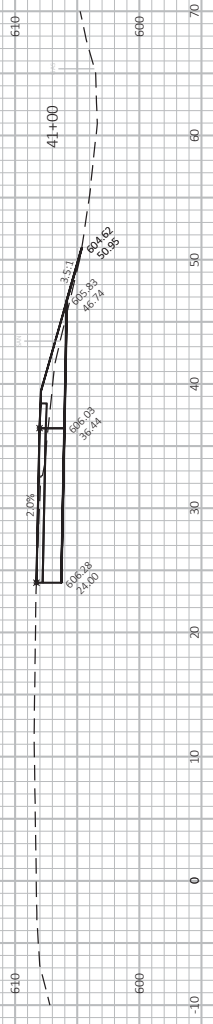

Addendum No. 01
ID 4190-16-71
Added Sheet 334E
December 7, 2016

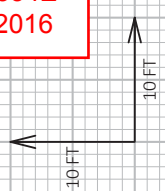
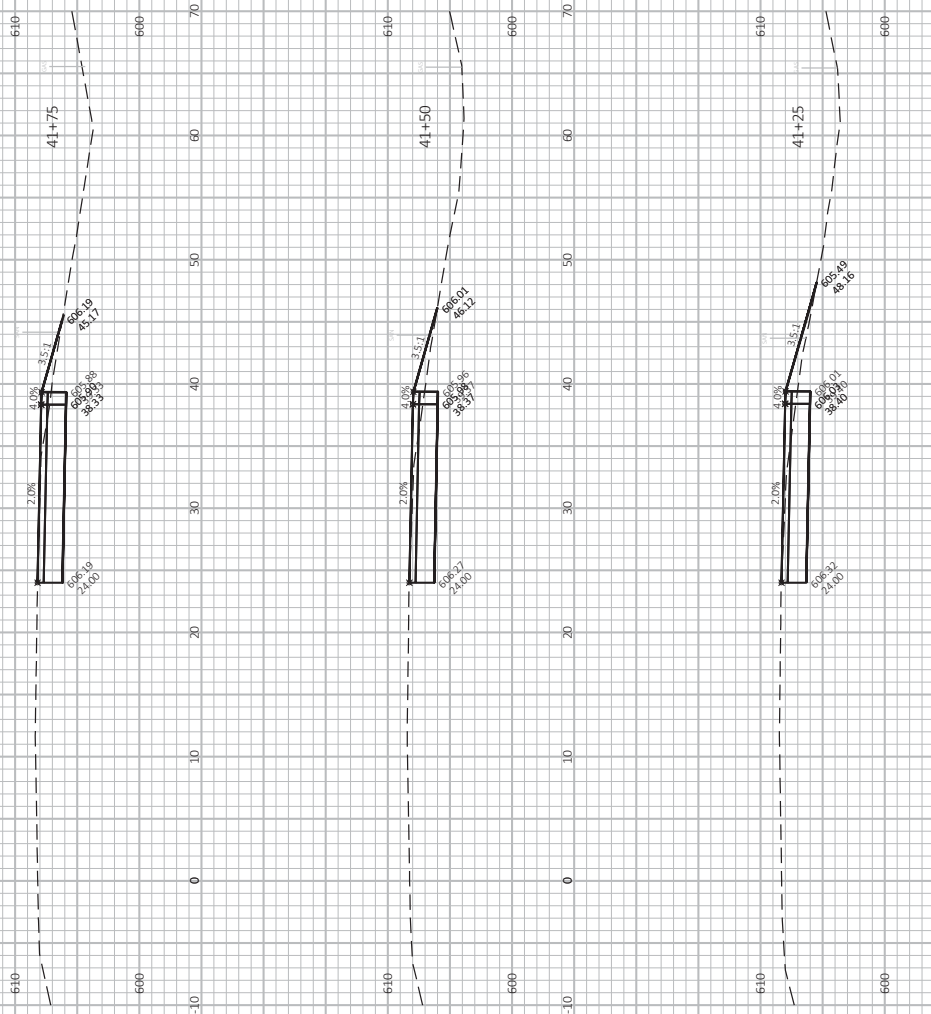

Addendum No. 01
 ID 4190-16-71
 Added Sheet 334F
 December 7, 2016

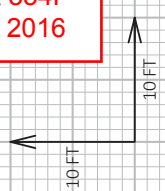
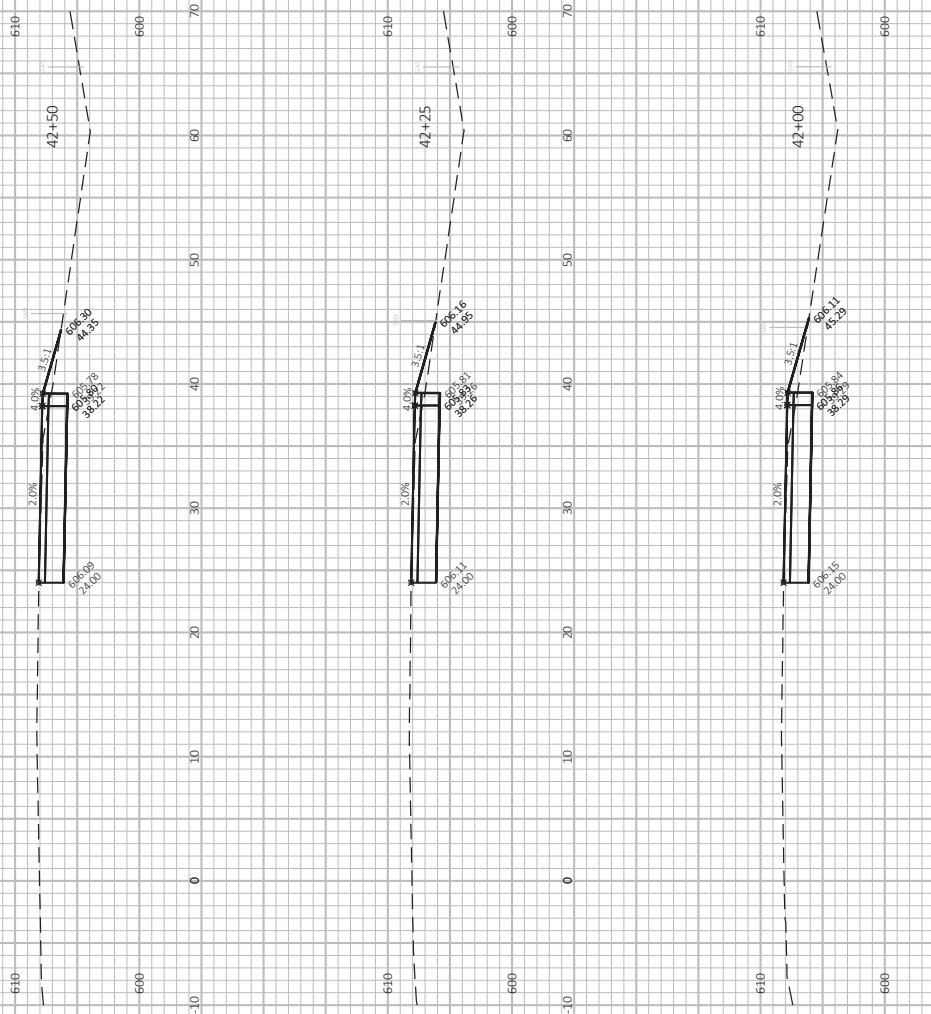

Addendum No. 01
 ID 4190-16-71
 Added Sheet 334G
 December 7, 2016

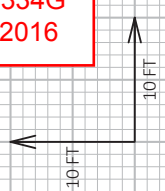
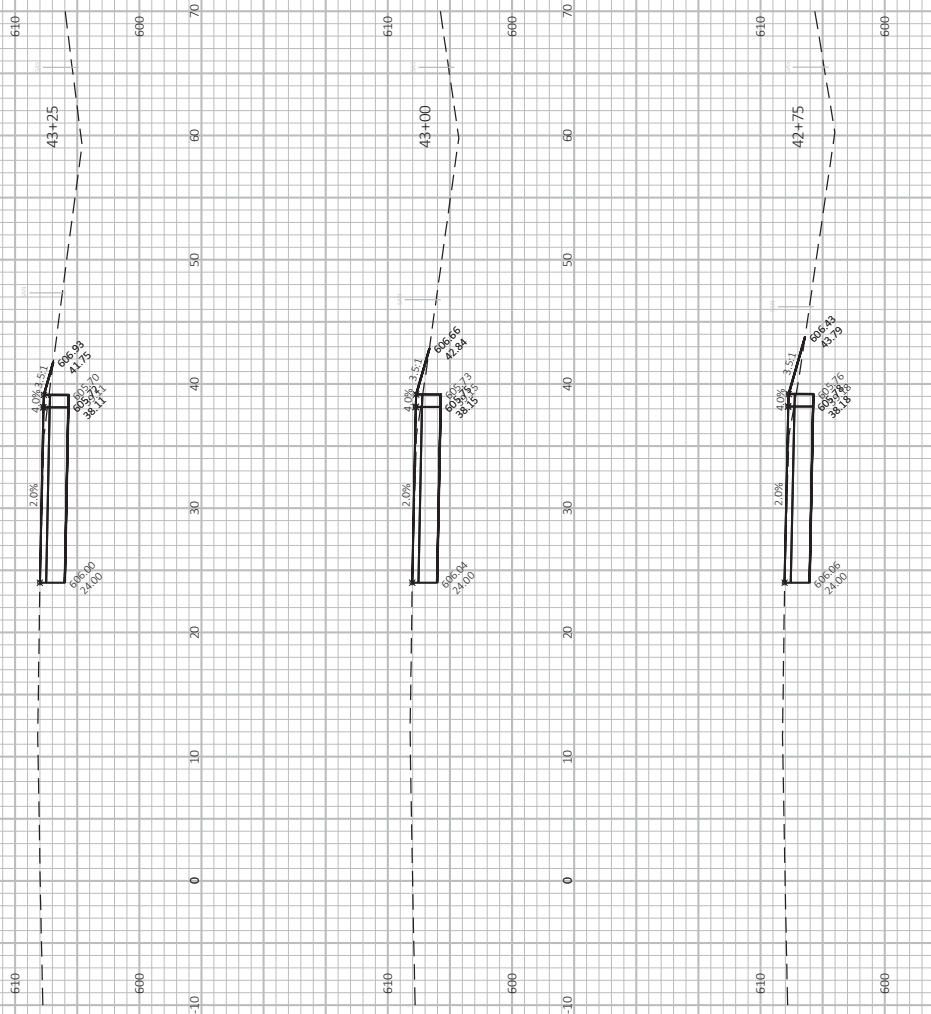

Addendum No. 01
 ID 4190-16-71
 Added Sheet 334H
 December 7, 2016

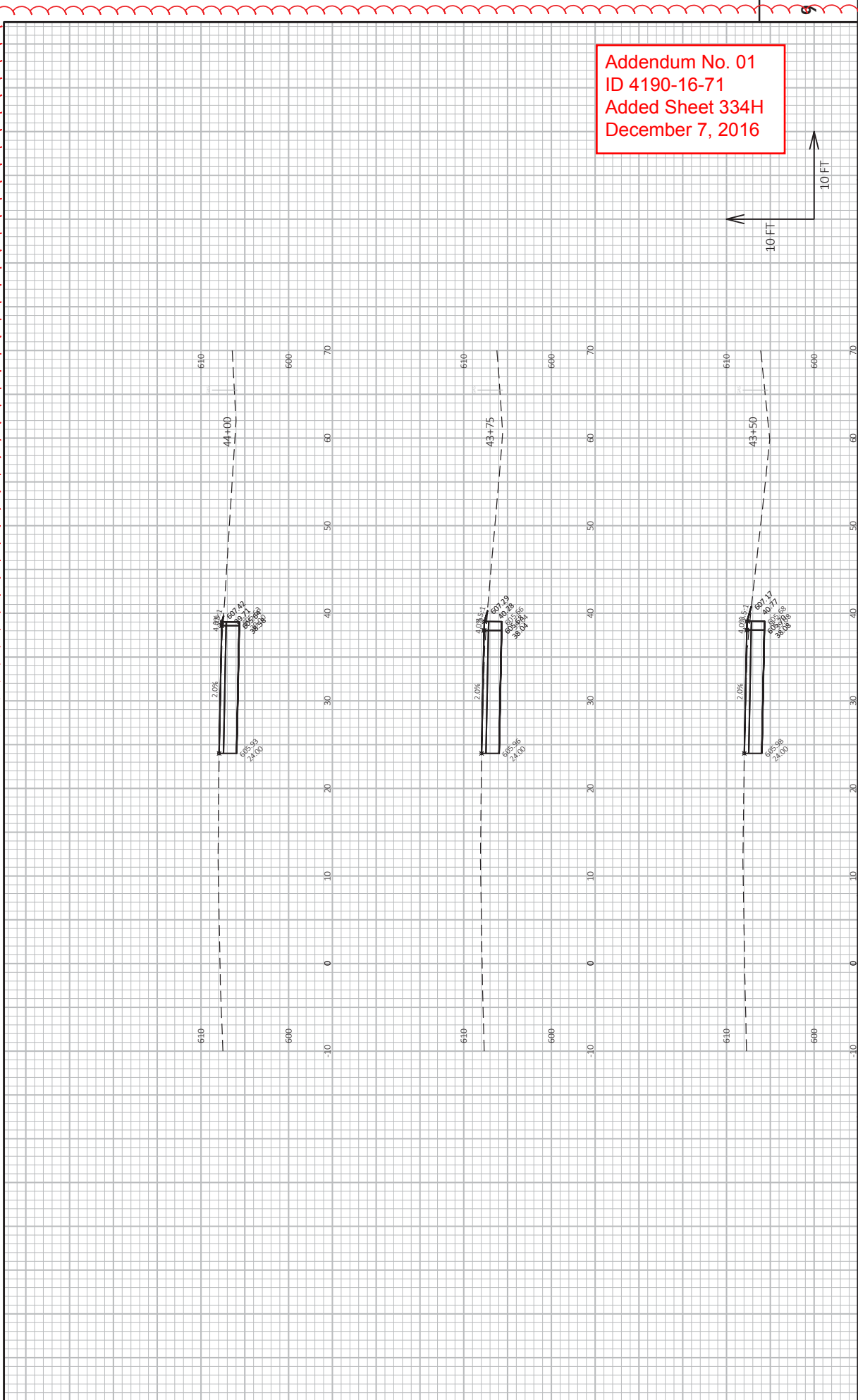



Proposal Schedule of Items

Proposal ID: 20161213025

Project(s): 4190-16-71, 4190-16-72

SECTION: 0001 Contract Items

Alt Set ID: Alt Mbr ID:

Proposal Line Number	Item ID Description	Approximate Quantity and Units	Unit Price	Bid Amount
0010	203.0100 Removing Small Pipe Culverts	3.000 EACH	_____.	_____.
0020	203.0200 Removing Old Structure (station) 01. STA 129+53	LS	LUMP SUM	_____.
0030	203.0600.S Removing Old Structure Over Waterway With Minimal Debris (station) 01. STA 60+25 NB	LS	LUMP SUM	_____.
0040	203.0600.S Removing Old Structure Over Waterway With Minimal Debris (station) 01. STA 60+25 SB	LS	LUMP SUM	_____.
0050	204.0100 Removing Pavement	952.000 SY	_____.	_____.
0060	204.0115 Removing Asphaltic Surface Butt Joints	361.000 SY	_____.	_____.
0070	204.0120 Removing Asphaltic Surface Milling	144,770.000 SY	_____.	_____.
0080	204.0150 Removing Curb & Gutter	175.000 LF	_____.	_____.
0090	204.0195 Removing Concrete Bases	19.000 EACH	_____.	_____.
0100	204.0220 Removing Inlets	1.000 EACH	_____.	_____.
0110	205.0100 Excavation Common	3,350.000 CY	_____.	_____.
0120	206.1000 Excavation for Structures Bridges (structure) 01. B-5-408	LS	LUMP SUM	_____.
0130	206.1000 Excavation for Structures Bridges (structure) 01. B-5-409	LS	LUMP SUM	_____.
0140	206.2000 Excavation for Structures Culverts (structure) 01. B-5-35	LS	LUMP SUM	_____.
0150	206.5000 Cofferdams (structure) 01. B-5-35	LS	LUMP SUM	_____.



Proposal Schedule of Items

Proposal ID: 20161213025

Project(s): 4190-16-71, 4190-16-72

SECTION: 0001 Contract Items

Alt Set ID: Alt Mbr ID:

Proposal Line Number	Item ID Description	Approximate Quantity and Units	Unit Price	Bid Amount
0160	208.0100 Borrow	868.000 CY	_____	_____
0170	210.1500 Backfill Structure Type A	1,600.000 TON	_____	_____
0180	210.2500 Backfill Structure Type B	820.000 TON	_____	_____
0190	213.0100 Finishing Roadway (project) 01. 4190-16-71	1.000 EACH	_____	_____
0200	305.0110 Base Aggregate Dense 3/4-Inch	892.000 TON	_____	_____
0210	305.0120 Base Aggregate Dense 1 1/4-Inch	3,511.000 TON	_____	_____
0220	305.0500 Shaping Shoulders	560.000 STA	_____	_____
0230	312.0110 Select Crushed Material	1,200.000 TON	_____	_____
0240	415.0120 Concrete Pavement 12-Inch	108.000 SY	_____	_____
0250	415.0410 Concrete Pavement Approach Slab	160.000 SY	_____	_____
0260	416.0610 Drilled Tie Bars	307.000 EACH	_____	_____
0270	416.0620 Drilled Dowel Bars	97.000 EACH	_____	_____
0280	416.1715 Concrete Pavement Repair SHES	42.000 SY	_____	_____
0290	416.1725 Concrete Pavement Replacement SHES	910.000 SY	_____	_____
0300	440.4410 Incentive IRI Ride	25,280.000 DOL	1.00000	25,280.00
0310	455.0605 Tack Coat	8,135.000 GAL	_____	_____
0320	460.2000 Incentive Density HMA Pavement	32,620.000 DOL	1.00000	32,620.00



Proposal Schedule of Items

Proposal ID: 20161213025

Project(s): 4190-16-71, 4190-16-72

SECTION: 0001 Contract Items

Alt Set ID: Alt Mbr ID:

Proposal Line Number	Item ID Description	Approximate Quantity and Units	Unit Price	Bid Amount
0330	460.2010 Incentive Air Voids HMA Pavement	28,170.000 DOL	1.00000	28,170.00
0340	460.4110.S Reheating HMA Pavement Longitudinal Joints	135,241.000 LF	_____.	_____.
0350	460.5223 HMA Pavement 3 LT 58-28 S	3,277.000 TON	_____.	_____.
0360	460.5224 HMA Pavement 4 LT 58-28 S	2,334.000 TON	_____.	_____.
0370	460.6223 HMA Pavement 3 MT 58-28 S	19,197.000 TON	_____.	_____.
0380	460.6424 HMA Pavement 4 MT 58-28 H	12,377.000 TON	_____.	_____.
0390	465.0105 Asphaltic Surface	510.000 TON	_____.	_____.
0400	465.0110 Asphaltic Surface Patching	200.000 TON	_____.	_____.
0410	502.0100 Concrete Masonry Bridges	594.000 CY	_____.	_____.
0420	502.3200 Protective Surface Treatment	896.000 SY	_____.	_____.
0430	502.3210 Pigmented Surface Sealer	218.000 SY	_____.	_____.
0440	503.0146 Prestressed Girder Type I 45W-Inch	960.000 LF	_____.	_____.
0450	504.0100 Concrete Masonry Culverts	48.000 CY	_____.	_____.
0460	505.0400 Bar Steel Reinforcement HS Structures	12,250.000 LB	_____.	_____.
0470	505.0600 Bar Steel Reinforcement HS Coated Structures	74,780.000 LB	_____.	_____.
0480	506.2605 Bearing Pads Elastomeric Non-Laminated	20.000 EACH	_____.	_____.



Proposal Schedule of Items

Proposal ID: 20161213025

Project(s): 4190-16-71, 4190-16-72

SECTION: 0001

Contract Items

Alt Set ID:

Alt Mbr ID:

Proposal Line Number	Item ID Description	Approximate Quantity and Units	Unit Price	Bid Amount
0800	614.0905 Crash Cushions Temporary	1.000 EACH	_____	_____
0810	614.0920 Salvaged Rail	4,153.000 LF	_____	_____
0820	614.2300 MGS Guardrail 3	2,813.000 LF	_____	_____
0830	614.2500 MGS Thrie Beam Transition	200.000 LF	_____	_____
0840	614.2610 MGS Guardrail Terminal EAT	8.000 EACH	_____	_____
0850	614.2620 MGS Guardrail Terminal Type 2	5.000 EACH	_____	_____
0860	619.1000 Mobilization	1.000 EACH	_____	_____
0870	620.0300 Concrete Median Sloped Nose	150.000 SF	_____	_____
0880	624.0100 Water	63.000 MGAL	_____	_____
0890	625.0500 Salvaged Topsoil	3,485.000 SY	_____	_____
0900	628.1104 Erosion Bales	30.000 EACH	_____	_____
0910	628.1504 Silt Fence	5,910.000 LF	_____	_____
0920	628.1520 Silt Fence Maintenance	5,910.000 LF	_____	_____
0930	628.1905 Mobilizations Erosion Control	6.000 EACH	_____	_____
0940	628.1910 Mobilizations Emergency Erosion Control	3.000 EACH	_____	_____
0950	628.2002 Erosion Mat Class I Type A	1,845.000 SY	_____	_____
0960	628.2023 Erosion Mat Class II Type B	1,640.000 SY	_____	_____



Proposal Schedule of Items

Proposal ID: 20161213025

Project(s): 4190-16-71, 4190-16-72

SECTION: 0001

Contract Items

Alt Set ID:

Alt Mbr ID:

Proposal Line Number	Item ID Description	Approximate Quantity and Units	Unit Price	Bid Amount
0970	628.7015 Inlet Protection Type C	11.000 EACH	_____.	_____.
0980	628.7504 Temporary Ditch Checks	20.000 LF	_____.	_____.
0990	628.7555 Culvert Pipe Checks	10.000 EACH	_____.	_____.
1000	628.7570 Rock Bags	50.000 EACH	_____.	_____.
1010	629.0210 Fertilizer Type B	2.300 CWT	_____.	_____.
1020	630.0140 Seeding Mixture No. 40	63.000 LB	_____.	_____.
1030	630.0200 Seeding Temporary	94.000 LB	_____.	_____.
1040	633.5200 Markers Culvert End	23.000 EACH	_____.	_____.
1050	634.0612 Posts Wood 4x6-Inch X 12-FT	44.000 EACH	_____.	_____.
1060	634.0614 Posts Wood 4x6-Inch X 14-FT	70.000 EACH	_____.	_____.
1070	634.0616 Posts Wood 4x6-Inch X 16-FT	28.000 EACH	_____.	_____.
1080	634.0618 Posts Wood 4x6-Inch X 18-FT	46.000 EACH	_____.	_____.
1090	637.2210 Signs Type II Reflective H	1,984.210 SF	_____.	_____.
1100	637.2215 Signs Type II Reflective H Folding	298.400 SF	_____.	_____.
1110	637.2230 Signs Type II Reflective F	519.220 SF	_____.	_____.
1120	638.2602 Removing Signs Type II	235.000 EACH	_____.	_____.
1130	638.3000 Removing Small Sign Supports	185.000 EACH	_____.	_____.



Proposal Schedule of Items

Proposal ID: 20161213025

Project(s): 4190-16-71, 4190-16-72

SECTION: 0001 Contract Items

Alt Set ID: Alt Mbr ID:

Proposal Line Number	Item ID Description	Approximate Quantity and Units	Unit Price	Bid Amount
1930	658.0610 Led Modules 12-Inch Green Ball	40.000 EACH	_____.	_____.
1940	658.0615 Led Modules 12-Inch Red Arrow	29.000 EACH	_____.	_____.
1950	658.0620 Led Modules 12-Inch Yellow Arrow	62.000 EACH	_____.	_____.
1960	658.0625 Led Modules 12-Inch Green Arrow	33.000 EACH	_____.	_____.
1970	658.0635 Led Modules Pedestrian Countdown Timer 16-Inch	1.000 EACH	_____.	_____.
1980	658.5069 Signal Mounting Hardware (location) 01. STH 32 and Lombardi Avenue	LS	LUMP SUM	_____.
1990	658.5069 Signal Mounting Hardware (location) 02. STH 32 and Potts Avenue	LS	LUMP SUM	_____.
2000	658.5069 Signal Mounting Hardware (location) 03. STH 32 and Cormier Road	LS	LUMP SUM	_____.
2010	658.5069 Signal Mounting Hardware (location) 04. STH 32 and Pilgrim Way	LS	LUMP SUM	_____.
2020	658.5069 Signal Mounting Hardware (location) 05. STH 32 and Vanderperren Way	LS	LUMP SUM	_____.
2030	658.5069 Signal Mounting Hardware (location) 06. STH 32 and Hansen Road	LS	LUMP SUM	_____.
2040	659.1120 Luminaires Utility LED B	12.000 EACH	_____.	_____.
2050	690.0150 Sawing Asphalt	4,683.000 LF	_____.	_____.
2060	690.0250 Sawing Concrete	915.000 LF	_____.	_____.
2070	715.0415 Incentive Strength Concrete Pavement	500.000 DOL	1.00000	500.00

