



Wisconsin Department of Transportation

Division of Transportation Systems Development

Bureau of Project Development
4802 Sheboygan Avenue, Rm 601
P O Box 7916
Madison, WI 53707-7916

March 8, 2017

Telephone: (608) 266-1631
Facsimile (FAX): (608) 266-8459

NOTICE TO ALL CONTRACTORS:

Proposal #01: 1005-10-75
Illinois State Line - Madison
Manogue Road Bridge/Apprs B-53-0350
IH 39
Rock County

Letting of March 14, 2017

This is Addendum No. 01, which provides for the following:

Special Provisions:

Revised Special Provisions	
Article No.	Description
3	Prosecution and Progress
5	Traffic

Schedule of Items:

Revised Bid Item Quantities					
Bid Item	Item Description	Unit	Old Quantity	Revised Quantity	Proposal Total
455.0605	Tack Coat	GAL	900	1,110	1,110
460.2000	Incentive Density HMA Pavement	DOL	2,000	2,250	2,250
460.7624	HMA Pavement 4 HT 58-28 V	TON	470	820	820
522.0530	Culvert Pipe Reinf. Conc. Class V 30-Inch	LF	333	310	310
643.0300	Traffic Control Drums	DAYS	13,000	13,400	13,400
643.0715	Traffic Control Warning Lights Type C	DAYS	2,650	2,800	2,800
643.0800	Traffic Control Arrow Boards	DAYS	550	560	560
643.0900	Traffic Control Signs	DAYS	7,750	7,850	7,850
643.1050	Traffic Control Signs PCMS	DAYS	580	600	600
643.1055.S	Truck or Trailer-Mounted Attenuator	DAYS	11	15	15

Added Bid Item Quantities					
Bid Item	Item Description	Unit	Old Quantity	Revised Quantity	Proposal Total
204.0120	Removing Asphaltic Surface Milling	SY	0	3,140	3,140
416.1715	Concrete Pavement Repair SHES	SY	0	18	18

Plan Sheets:

Revised Plan Sheets	
Plan Sheet	Plan Sheet Title (brief description of changes to sheet)
2	General Notes: add 2-inch overlay to HMA table
4	Typical Sections: revise label on Maintenance Driveway Finished Section
20	Plan Details: revise culvert pipe location
25	Erosion Control: revise culvert pipe location
27	Erosion Control: revise culvert pipe location
71	Miscellaneous Quantities: add removing asphaltic surface milling quantity
72	Miscellaneous Quantities: revise culvert pipe and HMA quantity and add concrete pavement repair SHES quantity
74	Miscellaneous Quantities: revise traffic control quantities
75	Plan and Profile: revise culvert pipe location

Added Plan Sheets	
Plan Sheet	Plan Sheet Title (brief description of why sheet was added)
29A	Traffic Control Stage A Overview: stage added for removal of existing rumble strips
29B	Traffic Control Stage A Typical Section: stage added for removal of existing rumble strips

The responsibility for notifying potential subcontractors and suppliers of these changes remains with the prime contractor.

Sincerely,

Mike Coleman

Proposal Development Specialist
Proposal Management Section

ADDENDUM NO. 01
PROJECT ID 1005-10-75
March 8, 2017

Special Provisions

3. Prosecution and Progress.

*Add the following section above section title **Stage 1**:*

Stage A

- Mill and overlay rumble strips and repair concrete shoulder along outside shoulder of NB and SB IH 39/90.

5. Traffic.

*Replace first bullet statement under section titled **C Traffic Operations** with the following:*

- Stages A, 1, 2 and 3

Schedule of Items

Attached, dated March 8, 2017, are the revised Schedule of Items Pages 1 – 9.

Plan Sheets

The following 8½ x 11-inch sheets are attached and made part of the plans for this proposal:

Revised: 2, 4, 20, 25, 27, 71, 72, 74 and 75.

Added: 29A and 29B.

END OF ADDENDUM

*NOTE

- SEEDING MIXTURE NO. 20
- STA. 4+39.15'MA' - LT
- STA. 4+39.15'MA' - RT
- STA. 14+65.45'MA' - LT
- STA. 14+65.45'MA' - RT
- STA. 18+00.00'MA' - LT
- STA. 18+00.00'MA' - RT
- STA. 28+45.53'RAD' - LT
- STA. 28+45.53'RAD' - RT
- STA. 70+15.00'RAE' - LT
- STA. 70+15.00'RAE' - RT
- SEEDING TEMPORARY
- STA. 10+00.00'MA' - LT
- STA. 10+00.00'MA' - RT
- STA. 12+29.38'MA' - LT
- STA. 12+29.38'MA' - RT
- STA. 14+83.88'MA' - LT
- STA. 14+83.88'MA' - RT

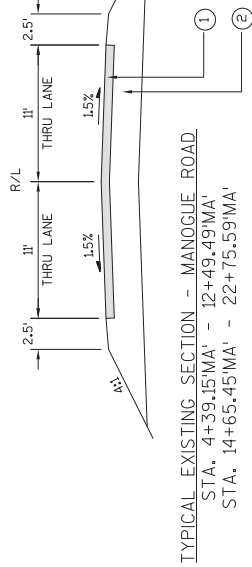

- LEGEND
- 1 BITUMINOUS CONCRETE PAVEMENT, 4-INCH
 - 2 GRAVEL OR CRUSHED STONE BASE COURSE, 14-INCH
 - 3 HMA PAVEMENT 3.5-INCH UPPER COURSE (4 LT 58-28 S)
 - 4 HMA PAVEMENT 1.75-INCH UPPER LAYER (4 LT 58-28 S)
 - 5 BASE AGGREGATE DENSE 1 1/4-INCH, 6-INCH
 - 6 BASE AGGREGATE DENSE 3-INCH, 6-INCH
 - 7 PREPARE FOUNDATION FOR ASPHALTIC PAVING
 - 8 BASE AGGREGATE DENSE 3/4-INCH, 3.5-INCH
 - 9 SALVAGED TOPSOIL, SEED, FERTILIZER, AND MULCH*
 - 10 SEED AND FERTILIZER*
 - M6S GUARDRAIL

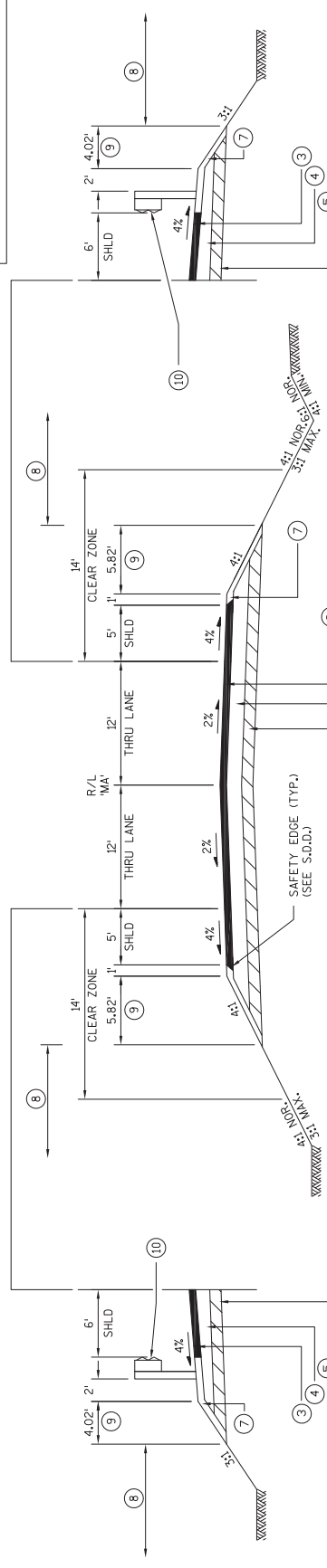

BEAM GUARD SECTION (TYP.)
 STA. 10+31.40'MA' - 12+08.71'MA'
 STA. 15+02.05'MA' - 16+81.81'MA'

TYPICAL FINISHED SECTION - MANOGUE ROAD
 STA. 4+39.15'MA' - 12+29.38'MA'
 STA. 14+83.88'MA' - 22+75.59'MA'

BEAM GUARD SECTION (TYP.)
 STA. 10+30.98'MA' - 12+08.71'MA'
 STA. 15+02.05'MA' - 16+82.33'MA'

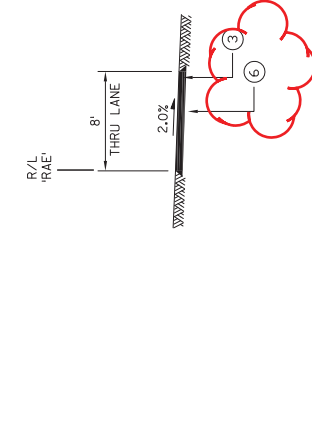
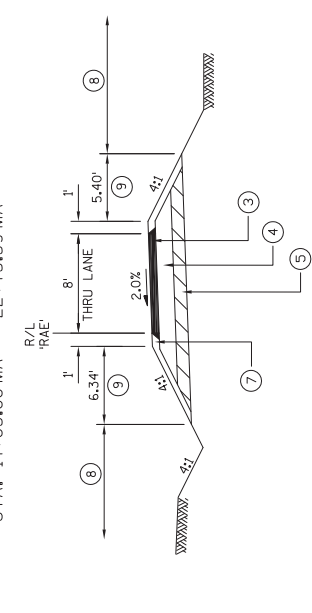
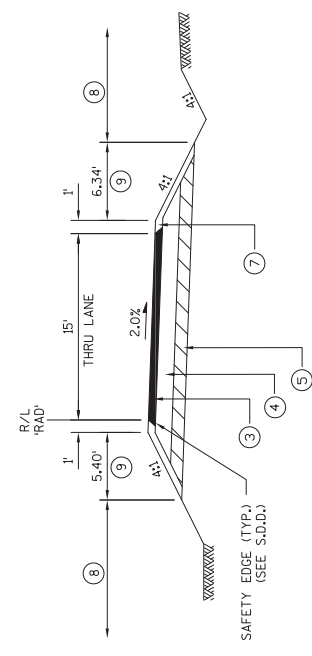

Addendum No. 01
 ID 1005-10-75
 Revised Sheet 4
 March 8, 2017



Addendum No. 01
 ID 1005-10-75
 Revised Sheet 20
 March 8, 2017

- LEGEND**
- (API3) HMA PAVEMENT 3.5-INCH (SEE GENERAL NOTES AND TYPICAL SECTIONS FOR MORE INFORMATION)
 - (AC01) BASE AGGREGATE DENSE 3/4-INCH
 - (PVD1) CONCRETE PAVEMENT APPROACH SLAB
 - (PVI1) CONCRETE SURFACE DRAIN (SEE CONSTRUCTION DETAIL FOR MORE INFORMATION)
 - (BC01) MGS THREE BEAM TRANSITION
 - (BC02) MGS GUARDRAIL
 - (BC04) MGS ENERGY ABSORBING TERMINAL
 - (U) PULL BOX NON-CONDUCTIVE 24X42-INCH (SEE CONSTRUCTION DETAIL FOR MORE INFORMATION)

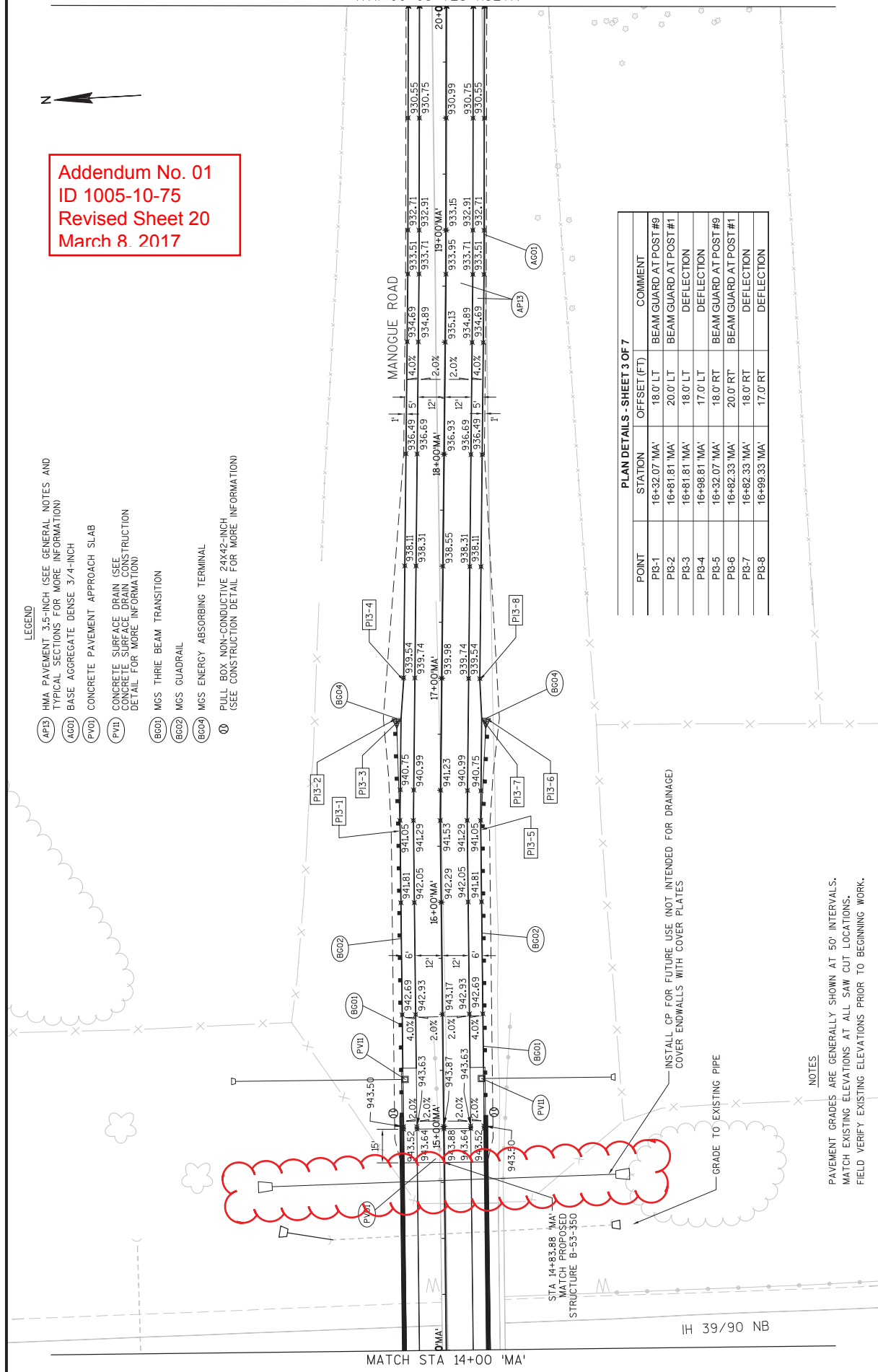

PLAN DETAILS - SHEET 3 OF 7

POINT	STATION	OFFSET (FT)	COMMENT
PI3-1	16+32.07 'MA'	18' 0" LT	BEAM GUARD AT POST #9
PI3-2	16+81.81 'MA'	20' 0" LT	BEAM GUARD AT POST #1
PI3-3	16+81.81 'MA'	18' 0" LT	DEFLECTION
PI3-4	16+98.81 'MA'	17' 0" LT	DEFLECTION
PI3-5	16+32.07 'MA'	18' 0" RT	BEAM GUARD AT POST #9
PI3-6	16+82.33 'MA'	20' 0" RT	BEAM GUARD AT POST #1
PI3-7	16+82.33 'MA'	18' 0" RT	DEFLECTION
PI3-8	16+99.33 'MA'	17' 0" RT	DEFLECTION

NOTES

PAVEMENT GRADES ARE GENERALLY SHOWN AT 50' INTERVALS.
 MATCH EXISTING ELEVATIONS AT ALL SAW CUT LOCATIONS.
 FIELD VERIFY EXISTING ELEVATIONS PRIOR TO BEGINNING WORK.

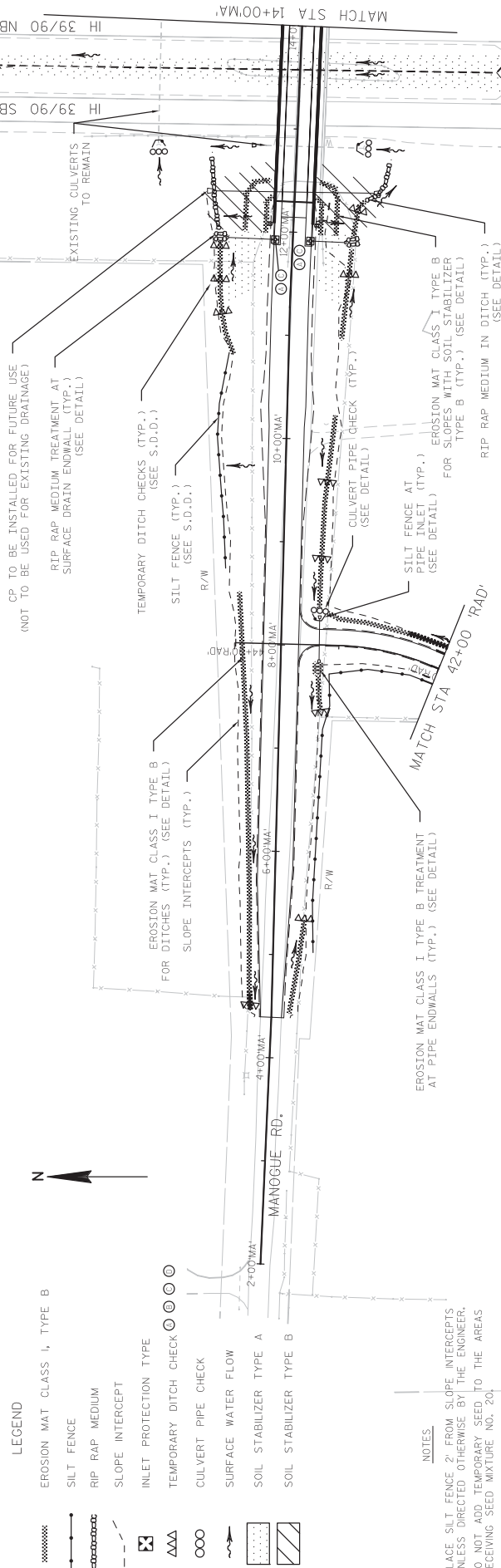

LEGEND

- EROSION MAT CLASS I, TYPE B
- SILT FENCE
- RIP RAP MEDIUM
- SLOPE INTERCEPT
- INLET PROTECTION TYPE
- TEMPORARY DITCH CHECK
- CULVERT PIPE CHECK
- SURFACE WATER FLOW
- SOIL STABILIZER TYPE A
- SOIL STABILIZER TYPE B

NOTES

PLACE SILT FENCE 2' FROM SLOPE INTERCEPTS UNLESS DIRECTED OTHERWISE BY THE ENGINEER. DO NOT ADD TEMPORARY SEED TO THE AREAS RECEIVING SEED MIXTURE NO. 20.

Addendum No. 01
ID 1005-10-75
Revised Sheet 25
March 8, 2017

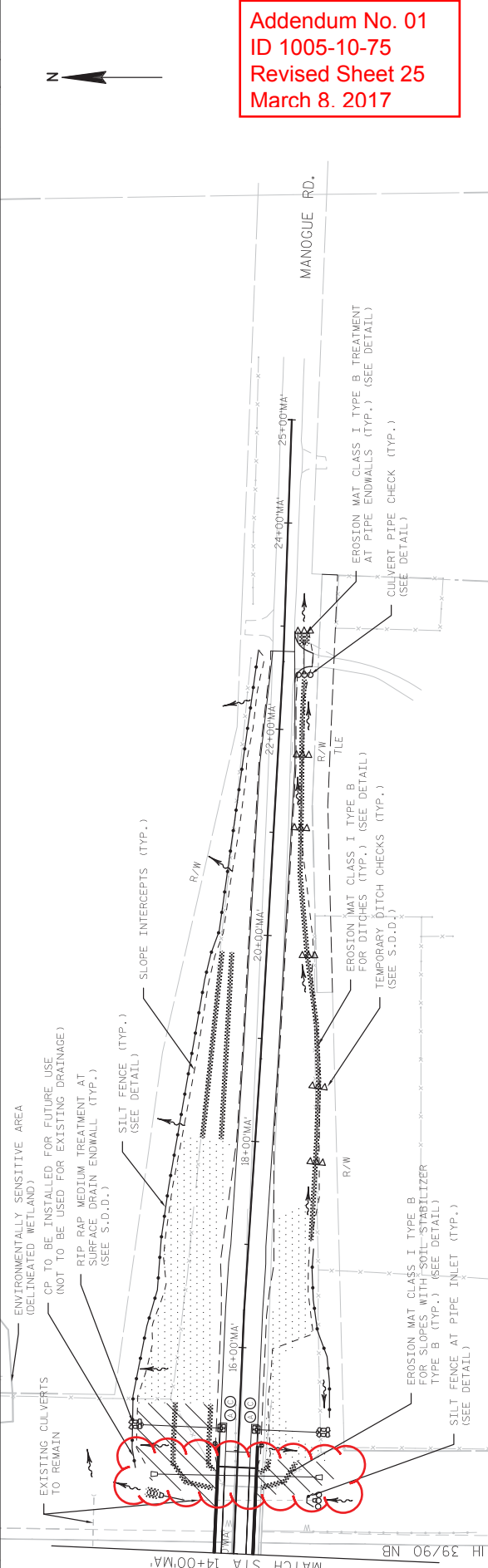

NOTES

ENVIRONMENTALLY SENSITIVE AREA (DELINEATED WETLAND)

CP TO BE INSTALLED FOR FUTURE USE (NOT TO BE USED FOR EXISTING DRAINAGE)

RIP RAP MEDIUM TREATMENT AT SURFACE DRAIN ENDWALL (TYP.) (SEE S.D.D.)

SILT FENCE (TYP.) (SEE DETAIL)

SLOPE INTERCEPTS (TYP.)

EROSION MAT CLASS I, TYPE B FOR SLOPES WITH SOIL-STABILIZER TYPE B (TYP.) (SEE DETAIL)

SILT FENCE AT PIPE INLET (TYP.) (SEE DETAIL)

Addendum No. 01
ID 1005-10-75
Revised Sheet 27
March 8, 2017

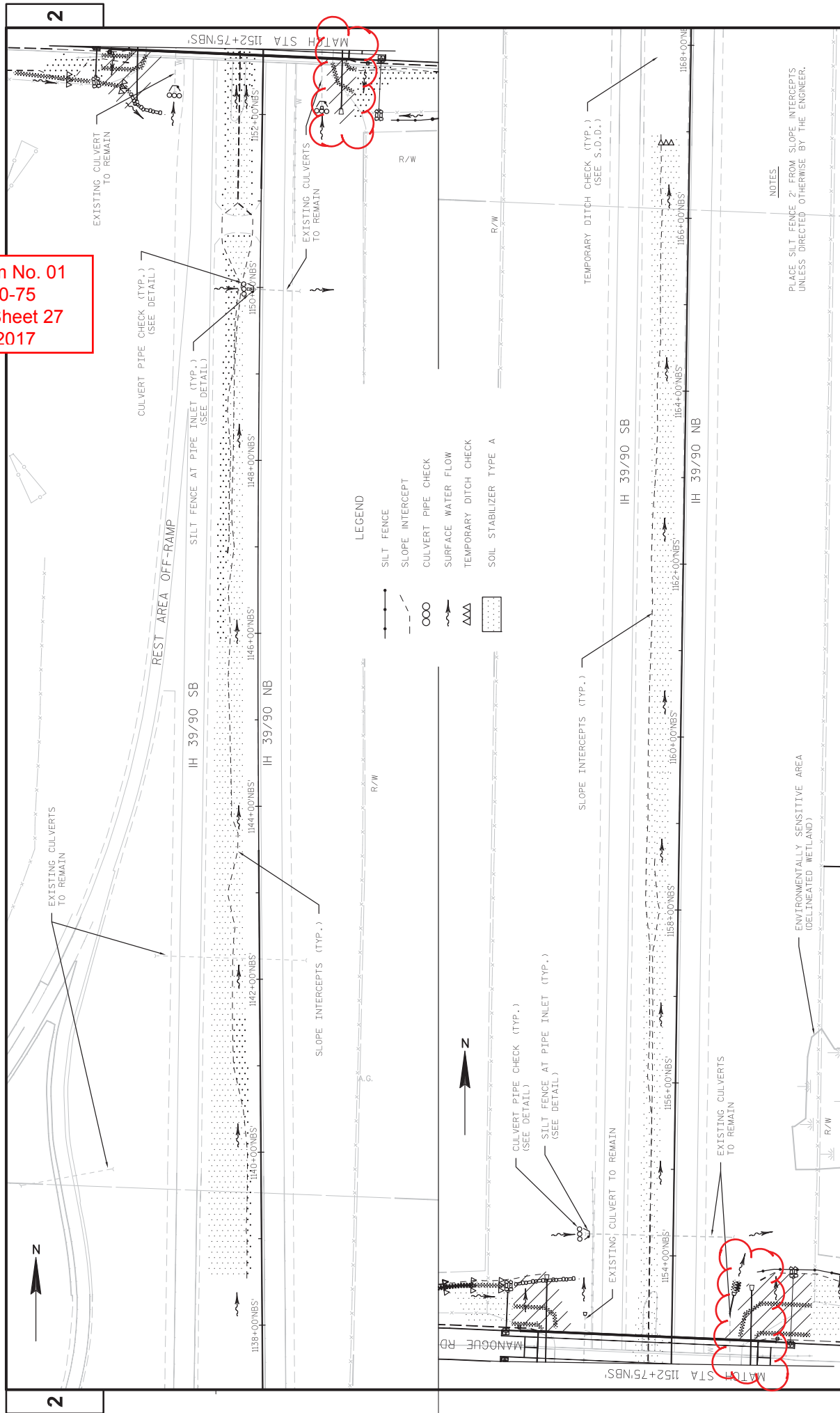

PROJECT NO: 1005-10-75	PLAN: EROSION CONTROL	SHEET 27
HWY: IH 39/90	COUNTY: ROCK	
FILE NAME : G:\WDOT\WIS19-11032\CTVIL3D\MANAGLESHEETS\PLAN\PLAN DETAILS\022001-EG.DWG	FLY DATE : 9/23/2008 9:36 AM	FLY NAME : BRZAN ST. VINCENT
	FLY SCALE : 1:100	WISDOT/CADD SHEET 42

PORTABLE CHANGEABLE MESSAGE SIGNS SHALL BE PLACED 1 MILE PRIOR TO TRAFFIC CONTROL ADVANCED WARNING SIGNS, AS WELL AS ON NB IH 39/90 SOUTH OF USH 14 AND ON SB IH 39/90 NORTH OF USH 51/5TH 73, OR AS DIRECTED BY THE ENGINEER. PORTABLE CHANGEABLE MESSAGE SIGNS SHALL BE IN PLACE 1 WEEK PRIOR TO AND DURING CONSTRUCTION AND SHALL BE USED TO INFORM THE PUBLIC OF THE PROJECT.

SEE S.D.D. "TRAFFIC CONTROL, SHOULDER CLOSURE ON DIVIDED ROADWAY, SPEEDS GREATER THAN 40 MPH" FOR ADVANCED WARNING SIGNS AND DETAILS NOT SHOWN IN PLANS.

SEE S.D.D. "BARRICADES AND SIGNS FOR MAINLINE CLOSURES" DETAIL C FOR ADVANCED WARNING SIGNS AND DETAILS NOT SHOWN IN PLANS.

Addendum No. 01
ID 1005-10-75
Added Sheet 29A
March 8, 2017

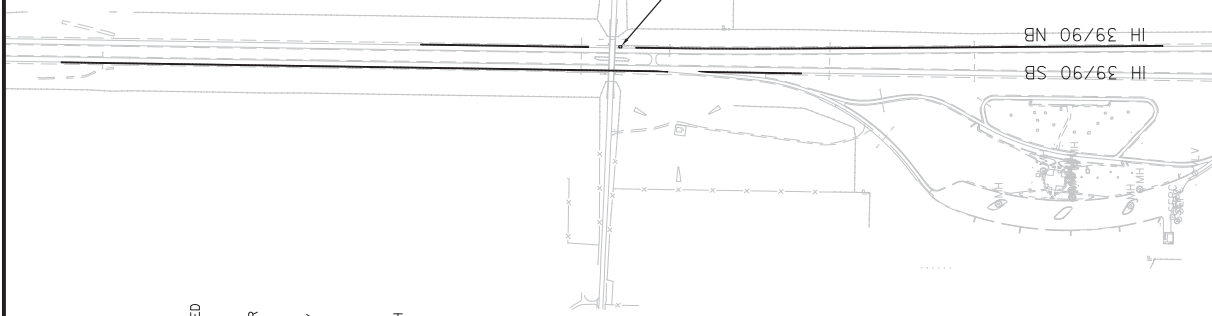

TRAFFIC CONTROL GENERAL NOTES (ALL STAGES):

- THE EXACT NUMBER, LOCATION, AND SPACING OF ALL SIGNS AND DEVICES SHALL BE ADJUSTED TO FIT FIELD CONDITIONS AS APPROVED BY THE ENGINEER.
- THE SPACING BETWEEN SIGNS SHOULD BE ADJUSTED TO NOT CONFLICT WITH AND TO PROVIDE A MINIMUM DISTANCE OF 200 FEET (500 FEET DESIRABLE) TO EXISTING SIGNS.
- THE TURNING OF TRAFFIC CONTROL DEVICES WHEN NOT IN USE TO OBSCURE THE MESSAGE WILL NOT BE ALLOWED.
- ANY SIGNS TEMPORARY OR EXISTING, WHICH CONFLICT WITH TRAFFIC CONTROL "IN USE" SHALL BE REMOVED IMMEDIATELY AS NEEDED AND AS REPORTED BY THE ENGINEER. REMOVE AND REPLACE OR REPAIR OR COVERING/UNCOVERING SIGNS WILL BE INCIDENTAL TO OTHER TRAFFIC CONTROL ITEMS.
- CONSIDER GEOMETRICS WHEN LOCATING SIGNS, ARROW BOARDS AND SIGN MESSAGE BOARDS SO THE DRIVER HAS A CLEAR VIEW OF THE ARROW BOARDS, SIGN MESSAGE BOARDS AND LANE CLOSURE DRUMS FOR A MINIMUM OF 1500 FEET IN FRONT OF THE DRUMS.
- IF SIGNS ARE IN PLACE LESS THAN 7 CONTINUOUS DAYS AND NIGHTS THE ADVANCED WARNING SIGNS MAY BE MOUNTED ON PORTABLE SUPPORTS.
- ALL TRAFFIC CONTROL SIGNING SHALL CONFORM TO: PART VI OF THE MANUAL ON UNIFORM TRAFFIC CONTROL DEVICES; THE WISCONSIN SUPPLEMENT TO THE MUTCD, AND OTHER CONTRACT DOCUMENTS.
- CONTRACTOR'S EQUIPMENT AND MATERIAL STOCKPILES MAY NOT BE STORED WITHIN THE CLEARZONE OF IH 39/90 WHILE THE CONTRACTOR IS NOT WORKING, UNLESS THEY ARE PROTECTED BY CONCRETE BARRIER TEMPORARY PRECAST.

SEE S.D.D. "BARRICADES AND SIGNS FOR MAINLINE CLOSURES" DETAIL C FOR ADVANCED WARNING SIGNS AND DETAILS NOT SHOWN IN PLANS.

LEGEND



MAINTENANCE OF TRAFFIC:

- MAINTAIN LOCAL ACCESS AT ALL TIMES
- IH 39/90 WILL BE OPEN TO ALL EXISTING LANES AT ALL TIMES EXCEPT FOR NIGHTTIME LANE CLOSURES, ROLLING STOPS, AND SHOULDER CLOSURES AS SPECIFIED IN THE CONTRACT SPECIAL PROVISIONS

CONSTRUCTION TO BE COMPLETED:

- IH 39/90: FILL RUMBLE STRIPS ALONG BOTH OUTSIDE SHOULDERS OF IH 39/90
- IH 39/90: CONCRETE PAVEMENT REPAIR SHES OF OUTSIDE SHOULDER OF NB IH 39/90

NOTES:

- REFER TO THE FOLLOWING STANDARD DETAIL DRAWINGS FOR TRAFFIC CONTROL DEVICES, AS WELL AS OTHER STANDARD DETAIL DRAWINGS AS NECESSARY, UNLESS OTHERWISE DIRECTED BY THE ENGINEER
- SEE SDD "BARRICADES AND SIGNS FOR MAINLINE CLOSURES"
- SEE SDD "TRAFFIC CONTROL, SHOULDER CLOSURE ON DIVIDED ROADWAY, SPEEDS GREATER THAN 40 MPH"

PROJECT NO: 1005-10-75

HWY: IH 39/90

COUNTY: ROCK

TRAFFIC CONTROL - STAGE A

SHEET 29A

E

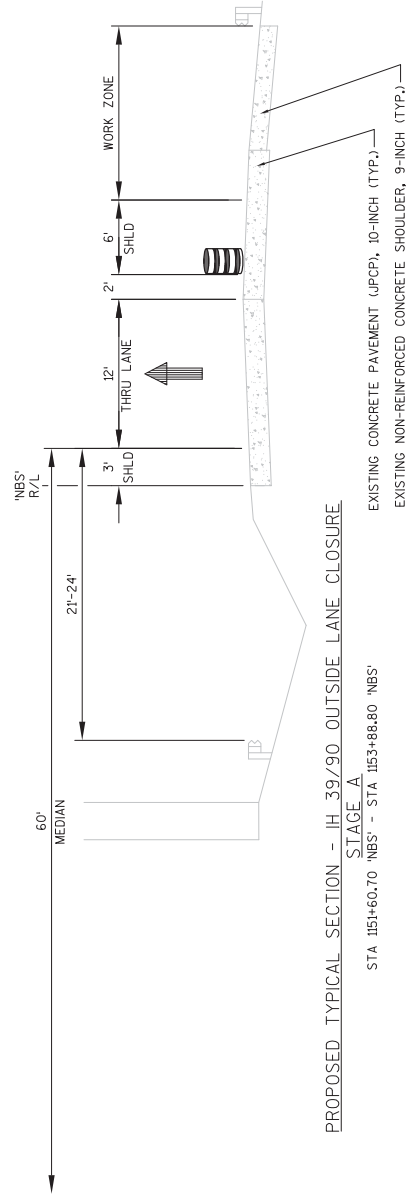
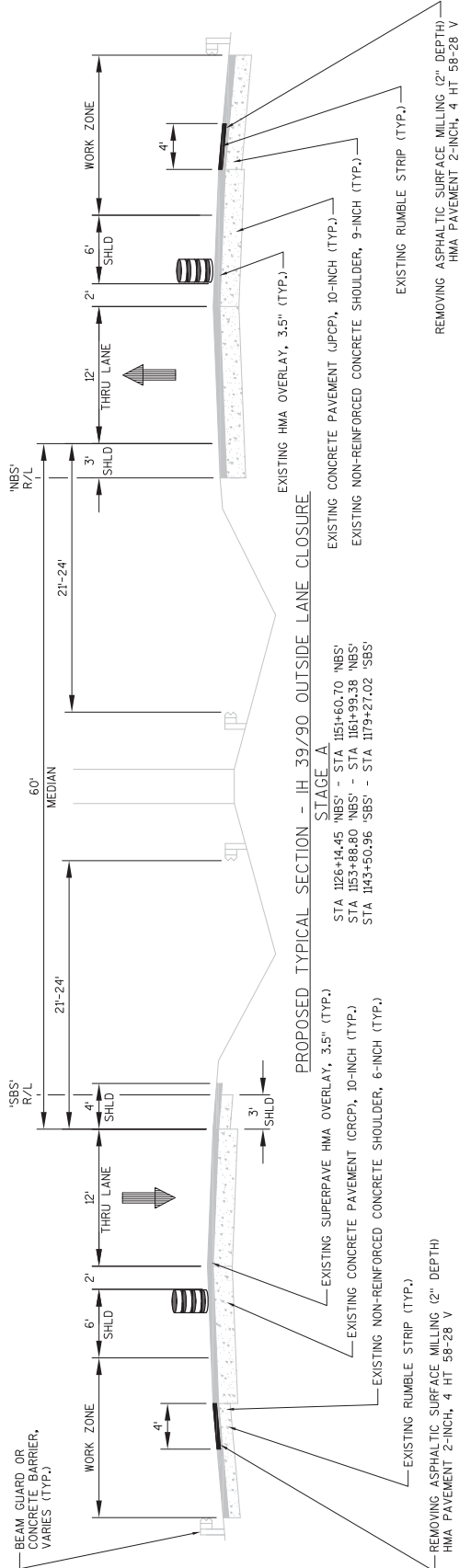

Addendum No. 01
 ID 1005-10-75
 Added Sheet 29B
 March 8, 2017

Addendum No. 01
 ID 1005-10-75
 Revised Sheet 71
 March 8, 2017

3

3

REMOVING SMALL PIPE CULVERTS		203.0100		REMARKS	
STATION	O/S	LOCATION	EACH	REMARKS	
10+03 MA	RT	DRIVEWAY	1	BURED	
22+72 MA	RT	DRIVEWAY	1	18' CPCM	
PROJECT TOTAL					2

STATION	O/S	LOCATION	LF	
112+10 NBS	RT	BRIDGE PIER	79	
112+40 SBS	RT	BRIDGE PIER	61	
PROJECT TOTAL				160

STATION	O/S	LOCATION	LF
204.0157			

REMOVING CONCRETE BARRIER		204.0157		
STATION	O/S	LOCATION	LF	
112+10 NBS	RT	BRIDGE PIER	79	
112+40 SBS	RT	BRIDGE PIER	61	
PROJECT TOTAL				160

STATION	O/S	LOCATION	LF
204.0170			

REMOVING FENCE		204.0170		
STATION	O/S	LOCATION	LF	
3+64 MA	LT	MANOQUE RD	963	
4+23 MA	RT	MANOQUE RD	862	
14+65 MA	LT	MANOQUE RD	883	
14+65 MA	RT	MANOQUE RD	825	
31+40 RAD	RT	EMERGENCY ACCESS DW	106	
31+46 RAD	LT/RT	EMERGENCY ACCESS DW	73	
PROJECT TOTAL				3,502

REMOVING ASPHALTIC SURFACE MILLING		204.0120		
STATION	O/S	LOCATION	LF	
1126+14 NBS	RT	MANOQUE RD	1,482	
1143+51 SBS	RT	MANOQUE RD	1,488	
PROJECT TOTAL				3,140

REMOVING GUARDRAIL		204.0165		
STATION	O/S	LOCATION	LF	
11+66 MA	LT	MANOQUE RD	74	
11+68 MA	RT	MANOQUE RD	72	
14+75 MA	LT	MANOQUE RD	72	
14+75 MA	RT	MANOQUE RD	75	
1153+31 SBS	RT	IH 39/90 SB	158	
1150+51 NBS	RT	IH 39/90 NB	159	
1152+03 NBS	RT	IH 39/90 NB	346	
PROJECT TOTAL				986

BASE AGGREGATE		305.0110		305.0120		305.0130	
STATION	O/S	LOCATION	DENSE 1 INCH (TON)	DENSE 1 INCH (TON)	DENSE 1 INCH (TON)	DENSE 1 INCH (TON)	DENSE 1 INCH (TON)
4+39 MA	RT	MANOQUE RD	267	1,563	1,441		
14+84 MA	RT	MANOQUE RD	265	1,577	1,452		
28+46 RAD	RT	EMERGENCY ACCESS DW	441	1,466	1,489		
70+15 RAE	RT	MAINTENANCE DW	89	201	227		
1138+54 NBS	RT	IH 39/90 NB	311	1,327	1,113		
1146+85 SBS	RT	IH 39/90 SB	-	2,201	-		
UNDISTRIBUTED			77	465	388		
PROJECT TOTAL			1,450	8,800	6,100		

OBLITERATING OLD ROAD		214.0100		
STATION	O/S	LOCATION	COMMENTS	
30+00 RAD	RT	EMERGENCY ACCESS DW	8 EXISTING DRIVEWAY	
40+00 RAD	RT	EMERGENCY ACCESS DW	3 EXISTING DRIVEWAY	
PROJECT TOTAL				11

PROJECT NO: 1005-10-75 HWY: IH 39/90 COUNTY: ROCK SHEET 71

ALL QUANTITIES ON THIS PLAN SHEET ARE CATEGORY 1000 UNLESS SPECIFIED OTHERWISE

ORIGINATOR: KL ENGINEERING, INC. REV. DATE: PRINT DATE: March 6, 2017

Excavation Common is the sum of the Cut and EBS Excavation columns, Item number 205.0100
 Note 1) Salvaged/Unusable Pavement Material is included in Cut.
 Note 2) EBS Excavation to be backfilled with Select Borrow. All EBS material is to be wasted offsite. EBS estimated at 6% undistributed quantity.
 Note 3) EBS Excavation to be backfilled with Select Borrow. All EBS material is to be wasted offsite. EBS estimated at 6% undistributed quantity.
 Note 4) Roadway Embankment = Unexpanded Fill
 Note 5) The Mass Ordinate +/- Or - Qty calculated for the Division. Plus quantity indicates an excess of material within the Division. Minus indicates a shortage of material within the Division.
 Mass Ordinate = Cut - Unexpanded Fill. The Mass Ordinate is for information purposes only as Excavation Common and Roadway Embankment are not balanced for quantity purposes and does not guarantee the quality of Excavation Common, and fill can be reused onsite.

Addendum No. 01
ID 1005-10-75
Revised Sheet 74
March 8, 2017

SIGNING

6372210	6372230	6340616	6340622	6382102	6384000	6382602	6383000	REMARKS
TYPE II	TYPE II	POSTS	POSTS	MOVING	MOVING	MOVING	REMOVING	
REFLECTIVE	REFLECTIVE	4X6-IN	4X6-IN	4X6-IN	4X6-IN	4X6-IN	SMALL SIGN MOUNTED	
SIZE	SIZE	18 FT	22 FT	TYPE II	SUPPORTS	TYPE II	ON SAME	
SIZE	SIZE	(EACH)	(EACH)	(EACH)	(EACH)	(EACH)	POST AS	
(SF)	(SF)	(EACH)	(EACH)	(EACH)	(EACH)	(EACH)	POST AS	
1-01	R2-1	2S 24X30	-	1	-	-	-	SPEED LIMIT 55 MPH
1-02	R2-1	2S 24X30	5.00	-	-	-	-	SPEED LIMIT 45 MPH
1-03	W12-2	(5) 48X48	-	-	-	-	-	LOW CLEARANCE SYMBOL
1-04	W12-2	(5) 48X36	16.00	-	2	-	-	LOW CLEARANCE SYMBOL
1-05	W12-2	(5) 48X36	12.00	-	2	-	-	LOW CLEARANCE SYMBOL
1-06	W52-52	(5) 48X36	-	-	-	-	1405	4.5 MILES AHEAD
1-07	W12-2	(5) 48X48	-	1	-	-	-	LOW CLEARANCE SYMBOL
1-08	W12-2	(5) 48X48	-	-	-	-	-	LOW CLEARANCE SYMBOL
1-09	R5-1	2S 30X30	6.25	-	-	-	-	DO NOT ENTER
1-10	R5-1	2S 30X24	5.00	-	-	-	1.09	EMERGENCY ACCESS ONLY
1R01	W5-52L	2S 24X30	-	-	-	-	1	END OF SPEED ZONE
1R02	W5-52L	2S 12X36	-	-	-	-	1	CLEARANCE STRIPPER DOWN RIGHT
1R03	W5-52R	2S 12X36	-	-	-	-	1	CLEARANCE STRIPPER DOWN LEFT
1R04	W5-52R	2S 12X36	-	-	-	-	1	CLEARANCE STRIPPER DOWN LEFT
1R05	W5-52R	2S 12X36	-	-	-	-	1	CLEARANCE STRIPPER DOWN LEFT
1R06	W5-52L	2S 12X36	-	-	-	-	1	CLEARANCE STRIPPER DOWN RIGHT
2-01	R6-2R	2S 24X30	5.00	-	-	-	-	ONE WAY RIGHT ARROW
2-02	R7-52R	2S 18X24	3.00	-	-	-	-	NO PARKING BETWEEN SIGNS (RIGHT ARROW)
2-03	R7-52L	2S 18X24	3.00	-	-	-	-	NO PARKING BETWEEN SIGNS (LEFT ARROW)
2-04	R5-1	2S 30X30	6.25	-	-	-	-	DO NOT ENTER
2-05	R5-1	2S 30X24	5.00	-	-	-	-	EMERGENCY ACCESS ONLY
2M00	R3-4B	(4) 36X48	-	-	-	-	-	NO U TURN SIGN COMBINED MAINT&POLICE
2M01	R3-4B	(4) 36X48	-	-	-	-	-	NO U TURN SIGN COMBINED MAINT&POLICE
2M03	R3-4B	(4) 36X48	-	-	-	-	-	NO U TURN SIGN COMBINED MAINT&POLICE
PROJECT TOTALS			43.50	88.00	5	4	6	6

SAWING ASPHALT

STATION - STATION	LOCATION	690.0150
		SAWING
		ASPHALT
		LF
4439 MA -	MANOGUE RD	21
22476 MA - 22495 MA	MANOGUE RD	41
22462 MA - 22475 MA	DRIVEWAY/RT	13
28+46 RAD	EMERGENCY ACCESS DW	55
30+83 RAD	EMERGENCY ACCESS DW	41
1138+54 NBS - 1158+69 NBS	NB IH 39/90	2,004
1150+61 NBS - 1150+87 NBS	NB IH 39/90	26
1146+85 SBS - 1166+49 SBS	SB IH 39/90	2,004
1150+50 SBS - 1150+81 SBS	SB IH 39/90	31
	UNDISTRIBUTED	214
	PROJECT TOTAL	4,480

TRAFFIC CONTROL DEVICES

603.8000	603.8125	614.0905	643.0300	643.0420	643.0715	643.0800	643.0900	643.1050	643.1055S	REMARKS
CONCRETE BARRIER	CRASH	WARRANTING	WARRANTING	WARRANTING	TRUCKOR	TRUCKOR	TRUCKOR	TRUCKOR	TRUCKOR	
DELIVERED	DELIVERED	DELIVERED	DELIVERED	DELIVERED	DELIVERED	DELIVERED	DELIVERED	DELIVERED	DELIVERED	
TYPE I	TYPE II	TYPE III	TYPE IV	TYPE V	TYPE VI	TYPE VII	TYPE VIII	TYPE IX	TYPE X	
(EACH)	(EACH)	(EACH)	(EACH)	(EACH)	(EACH)	(EACH)	(EACH)	(EACH)	(EACH)	
4	76	-	4	32	-	4	32	-	4	SHOULDER CLOSURES
4	312	20	40	120	8	96	16	4	4	LANESHOLDER CLOSURES
4	388	20	40	120	12	128	16	4	4	LANESHOLDER CLOSURES
21	378	-	-	-	-	-	-	-	-	MANOGUE RD
11	416	-	-	-	-	-	-	-	-	MANOGUE RD
10	1,830	2	1,920	100	200	500	40	10	10	MANLINE CLOSURE
21	1,830	2	2,338	478	538	590	62	990	94	LANESHOLDER CLOSURES
STAGE 1 SUBTOTALS										
14	-	-	252	224	-	196	56	-	-	MANLINE CLOSURE
12	-	-	864	-	96	48	384	-	-	SHOULDER CLOSURES
2	-	-	304	20	40	120	8	160	2	LANESHOLDER CLOSURES
STAGE 2 SUBTOTALS										
95	-	-	1,710	1,520	-	1,930	380	-	-	MANLINE CLOSURE
20	-	-	380	-	20	160	-	-	-	SHOULDER CLOSURES
77	-	-	5,544	-	616	308	2,464	-	-	SHOULDER CLOSURES
18	-	-	2,916	180	360	1,098	72	1,638	18	LANESHOLDER CLOSURES
STAGE 3 SUBTOTALS										
20	20	0	666	140	130	160	30	400	34	UNDISTRIBUTED
PROJECT TOTAL										
134	1,850	1,850	2	13,400	2,850	2,800	560	7,850	600	15

ALL QUANTITIES ON THIS PLAN SHEET ARE CATEGORY 1000 UNLESS SPECIFIED OTHERWISE

Addendum No. 01
 ID 1005-10-75
 Revised Sheet 75
 March 8, 2017

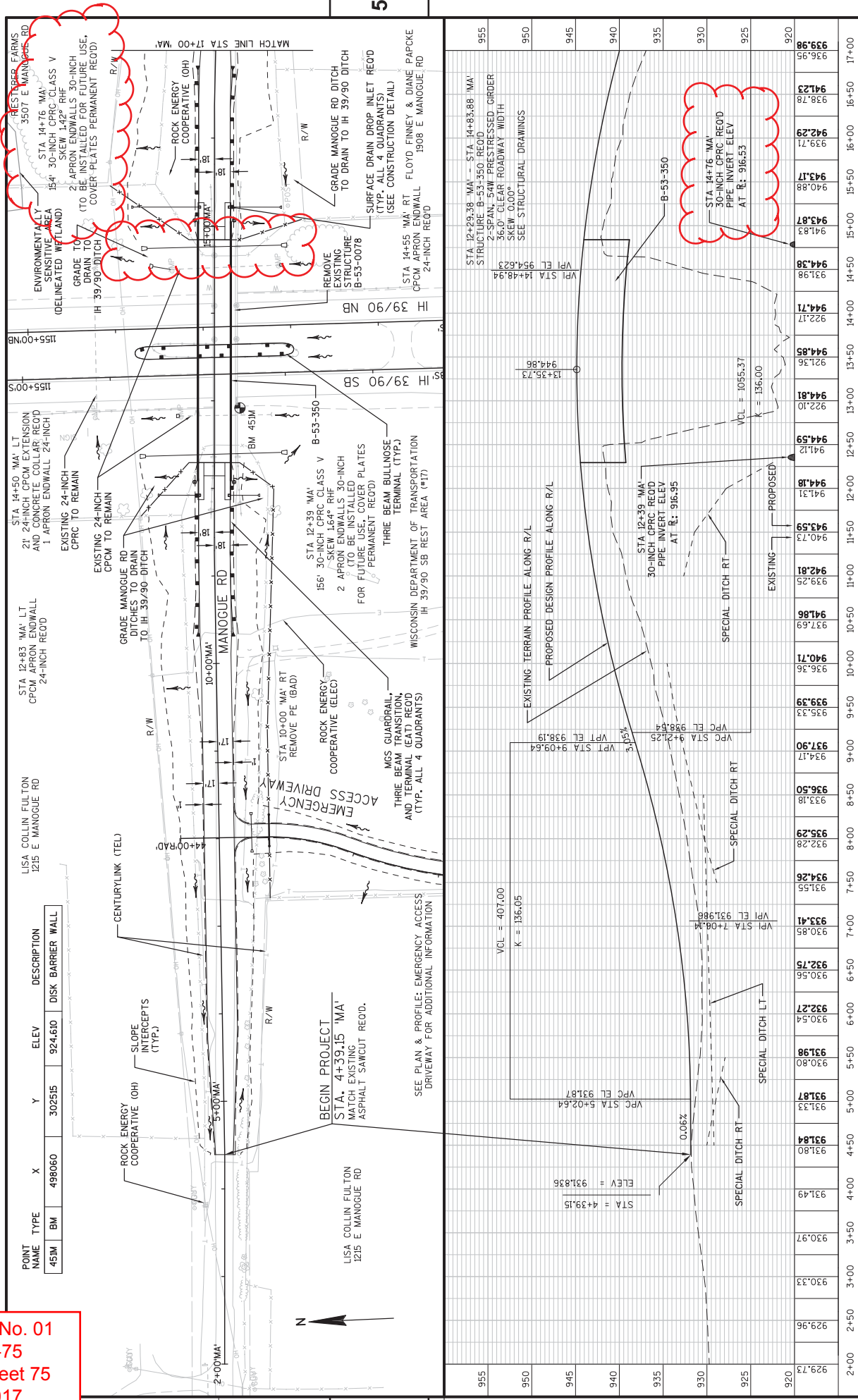

POINT NAME	TYPE	X	Y	ELEV	DESCRIPTION
45JM	BM	498060	302515	924.610	DISK BARRIER WALL

POINT NAME	TYPE	X	Y	ELEV	DESCRIPTION
125	LT	125	125	125	24-INCH CPCM EXTENSION AND CONCRETE COLLAR REOD
126	LT	126	126	126	1 APRON ENDWALL 24-INCH CPCM TO REMAIN
127	LT	127	127	127	EXISTING 24-INCH CPCM TO REMAIN
128	LT	128	128	128	EXISTING 24-INCH CPCM TO REMAIN
129	LT	129	129	129	EXISTING 24-INCH CPCM TO REMAIN
130	LT	130	130	130	EXISTING 24-INCH CPCM TO REMAIN
131	LT	131	131	131	EXISTING 24-INCH CPCM TO REMAIN
132	LT	132	132	132	EXISTING 24-INCH CPCM TO REMAIN
133	LT	133	133	133	EXISTING 24-INCH CPCM TO REMAIN
134	LT	134	134	134	EXISTING 24-INCH CPCM TO REMAIN
135	LT	135	135	135	EXISTING 24-INCH CPCM TO REMAIN
136	LT	136	136	136	EXISTING 24-INCH CPCM TO REMAIN
137	LT	137	137	137	EXISTING 24-INCH CPCM TO REMAIN
138	LT	138	138	138	EXISTING 24-INCH CPCM TO REMAIN
139	LT	139	139	139	EXISTING 24-INCH CPCM TO REMAIN
140	LT	140	140	140	EXISTING 24-INCH CPCM TO REMAIN
141	LT	141	141	141	EXISTING 24-INCH CPCM TO REMAIN
142	LT	142	142	142	EXISTING 24-INCH CPCM TO REMAIN
143	LT	143	143	143	EXISTING 24-INCH CPCM TO REMAIN
144	LT	144	144	144	EXISTING 24-INCH CPCM TO REMAIN
145	LT	145	145	145	EXISTING 24-INCH CPCM TO REMAIN
146	LT	146	146	146	EXISTING 24-INCH CPCM TO REMAIN
147	LT	147	147	147	EXISTING 24-INCH CPCM TO REMAIN
148	LT	148	148	148	EXISTING 24-INCH CPCM TO REMAIN
149	LT	149	149	149	EXISTING 24-INCH CPCM TO REMAIN
150	LT	150	150	150	EXISTING 24-INCH CPCM TO REMAIN
151	LT	151	151	151	EXISTING 24-INCH CPCM TO REMAIN
152	LT	152	152	152	EXISTING 24-INCH CPCM TO REMAIN
153	LT	153	153	153	EXISTING 24-INCH CPCM TO REMAIN
154	LT	154	154	154	EXISTING 24-INCH CPCM TO REMAIN
155	LT	155	155	155	EXISTING 24-INCH CPCM TO REMAIN
156	LT	156	156	156	EXISTING 24-INCH CPCM TO REMAIN
157	LT	157	157	157	EXISTING 24-INCH CPCM TO REMAIN
158	LT	158	158	158	EXISTING 24-INCH CPCM TO REMAIN
159	LT	159	159	159	EXISTING 24-INCH CPCM TO REMAIN
160	LT	160	160	160	EXISTING 24-INCH CPCM TO REMAIN
161	LT	161	161	161	EXISTING 24-INCH CPCM TO REMAIN
162	LT	162	162	162	EXISTING 24-INCH CPCM TO REMAIN
163	LT	163	163	163	EXISTING 24-INCH CPCM TO REMAIN
164	LT	164	164	164	EXISTING 24-INCH CPCM TO REMAIN
165	LT	165	165	165	EXISTING 24-INCH CPCM TO REMAIN
166	LT	166	166	166	EXISTING 24-INCH CPCM TO REMAIN
167	LT	167	167	167	EXISTING 24-INCH CPCM TO REMAIN
168	LT	168	168	168	EXISTING 24-INCH CPCM TO REMAIN
169	LT	169	169	169	EXISTING 24-INCH CPCM TO REMAIN
170	LT	170	170	170	EXISTING 24-INCH CPCM TO REMAIN
171	LT	171	171	171	EXISTING 24-INCH CPCM TO REMAIN
172	LT	172	172	172	EXISTING 24-INCH CPCM TO REMAIN
173	LT	173	173	173	EXISTING 24-INCH CPCM TO REMAIN
174	LT	174	174	174	EXISTING 24-INCH CPCM TO REMAIN
175	LT	175	175	175	EXISTING 24-INCH CPCM TO REMAIN
176	LT	176	176	176	EXISTING 24-INCH CPCM TO REMAIN
177	LT	177	177	177	EXISTING 24-INCH CPCM TO REMAIN
178	LT	178	178	178	EXISTING 24-INCH CPCM TO REMAIN
179	LT	179	179	179	EXISTING 24-INCH CPCM TO REMAIN
180	LT	180	180	180	EXISTING 24-INCH CPCM TO REMAIN
181	LT	181	181	181	EXISTING 24-INCH CPCM TO REMAIN
182	LT	182	182	182	EXISTING 24-INCH CPCM TO REMAIN
183	LT	183	183	183	EXISTING 24-INCH CPCM TO REMAIN
184	LT	184	184	184	EXISTING 24-INCH CPCM TO REMAIN
185	LT	185	185	185	EXISTING 24-INCH CPCM TO REMAIN
186	LT	186	186	186	EXISTING 24-INCH CPCM TO REMAIN
187	LT	187	187	187	EXISTING 24-INCH CPCM TO REMAIN
188	LT	188	188	188	EXISTING 24-INCH CPCM TO REMAIN
189	LT	189	189	189	EXISTING 24-INCH CPCM TO REMAIN
190	LT	190	190	190	EXISTING 24-INCH CPCM TO REMAIN
191	LT	191	191	191	EXISTING 24-INCH CPCM TO REMAIN
192	LT	192	192	192	EXISTING 24-INCH CPCM TO REMAIN
193	LT	193	193	193	EXISTING 24-INCH CPCM TO REMAIN
194	LT	194	194	194	EXISTING 24-INCH CPCM TO REMAIN
195	LT	195	195	195	EXISTING 24-INCH CPCM TO REMAIN
196	LT	196	196	196	EXISTING 24-INCH CPCM TO REMAIN
197	LT	197	197	197	EXISTING 24-INCH CPCM TO REMAIN
198	LT	198	198	198	EXISTING 24-INCH CPCM TO REMAIN
199	LT	199	199	199	EXISTING 24-INCH CPCM TO REMAIN
200	LT	200	200	200	EXISTING 24-INCH CPCM TO REMAIN

STATION	ELEVATION	DESCRIPTION
929.73		
929.96		
930.33		
930.97		
931.49		
931.80		
931.84		
931.87		
931.98		
930.54		
932.27		
930.56		
932.75		
930.85		
933.41		
931.55		
934.26		
932.28		
935.29		
933.18		
936.50		
934.17		
937.90		
935.33		
939.39		
936.36		
940.71		
937.69		
941.86		
939.29		
942.81		
940.73		
943.59		
941.31		
944.18		
941.12		
944.59		
922.10		
944.81		
921.36		
944.85		
922.17		
944.71		
931.98		
943.87		
940.88		
943.17		
939.71		
942.29		
938.78		
941.23		
936.95		
939.98		

PROJECT NO: 1005-10-75
 HWY: IH 39/90
 COUNTY: ROCK
 PLAN AND PROFILE: MANOGUE ROAD 'MA'
 SHEET 75
 PLOT BY: KL ENGINEERING
 PLOT DATE: 3/6/2017
 PLOT NAME: PLOT SCALE: 1" = 100'-XREF
 WISDOT/CADD SHEET 44



Proposal Schedule of Items

Proposal ID: 20170314001 Project(s): 1005-10-75

Federal ID(s): N/A

SECTION: 0001

Contract Items

Alt Set ID:

Alt Mbr ID:

Proposal Line Number	Item ID Description	Approximate Quantity and Units	Unit Price	Bid Amount
0010	201.0105 Clearing	13.000 STA	_____.	_____.
0020	201.0120 Clearing	80.000 ID	_____.	_____.
0030	201.0205 Grubbing	13.000 STA	_____.	_____.
0040	201.0220 Grubbing	80.000 ID	_____.	_____.
0050	203.0100 Removing Small Pipe Culverts	2.000 EACH	_____.	_____.
0060	203.0200 Removing Old Structure (station) 001. 13+56.63 'MA'	LS	LUMP SUM	_____.
0070	203.0210.S Abatement of Asbestos Containing Material (structure) 001. B-53-0078	LS	LUMP SUM	_____.
0080	203.0225.S Debris Containment (structure) 001. B- 53-0078	LS	LUMP SUM	_____.
0090	204.0157 Removing Concrete Barrier	160.000 LF	_____.	_____.
0100	204.0165 Removing Guardrail	956.000 LF	_____.	_____.
0110	204.0170 Removing Fence	3,502.000 LF	_____.	_____.
0120	205.0100 Excavation Common	5,806.000 CY	_____.	_____.
0130	206.1000 Excavation for Structures Bridges (structure) 001. B-53-0350	LS	LUMP SUM	_____.
0140	208.1100 Select Borrow	264.000 CY	_____.	_____.
0150	210.1500 Backfill Structure Type A	1,040.000 TON	_____.	_____.



Proposal Schedule of Items

Proposal ID: 20170314001 Project(s): 1005-10-75

Federal ID(s): N/A

SECTION: 0001

Contract Items

Alt Set ID:

Alt Mbr ID:

Proposal Line Number	Item ID Description	Approximate Quantity and Units	Unit Price	Bid Amount
0160	211.0100 Prepare Foundation for Asphaltic Paving (project) 001. 1005-10-75	LS	LUMP SUM	_____.
0170	213.0100 Finishing Roadway (project) 001. 1005-10-75	1.000 EACH	_____.	_____.
0180	214.0100 Obliterating Old Road	11.000 STA	_____.	_____.
0190	305.0110 Base Aggregate Dense 3/4-Inch	1,450.000 TON	_____.	_____.
0200	305.0120 Base Aggregate Dense 1 1/4-Inch	8,800.000 TON	_____.	_____.
0210	305.0130 Base Aggregate Dense 3-Inch	6,100.000 TON	_____.	_____.
0220	415.0410 Concrete Pavement Approach Slab	80.000 SY	_____.	_____.
0230	416.1010 Concrete Surface Drains	25.000 CY	_____.	_____.
0240	455.0605 Tack Coat	1,110.000 GAL	_____.	_____.
0250	460.2000 Incentive Density HMA Pavement	2,250.000 DOL	1.00000	2,250.00
0260	460.5224 HMA Pavement 4 LT 58-28 S	1,800.000 TON	_____.	_____.
0270	460.7223 HMA Pavement 3 HT 58-28 S	750.000 TON	_____.	_____.
0280	460.7624 HMA Pavement 4 HT 58-28 V	820.000 TON	_____.	_____.
0290	465.0120 Asphaltic Surface Driveways and Field Entrances	6.000 TON	_____.	_____.
0300	502.0100 Concrete Masonry Bridges	698.000 CY	_____.	_____.
0310	502.3200 Protective Surface Treatment	1,020.000 SY	_____.	_____.



Proposal Schedule of Items

Proposal ID: 20170314001 Project(s): 1005-10-75

Federal ID(s): N/A

SECTION: 0001

Contract Items

Alt Set ID:

Alt Mbr ID:

Proposal Line Number	Item ID Description	Approximate Quantity and Units	Unit Price	Bid Amount
0320	502.3210 Pigmented Surface Sealer	244.000 SY	_____.	_____.
0330	503.0155 Prestressed Girder Type I 54W-Inch	1,517.000 LF	_____.	_____.
0340	505.0400 Bar Steel Reinforcement HS Structures	11,920.000 LB	_____.	_____.
0350	505.0600 Bar Steel Reinforcement HS Coated Structures	107,310.000 LB	_____.	_____.
0360	506.2605 Bearing Pads Elastomeric Non-Laminated	24.000 EACH	_____.	_____.
0370	506.4000 Steel Diaphragms (structure) 001. B-53-0350	20.000 EACH	_____.	_____.
0380	511.1200 Temporary Shoring (structure) 001. B-53-0350	1,365.000 SF	_____.	_____.
0390	516.0500 Rubberized Membrane Waterproofing	26.000 SY	_____.	_____.
0400	517.1010.S Concrete Staining (structure) 001. B-53-0350	9,330.000 SF	_____.	_____.
0410	520.1018 Apron Endwalls for Culvert Pipe 18-Inch	4.000 EACH	_____.	_____.
0420	520.3318 Culvert Pipe Class III-A 18-Inch	97.000 LF	_____.	_____.
0430	520.8000 Concrete Collars for Pipe	2.000 EACH	_____.	_____.
0440	521.0124 Culvert Pipe Corrugated Steel 24-Inch	21.000 LF	_____.	_____.
0450	521.0721 Pipe Arch Corrugated Steel 21x15-Inch	47.000 LF	_____.	_____.
0460	521.1012 Apron Endwalls for Culvert Pipe Steel 12-Inch	4.000 EACH	_____.	_____.



Proposal Schedule of Items

Proposal ID: 20170314001 Project(s): 1005-10-75

Federal ID(s): N/A

SECTION: 0001

Contract Items

Alt Set ID:

Alt Mbr ID:

Proposal Line Number	Item ID Description	Approximate Quantity and Units	Unit Price	Bid Amount
0470	521.1024 Apron Endwalls for Culvert Pipe Steel 24-Inch	3.000 EACH	_____.	_____.
0480	521.1221 Apron Endwalls for Pipe Arch Steel 21x15-Inch	2.000 EACH	_____.	_____.
0490	521.1721 Apron Endwalls for Pipe Arch Sloped Side Drains Steel 21x15-Inch 6 to 1	2.000 EACH	_____.	_____.
0500	522.0518 Culvert Pipe Reinforced Concrete Class V 18-Inch	4.000 LF	_____.	_____.
0510	522.0530 Culvert Pipe Reinforced Concrete Class V 30-Inch	310.000 LF	_____.	_____.
0520	522.1018 Apron Endwalls for Culvert Pipe Reinforced Concrete 18-Inch	1.000 EACH	_____.	_____.
0530	522.1030 Apron Endwalls for Culvert Pipe Reinforced Concrete 30-Inch	4.000 EACH	_____.	_____.
0540	550.2126 Piling CIP Concrete 12 3/4 X 0.375-Inch	2,265.000 LF	_____.	_____.
0550	603.8000 Concrete Barrier Temporary Precast Delivered	1,850.000 LF	_____.	_____.
0560	603.8125 Concrete Barrier Temporary Precast Installed	1,850.000 LF	_____.	_____.
0570	604.0500 Slope Paving Crushed Aggregate	330.000 SY	_____.	_____.
0580	606.0200 Riprap Medium	110.000 CY	_____.	_____.
0590	611.0654 Inlet Covers Type V	4.000 EACH	_____.	_____.
0600	611.3220 Inlets 2x2-FT	4.000 EACH	_____.	_____.



Proposal Schedule of Items

Proposal ID: 20170314001 Project(s): 1005-10-75

Federal ID(s): N/A

SECTION: 0001

Contract Items

Alt Set ID:

Alt Mbr ID:

Proposal Line Number	Item ID Description	Approximate Quantity and Units	Unit Price	Bid Amount
0610	612.0212 Pipe Underdrain Unperforated 12-Inch	220.000 LF	_____.	_____.
0620	612.0406 Pipe Underdrain Wrapped 6-Inch	200.000 LF	_____.	_____.
0630	614.0150 Anchor Assemblies for Steel Plate Beam Guard	4.000 EACH	_____.	_____.
0640	614.0220 Steel Thrie Beam Bullnose Terminal	2.000 EACH	_____.	_____.
0650	614.0230 Steel Thrie Beam	150.000 LF	_____.	_____.
0660	614.0905 Crash Cushions Temporary	2.000 EACH	_____.	_____.
0670	614.2300 MGS Guardrail 3	350.000 LF	_____.	_____.
0680	614.2500 MGS Thrie Beam Transition	157.600 LF	_____.	_____.
0690	614.2610 MGS Guardrail Terminal EAT	4.000 EACH	_____.	_____.
0700	616.0100 Fence Woven Wire (height) 001. 4-Ft	911.000 LF	_____.	_____.
0710	616.0700.S Fence Safety	500.000 LF	_____.	_____.
0720	618.0100 Maintenance And Repair of Haul Roads (project) 001. 1005-10-75	1.000 EACH	_____.	_____.
0730	619.1000 Mobilization	1.000 EACH	_____.	_____.
0740	624.0100 Water	550.000 MGAL	_____.	_____.
0750	625.0500 Salvaged Topsoil	31,400.000 SY	_____.	_____.
0760	627.0200 Mulching	35,000.000 SY	_____.	_____.



Proposal Schedule of Items

Proposal ID: 20170314001 Project(s): 1005-10-75

Federal ID(s): N/A

SECTION: 0001

Contract Items

Alt Set ID:

Alt Mbr ID:

Proposal Line Number	Item ID Description	Approximate Quantity and Units	Unit Price	Bid Amount
0770	628.1504 Silt Fence	4,860.000 LF	_____.	_____.
0780	628.1520 Silt Fence Maintenance	2,430.000 LF	_____.	_____.
0790	628.1905 Mobilizations Erosion Control	6.000 EACH	_____.	_____.
0800	628.1910 Mobilizations Emergency Erosion Control	3.000 EACH	_____.	_____.
0810	628.2004 Erosion Mat Class I Type B	9,600.000 SY	_____.	_____.
0820	628.6505 Soil Stabilizer Type A	3.250 ACRE	_____.	_____.
0830	628.6510 Soil Stabilizer Type B	0.450 ACRE	_____.	_____.
0840	628.7005 Inlet Protection Type A	4.000 EACH	_____.	_____.
0850	628.7015 Inlet Protection Type C	4.000 EACH	_____.	_____.
0860	628.7504 Temporary Ditch Checks	230.000 LF	_____.	_____.
0870	628.7555 Culvert Pipe Checks	20.000 EACH	_____.	_____.
0880	628.7560 Tracking Pads	5.000 EACH	_____.	_____.
0890	629.0205 Fertilizer Type A	31.000 CWT	_____.	_____.
0900	630.0120 Seeding Mixture No. 20	405.000 LB	_____.	_____.
0910	630.0200 Seeding Temporary	700.000 LB	_____.	_____.
0920	630.0300 Seeding Borrow Pit	120.000 LB	_____.	_____.
0930	633.5200 Markers Culvert End	20.000 EACH	_____.	_____.



Proposal Schedule of Items

Proposal ID: 20170314001 Project(s): 1005-10-75

Federal ID(s): N/A

SECTION: 0001

Contract Items

Alt Set ID:

Alt Mbr ID:

Proposal Line Number	Item ID Description	Approximate Quantity and Units	Unit Price	Bid Amount
0940	634.0616 Posts Wood 4x6-Inch X 16-FT	5.000 EACH	_____.	_____.
0950	634.0618 Posts Wood 4x6-Inch X 18-FT	4.000 EACH	_____.	_____.
0960	634.0622 Posts Wood 4x6-Inch X 22-FT	4.000 EACH	_____.	_____.
0970	637.2210 Signs Type II Reflective H	43.500 SF	_____.	_____.
0980	637.2230 Signs Type II Reflective F	88.000 SF	_____.	_____.
0990	638.2102 Moving Signs Type II	3.000 EACH	_____.	_____.
1000	638.2602 Removing Signs Type II	6.000 EACH	_____.	_____.
1010	638.3000 Removing Small Sign Supports	6.000 EACH	_____.	_____.
1020	638.4000 Moving Small Sign Supports	3.000 EACH	_____.	_____.
1030	642.5201 Field Office Type C	1.000 EACH	_____.	_____.
1040	643.0200.S Traffic Control Surveillance and Maintenance (project) 001. 1005-10-75	130.000 DAY	_____.	_____.
1050	643.0300 Traffic Control Drums	13,400.000 DAY	_____.	_____.
1060	643.0420 Traffic Control Barricades Type III	2,800.000 DAY	_____.	_____.
1070	643.0705 Traffic Control Warning Lights Type A	2,850.000 DAY	_____.	_____.
1080	643.0715 Traffic Control Warning Lights Type C	2,800.000 DAY	_____.	_____.
1090	643.0800 Traffic Control Arrow Boards	560.000 DAY	_____.	_____.



Proposal Schedule of Items

Proposal ID: 20170314001 Project(s): 1005-10-75

Federal ID(s): N/A

SECTION: 0001

Contract Items

Alt Set ID:

Alt Mbr ID:

Proposal Line Number	Item ID Description	Approximate Quantity and Units	Unit Price	Bid Amount
1100	643.0900 Traffic Control Signs	7,850.000 DAY	_____.	_____.
1110	643.1050 Traffic Control Signs PCMS	600.000 DAY	_____.	_____.
1120	643.1055.S Truck or Trailer Mounted Attenuator	15.000 DAY	_____.	_____.
1130	645.0120 Geotextile Type HR	330.000 SY	_____.	_____.
1140	646.0106 Pavement Marking Epoxy 4-Inch	7,750.000 LF	_____.	_____.
1150	652.0125 Conduit Rigid Metallic 2-Inch	48.000 LF	_____.	_____.
1160	652.0225 Conduit Rigid Nonmetallic Schedule 40 2-Inch	1,305.000 LF	_____.	_____.
1170	653.0222 Junction Boxes 18x12x6-Inch	4.000 EACH	_____.	_____.
1180	690.0150 Sawing Asphalt	4,450.000 LF	_____.	_____.
1190	715.0415 Incentive Strength Concrete Pavement	500.000 DOL	1.00000	500.00
1200	715.0502 Incentive Strength Concrete Structures	4,188.000 DOL	1.00000	4,188.00
1210	SPV.0035 Special 001. Roadway Embankment	17,861.000 CY	_____.	_____.
1220	SPV.0060 Special 001. Baseline CPM Progress Schedule	1.000 EACH	_____.	_____.
1230	SPV.0060 Special 002. CPM Progress Schedule Updates And Accepted Revisions	6.000 EACH	_____.	_____.
1240	SPV.0060 Special 003. Cover Plates Permanent	4.000 EACH	_____.	_____.
1250	SPV.0060 Special 004. Access Gate 6-Foot	2.000 EACH	_____.	_____.



Proposal Schedule of Items

Proposal ID: 20170314001 Project(s): 1005-10-75

Federal ID(s): N/A

SECTION: 0001

Contract Items

Alt Set ID:

Alt Mbr ID:

Proposal Line Number	Item ID Description	Approximate Quantity and Units	Unit Price	Bid Amount
1260	SPV.0060 Special 005. Emergency Access Gate	2.000 EACH	_____.	_____.
1270	SPV.0060 Special 350. PULL BOX NON-CONDUCTIVE 24X42 INCH	4.000 EACH	_____.	_____.
1280	SPV.0090 Special 700. Fence Chain Link Polymer-Coated 6-Ft	589.000 LF	_____.	_____.
1290	SPV.0105 Special 001. Survey Project 1005-10-75	LS	LUMP SUM	_____.
1300	204.0120 Removing Asphaltic Surface Milling	3,140.000 SY	_____.	_____.
1310	416.1715 Concrete Pavement Repair SHES	18.000 SY	_____.	_____.
Section: 0001			Total:	_____.
			Total Bid:	_____.

